



# ProtoArc EM04 Wireless Bluetooth Trackball Mouse User Manual

[Home](#) » [ProtoArc](#) » ProtoArc EM04 Wireless Bluetooth Trackball Mouse User Manual 

## ProTour EM04 Wireless Bluetooth Trackball Mouse User Manual



Product Features

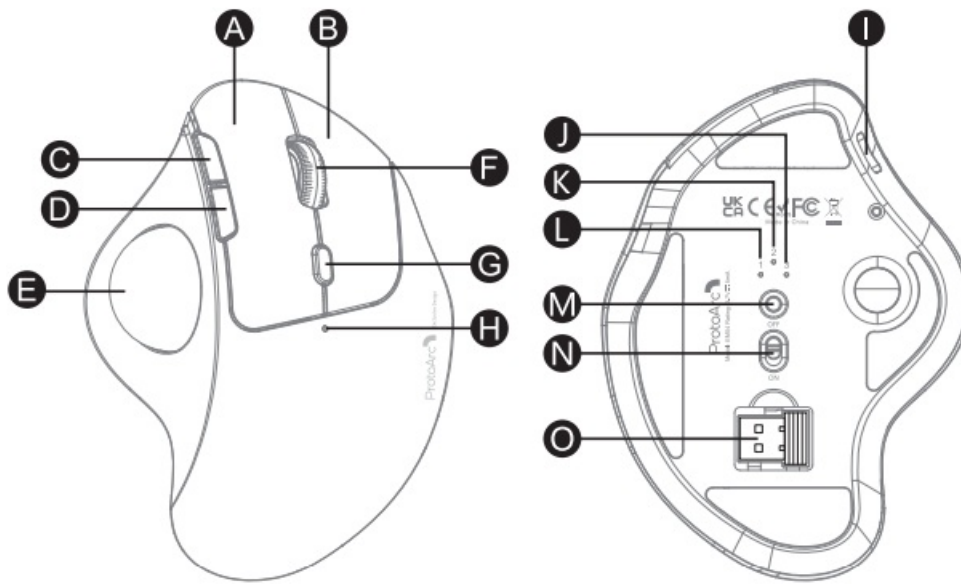

- A** Left Button
- Ⓢ** Right Button
- C** Forward Button
- D** Backward Button
- E** Trackball
- F** Scroll Wheel
- G** GDPI Button
- H** Charging/DPI Indicator
- I** TYPE-C Charging Port
- J** Wireless 2 Indicator
- K** Wireless 1 Indicator
- L** 2.4G Indicator
- M** Switch Device Button
- N** Power Switch
- USB Receiver

## USB Connection

1. Turn on the power switch to ON.

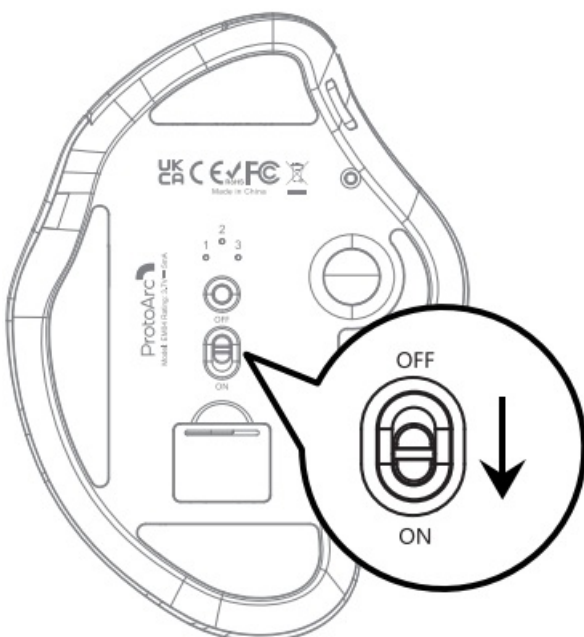

2. Take out the receiver

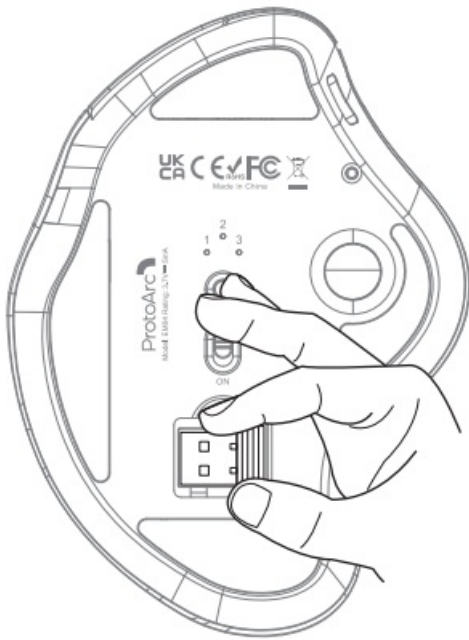

3. Press the mode switch button until the white light 1 is on and enter 2.4G mode.

3

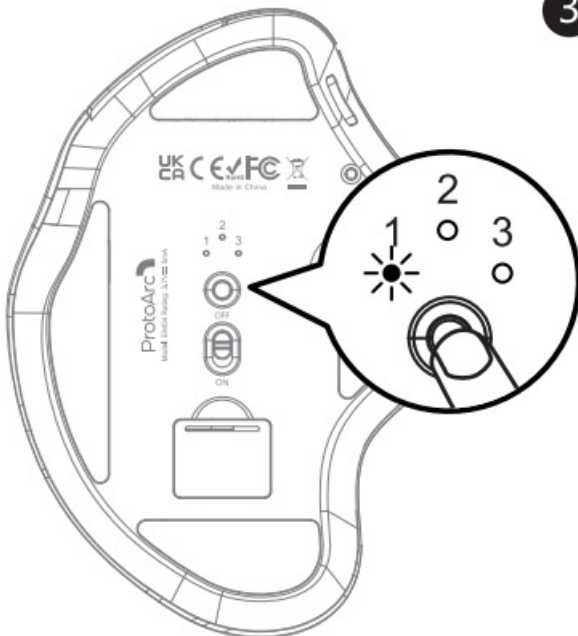

4. Insert the usb receiver into your computer's usb port.

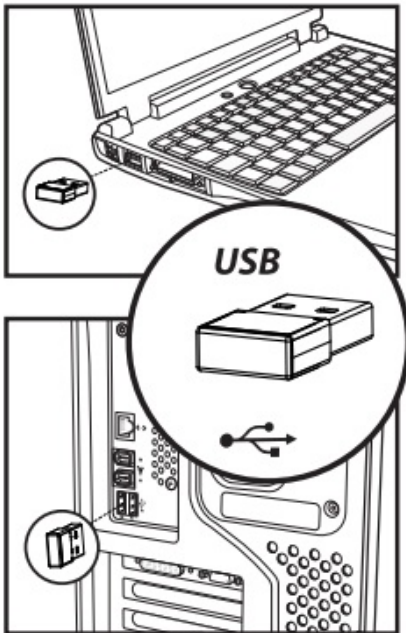

## Contents

- [1 Bluetooth Connection](#)
- [2 Windows 10 System](#)
- [3 Mac OS System](#)
- [4 iOS System](#)
- [5 Android system](#)
- [6 haring Function Guide](#)
- [7 How to switch connection mode](#)
- [8 Data parameters](#)
- [9 What's in Package](#)
- [10 Documents / Resources](#)
  - [10.1 References](#)
- [11 Related Posts](#)

## Bluetooth Connection

1. .Turn on the power switch 10 ON

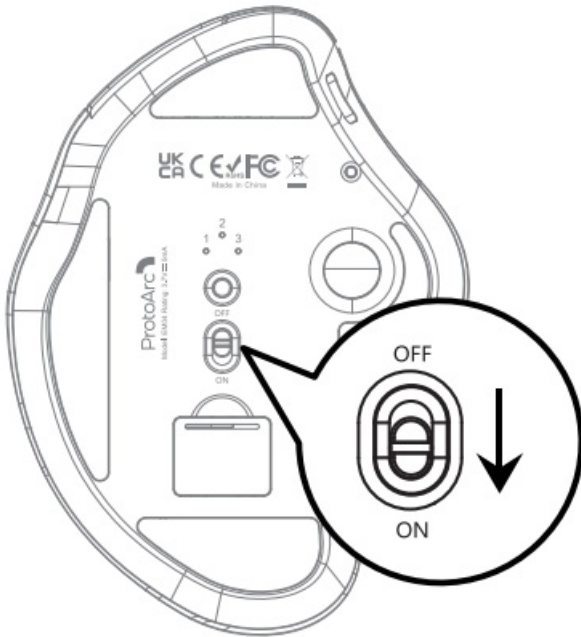

2. Press the mode switch button and switch to 2 or 3 mode, the white light flashes slowly.

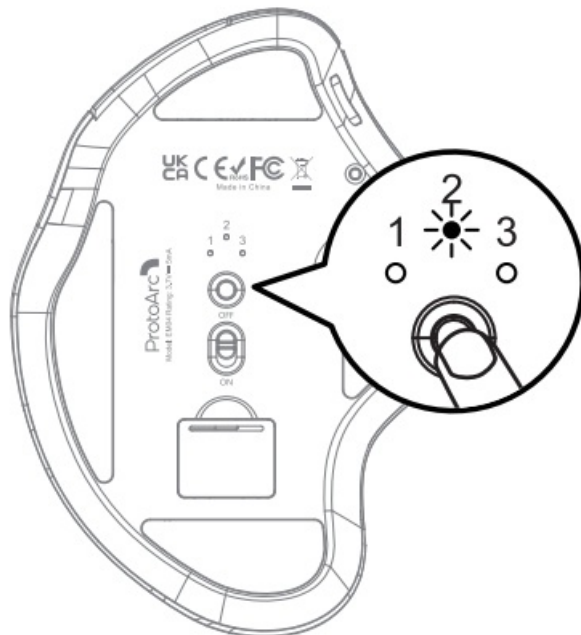

3. Press and hold the mode switch button for 3~5 seconds until the white light fishes quickly, then the mouse enters the Bluetooth pairing mode.

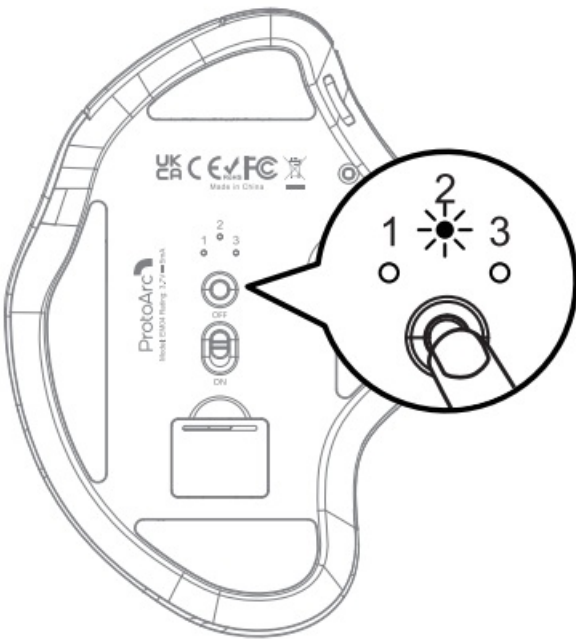

## Windows 10 System

4. Click “Bluetooth device”



5. Click “Add or remove a Bluetooth device”.

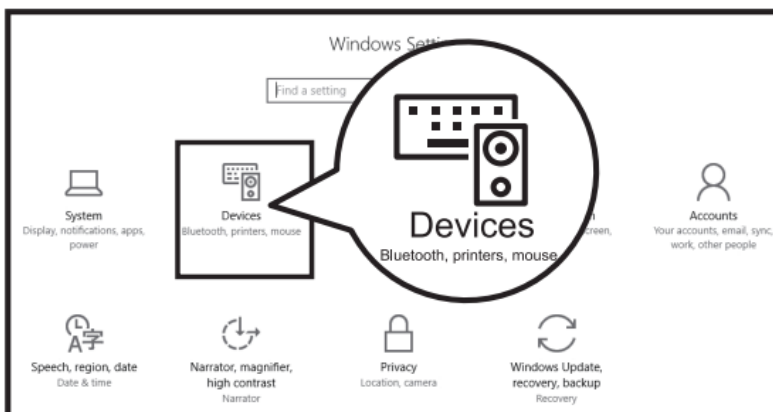

6. Your computer will automatically search for “ProTour EM04” and then click “pair”.

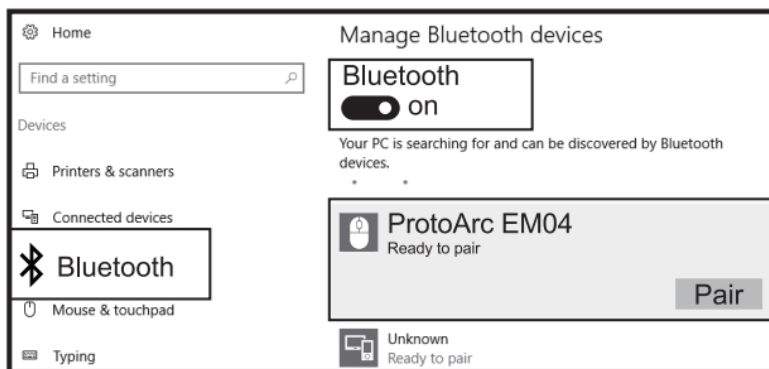

7. "ProTour EMO4- s connected an can be used normally

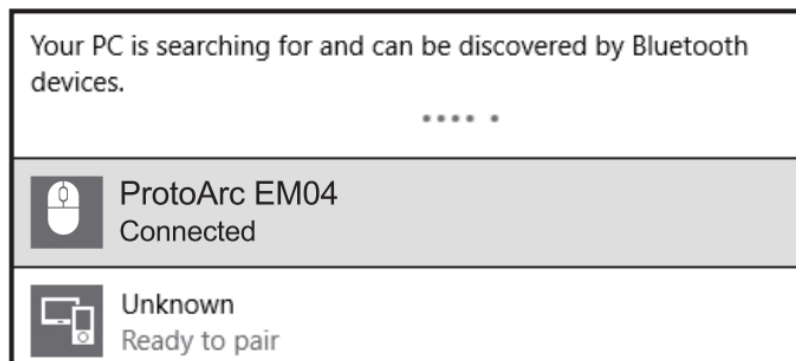

## Mac OS System

Please complete the Bluetooth mode installation step 123 before paining

1. .click system Preferences: on Mac

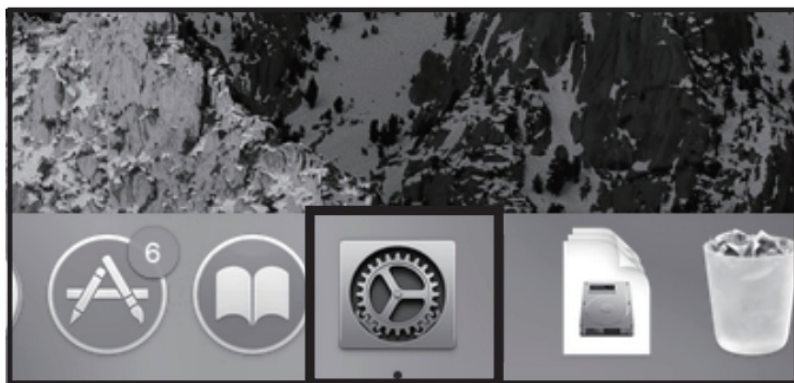

2. Click "Bluetooth in "System Preferences".

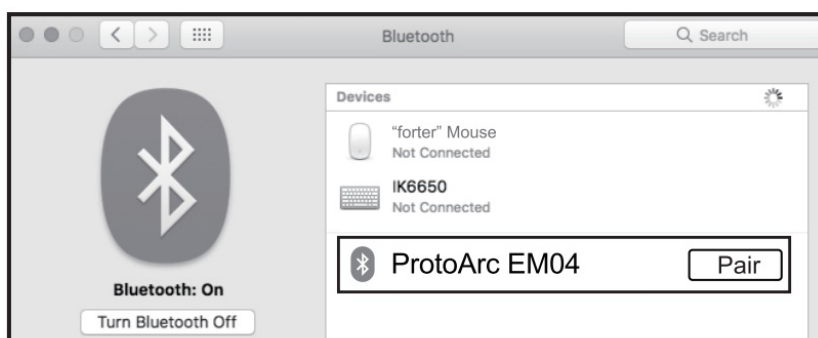

3. Your computer will automatically find “ProTour EM04”, then click “pair”, and you can use it after installation

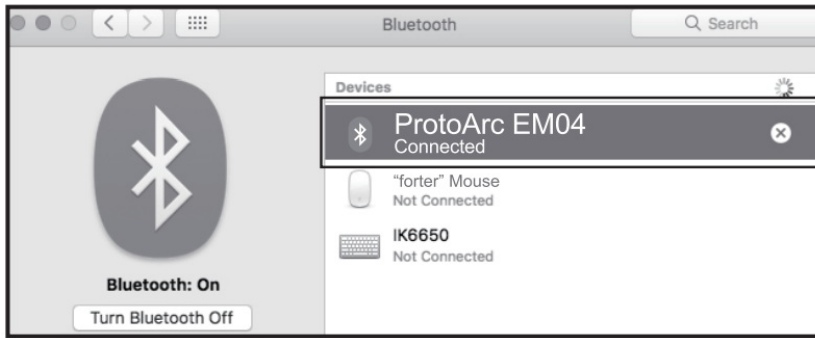

## iOS System

Only the system above iOS 13 supports the mouse function.  
Please complete the Bluetooth mode installation step 123 before pairing.

1. Click Settings on your device, then turn on Accessibility.

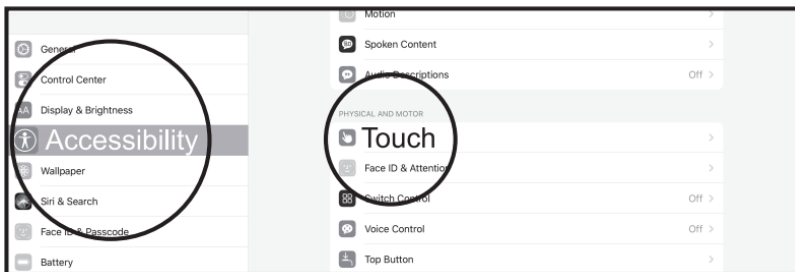

2. click Touch

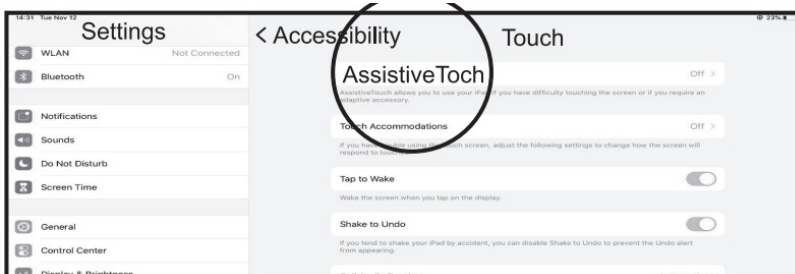

3. Turn on Assistive Touch

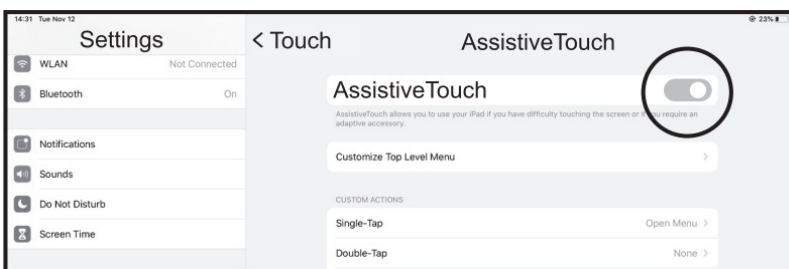

4. Click Settings on the device, then turn on Bluetooth

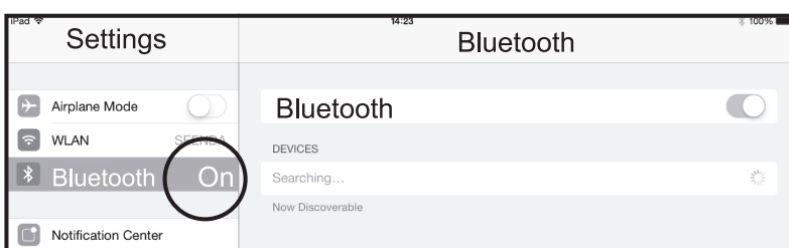

5. Your computer will automatically find \*ProTour EM04”, then click \*Pair’, complete pairing



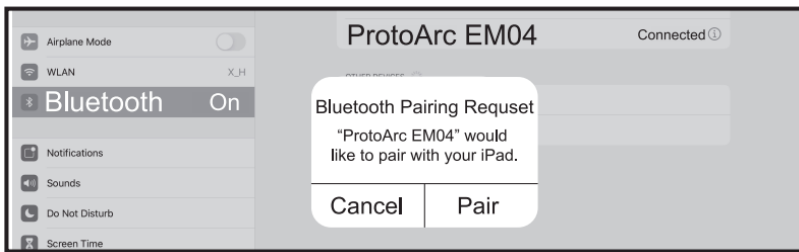

6. “ProTour EM04” s connected and can be used normally

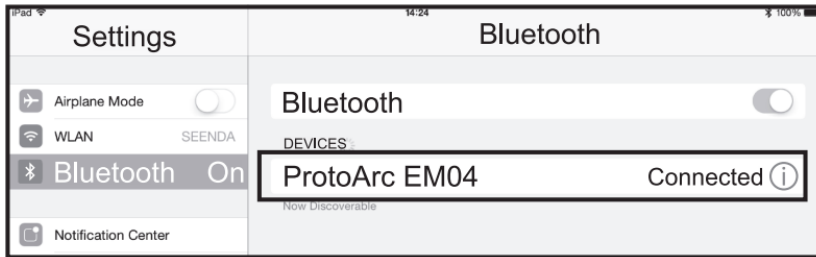

## Android system

Please complete the Bluetooth mode installation step 123 before pairing

1. Crick Settings on the devices, then tum on Bluetooth



2. Your computer will automatically find “ProTour EM04”, then click “pair”, complete pairing

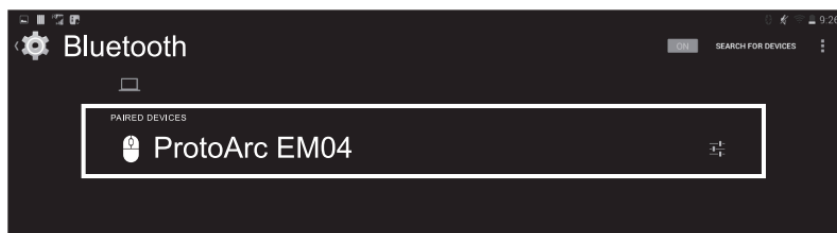

3. “Proton EWO4” s connected and on boa used normally

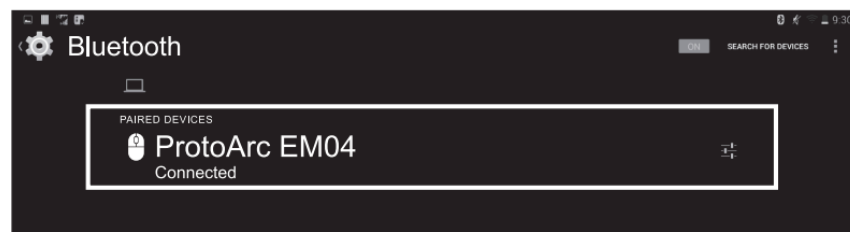

## haring Function Guide

When the power is insufficient, the charging indicator and the corresponding channel indicator flash until it s timed off. Please ‘connect the power supply for charging in time, and use the USB cable to connect the TYPE-C charging Port.

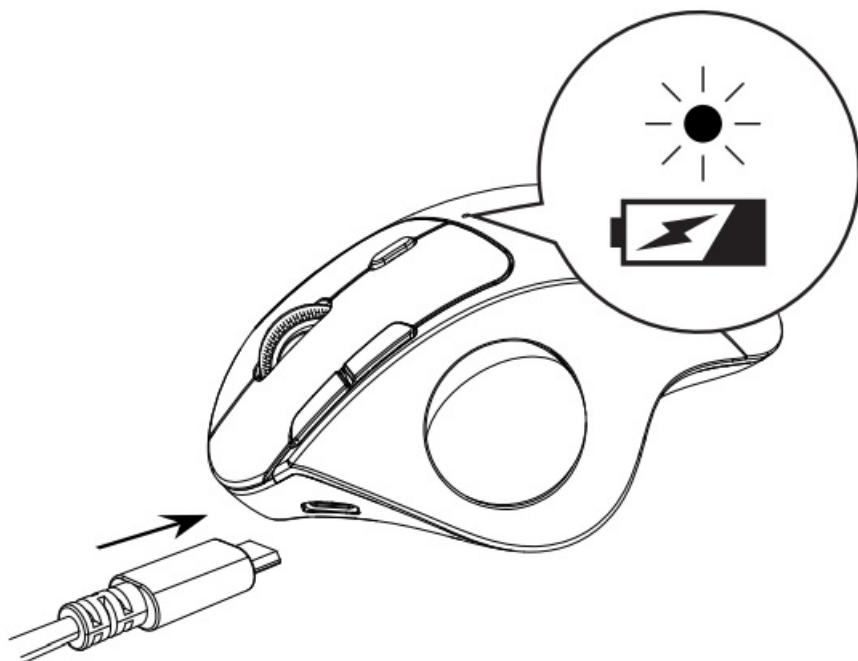

Connect the charging cable to the USB port of the computer, the charging indicator s always on during charging, the charging time is about 1-3.5 hours and the indicator ight turs off when charging is complete.

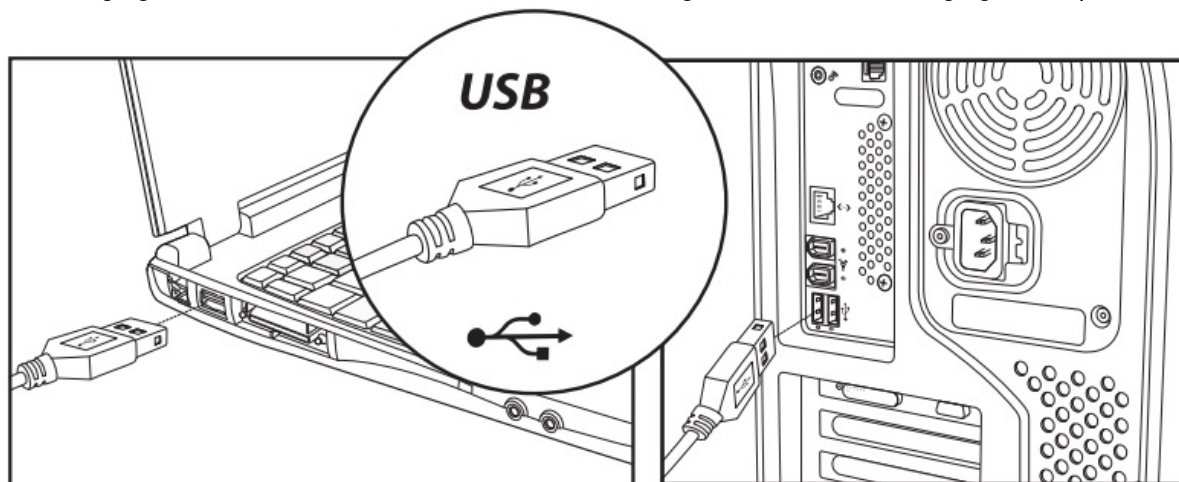

## How to switch connection mode

After BT1, BT2 and 2.4G USB mode is connected, press the mode switch bunion on the top of the mouse to switch between multiple devices.

Wireless 1 Device Connection

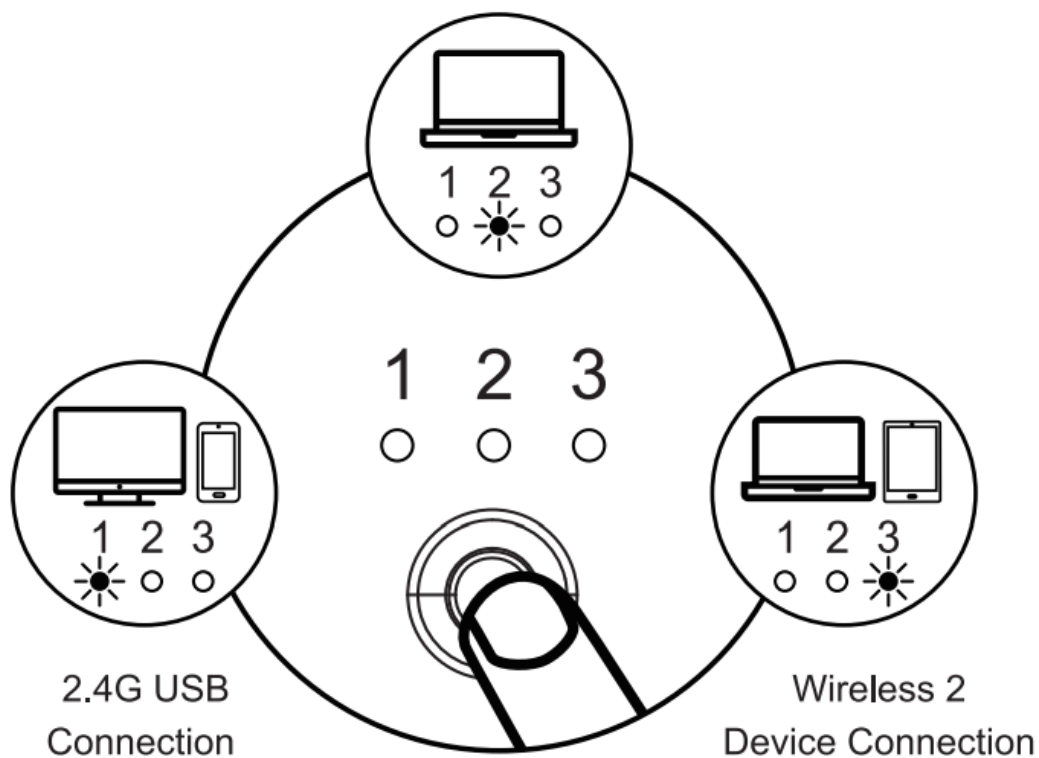

## Data parameters

### Basic parameter.

**Movement Detection Technology:** Optical

**Lithium Battery Capacity:** 300mA

**DPI:** 200-400-800-1200-1600

**Click Life:** 3 million+ Dimension: 136.8'100.552.3mm

**Weight:** 119g

### Bluetooth transmission parameters:

**Transmission distance:** 10m

**Working Voltage:** 3.7V

**Working current:** 8mA

**Reaction rate:** 125Hz

#### System requirement:

Bluetooth-enable device

Windows 8, Windows 10 or higher version Mac OS X 10.10 or higher version

Android 4.3 or higher version

### 2.4G transmission parameters :

Transmission distance: 20m

**Working Voltage:** 3.7V

**Working current:** 10mA

**Reaction rate:** 250Hz

#### System requirement:

An available USB port

Windows XP, Windows 7, Windows 8, Windows 10 or higher version Mac OS x 10.10 or higher version

## What's in Package

- 1 x Wireless Mouse
- 1 x USB Receiver

- 1 x Type C Charging Cable
- 1 x User Manual

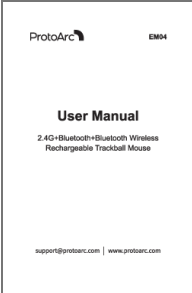
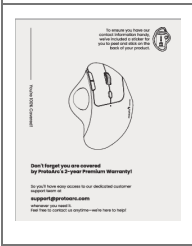

Documents / Resources

 <p>The image shows the cover of the ProtoArc EM04 User Manual. It features the ProtoArc logo, the model number EM04, and the title 'User Manual' for the '2.4G+Bluetooth+Bluetooth Wireless Rechargeable Trackball Mouse'. Contact information for support@protoarc.com and www.protoarc.com is at the bottom.</p>	<p><a href="#">ProtoArc EM04 Wireless Bluetooth Trackball Mouse</a> [pdf] User Manual</p> <p>EM04, EM04 Wireless Bluetooth Trackball Mouse, Wireless Bluetooth Trackball Mouse, Bluetooth Trackball Mouse, Trackball Mouse, Mouse</p>
 <p>The image shows the cover of the ProtoArc EM04 User Guide. It features a diagram of the mouse and text including 'Don't forget to read the manual by ProtoArc's 2-year Warranty!', 'support@protoarc.com', and 'EM04 User Guide'.</p>	<p><a href="#">ProtoArc EM04 Wireless Bluetooth Trackball Mouse</a> [pdf] User Guide</p> <p>EM04, EM04 Wireless Bluetooth Trackball Mouse, Wireless Bluetooth Trackball Mouse, Bluetooth Trackball Mouse, Trackball Mouse, Mouse</p>

References

- [User Manual](#)