



# ProtoArc EM01 Wireless Rechargeable RGB Trackball Mouse User Manual

[Home](#) » [ProtoArc](#) » ProtoArc EM01 Wireless Rechargeable RGB Trackball Mouse User Manual 

## ProtoArc EM01 Wireless Rechargeable RGB Trackball Mouse User Manual



### Contents

- [1 What's in Package](#)
- [2 Product Feature](#)
- [3 2.4G USB CONNECTION](#)
- [4 BLUETOOTH CONNECTION](#)
- [5 Charging Function Guide](#)
- [6 How to switch connection mode](#)
- [7 Data Parameters](#)
- [8 FCC Warning](#)
- [9 Documents / Resources](#)
- [10 Related Posts](#)

### What's in Package

- 1 x Wireless Mouse
- 1 x USE Receiver
- 1 x Type C Charging Cable
- 1x User Manual

## Product Feature

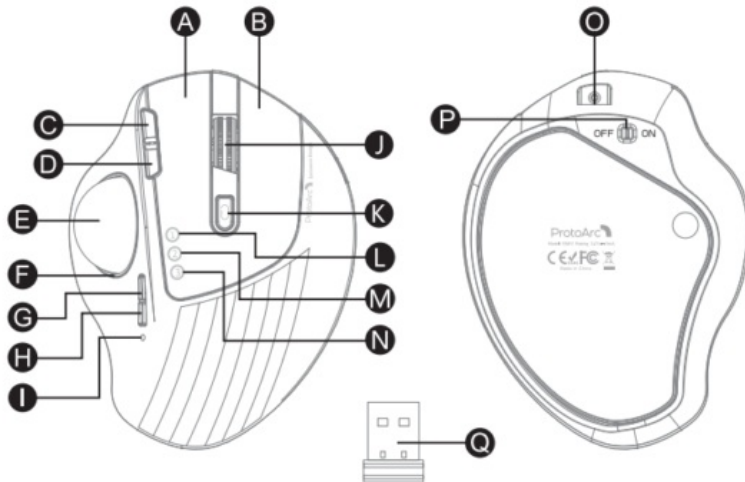

- A. Left Button
- B. Right Button
- C. Forward Button
- D. Backward Button
- E. Trackball
- F. Led Rim Light
- G. Light Swath Button
- H. DPI Button
- I. Charging !DPI Indicated.
- J. Scroll Wheel
- K. Switch Device Button
- L. 2.4G Indicator
- M. Wireless 1 Indicator
- N. Wireless 2 Indicator
- O. TYPE-C Charging Port
- P. Power Switch
- Q. USB Receiver

**Light switch button:** Press lightly to switch lights, long press for three seconds to turn off the light effect.

### Light mode:

1. Streamer mode (Default)
2. Breathing mode
3. Mixed color breathing mode
4. Neon mode

### Adjustable mouse grip angle

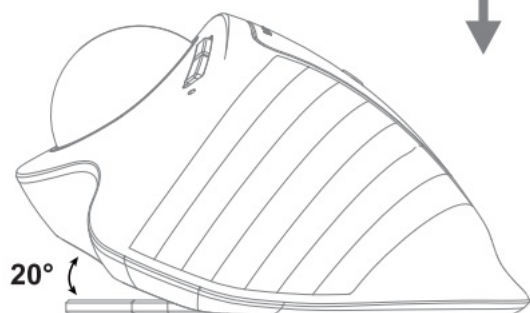
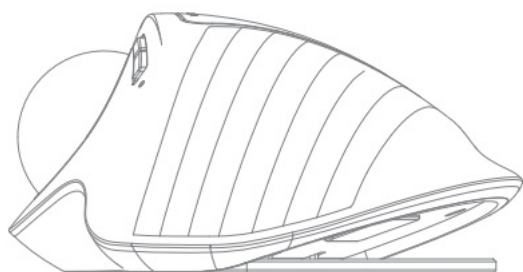

## 2.4G USB CONNECTION

1. Turn on the power switch to ON.

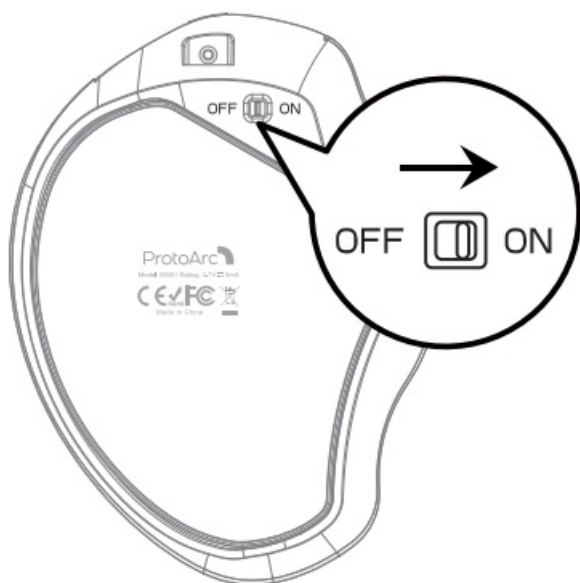

2. Take out the receiver

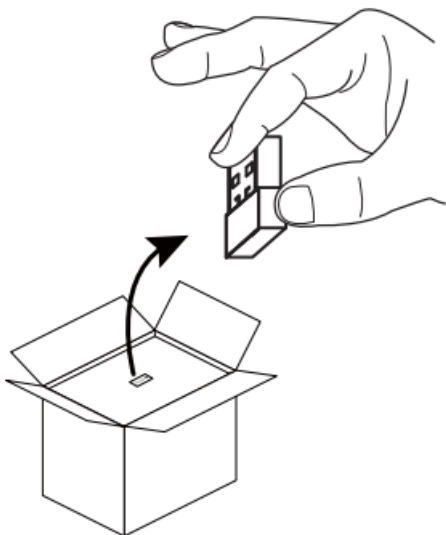

3. Press the mode switch button

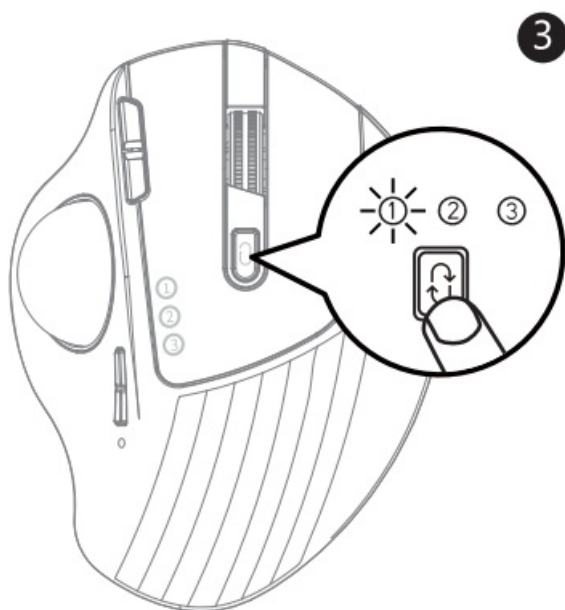

4. Insert the usb receiver until the white light C) is on and into your computer's usb enter 2.4G mode. port.

4

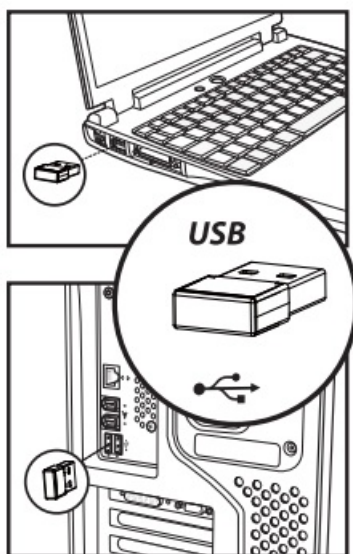

## BLUETOOTH CONNECTION

1. Turn on the power switch to ON.

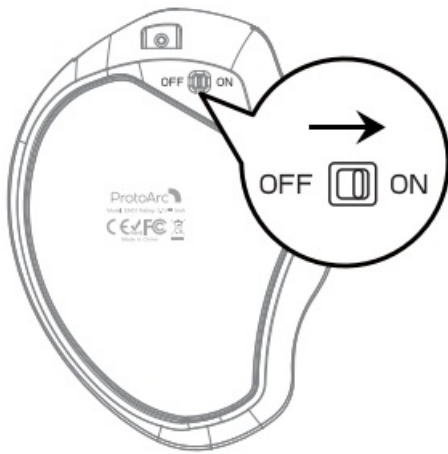

2. Press the mode switch button and switch to(DorC) mode, the white light flashes slowly.

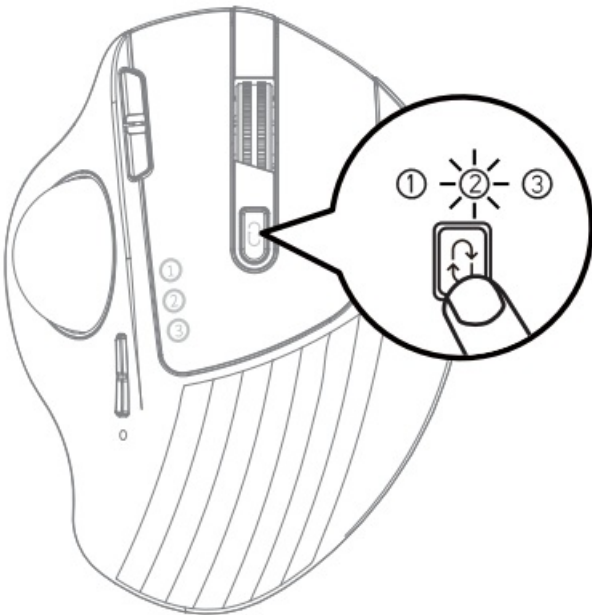

3. Press and hold the mode switch button for 3-5 seconds until the white light flashes quickly, then the mouse enters the Bluetooth pairing mode.

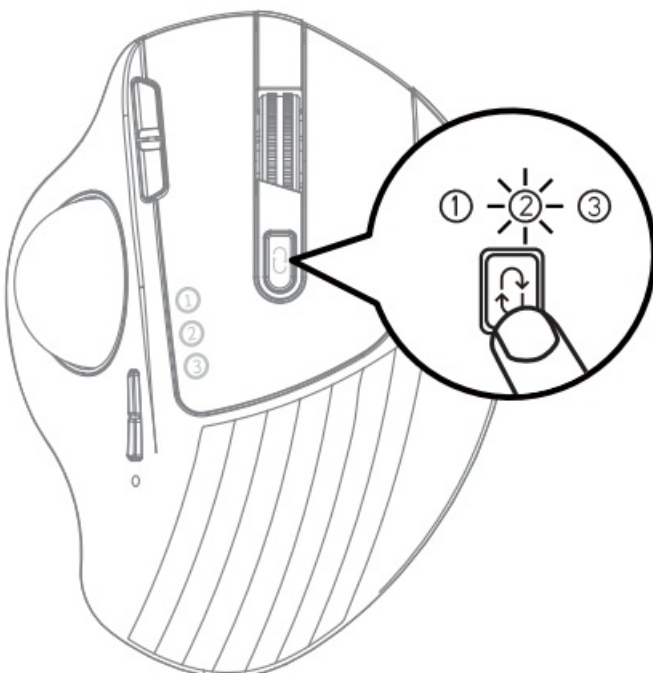

4. Click "Bluetooth device"



5. Click "Add or remove a Bluetooth device"

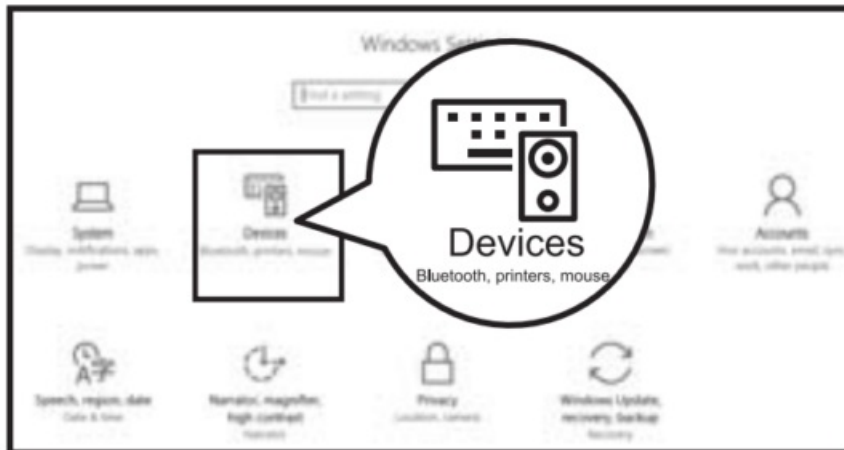

6. Your computer will automatically search for "ProtoArc EM01" and then click "pair"

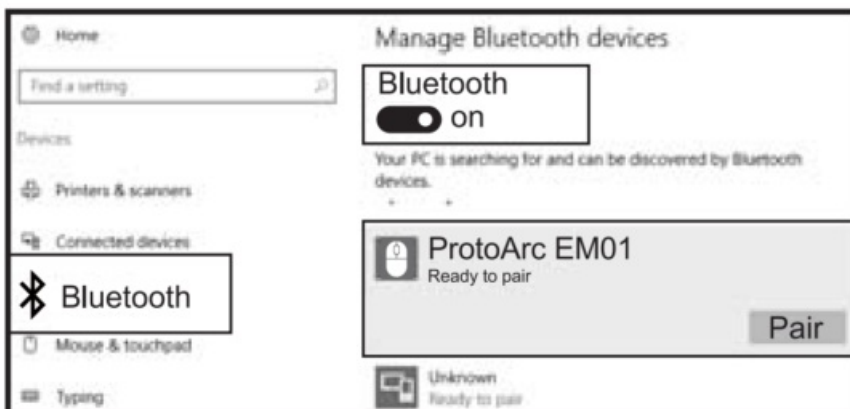

7. "ProtoArc EM01" is connected and can be used normally.

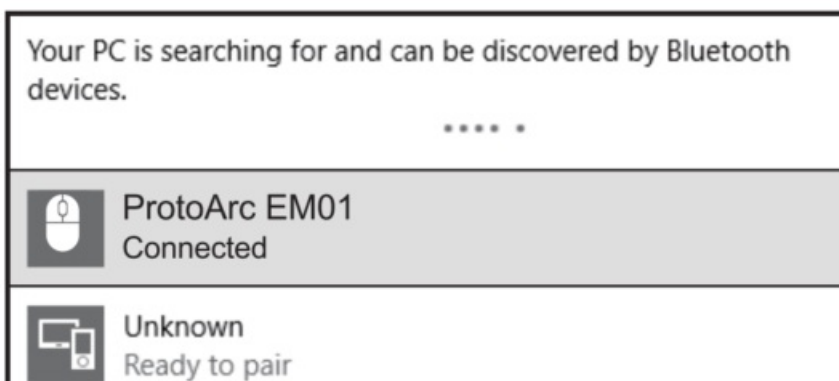

## MAC OS SYSTEM

Please complete the Bluetooth mode installation step 123 before pairing.

1. Click “System Preferences” on Mac



2. Click “Bluetooth” in “System Preferences”



3. Your computer will automatically find “ProtoArc EM01”, then click “pair”, and you can use it after installation.



## iOS System

Only the system above iOS 13 supports the mouse function. Please complete the Bluetooth mode installation step 123 before pairing.

1. Click setting on your device, then turn on Accessibility

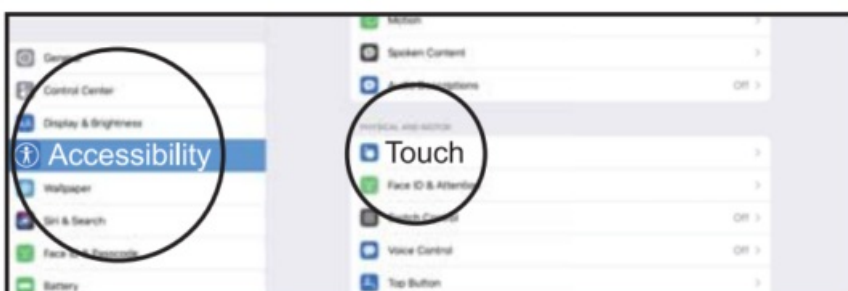

2. Click Touch

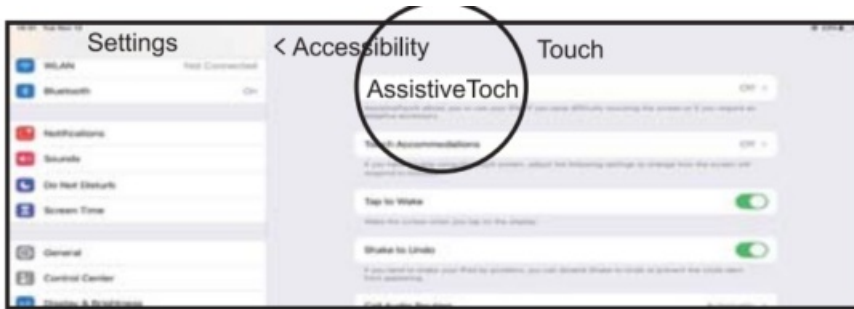

3. Turn on Assistive Touch

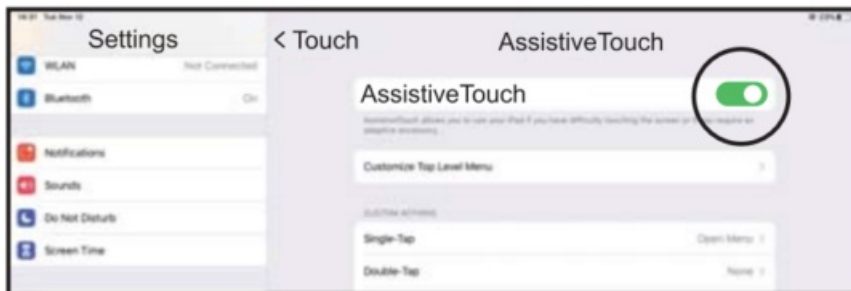

4. Click Settings on the device, then turn on Bluetooth



5. Your computer will automatically find "ProtoArc EM01", then click "Pair", complete pairing.

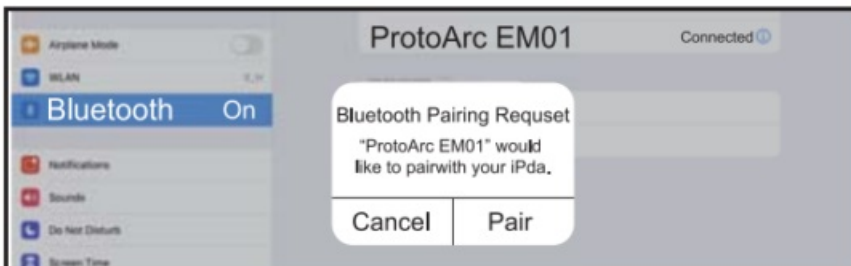

6. "ProtoArc EM01" is connected and can be used normally



## Andriod System

Please complete the Bluetooth mode installation step 123 before pairing.



1. Click Settings on the device, then turn on Bluetooth

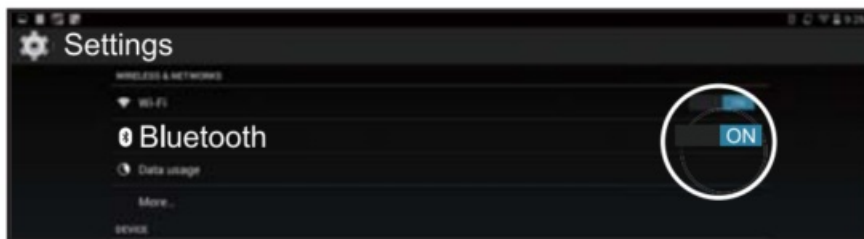

2. Your computer will automatically find “ProtoArc EM01”, then click “pair”, complete pairing.

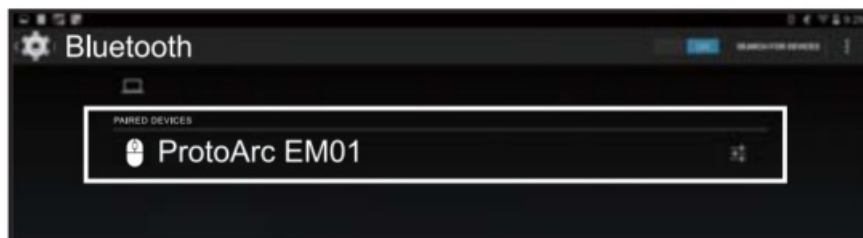

3. ProtoArc EM01” is connected and can be used normally

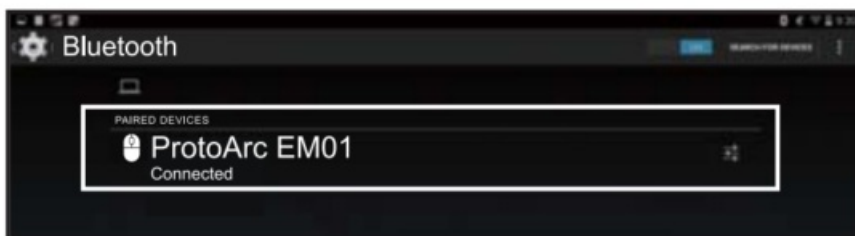

## Charging Function Guide

When the power is insufficient, the charging indicator and the corresponding channel indicator lash until it is turned off. Please connect the power supply for charging in time, and use the USB cable to connect the TYPE-C charging Port.

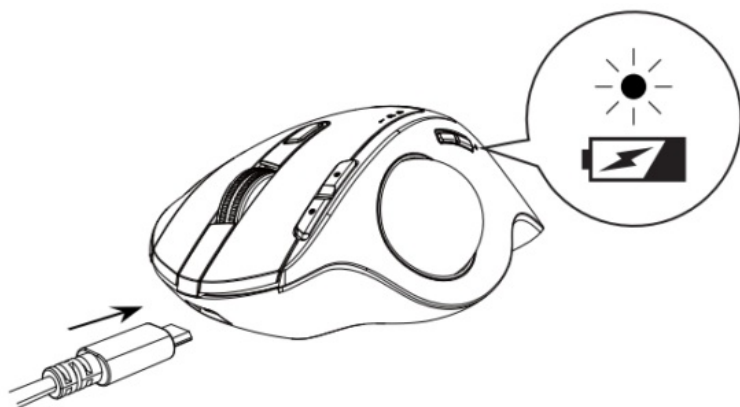

Connect the charging cable to the USB port of the computer, the charging indicator is always on during charging, the charging time is about 1-3.5 hours and the indicator light turns off when charging is complete.

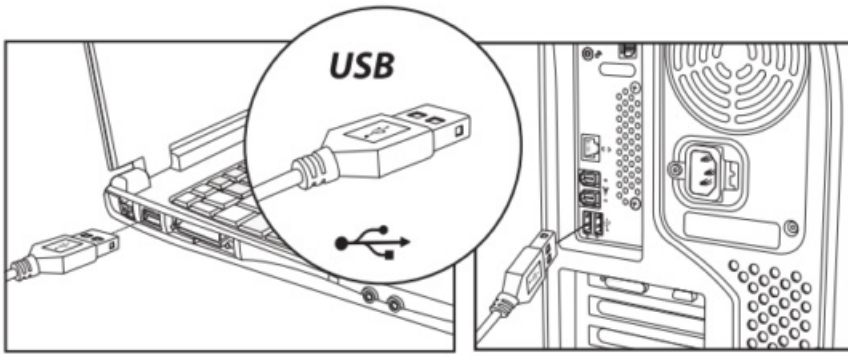

## How to switch connection mode

After BT1, BT2 and 2.4G USB mode is connected, press the mode switch button on the top of the mouse to switch between multiple devices.

### Wireless 1 Device Connection

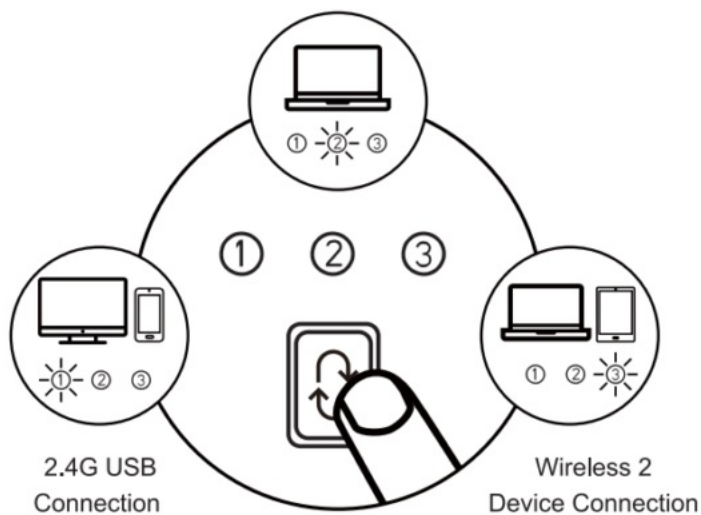

Press the mode switch button on the top of the mouse to switch between 3 devices

## Data Parameters

### Basic parameter:

- Chip: Nordic NRF51802W
- Movement Detection Technology: Optical
- Lithium battery Capacity: 900mA
- DPI: 1000-1600-2400
- Click life: 3 million+
- Dimension: 133'101'51 mm
- Weight: 190g

### Bluetooth transmission parameters:

- Transmission distance: 10m

- Working Voltage: 3.7V
- Working current: 4mA
- Reaction rate: 125Hz

#### **System requirement:**

- Bluetooth-enable device  
Windows 8, Windows 10 or higher version  
Mac OS x 10.10 or higher version  
Android 4.3 or higher version

#### **2.4G transmission parameters:**

- Transmission distance: 20m
- Working Voltage: 3.7V
- Working current: 5.5mA
- Reaction rate: 250Hz

#### **System requirement:**

- An available USB port  
Windows XP, Windows 7, Windows 8, Windows 10 or higher version  
Mac OS x 10.10 or higher version

#### **FCC Warning**

This device complies with Part 15 of the FCC Rules. Operation is subject to the following two conditions: (1) This device may not cause harmful interference, and (2) this device must accept any interference received, including interference that may cause undesired operation.

**NOTE 1:** This equipment has been tested and found to comply with the limits for a Class B digital device, pursuant to part 15 of the FCC Rules. These limits are designed to provide reasonable protection against harmful interference in a residential installation. This equipment generates uses and can radiate radio frequency energy and, if not installed and used in accordance with the instructions, may cause harmful interference to radio communications. However, there is no guarantee that interference will not occur in a particular installation. If this equipment does cause harmful interference to radio or television reception, which can be determined by turning the equipment off and on, the user is encouraged to try to correct the interference by one or more of the following measures:

- Reorient or relocate the receiving antenna.
- Increase the separation between the equipment and receiver.
- Connect the equipment into an outlet on a circuit different from that to which the receiver is connected.
- Consult the dealer or an experienced radio/TV technician for help.

**NOTE 2:** Any changes or modifications to this unit not expressly approved by the party responsible for compliance could void the user's authority to operate the equipment.

#### **Documents / Resources**

	<p><a href="#">ProtoArc EM01 Wireless Rechargeable RGB Trackball Mouse</a> [pdf] User Manual EM01, 2A5DL-EM01, 2A5DLEM01, EM01 Wireless Rechargeable RGB Trackball Mouse, EM01 , Wireless Rechargeable RGB Trackball Mouse, RGB Trackball Mouse, Rechargeable RGB Trackball Mouse, RGB Trackball Mouse, Trackball Mouse</p>
---	---