



ProtoArc EM01 Wireless Bluetooth Trackball Mouse User Manual

[Home](#) » [ProtoArc](#) » ProtoArc EM01 Wireless Bluetooth Trackball Mouse User Manual 

ProtoArc

Emo1

User Manual

2.4G+Bluetooth+Bluetooth
Rechargeable RGB Trackball Mouse

Contents

- [1 Product Features](#)
- [2 2.4G USB Connection](#)
- [3 Bluetooth Connection](#)
- [4 Charging Function Guide](#)
- [5 How to switch connection mode](#)
- [6 Date parameters](#)
- [7 What's in Package](#)
- [8 Documents / Resources](#)
 - [8.1 References](#)
- [9 Related Posts](#)

Product Features

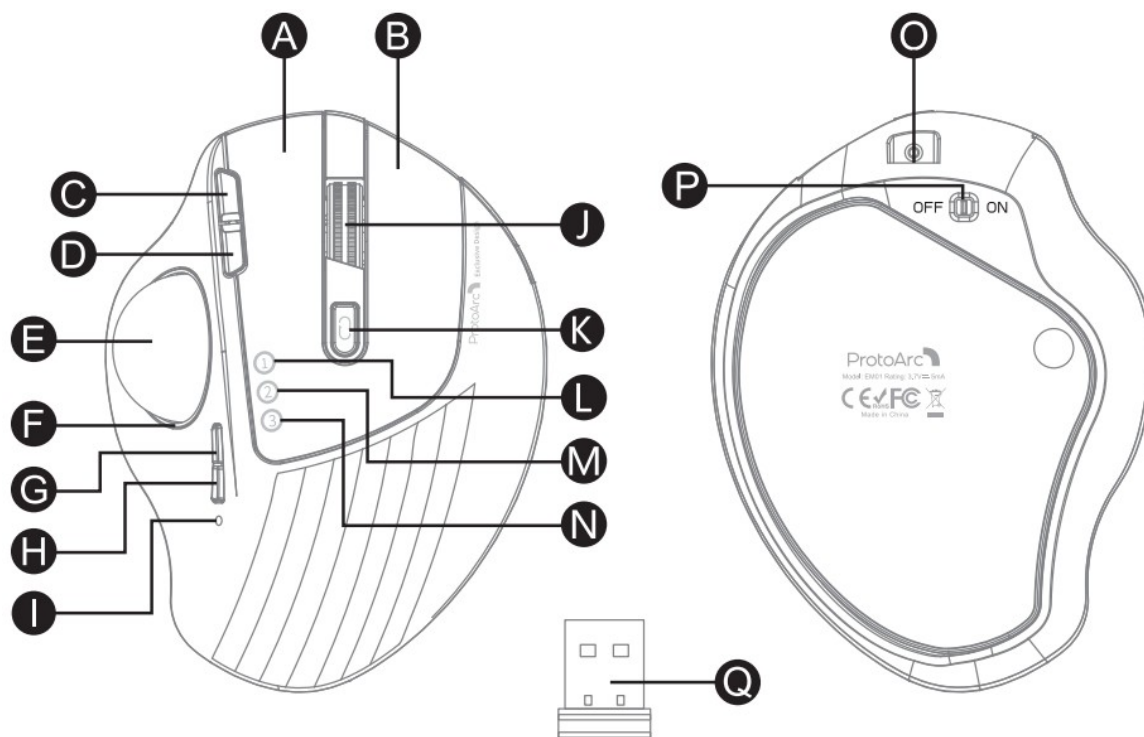

A. Left Button
C. Forward Button
E. Trackball
G. Light Switch Button
I. Charging / DPI Indicator
K. Switch Device Button
M. Wireless 1 Indicator
O. TYPE-C Charging Port
Q. USB Receiver

B. Right Button
D. Backward Button
F. LED Rim Light
H. DPI Button
J. Scroll Wheel
L. 2.4 Indicator
N. Wireless 2 Indicator
P. Power Switch

 **Light switch button:** Press lightly to switch lights, long press for three seconds to turn off the light effect.
Light mode:

1. Streamer mode (Default)
2. Breathing mode
3. Mixed color breathing mode
4. Neon mode.

Adjustable mouse grip angle

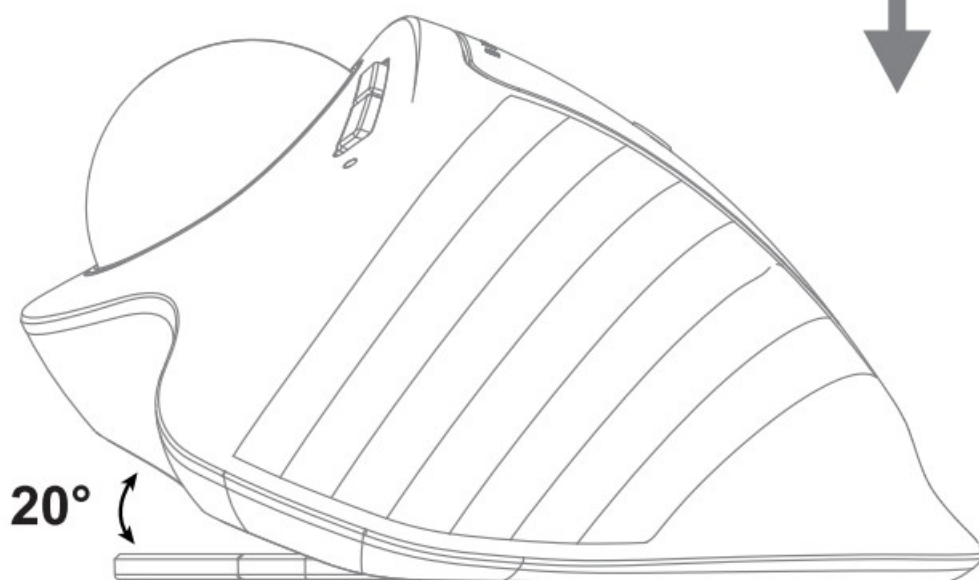
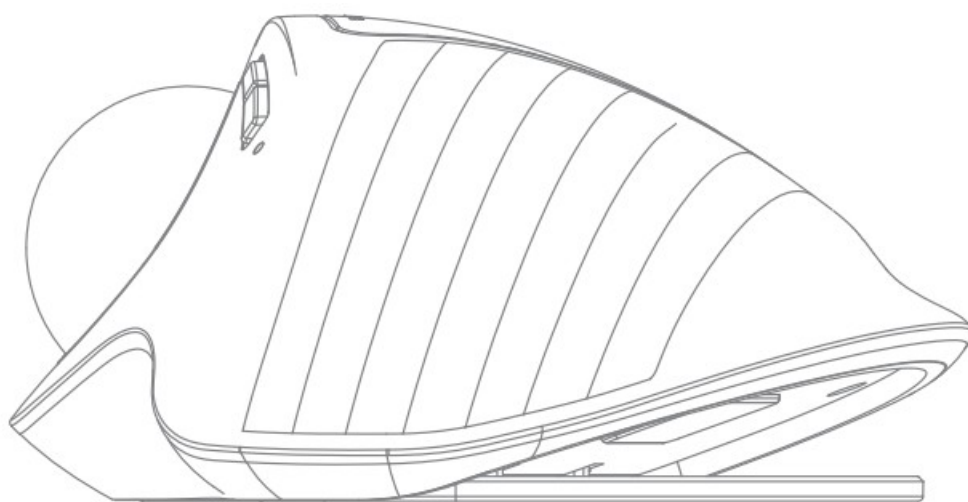

2.4G USB Connection

1. Turn on the power switch 100N.

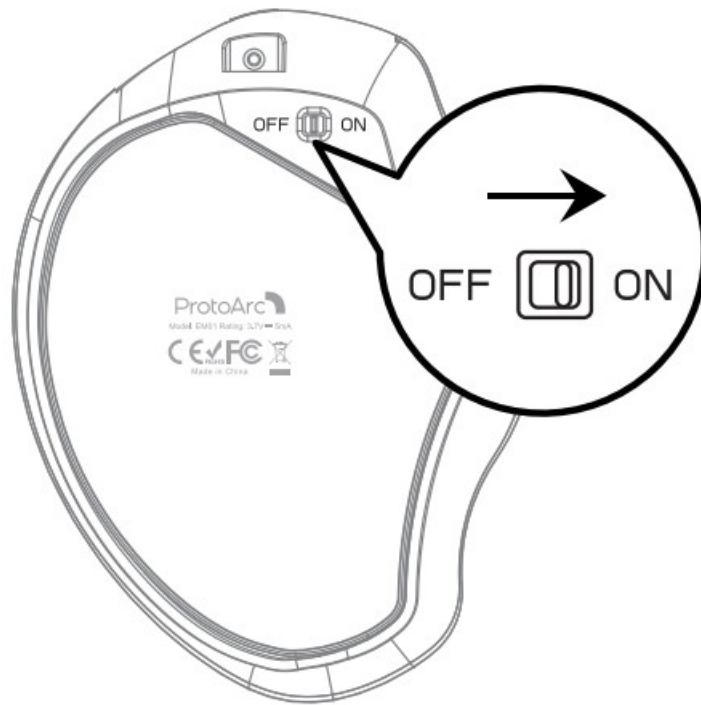

2. Take out the receiver.

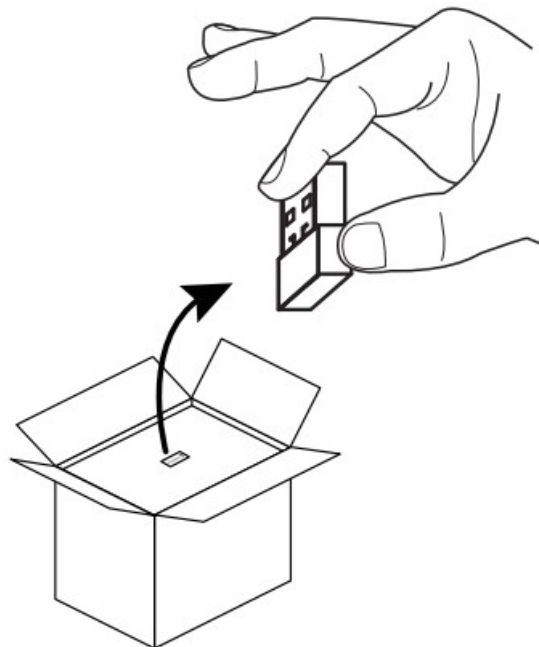

3. Press the mode switch button until the white light 1 is on and enter 2.4G mode.

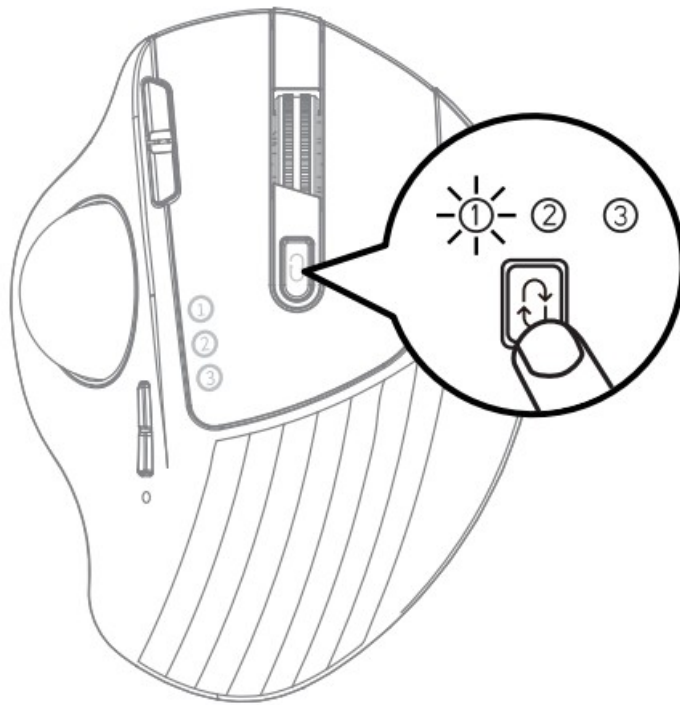

4. Insert the usb receiver into your computer's usb port.

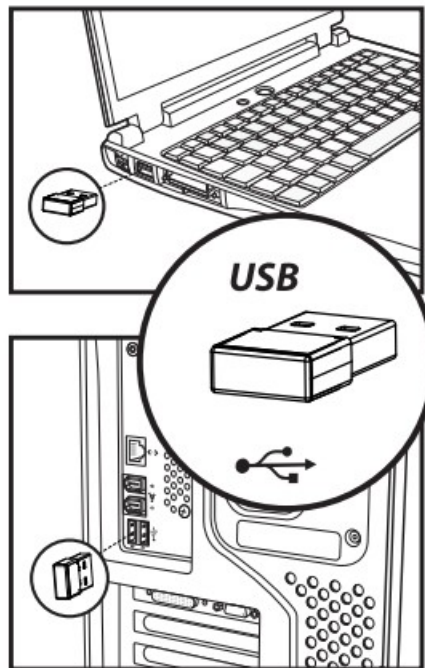

Bluetooth Connection

1. Turn on the power switch to ON.

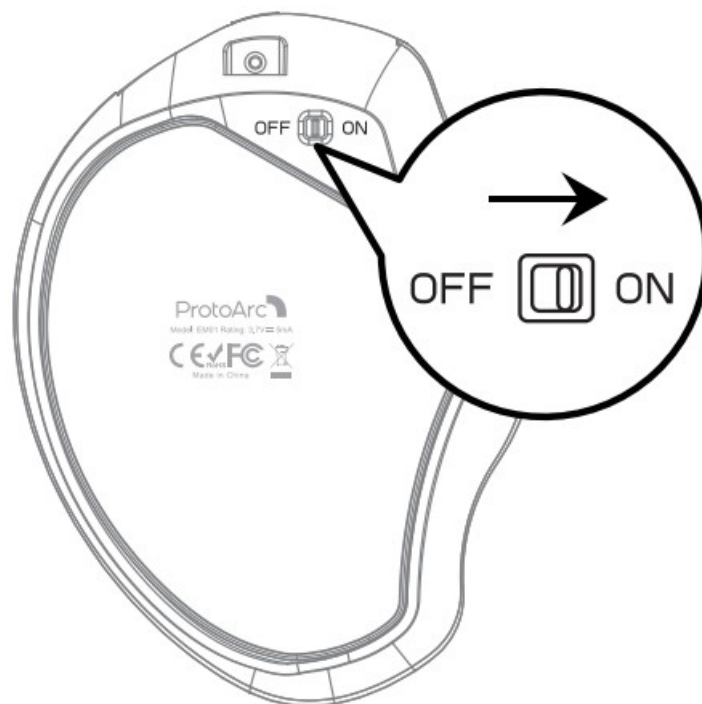

2. Press the mode switch button and switch to 2 or 3 mode, the white light flashes slowly.

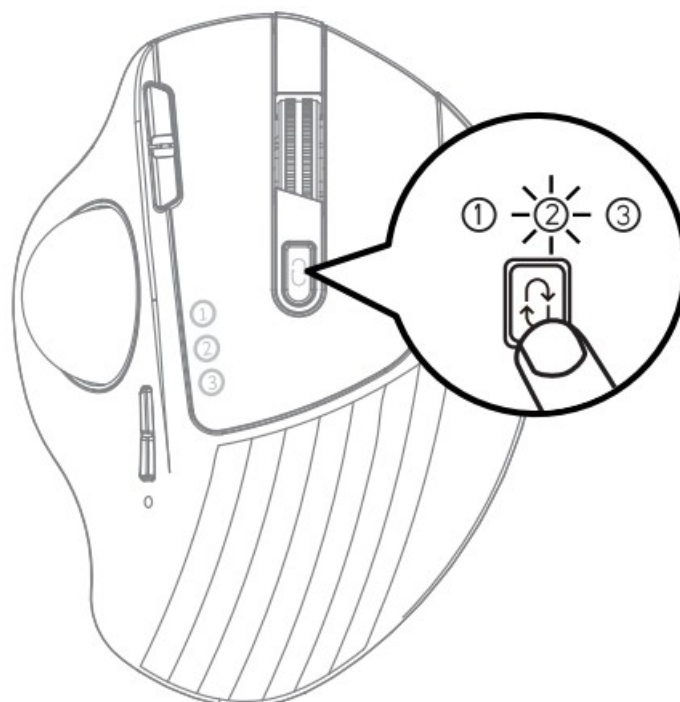

3. Press and hold the mode switch button for 3~5 seconds until the white light flashes quickly, then the mouse enters the Bluetooth pairing mode.

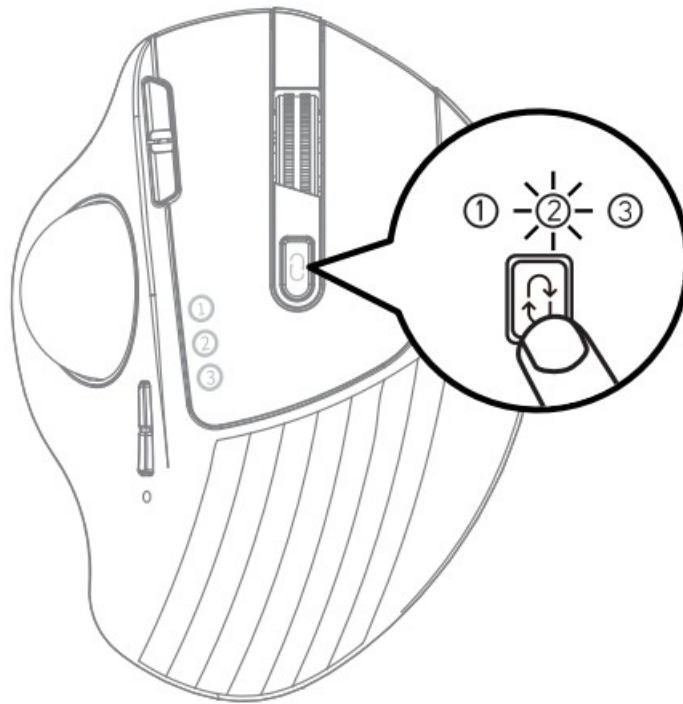

Windows 10 System

4. Click "Bluetooth device™"



5. Click "Add or remove a Bluetooth device"

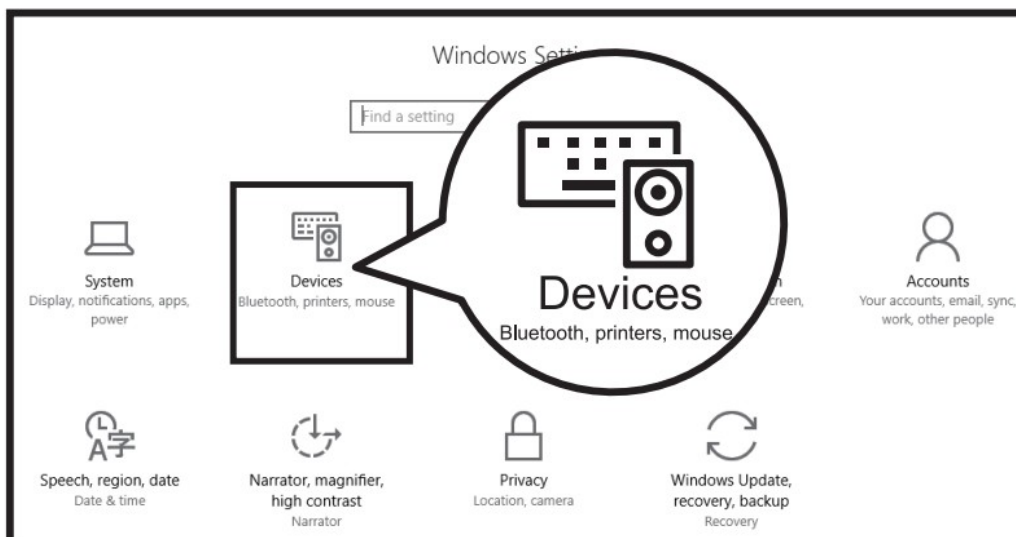

6. Your computer will automatically search for "ProtoArc EM01" and then click "pair"

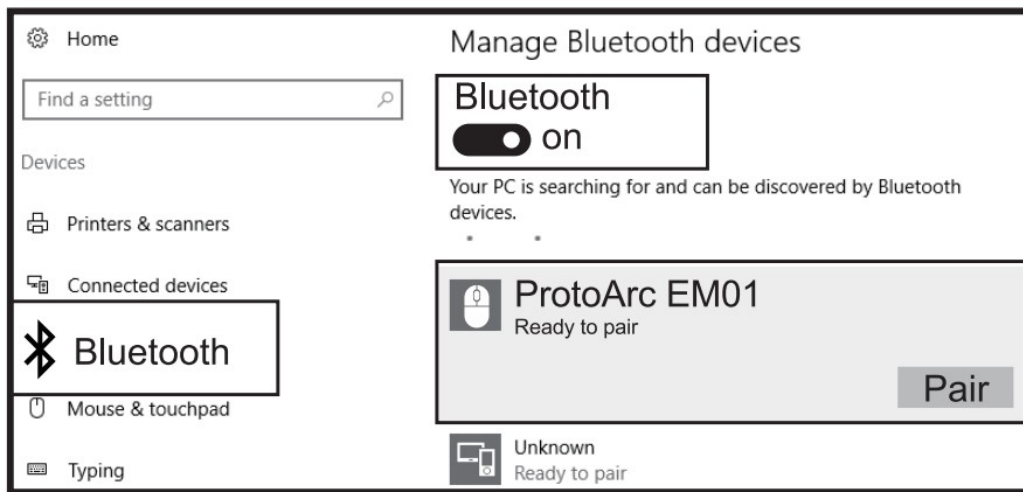

7. "ProtoArc EM01" is connected and can be used normally

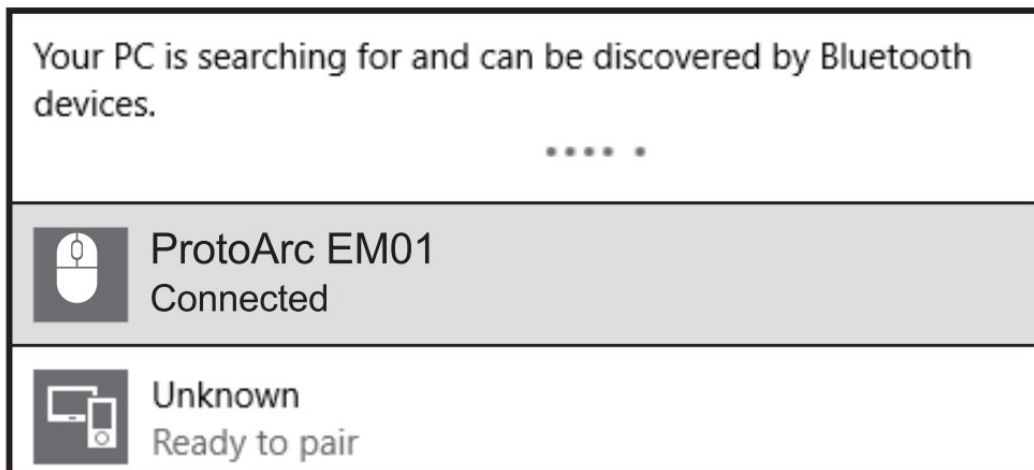

Mac OS System

Please complete the Bluetooth mode installation step 123 before pairing.

4. Click "System Preferences" on Mac



5. Click "Bluetooth" in "System Preferences"



6. Your computer will automatically find “ProtoArc EMO1”, then click “pair”, and you can use it after installation.



iOS System

Only the system above iOS 13 supports the mouse function.

Please complete the Bluetooth mode installation step 123 before pairing.

4. Click Settings on your device, then turn on Accessibility

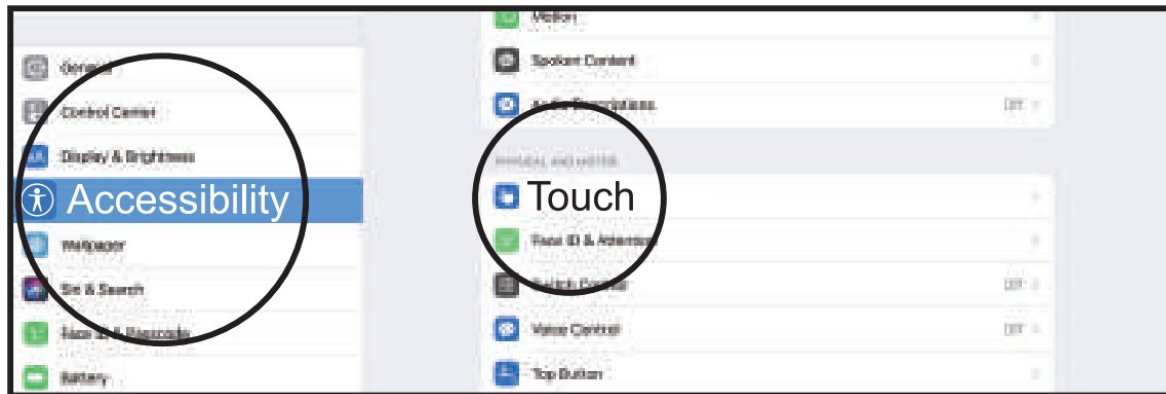

5. Click Touch

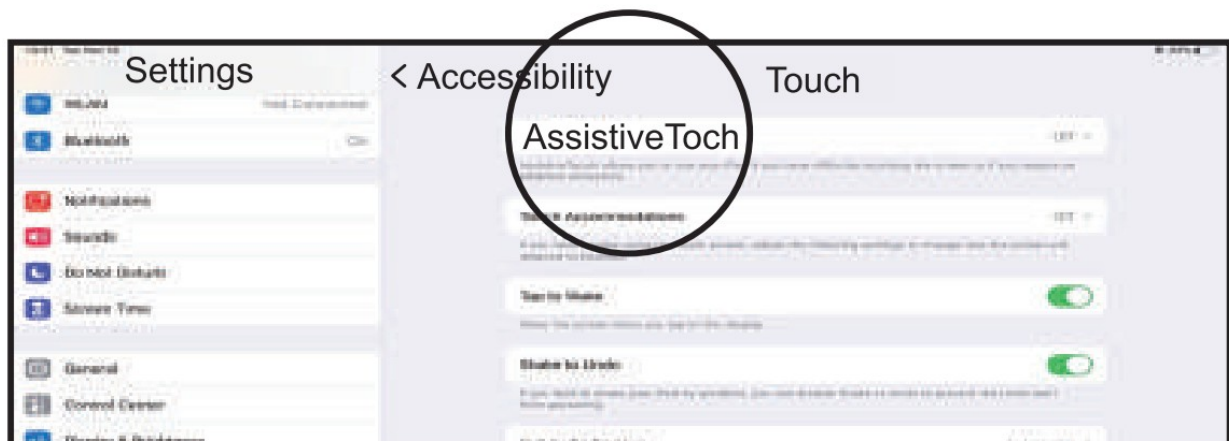

6. Turn on Assistive Touch

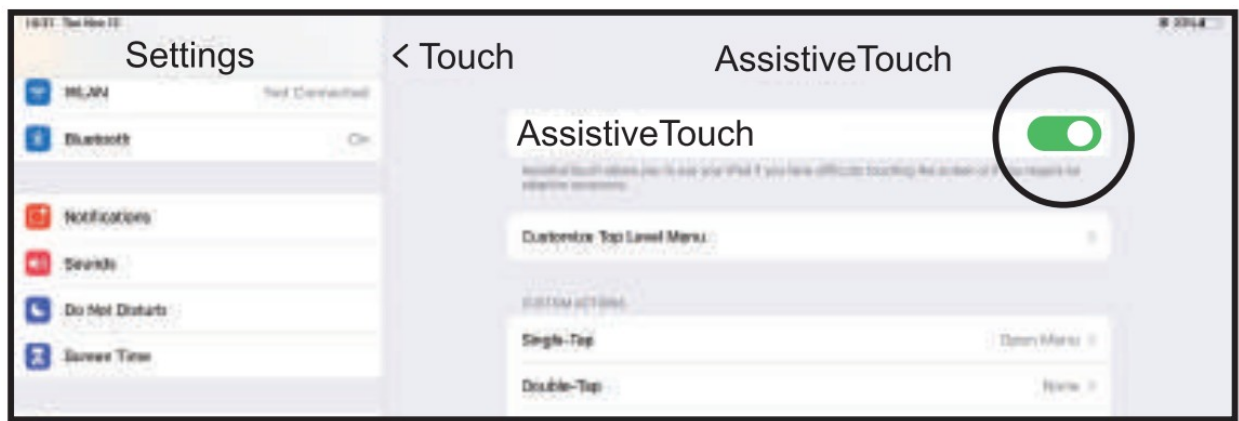

7. Click Settings on the device, then turn on Bluetooth



8. Your computer will automatically find "ProtoArc EM01", then click "Pair", complete pairing.

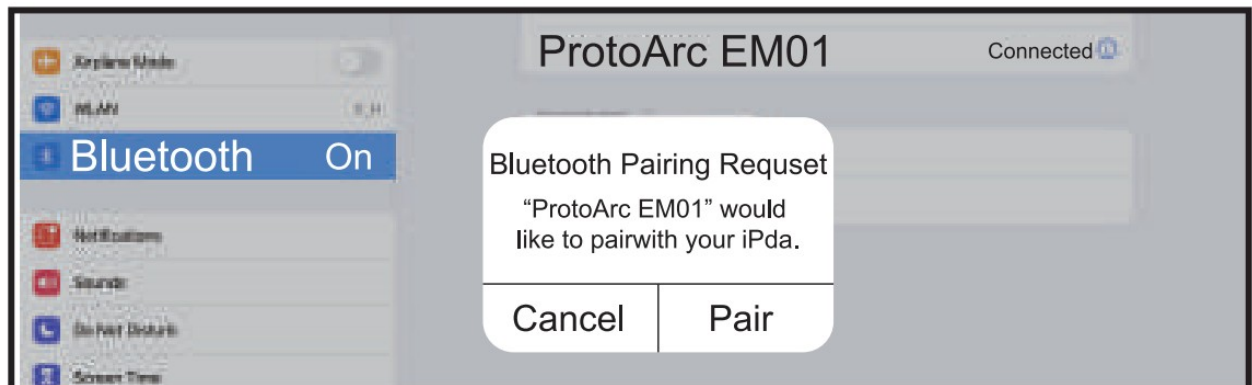

9. "ProtoArc EM01" is connected and can be used normally



Android system

Please complete the Bluetooth made installation step 123 before pairing.

4. Click Settings on the device, then turn on Bluetooth

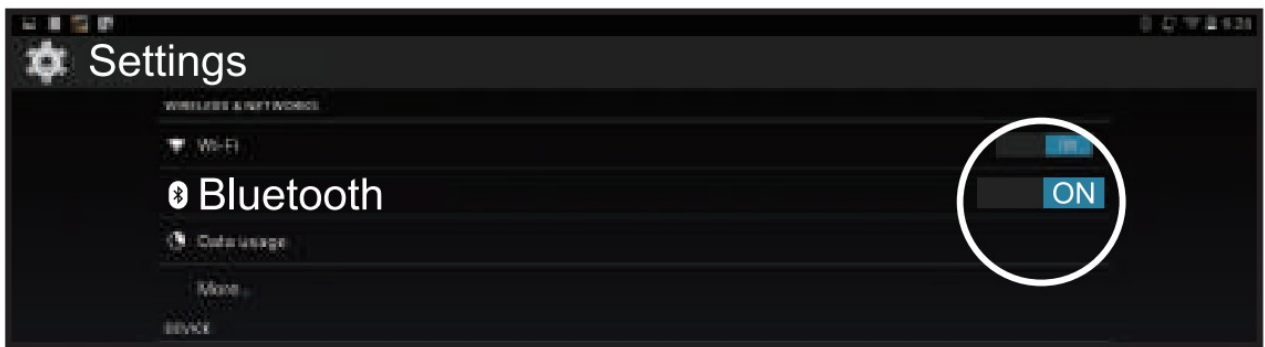

5. Your computer will automatically find “ProtoArc EM01”, then click “pair”, complete pairing.

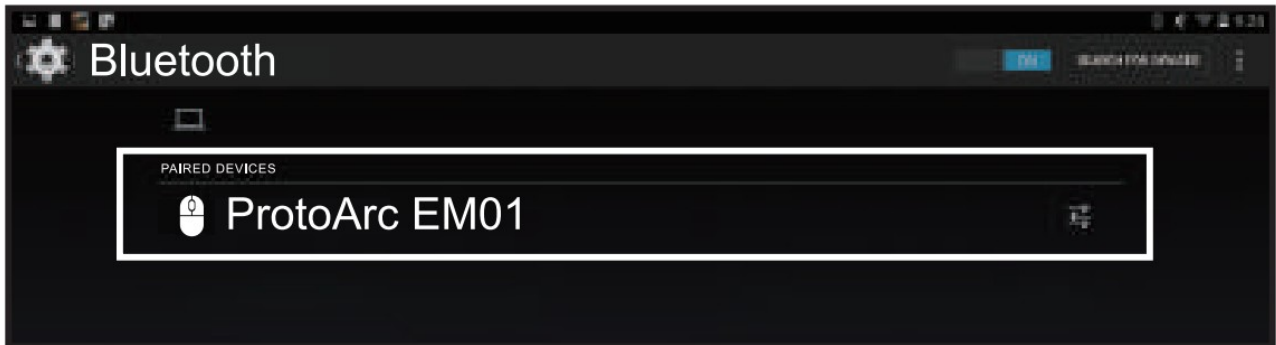

6. “ProtoArc EM01” is connected and can be used normally.

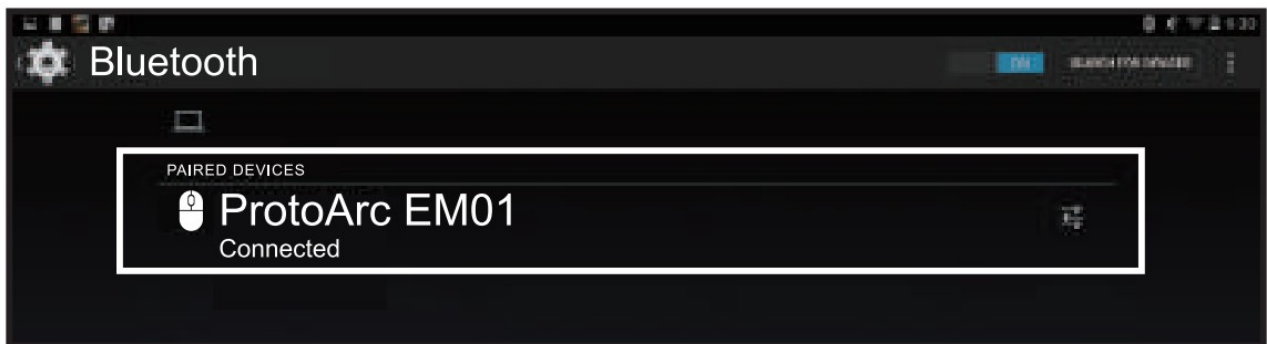

Charging Function Guide

When the power is insufficient, the charging indicator and the corresponding channel indicator flash until it is turned off. Please connect the power supply for charging in time, and use the USB cable to connect the TYPE-C charging Port.

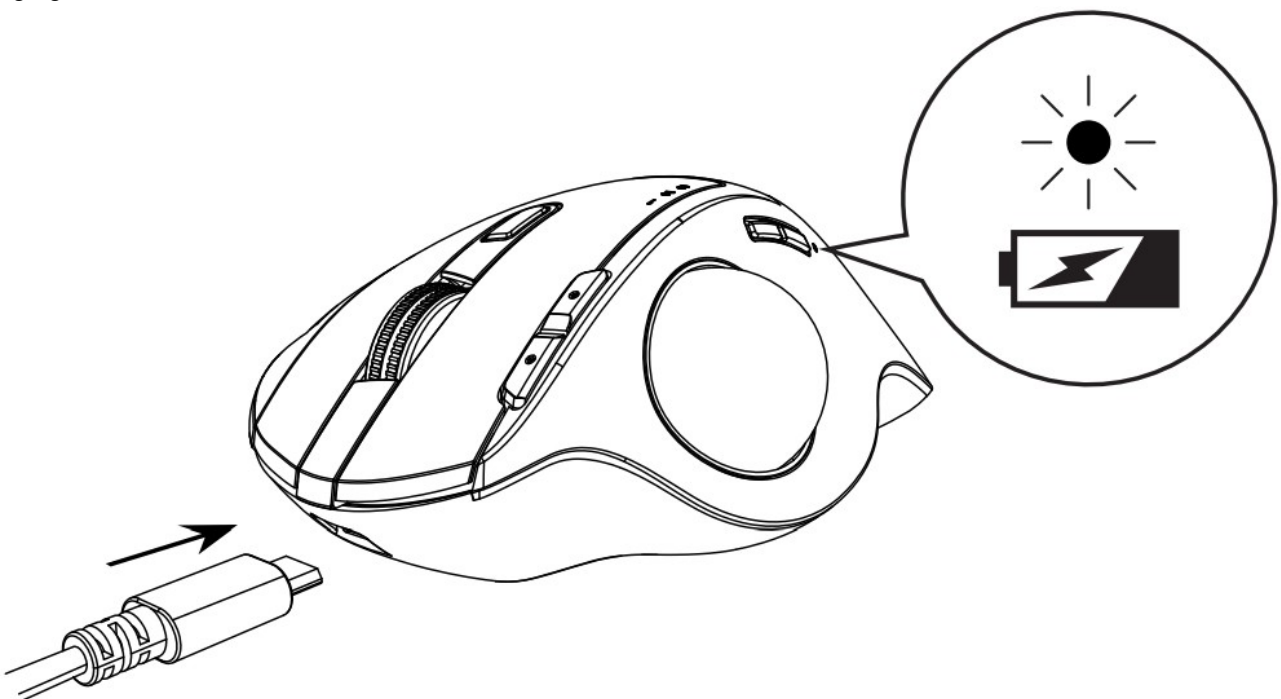

Connect the charging cable to the USB port of the computer, the charging indicator is always on during charging, the charging time is about 1-3.5 hours and the indicator light turns off when charging is complete.

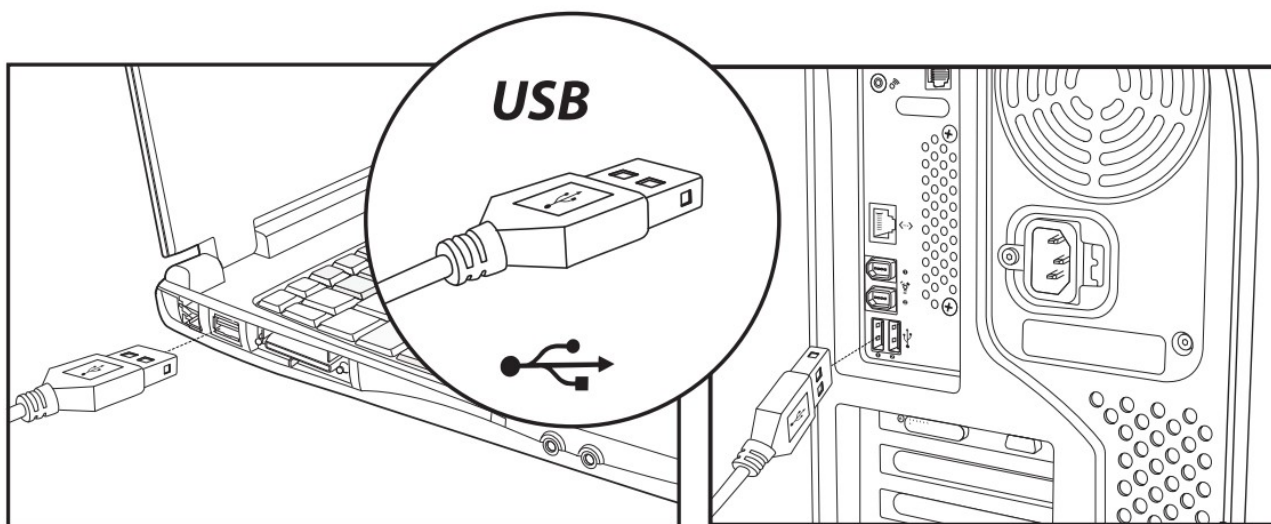

How to switch connection mode

After BT1, BT2 and 2.4G USB mode is connected, press the mode switch button on the top of the mouse to switch between multiple devices.

Wireless 1 Device Connection

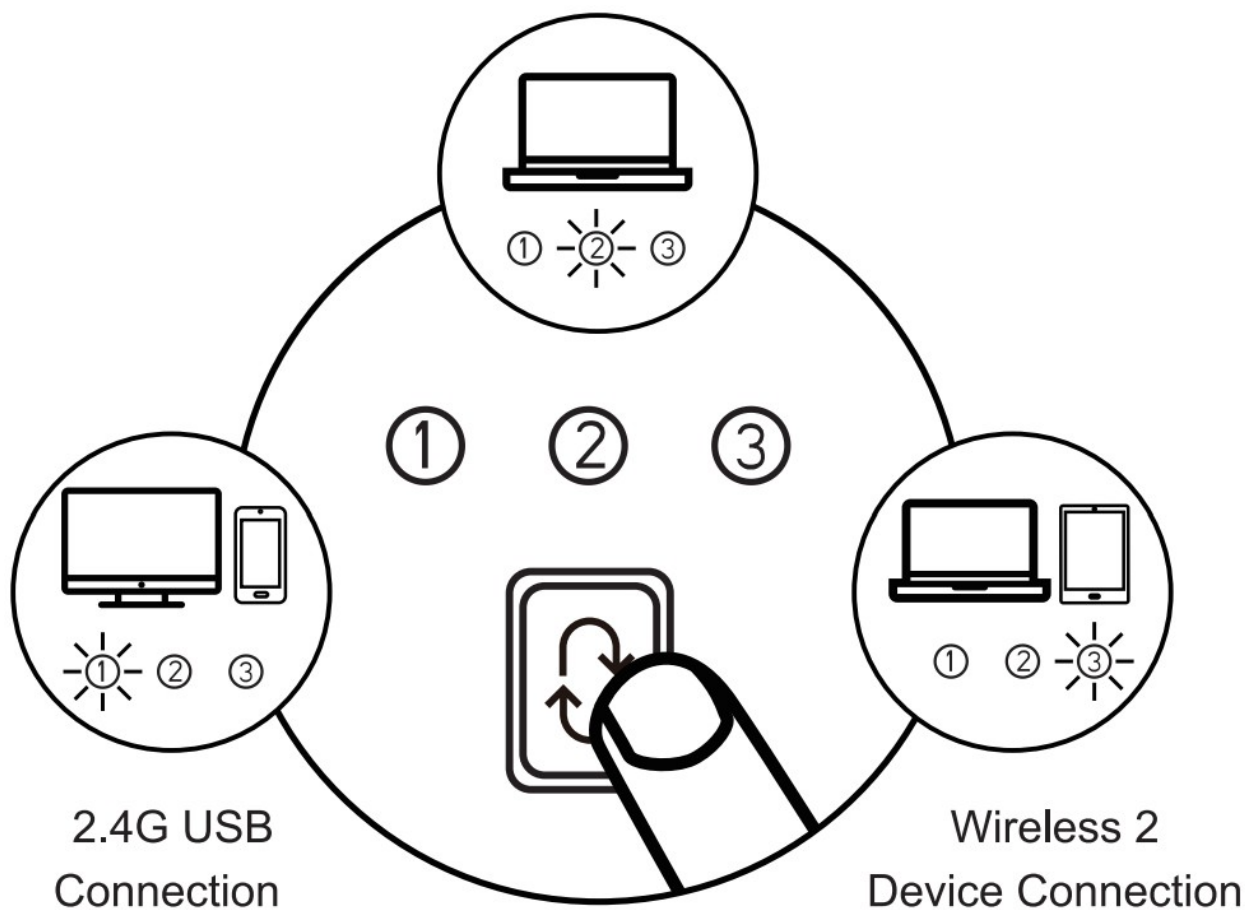

Date parameters

Basic parameter:

Chip: Nordic NRF51802W

Movement Detection Technology: Optical

Lithium battery Capacity: 900mA

DPI: 1000- 1600-2400

Click life: 3 million+
Dimension: 133*101*51mm
Weight: 190g
Bluetooth transmission parameters:
Transmission distance: 10m
Working Voltage: 3.7V
Working current: 4mA
Reaction rate: 125Hz
System requirement:
Bluetooth-enable device
Windows 8, Windows 10 or higher version
Mac OS x 10.10 or higher version
Android 4.3 or higher version
2.4G transmission parameters:
Transmission distance: 20m
Working Voltage: 3.7V
Working current: 5.5mA
Reaction rate: 250Hz
System requirement:
An available USB port
Windows XP, Windows 7, Windows 8, Windows 10 or higher version

What’s in Package

- Mac OS x 10.10 or higher version
- ▶ 1x Wireless Mouse
 - ▶ 1x USB Receiver
 - ▶ 1x Type C Charging Cable
 - ▶ 1x User Manual



Documents / Resources

<p>The thumbnail image shows the cover of the user manual for the ProtoArc EM01. It features the ProtoArc logo at the top left, the model number "EM01" at the top right, and the title "User Manual" in the center. Below the title, it specifies "2.4G Wireless Bluetooth Rechargeable RGB Trackball Mouse". At the bottom, the email "support@protoarc.com" and the website "www.protoarc.com" are listed.</p>	<p>ProtoArc EM01 Wireless Bluetooth Trackball Mouse [pdf] User Manual</p> <p>EM01, EM01 Wireless Bluetooth Trackball Mouse, Wireless Bluetooth Trackball Mouse, Bluetooth Trackball Mouse, Trackball Mouse, Mouse</p>
---	---

References

- [User Manual](#)

