



# ProtoArc EM01 2.4G Pluse Bluetooth Recchargeable RGB Trackball Mouse User Manual

[Home](#) » [ProtoArc](#) » ProtoArc EM01 2.4G Pluse Bluetooth Recchargeable RGB Trackball Mouse User Manual 

## Contents

- [1 ProtoArc EM01 2.4G Pluse Bluetooth Recchargeable RGB Trackball Mouse](#)
- [2 Product Features](#)
  - [2.1 Adjustable Mouse Grip Angle](#)
  - [2.2 2.4G USB Connection](#)
- [3 Bluetooth Connection](#)
  - [3.1 Windows 10 OS](#)
  - [3.2 Mac OS](#)
  - [3.3 iOS](#)
  - [3.4 Android OS](#)
  - [3.5 Charging Guide](#)
  - [3.6 How To Switch Devices](#)
- [4 Specifications](#)
  - [4.1 What's in Package](#)
- [5 Documents / Resources](#)
- [6 Related Posts](#)



**ProtoArc EM01 2.4G Pluse Bluetooth Recchargeable RGB Trackball Mouse**



## Product Features

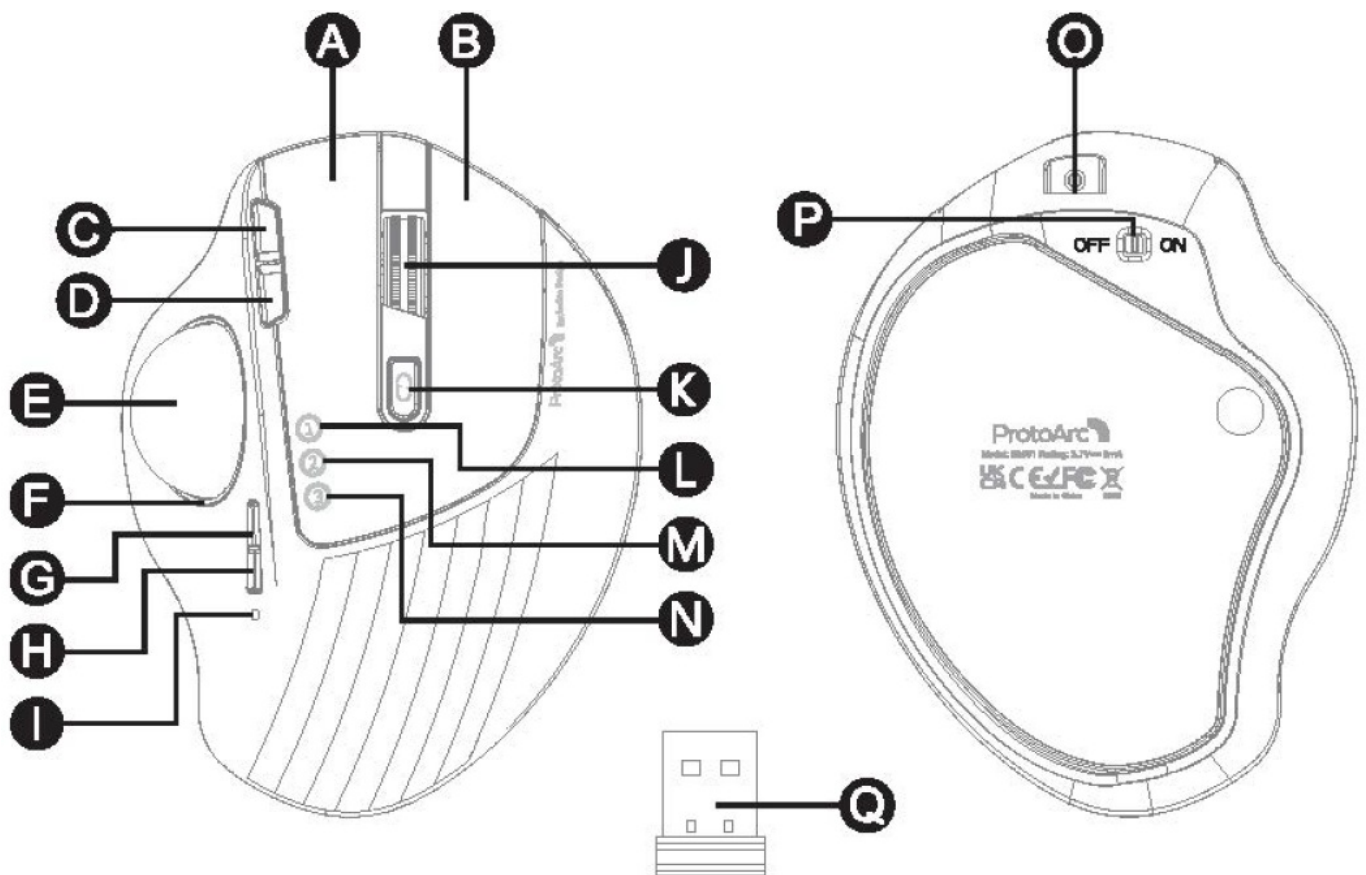

- A. Left Button
- B. Right Button

- C. Forward Button
- D. Backward Button
- E. Trackball
- F. RGB Rim Light
- G. Light Switch Button DPI
- H. DPI Button
- I. Charging/ DPI Indicator
- J. Scroll Wheel
- K. Switch Device Button
- L. Channel Indicator 1
- M. Channel Indicator 2
- N. Channel Indicator3
- O. Type-C Charging Port
- P. Power Switch
- Q. USB Receiver

**Light Switch Button:** Short press to switch light modes, long press for three seconds to turn off the light.

**Light Mode:**

1. Streamer mode (Default)
2. Breathing mode
3. Mixed color breathing mode
4. Neon mode

**Adjustable Mouse Grip Angle**

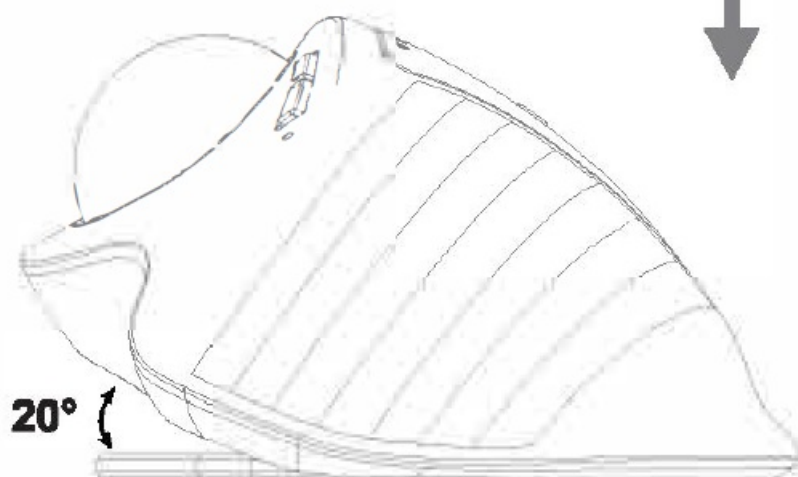
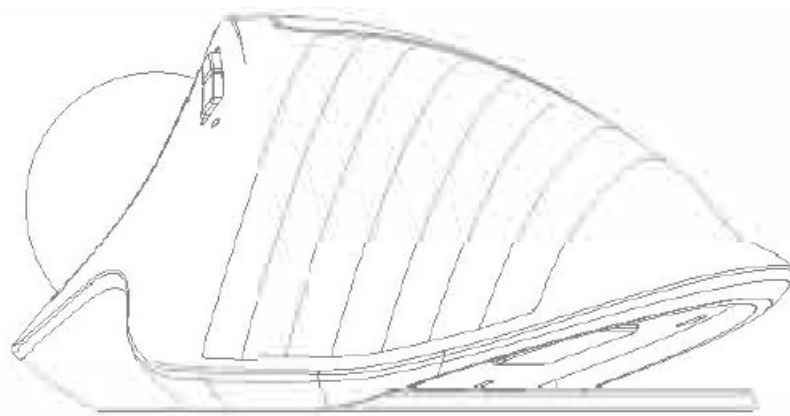

#### 2.4G USB Connection

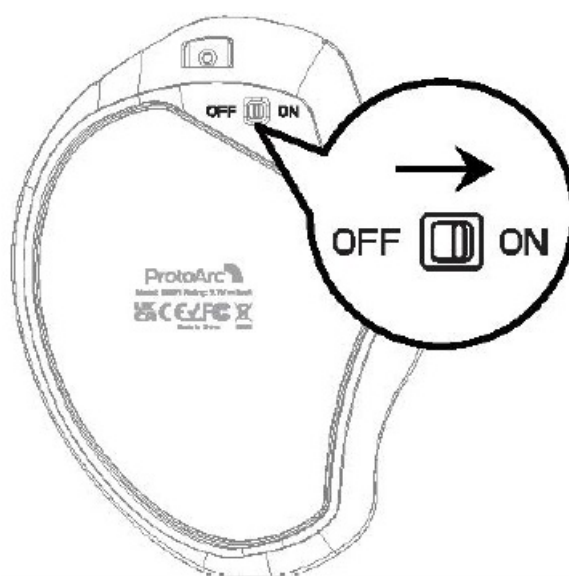

1. Turn on the power switch to ON.

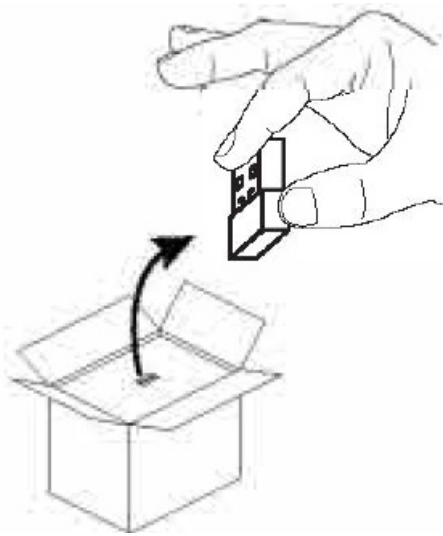

2. Get the USB receiver ready

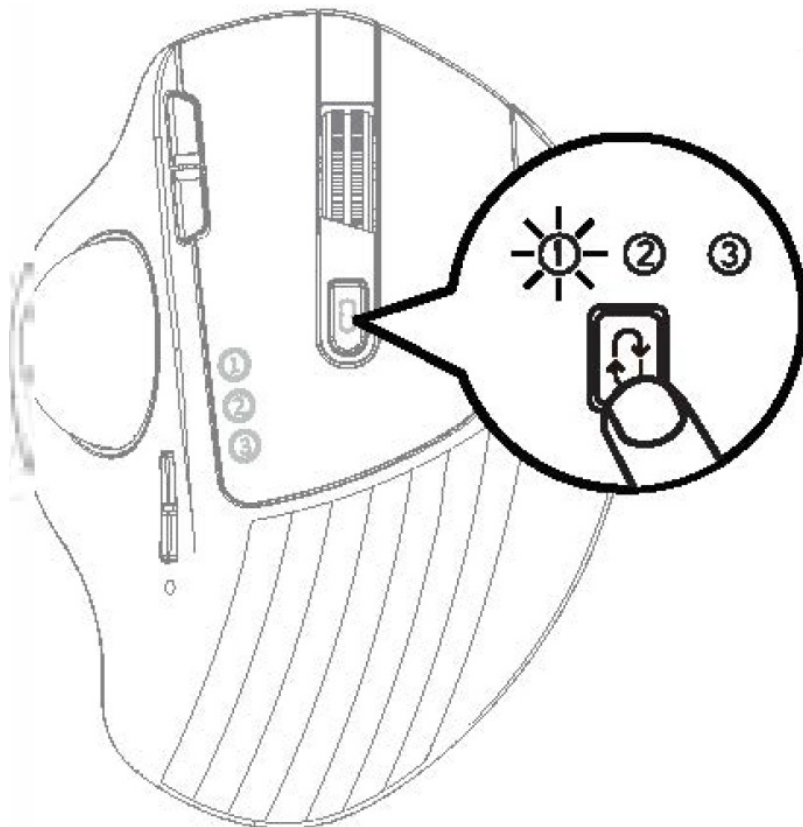

3. Press and hold the switch device button until the white indicator light Dis on to enter 2.4G mode.

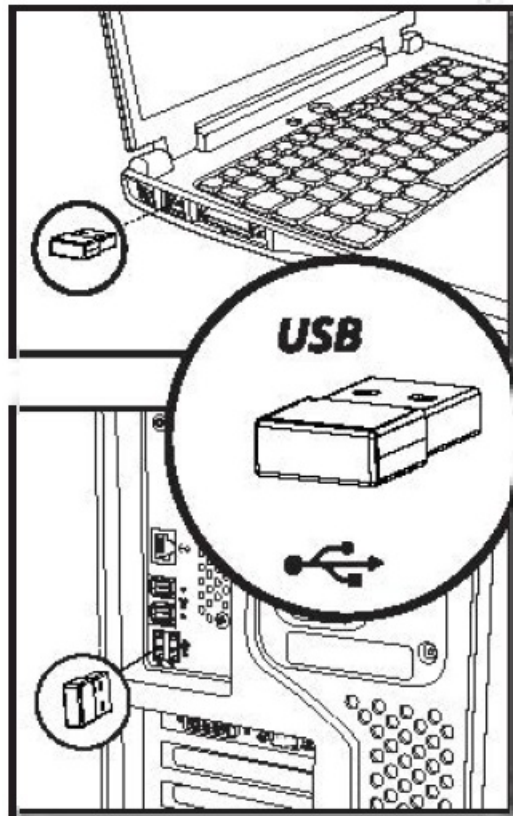

4. Insert the USB receiver into your computer's USB port.

## Bluetooth Connection

1. Turn the power switch ON.

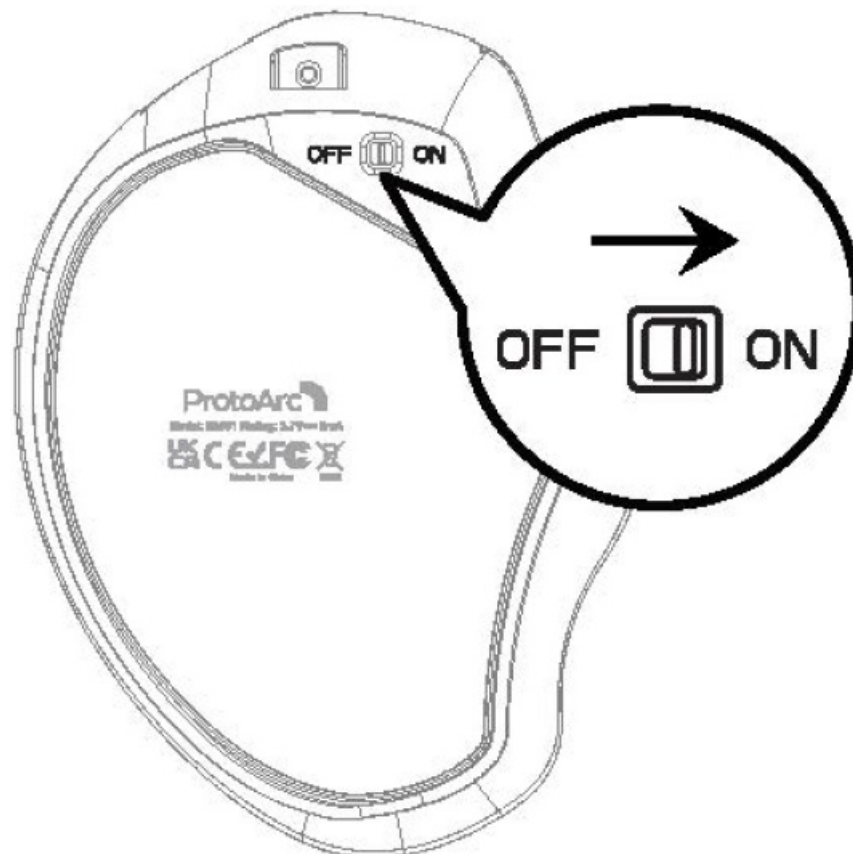

2. Press the switch device button to switch to channel2 or 3, the corresponding white indicator light will flash slowly.

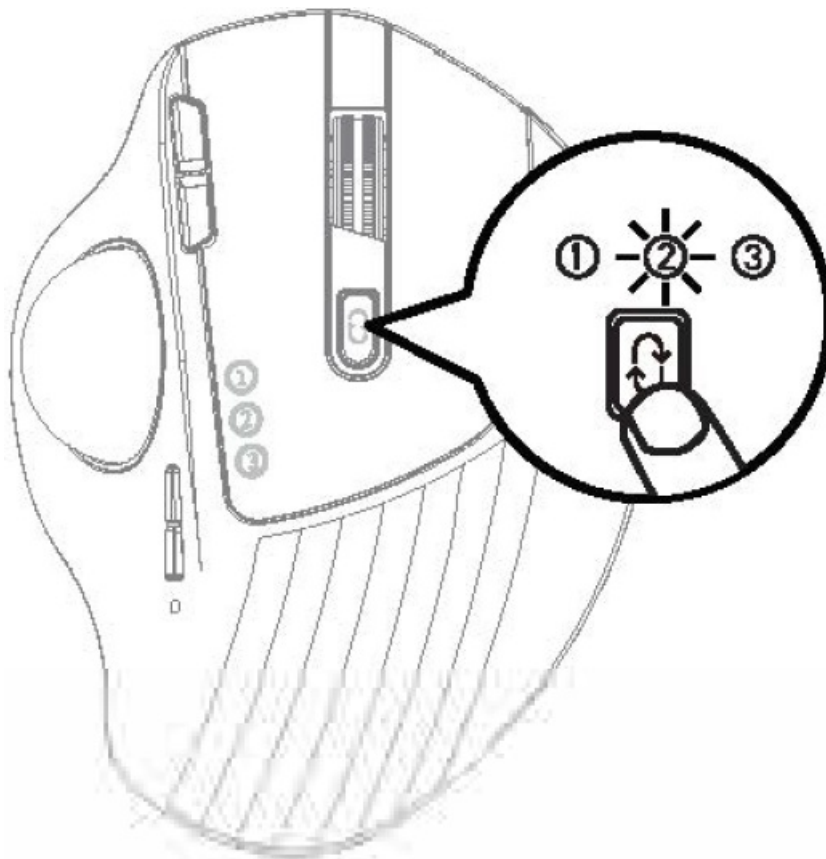

3. Press and hold the switch device button for 3-5 seconds until the white indicator light flashes quickly, then the mouse enters the Bluetooth pairing mode.

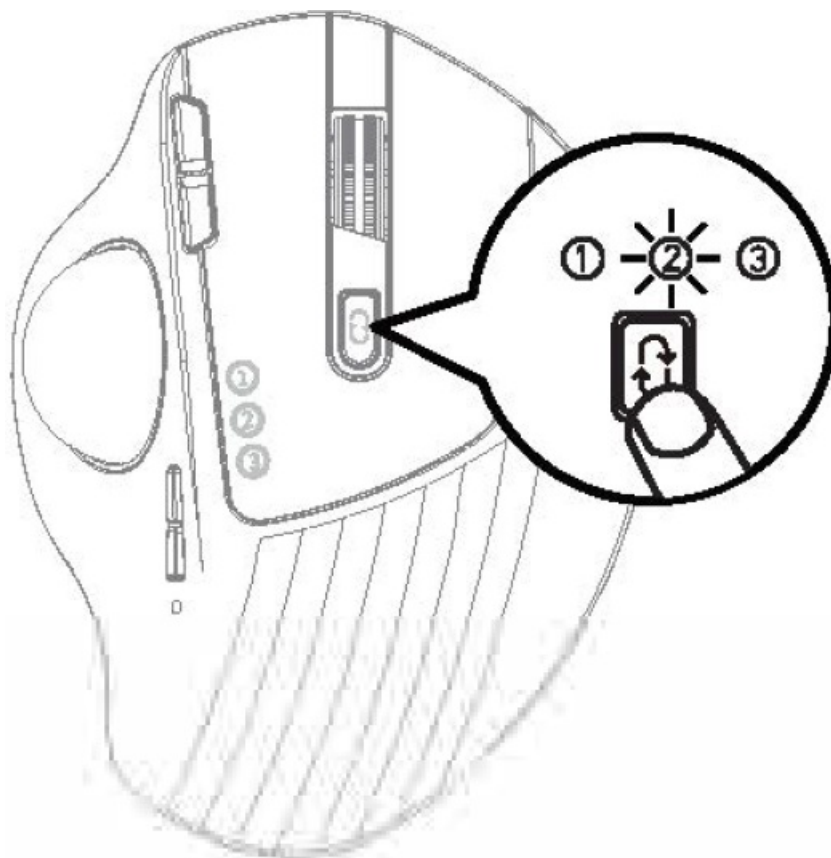

**Windows 10 OS**

Click "Bluetooth device"



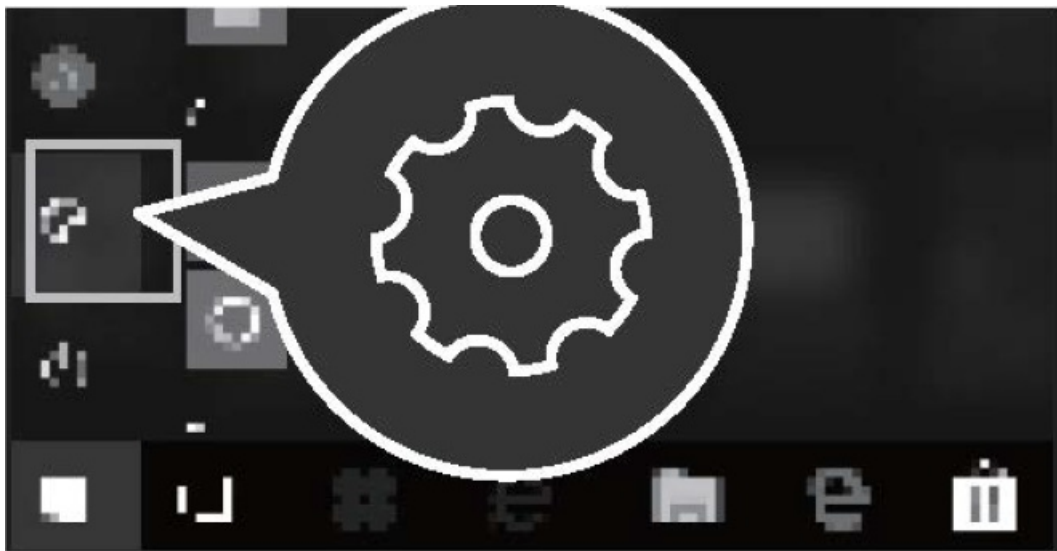

Click "Add or remove a Bluetooth device"

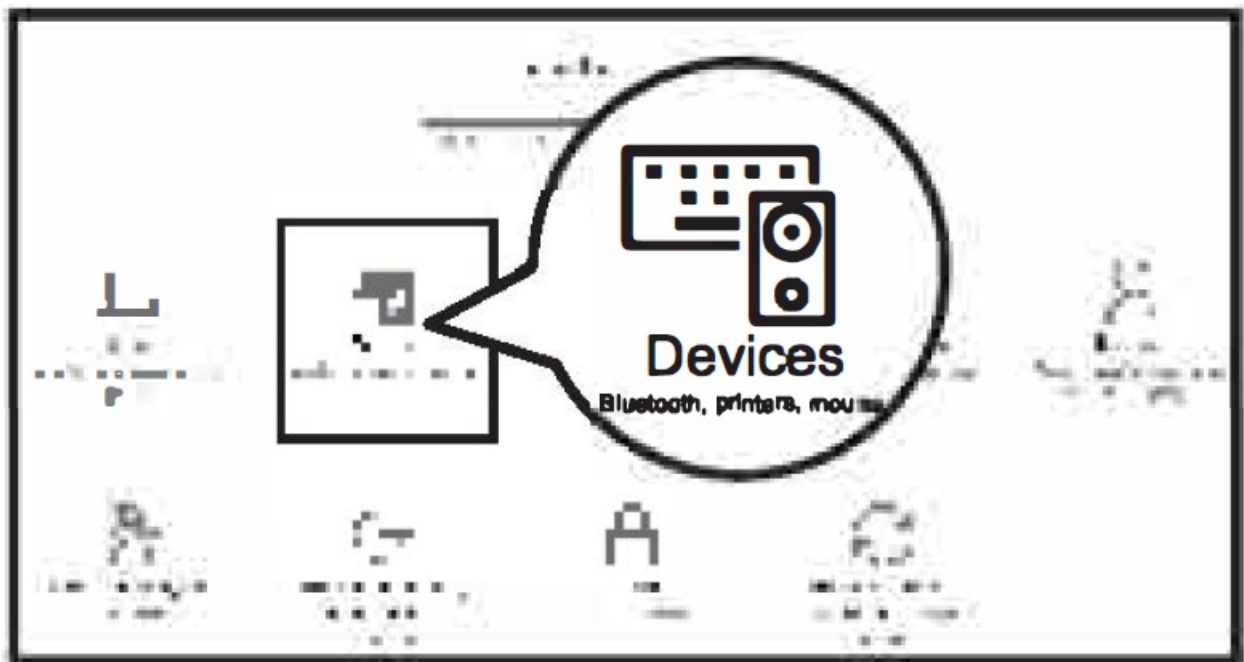

Your computer will automatically search for "ProtoArc EM01" when this appears in the list, click "pair"

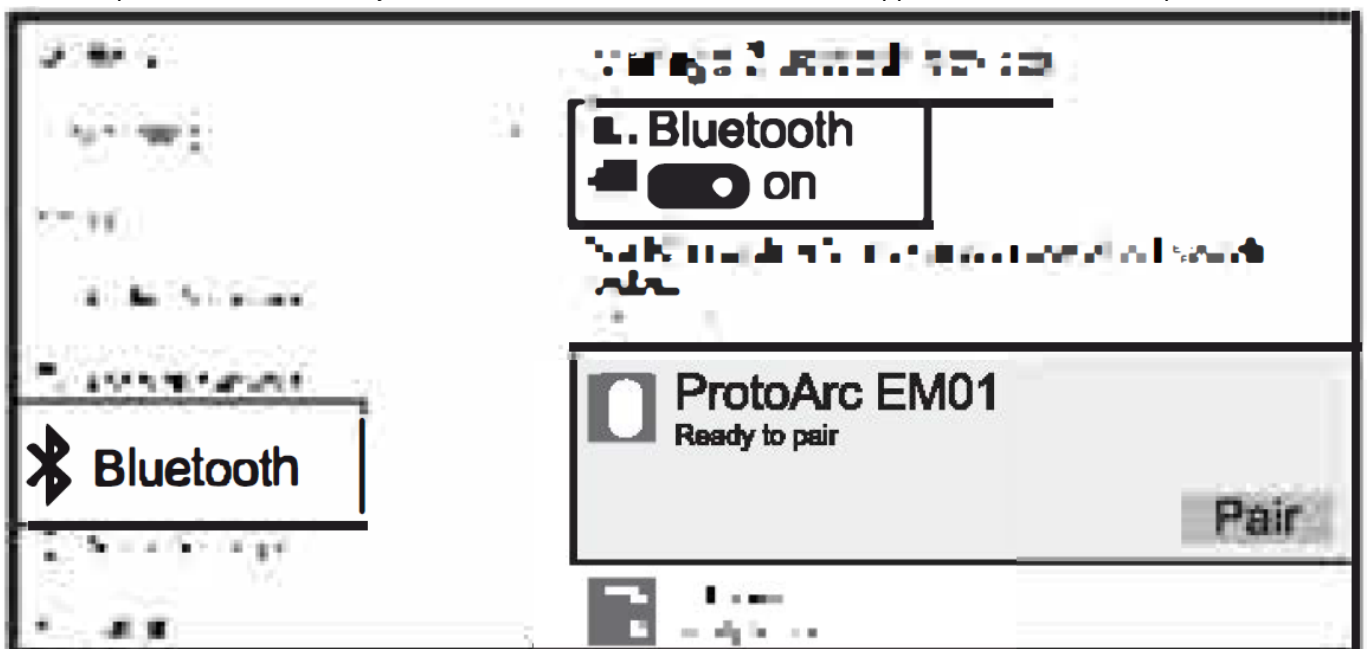

"ProtoArc EM01" is now connected and ready to go



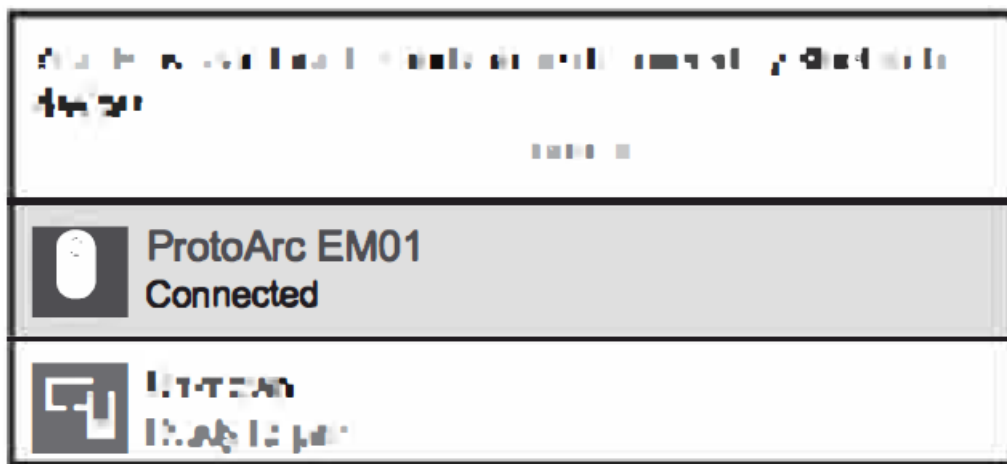

## Mac OS

**Note:** Please complete step 1, 2 and 3 in 'Bluetooth Connection' before pairing.

Click "System Preferences" on Mac



Click "Bluetooth" in "System Preferences"



Wait for your Mac to find and shows "ProtoArc EM01" in the list, then click "pair" to connect the mouse.

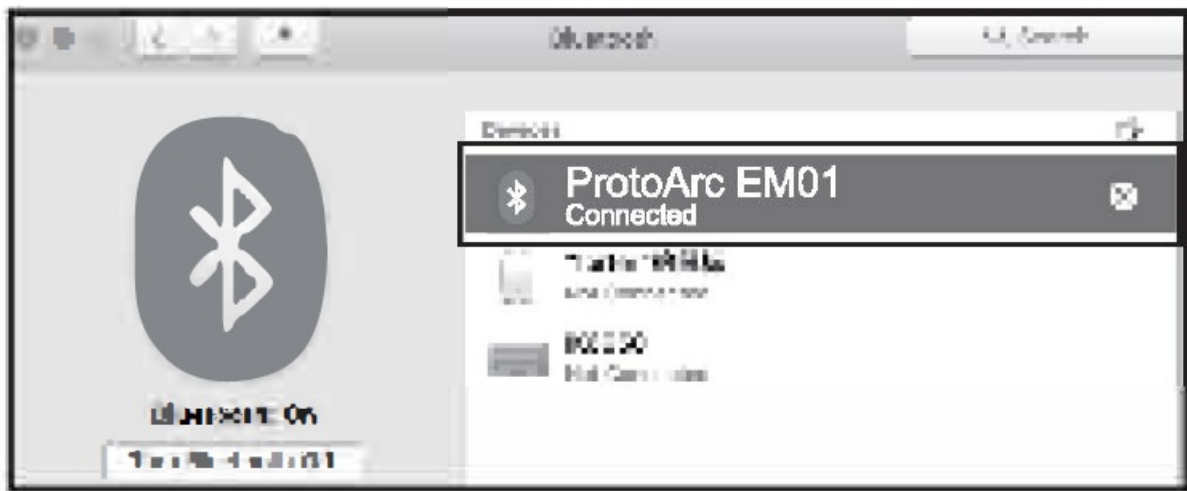

iOS

**Note:** Requires iOS 13 or higher to support mouse function. Please complete step 1, 2 and 3 in 'Bluetooth Connection' before pairing.

Click Settings on your device, then turn on Accessibility



Click touch



Turn on Assistive Touch

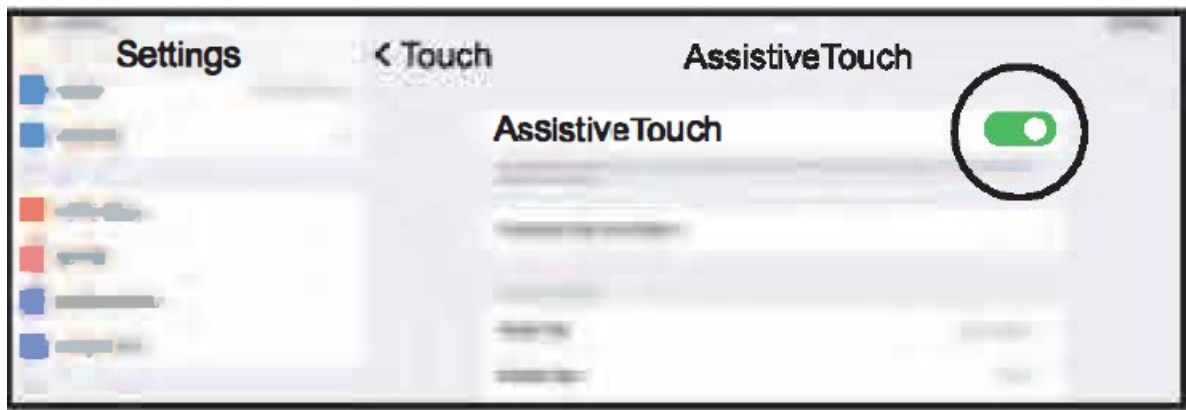

Click Settings on the device, and turn on Bluetooth



Wait for your device to find and shows "ProtoArc EM01" in the list, then click "pair" to connect the mouse.



"ProtoArc EM01" is now connected.

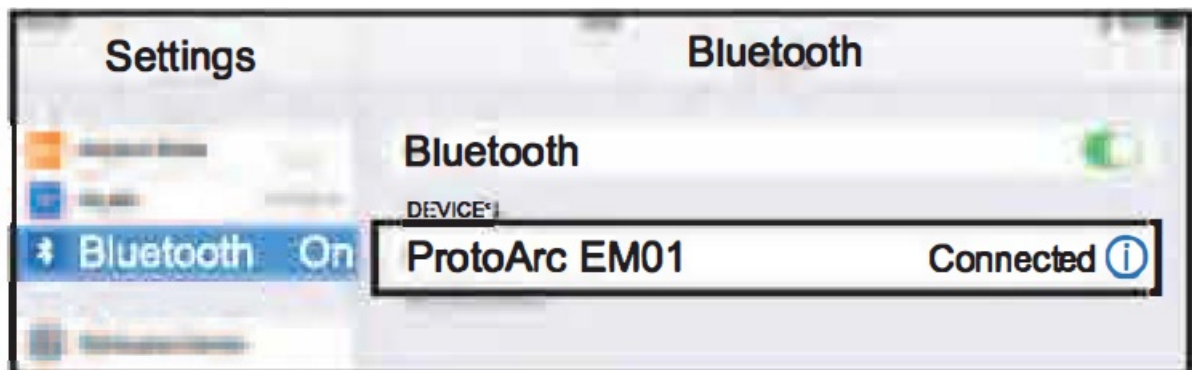

## Android OS

Please complete step 1, 2 and 3 in 'Bluetooth Connection' before pairing.

1. Click Settings on the device, then turn on Bluetooth.

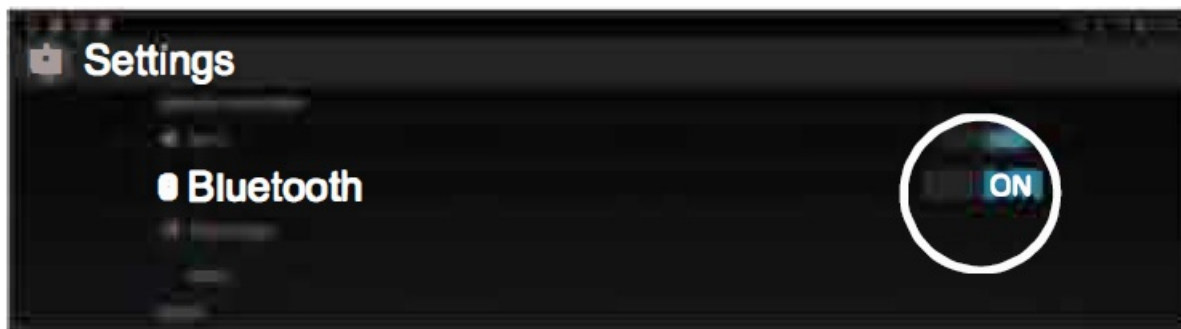

2. Your computer will automatically search for "ProtoArc EM01" when this appears in the list, click "pair"



3. "ProtoArc EM01" is now connected



### Charging Guide

When the battery is low, the indicator light and the corresponding channel light will start to flash until the mouse is turned off. Please connect the power supply as soon as possible to ensure best user experience.

**Note:** Low battery may cause poor connection quality.

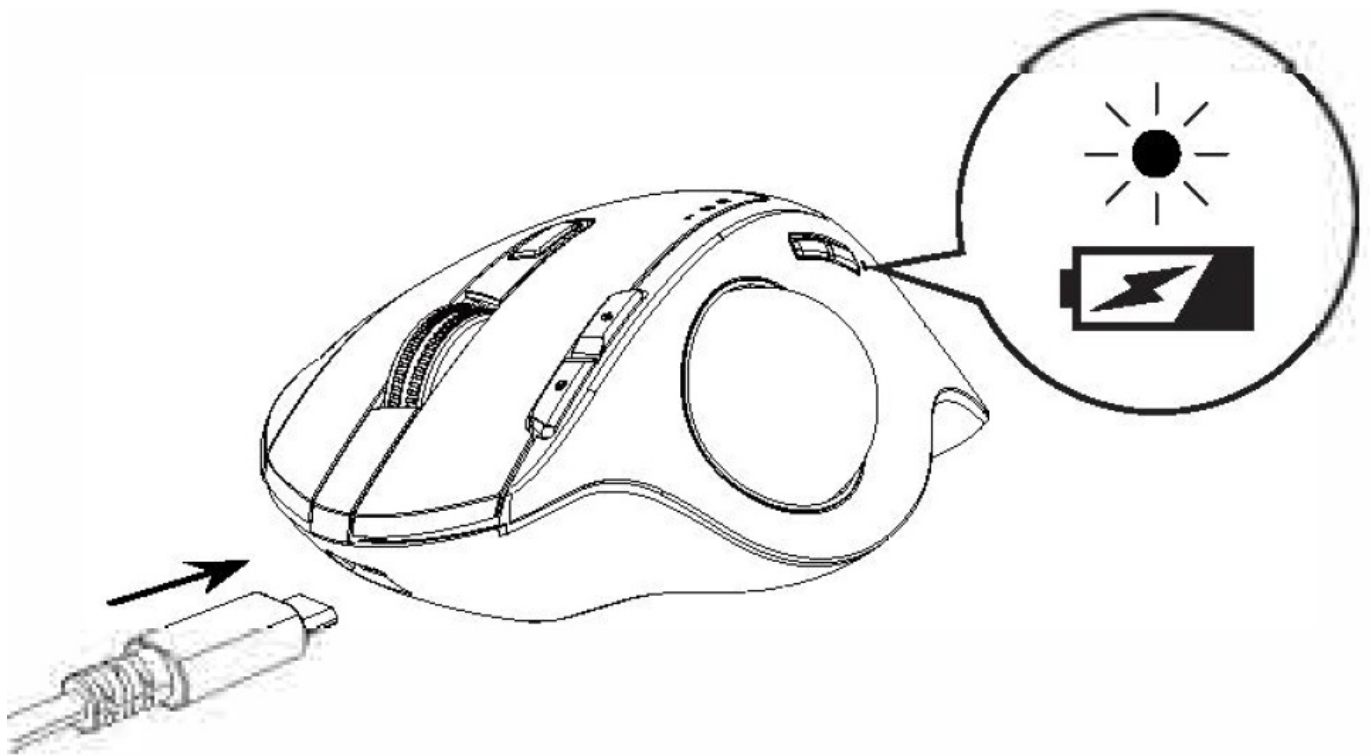

Connect the Type-C Side to the mouse and the USB-A side to the computer. The charging indicator light is always on while charging. a full charge cycle takes about 1 to 3.5 hours and the indicator light will automatically shuts off when charging is complete.

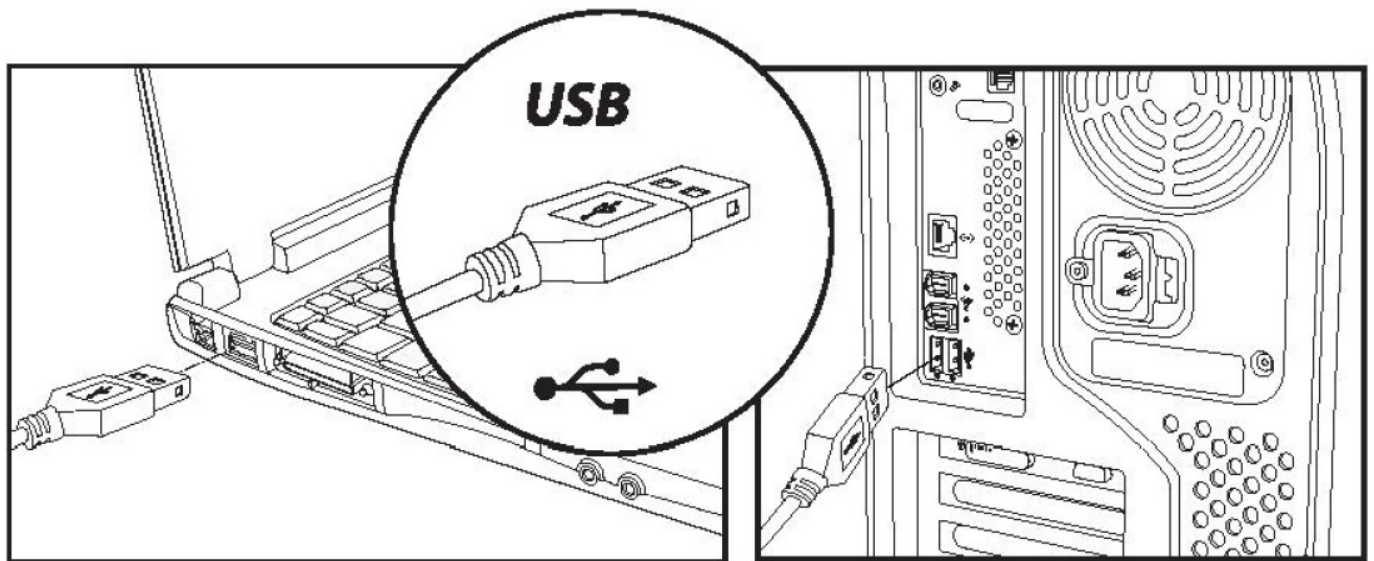

#### How To Switch Devices

After BT1, BT2 and 2.4G USB mode are connected, short press the switch device button on the top of the mouse to switch between multiple devices.



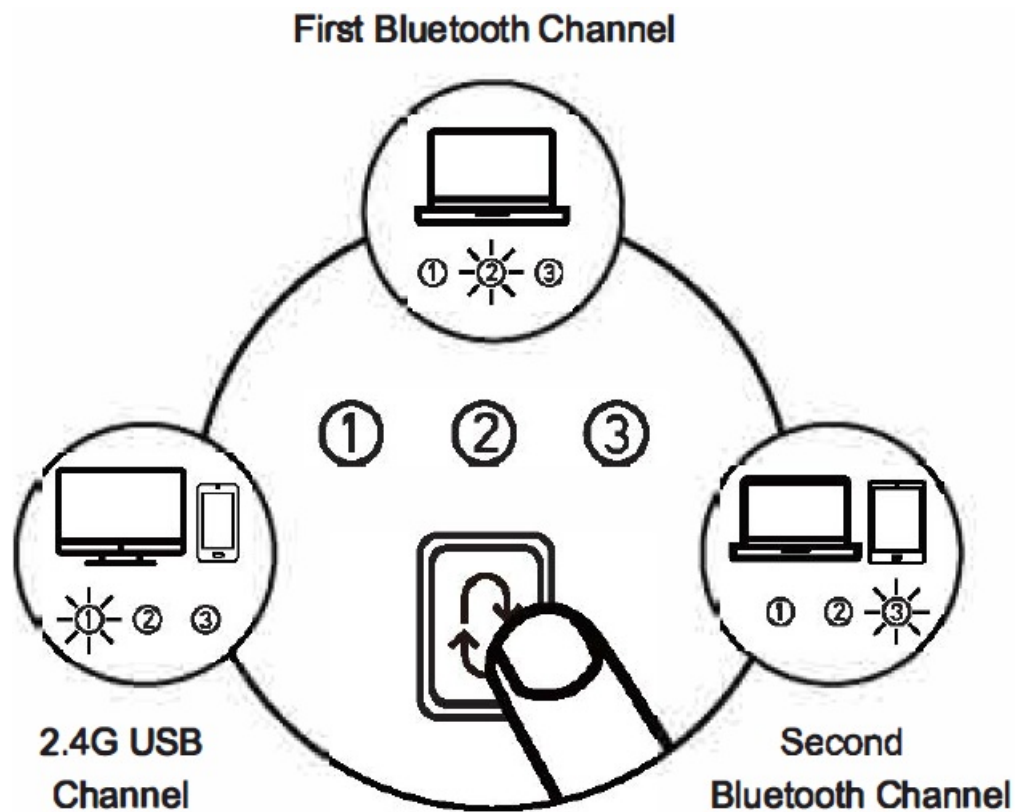

The indicator light will flash every 3 seconds to indicate the currently connected channel.

## Specifications

### Basic parameters:

- Chip: Nordic NRF51802W
- Movement Detection Technology: Optical
- Lithium battery Capacity: 900mA
- DPI: 1000-1600-2400
- Click life: 3 million+ Dimension: 133 x 101 x 51mm / 5.2" x 3.9" x 2.0"
- Weight: 190g/6.7oz

### Bluetooth transmission parameters:

- Transmission distance: 10m / 32.8ft
- Working Voltage: 3.7V
- Working current: 4mA
- Reaction rate: 125Hz

### System requirement:

- Bluetooth-enable device
- Windows 8, Windows 10 or higher version
- Mac OS x 10.10 or higher version
- Android 4.3 or higher version

## 2.4G transmission parameters:

- Transmission distance: 20m /65.6ft
- Working Voltage: 3.7V
- Working current: 5.5mA
- Reaction rate: 250Hz

## System requirement:

An available USB port

Windows XP, Windows 7, Windows 8, Windows 10 or higher version Mac OS x 10.10 or higher version

## What's in Package

- 1x Wireless Mouse
- 1xUSB Receiver
- 1x Type C Charging Cable
- 1x User Manual

## Documents / Resources

	<p><a href="#">ProtoArc EM01 2.4G Pluse Bluetooth Recgargeable RGB Trackball Mouse</a> [pdf] User Manual</p> <p>EM01 2.4G Pluse Bluetooth Recgargeable RGB Trackball Mouse, EM01, 2.4G Pluse Bluetooth Recgargeable RGB Trackball Mouse, Bluetooth Recgargeable RGB Trackball Mouse, Recgargeable RGB Trackball Mouse, RGB Trackball Mouse, Trackball Mouse, Mouse</p>
---	--