



ProtoArc EK01-NL Ergonomic Keyboard User Manual

[Home](#) » [ProtoArc](#) » ProtoArc EK01-NL Ergonomic Keyboard User Manual 

ProtoArc EK01-NL Ergonomic Keyboard



Contents

- 1 Product Features
- 2 2.4GHz Connection Steps
- 3 Bluetooth Connection Steps
- 4 How to Switch Device Channels
- 5 Keyboard Charging
- 6 Multimedia Function Button
- 7 Product Specification
- 8 Tips
- 9 Sleep Mode
- 10 What's In Package
- 11 Customer Support
- 12 Documents / Resources
 - 12.1 References
- 13 Related Posts

Product Features

Press FN and "Direction Keys" to realize PgUP PgDn Home End.
Single Press "Direction Keys" to realize direction key function.

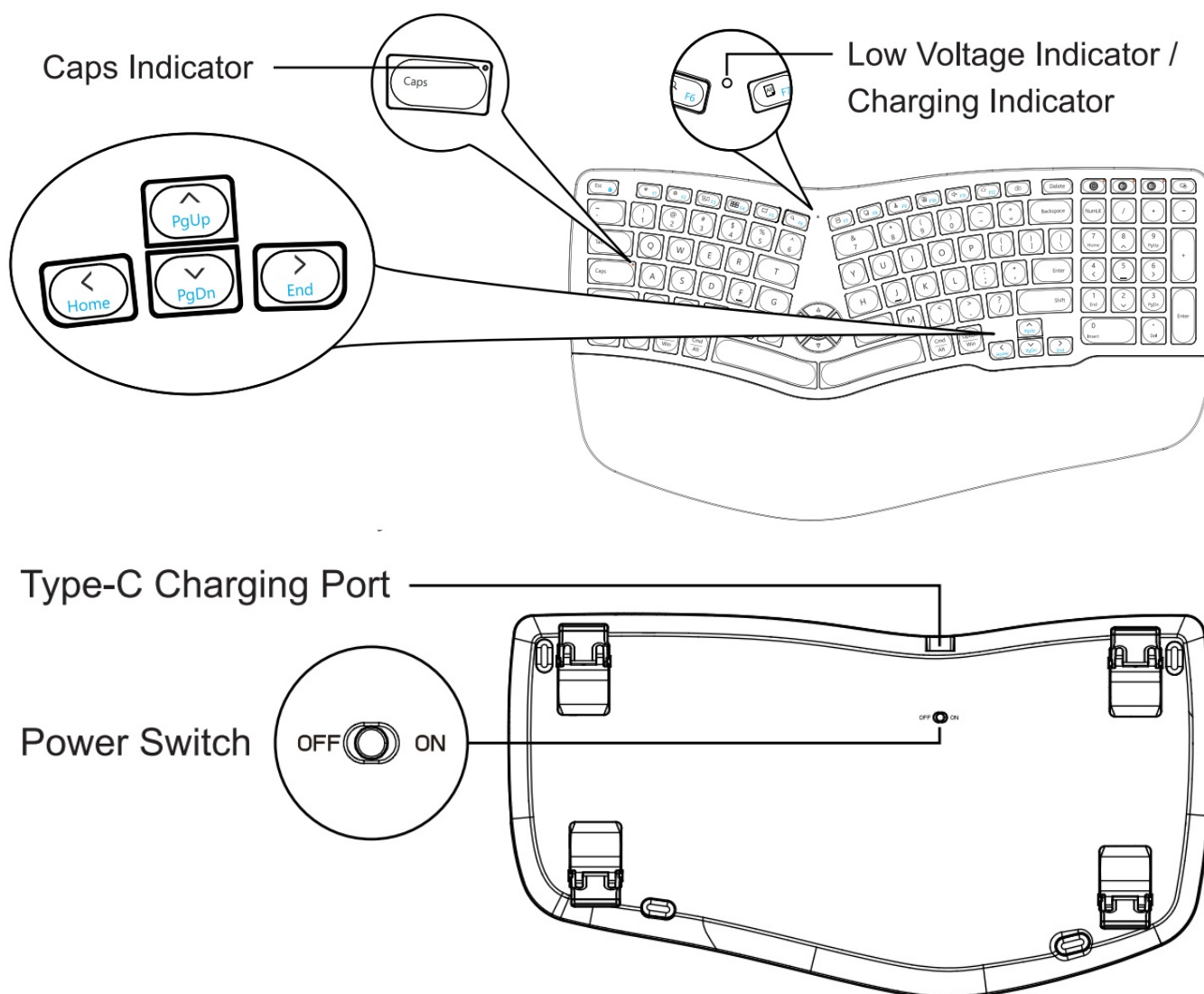

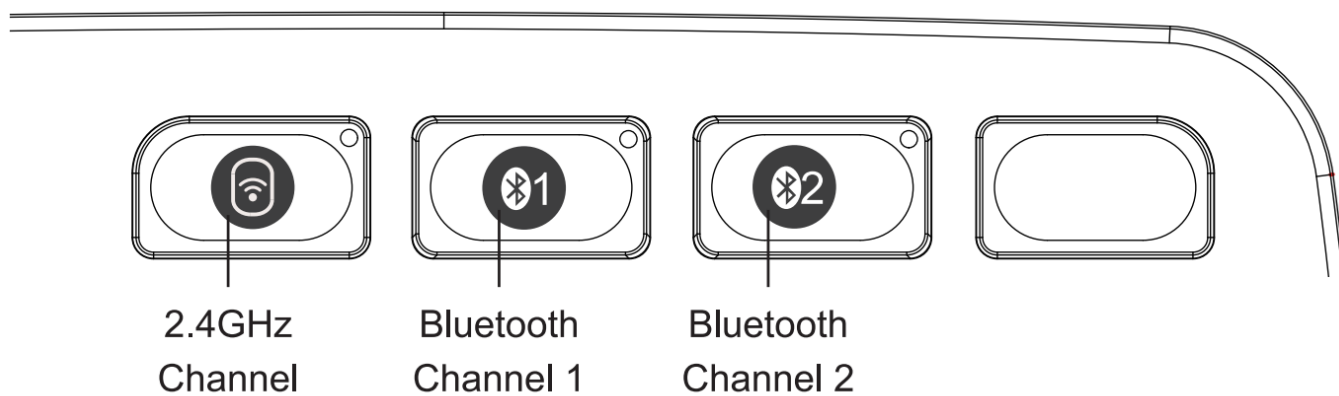

2.4GHz Connection Steps

1. Switch the keyboard power ON.

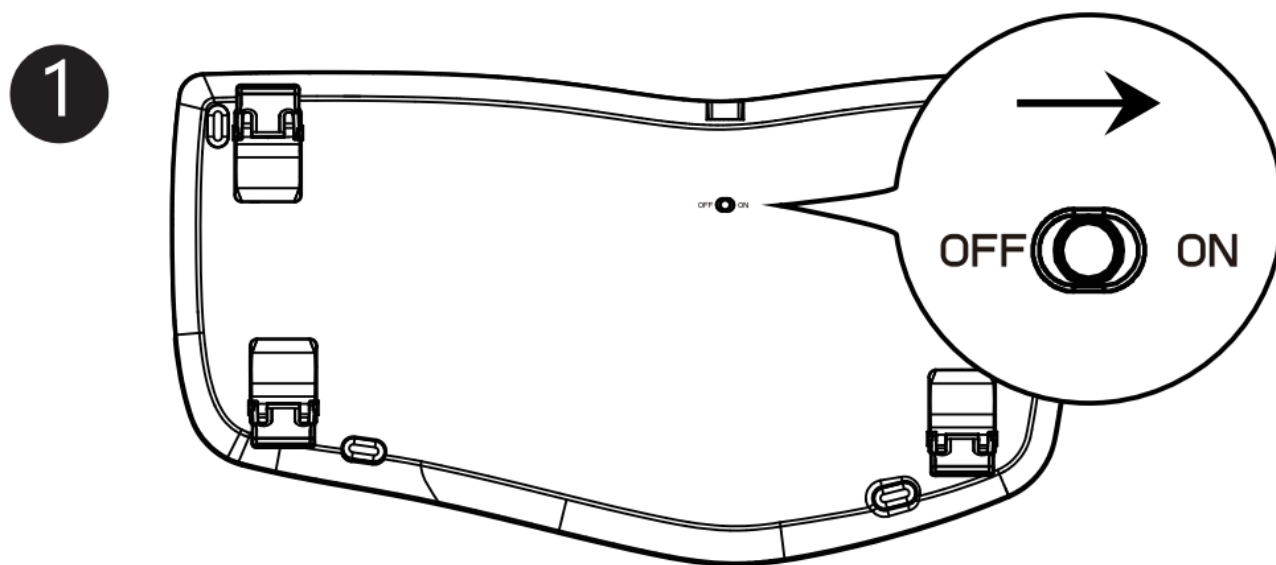

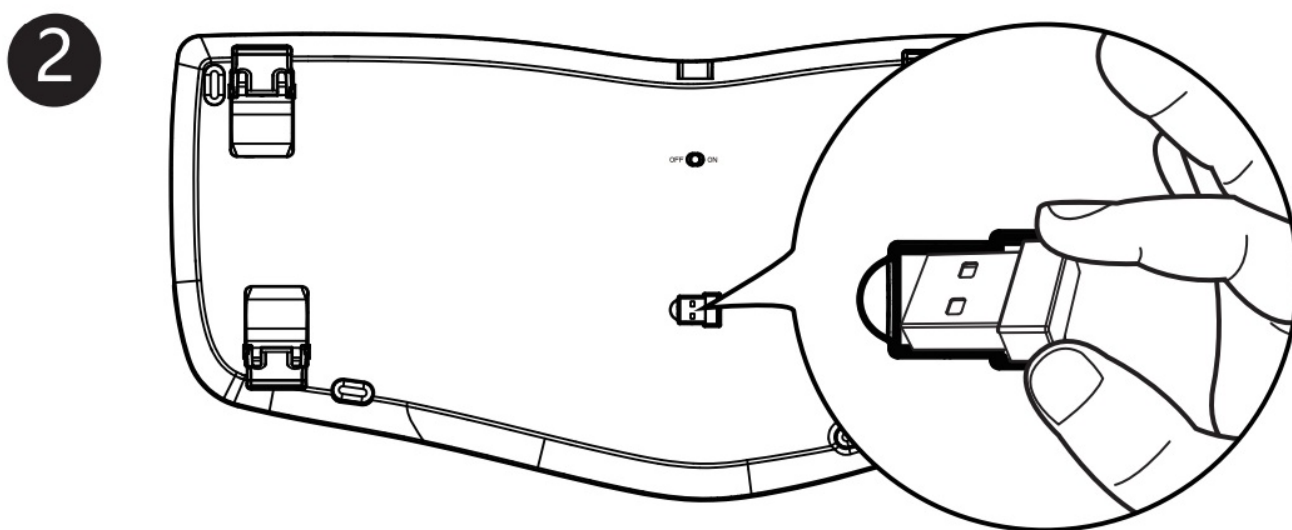

2. Take out the USB receiver.

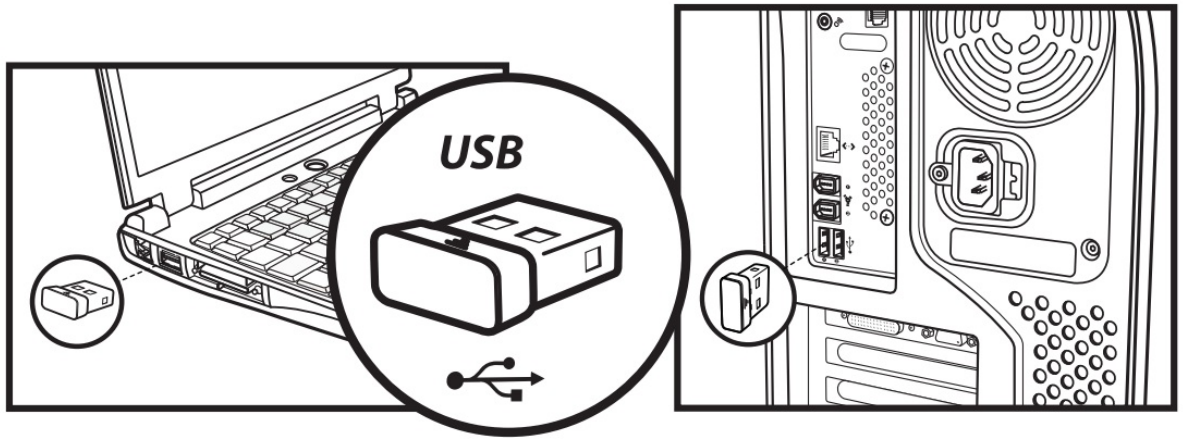

3. Plug the USB receiver into the USB port of the computer.

3



4. Press  key to switch to 2.4G channel, the white indicator will flash slowly, the keyboard now is in 2.4G mode.

4

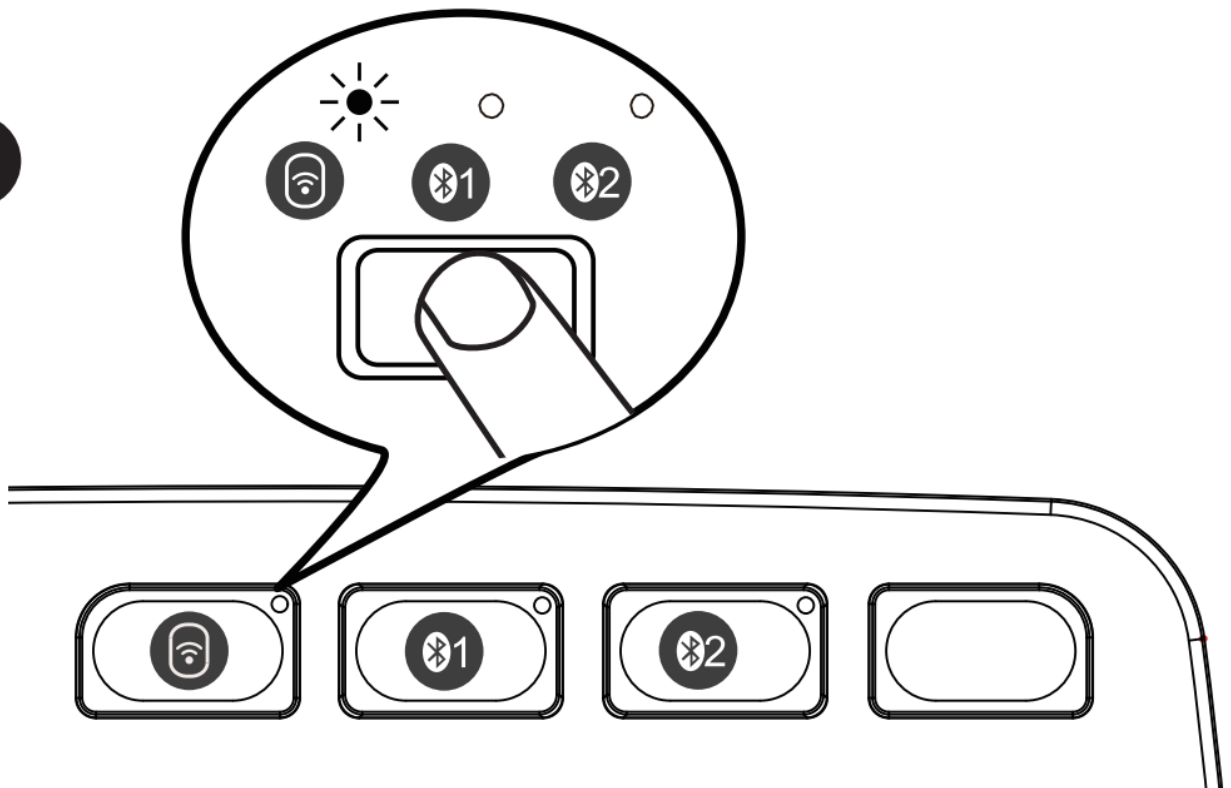

Bluetooth Connection Steps

1. Switch the power ON.

1

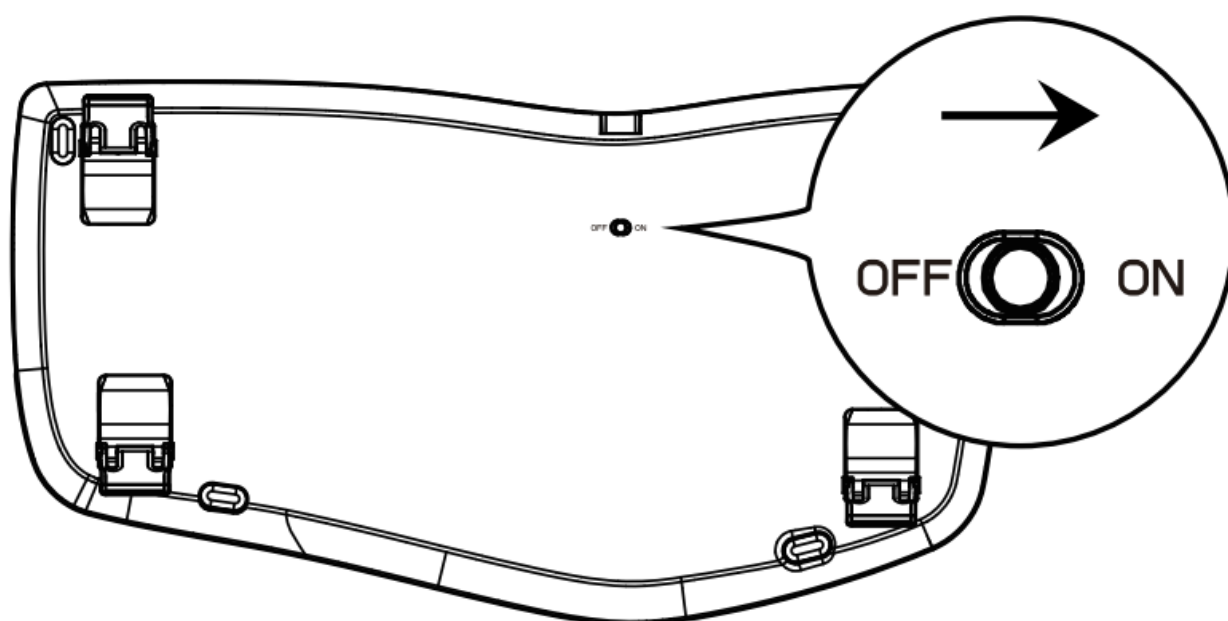

2. Press the channel key to choose a bluetooth channel  /  when the indicator light flashes slowly, keyboard is in the corresponding channel.

2

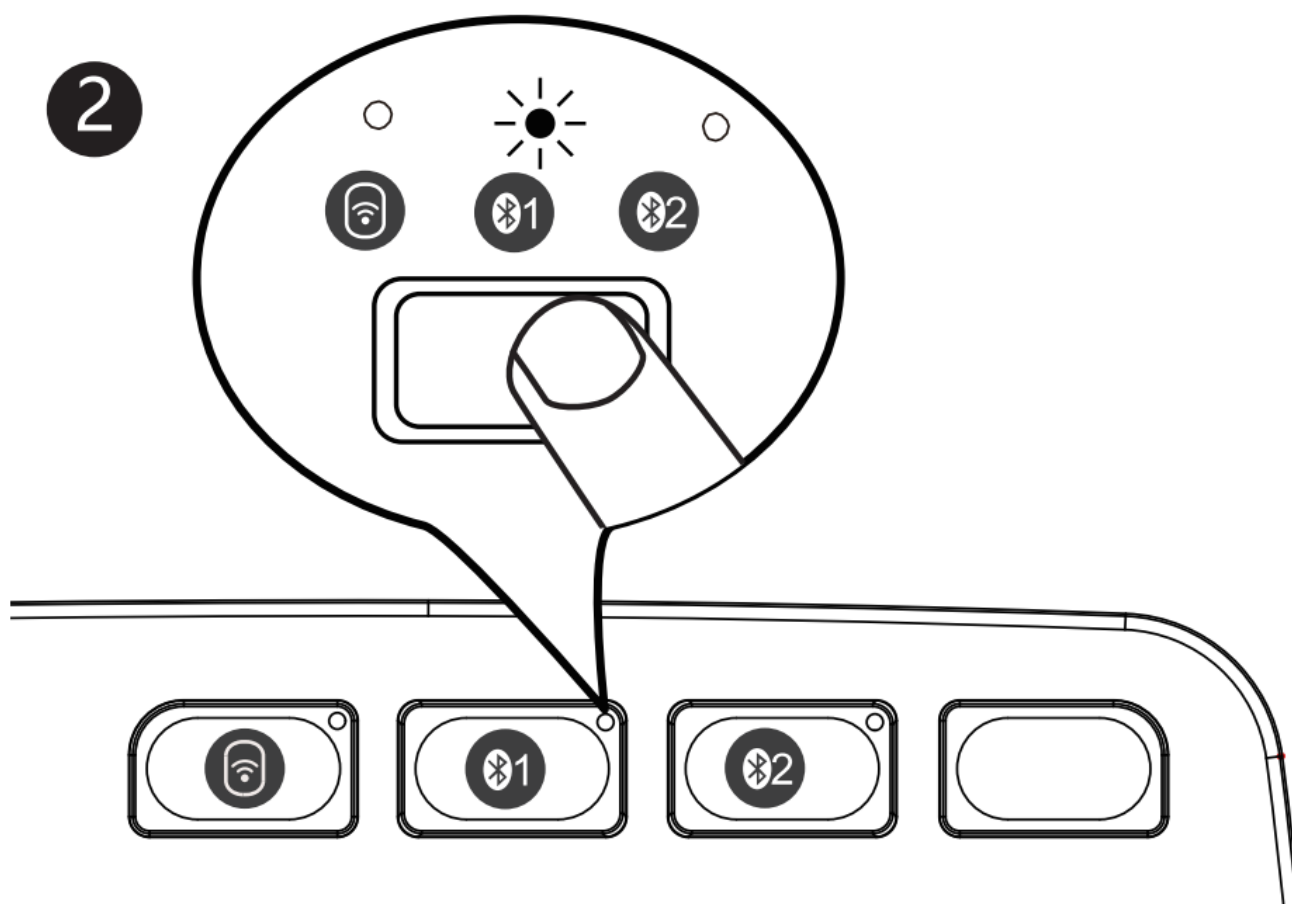

3. Hold and press the channel key for 3 to 5 seconds, the white indicator will flash quickly, the keyboard now enters bluetooth pairing mode.

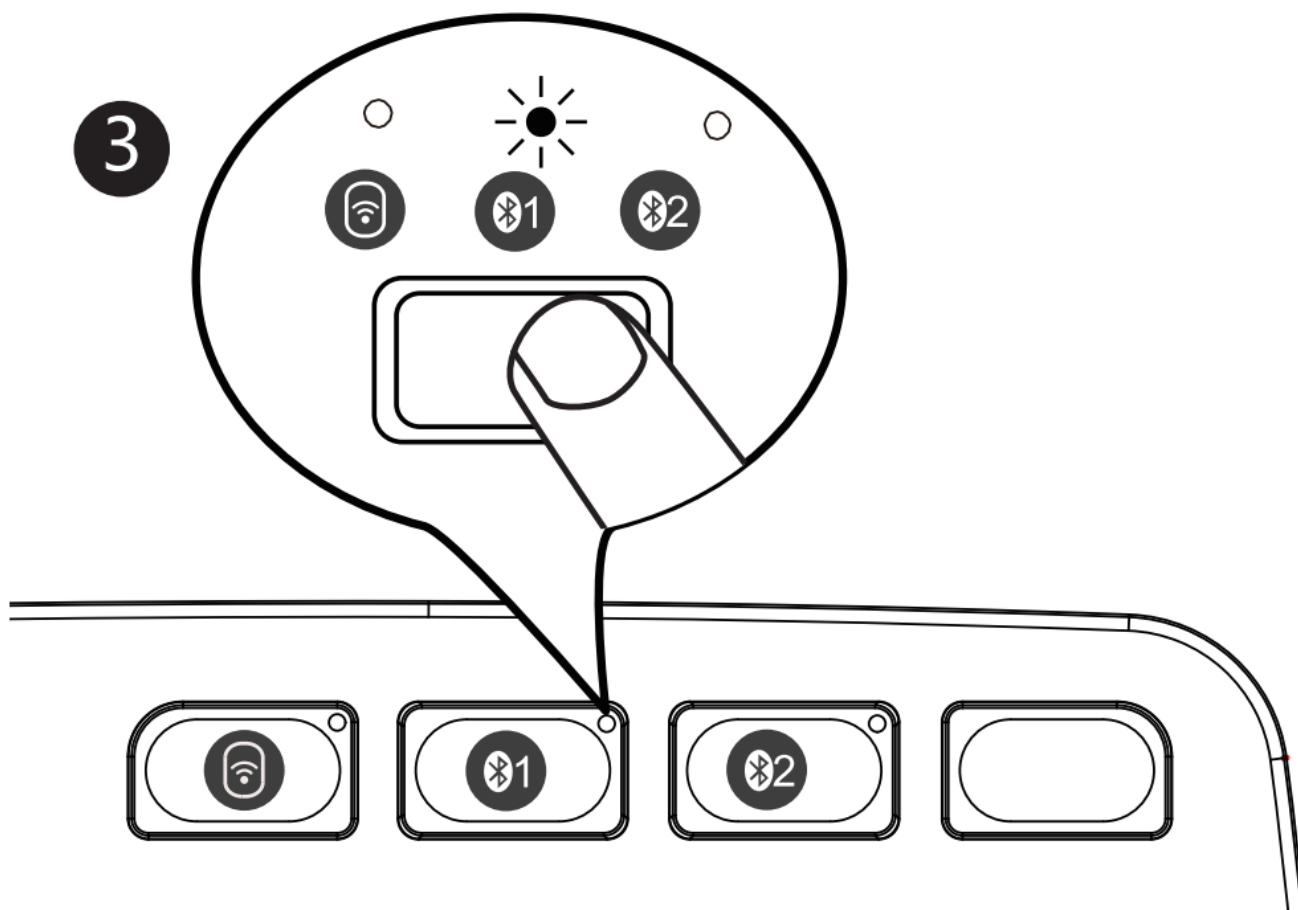

Windows 10 OS

4. Open "Settings" and Click Bluetooth Devices.

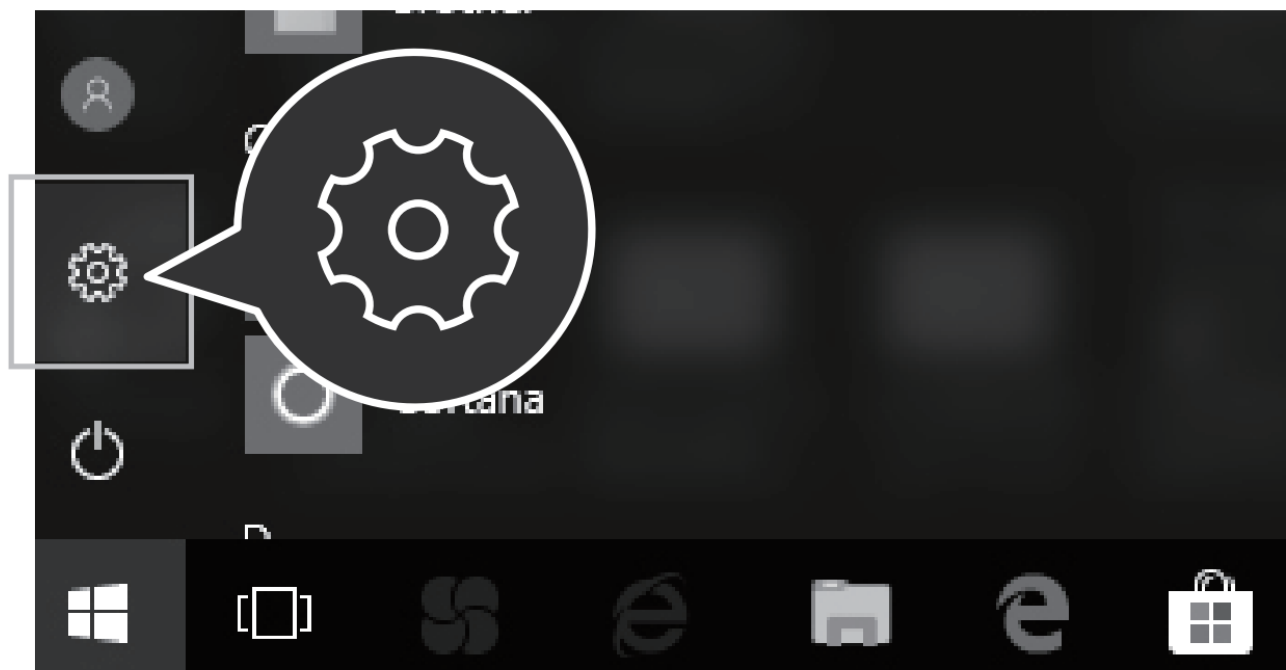

5. Choose "Add / Delete Bluetooth Devices".

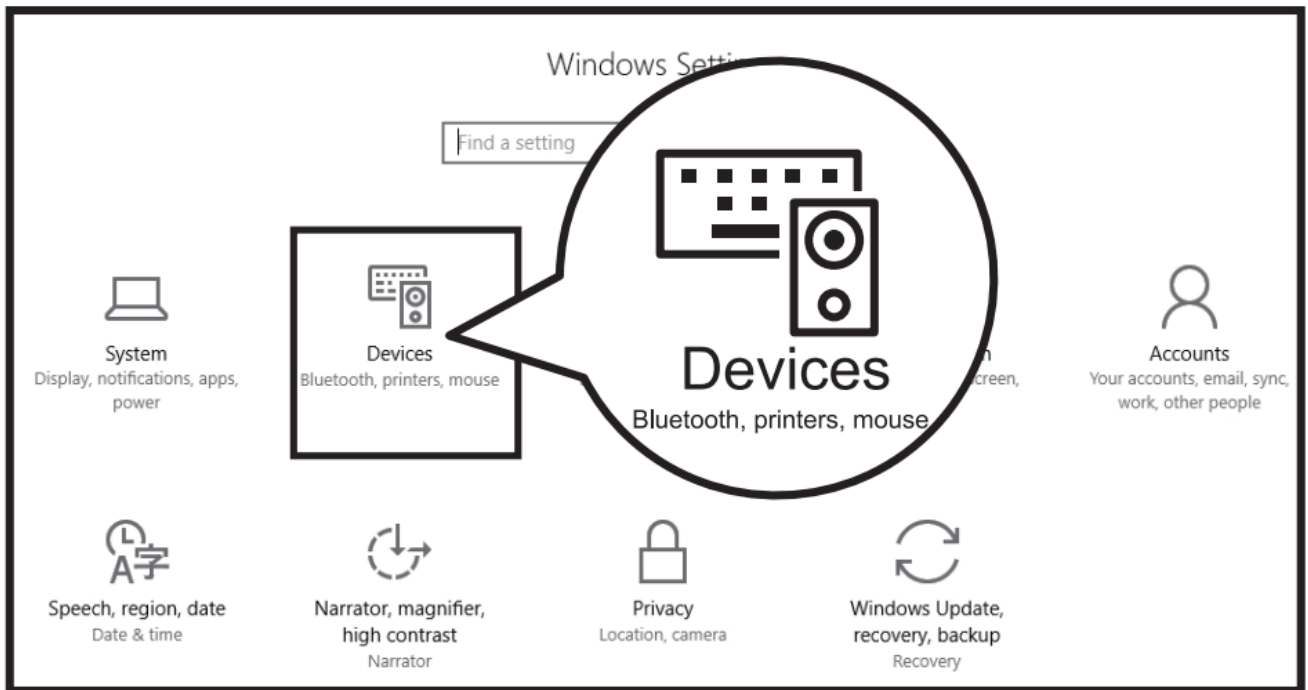

6. Search for “ProtoArc EK01-NL” and click “Pair”.

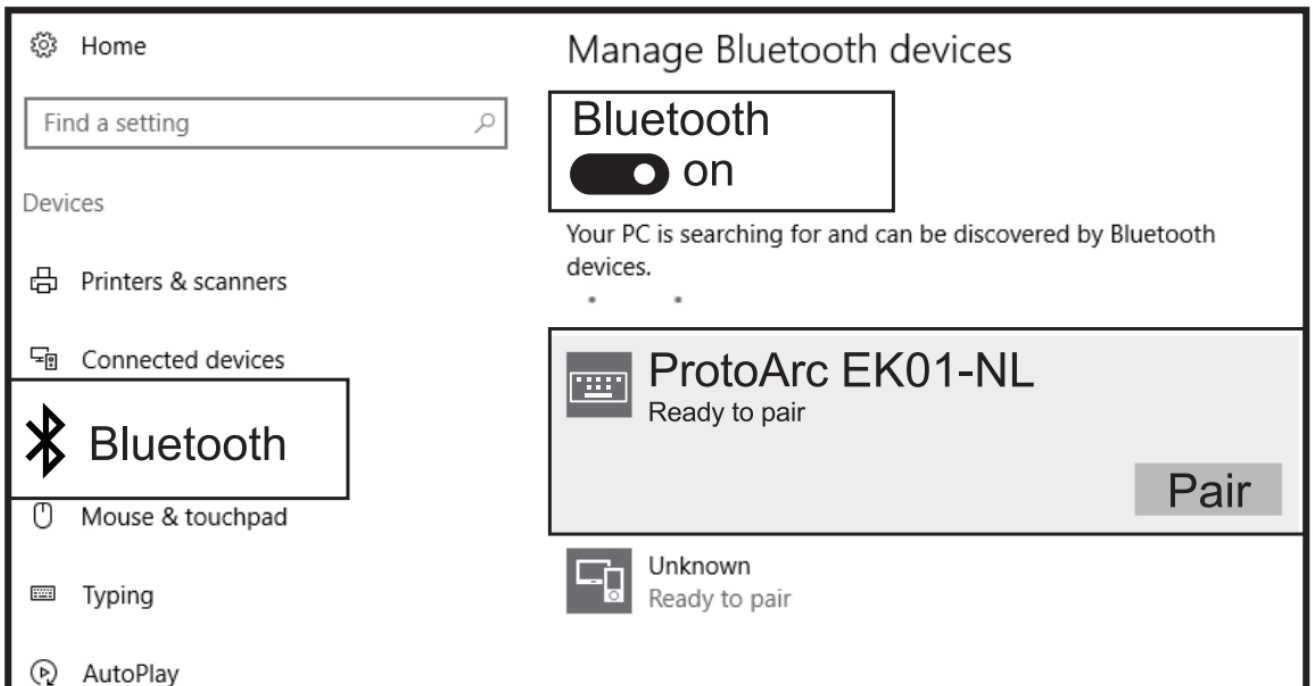

7. Pairing is complete when it shows “ProtoArc EK01-NL Connected”.

Your PC is searching for and can be discovered by Bluetooth devices.

.....



ProtoArc EK01-NL
Connected



Unknown
Ready to pair

Mac OS

Complete Keyboard Bluetooth Connection Steps 1, 2 and 3 before pairing.

Find "System Preferences" on Mac.



Turn on "Bluetooth" in System Preferences, search for "ProtoArc EK01-NL".



Click “Pair”, then wait until it shows “connected” for pairing to complete .



iOS

Complete Keyboard Bluetooth Connection Steps 1, 2 and 3 before pairing.

Open “Settings” and turn on Bluetooth.



Choose “ProtoArc EK01-NL” from the list and click “Pair”.

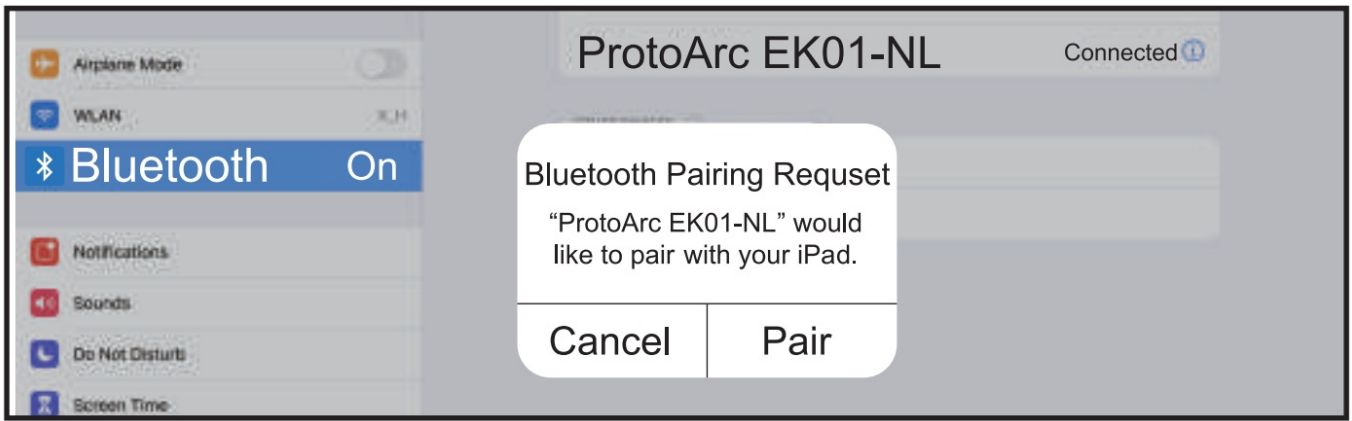

Pairing is complete when it shows “ProtoArc EK01-NL Connected”.



Android System

Complete Keyboard Bluetooth Connection Steps 1, 2 and 3 before pairing.

Open “Settings” and turn on Bluetooth.

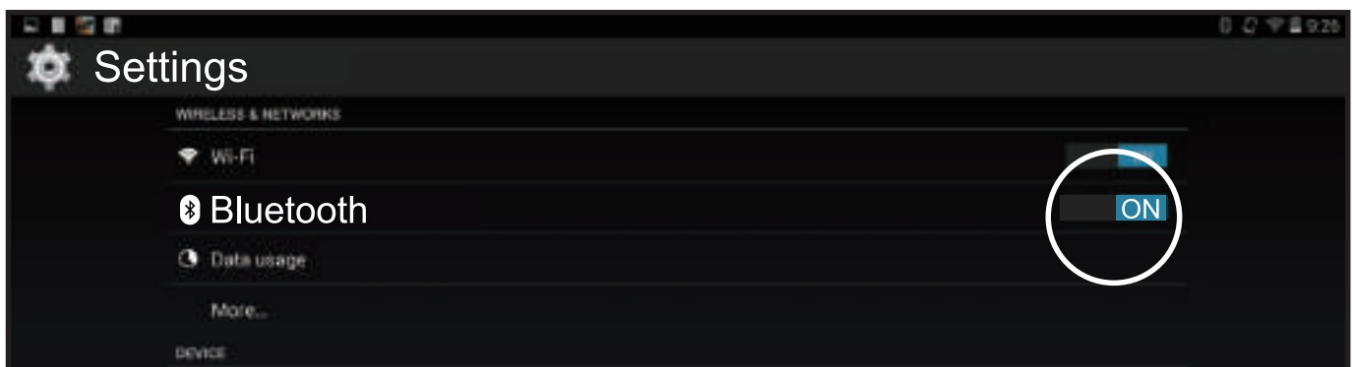



Bluetooth search and click to pair the “ProtoArc EK01-NL”.

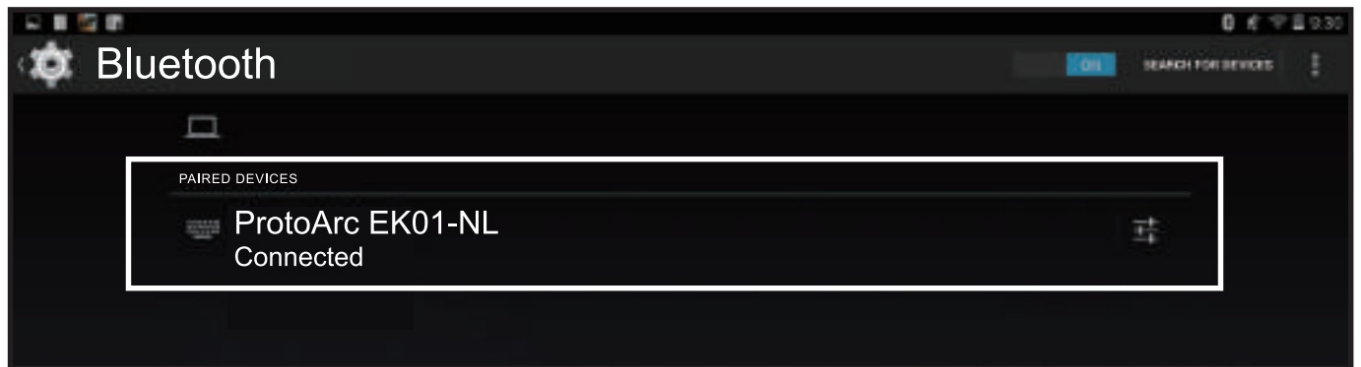

Pairing is complete when it shows “ProtoArc EK01-NL Connected”.



How to Switch Device Channels

After    are connected, press the corresponding channel key to switch between devices.

Bluetooth 1 Device Channel

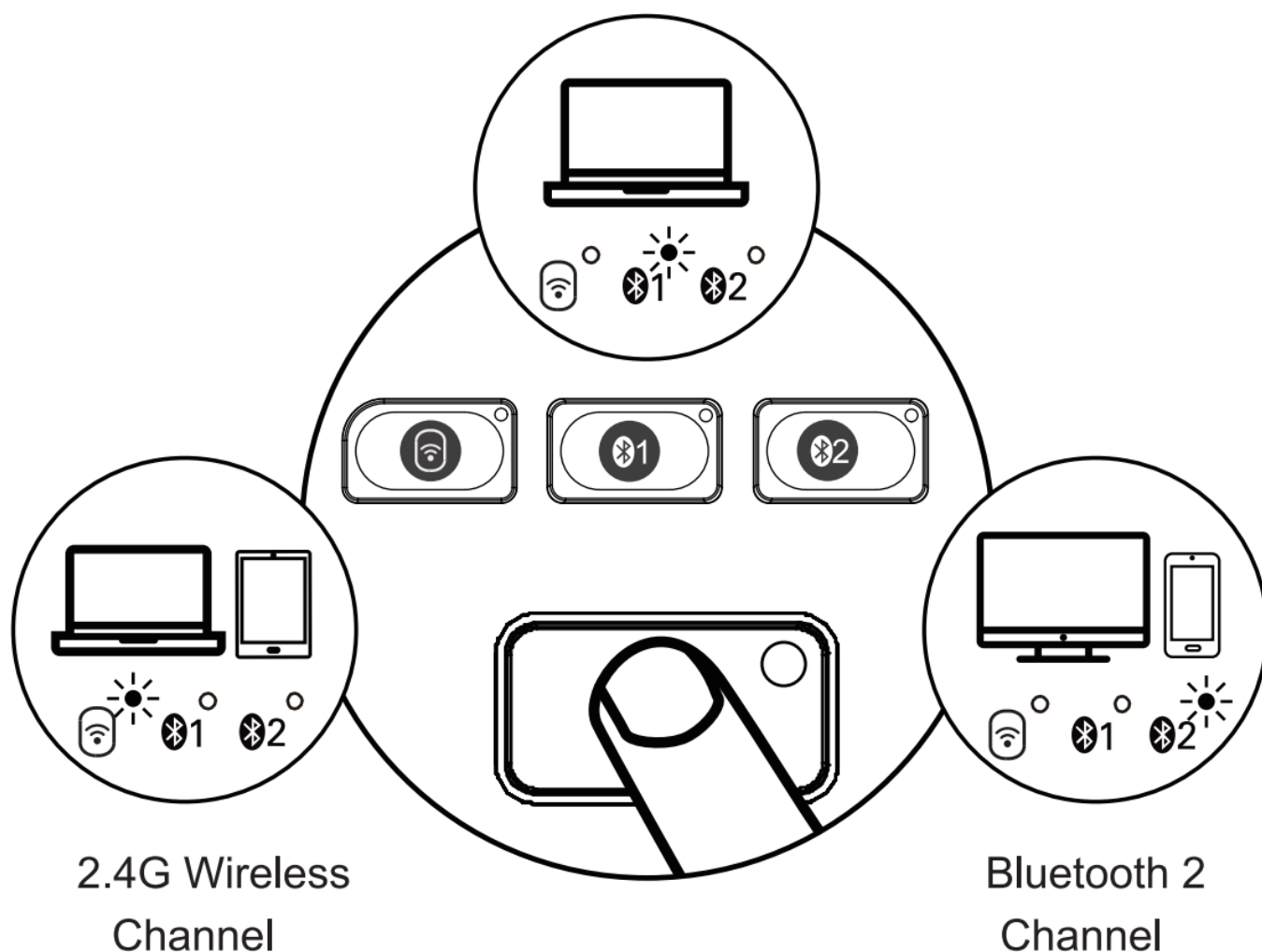

Keyboard Charging

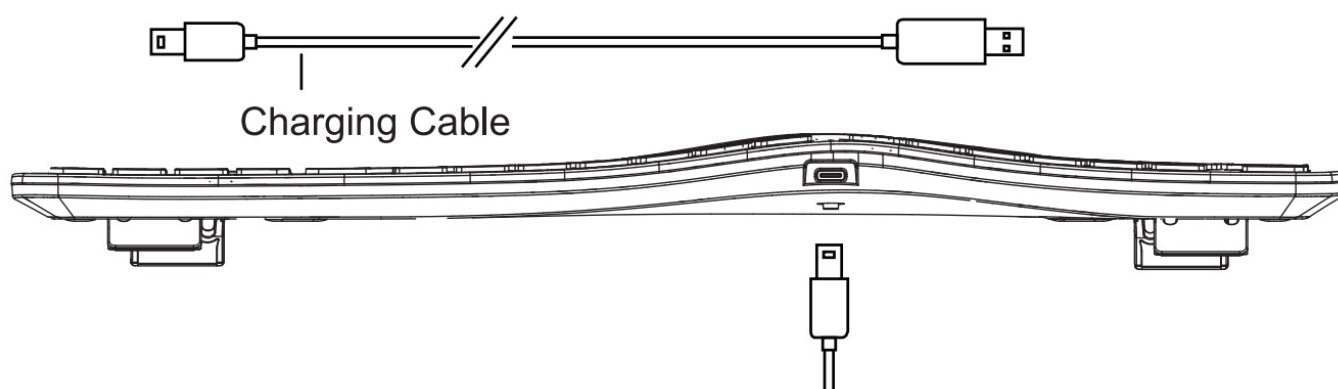















When battery is low, the power indicator light will start to flash until the keyboard turns off. Please recharge as soon as possible to ensure best user experience.





Low battery may cause poor connection quality, resulting delays or other problems while using.

The power indicator light is red while charging and will turn green when fully charged. One full charge cycle takes about 2-3 hours.

Multimedia Function Button

| Buttons | Windows | Android | iOS | MAC OS |
|---------|---------|---------|-----|--------|
|---------|---------|---------|-----|--------|

| | | | | |
|---|----------------------|---------------------|---------------------|----------------------|
|  | Decrease brightness | Decrease brightness | Decrease brightness | Decrease brightness |
|  | Increase brightness | Increase brightness | Increase brightness | Increase brightness |
|  | Window switching | Window switching | / | Multi-window preview |
|  | Multi-window preview | / | App switching | App switching |
|  | Show desktop | / | / | Show desktop |
|  | Search | Search | Search | Search |
|  | Select all | Select all | Select all | Select all |
|  | Copy | Copy | Copy | Copy |
|  | Cut | Cut | Cut | Cut |
|  | Paste | Paste | Paste | Paste |
|  | Mute | Mute | Mute | Mute |
|  | Home | Home | Home | / |
|  | Screenshot | Screenshot | Screenshot | Screenshot |
|  | Lock | / | Lock | Lock |
|  | Volume up | Volume up | Volume up | Volume up |

| | | | | |
|---|---|-------------|-------------|-------------|
|  | Volume down | Volume down | Volume down | Volume down |
|  | Previous | Previous | Previous | Previous |
|  | Play & Stop | Play & Stop | Play & Stop | Play & Stop |
|  | Next | Next | Next | Next |
|  | press FN+ESC to turn ON / OFF the FN function | | | |

NOTE: The FN function is for alternate commands (F1-F12 & multimedia functions are dual-use keys).

Product Specification

| | |
|------------------------------|---|
| Compatible Operating Systems | 2.4G: Windows System Bluetooth: Windows 8, Windows 10 or above, Mac OS X 10.12 or above, Android 4.3 or above. |
| Battery Capacity | 300mAh |
| Sleep Time | Enter into the sleep mode after no operation of 30 minutes |
| Battery Life | 1000 times charge and discharge |
| Key Life | 3 Millions Strokes |
| Standby Time | 200 Hours |
| Wake Up Way | Press any key |
| Operating Distance | 8 m / 26 ft |
| Working Current | 53mA |
| Keyboard Dimension | 423.8 x 231.4 x 27.7mm / 16.7" x 9.1" x 1.1" |

Tips

1. If keyboard fails to connect, switch the keyboard power OFF then turn it back ON, retry the Bluetooth connection procedures again. Clear the current Bluetooth connection list, remove current devices and then reconnect.
2. To switch to a already connected channel, please wait for 3 seconds after pressing the switch device button for it to respond.
3. The keyboard has memory function, when a keyboard channel is successfully connected, that channel

connection will remain connected in the default channel. The corresponding indicator light will be on.

Sleep Mode

1. When the keyboard stays idle for more than 30 minutes, it will automatically enter sleep mode and the indicator light will be off.
2. To wake the keyboard simply press any key on the keyboard and it will be ready within 3 seconds. The indicator light will turn on again.

What's In Package

- 1 x Wireless Bluetooth Keyboard
- 1 x USB Receiver
- 1 x Type-C Charging Cable
- 1 x User Manual

Customer Support

support@protoarc.com
www.protoarc.com

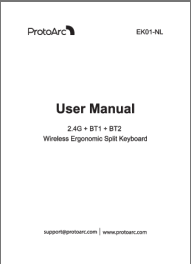

Documents / Resources

| | |
|---|---|
|  The image shows the front cover of the user manual. It is white with black text. At the top left is the ProtoArc logo. In the center, it says "User Manual" followed by "2.4G + BT1 + BT2" and "Wireless Ergonomic Split Keyboard". At the bottom, it provides the email "support@protoarc.com" and the website "www.protoarc.com". | <p>ProtoArc EK01-NL Ergonomic Keyboard [pdf] User Manual</p> <p>EK01-NL Ergonomic Keyboard, EK01-NL, Ergonomic Keyboard, Keyboard</p> |
|---|---|

References

- [User Manual](#)

[Manuals+](#), [Privacy Policy](#)

This website is an independent publication and is neither affiliated with nor endorsed by any of the trademark owners. The "Bluetooth®" word mark and logos are registered trademarks owned by Bluetooth SIG, Inc. The "Wi-Fi®" word mark and logos are registered trademarks owned by the Wi-Fi Alliance. Any use of these marks on this website does not imply any affiliation with or endorsement.