



## ProtoArc 2.4G Bluetooth Bluetooth Wireless Rechargeable Mouse User Manual

[Home](#) » [ProtoArc](#) » ProtoArc 2.4G Bluetooth Bluetooth Wireless Rechargeable Mouse User Manual 

ProtoArc 2.4G Bluetooth Bluetooth Wireless Rechargeable Mouse User Manual



## Contents

- 1 Product Features
- 2 USB Connection
- 3 Bluetooth Connection
- 4 Charging Function Guide
- 5 How to switch connection mode
- 6 Data parameters
- 7 What's in Package
- 8 Documents / Resources
- 9 Related Posts

## Product Features

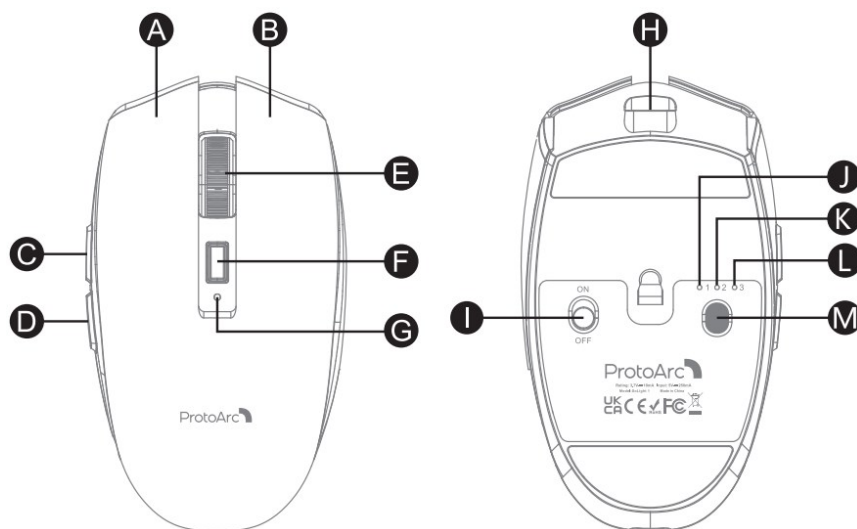

- A** Left Button
- B** Right Button
- C** Forward Button
- D** Backward Button
- E** Scroll Wheel
- F** DPI Button
- G** Charging / DPI Indicator
- H** TYPE-C Charging Port
- I** Power Switch
- J** 2.4G Indicator
- K** Wireless 1 Indicator
- L** Wireless 2 Indicator
- M** Switch Device Button

## USB Connection

1. Turn on the power switch to **ON**.

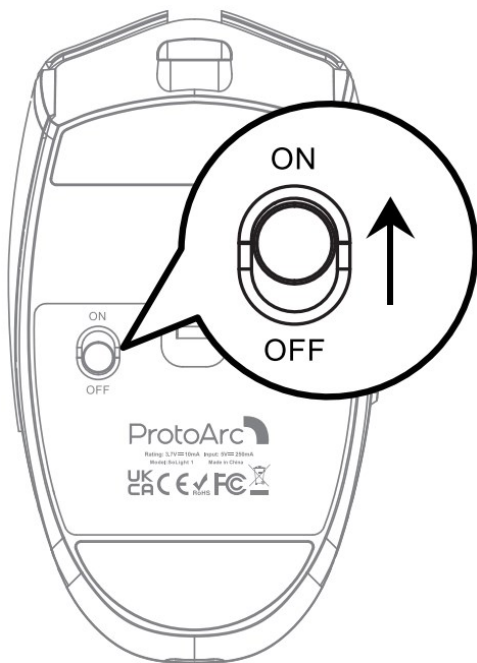

2. Open the cover and take out the USB receiver.

**Notice:** Buckle out the cover from behind first and then slide out the cover.

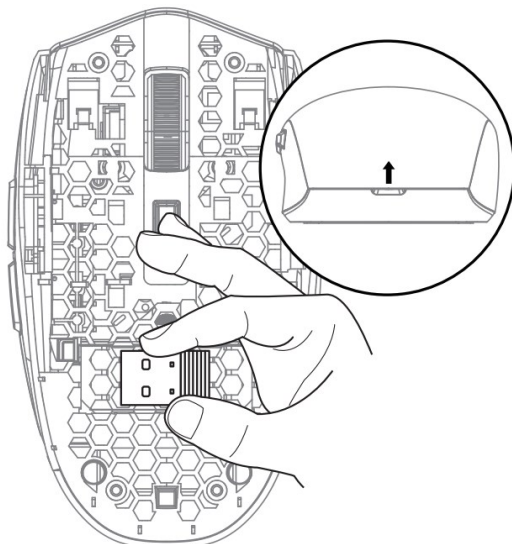

3. Press the mode switch button until the white light 1 is on and enter 2.4G mode.



4. Insert the usb receiver into your computer's usb port.

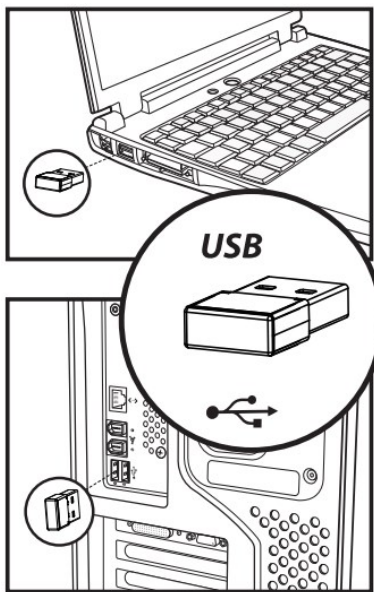

## Bluetooth Connection

1. Turn on the power switch to **ON**.



2. Press the mode switch button and switch to 2 or 3 mode, the white light flashes slowly.

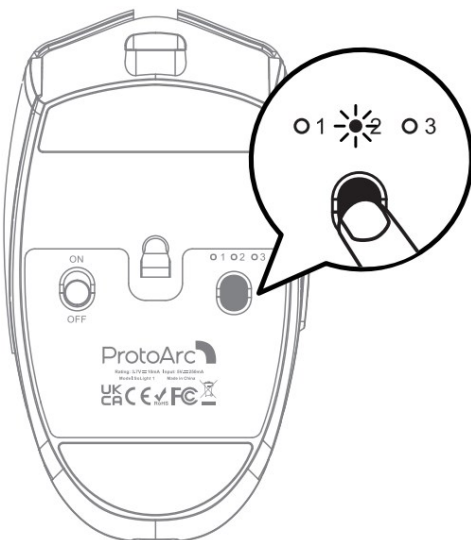

3. Press and hold the mode switch button for 3~5 seconds until the white light flashes quickly, then the mouse

enters the Bluetooth pairing mode.



## Windows 10 System

4. Click “Bluetooth device”.



5. Click “Add or remove a Bluetooth device”.

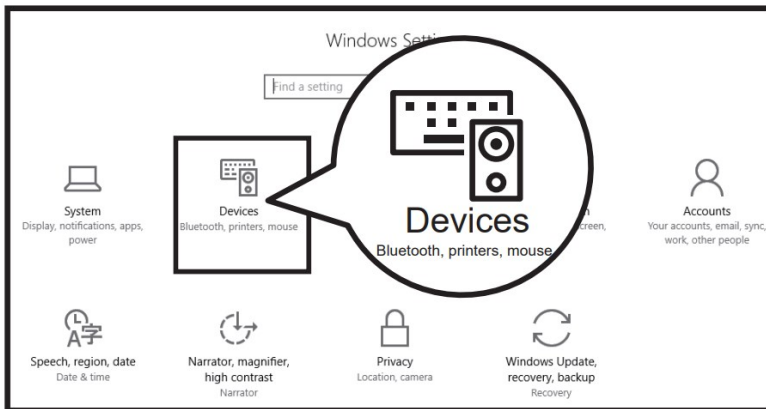

6. Your computer will automatically search for “ProtoArc SoLight 1” and then click “pair”.

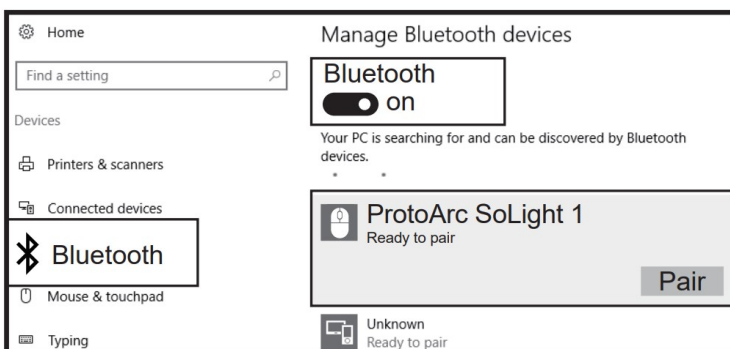

7. "Proto Arc So Light 1" is connected and can be used normally.

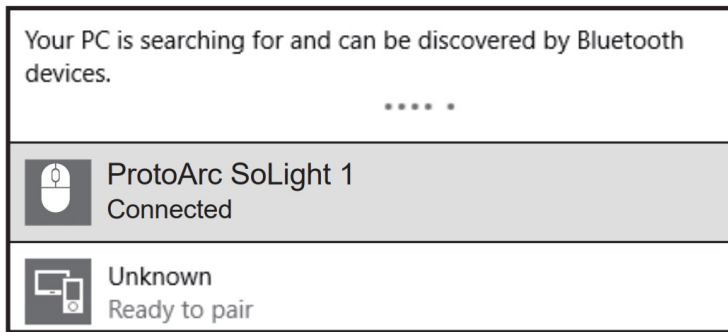

## Mac OS System

Please complete the Bluetooth mode installation step 123 before pairing.

1. Click "System Preferences" on Mac.

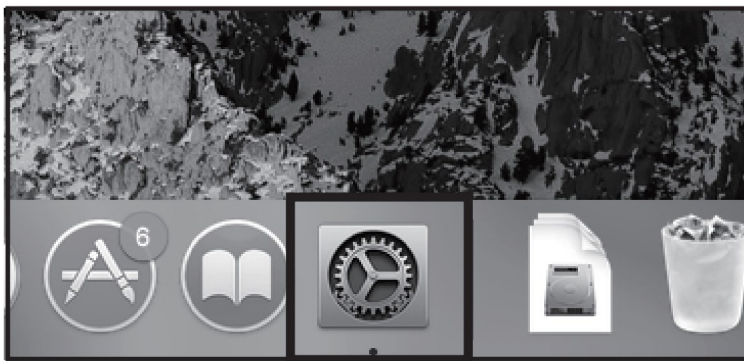

2. Click "Bluetooth" in "System Preferences".

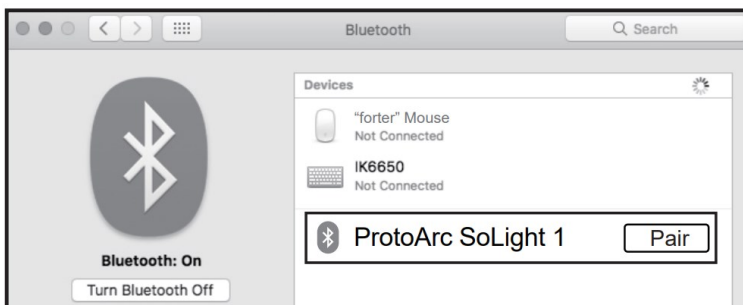

3. Your computer will automatically find "ProtoArc SoLight 1", then click "pair", and you can use it after installation.

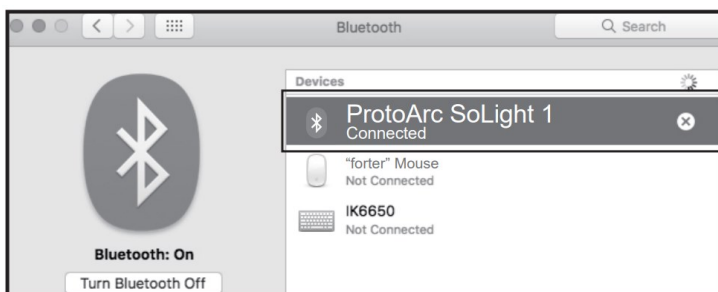

## iOS System

Only the system above iOS 13 supports the mouse function. Please complete the Bluetooth mode installation step 123 before pairing.

1. Click Settings on your device, then turn on Accessibility.

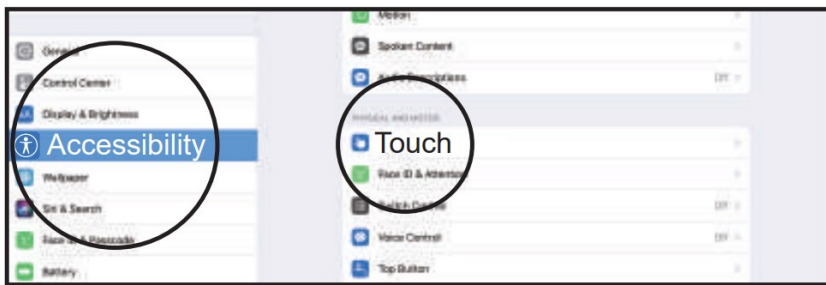

2. Click Touch.

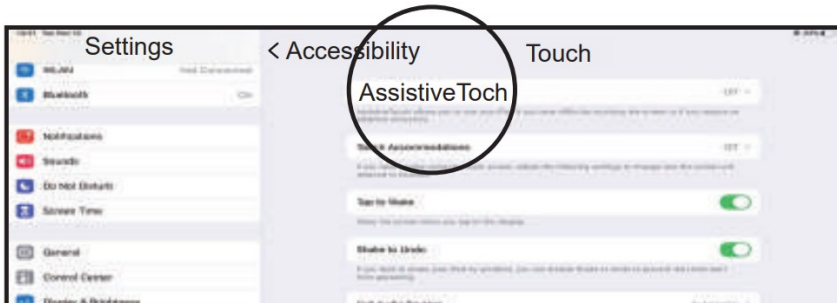

3. Turn on Assistive Touch.

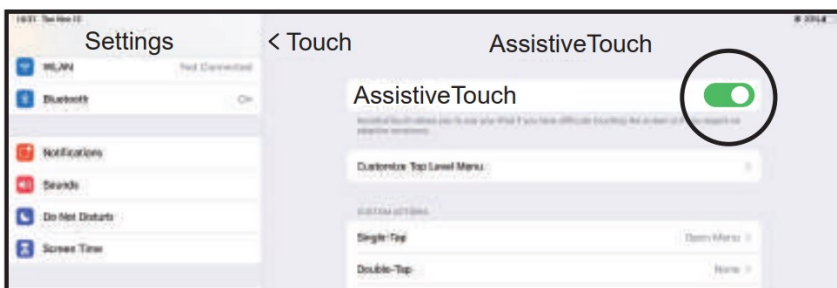

4. Click Settings on the device, then turn on Bluetooth.



5. Your computer will automatically find “ProtoArc SoLight 1”, then click “Pair”, complete pairing.

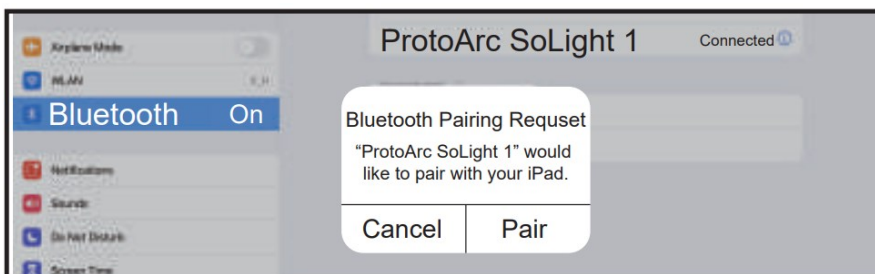

6. “ProtoArc SoLight 1” is connected and can be used normally.

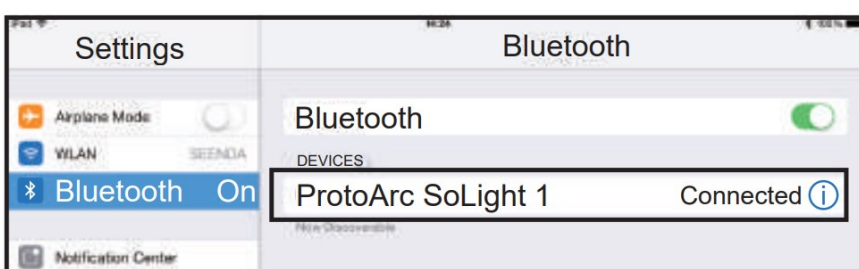



## Android system

Please complete the Bluetooth mode installation step 123 before pairing.

1. Click Settings on the device, then turn on Bluetooth.

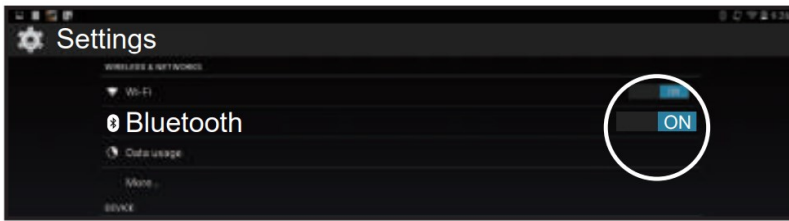

2. Your computer will automatically find “ProtoArc SoLight 1”, then click “pair”, complete pairing.

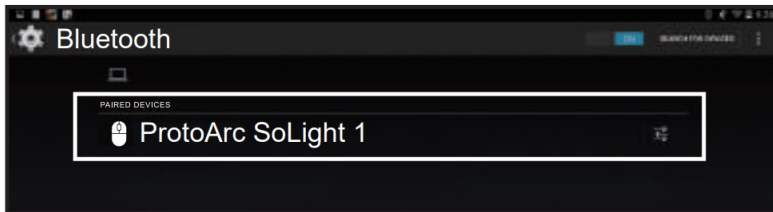

3. “ProtoArc SoLight 1” is connected and can be used normally.

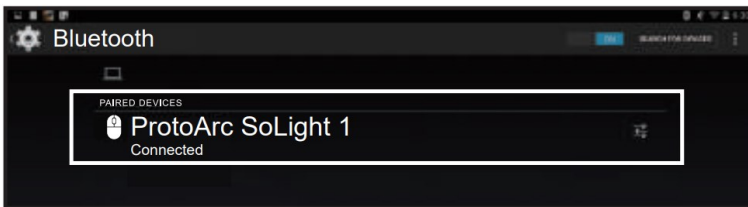

## Charging Function Guide

When the power is insufficient, the charging indicator and the corresponding channel indicator flash until it is turned off. Please connect the power supply for charging in time, and use the USB cable to connect the TYPE-C charging Port.

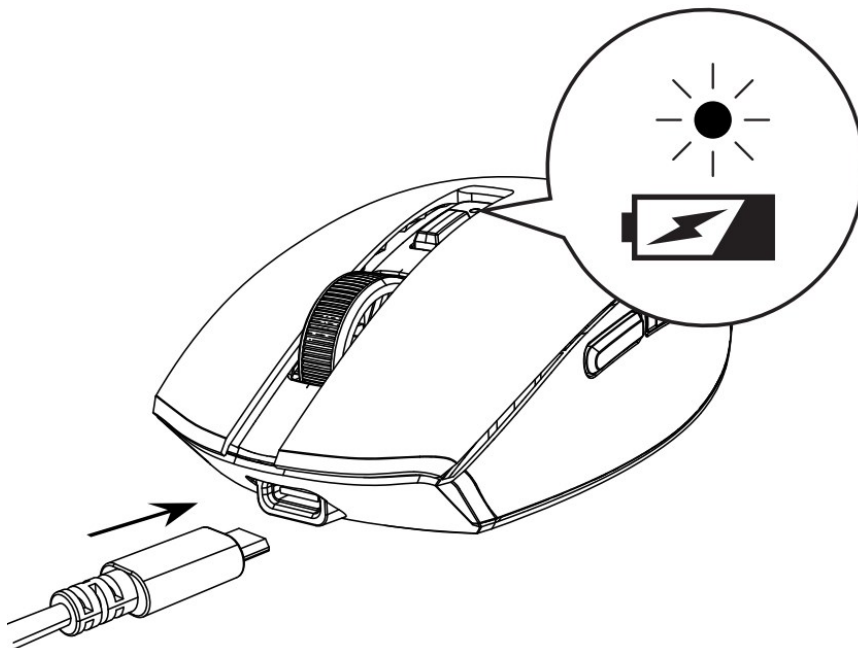

Connect the charging cable to the USB port of the computer, the charging indicator is always on during charging, the charging time is about 1-3.5 hours and the indicator light turns off when charging is complete.



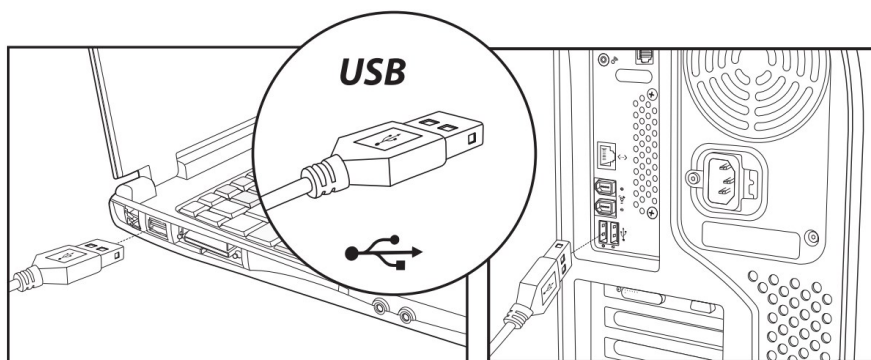

## How to switch connection mode

After BT1, BT2 and 2.4G USB mode is connected, press the mode switch button on the top of the mouse to switch between multiple devices.

Wireless 1 Device Connection

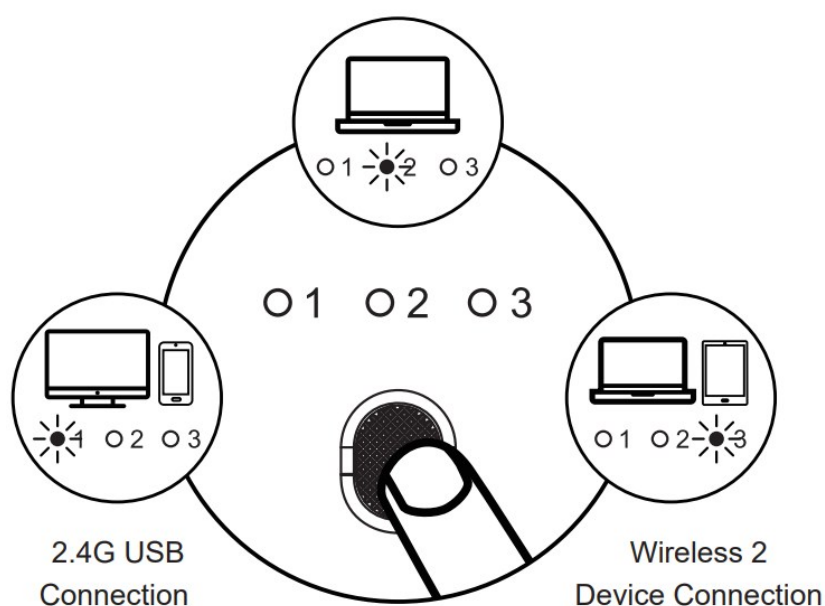

Press the mode switch button on the top of the mouse to switch between 3 devices.

## Data parameters

### Basic parameter:

**Chip:** Nordic NRF51802W

**Movement Detection Technology:** Optical

**Lithium battery Capacity:** 300mA

**DPI:** 1000-1600-2400

**Click life:** 3 million+

**Dimension:** 109.2\*62.3\*38.3mm

**Weight:** 57g

### Bluetooth transmission parameters:

**Transmission distance:** 10m

**Working Voltage:** 3.7V

**Working current:** 8mA

**Reaction rate:** 125Hz

### System requirement:

Bluetooth-enable device

Windows 8, Windows 10 or higher version

Mac OS x 10.10 or higher version

Android 4.3 or higher version

**2.4G transmission parameters:**

**Transmission distance:** 20m

**Working Voltage:** 3.7V

**Working current:** 10mA

**Reaction rate:** 250Hz

**System requirement:**

An available USB port

Windows XP, Windows 7, Windows 8, Windows 10 or higher version Mac OS x 10.10 or higher version

**What's in Package**

- 1 x Wireless Mouse
- 1 x USB Receiver
- 1 x Type C Charging Cable
- 1 x User Manual

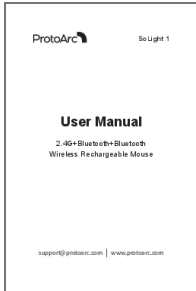

**Documents / Resources**

 The image shows the front cover of the user manual. It features the ProtoArc logo at the top left, the model name 'SoLight 1' at the top right, and the title 'User Manual' in the center. Below the title, it lists the product features: '2.4G+Bluetooth+Bluetooth Wireless Rechargeable Mouse'. At the bottom, there is contact information: 'support@protoarc.com   www.protoarc.com'.	<p><a href="#">ProtoArc 2.4G Bluetooth Bluetooth Wireless Rechargeable Mouse</a> [pdf] User Manual SoLight 1 Bluetooth Mouse, SoLight 1, Bluetooth Mouse, Mouse</p>
---	---

[Manuals+.](#)