



PROSLAT Fusion Plus Procore plus Backsplash Installation Guide

[Home](#) » [Proslat](#) » PROSLAT Fusion Plus Procore plus Backsplash Installation Guide 

Contents

- [1 PROSLAT Fusion Plus Procore plus Backsplash](#)
- [2 Safety Information](#)
- [3 Pre-Installation](#)
- [4 HARDWARE LIST](#)
- [5 Care and cleaning](#)
- [6 Assembly instructions](#)
- [7 Warranty](#)
- [8 Disclaimer of liability](#)
- [9 Documents / Resources](#)
 - [9.1 References](#)



PROSLAT Fusion Plus Procore plus Backsplash



THANK YOU

We appreciate the trust and confidence you have placed in Proslat through the purchase of this product. Visit www.proslat.com to see our full line of products available for your home storage needs. Thank you for choosing Proslat!

Safety Information

SLATWALL MUST BE INSTALLED INTO WALL STUDS

- It is the responsibility of the installer to ensure that the wall mounting surface and structure are sufficient in strength & capacity to support slatwall weight and its contents. Failure to observe these conditions may result in injury or death.
- For optimum performance, slatwall must be mounted to vertical wall studs spaced apart no more than 24 in.

WARNING: Ensure that the wall mounting surface and structure are sufficient in strength & capacity to support Slatwallweight and its contents.

CAUTION: For optimum performance, Procore+ Slatwall must be mounted to vertical wall studs no larger than 24 in.

Pre-Installation

TOOLS REQUIRED

 Stud finder	 Level	 Marker	 Tin Snips	 Power screwdriver
---	---	--	--	---

HARDWARE LIST

Part	Description
AA	Torx T25 bit / Embout Torx T25
BB	2½ in. Torx screws / Vis Torx de 6,4 cm



PACKAGE CONTENTS

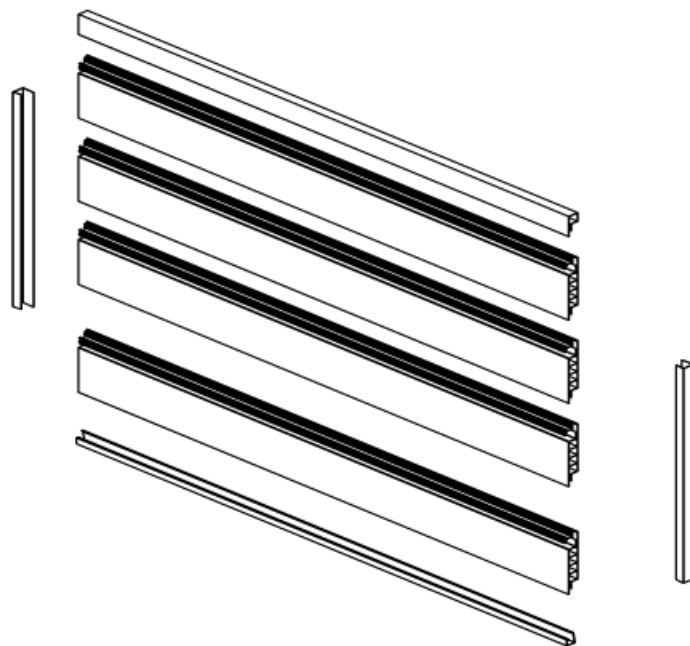

- 1 x Top trim
- 4 x Panels
- 2 x J-trims
- 1 x Starter trim

Care and cleaning

- Proslat Procore+ panels are very durable and water-resistant. They can be washed with a power washer on low setting or wiped with a soft cloth and mild detergents. Do not use sharp objects or abrasive cleaners.

Assembly instructions

Assemble FusionPlus Cabinets

- Assemble Fusion Plus Cabinets without the wall mount cabinets before starting the installation of the backsplash.

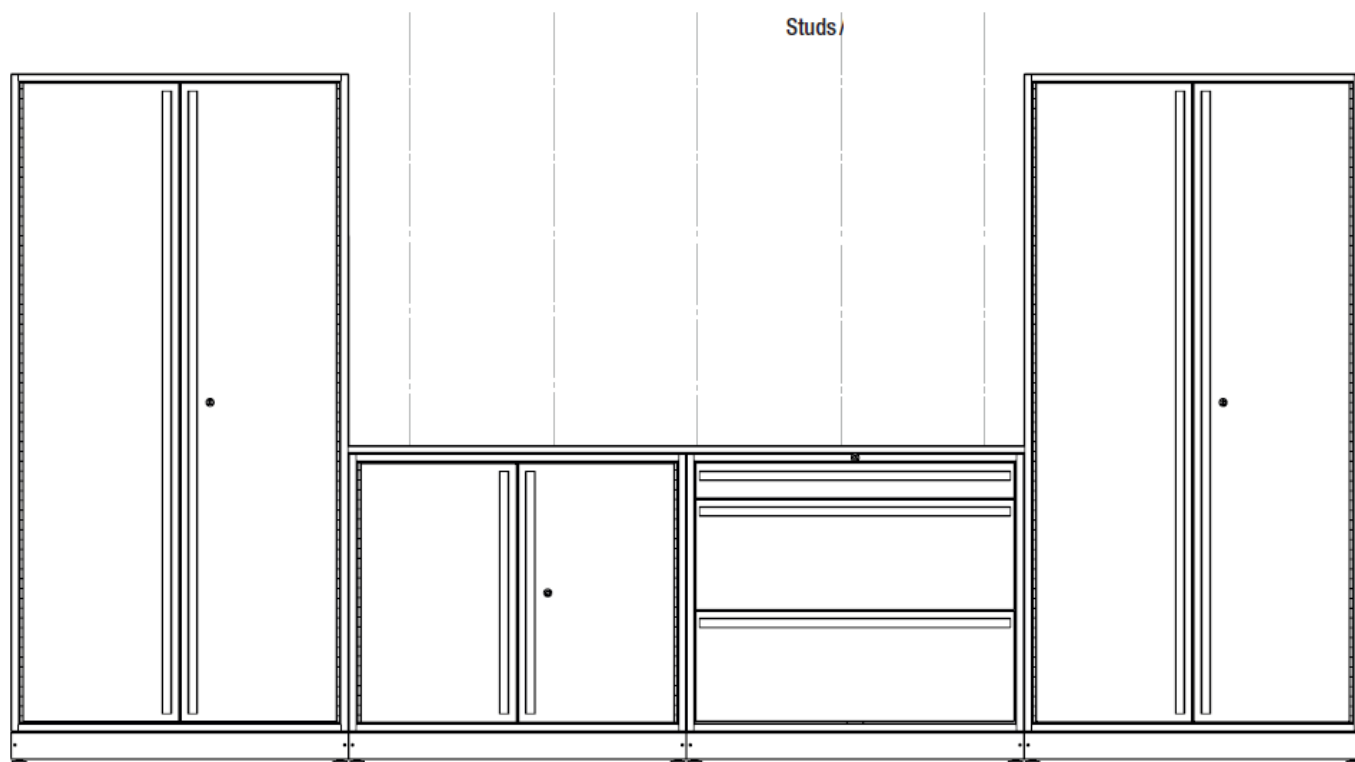

Location of your studs

- Using a stud finder, locate all studs and mark along their length with a level.
- You will need to screw each panel into each stud.



Install your horizontal starter trim

- Install your bottom starter trim on top of the work surface (the wider side installs against the wall), level and screw into the middle studs. Do not screw into the ends of the bottom horizontal starter trim yet.

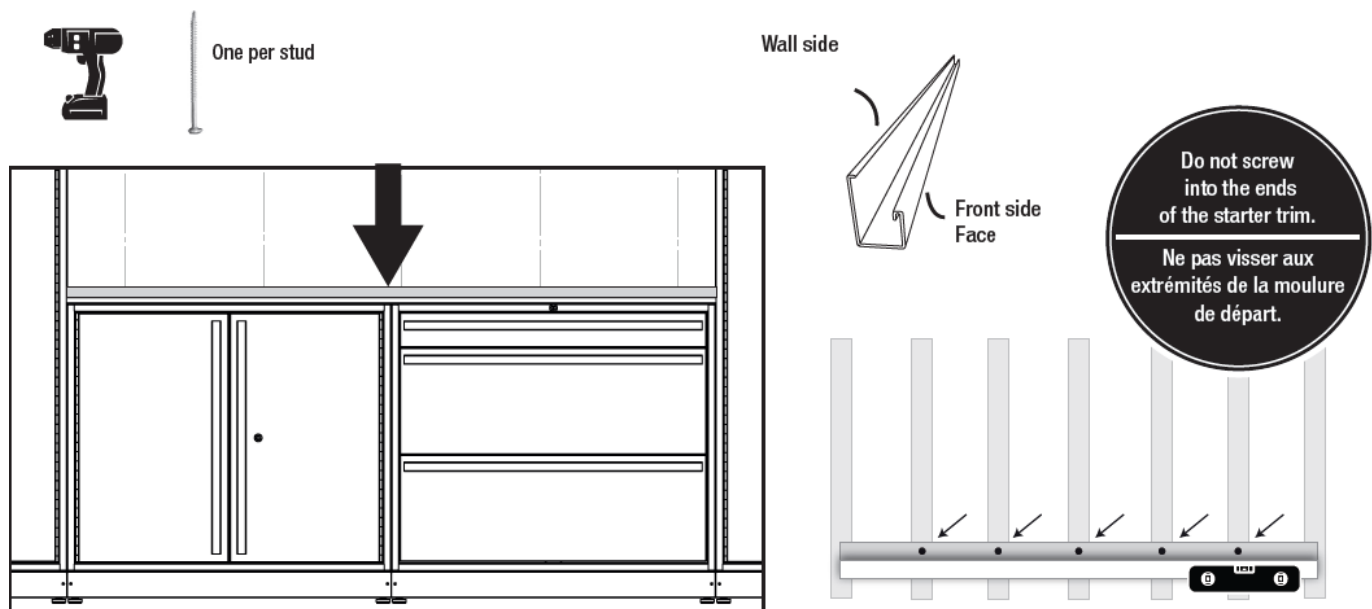

Install your vertical J-trim

- Starting on one side, overlap a side J-trim with your starter trim (the wider side installs against the wall) and screw through both (as indicated in the image).
- Level the side J-trim and drill one screw at the top to hold it in place. / Nivelez la moulure latérale et installez une vis dans le haut pour la faire tenir en place.

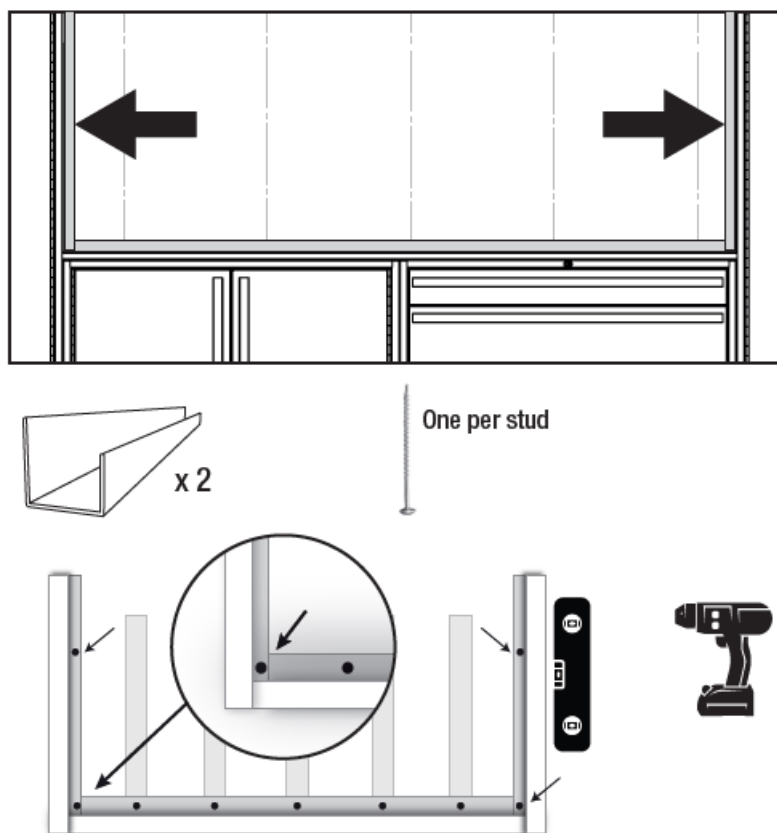

Install the first panel

- To install the first panel, fit the panel into the top of the tracks made by the vertical J-trims and slide all the way to the bottom.

- Make sure your panel is seated into the bottom starter trim and is level. Screw through the upper channel of the panel and into each stud. Drill screws at either end of the panel through the vertical J-trim and into your stud. This will hold your vertical J trims to the wall.

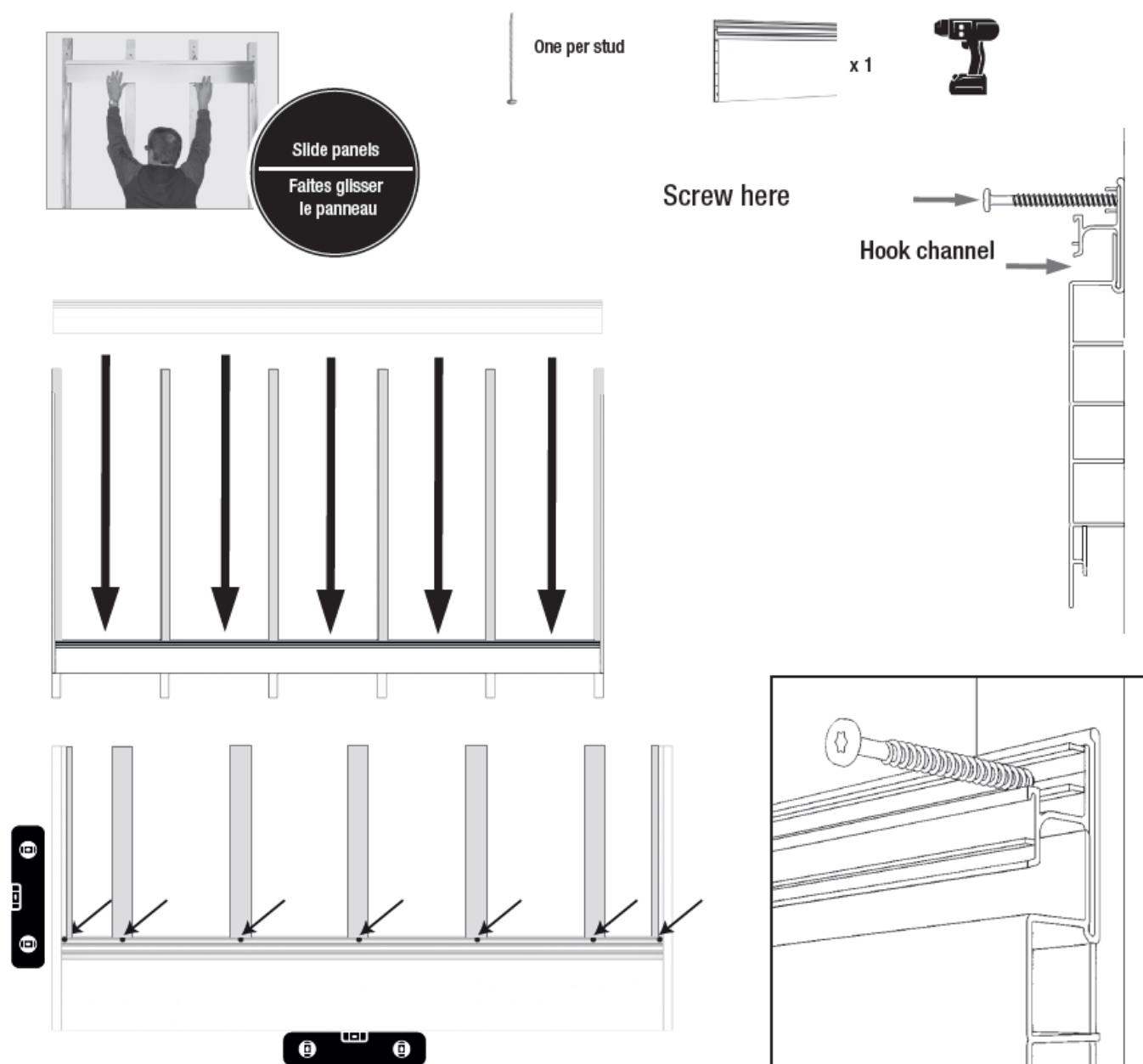

Installation of the following three panels

- Repeat Step 5 for all remaining panels. Push down on each panel before screwing to make sure that it is properly overlapped with the lower adjacent panel.
- Make sure you screw into every stud before installing the next panel.

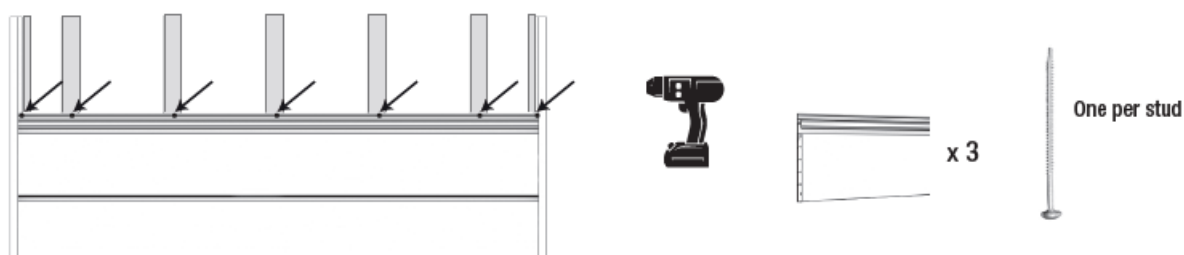

- Repeat until your last piece is left, verifying the level of every panel.
- Properly interlocked panels will conceal the previous panel's installation screws.

NOTE: Screws installed at the top of the vertical J-trims may have to be removed to complete a clean installation of the top panel.

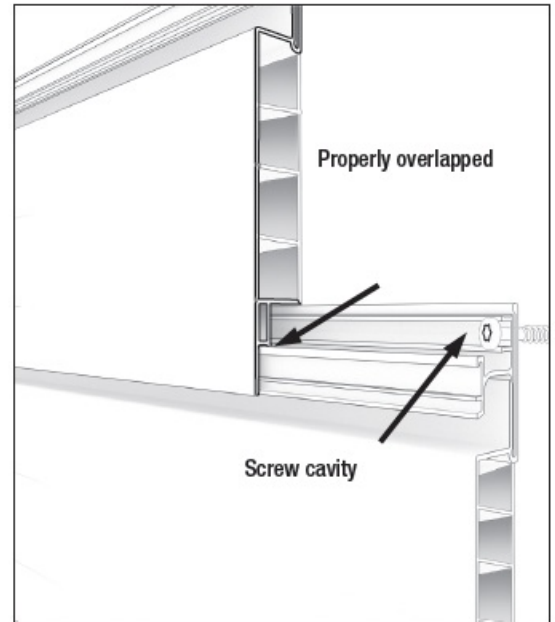
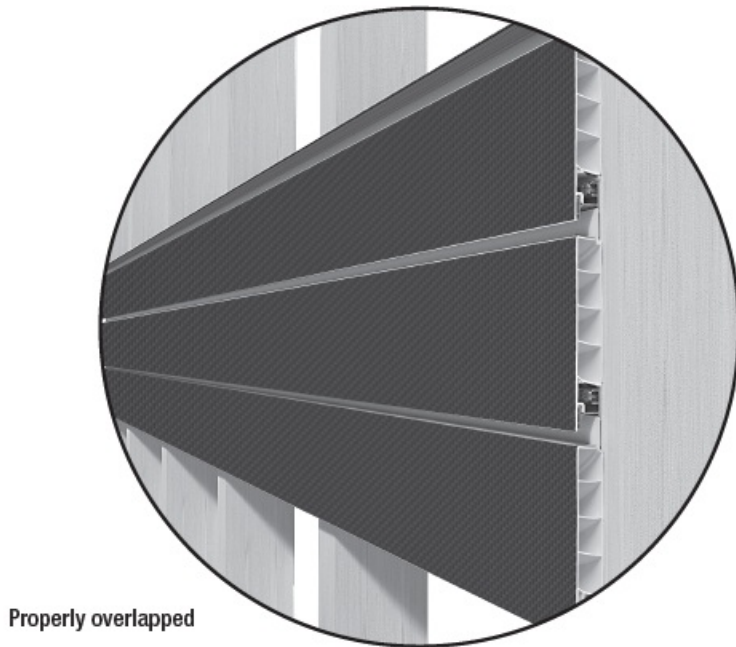

Install your top trim

- Install your horizontal top L-trim by simply clipping it into the lip above the screw cavity.

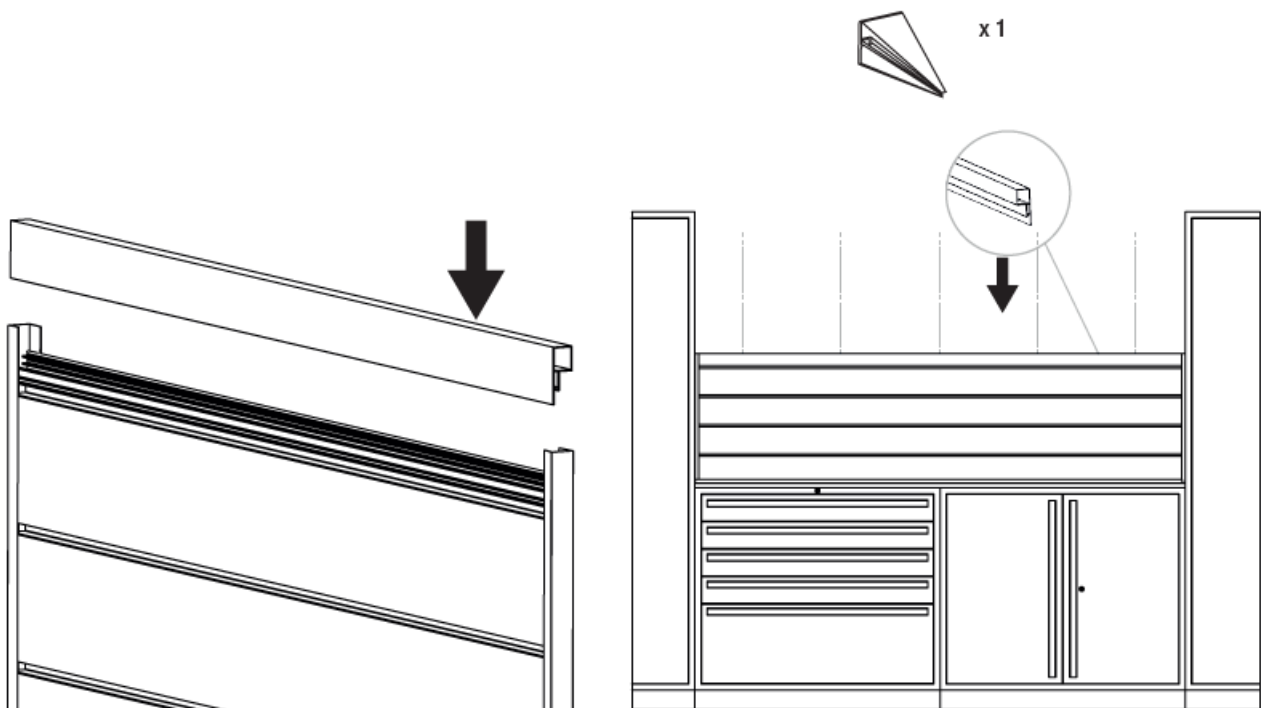

Side-by-side installation

- If you are installing two or more sections side by side, use 2 J-trims (placing them back to back) to connect sections.

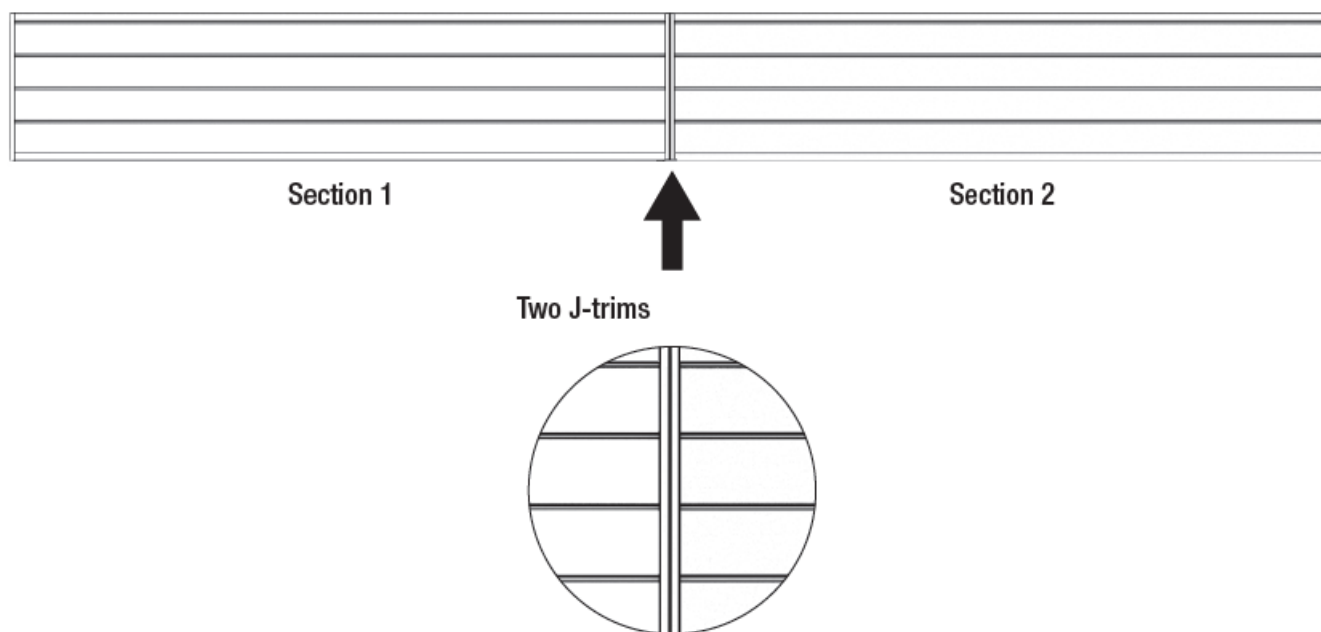

Warranty

Warranty – Proslat PROCORE+ Slatwall

This document details the Solutions Murales Proslat Inc. Warranty for all new Proslat Procore+ Slatwall purchased anywhere in North America. This Lifetime Warranty extends only to the first retail purchaser of the Procore+ Slatwall. Lifetime Warranty. Solutions Murales Proslat Inc. (hereafter Proslat) warrants its Procore+ slatwall against defects in material or workmanship for a lifetime period. Proslat will replace any defective panel as long as it was installed and maintained according to the printed instructions and local building codes. Any Proslat Procore+ Slatwall replaced under the terms of the Lifetime Warranty inherits the remaining warranty period from the original purchase. Exclusions. The Proslat Procore+ Warranty does not cover the following: Damage that results from improper installation or misuse or abuse; Damage due to acts of God, fire, or accident; Damage created by non-Proslat accessories such as hooks, baskets, cabinets, and shelving; Damage that results from loading accessories beyond the stated maximum weight capacity of the slatwall panels [225 lb. (102 kg) per square foot]; The cost of labor or accessory materials; and shipping cost to return defective products. Limitations of Warranty. The above Lifetime Warranty is the exclusive warranty for Proslat Procore+ Slatwall. Proslat disclaims all other warranties, express or implied, including any implied warranties or merchantability, fitness for a particular purpose, or otherwise. If you live in an area where consumer law prohibits this disclaimer, the above Lifetime Warranty will not extend the time period of any such implied warranty. Obtaining Lifetime Warranty Service. For warranty service, call 1.888.691.2944. You will need your original proof of purchase and photos to illustrate the claimed defect.

Disclaimer of liability

Solutions Murales Proslat Inc. and its successors, distributors, and dealers (hereafter SELLER) shall in no way be responsible for the product's proper use and service. THE BUYER HEREBY WAIVES ALL LIABILITY CLAIMS. The BUYER acknowledges that he/she is not relying on the SELLER's skill or judgment to select or furnish goods suitable for any particular purpose and that there are no liabilities that extend beyond the description on the face hereof and the BUYER hereby waives all remedies or liabilities, expressed or implied, arising by law or otherwise, (including without any obligations of the SELLER with respect to merchantability and consequential damages) or whether or not occasioned by the SELLER's negligence. The SELLER disclaims any warranty and expressly disclaims any liability for personal injury or damages. The BUYER acknowledges and agrees that the disclaimer of any liability for personal injury is a material term for this agreement and the BUYER agrees to indemnify the SELLER and to hold the SELLER harmless from any claim related to the item of the equipment purchased. Under no circumstances will the SELLER be liable for any damages or expenses by reason of the use or sale of any

such equipment. The SELLER assumes no liability regarding the improper installation or misapplication of its products. It is the installer’s responsibility to check for proper installation and if in doubt, contact the manufacturer. These assembly guidelines will direct you through the process of assembling a section of Solutions Murales Proslat Inc product. Please keep in mind that they may not cover every assembly or installation scenario you may encounter. Since each installation is unique in its performance requirements, the ultimate installation method used is the sole responsibility of the installer. Proslat Inc. disclaims any liability or responsibility for the improper installation of this product. The purchaser is solely responsible for compliance with applicable local codes. Solutions Murales Proslat Inc. recommends that all designs be reviewed by a licensed architect, engineer or local building official before installation.

QUESTIONS, PROBLEMS, MISSING PARTS?

CALL PROSLAT CUSTOMER SERVICE 8 A.M. – 5 P.M., EST, MONDAY – FRIDAY • 1-888-691-2944.

PROSLAT.COM.

Documents / Resources

	<p>PROSLAT Fusion Plus Procore plus Backsplash [pdf] Installation Guide 87803, 87802, 87801, Fusion Plus Procore plus Backsplash, Fusion Plus Procore, Fusion, Proc ore plus Backsplash, Procore plus, Backsplash</p>
---	---

References

-  [Lifts, Cabinets, Racks & Flooring - Custom Storage | Proslat Garage – Proslat US](#)
-  [Lifts, Cabinets, Racks & Flooring - Custom Storage | Proslat Garage – Proslat US](#)