



ProPlex GBS 5-Port Ethernet Switch User Guide

[Home](#) » [ProPlex](#) » ProPlex GBS 5-Port Ethernet Switch User Guide

ProPlex[®]

Contents [[hide](#)]

- [1 DATA DISTRIBUTION](#)
- [2 ProPlex GBS 5-Port Ethernet Switch Quick Start Guide](#)
 - [2.1 Introduction](#)
 - [2.2 Overview](#)
 - [2.3 Setup](#)
 - [2.4 LED status information](#)
- [3 Documents / Resources](#)
- [4 Related Posts](#)

DATA DISTRIBUTION



ProPlex GBS 5-Port Ethernet Switch Quick Start Guide

Introduction

The ProPlex GBS 5-Port Ethernet Switch is an unmanaged switch with four 10/100 Mbps ports and one 1Gbps port. The 10/100Mbps ports include PoE functionality (IEEE 802.3af compliant). Suitable for multicast, video, audio, or lighting, just a few key features include:

- One Gigabit port, four 100 Mbps PoE ports
- Overall 60W PoE power budget, 15W per output, 48 VDC
- Compatible with a wide range of entertainment-specific protocols, including sACN, ArtNet, CobraNet, ETCNet, Ethersound, and MA-Net
- Powerful and compact, for network applications of all kinds
- Complete range of DIN Rail Devices and Drives to make a complete system!

Part number	PPGBSPOEDIN005
Output channels	5
Operating voltage	48 VDC
Output Power	60 W max.
Power input	Phoenix MSTB 2-terminal
Ethernet Ports	RJ-45
Speed rates	4x 10-100 Mbps PoE
	1x 1 Gbps
PoE support	YES (IEEE 802.3af compliant)
Dimensions (HxWxD)	1.8 x 4.1 x 3.63 in (45,7 x 104 x 92,30 mm)
Weight	0.35 lbs (159 g)

Dimensions Dimensions in inches (mm)

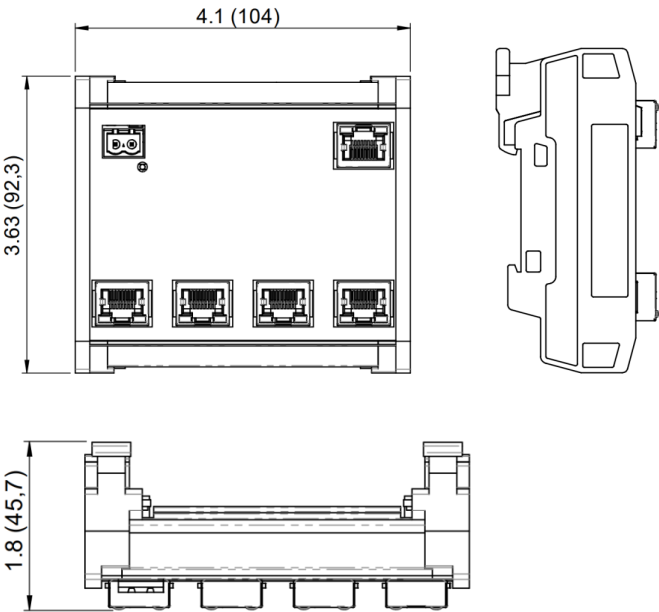

Overview

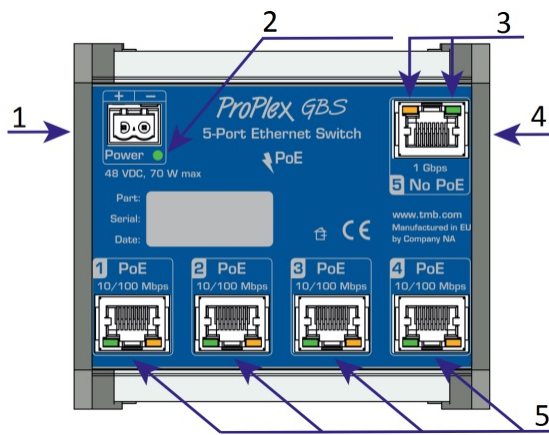

1. Power IN
2. Power LED
3. Network Link/Activity LEDs
4. 1 Gbps ethernet port
5. 4x 10/100 Mbps ethernet ports

Setup

ProPlex DIN Rail devices use a standard Phoenix MSTB screw terminal connector in various pin configurations. Please refer to the wiring diagrams below for correct hook up of your ProPlex DIN Rail product.

1. Connect the 48 VDC power to the power input located in top left corner. The connector should be wired as depicted in the image below.

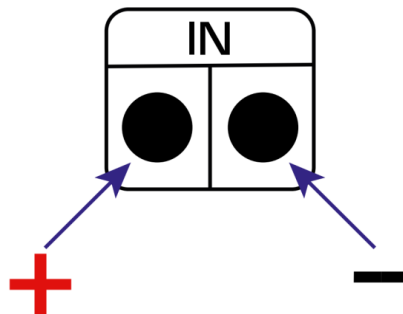

2. To use the PoE function:

- Connect the ethernet cable with the RJ-45 connector to the ethernet ports 1-4 located at the bottom of the unit.

When using PoE to pass electric power and data, switch can provide up to 15.4 W per output (IEEE 802.3af compliant).

2.1 Note! The 1 Gbps ethernet port at the top right of the unit does not support PoE.

LED status information

The Power LED has two states: ON and OFF.

- ON: Unit is receiving power
- OFF: Unit is not receiving power



Link LED has 2 statuses: ON and OFF.

If the LED is lit, then the link is connected.
 If the LED is off, then the link is not connected.

Activity LEDs has 2 statuses: blinking and OFF

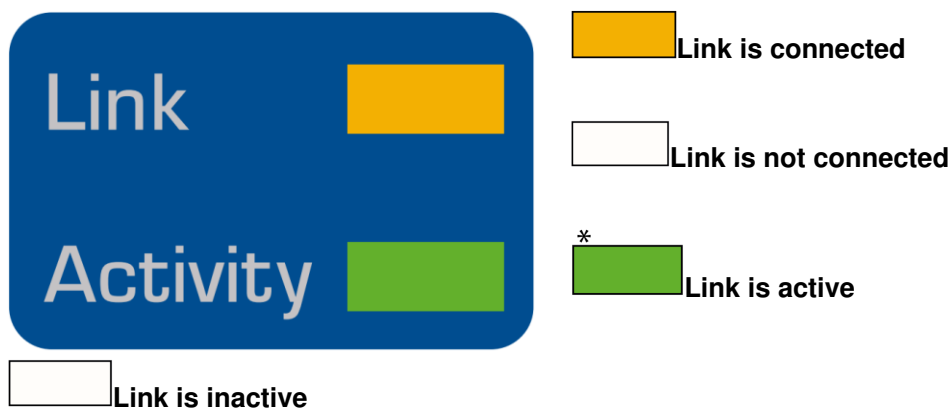

If the activity LED is blinking, link is active and receiving data.
 If the activity LED is OFF, the link is not active.



*blinking

ProPlex GBS DIN Quick Start Guide, v1.2 11 June 2021

Documents / Resources

  <p>ProPlex GBS 5-Port Ethernet Switch Quick Start Guide</p>	<p>ProPlex GBS 5-Port Ethernet Switch [pdf] User Guide GBS 5-Port Ethernet Switch, GBS, 5-Port Ethernet Switch, PPGBSPOEDIN005</p>
---	---