



# PROMISE TECHNOLOGY PegasusPro R16 System CPU User Guide

[Home](#) » [PROMISE TECHNOLOGY](#) » PROMISE TECHNOLOGY PegasusPro R16 System CPU User Guide 

## Contents

- [1 PROMISE TECHNOLOGY PegasusPro R16 System CPU](#)
- [2 OVERVIEW](#)
- [3 UNPACKING](#)
- [4 DEVICE INSTALLATION](#)
- [5 POWER ON](#)
- [6 CONNECT PRIVATE PORT](#)
- [7 CONNECT SHARE PORT](#)
- [8 PROMISE UTILITY PRO](#)
- [9 Documents / Resources](#)
  - [9.1 References](#)
- [10 Related Posts](#)

# PROMISE

## PROMISE TECHNOLOGY PegasusPro R16 System CPU



## OVERVIEW

The PegasusPro Series systems are shipped ready to use, configured with shared storage volumes on a RAID

array. The user must download and install PROMISE Utility Pro software on the computers used to mount and the Shared storage volume over the local network; or access the storage directly using a Thunderbolt™ 3 cable.

The initial setup procedure is summarized below:

Preparing to install

- Unpacking the device
- Install Drivers and Software

## **Device Installation**

1. Connecting the power and powering on
2. Power on system
3. Connecting Thunderbolt™ 3 cable
4. Connecting 10G cable(s)

## **PROMISE Utility Pro**

Launch PROMISE Utility Pro, use for host administrator setup and connection to collaborative users.

PREPARING TO INSTALL PEGASUSPRO R16

## **UNPACKING**

The PegasusPro R16 box contains the following items:

- One PegasusPro R16 enclosure
- This Quick Start Guide
- Two 1.5m (4.9 ft) Power cords
- Thunderbolt 3 / USB3.2 cable

## **INSTALL SOFTWARE AND DRIVER**

First download and install the hardware driver for the host computer, or any other computer used to connect directly to the PegasusPro R16 via Thunderbolt™ 3. Go to:

[promise.com](#) > Products > Pegasus > PegasusPro > Download > Drivers

Then download and install PROMISE Utility Pro on the host computer and collaborative user computers. Go to: [promise.com](#) > Products > Pegasus > PegasusPro > Download > Utilities

The host computer is connected to the PegasusPro R16 via the Thunderbolt™ 3 cable. This is a Direct Attached Storage (DAS) connection. Use the host computer for administration of the PegasusPro R16 and the storage network, including which users are allowed to access it.

## **DEVICE INSTALLATION**

**CONNECT POWER** PegasusPro R16 enclosures are equipped a single power supply. Insert the female end of one of the supplied power cable in to a power cable receptacle on the power supply unit, and plug the other end in to a suitable power outlet.

### **Power receptacle on rear panel**



## POWER ON

Press the Power button on the front left bracket facing.

Make sure to download and install the hardware driver for your computer before proceeding to connect the Thunderbolt™ 3 port.

### Power button on front left side



The device illustrations here are for the purpose of describing the initial installation and setup. For more complete descriptions of the hardware, please see the Product Manual.

## CONNECT PRIVATE PORT

Connect the host computer directly to the PegasusPro R16 with a Thunderbolt™ 3 cable. This Direct Attached Storage (DAS) connection is called the Private Port; it is used by one individual with access to two DAS volumes.

After connecting the Thunderbolt™ 3 cable, two DAS volumes appear on the desktop:

PegasusPro\_DAS1 and PegasusPro\_DAS2.

Later the host system can use PROMISE FileBoost to copy content from the DAS volumes to Shared folders.

### Thunderbolt™ 3 and 10G ports on rear panel



## Private Port and Share Port Connections

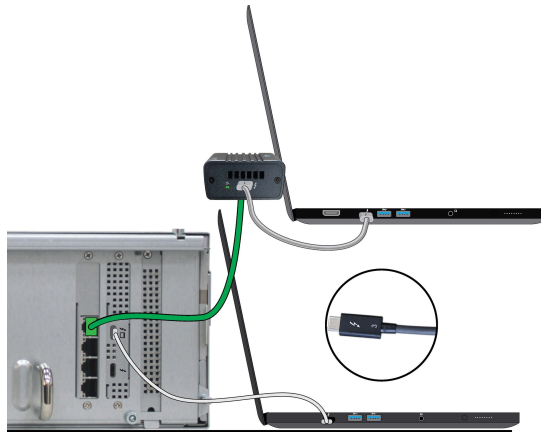

- Make sure the computer port is a
- Thunderbolt™ 3 female connection. A
- Thunderbolt™ 3 port has a Thunderbolt™
- icon next to the port.
- Thunderbolt™ 3
- port on administrator's
- computer

PegasusPro is compatible with a Thunderbolt™4 Windows PC except when it is connected behind a Thunderbolt 4 dock or Hub (Goshen Ridge-based).

**NOTE:** PROMISE SANLink3 Ethernet-to-Thunderbolt™ 3 bridge is recommended for Mac collaborative users that do not have an Ethernet port.

## CONNECT SHARE PORT

Use a suitable Ethernet cabling (Cat. 6e or better) to connect one to four of the Share Ports (10G network ports) on the rear panel. The network cables for the Share Ports can be connected to a switched Ethernet network, or connect directly to a collaborative user computer. Mac users that do not have an Ethernet port, use the SANLink3 Ethernet-to-Thunderbolt™ 3 bridge to connect to the 10G Share network.

**NOTE:** For simplicity, it is recommended to use DHCP on for all computers connected to the 10G network Share Ports.

The 10G network Share Port enables the administrator to use PROMISE Utility Pro to manage the PegasusPro device, give access permission and create new shared or private folders. Other users connecting to the Share Port use PROMISE Utility Pro to mount shared folder for collaborative work.

## PROMISE UTILITY PRO

### Host Computer

Use the host computer to launch PROMISE Utility Pro.

Log in as the PegasusPro system administrator using the default account login: User Account: admin

**Password:** admin

### Host Folders

When connected to the PegasusPro, the host will see two DAS volumes under On DAS Space, a shared Public Folder and a shared Home Folder. New folders are created by clicking on the New Folder button.

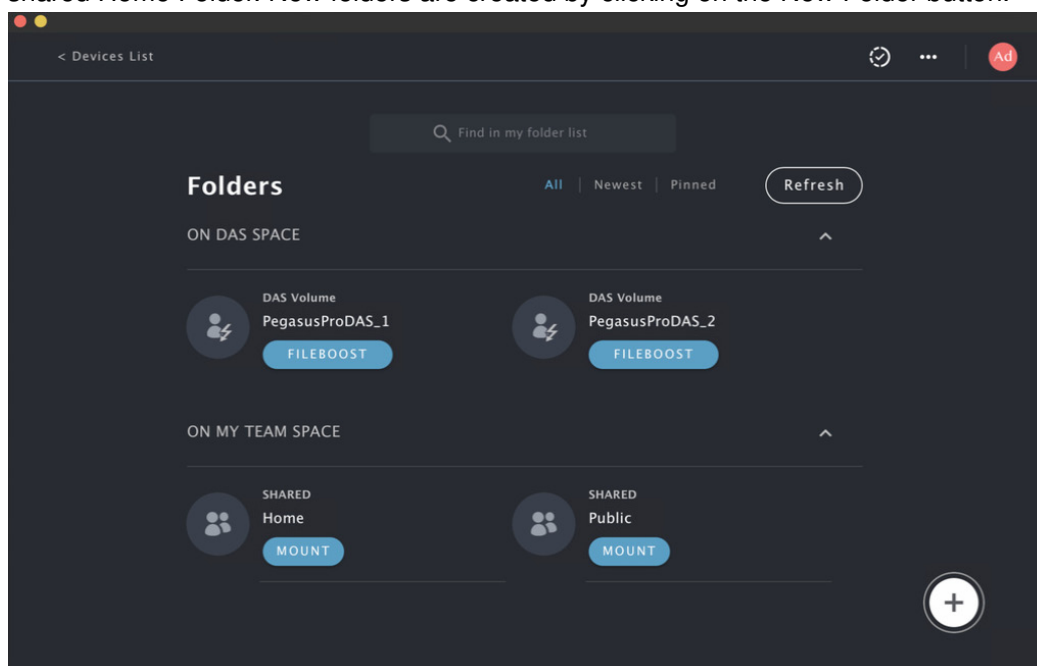

### Host Access Request

Collaborative user accounts will ask for permission to access the PegasusPro. The host account can Approve or Dismiss the request.

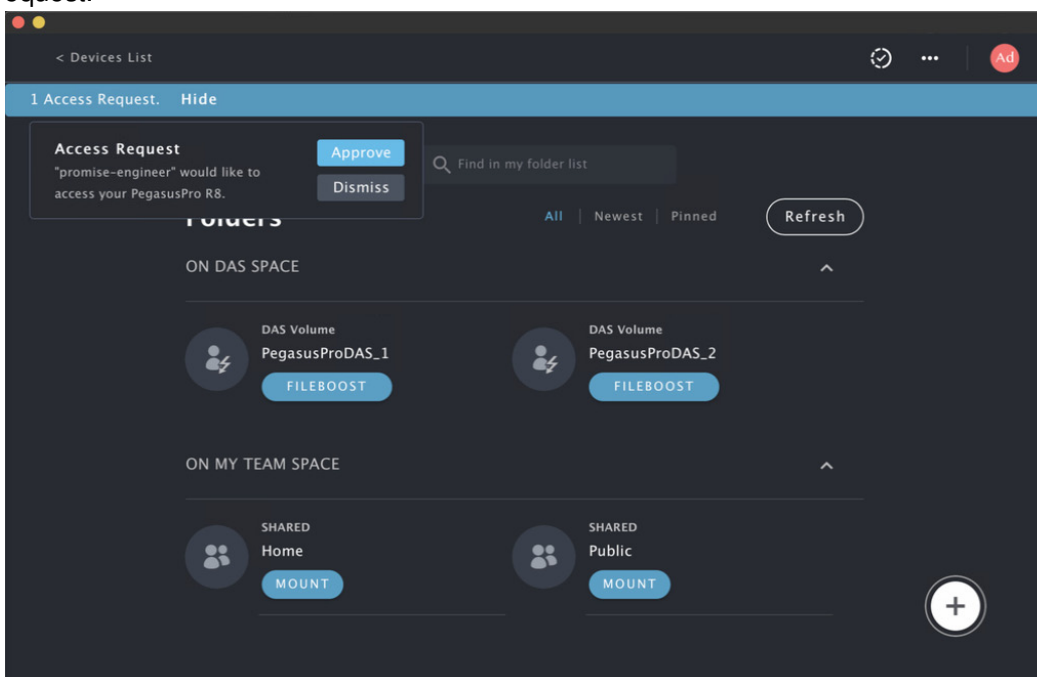

**Collaborative Users**

Launch PROMISE Utility Pro, the PegasusPro system will be located automatically. Click on Continue with Mac Device to automatically set up your user account.

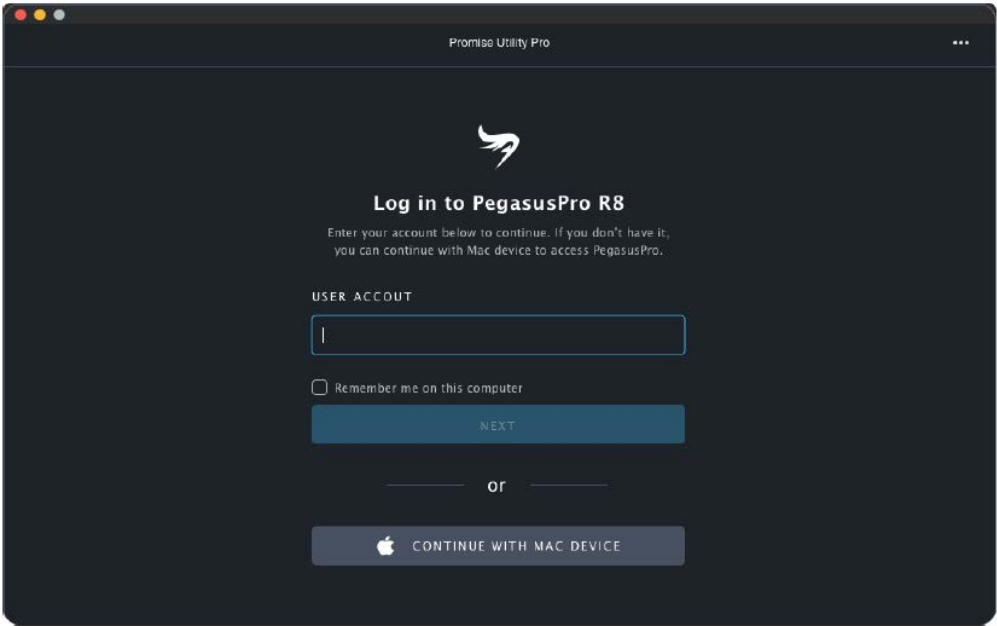

**Collaborative User folder**

An access request is sent to the host computer – once access is granted, collaborative users see the default shared folders — Public Folder, Home Folder.

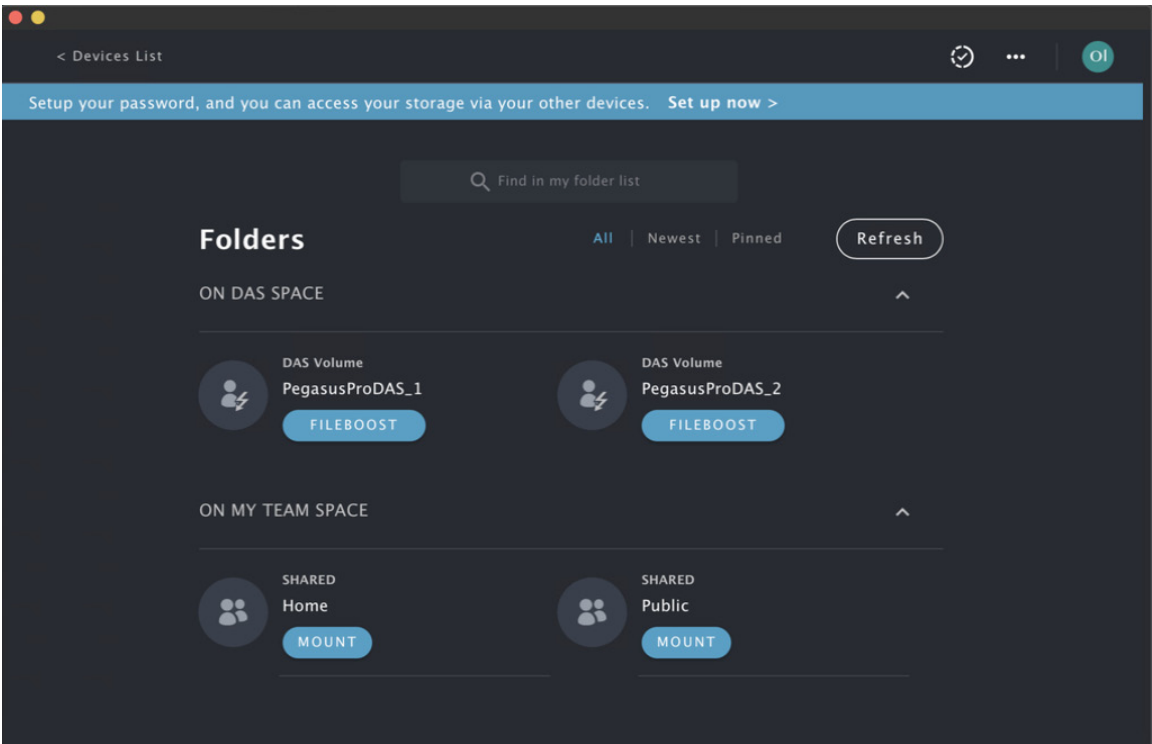

**Documents / Resources**

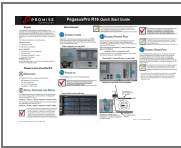

[PROMISE TECHNOLOGY PegasusPro R16 System CPU](#) [pdf] User Guide  
PegasusPro R16, System CPU, PegasusPro R16 System CPU

**References**

- [PROMISE Technology - Storage Solutions for IT, Cloud, Surveillance and Rich Media](#)

[Manuals+](#), [home](#) [privacy](#)