



[Home](#) » [PROMASTER ELECTRONIC](#) » **PROMASTER ELECTRONIC KPWCA01 Wireless Carplay and Android Auto Smart Box User Manual** 

Contents [[hide](#)]

- [1 PROMASTER ELECTRONIC KPWCA01 Wireless Carplay and Android Auto Smart Box](#)
- [2 Specifications](#)
- [3 Safety Precautions](#)
- [4 Installation](#)
- [5 Operation](#)
- [6 Preface](#)
- [7 Connection Diagram](#)
- [8 Product connection](#)
- [9 How to use wireless Android Auto](#)
- [10 Frequently Asked Questions](#)
- [11 Documents / Resources](#)
 - [11.1 References](#)



PROMASTER ELECTRONIC KPWCA01 Wireless Carplay and Android Auto Smart Box



Specifications

- Compliance: Part 15 of the FCC Rules
- Radiation Exposure: FCC limits for uncontrolled environment
- Minimum Distance: 20cm between radiator and body

Product Usage Instructions

Safety Precautions

1. Do not make any changes or modifications to the device not approved by the manufacturer.
2. Ensure the device is operated within the specified conditions to prevent harmful interference.
3. Maintain a minimum distance of 20cm between the device's radiator and your body during operation.

Installation

- Place the device on a stable surface with proper ventilation.
- Connect the necessary cables and power source as instructed in the manual.

Operation

1. Power on the device using the designated switch or button.

2. Follow the specific operation instructions provided for the intended use of the device.

Preface

This smart box is designed for iPhone/ Android smartphones to use Apple CarPlay/ Android Auto wirelessly on the factory car multimedia system, which has a built-in Apple CarPlay function. We have adapted to almost all models with CarPlay on the market, but if there are any problems while using the box, please do not hesitate to contact us.

Functions convert OEM CarPlay to CarPlay/Android.	
Auto wireless,	
Compatibility	All cars built with CarPlay and Android Auto
Contral	Touch Screen, Steering wheel, Joystick control
Input Power	USB SV
Connectivity	Wi-Fi & Btuetooth

Connection Diagram

Choose the USB or Type-C port with an interconnection function.

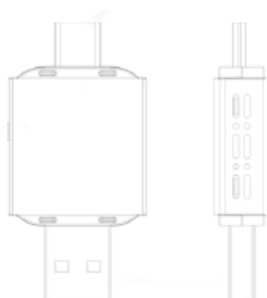

Product connection

How to use wireless CarPlay:

If the factory car supports CarPlay connection via USB cable, please plug the device into the USB port in the car. Usually, that USB port marked with CarPlay or smartphone icon, select the CarPlay function in the original car radio system, it goes to below interface:

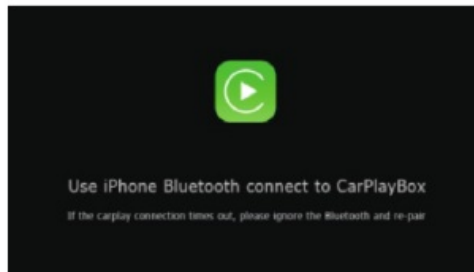

Make sure your iPhone's Bluetooth and Wi-Fi features are turned on and no other in-car devices are connected, On your iPhone, go to "Settings" > "Bluetooth", in Other Devices list, you will see a Bluetooth device name started with "Autobox-xxxx", tap to pair, allow permission and tap Use Car-play box to connect wirelessly

Version update description:

After connecting wireless CarPlay, scan this QR code with your camera or enter 192.168.2.1 in Safari to update the firmware. Note that some head units cut off the power to the USB adaptor while updating and leaving the process stuck at 1 %, if this is the case, please connect the adaptor to a USB port with contact power supply such as a computer's USB port (Don't update the device while the USB adaptor is plugged into the Car play's USB port).

Note: You need an iPhone and an open mobile data function to access the Safari browser



How to use wireless Android Auto

Before using Android Auto, please make sure you have the latest Android Auto application on your Android smartphone

- Enable "wireless Android Auto" in Android Auto settings
- Turn on the Android phone's Wi-Fi and Bluetooth, and then search Bluetooth name "Autobox-xxxx", tap to pair
- It will connect to wireless Android Auto automatically after a few seconds

- <- Android Auto

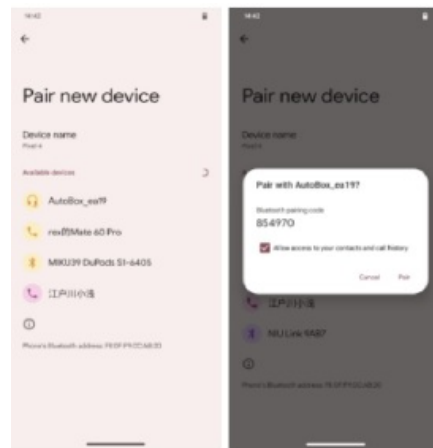

How to update the box:

Before updating the Android Auto box, please make sure you have disconnected the wireless Android Auto, and also with a stable SV power supply (USB port for the original Android Auto is not recommended)

1. Switch on the Wi-Fi in your Android smartphone, and connect the Wi-Fi Autobox-xxxx with password 88888888 (Pictures 1)
2. Wi-Fi is connected to the above hotspot (Autobox-xxxx)
3. Open the link 7 92.168.2.1 .. with Chrome browser (Pictures2)

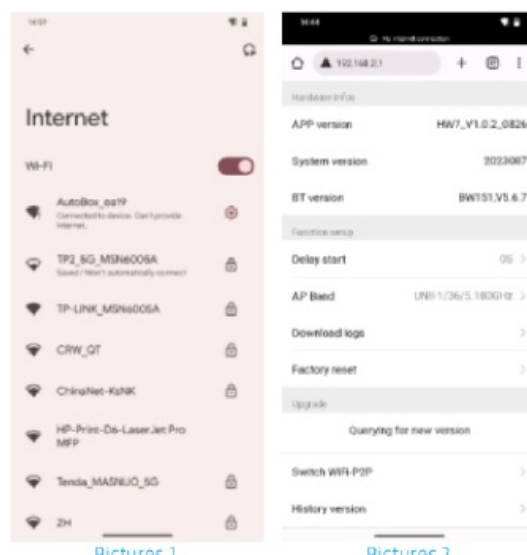

4. Choose Switch P2P, below means P2P switched (Pictures 3)
5. Go back to the smartphone's Settings, choose Wi-Fi, and find Wi-Fi Direct, then connect with Autobox-xxxx hotspot (Pictures 4)
6. Go back to the web page of 7 92.168.2.7, choose "Querying for new update, then update the box (Pictures 5)

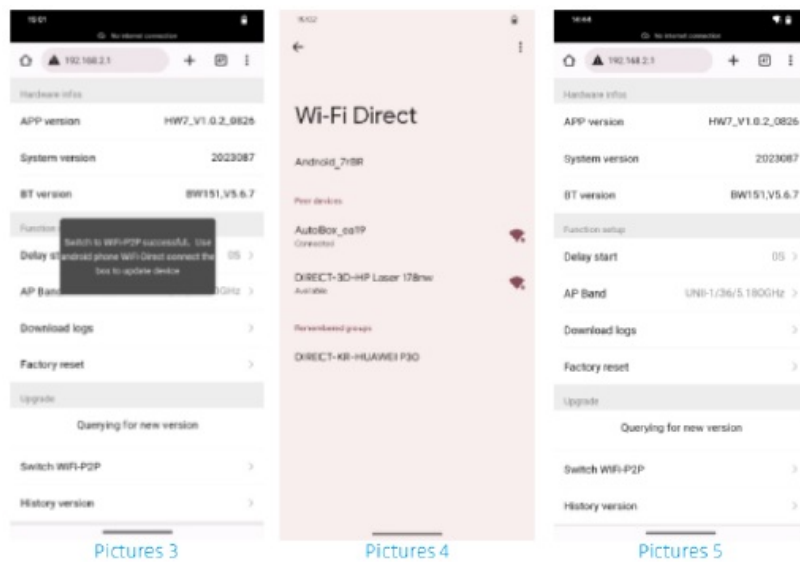

FCC Warning:

This equipment has been tested and found to comply with the limits for a Class B digital device, pursuant to part 15 of the FCC Rules. These limits are designed to provide reasonable protection against harmful interference in a residential installation. This equipment generates, uses, and can radiate radio frequency energy and, if not installed and used according to the instructions, may cause harmful interference to radio communications. However, there is no guarantee that interference will not occur in a particular installation.

If this equipment does cause harmful interference to radio or television reception, which can be determined by turning the equipment off and on, the user is encouraged to try to correct the interference by one or more of the following measures:

- Reorient or relocate the receiving antenna.
- Increase the separation between the equipment and receiver.
- Connect the equipment to an outlet on a circuit different from that to which the receiver is connected.
- Consult the dealer or an experienced radio/TV technician for help.

Caution: Any changes or modifications to this device not explicitly approved by the manufacturer could void your authority to operate this equipment.

This device complies with part 15 of the FCC Rules. Operation is subject to the following two conditions:

1. This device may not cause harmful interference, and
2. This device must accept any interference received, including interference that may cause undesired operation.

This equipment complies with FCC radiation exposure limits set forth for an uncontrolled environment. This equipment should be installed and operated with a minimum distance of 20cm between the radiator and your body.

Frequently Asked Questions

- **Q: Can I modify the device for better performance?**
A: No, any changes or modifications not approved by the manufacturer may void the warranty and affect the device’s operation.
- **Q: What should I do if I experience interference during operation?**
A: Ensure that the device is operated within the recommended conditions and check for any external sources of interference.

Documents / Resources

	<p>PROMASTER ELECTRONIC KPWCA01 Wireless Carplay and Android Auto Smart Box [pdf] User Manual</p> <p>KPWCA01, KPWCA01 Wireless Carplay and Android Auto Smart Box, Wireless Carplay and Android Auto Smart Box, Carplay and Android Auto Smart Box, Auto Smart Box, Smart Box</p>
---	---

References

- [User Manual](#)

Leave a comment

Your email address will not be published. Required fields are marked *

Comment *

Name

Email

Website

☐ Save my name, email, and website in this browser for the next time I comment.

Post Comment

Search:

e.g. whirlpool wrf535swhz

Search

[Manuals+](#) | [Upload](#) | [Deep Search](#) | [Privacy Policy](#) | [@manuals.plus](#) | [YouTube](#)

This website is an independent publication and is neither affiliated with nor endorsed by any of the trademark owners. The "Bluetooth®" word mark and logos are registered trademarks owned by Bluetooth SIG, Inc. The "Wi-Fi®" word mark and logos are registered trademarks owned by the Wi-Fi Alliance. Any use of these marks on this website does not imply any affiliation with or endorsement.