



prolink SFC Series Super Fast Charging Line Interactive User Guide

[Home](#) » [PROLiNK](#) » prolink SFC Series Super Fast Charging Line Interactive User Guide 

prolink SFC Series Super Fast Charging Line Interactive



Contents

- [1 Important Safety Warning](#)
- [2 Package Contents](#)
- [3 Overview](#)
- [4 Installation & Initial Startup](#)
- [5 Software Download & Installation](#)
- [6 Storage and Maintenance](#)
- [7 Storage and Maintenance](#)
- [8 Troubleshooting](#)
- [9 Specifications](#)
- [10 WARRANTY TERMS](#)
- [11 Worldwide Customer Care Centers](#)
- [12 Documents / Resources](#)
 - [12.1 References](#)
- [13 Related Posts](#)

Important Safety Warning

CAUTION

1. To prevent the risk of fire or electric shock, install in a temperature and humidity controlled indoor area free of conductive contaminants. (See the specifications for the acceptable temperature and humidity range.)
2. To reduce the risk of overheating the UPS, DO NOT cover the UPS' cooling vents and avoid exposing the unit to direct sunlight or installing the unit near heat emitting appliances such as space heaters or furnaces.
3. DO NOT attach non-computer-related items, such as medical equipment, life-support equipment, microwave ovens, or vacuum cleaners to UPS.
4. DO NOT plug the UPS input into its own output.
5. DO NOT allow liquids or any foreign object to enter the UPS. DO NOT place beverages or any other liquid-containing vessels on or near the unit.
6. In the event of an emergency, press the OFF button and disconnect the power cord from the AC power supply to properly disable the UPS.
7. DO NOT attach a power strip or surge suppressor to the UPS.
8. Attention hazardous through electric shock. Also with disconnection of this unit from the mains, hazardous voltage still may be accessible through supply from battery. The battery supply should be therefore disconnected in the plus and minus pole at the quick connectors of the battery when maintenance or service work inside the UPS is necessary.
9. Servicing of batteries should be performed or supervised by personnel knowledgeable of batteries and the required precautions. Keep unauthorized personnel away from batteries.
10. When replacing the batteries, use the same number and type of batteries.
11. Internal battery voltage is 12VDC. Sealed, lead-acid, 6-cell battery.
12. DO NOT dispose of batteries in a fire. The battery may explode. DO NOT open or mutilate the battery or batteries. Released electrolyte is harmful to the skin and eyes.
13. Unplug the UPS prior to cleaning and DO NOT use liquid or spray detergent.
14. A battery can present a risk of electric shock and high short circuit current. The following precaution should be observed before replacing batteries:
 1. Remove watches, rings, or other metal objects.

2. Use tools with insulated handles.
3. Wear rubber gloves and boots.
4. Do not lay tools or metal parts on top of batteries.
5. Disconnect charging source prior to connecting or disconnecting batteries terminal.

WARNING

1. DO NOT modify the UPS input cable.
2. Consult your dealer if the UPS input cable connector does not match the utility receptacle.
3. The UPS must be grounded while in use. Operate the UPS only from a properly grounded AC outlet (2 wire plus ground).
4. Turn off the UPS before unplugging it from the AC outlet.

Package Contents

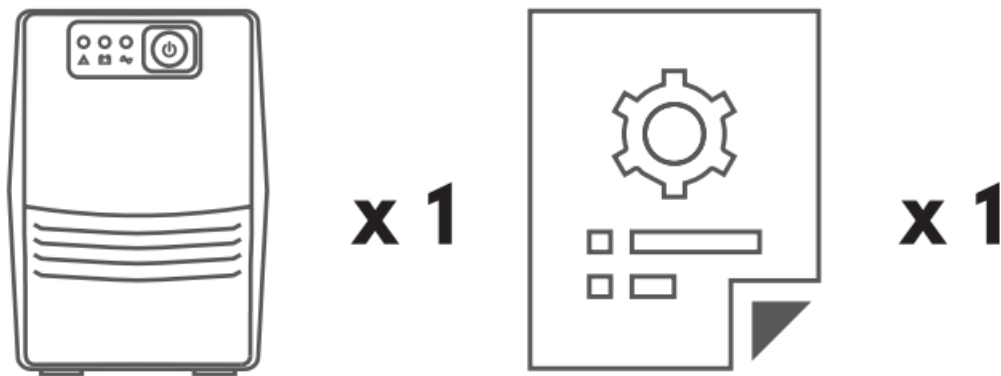

Note:

1. The illustrations in this document may appear different from your model.
2. If any of above item is not packed in your package when open, please consult your seller immediately.

Overview

INSPIRE 703SFC

Legend

1. Power Switch
2. Fault Indicator: Red LED Lighting
3. Battery Mode Indicator: Yellow LED Flashing
4. AC Mode Indicator: Green LED Lighting
5. Power AC Input
6. Backup Outlets

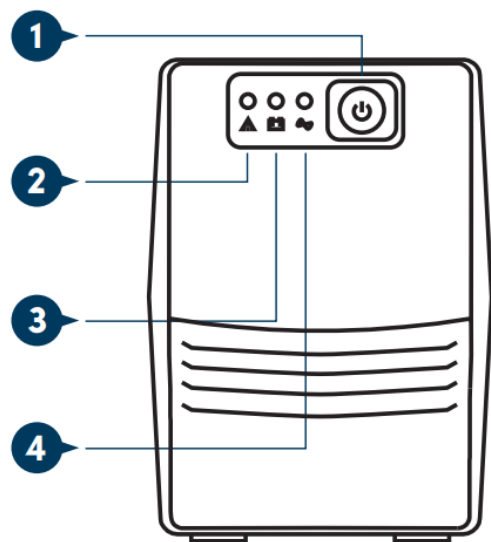

Front View

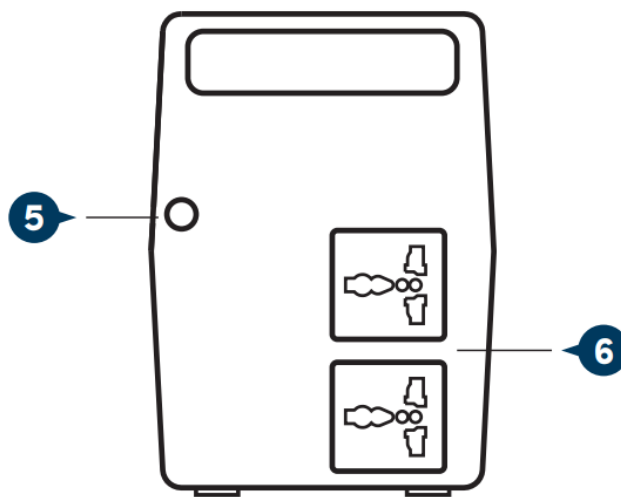

Rear View

INSPIRE 853SFCU

Legend

1. Power Switch
2. Fault Indicator: Red LED Lighting
3. Battery Mode Indicator: Yellow LED Flashing
4. AC Mode Indicator: Green LED Lighting
5. USB Port
6. Power AC Input
7. RJ11 Ports (In & Out)
8. Backup Outlets

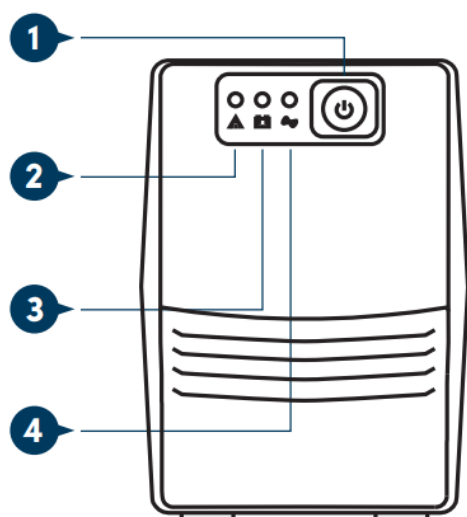

Front View

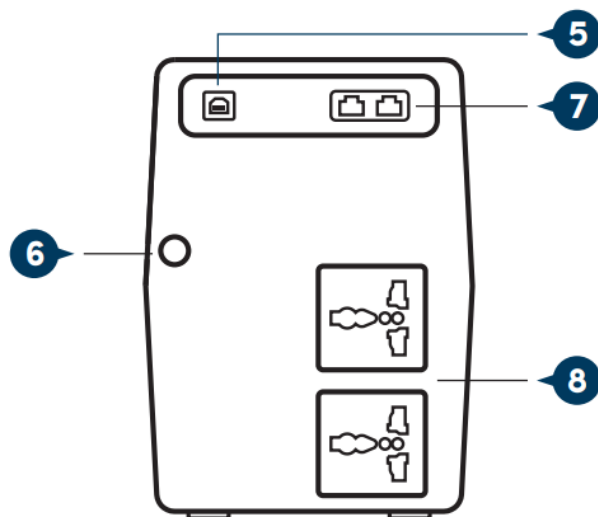

Rear View

INSPIRE 1203SFCU

Legend

1. Power Switch
2. Fault Indicator: Red LED Lighting
3. Battery Mode Indicator: Yellow LED Flashing
4. AC Mode Indicator: Green LED Lighting
5. Power AC Input
6. USB Port
7. RJ45 Ports (In & Out)
8. Backup Outlets

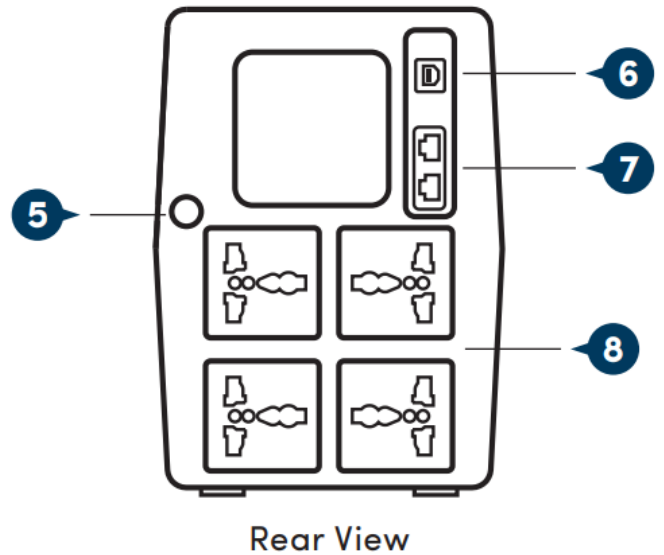
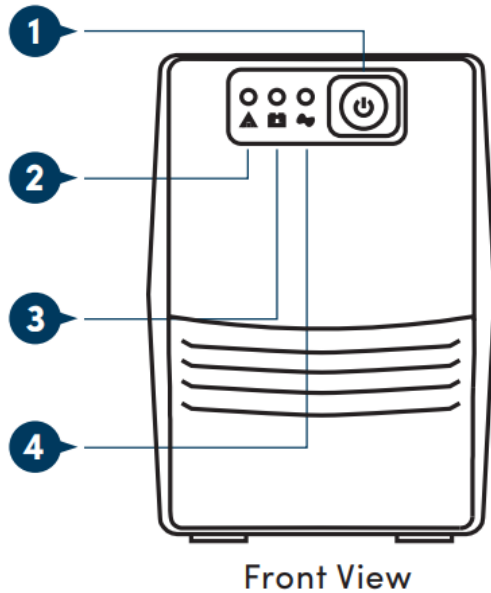

INSPIRE 1253SFCU

Legend

1. Power Switch
2. Fault Indicator: Red LED Lighting
3. Battery Mode Indicator: Yellow LED Flashing
4. AC Mode Indicator: Green LED Lighting
5. Power AC Input
6. USB Port
7. RJ45 Ports (In & Out)
8. Backup Outlets

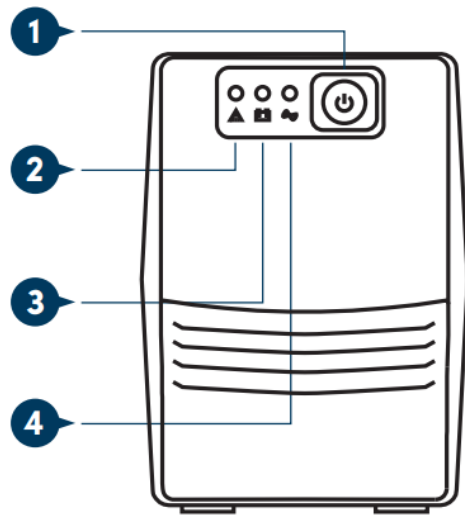

Front View

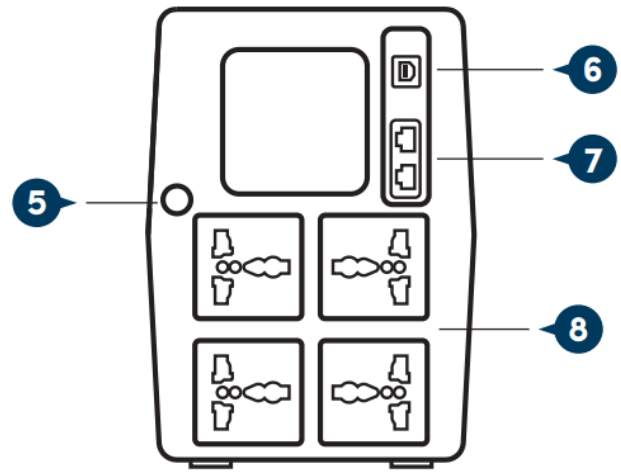

Rear View

INSPIRE 1503SFCU

Legend

1. Power Switch
2. Fault Indicator: Red LED Lighting
3. Battery Mode Indicator: Yellow LED Flashing
4. AC Mode Indicator: Green LED Lighting
5. Fan
6. Power AC Input
7. USB Port
8. RJ45 Ports (In & Out)
9. Backup Outlets

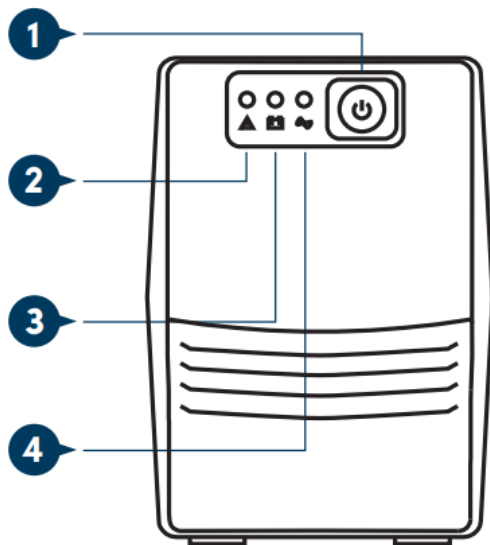

Front View

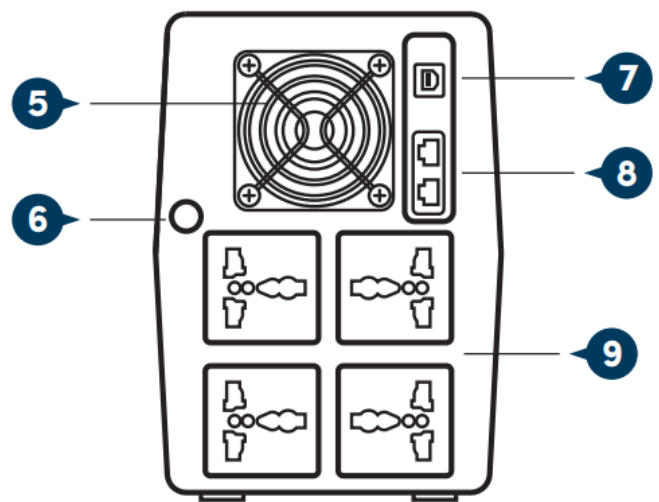

Rear View

INSPIRE 2003SFCU

Legend

1. Power Switch
2. Fault Indicator: Red LED Lighting
3. Battery Mode Indicator: Yellow LED Flashing
4. AC Mode Indicator: Green LED Lighting
5. Fan
6. Power AC Input
7. USB Port
8. RJ45 Ports (In & Out)
9. Backup Outlets

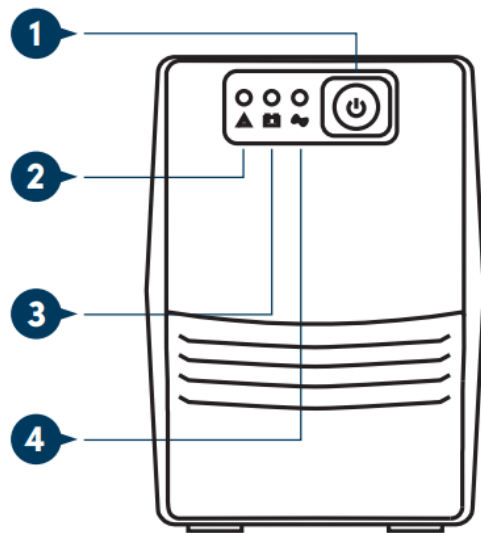

Front View

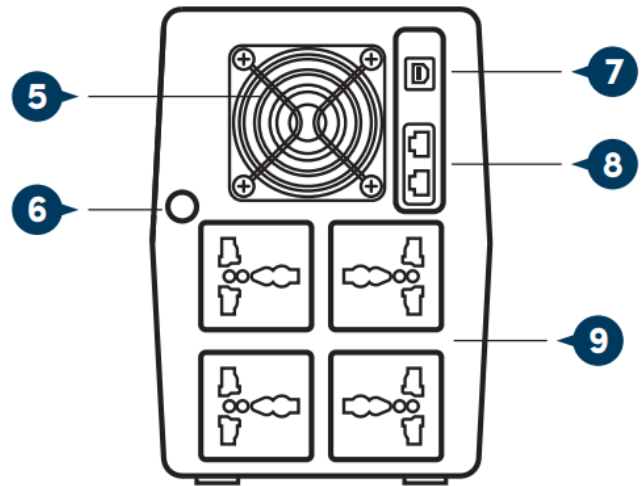

Rear View

INSPIRE 3003SFCU

Legend

1. AC Mode: Indicating load level Battery Mode: Indicating battery capacity
2. Fault Indicator: Red LED Lighting
3. AC Mode Indicator: Green LED Lighting Battery Mode Indicator: Green LED Flasing
4. Power switch
5. Modem/Phone/ Network surge protection
6. Circuit breaker
7. AC input
8. USB port
9. Backup Outlets

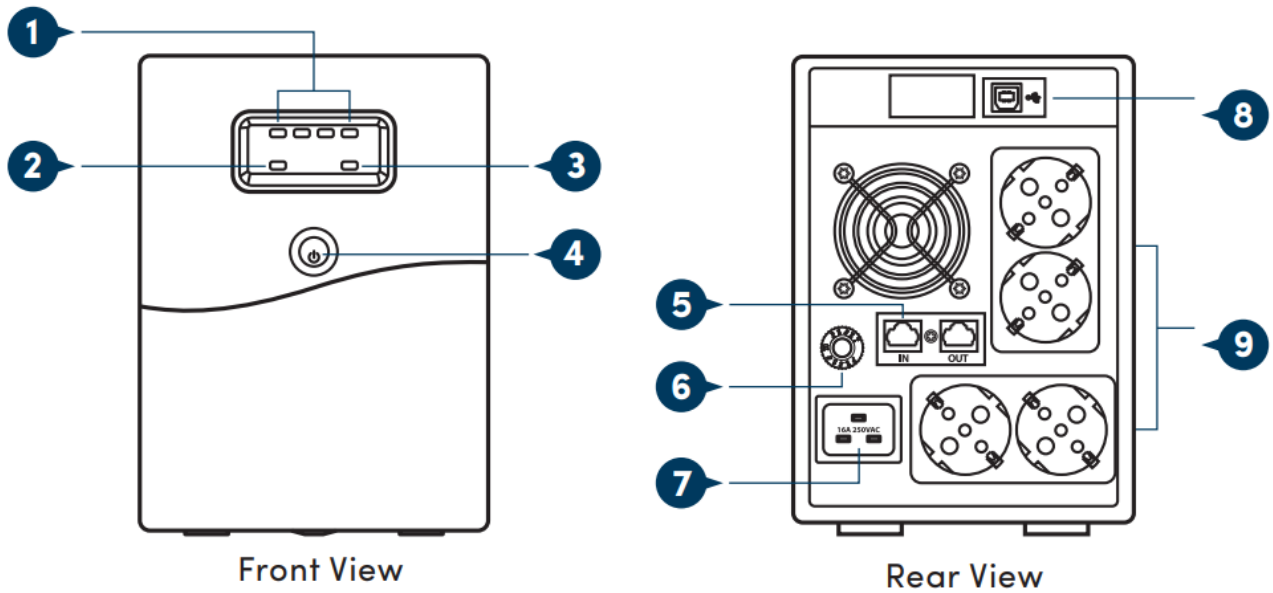

Installation & Initial Startup

Note

Before installation, please inspect the unit. Be sure that nothing inside the package is damaged.



Connect to Utility and Charging

Connect the AC Input Cord from the wall outlet to the UPS. For the best result, suggest to charge the battery at least 6 hours before initial use. The unit charges its battery while connecting to the utility.



Placement & Storage Conditions

Install the UPS in a protected area that is free of excessive dust and has adequate air flow. Please place the UPS away from other units at least 20cm to avoid interference. DO NOT operate the UPS where the temperature and humidity is outside the specific limits. (Please check the specs for the limitations).

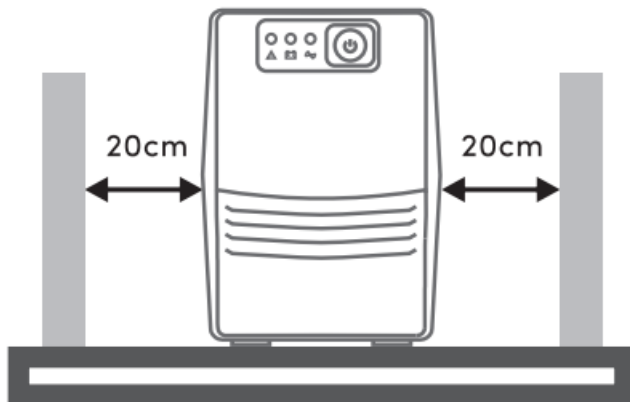

Connect the Loads

Plug in the loads to output receptacles on the rear panel of the UPS. Simply turn on the power switch of UPS unit, and then devices connected to the UPS will be protected by UPS unit.



CAUTION

NEVER connect a laser printer or scanner to the UPS unit. This may cause the damage of the unit.

Data Line Surge Protection (Only for the model with RJ11/RJ45)

Connect a single network/telephone/fax line into surge-protected "IN" outlet on the back panel of the UPS unit. Connect from "OUT" outlet with another network/telephone/fax line cable.

Connect Communication Cable (Only for the model with USB port)

To allow for unattended UPS shutdown/start-up and status monitoring, connect the communication cable one end to the USB port and the other to the communication port of your PC. With the monitoring software installed, you can schedule UPS shutdown/start-up and monitor UPS status through PC.

Turn On/Off the Unit

Turn on the UPS unit by pressing the power switch. Turn off the UPS unit by pressing again the power switch.

Software Download & Installation

Note

Only for model with USB port.

Please follow steps below to download and install monitoring software:

1. Go to the website <http://www.power-software-download.com>
2. Click ViewPower software icon and then choose your required OS to download the software.
3. Follow the on-screen instruction to install the software.
4. When your computer restarts, the monitoring software will appear as orange plug icon located in the system tray, near the clock.
5. For UPS with HID-compliant USB Port (optional), you may safely shutdown the UPS during power failure simply by connecting to a computer with pre-installed Windows/ Linux/ Mac OS through the USB port even without monitoring software.

Storage and Maintenance

Storage

Before storing, charge the UPS at least 6~8 hours. Store the UPS covered and upright in a cool, dry location. During storage, recharge the battery in accordance with the following table:

STORAGE TEMPERATURE	RECHARGE FREQUENCY	CHARGING DURATION
-25°C – 40°C	Every 3 months	1-2 hours
40°C – 40°C	Every 2 months	1-2 hours



The UPS system operates with hazardous voltages. Repairs may be carried out only by qualified maintenance personnel.



Even after the unit is disconnected from the mains, components inside the UPS system are still connected to the battery packs which are potentially dangerous.



Only persons are adequately familiar with batteries and with the required precautionary measures may replace batteries and supervise operations. Unauthorized persons must be kept well away from the batteries.



Batteries may cause electric shock and have a high short-circuit current. Please remove all wristwatches, rings and other metal personal objects before maintenance or repair, and only use tools with insulated grips and handles for maintaining or repairing.

Storage and Maintenance



When replace the batteries, install the same number and same type of batteries.



Do not attempt to dispose of batteries by burning them. This could cause battery explosion. The batteries must be rightly deposited according to local regulation.



Do not open or destroy batteries. Escaping electrolyte can cause injury to the skin and eyes. It may be toxic.



Do not disassemble the UPS system.

Troubleshooting

Use the table below to solve minor problems.

PROBLEM	POSSIBLE CAUSE	SOLUTIONS
No LED display on the front panel	Low battery	Charge the UPS at least 6 hours
	Battery fault	Replace the battery with the same type of battery
	The UPS is not turned on	Press the power switch again to turn on the UPS
Alarm continuously sounds when the main is normal	The UPS is overload	Remove some loads first. Before reconnecting equipment, please verify that the load matches the UPS capability specified in the specs.
When power fails, back-up time is shortening	The UPS is overload	Remove some critical load
	Battery voltage is too low	Charge the UPS at least 6 hours
	Battery defect. It might be due to high temperature operation environment or improper operation to battery	Replace the battery with the same type of battery
The main is normal but LED is flashing	Power cord is loose	Reconnect the power cord properly

Specifications

MODEL	INSPIRE 703SFC	INSPIRE 853SFCU
Capacity	650 VA	850 VA

INPUT

Voltage Range	140 – 300VAC $\pm 5\%$ for 230VAC mode 140 – 290VAC $\pm 5\%$ for 220VAC mode
Frequency	50Hz/60Hz (Auto-sensing)
Phase	Single + GND

OUTPUT

Voltage Range	220VAC/230VAC + 12%-14%
Battery Mode	220VAC/230VAC $\pm 10\%$
Frequency	50Hz $\pm 1\%$ (Battery Mode); 60Hz $\pm 1\%$ (Battery Mode)
Waveform	Simulated Sine Wave (Battery Mode), Sine Wave (AC Mode)
Transfer Time	2ms typical

BATTERY

Type & Number	12 V/ 7 AH x 1	12 V/ 9 AH x 1
Backup Time	8 – 30 mins depending on the load	
Charging Time	2 – 4 hours recover to 90% capacity	

PROTECTION/MONITORING

Short Circuit Protection	Yes (Line Mode and Battery Mode)	
Surge Protection	Yes	
Alarm	Audible & Visual	
UPS Protection	Load Auto Sensing and Abnormal Protection	
Overload Protection	Line Mode – 100 – 120% 5mins change to fault mode >120% change to fault mode immediately Battery Mode – 100 – 120% 5 secs shutdown >120% shutdown immediately	
Intelligent Battery	Prevent overcharging of battery	
Management	Protect battery and prolong battery life	
Data Line Surge Protection	–	RJ11

SOFTWARE MONITORING

USB Connector #1	AC Fault, Battery Low, Shutdown UPS
Software #1	Support Windows® 7/ 8/ 10, Linux and Mac

GENERAL

Noise Level	< 40dB	
Temperature	0°C – 40°C	
Humidity	0 – 90%	
Built in AVR	TRUE Full AVR (3steps)	
Dimension D x W x H	279 x 101 x 142mm	
Weight (kg)	4.2	4.9

MODEL	INSPIRE 1203SFCU	INSPIRE 1253SFCU
Capacity	1200 VA	1250 VA

INPUT

Voltage Range	140 – 300VAC $\pm 5\%$ for 230VAC mode 140 – 290VAC $\pm 5\%$ for 220VAC mode
Frequency	50Hz/60Hz (Auto-sensing)
Phase	Single + GND

OUTPUT

Voltage Range	220VAC/230VAC + 12%-14%	230VAC + 12%-14%
Battery Mode	220VAC/230VAC $\pm 10\%$	230VAC $\pm 10\%$
Frequency	50Hz $\pm 1\%$ (Battery Mode); 60Hz $\pm 1\%$ (Battery Mode)	
Waveform	Simulated Sine Wave (Battery Mode), Sine Wave (AC Mode)	
Transfer Time	2ms typical	

BATTERY

Type & Number	12 V/ 7 AH x 2
Backup Time	8 – 30 mins depending on the load
Charging Time	2 – 4 hours recover to 90% capacity

PROTECTION/MONITORING

Short Circuit Protection	Yes (Line Mode and Battery Mode)
Surge Protection	Yes
Alarm	Audible & Visual
UPS Protection	Load Auto Sensing and Abnormal Protection
Overload Protection	Line Mode – 100 – 120% 5mins change to fault mode >120% change to fault mode immediately Battery Mode – 100 – 120% 5 secs shutdown >120% shutdown immediately
Intelligent Battery	Prevent overcharging of battery
Management	Protect battery and prolong battery life
Data Line Surge Protection	RJ45

SOFTWARE MONITORING

USB Connector	AC Fault, Battery Low, Shutdown UPS
Software	Support Windows® 7/ 8/ 10, Linux and Mac

GENERAL

Noise Level	< 40dB	
Temperature	0°C – 40°C	
Humidity	0 – 90%	
Built in AVR	TRUE Full AVR (3steps)	
Dimension D x W x H	320 x 130 x 182mm	
Weight (kg)	8.2	9.2

MODEL	INSPIRE 1503SFCU	INSPIRE 2003SFCU	INSPIRE 3003SFCU
Capacity	1500 VA	2000 VA	3000 VA

INPUT

Voltage Range	140 – 300VAC ±5% for 230VAC mode 140 – 290V AC ±5% for 220VAC mode	162 – 300VAC ±5% for 220/230/240VAC mode
Frequency	50Hz/60Hz (Auto-sensing)	60Hz/50Hz (Auto-sensing)
Phase	Single + GND	Single + GND

OUTPUT

Voltage Range	220VAC/230VAC + 12%-14%	220VAC/230/240VAC ±15%
Battery Mode	220VAC/230VAC ±10%	220VAC/230/240VAC ±10%
Frequency	50Hz ± 1% (Battery Mode); 60Hz ± 1% (Battery Mode)	
Waveform	Simulated Sine Wave (Battery Mode), Sine Wave (AC Mode)	
Transfer Time	2ms typical	2 – 6ms typical

BATTERY

Type & Number	12 V/ 9 AH x 2	
Backup Time	Up to 40 mins depending on the load	
Charging Time	2 – 4 hours recover to 90% capacity	4 – 6 hours recover to 90% capacity

PROTECTION/MONITORING

Short Circuit Protection	Yes (Line Mode and Battery Mode)
Surge Protection	Yes
Alarm	Audible & Visual
UPS Protection	Load Auto Sensing and Abnormal Protection
Overload Protection	Line Mode – 100 – 120% 5mins change to fault mode >120% change to fault mode immediately Battery Mode – 100 – 120% 5 secs shutdown >120% shutdown immediately
Intelligent Battery	Prevent overcharging of battery
Management	Protect battery and prolong battery life
Data Line Surge Protection	RJ45

SOFTWARE MONITORING

USB Connector	AC Fault, Battery Low, Shutdown UPS
Software	Support Windows® 7/ 8/ 10, Linux and Mac

GENERAL

Noise Level	< 40dB		< 45dB	
Temperature	0°C – 40°C			
Humidity	0 – 90%			
Built in AVR	TRUE Full AVR (3steps)			
Dimension D x W x H	320 x 130 x 182		397 x 146 x 205	
Weight (kg)	10.4	10.6		14

WARRANTY TERMS

We thank you for your trust in choosing this product us and as a Distributor in Indonesia, we provide a service guarantee Repair and Replacement of UPS Parts and Batteries with the following provisions:

1. Improvement hope is given for 24 (twenty four) months starting from the date of purchase against the following damages replacement of spare parts, except batteries, only 12 (twelve) months.
2. Shipping costs and damage that may occur during transit is the responsibility of the owner of the goods.
3. Warranty is VOID or VOID:
 - The item has been unsealed or repaired by the owner / third party.
 - The goods are damaged due to transportation, falls or errors caused by the user.
 - The item was damaged due to fire, lightning strike or disaster natural.
 - The serial number has been changed or removed and does not match item to be repaired.
 - The Guarantee Card does not have the seller's signature or stamp.
 - The Warranty Card does not match the actual item or There are scribbles and deletions on the Warranty Card.
4. Show this Guarantee card when the goods are to be serviced.
5. For information regarding storage and maintenance, please see instructions in the manual.

Register online for your product guarantee at www.prolink2u.com

*Shipping costs are borne by the buyer

LIST OF AFTER SALES SERVICES:

1. PT. INTIDATA NUSANTARA PROLINK | JL. WEST CIDENG NO. 79, CENTRAL JAKARTA 10150 | Tel: 021-34831777
2. AT COMPUTER | SULTAN ADAM COMPANY SHOP PERMAI, NO. 13 BANJARMASIN | Tel: 0511-7404486
3. PT. GREATER EAST PROSHOP | JL. RAYA MANYAR 69E SURABAYA RT.004 RW.010, MENUK PUMPUNGAN SUKOLILO SURABAYA JAVA EAST 60286 | Tel: 031-59173511

4. PT. ANDARU PRIMA HARSA | JL BRIGJEN KATAMSO NO 75-77 RT 044 RW 013, PRAWIRODIRJAN GONDOMANAN YOGYAKARTA 55655 | Tel: 0274-420277
5. DELTACOM | JL. GREAT MOSQUE NO.90K MAKASSAR | Tel: 0411-442806
6. PT. ARTHANAYA TECHNOLOGY | JL TEUKU UMAR NO 200 AGUNG RAYA SHOPPING COMPLEX NO 12, DAUH PURI KAUH – WEST DENPASAR- DENPASAR-BALI 80113 | Tel: 0361-2096382
7. METRO COMPUTER | JL. ELEPHANT MADA NO.87 | Tel: 0561-741610
8. PT. DWIWIRA PUTRADYNAMICS | JL. LOYAL BUDDHIST NO. 107A, NEW WEEK | Tel: 0761-36486
9. PT. SQUARE GORONTALO | JL. S. PARMAN NO.38 BIAWAO, SOUTH CITY CITY GORONTALO | Tel: 082188007111
10. PT. CORE SANHO MAIN TECHNOLOGY | JL. WHEELING NO. 48 MEDAN | Tel: 061-7330800

Stick it stamps here.

Dear.
Customer Service
PT. INTIDATA NUSANTARA PROLINK
Jl. West Cideng No. 79
Central Jakarta 10150 – Indonesia

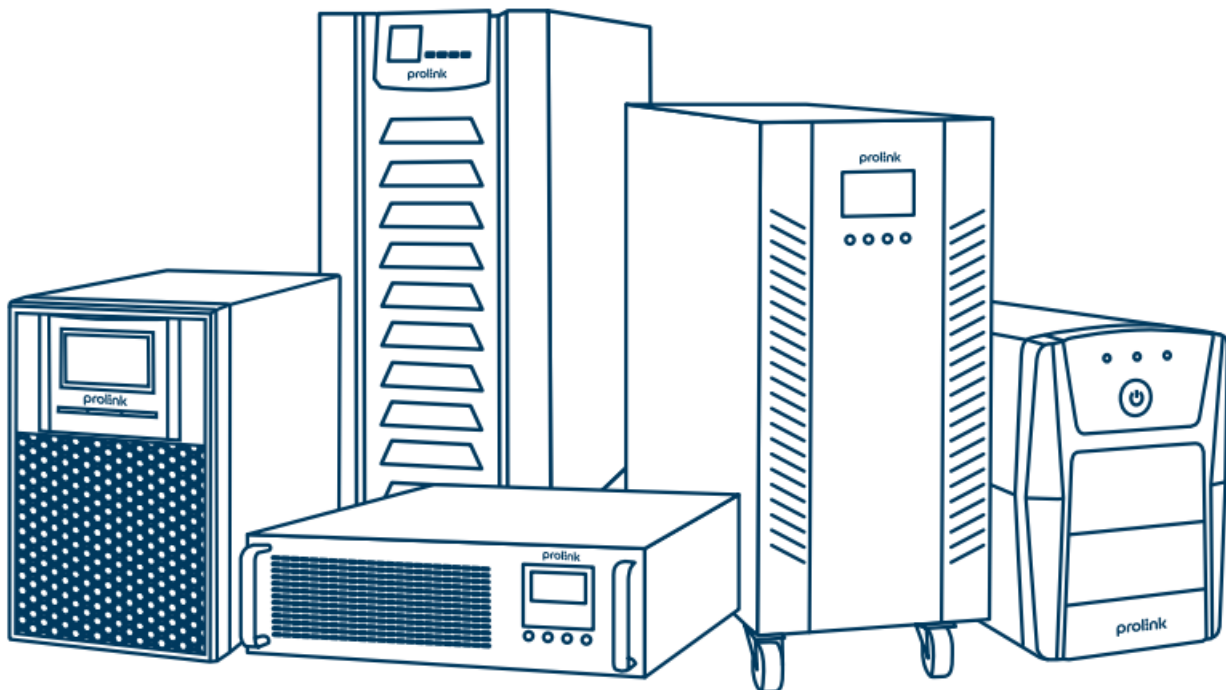

Worldwide Customer Care Centers

INDONESIA Office

PT PROLINK INTIDATA NUSANTARA
Walk-In : Jl. Cideng Barat No. 79, Jakarta Pusat 10150, Indonesia.
Telephone : +62 21 3483 1777
Sale Enquiries : sales.id@prolink2u.com
Technical Support : support.id@prolink2u.com

MALAYSIA Office

FIDA SYSTEMS (M) SDN BHD
Walk-In : 29 Jalan USJ 1/31, 47600 Subang Jaya, Selangor Darul Ehsan, Malaysia.
Telephone : +60 3 8024 9151
Sale Enquiries : sales.my@prolink2u.com
Technical Support : support.my@prolink2u.com

SINGAPORE Office

FIDA INTERNATIONAL (S) PTE LTD
Walk-In : Block 16 Kallang Place #06-02, Kallang Basin Industrial Estate, Singapore 339156.
Telephone : +65 6357 0668
Sale Enquiries : sales@prolink2u.com
Technical Support : support@prolink2u.com

Technical Support Hotline

INDONESIA : +62 21 3483 1717
MALAYSIA : +60 3 8023 9151
SINGAPORE : +65 6357 0666

Note: Closed on Saturdays, Sundays and local/regional Public Holidays.

Register online for your Product Warranty at www.prolink2u.com

Prolink is a registered trademark of Fida International (S) Pte Ltd. Other brands and product names are trademarks or registered trademarks of their respective holders. Product images are purely for illustrative purposes and may defer from the actual product. Specifications are subjected to changes without prior notice.
Copyright © 2023 Fida International (S) Pte Ltd.

Kartu Garansi harus diisi lengkap, kirimkan paling lambat 14 hari setelah Tgl. Pembelian

Tanda pendaftaran No:

Alamat Pengiriman PT. PROLINK INTIDATA NUSANTARA
Address Jl. Cideng Barat No. 79 Jakarta Pusat 10150 – Indonesia

Telp. : (62-21) 34831777
Fax : (62-21) 34830788
Email : support.id@prolink2u.com



