

**PROLiNe**  
**VCBLMUL**  
**TIC2 Slide**  
**Vacuum**



## PROLiNe VCBLMULTIC2 Slide Vacuum Instruction Manual

[Home](#) » [PROLiNe](#) » PROLiNe VCBLMULTIC2 Slide Vacuum Instruction Manual 

### Contents

- [1 PROLiNe VCBLMULTIC2 Slide Vacuum](#)
- [2 Product Description](#)
- [3 IMPORTANT SAFETY INSTRUCTIONS](#)
- [4 SAFETY INFORMATION](#)
- [5 PRODUCT OVERVIEW](#)
- [6 ASSEMBLY](#)
- [7 OPERATION](#)
- [8 CLEANING AND MAINTENANCE](#)
- [9 SPECIFICATIONS](#)
- [10 Documents / Resources](#)
  - [10.1 References](#)
- [11 Related Posts](#)

**PROLiNe**

**PROLiNe VCBLMULTIC2 Slide Vacuum**



## Product Description

The product includes a hose, floor brush, handle, air outlet filter grille, and suction mouth.

## Assembly

**Connecting the Hose:** Insert the hose handle into one end of the tube.

**Assembling Tubes and Accessories:** Attach the desired cleaning accessory to the end of the tube. To remove tubes and accessories, firmly grip each part and pull apart.

## Operation

**Using Cleaning Accessories:** Position 1: Brushes out for hard floors.

To reduce suction power quickly, adjust the airflow regulator.  
Use the cleaning accessories to reach difficult areas.

## Cleaning and Maintenance

To clean, open the dustbin.

## Disposal

Follow proper disposal guidelines for this product.

## FAQ

**Q: How do I clean the filter?**

**A:** To clean the filter, follow the instructions provided in the manual. Typically, you can remove the filter and clean it with water or replace it if necessary.

## IMPORTANT SAFETY INSTRUCTIONS

PLEASE READ THE FOLLOWING SAFETY WARNINGS AND THE INSTRUCTIONS CAREFULLY BEFORE USING THE APPLIANCE AND KEEP FOR FUTURE REFERENCE.

## **WARNINGS**

- This appliance is intended for domestic household use only and should not be used for any other purpose or in any other application, such as for non-domestic use or in a commercial environment.
- If the supply cord is damaged, it must be replaced by the manufacturer, its service agent or similarly qualified persons in order to avoid a hazard.
- Regarding the detailed instructions for the method and frequency of cleaning and the precautions during user maintenance, refer to the section "CLEANING AND MAINTENANCE" on pages 66-69 of the manual.
- This appliance can be used by children aged from 8 years and above and persons with reduced physical, sensory or mental capabilities or lack of experience and knowledge if they have been given supervision or instruction concerning use of the appliance in a safe way and understand the hazards involved. Children shall not play with the appliance.

Cleaning and user maintenance shall not be made by children without supervision.

- The plug must be removed from the socket-outlet before cleaning or maintaining the appliance.
- Following objects are strictly banned, otherwise the vacuum cleaner will be damaged or fire calamity will be caused, which bring such accidents as human body injuries:
  - Don't pick up large or sharp broken objects such as glasses.
  - Don't pick up harming or erodent liquids (solvent, corrosive, detergent...).
  - Don't pick up inflammable or explosive substance such as gasoline or alcohol.
  - Don't pick up/ vacuum burning or glowing objects (cigarettes, matches, hot ashes).
- Regarding the detailed instructions for the safe use of the appliance, refer to the section "OPERATION".

## **SAFETY INFORMATION**

- Always turn off and unplug the appliance from the mains socket if it is left unattended and before assembling, disassembling or cleaning.
- Do not unplug by pulling on the power cord. To unplug, grasp the plug not the power cord.
- Do not use the appliance with wet hands or feet.
- Never operate the vacuum cleaner without filters in place.
- Do not use the appliance outdoors or on wet surfaces.
- Do not pull or carry the appliance by the power cord.
- The appliance should only be used for its intended purpose as described in this instruction manual.
- Do not use the appliance to suck up water or any other liquid.
- To prevent electrical shock, do not immerse the appliance, power cord or power plug into water or other liquids.
- Use only original accessories approved by the manufacturer.
- The hose must be checked regularly and must not be used if damaged.
- Do not operate the vacuum cleaner too close to the heaters, radiators and other hot surfaces.
- Do not leave the appliance unattended when it is in operation.

## **PRODUCT OVERVIEW**

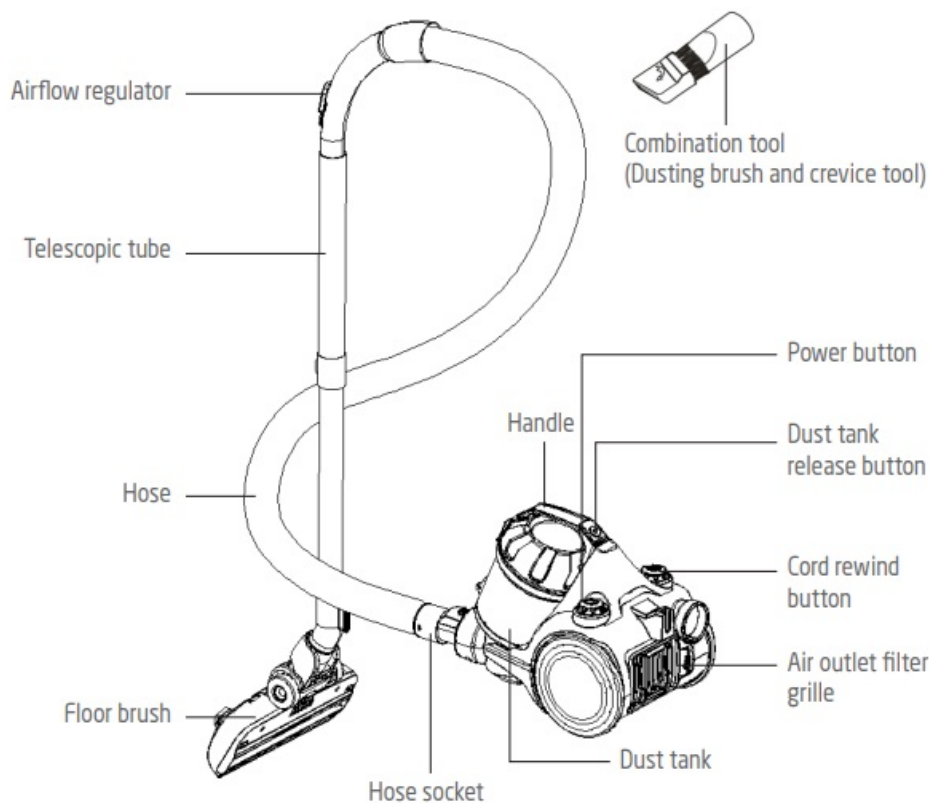

## ASSEMBLY

Always disconnect the appliance from the mains socket before assembling or disassembling accessories.

### Connecting the hose

- To fit the hose, push it firmly into the hose socket on the front of the appliance until the hose clicks into place.



- To remove the hose, press the release button on the hose end and pull the hose out of the appliance.

### Connecting tubes and accessories

1. Insert the hose handle into one end of tubes.
2. Adjust the tubes to your desired length.
  - Push forward the switch on the tube then adjust. Release the switch until the desired length is achieved.
3. Attach the desired cleaning accessory to the end of the tube.



To remove the tubes and accessories, hold each piece tightly and pull firmly apart.

## OPERATION

1. Pull the power cord out of the appliance and insert the mains plug into the mains socket.
  - A YELLOW mark on the power cord indicates the ideal cable length. Do not extend the power cord beyond the RED mark.
2. Press the power button on top of the appliance to switch on the appliance.
3. You can quickly reduce the suction power by pushing the airflow regulator on the hose handle.
  - Push it forward, suction power will increase; push it backward, suction power will reduce.



## Using the Cleaning Accessories

- Dual position carpet / floor brush

**Position 1:** Bristles extended For hard floors



**Position 2:** Bristles retracted For carpets

- Combination tool (dusting brush and crevice tool)

This combination tool is a dual-purpose tool.

To clean hard to reach corners, keep the nozzle folded and use it as a crevice nozzle.

To use it as a dusting brush, pull the brush section in the direction of the arrow to clean curtains, etc.



## CLEANING AND MAINTENANCE

Always switch off the appliance and unplug from the mains socket before carrying out any maintenance or cleaning.

Clean the outside of the appliance with a damp cloth.

Dry thoroughly before use.

### Emptying the Dust Tank

Empty the dust tank when the dust reaches the MAX line.

1. Press the dust tank release button to remove the dust tank.



2. Hold the dust tank over a trash receptacle and then press the dust release button to open the dust tank door.  
Empty the dust tank.



3. Close the dust tank door after emptying.

### Cleaning the dust tank filter

It is very important to keep the filter clean to maintain maximum performance from the vacuum. Clean the filter regularly.

1. Pull on the latch on the upper cover of the dust tank and open the upper cover.



2. Remove the sponge and filter from the upper cover. Pull the filter out of the dust tank. Hold the handle of the filter to rotate it anticlockwise and remove it.



3. Tap all parts against a trash receptacle. Wash them and the sponge under running water. Dry thoroughly.
  - DO NOT USE DETERGENTS TO CLEAN THEM.
4. Place the filter in the housing and then turn it clockwise until it locks into position.
5. Assemble the filter and sponge back into the dust tank.
6. Close the upper cover of dust tank until a click is heard.
7. Attach the dust tank back to the appliance.
  - Make sure the opening on the dust tank is aligned with the air inlet of the appliance.

### **Cleaning the air inlet filter**

Remove the dust tank and then remove the filter from the air inlet. Clean the filter under running water. Dry it thoroughly before replacing it.

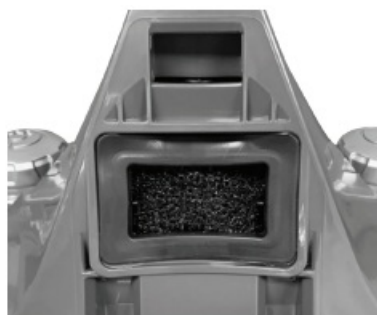

### **Cleaning HEPA filter**

The high efficiency particulate air (HEPA) filter is an effective system in removing almost all indoor pollutants, dust mites, pollen and mould spores.

1. Remove the air outlet filter grille and then remove the HEPA filter.
2. Wash them under running water and allow them to dry thoroughly.
  - DO NOT USE DETERGENTS TO CLEAN THE FILTER.
3. After cleaning, attach the HEPA filter back and then attach the air outlet grille to the appliance until a click is heard.

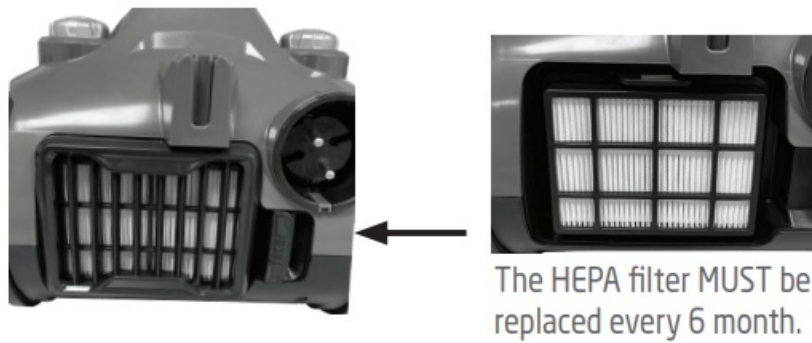

### Rewinding the Power Cord

When not in use, unplug the appliance from the mains socket and then press the cord rewind button to feed back the power cord.

**CAUTION:** Take special care to rewind the mains cord by holding the plug to avoid injury by a whipping action.

### Storage

Insert the holder of the floor brush with tubes into the storage clip at the rear of the appliance.

## SPECIFICATIONS

- **Ratings:** 220-240V~ 50-60Hz 700W

## DISPOSAL

As a responsible retailer we care about the environment. As such we urge you to follow the correct disposal procedure for the appliance and packaging materials. This will help conserve natural resources and ensure that it is recycled in a manner that protects health and the environment.

You must dispose of this appliance and its packaging according to local laws and regulations.

Because this appliance contains electronic components, the appliance and its accessories must be disposed of separately from household waste when the appliance reaches its end of life.

Contact your local authority to learn about disposal and recycling.

The appliance should be taken to your local collection point for recycling. Some collection points accept appliance free of charge.

We apologise for any inconvenience caused by minor inconsistencies in these instructions, which may occur as a result of product improvement and development.

Etablissements Darty & fils ©, 9 Rue des Bateaux-Lavois, 94200 Ivry-sur-Seine, France 11/07/2023



**Déclaration UE de Conformité** N°862022100027

*EU Declaration of Conformity*  
*EU- Conformiteitsverklaring*  
*Declaración UE de Conformidad*  
*Declaração UE de Conformidade*

**Description du produit –**

ASPIRATEUR SANS SAC

*Product Description:*  
*Productbeschrijving:*  
*Descripción del producto:*  
*Descrição do produto:*

BAGLESS VACUUM CLEANER  
ZAKLOZE STOFZUIGER  
ASPIRADOR SIN BOLSA  
ASPIRADOR SEM SACO

**Marque –**

Proline

*Brand /Merk /Marca:*

**Référence commerciale –**

VCBLMULTIC2

*Model number:*  
*/Modelnummer / Numero de modelo /*  
*Numero do modelo:*

**L'objet de la déclaration décrit ci-dessus est conforme à la législation  
d'harmonisation de l'Union applicable :**

*The object of the declaration described above is in conformity with the relevant Union  
harmonisation legislation:*

*Het hierboven beschreven voorwerp is in overeenstemming met de desbetreffende  
harmonisatiewetgeving van de Unie:*

*El objeto de la declaración descrita anteriormente es conforme con la legislación de armonización  
pertinente de la Unión:*

*O objeto da declaração acima descrito está em conformidade com a legislação de harmonização  
da União aplicável:*

Reference number	Title
<input checked="" type="checkbox"/> 2014/30/EU	EMC Directive (EMC)
<input checked="" type="checkbox"/> 2014/35/EU	Low Voltage Directive (LVD)
<input checked="" type="checkbox"/> 2009/125/EC	Eco design requirements for energy-related products (ErP)
<input checked="" type="checkbox"/> 2011/65/EU & (EU) 2015/863	RoHS

**EMC:**  
 EN IEC 55014-1:2021  
 EN IEC 61000-3-2:2019+A1:2021  
 EN 61000-3-3:2013+A1:2019  
 EN IEC 55014-2:2021

**LVD :**  
 EN 60335-2-2:2010 + A11:2012 + A1:2013  
 EN 60335-1:2012 + A11:2014 + A13:2017 + A1:2019 + A14:2019 + A2:2019 + A15:2021  
 EN 62233:2008

**ErP :**  
 (EU) No 666/2013  
 (EU) No 2017/1369  
 (EU) 2016/2282  
 (EU) 2017/254  
 EN 60312-1: 2017  
 EN 60704-1:2010+A11  
 EN 60704-2-1:2015  
 EN 60704-3:2006

La présente déclaration de conformité est établie sous la seule responsabilité du fabricant.  
 This declaration of conformity is drawn up under the sole responsibility of the manufacturer.  
 Deze conformiteitsverklaring wordt uitsluitend onder de verantwoordelijkheid afgelegd van de fabrikant.  
 Esta declaración de conformidad se redacta bajo la exclusiva responsabilidad del fabricante.  
 Esta declaração de conformidade é redigida sob a responsabilidade exclusiva do fabricante.

**Le responsable de cette déclaration est :**  
 The person responsible for this declaration is:  
 De verantwoordelijke persoon voor deze verklaring is:  
 La persona responsable de esta declaración es:  
 A pessoa responsável por esta declaração é:

Signé par et au nom de – Signed by and on behalf of: **Etablissements Darty & Fils**  
 Nom – Name : **Predrag Petricevic**  
 Fonction – Position: **Directeur du Laboratoire Fnac Darty**

Place, Date / Lieu :  
 Ivry-sur-Seine, octobre 27, 2022

Designed by:  
*Predrag Petricevic*  
 EA35F3F8BF314C6...

**CE**

**QUALITY ASSURANCE SERVICE**  
**FNAC DARTY**

Etablissements Darty & fils ©,  
 9 Rue des Bateaux-Lavours, 94200 Ivry-sur-Seine, France

## Documents / Resources



[PROLiNe VCBLMULTIC2 Slide Vacuum](#) [pdf] Instruction Manual  
 VCBLMULTIC2 Slide Vacuum, VCBLMULTIC2, Slide Vacuum, Vacuum

## References

- [User Manual](#)

### Manuals+. Privacy Policy

This website is an independent publication and is neither affiliated with nor endorsed by any of the trademark owners. The "Bluetooth®" word mark and logos are registered trademarks owned by Bluetooth SIG, Inc. The "Wi-Fi®" word mark and logos are registered trademarks owned by the Wi-Fi Alliance. Any use of these marks on this website does not imply any affiliation with or endorsement.