

PROLIGHTS
35W Variable
White LED
Gallery Light



PROLIGHTS 35W Variable White LED Gallery Light User Manual

[Home](#) » [PROLIGHTS](#) » PROLIGHTS 35W Variable White LED Gallery Light User Manual 

Contents

- 1 PROLIGHTS 35W Variable White LED Gallery Light
- 2 Product Usage Instructions
- 3 SAFETY INFORMATION
- 4 OPTIONAL ACCESSORIES
- 5 TECHNICAL DRAWING
- 6 TILT RANGE
- 7 INSTALLATION
- 8 CONNECTION TO THE MAINS SUPPLY
- 9 START UP
- 10 PRODUCT OVERVIEW
- 11 RDM FUNCTIONS
- 12 DMX CHARTS
- 13 ACCESSORIES INSTALLATION
- 14 MAINTENANCE
- 15 TROUBLESHOOTING
- 16 Frequently Asked Questions
- 17 Documents / Resources
 - 17.1 References
- 18 Related Posts



PROLIGHTS 35W Variable White LED Gallery Light



Specifications

- Model: EclDisplay DATVW
- Light Source: 35W variable white LED
- Control: DMX, Dali T6, knob-dimming
- Rev.03 – 07/24
- English version

Product Usage Instructions

Thank you for choosing PROLIGHTS

Please note that every PROLIGHTS product has been designed in Italy to meet quality and performance requirements for professionals and designed and manufactured for the use and application as shown in this document. Any other use, if not expressly indicated, could compromise the good condition/operation of the product and/or be a source of danger. This product is meant for professional use. Therefore, commercial use of this equipment is subject to the respectively applicable national accident prevention rules and regulations. Features, specifications and appearance are subject to change without notice. Music & Lights S.r.l. and all affiliated companies disclaim liability for any injury, damage, direct or indirect loss, consequential or economic loss or any other loss occasioned by the use of, inability to use or reliance on the information contained in this document. Product user manual can be downloaded from the website www.prolights.it , or can be inquired to the official PROLIGHTS distributors of your territory (https://www.prolights.it/sales_network.html). Scanning the below QR Code, you will access the download area of the product page, where you can find a broad set of always updated technical documentation: specifications, user manual, technical drawings, photometrics, personalities, fixture firmware updates.



Visit the download area of the product page



The PROLIGHTS Logo, PROLIGHTS names and all other trademark in this document pertaining to PROLIGHTS services or PROLIGHTS product are trademarks OWNED or licensed by Music & Lights S.r.l., its affiliates, and subsidiaries. PROLIGHTS is a registered trademark by Music & Lights S.r.l. All right reserved. Music & Lights – Via A. Olivetti, snc – 04026 – Minturno (LT) ITALY

SAFETY INFORMATION



WARNING!

- See <https://www.prolights.it/product/ECLDISPLAYDATVW#download> for installation instructions.
- Please read carefully the instruction reported in this section before installing, powering, operating or servicing the product and observe the indications also for its future handling.



This unit is not for household and residential use, only professional applications.



Connection to mains supply

- The Connection to the mains supply must be carried out by a qualified electrical installer.
- Use only AC supplies 100-240V 50-60 Hz, the fixture must be electrically connected to ground (earth).
- Select the cable cross section in according with the maximum current draw of the product and the possible number of products connected at the same power line.

- The AC mains power distribution circuit must be equipped with magnetic+residual current circuit breaker protection.
- Do not connect it to a dimmer system; doing so may damage the product.



Protection and Warning against electrical shock

- Do not remove any cover from the product, always disconnect the product from AC power before servicing.
- Ensure that the fixture is electrically connected to ground (earth). And use only a source of AC power that complies with local building and electrical codes and has both overload and ground-fault (earth-fault) protection.
- Before using the fixture, check that all power distribution equipment and cables are in perfect condition and rated for the current requirements of all connected devices.
- Isolate the fixture from power immediately if the power plug or any seal, cover, cable, or other components are damaged, defective, deformed or showing signs of overheating.
- Do not reapply power until repairs have been completed.
- Refer any service operation not described in this manual to PROLIGHTS Service team or an authorized PROLIGHTS service center.



Installation

- Make sure that all visible parts of the product are in good visible condition before its use or installation.
- Make sure the point of anchorage is stable before positioning the projector.
- When suspending the fixture above ground level, secure it against failure of primary attachments by attaching a safety cable that is approved as a safety attachment for the weight of the fixture to the attachment point on the main frame of the product. In case the safety cable, enter in action, it needs to be replaced with a new one.
- Install the product only in well ventilated places.
- For non temporary installations, ensure that the fixture is securely fastened to a load-bearing surface with suitable corrosionresistant hardware.
- For a temporary installation with clamps, ensure that the quarter-turn fastener and/or screws are turned fully, and secured with a suitable safety cable.

Minimum distance of illuminated objects

- The projector needs to be positioned so that the objects hit by the beam of light are at least 0,5 meters (1,64 ft) from the lens of the projector.

Ta 45°C

Max operating ambient temperature (Ta)

- Do not operate the fixture if the ambient temperature (Ta) exceeds 45 °C (113 °F).

Ta -10°C Minimum operating ambient temperature (Ta)

- Do not operate the fixture if the ambient temperature (Ta) is below -10 °C (14 °F).



Protection from burns and fire

- The exterior of the fixture becomes hot during use. Avoid contact by persons and materials.
- Ensure that there is free and unobstructed airflow around the fixture.
- Keep flammable materials well away from the fixture
- Do not expose the front glass to sunlight or any other strong light source from any angle.
Lenses can focus the sun's rays inside the fixture, creating a potential fire hazard.
- Do not attempt to bypass thermostatic switches or fuses.



Indoor use

- This product is designed for indoor and dry environments.
- Do not use in wet location and do not expose the fixture to rain or moisture.
- Never use the fixture in places subject to vibrations or bumps.
- Make certain that no inflammable liquids, water or metal objects enter the fixture.
- Excessive dust, smoke fluid, and particle build up degrades performance, causes overheating and will damage the fixture.
- Damages caused by inadequate cleaning or maintenance are not covered by the product warranty.

Tc 65°C

Temperature of the external surface

- The surface of the fixture can reach up to 65 °C (149 °F) during operation. Avoid contact with people and materials.

Maintenance

- Warning! Disconnect the fixture from AC mains power and allow to cool for at least 10 minutes before handling.
- Only technicians who are authorized by PROLIGHTS or Authorised service partners are permitted to open the fixture.
- Users may carry out external cleaning, following the warnings and instructions provided, but any service operation not described in this manual must be referred to a qualified service technician.
- Important! Excessive dust, smoke fluid, and particle build up degrades performance, causes overheating and will damage the fixture. Damages caused by inadequate cleaning or maintenance is not covered by the product warranty.



Photobiological safety

- This device emits potentially dangerous optical radiation and is identified in the category of Risk Group 2 according to EN 62471.



Do not stare at the operating light source

- Do not look directly at the LED source during operation. It can be harmful to the eyes and skin.
- During Installation, operation and maintenance, be prepared for the fixture to light and move suddenly when connected to power.
- The device should be positioned so that prolonged staring into the luminaire at a distance closer than 3,6 m (11,8 ft) is not expected.

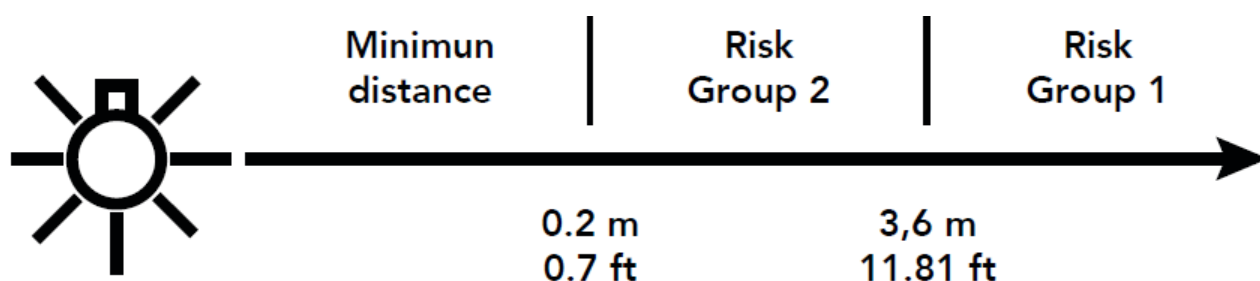

Disposal

- This product is supplied in compliance with European Directive 2012/19/EU – Waste

Electrical and Electronic Equipment (WEEE). To preserve the environment please dispose/recycle this product at the end of its life according to the local regulation.



The products to which this manual refers comply with:

- 2014/35/EU – Safety of electrical equipment supplied at low voltage (LVD).
- 2014/30/EU – Electromagnetic Compatibility (EMC).
- 2011/65/EU – Restriction of the use of certain hazardous substances (RoHS).



The products to which this manual refers comply with:

- UL 1573 + CSA C22.2 No. 166 – Stage and Studio Luminaires and Connector Strips.
- UL 1012 + CSA C22.2 No. 107.1 – Standard for power units other than class 2.



- This device complies with Part 15 of the FCC Rules.

Operation is subject to the following two conditions:

1. This device may not cause harmful interference, and
2. This device must accept any interference received, including interference that may cause undesired operation.



PACKAGING

PACKAGE CONTENT

- 1x ECLDISPLAYDATVW.
- User Manual.

OPTIONAL ACCESSORIES

DEDICATED ACCESSORIES

Check the updated accessories list, description and informations of the product at the following link:

ECLDISPLAYDATVW: <https://www.prolights.it/product/ECLDISPLAYDATVW#accessories>

NORDIC ALUMINUM TRACK

NOTE: the final terms “2” and “3” in the codes indicate the corresponding color variant in black and white respectively.

- NAXTSA682/3: global Pulse 3-Circuit MULTI Adapter, 10A 100N Slot connection, black/white.
- NAGAC6002/3: global Pulse DALI 3-Circuit Adapters, 10A 100N Slot connection, black/white.
- NAXTSA57129: global Pulse Rotating Nipples 3-Circuit Adapters, M10, H 12MM.
- NAXTSA55129: global Pulse Rotating Nipples 3-Circuit Adapters, M13, H 12mm, D 9mm.
- NAGAM109: global Pulse Nut M10 for NAXTSA57129.
- NAGAM139: global Pulse Nut M13 for NAXTSA55129.
- NAXTSC61002/3: global Pulse XTSC Lighting Track, 3 circuit DALI, 1000mm, black/white.
- NAXTSC62002/3: global Pulse XTSC Lighting Track, 3 circuit DALI, 2000mm, black/white.

- NAXTSC63002/3: global Pulse XTSC Lighting Track, 3 circuit DALI, 3000mm, black/white.
- NAXTSC64002/3: global Pulse XTSC Lighting Track, 3 circuit DALI, 4000mm, black/white.
- NAXTSC6112/3: global Pulse XTS Connector 3-CCT DALI end feed, earth right, black/white.
- NAXTSC6122/3: global Pulse XTS Connector 3-CCT DALI end feed, earth left, black/white.
- NAXTSC6142/3: global Pulse XTS Connector 3-CCT DALI middle feed, black/white.
- NAXTSC6232/3: global Pulse XTS Connector 3-CCT DALI flexible corner connector, black/white.
- NAXTSNC6342/3: global Pulse XTSN Connector 3-CCT DALI L connector, earth right, black/white.
- NAXTSNC6352/3: global Pulse XTSN Connector 3-CCT DALI L connector, earth left, black/white.
- NAXTSNC6362/3: global Pulse XTSN Connector 3-CCT DALI T connector, earth right/right, black/white.
- NAXTSNC6372/3: global Pulse XTSN Connector 3-CCT DALI T connector, earth left/left, black/white.
- NAXTSNC6382/3: global Pulse XTSN Connector 3-CCT DALI X connector, black/white.
- NAXTSNC6392/3: global Pulse XTSN Connector 3-CCT DALI T connector, earth right/left, black/white.
- NAXTSNC6402/3: global Pulse XTSN Connector 3-CCT DALI T connector, earth left/right, black/white.
- NAXTS412/3: global Pulse XTS Connector 3-CCT DALI END cap, black/white.
- NAKKT3013184/5: kit for NAXTSA682 adapter, black/white.
- NAKKT306007/8: kit for Global Pulse DMX/DALI 3-Circuit Adapters NAGAC6002, black/white.
- NASPW12SK215M: global Pulse Track clip wire suspension set 1.5m, 150N, black.
- NASPW12SK25M: global Pulse Track clip wire suspension set 5m, 150N, black.
- NASPW12SK315M: global Pulse Track clip wire suspension set 1.5m, 150N, white.
- NASPW12SK35M: global Pulse Track clip wire suspension set 5m, 150N, white.
- NASKB122/3: global Pulse Track Mounting Clamp for Rod and Wire, 200N, black/white.
- NAXTSC6212/3: global Pulse XTS Connector 3-CCT DALI straight connector, black/white.

EUTRAC TRACK

- EUT997592/6: EUTRAC multiAdapter with data bus option, black/white.
- EUT990662/6: mounting nut66 for EUT99759, black/white.
- EUT996980: data bus tap EUT99759.

TECHNICAL DRAWING

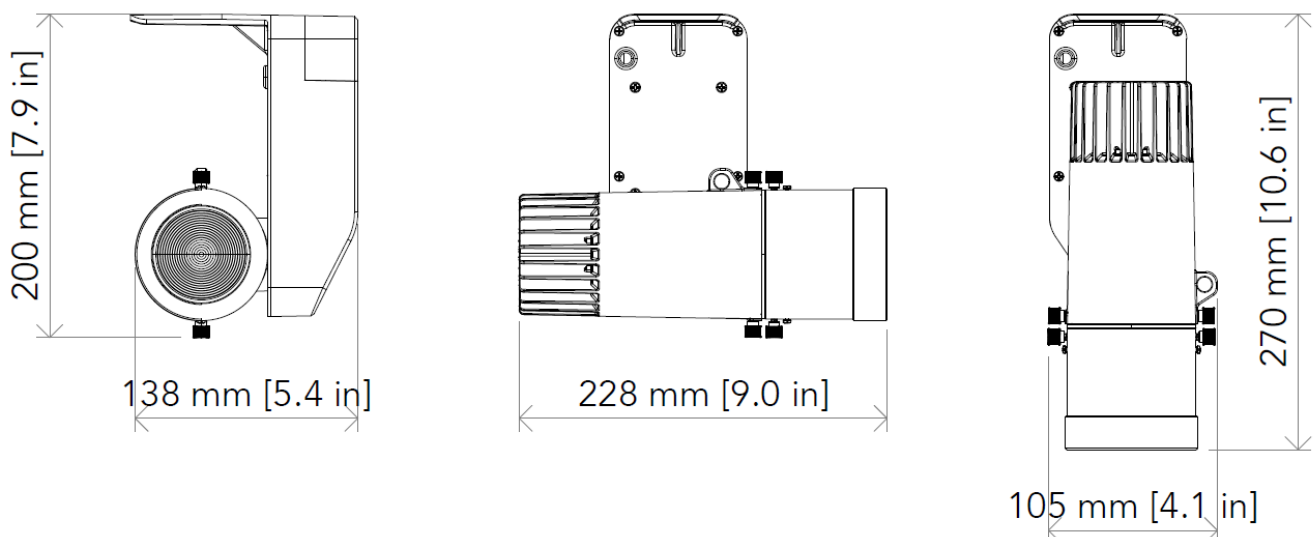

Weight: 1.78 kg – 3.92 lbs ECLDISPLAYDATVW with ECLDISPWASHL1530

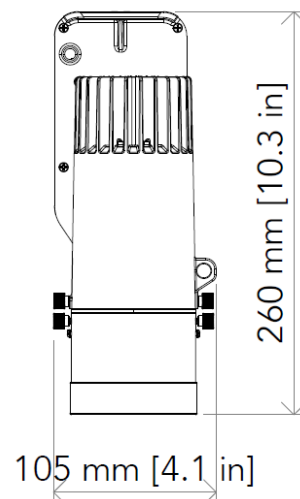
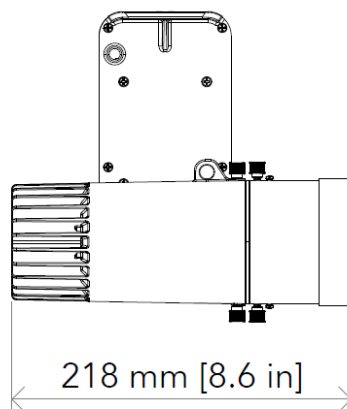
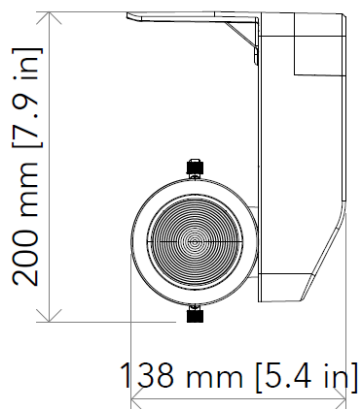

Weight: 1.77 kg – 3.90 lbs ECLDISPLAYDATVW with ECLDISPWASHL2550

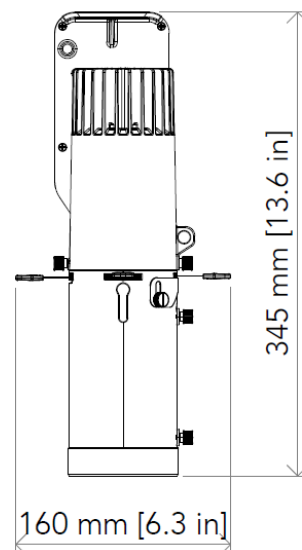
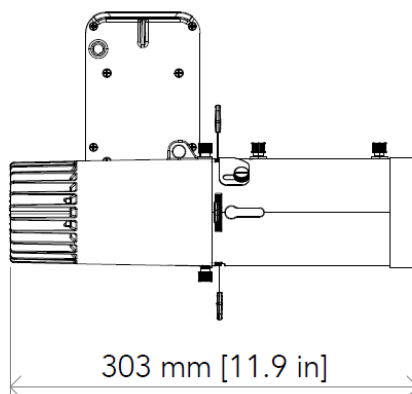
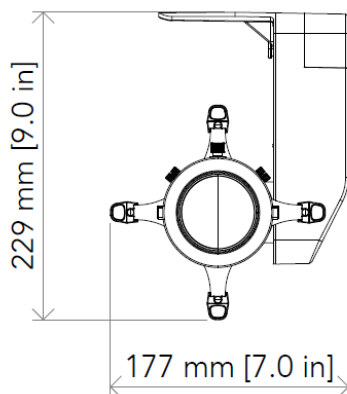

Weight: 1.95 kg – 4.29 lbs ECLDISPLAYDATVW with ECLDISPPRZL2040

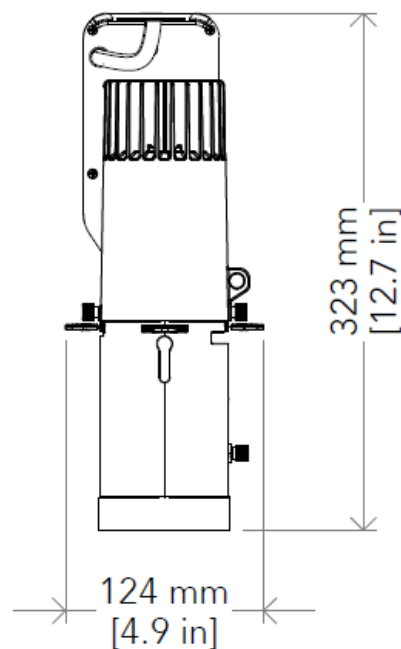
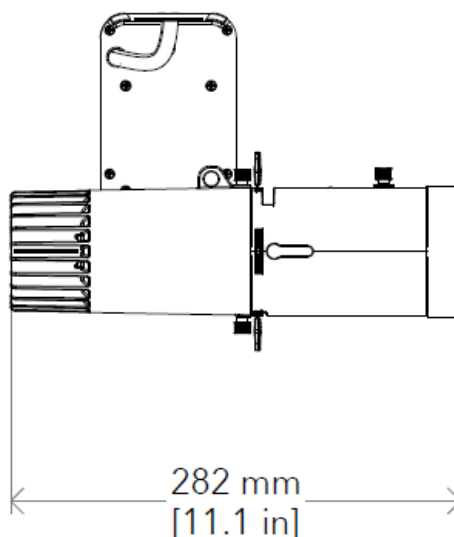
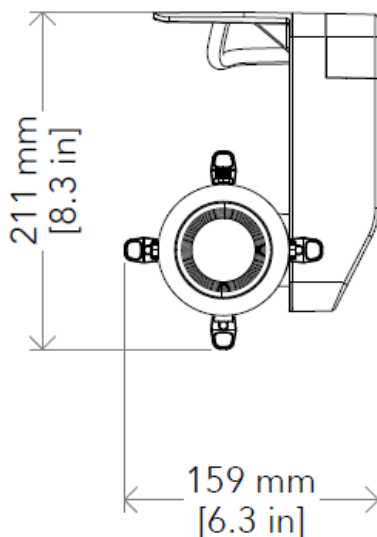

Weight: 2.15 kg – 4.74 lbs
Dimensions are in mm / in

ECLDISPLAYDATVW with ECLDISPPRHDL18-36-50

TILT RANGE

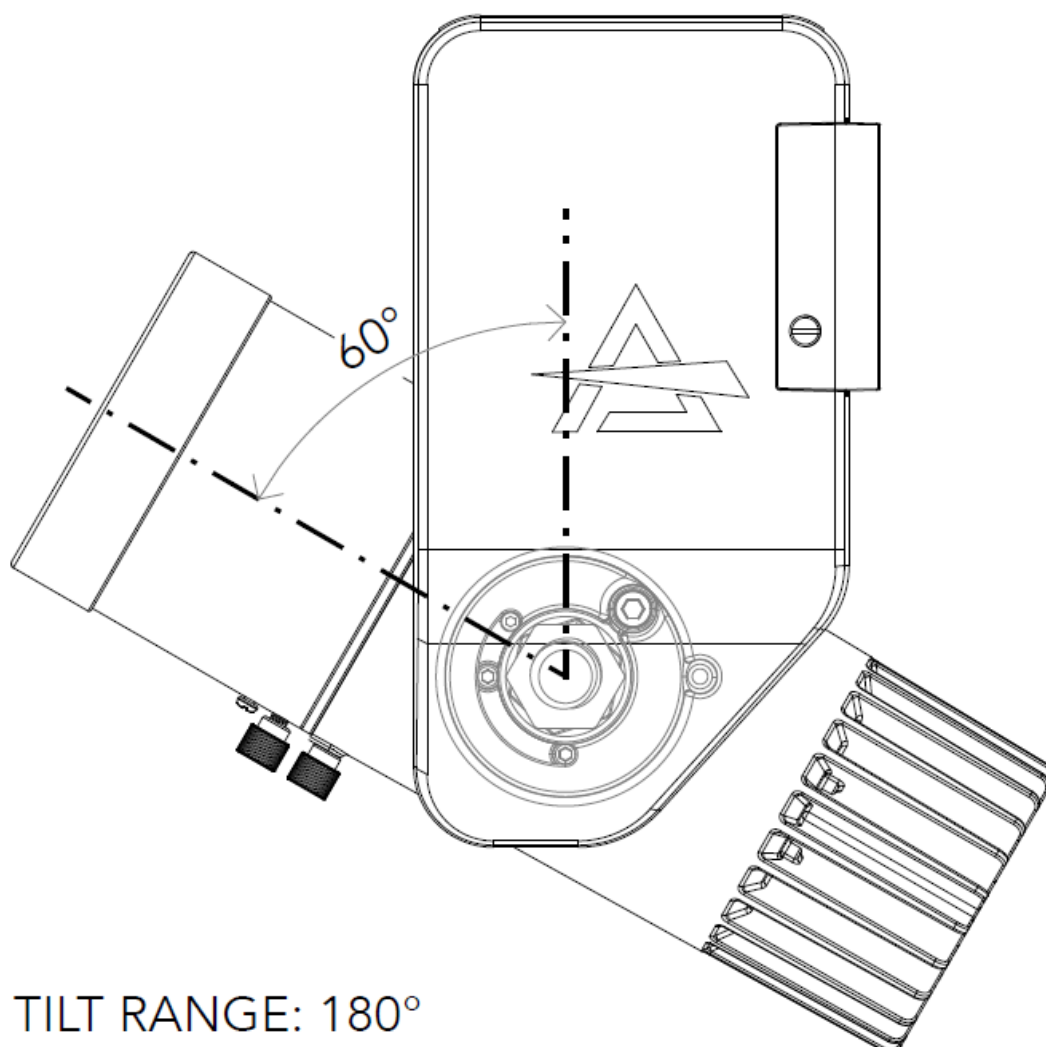

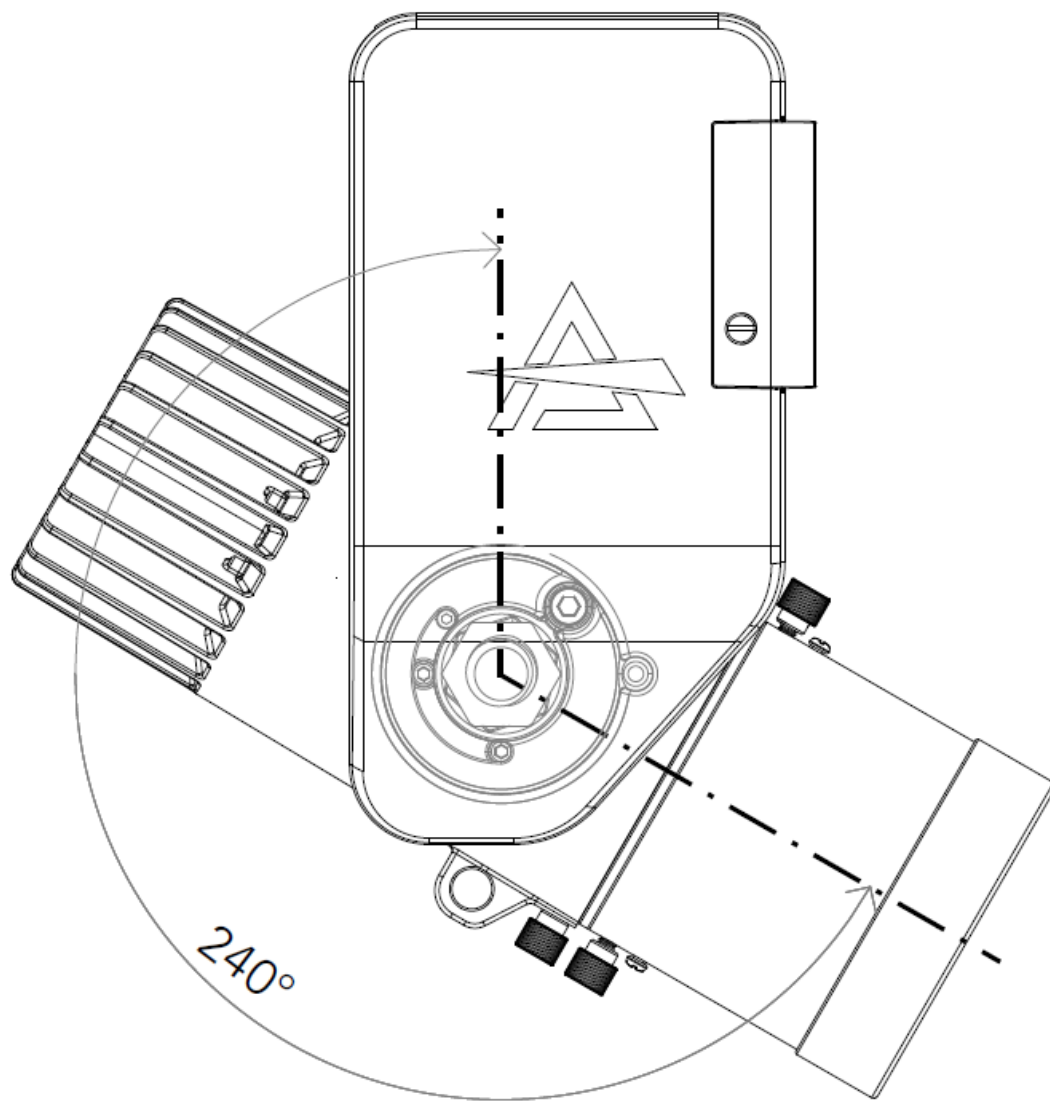

INSTALLATION

MOUNTING

Check that the supporting structure can safely bear the weight of all installed fixtures, clamps, cables, auxiliary equipment, etc. and complies with locally applicable regulations. When suspending the fixture above ground level, secure it against failure of primary attachments by attaching a safety wire that is approved as a safety attachment for the weight of the fixture to an anchor point on the product main frame. Do not use removable parts or weak anchors for secondary attachment.

Warning! When clamping the fixture to a truss or other structure at any angle, use clamps of half-coupler type. Do not use any type of clamp that does not completely encircle the structure when fastened.

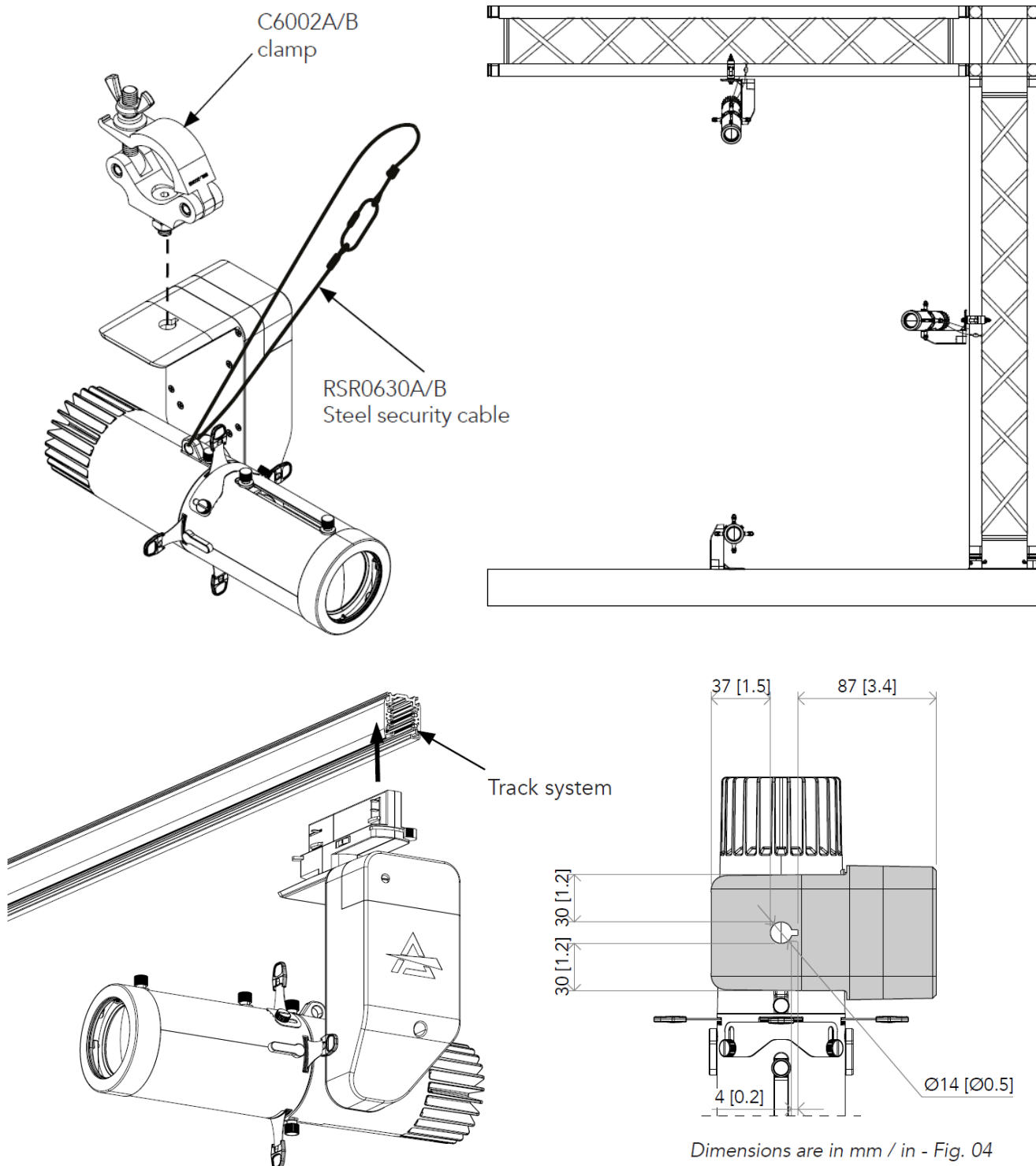

CONNECTION TO THE MAINS SUPPLY

WARNING: For protection from electric shock, the fixture must be earthed!

The product is equipped with auto-switching power supply that automatically adjusts to any 50-60Hz AC power source from 100-240 Volts.

If you need to install a power plug on the power cable to allow connection to power outlets, install a grounding-type (earthed) plug, following the plug manufacturer's instructions. If you have any doubts about proper installation, consult a qualified electrician.

The max power consumption is 33W.

TRACK INSTALLATION

In case of track installation it is recommended a maximum track length of 20 meters and up to 15 units.

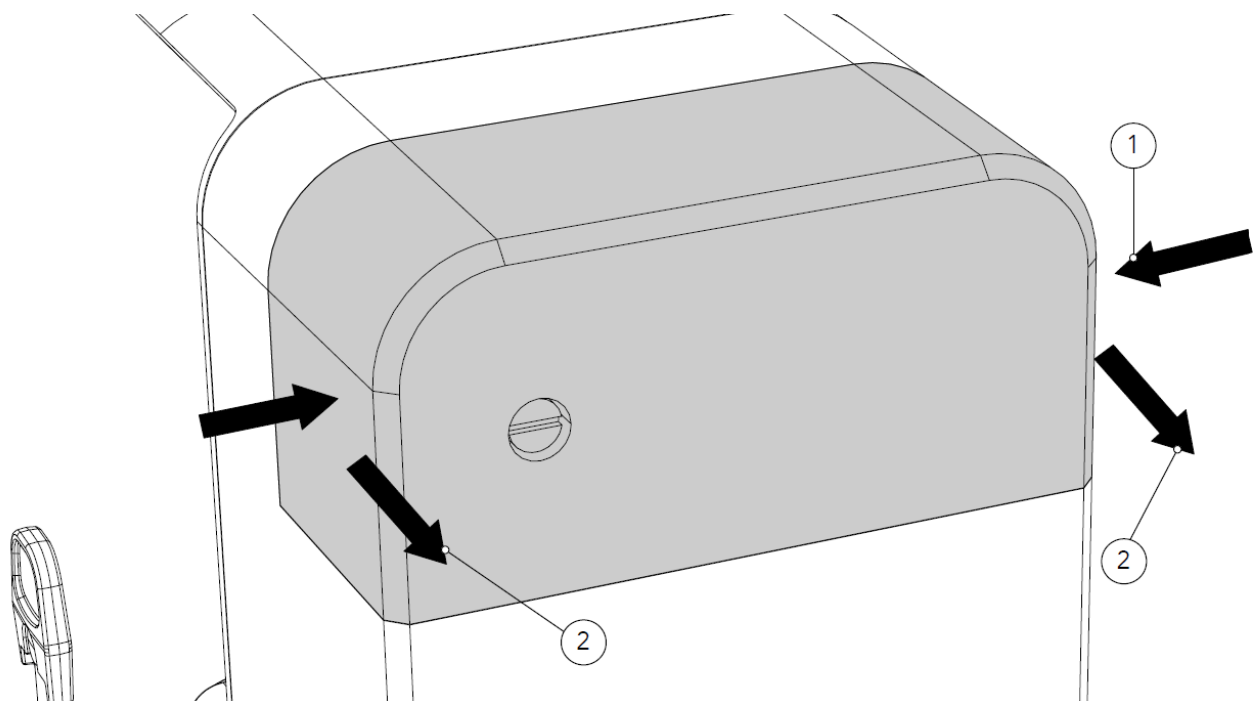
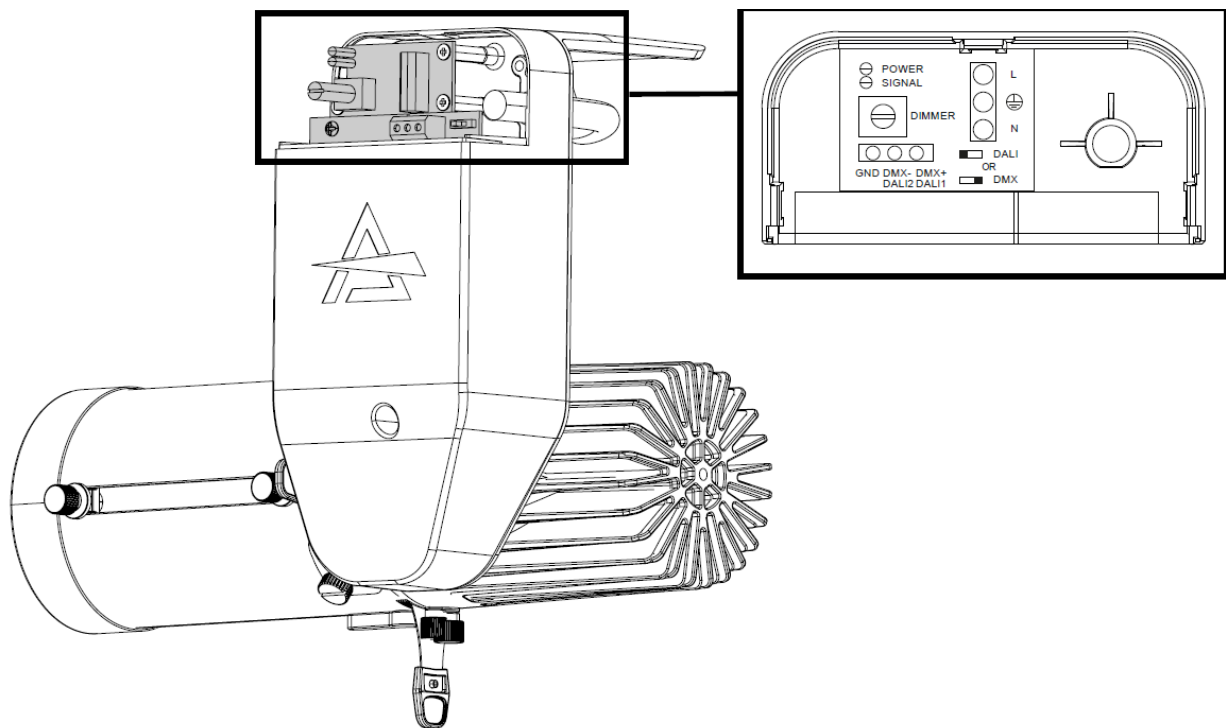

Press down on the sides of the cage (1). Then remove it (2).

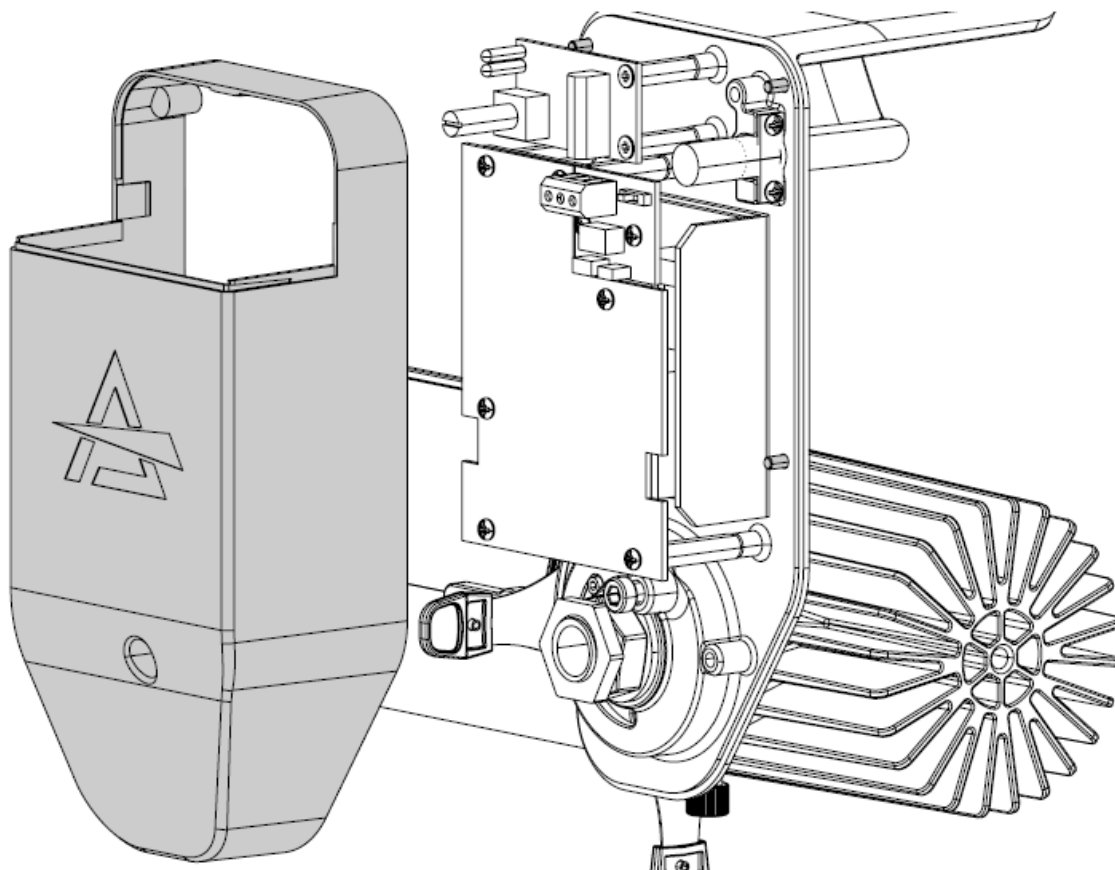

Loosen and remove the marked four screws (2). Then remove the arm housing (3).

4

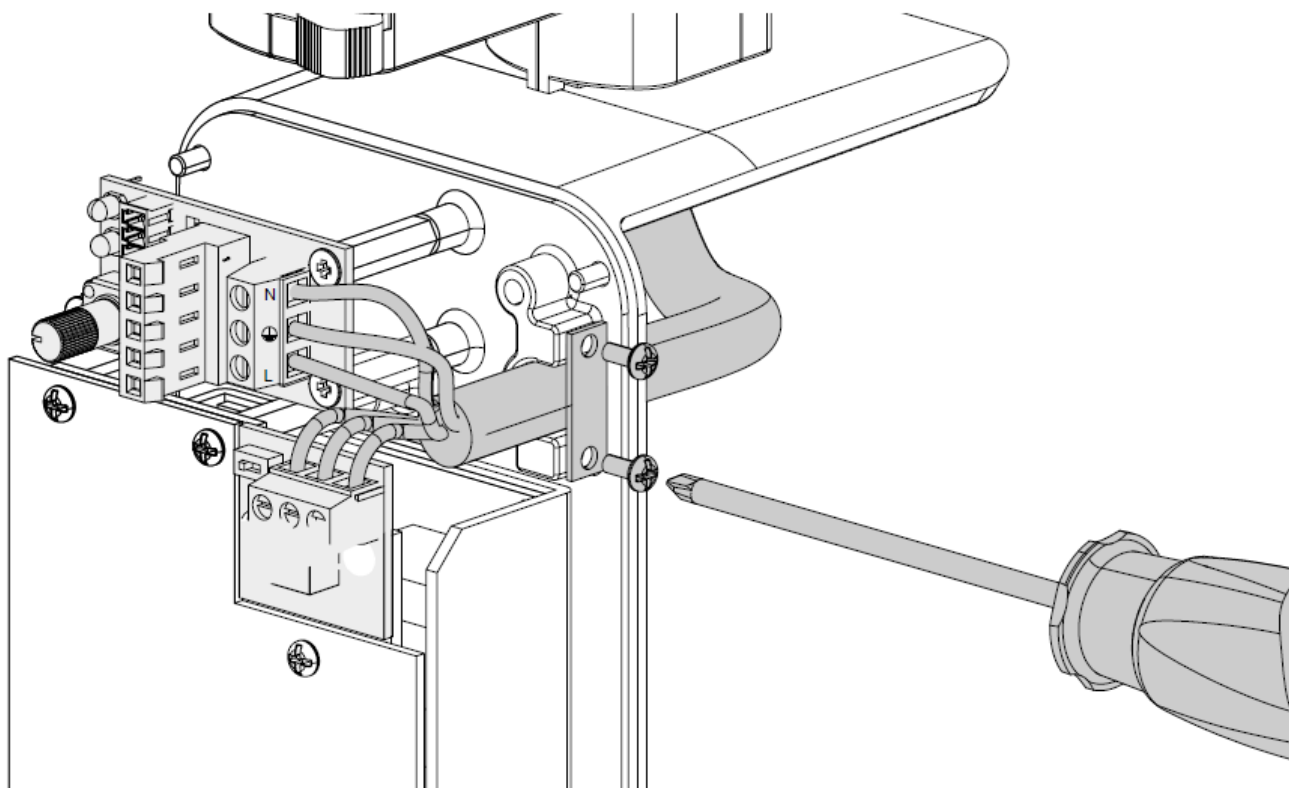

Only SJ, SJO, SJT. or other wires can be allowed to use, the customer must be assure that it can also meet the 156N tension test their connection.

START UP

CONNECT AND DISCONNECT POWER FROM THE PRODUCT

To apply and disconnect power to the product:

- Check that the product is installed and secured as indicated in the Safety Informations, and that personal safety will not be put at risk when the fixture lights up.
- Connect the power connector into the Mains input socket (100-240 VAC-50/60 Hz).
- The product is then ready for its operations and can be controlled through the available input signals on board.
- To disconnect power from the product, disconnect the Mains from the socket.

PRODUCT OVERVIEW

1. SAFETY EYE to attach safety cable;
2. KNOB for releasing and locking the optic;
3. KNOB for releasing and locking the optic and for zoom;
4. OPTIC (accessory not included, in the figure ECLDISPWASHL1530);
5. RUBBER RING (accessory included in the box optic);
6. PLASTIC CAP for access to connections;
7. KNOB dimming;
8. LOCK TILT;
9. PLASTIC ARM COVER.

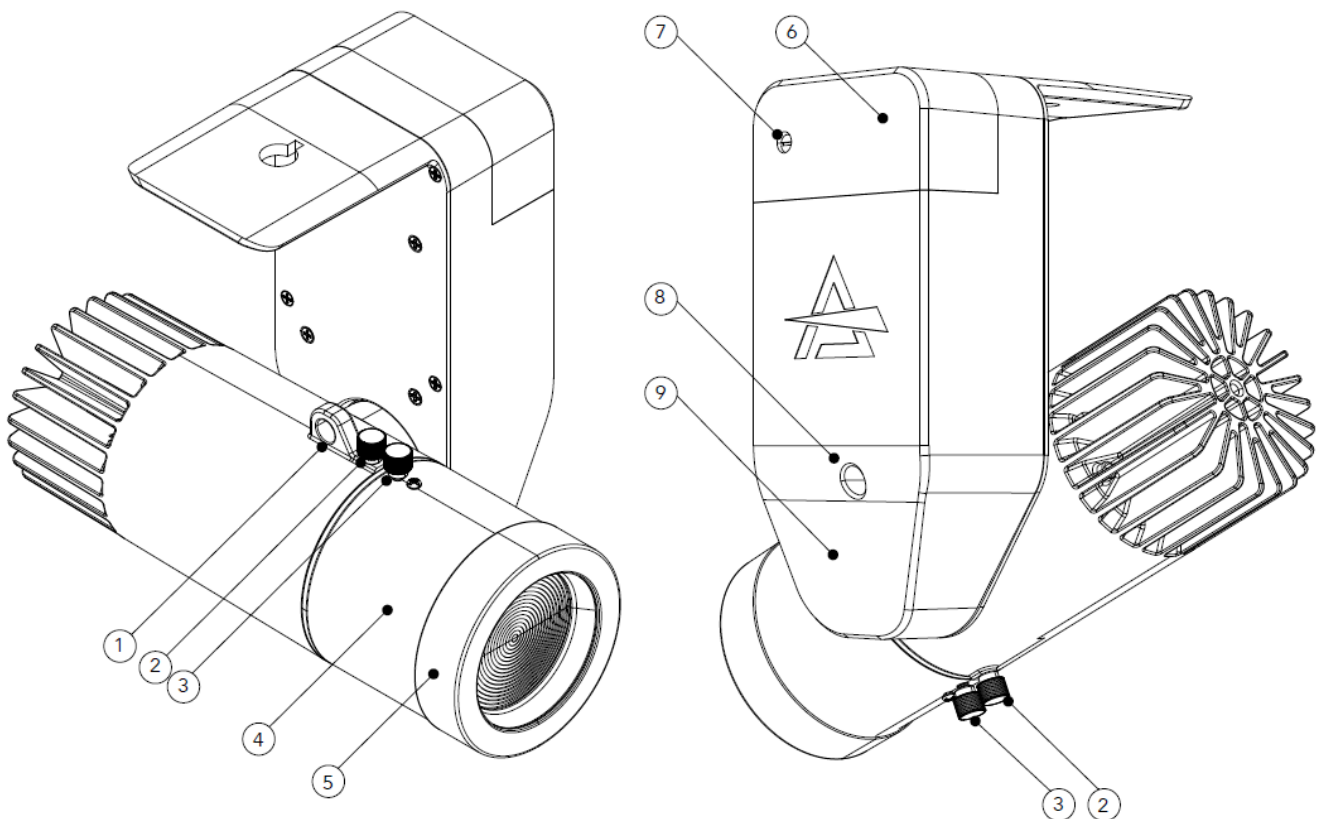

CONTROL PRIORITY ORDER

The control with higher priority defines the maximum dimming level of the successive inputs. There is an dip switch to rapidly change between DALI or DMX (though DMX is set as default).

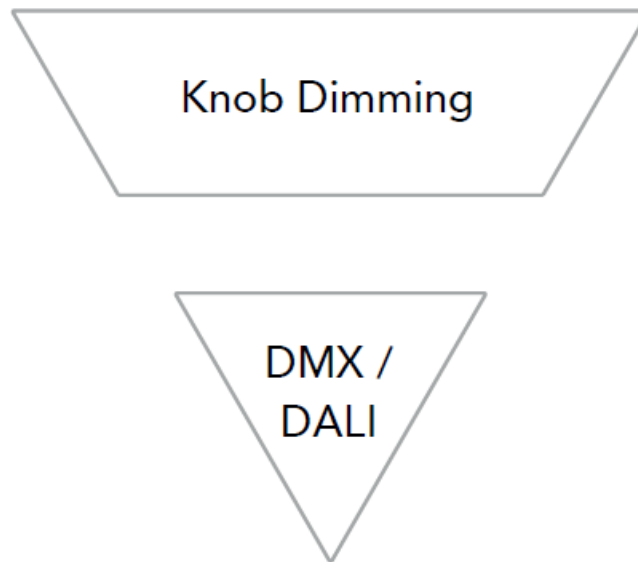

RDM FUNCTIONS

The product can communicate using RDM (Remote Device Management) protocol over a DMX512 Networks. RDM is a bi-directional communications protocol for use in DMX512 control systems, it is the open standard for DMX512 device configuration and status monitoring. The RDM protocol allows data packets to be inserted into a DMX512 data stream without affecting existing non-RDM equipment. It allows a console or dedicated RDM controller to send commands to and receive messages from specific fixtures.

Model ID	Mode IDs
D131	<u>UNO: 1</u>
	<u>BASIC: 2</u>
	<u>STANDARD: 3</u>
	EXTENDED: 4

The PIDs in the following tables are supported in the product.

RDM PIDs						
Parameter	Category	PID Address	GET	SET	Value	Description
DEVICE_INFO	Product Information	0x0060	x			
PRODUCT_DETAIL_ID_LIST	Product Information	0x0070	x			
DEVICE_MODEL_DESCRIPTION	Product Information	0x0080	x			
MANUFACTURER_LABEL	Product Information	0x0081	x			
DEVICE_LABEL	Product Information	0x0082	x	x		
FACTORY_DEFAULTS	Product Information	0x0090	x	x		
SOFTWARE_VERSION_LABEL	Product Information	0x00C0	x			
BOOT_SOFTWARE_VERSION_ID	Product Information	0x00C1	x			
BOOT_SOFTWARE_VERSION_LABEL	Product Information	0x00C2	x			
DMX_PERSONALITY	DMX512Setup	0x00E0	x	x		
DMX_PERSONALITY_DESCRIPTION	DMX512Setup	0x00E1	x			
DMX_START_ADDRESS	DMX512Setup	0x00F0	x	x		
SLOT_INFO	DMX512 Setup	0x0120	x			

RDM PIDs						
Parameter	Category	PID Address	GET	SET	Value	Description
SLOT_DESCRIPTION	DMX512Setup	0x0121	x			
DEFAULT_SLOT_VALUE	DMX512Setup	0x0122	x			
DMX_BLOCK_ADDRESS	DMX512Setup	0x0140	x	x		

DMX_FAIL_MODE	DMX512Setup	0x0141	x	x		
DMX_STARTUP_MODE	DMX512Setup	0x0142	x	x		
DIMMER_INFO	Dimmer Settings	0x0340	x			
MINIMUM_LEVEL	Dimmer Settings	0x0341	x	x		
MAXIMUM_LEVEL	Dimmer Settings	0x0342	x	x		
CURVE	Dimmer Settings	0x0343	x	x		
CURVE_DESCRIPTION	Dimmer Settings	0x0344	x	x		
OUTPUT_RESPONSE_TIME	Dimmer Settings	0x0345	x	x		
OUTPUT_RESPONSE_TIME_DESCRIPTION	Dimmer Settings	0x0346	x			
MODULATION_FREQUENCY	Dimmer Settings	0x0347	x	x		
MODULATION_FREQUENCY_DESCRIPTION	Dimmer Settings	0x0348	x			
SENSOR_DEFINITION	Sensors	0x0200	x			
SENSOR_VALUE	Sensors	0x0201	x	x		
RECORD_SENSORS	Sensors	0x0202		x		
BURN_IN	Sensors	0x0440	x	x		
DEVICE_HOURS	Power/Lamp Settings	0x0400	x	x		
LAMP_HOURS	Power/Lamp Settings	0x0401	x	x		
LAMP_STRIKES	Power/Lamp Settings	0x0402	x	x		
LAMP_STATE	Power/Lamp Settings	0x0403	x	x		
LAMP_ON_MODE	Power/Lamp Settings	0x0404	x	x		
DEVICE_POWER_CYCLES	Power/Lamp Settings	0x0405	x	x		
LOCK_PIN	Configuration	0x0640	x	x		
LOCK_STATE	Configuration	0x0641	x	x		

RDM PIDs						
Parameter	Category	PID Address	GET	SET	Value	Description
LOCK_STATE_DESCRIPTION	Configuration	0x0642	x			
IDENTIFY_DEVICE	Control	0x1000	x	x		
IDENTIFY_MODE	Control	0x1040	x	x		
UNO MODE CCT	Manufacturer PIDs	0x830A	x	x	0-255(Def. 128)	Refer to DMX Chart for CCT Value
DMX FAULT	Manufacturer PIDs	0x82DD	x	x	0-2(Def. 2)	0: HOLD1: B LACKOUT 2: STAND ALONE
MASTER/SLAVE	Manufacturer PIDs	0x8211	x	x	0-2(Def. 1)	0:MASTER DMX 1:MASTER NO DMX 2: SLAVE
STATIC DIMMER	Manufacturer PIDs	0x8207	x	x	0-255	
STATIC CCT	Manufacturer PIDs	0x82BF	x	x	0-255(Def. 128)	Refer to DMX Chart for CCT Value
STATIC STROBE	Manufacturer PIDs	0x8208	x	x	0-20	
WHITE CALIBRATION WW	Manufacturer PIDs	0x8200	x	x	125 -255	Service Purpose
WHITE CALIBRATION CW	Manufacturer PIDs	0x8201	x	x	125 -255	Service Purpose
CURRENT HOURS	Manufacturer PIDs	0x82C5	x	x		0-65535
POWER CONSUMPTION(AC 220V)	Manufacturer PIDs	0x82DE	x			
MAINTENANCE TIME:ALERT PERIOD	Manufacturer PIDs	0x83DF	x	x	10- 300	
MAINTENANCE TIME:ELAPSED TIME	Manufacturer PIDs	0x82E0	x	x	0 -ALERT PERIOD	
CLEAN ALL DATA	Manufacturer PIDs	0x82C8	x	x	0 -1	0:NO,1:YES

NOTE: the terms shown in BOLD indicates the default settings.

1	DMX ADDRESS	001 – 512				Set address used for Fixture
---	-------------	------------------	--	--	--	------------------------------

2	DMX MODE	UNO				Set DMX chart for Main Fixture.
		BASIC				
		STANDARD				
		EXTENDED				
3	DIMMER CURVE	LINEAR				Select different curve behaviour of dimmer.
		S-CURVE				
		SQUARE LAW				
		INVERSE SQUARE LAW				
4	DIMMERS PEED	AUTO				Linear dimmer behaviour
		FAST				Dimmer curve adding long fade.
		MEDIUM				Dimmer curve adding medium fade.
		SLOW				Dimmer curve adding little fade.
5	LEDFREQUENCY	600Hz				Select PWM frequency.
		1200Hz				
		2000Hz				
		4000Hz				
		6000Hz				
		25kHz				
6	DMX FAULT	BLACKOUT				To choose the behaviour of fixture in case of dmx signal lost.
		HOLD				
		STAND ALONE				
7	SPECIFIC PIDS	Check RDMSection				
8	INFORMA	DEVICE TIME	FIXTURE HOURS	(READ AND RESET)		To check the total working hours of the unit.
			CURRENT HOURS	(READ AND RESET)		To check the current working hours of the unit.
			SOURCE HOURS	(READ AND RESET)		To see the total operating hours of the LED source.
			POWER ON CYCLE	(READ AND RESET)		To see the power cycles of the machine.
			MAINTENANCE	ELAPSED TIME		To choose and reset unit maintenance

	TIONS		NCE TIME	ALERT PE RIOD	10 -30 0	warning hours.
		POWERCONS UMPTION				To see power consumption.
		SOFTWAREV ERSION				View informations about software version.
		DEVICE INFO				To see device info.
		DEVICE LABE L				To see device label.
		RDM UID				View ID for the RDM control
9	STAND AL ONE	MASTER/SLA VE	MASTER D MX			Outputs dmx signal.
			MASTER N O DMX			Doesn't output dmx signal.
			SLAVE			Receive dmx signal.
		DIMMER	0-255			
		STROBE	0-20			
		CCT	0-255			
10	FACTORY DEFAULT					To reset the unit to factory default setti ngs.

DMX CHARTS

ID	NAME	FOOTPRINT
1	UNO	1CH
2	BASIC	2CH
3	STANDARD	4CH
4	EXTENDED	10CH

<u>Model ID</u>
<u>D131</u>

Channel	UNO	BASIC	STANDARD	EXTENDED
1	DIMMER	DIMMER	DIMMER	DIMMER
2		CCT	DIMMER FINE	DIMMER FINE
3			STROBE	STROBE
4			CCT	CCT
5				CROSSFADE
6				WARM WHITE
7				WARM WHITE FINE
8				COLD WHITE
9				COLD WHITE FINE
10				CONTROL

	Di		mmer		
Function	8 bit value		16 bit value		Note
	From	To	From	To	
Dimmer	0	255	0	65535	Default @ 0

	Strobe				
Function	8 bit value		16 bit value		Note
	From	To	From	To	
Open	0	1	–	–	Default @ 255
Strobe from Slow to Fast	2	62	–	–	
Open	63	64	–	–	
Pulse In from slow to fast	65	125	–	–	
Close	126	127	–	–	
Pulse Out from slow to fast	128	188	–	–	
Open	189	190	–	–	
Random from slow to fast	191	251	–	–	
Open	252	255	–	–	

CCT						
Function		8 bit value		16 bit value		Note
CCT From	CCT To	From	To	From	To	
2700	2800	0	9	0	2260	Default @ 0
2800	2900	9	18	2260	4520	
2900	3000	18	26	4520	6779	
3000	3100	26	35	6779	9039	
3100	3200	35	44	9039	11299	
3200	3300	44	53	11299	13559	
3300	3400	53	62	13559	15819	
3400	3500	62	70	15819	18079	
3500	3600	70	79	18079	20338	
3600	3700	79	88	20338	22598	
3700	3800	88	97	22598	24858	
3800	3900	97	106	24858	27118	
3900	4000	106	114	27118	29378	
4000	4100	114	123	29378	31638	
4100	4200	123	132	31638	33897	
4200	4300	132	141	33897	36157	
4300	4400	141	149	36157	38417	
4400	4500	149	158	38417	40677	
4500	4600	158	167	40677	42937	
4600	4700	167	176	42937	45197	
4700	4800	176	185	45197	47456	

4800	4900	185	193	47456	49716
4900	5000	193	202	49716	51976
5000	5100	202	211	51976	54236
5100	5200	211	220	54236	56496
5200	5300	220	229	56496	58756
5300	5400	229	237	58756	61015
5400	5500	237	246	61015	63275
5500	5600	246	255	63275	65535

	Crossfade from CCT to Color				
Function	8 bit value		16 bit value		Note
	From	To	From	To	
Linear Cross fade	0	255	0	65535	Default @ 255 / 65535

	Warm White				
Function	8 bit value		16 bit value		Note
	From	To	From	To	
0 – 100%	0	255	0	65535	Default @ 255 / 65535

	Cold White				
Function	8 bit value		16 bit value		Note
	From	To	From	To	
0 – 100%	0	255	0	65535	Default @ 255 / 65535

Control Ch	annel				
Function	8 bit value		16 bit value		Note
	From	To	From	To	
No Functon	0	1	–	–	Default @ 0
DIMMER CURVE LINEAR	2	3	–	–	

DIMMER CURVE S-CURVE	4	5	–	–	Hold 3s to take function
DIMMER CURVE SQUARE LAW	6	7	–	–	
DIMMER CURVE INVERSE SQUARE LAW	8	9	–	–	
DIMMER SPEED AUTO	10	11	–	–	
DIMMER SPEED FAST	12	13	–	–	
DIMMER SPEED MEDIUM	14	15	–	–	
DIMMER SPEED SLOW	16	17	–	–	
LED FREQUENCY 600HZ	18	19	–	–	
LED FREQUENCY 1200HZ	20	21	–	–	
LED FREQUENCY 2000HZ	22	23	–	–	
LED FREQUENCY 4000HZ	24	25	–	–	
LED FREQUENCY 6000HZ	26	27	–	–	
LED FREQUENCY 25KHZ	28	29	–	–	
STAND ALONE MASTER DMX	30	31	–	–	
STAND ALONE MASTER NO DMX	32	33	–	–	
STAND ALONE SLAVE	34	35	–	–	
DMX FAULT HOLD	36	37	–	–	
DMX FAULT BLACKOUT	38	39	–	–	
DMX FAULT STAND ALONE	40	41	–	–	
Reserved	42	251	–	–	
FACTORY DEFAULT OF CONTROL FUNCTIONS	252	253	–	–	
Reserved	254	255	–	–	

ACCESSORIES INSTALLATION

OPTIC (CODES ECLDISPWASHL1530 / ECLDISPWASHL2550 / ECLDISPPRZL2040 – OPTIONAL)

The mounting procedure is the same for all lenses.

1

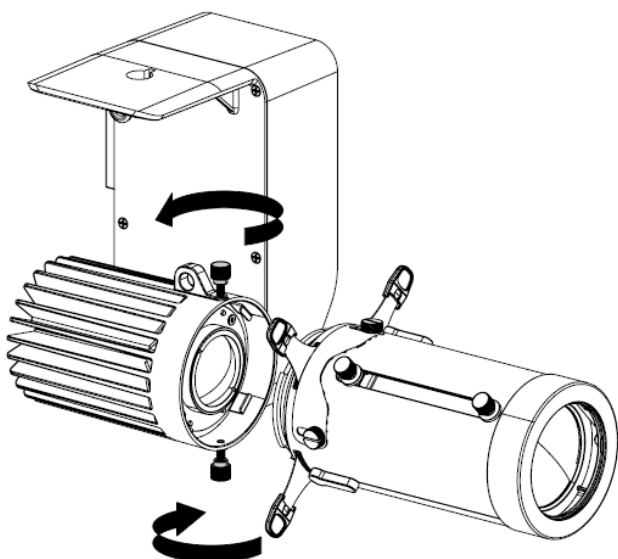

2

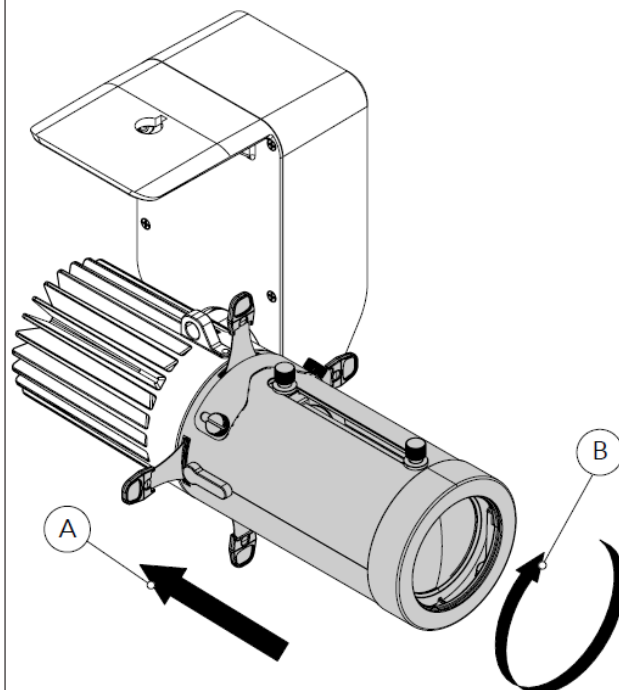

Loosen the two marked knob of the ECLDISPLAY.

3

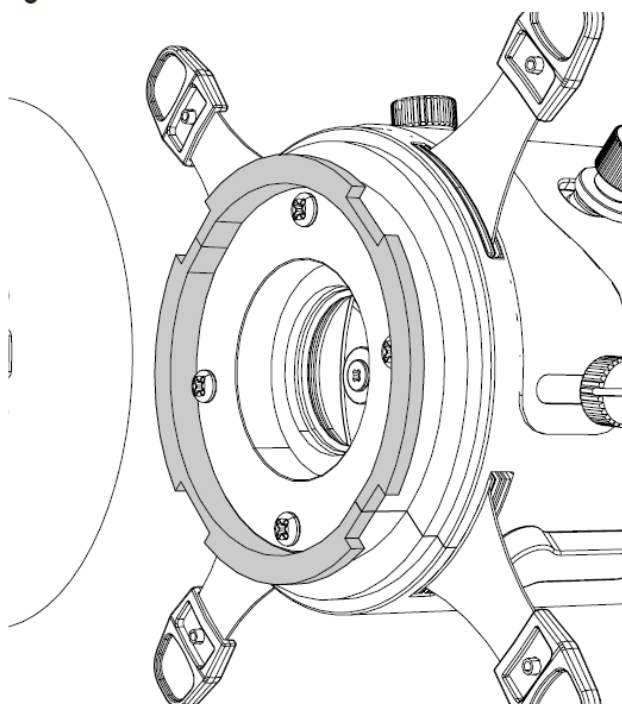

4

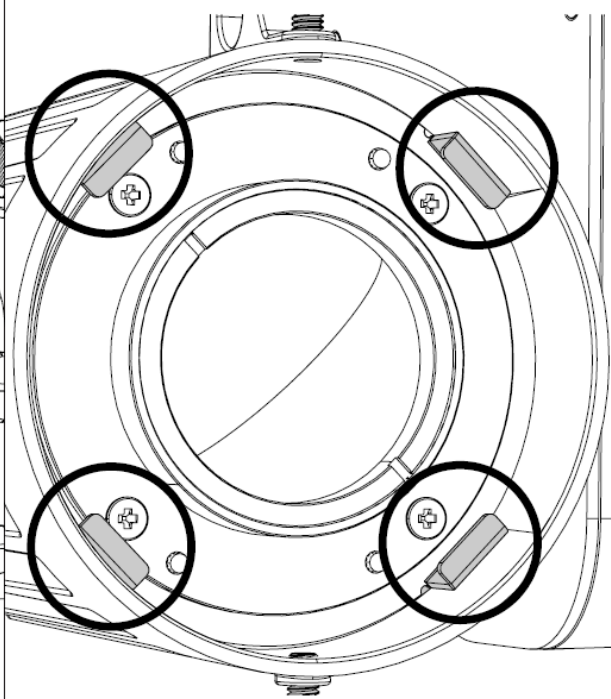

Insert the optic (2-A) and rotate it (2-B) so the marked grooves (3) of the optic coincides with the four marked flaps of the unit (4).

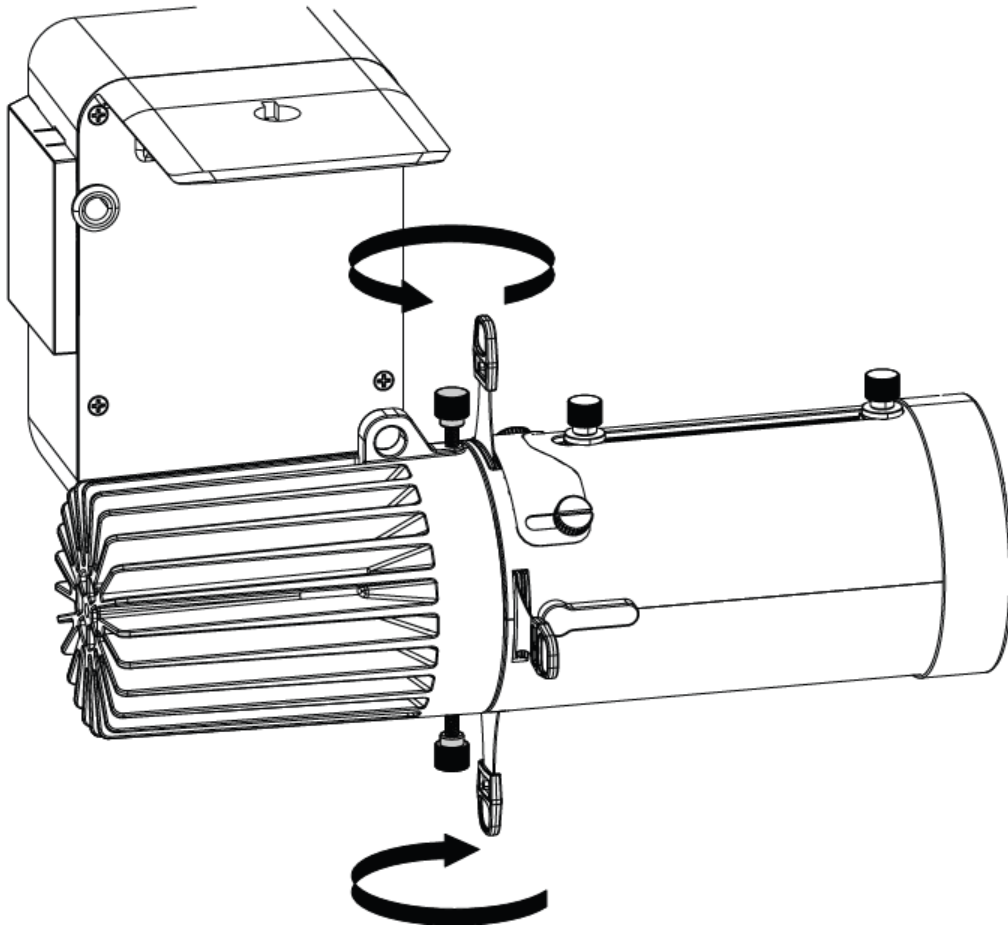

Loosen the two marked knobs on the top and lower of the ECLDISPLAY to rotate the optics.

5

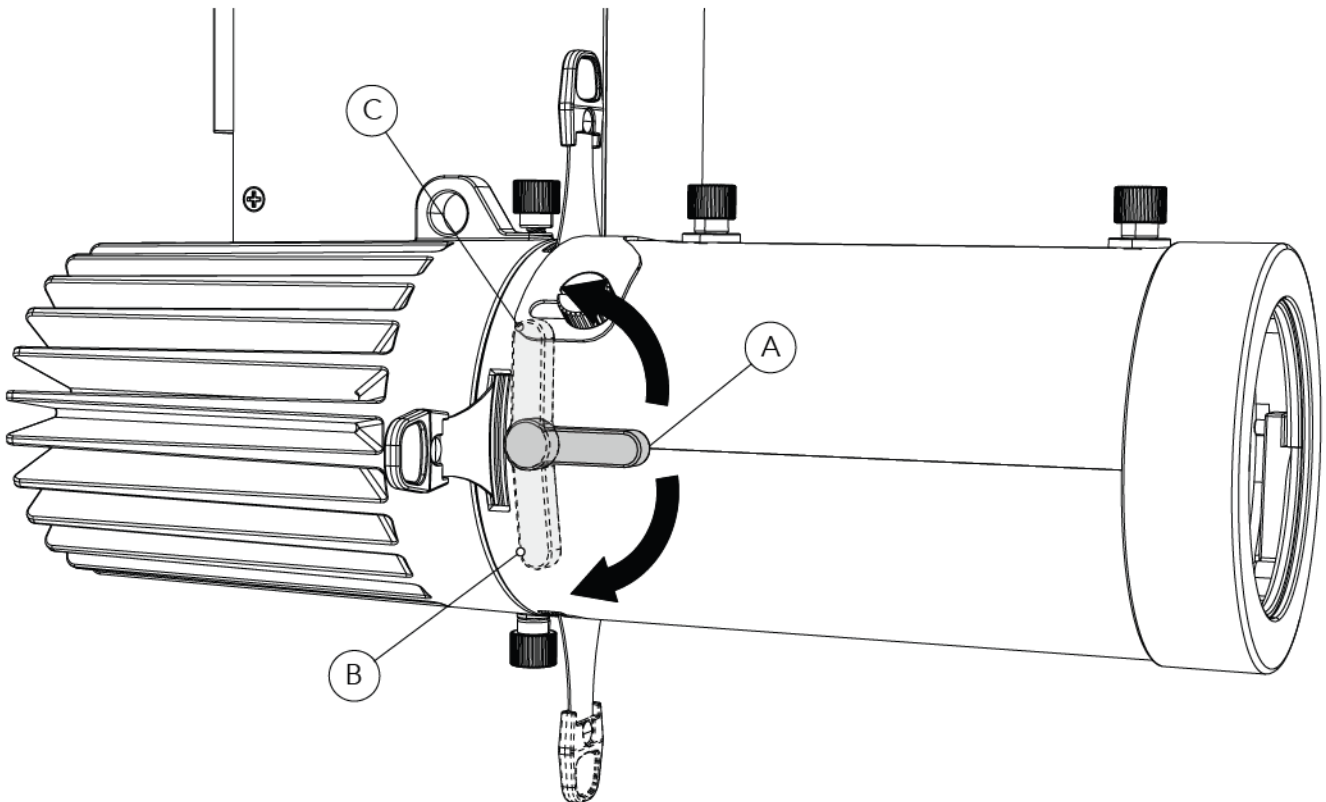

The marked lever in position A allows the locking of the blades. Rotating the lever to position B or C allows the release of the blades. This operation must be repeated for both levers on the frame system.

BARNDOOR AND FILTER FRAME (CODE ECLDISPBDNFFB – OPTIONAL)

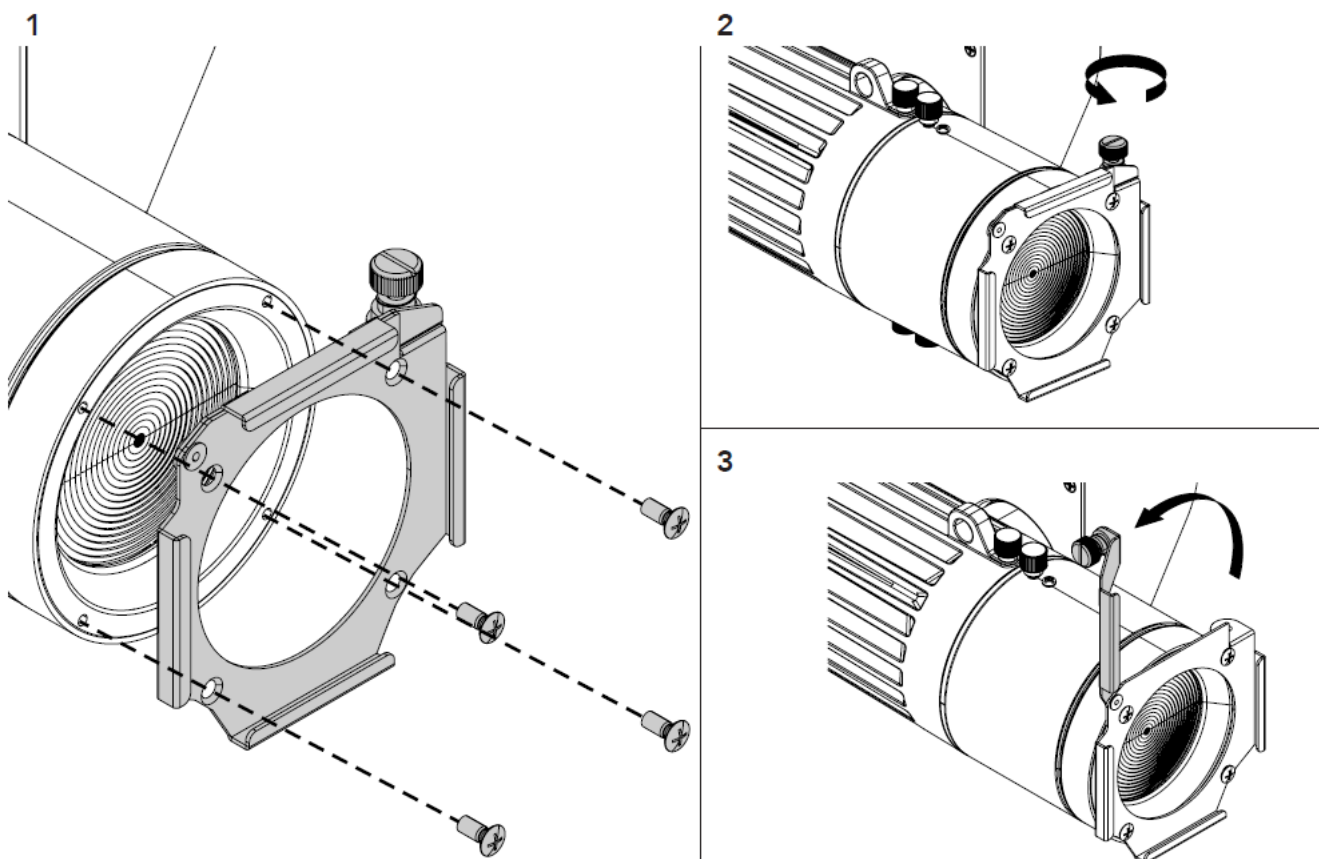

Insert the filter frame mounting the four marked screws into the holes provided on the optic. Rotate the marked knob of the filter frame (2) and move the marked rod upwards (3).

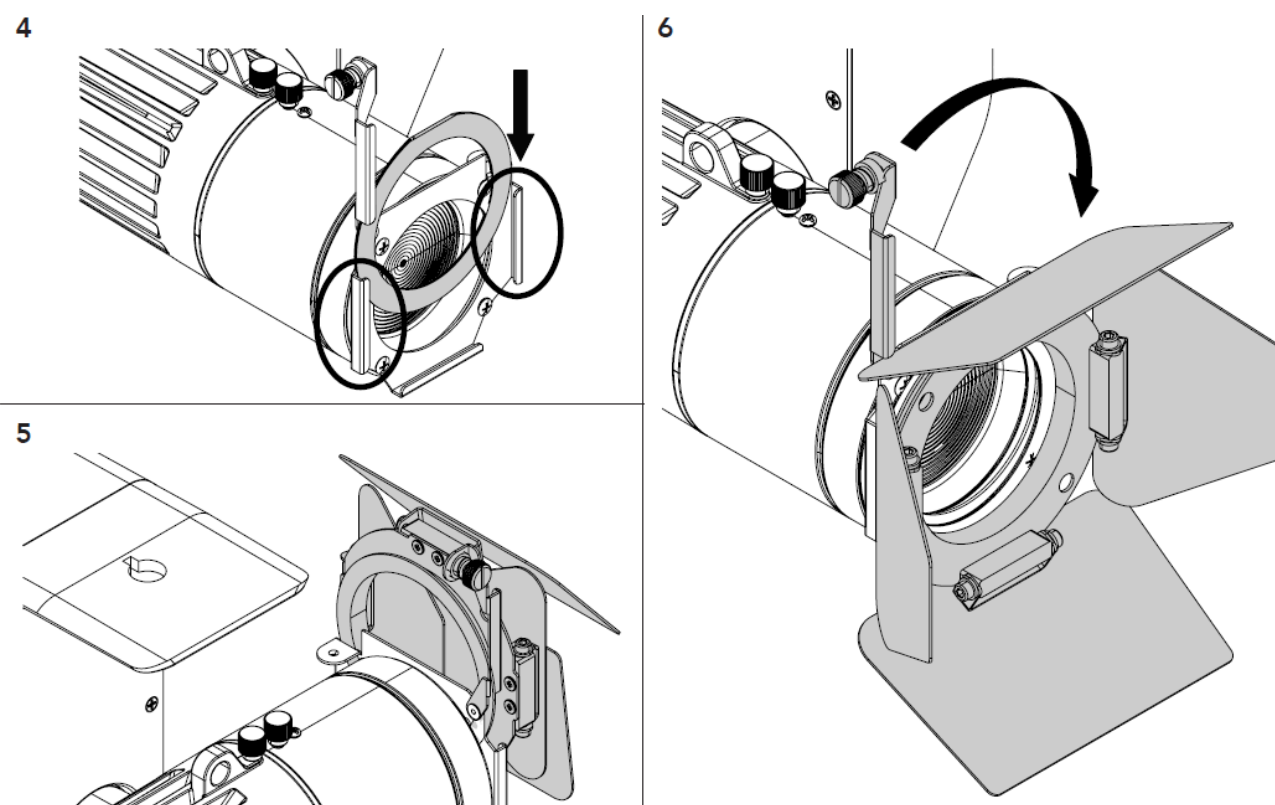

Insert the holder from above through the track (4). Then insert the barn door (5). Move the marked rod down (6).

Move the marked rod down (6).

NOTE: the rubber ring can also be used to fix a filter with a maximum diameter of 79 mm.

1

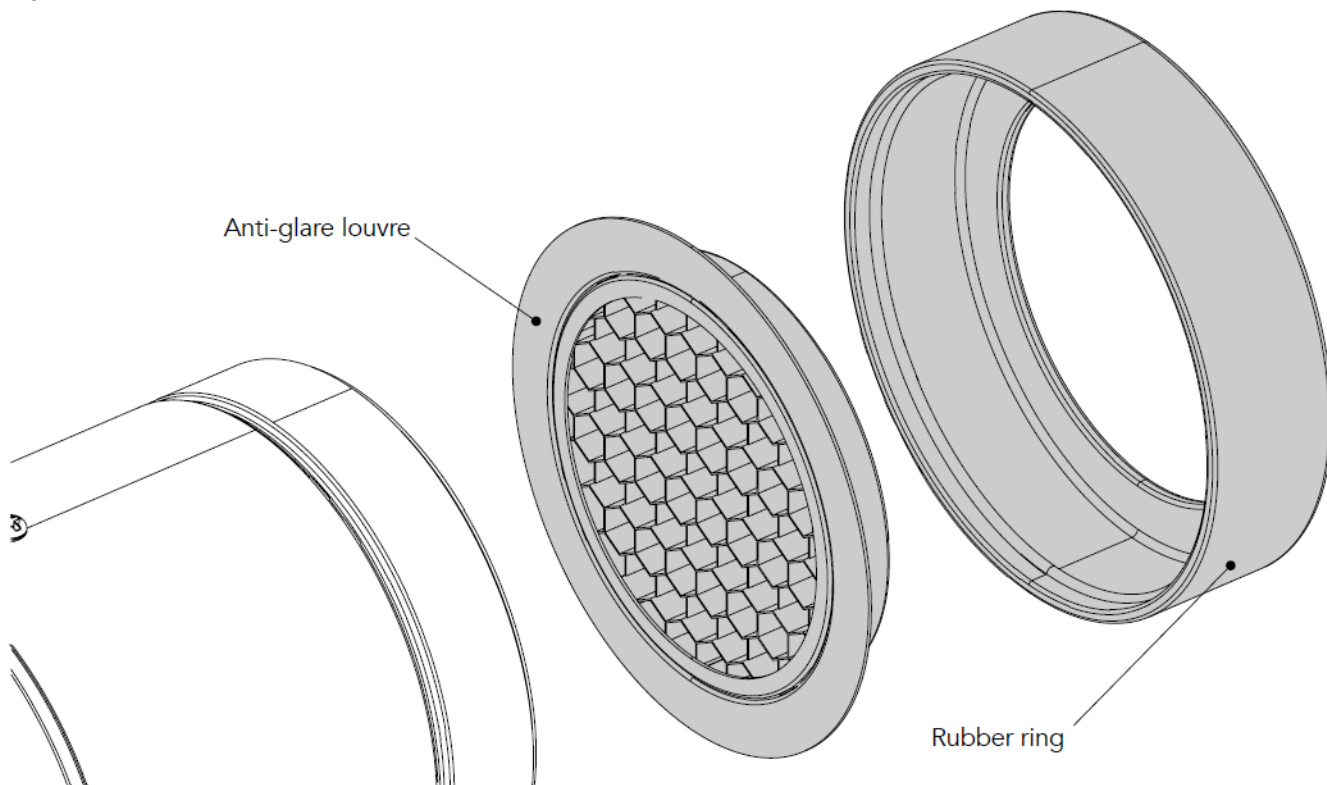

Insert the anti-glare louvre or a filter of maximum size of Ø79 mm into the rubber ring.

2

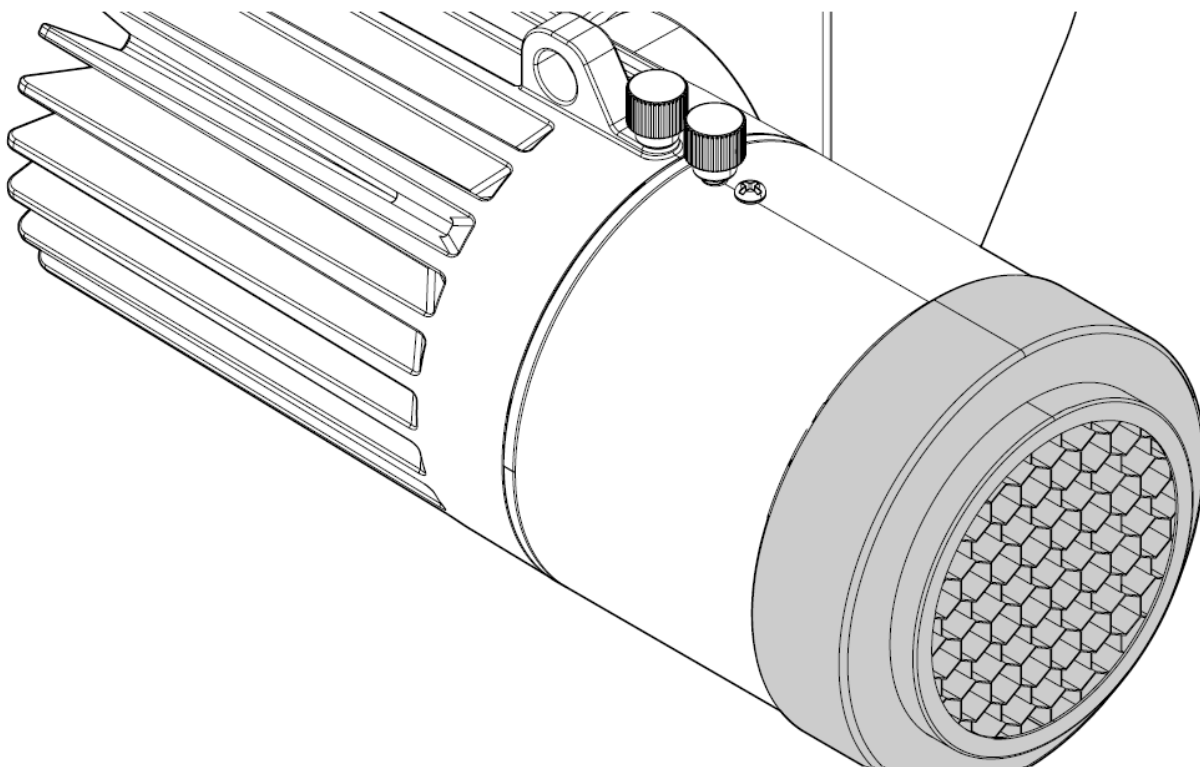

Mount the anti-glare louvre with the rubber ring on the optic.

GOBO HOLDER (CODE ECLDISPGOBOHIND – OPTIONAL)

1

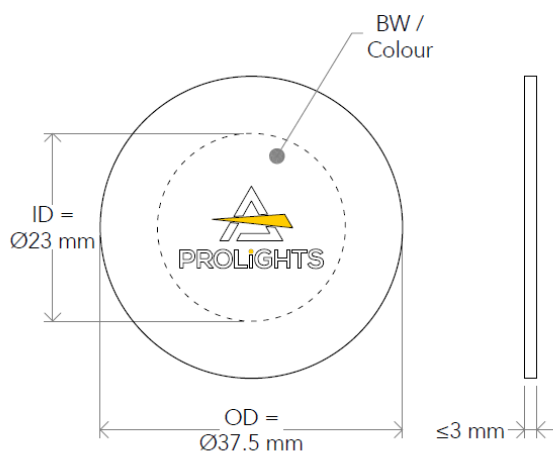

2

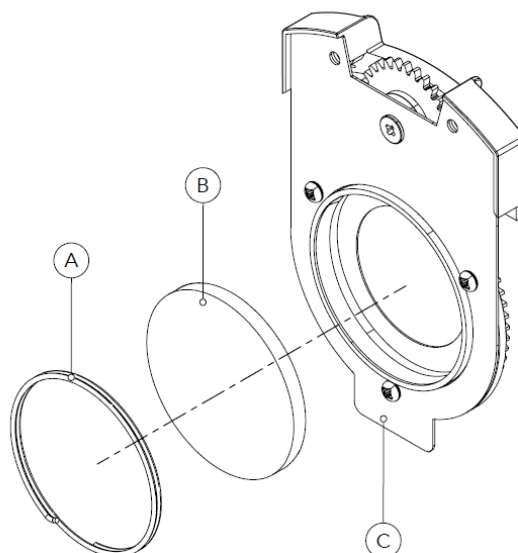

To mount the gobo remove the spring (1) from the gobo holder. Then insert the gobo following the sequence of image 2.

3

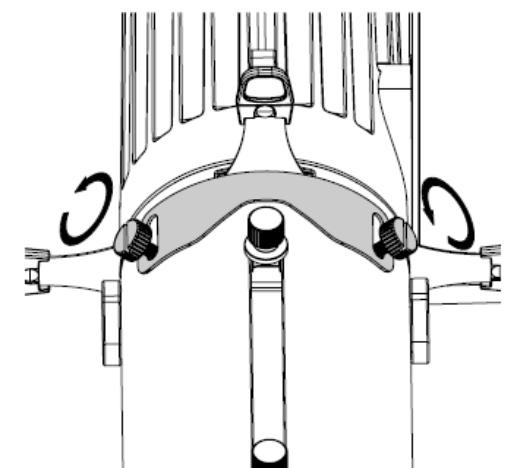

4

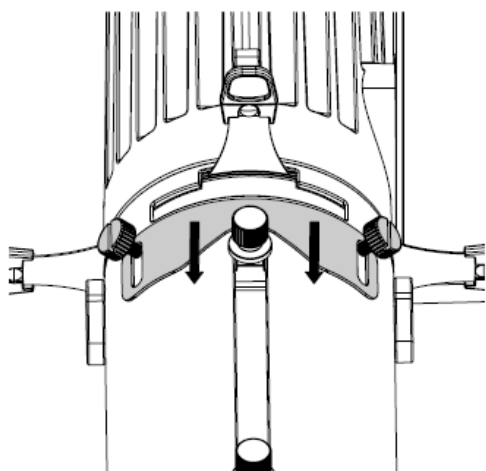

5

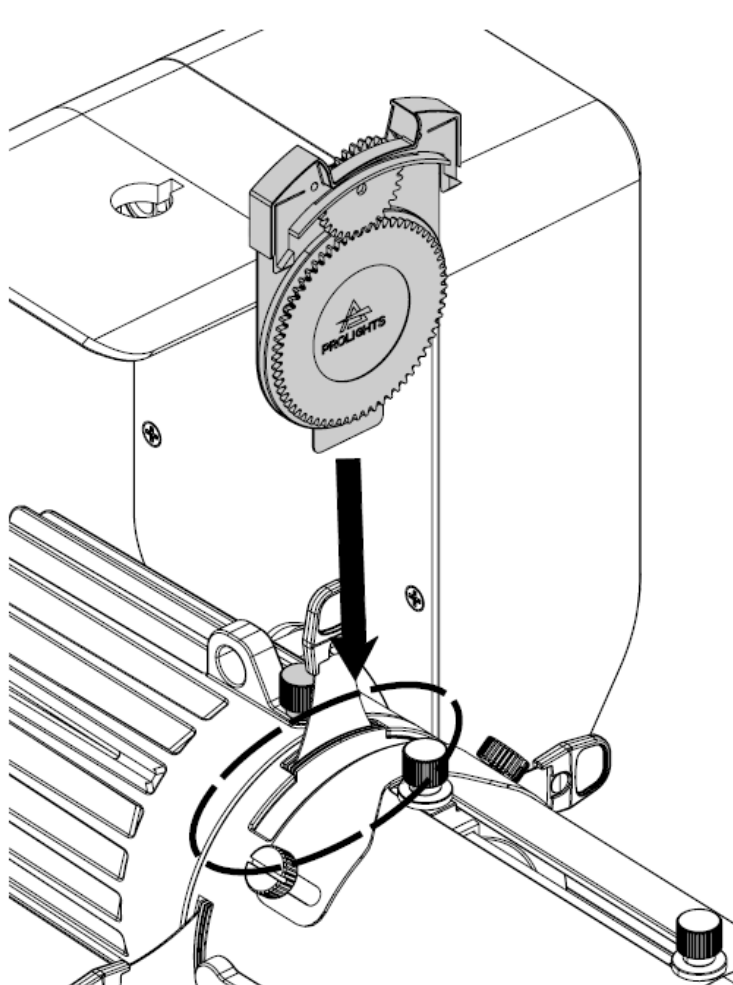

Loosen the two marked knobs of the optic (3). Then move the cover plate (4). Insert the gobo holder into the slot provided on the optic (5).

HALF SNOOT, FULL SNOOT (CODES ECLDISPHSNOOT, ECLDISPFSNOOT – OPTIONAL)

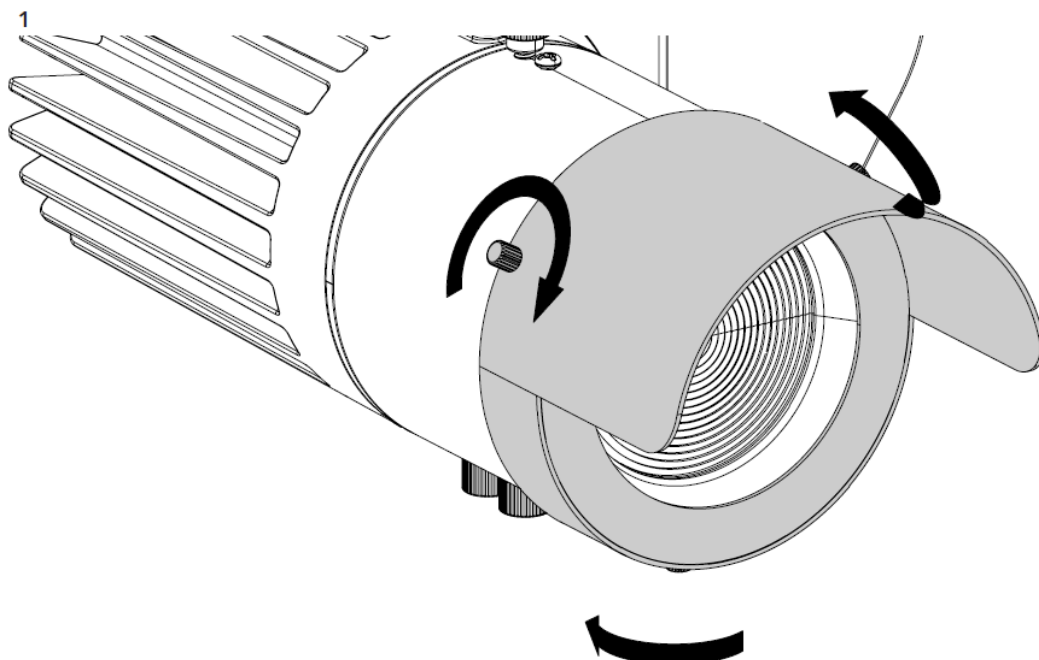

Loosen the three marked knob. Insert the half snoot on the optic and tighten the knobs in the egraved ring.

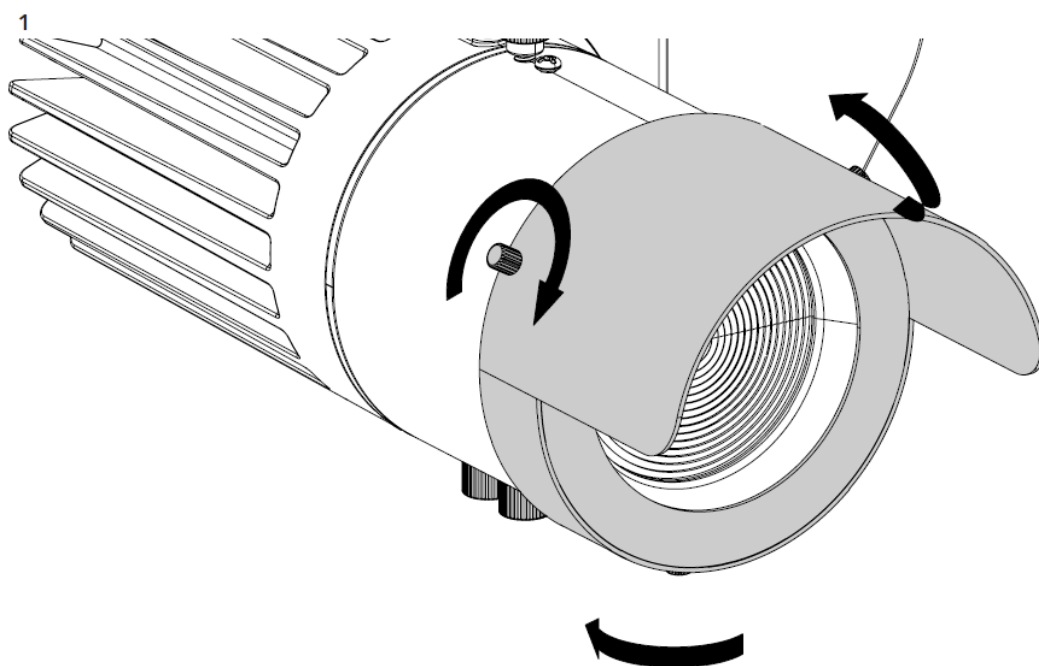

Loosen the three marked knob. Insert the full snoot on the optic and tighten the knobs in the egraved ring.

CEILING ADAPTER KIT (CODES ECLDISPCEILKIT, ECLDISPCEILFLG – OPTIONAL)

1

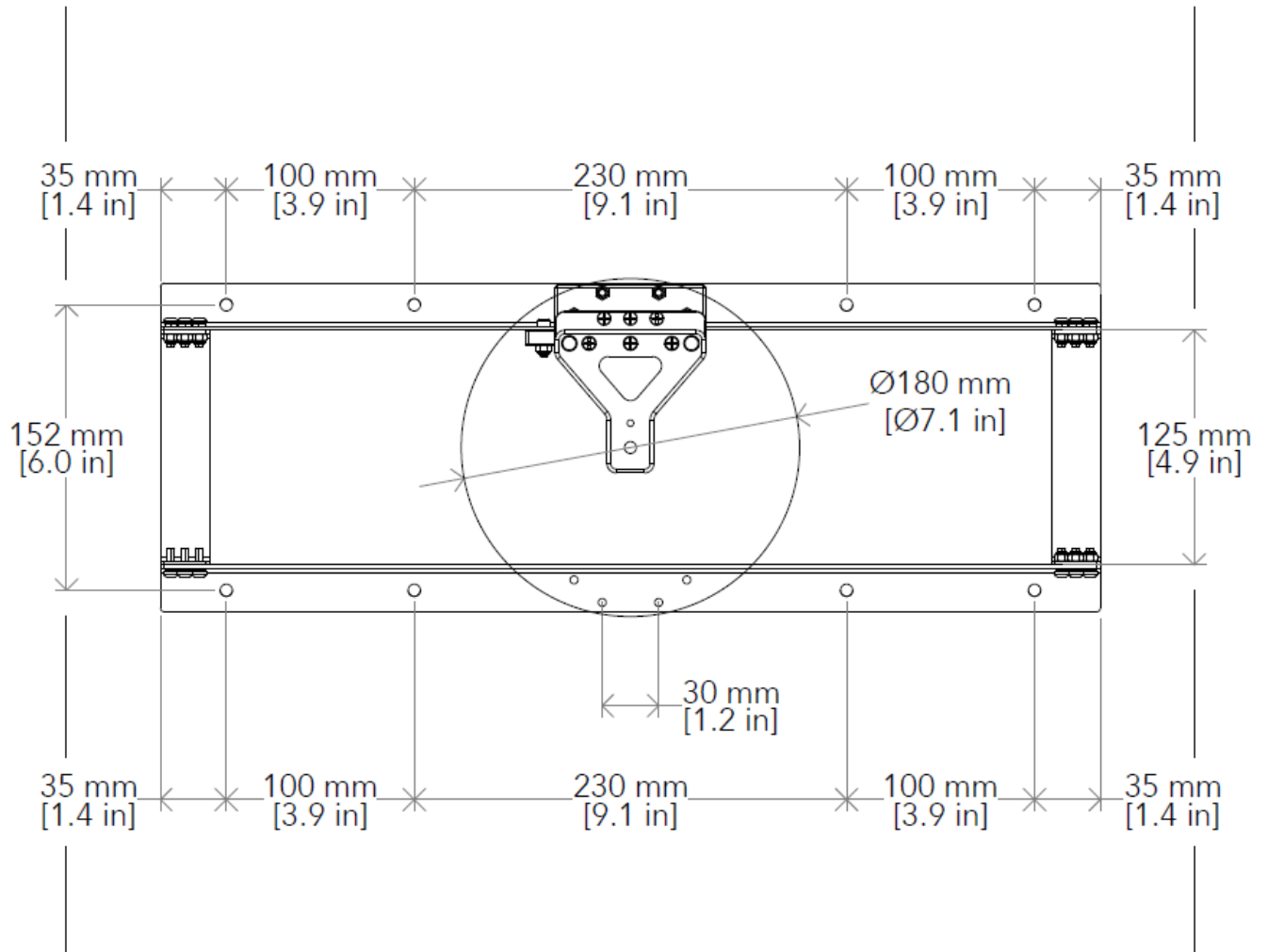

2

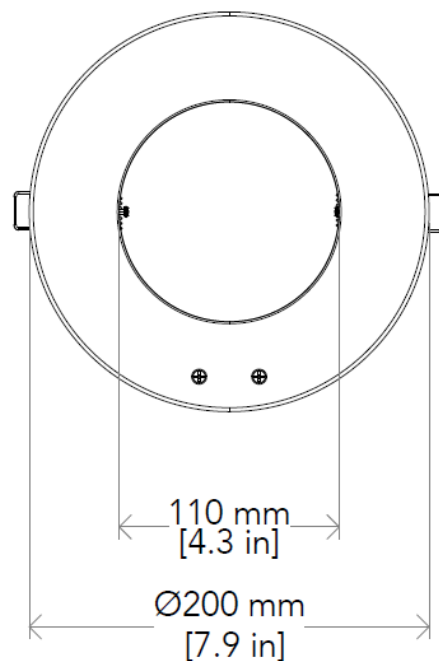

Measurements for cuts on the panels (1) and of the ECLDISPCEILFLG (2).

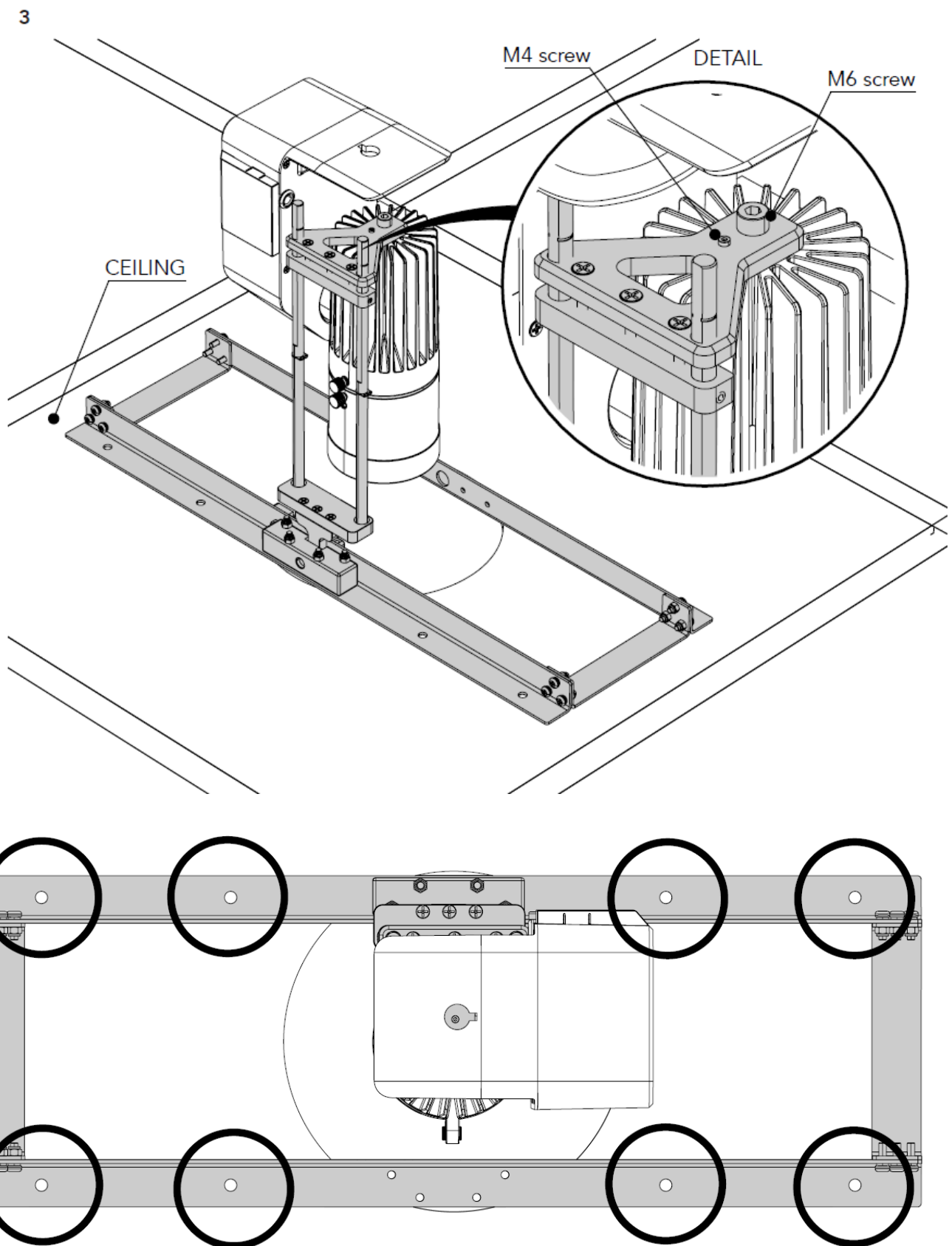

Mount the marked ceiling adapter kit on the ceiling by tightening the screws in the marked points (4). Fit the M6 screw to fix the projector (placed upside down) in the holes provided in the back housing (see detail). Fit the M4 screw to lock rotation.

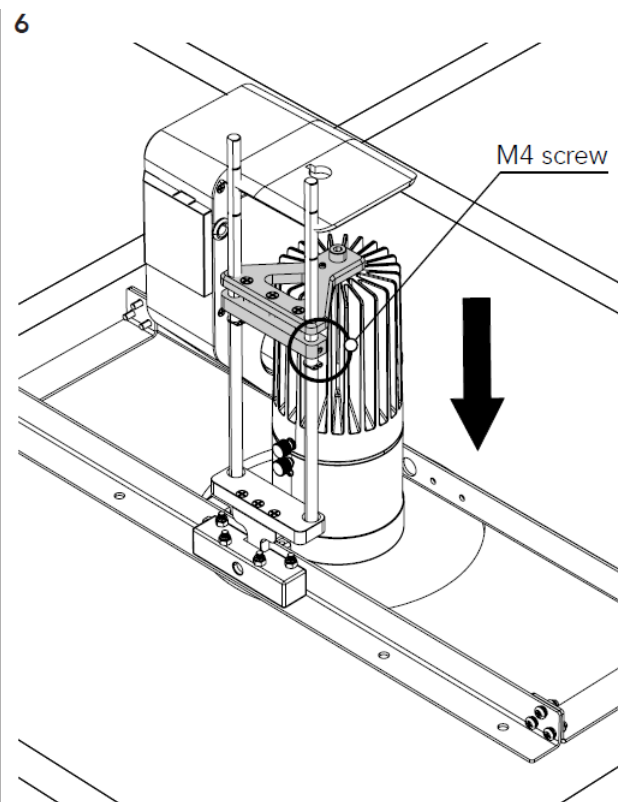
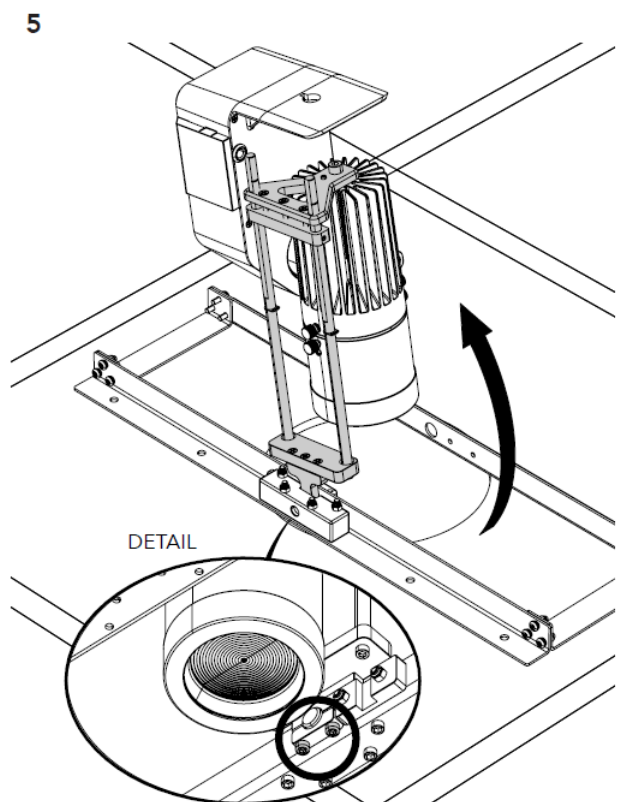

The projector can be tilted with a range of tilt movement of $-15^{\circ} \div +15^{\circ}$ (5). Tighten the two screws (see "DETAIL") to lock the tilt movement. It is possible to decide the positioning height of the projector by using the marked plate (6). Tighten the M4 screw (6) to lock the vertical movement of the plate.

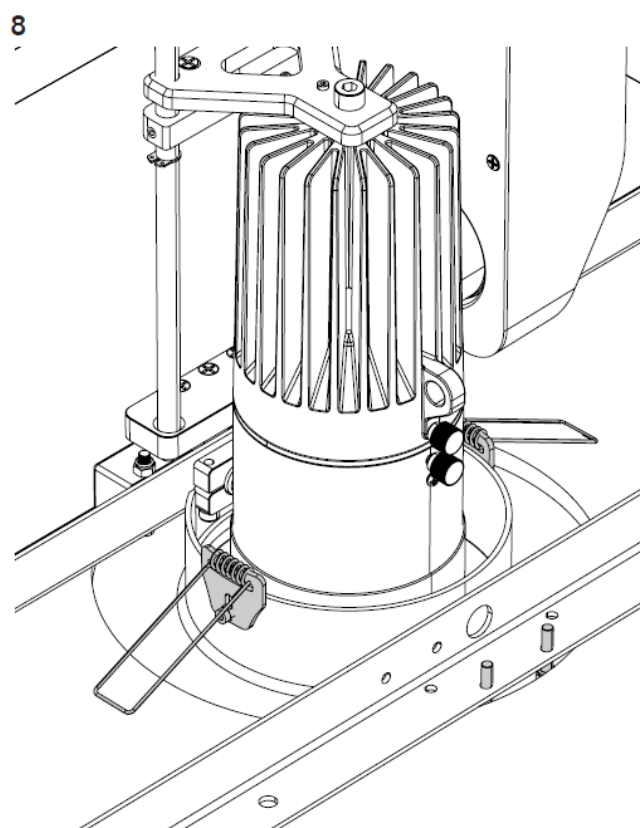
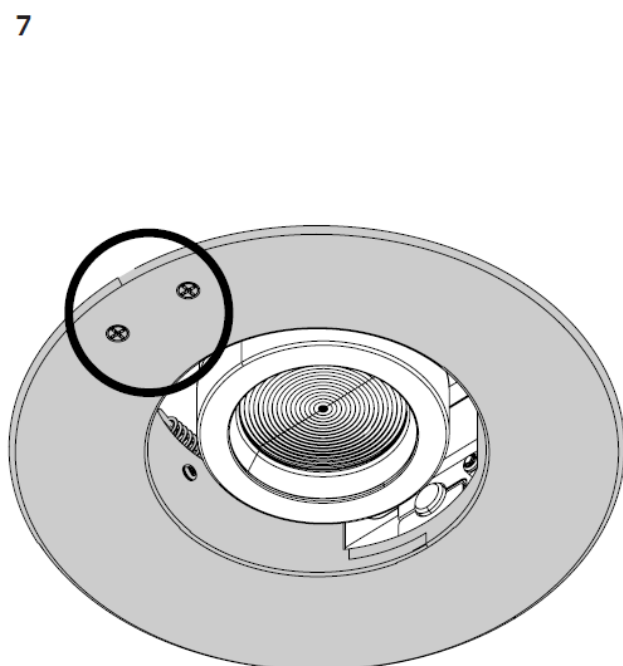

Mount the flange tightening the two marked screws (7) to complete the ceiling adapter kit.

MAINTENANCE

MAINTENANCE AND CLEANING THE PRODUCT

WARNING: Disconnect from the mains before starting any maintenance work

It is recommended to clean the front at regular intervals, from impurities caused by dust, smoke, or other particles to ensure that the light is radiated at maximum brightness.

- For cleaning, disconnect the main plug from the socket. Use a soft, clean cloth moistened with a mild detergent. Then carefully wipe the part dry. For cleaning other housing parts use only a soft, clean cloth. Never use a liquid, it might penetrate the unit and cause damage to it.
- The user must clean the product periodically to maintain optimum performance and cooling. The user may also upload firmware (product software) to the fixture via the DMX signal input port or USB port using firmware and instructions from PROLIGHTS.
- The frequency of such maintenance operations is to be performed according to various factors, such as the amount of the use and the condition of the installation environment (air humidity, presence of dust, salinity, etc.). It is recommended that the product is subject to annual service by a qualified technician for special maintenance involving at least the following procedures:
 - General cleaning of internal parts.
 - For all the parts subject to friction, using lubricants specifically supplied by PROLIGHTS.
 - General visual check of the internal components, cabling, mechanical parts, etc.
 - Electrical, photometric and functional checks; eventual repairs.
 - Cleaning the lenses. Only use neutral soap and water to clean the lenses, then dry it carefully with a soft, non-abrasive cloth.

WARNING: the use of alcohol or any other detergent could damage the lenses.

- All other service operations on the product must be carried out by PROLIGHTS, its approved service agents or trained and qualified personnel.
- It is PROLIGHTS policy to apply the strictest possible calibration procedures and use the best quality materials available to ensure optimum performance and the longest possible component lifetimes. However, optical components are subject to wear and tear over the life of the product, resulting in gradual changes in colours over many thousands of hours of use. The extent of wear and tear depends heavily on operating conditions and environment, so it is impossible to specify precisely whether and to what extent performance will be affected. However, you may eventually need to replace optical components if their characteristics are affected by wear and tear after an extended period of use and if you require fixtures to perform within very precise optical and colour parameters.
- Do not apply filters, lenses or other materials on lenses or other optical components. Use only accessories approved by PROLIGHTS.

VISUAL CHECK OF PRODUCT HOUSING

- The parts of the product cover/housing should be checked for eventual damages and breaking start at least every two months. In addition, especially the parts of the front lens holder have to be checked mechanically (by means of movement by the part) if it is firmly fastened to the fixture. If hint of a crack is found on some plastic part, do not use the product until the damaged part will be replaced.
- Cracks or another damages of the cover/housing parts can be caused by the product transportation or manipulation and also ageing process may influence materials.

- This checking is necessary for both fixed installations and preparing product for renting. Any free moving parts inside of the product, cracked cover/housing or any part of front lens not sitting properly in place need to be immediately replaced.

TROUBLESHOOTING

Problems	Possible causes	Checks and remedies
Product doesn't power ON	<ul style="list-style-type: none"> • No power to the product 	<ul style="list-style-type: none"> • Check that power is switched ON and cables are plugged in.
Product reset correctly but does not respond correctly to the controller.	<ul style="list-style-type: none"> • Bad signal connection 	<ul style="list-style-type: none"> • Inspect connections and cables. Fix eventual bad connections. Repair or replace damaged cables.
	<ul style="list-style-type: none"> • Signal connection not terminated 	<ul style="list-style-type: none"> • Insert DMX termination plug in signal output socket of the last product on the signal line.
	<ul style="list-style-type: none"> • Incorrect addressing of the product 	<ul style="list-style-type: none"> • Check the product address and control settings
	<ul style="list-style-type: none"> • One of the product is defective and is corrupting the signal transmission on the signal line 	<ul style="list-style-type: none"> • Unplug the XLR in and out connectors and connect them directly together to bypass one product at a time until normal operation is regained. Once found the error, have that fixture serviced by a qualified technician.
Timeout error after fixture reset.	<ul style="list-style-type: none"> • One or more hardware components requires mechanical adjustments 	<ul style="list-style-type: none"> • Check product stored error messages for more information. Contact PROLIGHTS Service or an authorized service partner.
Mechanical effect loses position	<ul style="list-style-type: none"> • Mechanical hardware require cleaning, adjustment or lubrication 	<ul style="list-style-type: none"> • Check product stored error messages for more information. Contact PROLIGHTS Service or an authorized service partner.
Light output turn OFF Intermittently	<ul style="list-style-type: none"> • Fixture is too hot 	<ul style="list-style-type: none"> • Check product stored error messages. • Allow product to cool. • Clean the product and airflow filters. • Reduce ambient temperature.

	<ul style="list-style-type: none"> • Hardware failure (temperature sensor, fans, Light source...) 	<ul style="list-style-type: none"> • Check product stored error messages for more information. Contact. PROLIGHTS Service or an authorized service partner.
General low light intensity	<ul style="list-style-type: none"> • Dirty lens assembly • Dirty or damaged filters 	<ul style="list-style-type: none"> • Clean the fixture regularly. • Install lens assembly properly.

Contact an authorized service center in case of technical problems or not reported in the table can not be resolved by the procedure given in the table.

PROLIGHTS is a trademark of MUSIC & LIGHTS S.r.l.

musiclights.it

Via A.Olivetti snc

04026 – Minturno (LT) ITALY

Tel: +39 0771 72190

prolights.it

support@prolights.it

Frequently Asked Questions

• Q: Is the EclDisplay DATVW suitable for outdoor use?

A: No, this product is designed for indoor use only. Outdoor use may lead to overheating and damage to the fixture.

• Q: What are the control options available for this product?

A: The EclDisplay DATVW can be controlled via DMX, Dali T6, and knob-dimming methods.

Documents / Resources

	<p>PROLIGHTS 35W Variable White LED Gallery Light [pdf] User Manual</p> <p>35W Variable White LED Gallery Light, White LED Gallery Light, LED Gallery Light, Gallery Light</p>
---	--

References

-  [Music & Lights](#)
- [User Manual](#)

[Manuals+.](#) [Privacy Policy](#)

This website is an independent publication and is neither affiliated with nor endorsed by any of the trademark owners. The "Bluetooth®" word mark and logos are registered trademarks owned by Bluetooth SIG, Inc. The "Wi-Fi®" word mark and logos are registered trademarks owned by the Wi-Fi Alliance. Any use of these marks on this website does not imply any affiliation with or endorsement.