



# PROJECT SOURCE S-4 Refrigerator Water Filter User Manual

[Home](#) » [PROJECT SOURCE](#) » PROJECT SOURCE S-4 Refrigerator Water Filter User Manual 

## Contents

- [1 PROJECT SOURCE M-4 Refrigerator Water Filter](#)
- [2 Troubleshooting](#)
- [3 CARE AND MAINTENANCE](#)
  - [3.1 WARRANTY](#)
- [4 SAFETY INFORMATION](#)
  - [4.1 INSTALLATION OVERVIEW](#)
- [5 SPECIFICATIONS](#)
- [6 Documents / Resources](#)
- [7 Related Posts](#)



**PROJECT SOURCE M-4 Refrigerator Water Filter**



PROJECT SOURCE and logo design are trademarks or registered trademarks of LF, LLC. All rights reserved.

Thank you for purchasing this Project Source Refrigerator Water Filter. We’ve created these easy-to-follow instructions to ensure you have a simple installation process. But, if you need more information than what is provided here, please visit [Lowes.com](https://www.Lowes.com), search the item number and refer to the Guides & Documents tab on the product’s page.

**Troubleshooting**

PROBLEM	POSSIBLE CAUSE	CORRECTIVE ACTION
Missing O-Ring	Manufacturer Error Error del	Call Customer Service for replacement: 866-389-8827
Leaking	Improper Installation	Remove and reinstall, ensuring the filler is securely installed
Fugas		within the refrigerator housing.
Slow Flow/No Flow	Improper Installation/Trapped Air Inside of the Filter	Submerge filter without safety cap in a bowl or sink full of water
		for 45 minutes to 1 hour, reinstall.

**CARE AND MAINTENANCE**

Replace filter every 6 months or 300 gallons, whichever precedes.

**WARRANTY**

This replacement filter cartridge is warranted to be free from defects in material and manufacture for one ( 1) year from the date of purchase. This warranty does not cover any failures resulting from abuse, misuse, alteration, or

damage not caused by the manufacturer or failure to follow proper installation and use instructions. If the product fails to satisfy this limited warranty during the described period, the manufacturer will replace or refund the purchase price of the product. This warranty does not cover additional costs such as labor.

## SAFETY INFORMATION

### WARNING

To reduce the risk of property damage due to water leakage, this filter **MUST** be installed in accordance with the manufacturers specifications and instructions. Installation shall comply with applicable state and local regulations. For cold water applications only. Do not use with water that is microbiologically unsafe or of unknown quality without adequate disinfection before or after the system. Systems certified for cyst reduction may be used on disinfected waters that may contain filterable cysts. This filter unit must be replaced every 6 months, at the rated capacity, or sooner if reduced water flow occurs. Failure to follow instructions and operating specifications will void your warranty. Further, manufacturer assumes no responsibility or liability for damages arising out of misuse of the product. Protect from freezing.

### INSTALLATION OVERVIEW

1. Carefully remove the sanitary cap from the top of the new filter.

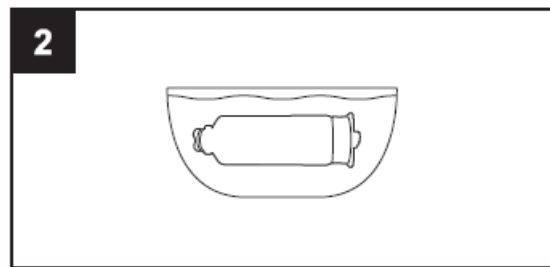
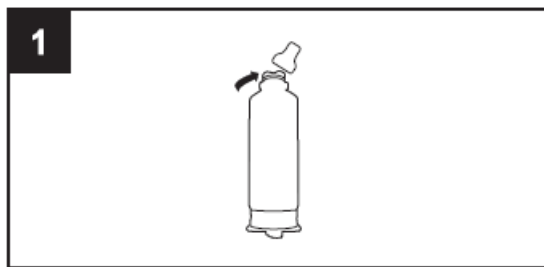

2. Submerge new filter in a bowl or sink full of water for 45 minutes to 1 hour to precondition.
3. Locate your existing filter by opening the filter cover and remove it by turning the filter counter clockwise a full 1/4 turn.

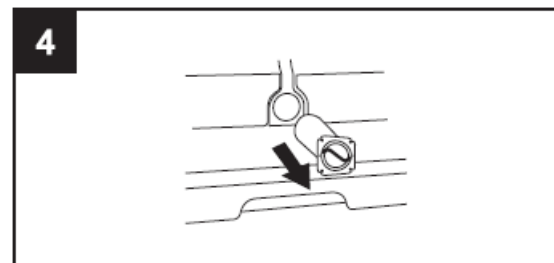
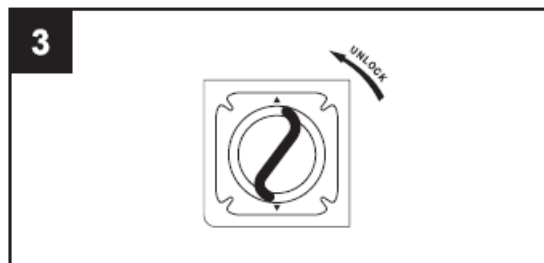

4. To prevent water spillage on the filter tray, remove the filter by pulling it straight out.

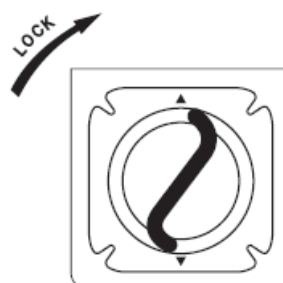

5. Insert the new filter into the refrigerator filter housing and turn clockwise a full 1/4 turn until you feel it stop. The arrows on the filter knob should align with the arrows on the refrigerator.

**Note:** Please ensure the filter is fully installed as it is required to activate the internal water valve. If the filter isn't properly installed, you may experience a slow flow or a chattering noise. If this occurs, please uninstall and reinstall the filter ensuring the filter is fully installed.

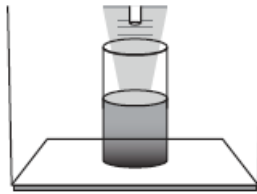

6. Run approximately 2.5 gallons of water from the dispenser periodically to clear the system and to receive a good flow. If the water flow is slower than usual, please repeat Step 5.

**Note:** Initial flow rate may be slower than expected. Full flow rate should be restored within 24-36 hours.

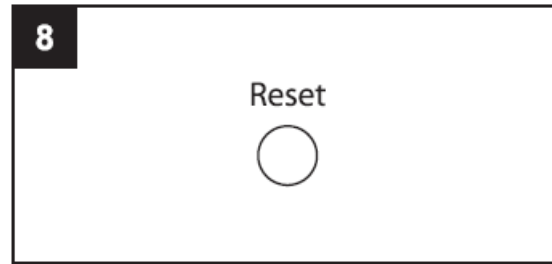

7. Inspect the filter for any noticeable leaks. If leaks are detected, please repeat Step 5.
8. To reset the filter monitor light, please refer to your refrigerator owner's manual for specific instructions.



9. Locate the included Water Filter Replacement Calendar and follow the instructions on the label.

## SPECIFICATIONS

- Flow Rate: .5 gpm (1.89 lpm)
- Operating Temperature: 33'-100°F (0.6"-38°C)
- Min Operating Pressure: 30 psi (207 kPa)
- Max Operating Pressure: 100 psi (689 kPa)
- Capacity: 6 months or 300 gallons (1,136 liters)

This Standard S-4/S-4-2 42 and is 53 Tested for the and reduction Certified of by NSF chlorine taste International and odor, against TetrachNSF/ANSI lorethylene, Endrin, performance Carbon data sheet Tetrachloride, for complete Trichlorobenzene, list of claims. p-Dichlorobenzene. Refer to Perfomance data sheet for complete list of claims.

## Documents / Resources



**[PROJECT SOURCE S-4 Refrigerator Water Filter](#) [pdf] User Manual**  
S-4, S-4-2, S-4 Refrigerator Water Filter, S-4, Refrigerator Water Filter, Water Filter, Filter