



PROJECT SOURCE RPV31-PS 11 in Handheld Pool Vacuum User Manual

[Home](#) » [PROJECT SOURCE](#) » PROJECT SOURCE RPV31-PS 11 in Handheld Pool Vacuum User Manual 

PROJECT SOURCE RPV31-PS 11 in Handheld Pool Vacuum User Manual



Contents

- 1 PARTS DIAGRAM
- 2 SAFETY INFORMATION
- 3 GETTING STARTED
- 4 ASSEMBLY
- 5 OPERATION
- 6 EMPTYING THE FILTER CAGE
- 7 MAINTENANCE & STORAGE
- 8 TROUBLESHOOTING
- 9 Documents / Resources
 - 9.1 References
- 10 Related Posts

PARTS DIAGRAM

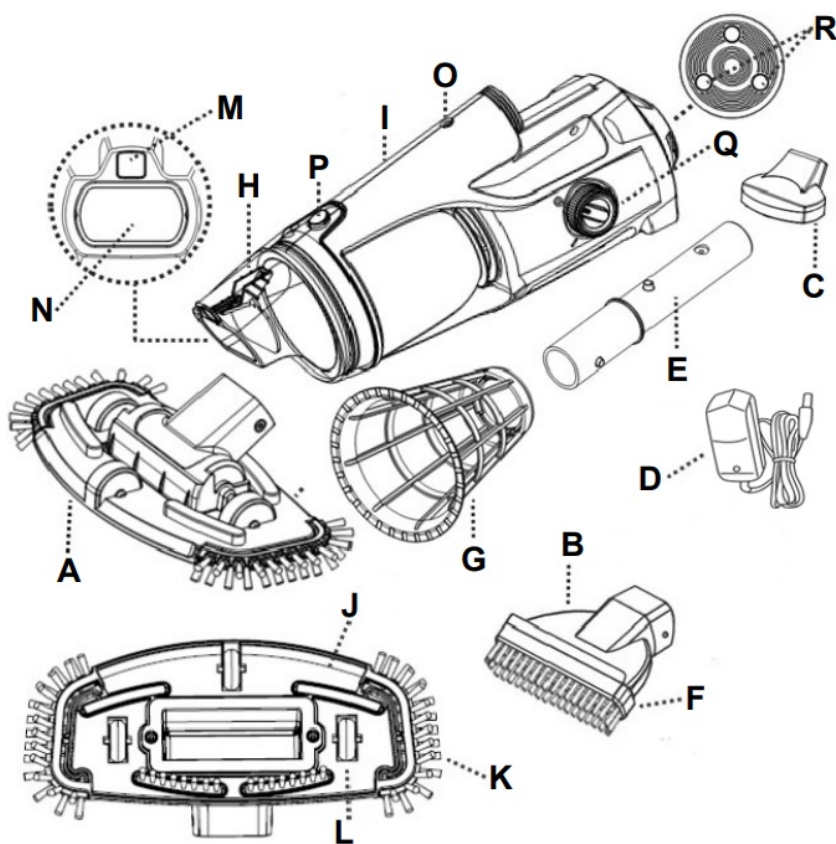

A	Pivoting suction head (with side brushes)
B	Flat Suction Nozzle
C	Charger base
D	External Adaptor
E	Telescopic pole connector
F	Sliding brush
G	Filter cage
H	Transparent canister
I	Main body
J	Brushes
K	Side Brushes
L	Wheel
M	Water draining valve
N	Suction nozzle flap
O	Locking hole(for pole connector /handle)
P	Locking button(for transparent canister)
Q	Power ON/OFF Switch
R	Charging contact plate

Battery: Rechargeable

Internal Li-ion battery pack,
2000mAh, 7.4VDC, 14.8Wh

Charging voltage : 8.4V DC, 1.0 A

Motor: 7.2V DC

SAFETY INFORMATION

Information contained in this Instruction Manual will help you operate the item safely, protect yourself and others from hazards, and prevent damage to the device and other property.

SAVE THESE INSTRUCTIONS

WARNING!

- This is not a TOY. Children should be kept out of reach from this pool vacuum and its accessories.
- Never allow children to operate this product.
- This pool vacuum is not intended for use by someone with reduced physical, sensory or mental capabilities, or a lack of experience and knowledge unless they have been given instructions concerning the appliance and are under supervision of the person responsible for their safety.
- Make sure the pool vacuum is fully immersed in the water before operation. The minimum water level required

to operate the device must reach above the power ON/OFF switch of the pool vacuum when it is held in a vertical position. Operating the pool vacuum when it is not immersed in the water correctly could damage the unit and void the warranty as a result.

- Maximum operating depth in water is 3 meters (10ft).
- Maximum water temperature: 5°C (41°F) –35°C (95°F)
- **DO NOT** use power extension cords.
- Connect the external adaptor to a power source through a ground fault circuit interrupter (GFCI). If in doubt, consult a qualified professional electrician.
- Do not use this pool vacuum if any damage is detected.
- Replace damaged parts as soon as possible. Only use parts certified by the distributor or manufacturer.
- Turn off the power, disconnect the external adaptor from the power source, and unplug the external adaptor from the charging base before detaching the pool vacuum from the charging base.
- Disconnect the pool vacuum from the supply mains prior to carrying out user maintenance such as cleaning the filter.
- Detach the pool vacuum from the charging base and make sure the pool vacuum is OFF before servicing the product.
- Battery installed is a rechargeable Li-ion battery pack. Never attempt to replace the battery pack.
- The pool vacuum is only to be used with the external adaptor delivered with this product.
- You should not operate this pool vacuum when people/pets are present in the water.
- **DO NOT** use this pool vacuum without an intact filter cage in place, as your warranty will be voided as a result.
- Suction entrapment hazard: This pool vacuum generates suction. Do not allow hair, body, or any loose parts of your clothing to contact the suction hole of the pool vacuum during its operation.
- Never insert body parts, clothing or other objects into the openings and moving parts of the pool vacuum.
- **DO NOT** use this pool vacuum to pick up any toxic substance, flammable or combustible liquids such as gasoline, or in the presence of explosive or flammable fumes.
- Never attempt in any way to disassemble this pool vacuum.
- Under no circumstances should you attempt to disassemble the pool vacuum and replace the impeller, motor, and battery by yourself.
- Never insert any object to touch the impeller.
- External adaptor and charging base:
 - For indoor use only.
 - Never use the external adaptor and charging base for anything other than charging the battery of the pool vacuum that is supplied in the same pack.
 - The external adaptor and charging base should not be used outdoors, nor exposed to rain, humidity, any liquid or heat.
 - Keep the external adaptor and charging base out of reach of children.
 - Never use the external adaptor and charging base if any damage is detected.
 - **DO NOT** handle the external adaptor and charging base with wet hands.
 - **DO NOT** handle the pool vacuum, external adaptor, and charging base while charging with wet hands and without shoes.
 - Keep the external adaptor disconnected from power when it is not in use.
 - Never attempt to open the external adaptor and charging base.
 - If the supply cord is damaged, it must be replaced by the manufacturer, its service agent or an equally qualified person in order to prevent hazards of any kind.

- Make sure the pool vacuum and the charging base are completely dry before charging.
- This pool vacuum is designed for underwater use only; it is not an all-purpose vacuum cleaner. **DO NOT** attempt to use it to clean anything other than your pool / spa.
- Use only original accessories delivered with this product.
- **DO NOT** use this pool vacuum right after chlorinating/shocking the pool due to high chlorine levels. It is recommended to leave the pool circulating for at least 24-48 hours.
- It is not recommended to use this pool vacuum with another pool vacuum/cleaner simultaneously.
- Avoid picking up hard, sharp objects with this product. They may damage the pool vacuum and filter.
- Exercise caution when cleaning pool stairs.
- Only use the charging base for its intended purpose as outlined in this manual.
- To avoid damaging the external adaptor and the cord, do not carry the pool vacuum by the cord or pull the cord to disconnect it from the power source and product.
- Charge the pool vacuum indoor in a clean, dry area with good ventilation and an ambient temperature between 5°C (41°F) and 30°C (86°F).
- **DO NOT** leave the pool vacuum charging for over 10 hours.
- If the pool vacuum will not be used for an extended period, detach it from the charging base and use a damp cloth to clean and dry the pool vacuum and accessories. Make sure to charge the pool vacuum to about 30% to 50% of the battery capacity before it is stored. Store in a well-ventilated area away from sunlight, heat, ignition sources, pool chemicals, and children. Never leave the pool vacuum plugged in for long-term storage. Recharge the pool vacuum every three months.

Above warnings and cautions are not intended to incorporate all possible instances for risks and / or severe injuries.

Pool / spa owners should always exercise extra caution and common sense when utilizing the product.

GETTING STARTED

IMPORTANT NOTE: Fully charge the electric vacuum before using it for the first time.

Charging the battery

WARNING!

- Never use the external adaptor and charging base if any damage is detected.
- Make sure the pool vacuum and the charging base are clean and dry before set-up.
- **DO NOT** handle the pool vacuum, external adaptor and charging base while it is charging with wet hands and without shoes.
- Connect the external adaptor to the power source through a ground fault circuit interrupter (**GFCI**).
- Charge the pool vacuum with the original external adaptor provided.
- **DO NOT** use power extension cords.
- Fully charge the battery before first use.
- Charging must be done indoors, in a dry & well-ventilated area away from sunlight, children, heat, ignition sources, and with an ambient temperature between 5°C (41°F) and 30°C (86°F).
- Always disconnect the external adaptor from the power source when charging is complete.
- Do not leave the pool vacuum charging for over 10 hours.

- Immediately turn the power off and disconnect the external adaptor from the power source if you detect any of the following conditions: offensive or unusual odor, excessive heat, deformation, cracks, leaks or smoke

1. Place the unit on a flat surface. Make sure the pool vacuum is off by turning the power **ON/OFF** switch to the **OFF** position prior to charging.

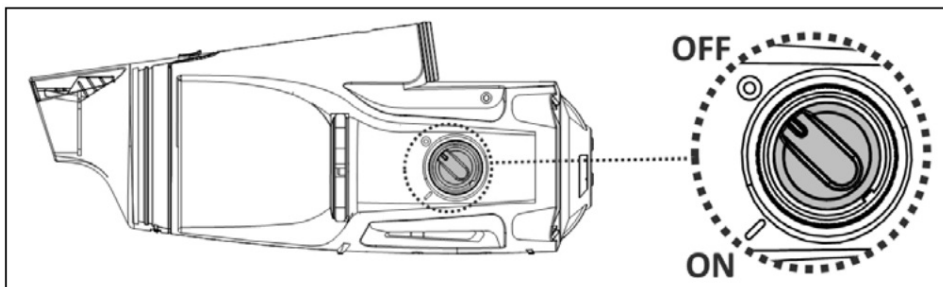

2. Align and slide the hook of the charging base onto the side notch at the bottom of the main body until it stops. Make sure their contact plates are properly in contact.

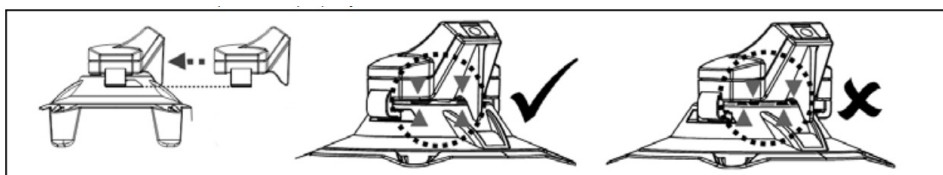

3. Plug the jack of the external adaptor or into the charging port at the end of the charging base.

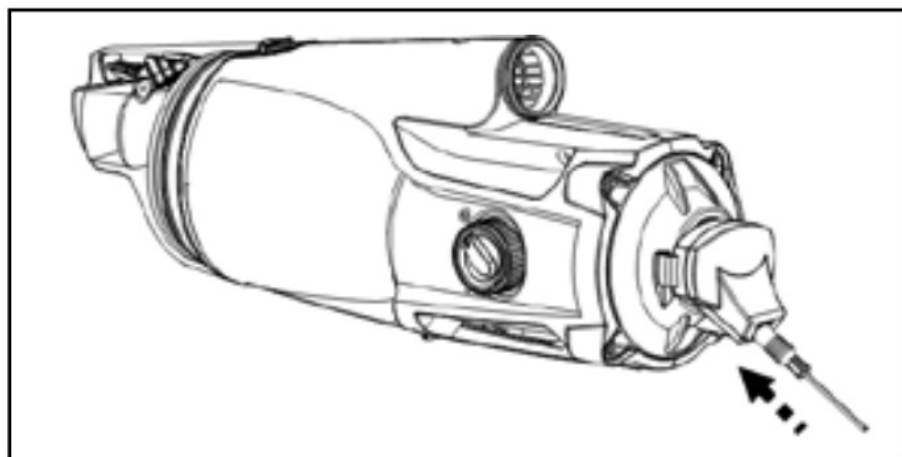

4. Connect the external adaptor to the power source. Once the pool vacuum begins charging, the indicator light on the external adaptor will turn red. Normally, it takes about 4- 5 hours to reach a full charge. The indicator light will turn green when the pool vacuum is almost fully charged.
5. When charging is complete, disconnect the external adaptor from the power source then unplug the jack from the charging base.
6. Detach the charger base from pool vacuum. Store charger base and external adapter in a cool dry place till next use.

NOTE:

- In case, charging plates get wet, dry the area completely before charging.
- Normally, the pool vacuum can be operated up to 30 minutes on a full charge (charged for 4-5 hours)
- **FACT:** Rechargeable lithium-Ion battery is classified as a consumable item. It has a limited life and will gradually lose its capacity to hold a charge. Therefore, running time of the pool vacuum will gradually reduce through repeated charging and discharging in operation.

- Let the pool vacuum rest for 30 to 40 minutes before charging it again.

ASSEMBLY

Suction head assembly

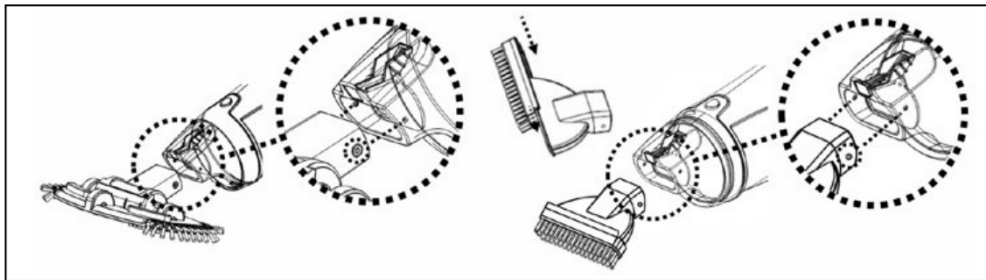

Insert the suction head directly into the suction mouth of the pool vacuum until the side tabs of the transparent case clip in the holes of the suction head's pivot.

Note: For vinyl liner and fiberglass pools / spas, it is recommended to keep the brush on the flat nozzle to avoid damaging the pool / spa.

Telescopic pole connector assembly

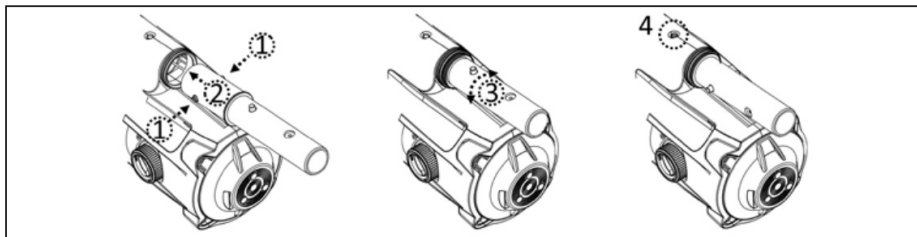

1. Press down the side pins of the connector/handle. 2. Insert the pole connector inside the main body.
2. Turn the connector in either direction until the pin is secured in the hole 4. Pin will protrude through hole.

Telescopic pole (not included)

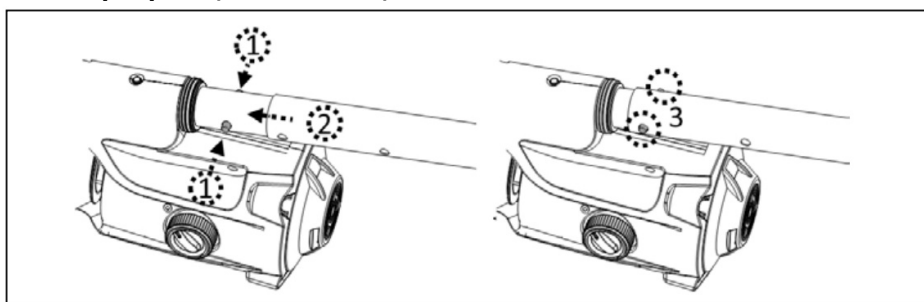

1. Press down on both side tabs.
2. Slide telescopic pole over pole connector/handle
3. Allow tabs to snap into side holes on pole.

To release the telescopic pole, press down on both the side tabs simultaneously, and then pull out the pole.

OPERATION

WARNING!

- Do not use the pool vacuum if any damage is detected.
- Oil stain could occur due to possible leakage of lubricants applied to the O-ring.
- Do not operate this pool vacuum if there are people/pets present in the water.
- Make sure the pool vacuum is fully immersed in the water before initiating operation. The minimum water level required to operate the device must reach above the power ON/OFF switch of the pool vacuum when it is held in a vertical position. Operating the pool vacuum when not immersed in the water correctly can damage the unit and the warranty will be voided as a result.
- Maximum operating depth in water is 3 meters (10ft).
- Maximum water temperature: 5°C (41°F) –35°C (95°F)
- **DO NOT** use the pool vacuum without an intact filter cage in place. Using your pool vacuum without an intact filter cage in place will VOID your warranty.
- **Suction entrapment hazard:** This pool vacuum generates suction. Do not allow hair, body or any loose parts of your clothing to contact the suction mouth of the pool vacuum during its operation.
- Never insert body parts, clothing or other objects into the openings and moving parts.
- **DO NOT** use this pool vacuum to pick up any toxic substance, flammable or combustible liquids such as gasoline, or operate in the presence of explosive or flammable fumes.
- **DO NOT** cover the side slot of the cleaner body during operation. The impeller/motor may be damaged as a result.
- Never insert any object to touch the impeller.

Fully submerge vacuum under water before turning on.

1. Immerse the vacuum in the pool/spa and turning the power ON/OFF switch to the ON position.
2. Continue lowering so that the pivoting head contacts the bottom of the pool/spa, and slowly move the vacuum across the bottom to collect debris into the filter cage of the vacuum
3. When filter cage is full or task is complete, remove the pool vacuum from the pool/spa, lift the pool vacuum while pointing it downwards to allow water to escape from the vacuum and pole.
4. Immediately after removing the vacuum from the pool / spa turn the power ON/OFF switch to the OFF position.

Then, you can empty the filter bag and charge the vacuum for the next use.

NOTE: Rinse the pool vacuum with fresh water after every use. DO NOT use any detergent.

CAUTION

- Use only original accessories delivered with this product.
- **DO NOT** use this pool vacuum immediately after pool-shocking. It is recommended to leave the pool circulating for at least 24-48 hours.
- It is not recommended to use this pool vacuum with another pool vacuum/cleaner simultaneously.
- **DO NOT** leave the pool vacuum in the water when it is not in use or when battery is low as water leakage may occur.
- Make sure the pool vacuum is always facing downwards when it is inserted or removed from pool. Otherwise it may bend the pole connector and damage it during the process.

EMPTYING THE FILTER CAGE

WARNING! Using the electric vacuum without a filter cage in place will VOID your warranty.

To maximize the cleaning efficiency of the cleaner, be sure to clean the filter cage before and after each use.

CAUTION! If the electric vacuum is charging, disconnect the external adaptor from the power source and detach the pool vacuum from the charger base.

1. Place the pool vacuum on a stable surface.
2. Press the locking button until the locking hole on the clear canister can swing off freely.
3. Clean out the debris and rinse the filter cage with water. If brushing is deemed necessary, use only a soft brush to clean the cage gently and carefully.

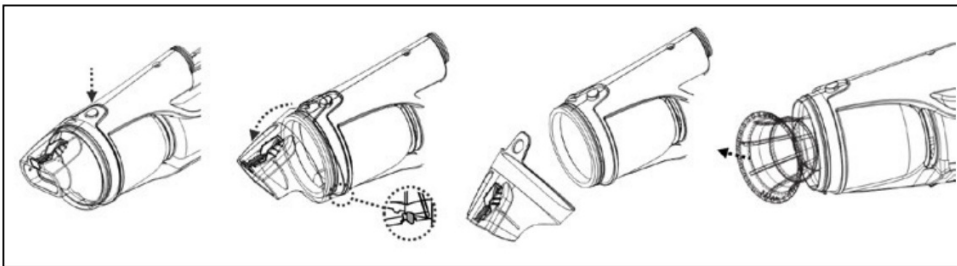

4. Re-position the filter cage inside the main body. Make sure the filter cage is completely inserted inside the main body.
5. Re-install the canister, by first aligning the notch of the canister with the hook on the bottom of the main body and then swing the canister onto main body. Make sure the locking hole on the clear canister is secured with the locking button.

MAINTENANCE & STORAGE

1. Battery discharges on its own during storage. Make sure to charge the pool vacuum to about 30% to 50% of the battery capacity before it is stored.
2. You must re-charge the battery at least once every three months when it is not in use.

- Unplug the external adaptor from socket and then unplug the adapter jack from the charging base.
- Detach accessories from the pool vacuum. If necessary, rinse the pool vacuum and accessories with fresh water.

DO NOT use detergent.

- Make sure to drain the water from the unit, handle and pole connector.
- Use a damp cloth to clean and dry the pool vacuum and its accessories.
- Store them in a well-ventilated area away from the sunlight, children, heat, ignition sources, and pool chemicals.

Ambient temperature for storage should be 10°C – 25°C (50°F – 77°F). NOTE: A higher temperature may reduce the battery life during storage.

WARNING!

- Never attempt in any way to disassemble the pool vacuum.
- Under no circumstances should you attempt to disassemble the pool vacuum and replace the impeller, motor and battery.

CAUTION!

- Excessive heat can damage the battery and reduce its lifespan as a result.
- Consult your dealer regarding battery replacement if the following happens:
 - Battery does not charge fully.
 - Battery operation time is noticeably reduced. Observe and record the run times of the first few operations (on a full charge). Use these run times as a reference point to compare with run times of older batteries.
- The battery must be removed from the pool vacuum before it is scrapped.
- The pool vacuum must be disconnected from the supply mains when removing the battery
- The battery is to be disposed safely and according to local ordinances or regulations.

NOTE: Incorrect maintenance may reduce the battery life and affect its capacity as a result.

TROUBLESHOOTING

Problem	Possible Cause	Solution
Pool vacuum does not capture debris	Battery is running out	Charge the battery again.
	Impeller is jammed	Power off the pool vacuum and visually check the gap in the middle of the pool vacuum to see if the impeller is jammed by large debris. If possible, use a small tool to remove the debris carefully. WARNING! Make sure the pool vacuum is powered off when the unit is being serviced.
	Impeller is broken	Replace main body
	Filter cage is full	Clean the filter cage.
Debris escapes from the filter	Suction nozzle flap is broken	Suction nozzle flap works like a door to prevent debris from escaping from the filter. Replace nozzle flap
	Filter cage is damaged.	Replace with a new filter cage.
	Outlet valve comes off.	Without the outlet valve, the pool vacuum might capture debris through this opening. Replace Transparent canister
	Debris is too fine	Filter bag will not collect fine silt or algae less than 250 micron in size.
Pole connector can't be secured.	Side pin on pole connector is broken	Replace with a new pole connector.
Pool vacuum can not be charged / recharged	Battery is damaged	Replace main body WARNING! DO NOT open the pool vacuum and replace the battery by yourself. This could result in severe or fatal injury and the warranty will be voided as a result.
	Contact plates of the charger base and unit are not connected.	Make sure that the charger base is assembled on the unit properly and the contact plates are connected.
	External adaptor damaged	Replace external adaptor or WARNING! Using the wrong external adaptor will result in damaging the pool vacuum / battery and voiding the warranty as a result.
Pool vacuum does not move smoothly	Wheel is jammed	Clean out the debris from the wheel.

PROJECT SOURCE and logo design are trademarks or registered trademarks of LF, LLC. All rights reserved.



Questions, problems, missing parts? Before returning to your retailer, call our customer service department at 866-439-9800, 8 a.m. – 8 p.m., EST, Monday – Sunday.

You may also contact us anytime at ascs@lowes.com.



Documents / Resources

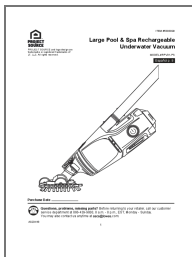

[PROJECT SOURCE RPV31-PS 11 in Handheld Pool Vacuum](#) [pdf] User Manual
RPV31-PS 11 in Handheld Pool Vacuum, RPV31-PS, 11 in Handheld Pool Vacuum, Handheld Pool Vacuum, Pool Vacuum, Vacuum

References

- [User Manual](#)