



PROJECT SOURCE G-3 Refrigerator Water Filter User Manual

[Home](#) » [PROJECT SOURCE](#) » PROJECT SOURCE G-3 Refrigerator Water Filter User Manual 

Contents

- [1 PROJECT SOURCE G-3 Refrigerator Water Filter](#)
- [2 TROUBLESHOOTING](#)
- [3 CARE AND MAINTENANCE](#)
- [4 WARRANTY](#)
- [5 SAFETY INFORMATION](#)
- [6 INSTALLATION OVERVIEW](#)
- [7 SPECIFICATIONS](#)
- [8 Documents / Resources](#)
 - [8.1 References](#)
- [9 Related Posts](#)



PROJECT SOURCE G-3 Refrigerator Water Filter



PROJECT SOURCE and logo design are trademarks or registered trademarks of LF, LLC. All rights reserved.

Thank you for purchasing this Project Source Refrigerator Water Filter. We've created these easy-to-follow instructions to ensure you have a simple installation process. But, if you need more information than what is provided here, please visit [Lowes.com](https://www.lowes.com), search the item number and refer to the Guides & Documents tab on the product's page.

If the item is no longer for sale, or if you have any questions or problems, please call our customer service department at 1-866-389-8827, 8 a.m. – 8 p.m., EST, Monday – Sunday. You could also contact us at partsplus@lowes.com or visit www.lowespartsplus.com.

TROUBLESHOOTING

PROBLEM	POSSIBLE CAUSE	CORRECTIVE ACTION
Missing O-Ring	Manufacturer Error	Call Customer Service for replacement: 866-389-8827
Leaking	Improper Installation	Remove and reinstall, ensuring the filter is securely installed within the refrigerator housing.
Slow Flow	Improper Installation	Submerge filter without safety cap in a bowl or sink full of water for 45 minutes to 1 hour, reinstall.

CARE AND MAINTENANCE

Replace filter every 6 months or 300 gallons, whichever precedes.

WARRANTY

This replacement filter cartridge is warranted to be free from defects in material and manufacture for one (1) year from the date of purchase. This warranty does not cover any failures resulting from abuse, misuse, alteration, or damage not caused by the manufacturer or failure to follow proper installation and use instructions. If the product fails to satisfy this limited warranty during the described period, the manufacturer will replace or refund the purchase price of the product. This warranty does not cover additional costs such as labor.

SAFETY INFORMATION

WARNING

To reduce the risk of property damage due to water leakage, this filter **MUST** be installed in accordance with the manufacturer's specifications and instructions. Installation shall comply with applicable state and local regulations. For cold water applications only. Do not use water that is microbiologically unsafe or of unknown quality without adequate disinfection before or after the system. Systems certified for cyst reduction may be used on disinfected waters that may contain filterable cysts. This filter unit must be replaced every 6 months, at the rated capacity, or sooner if reduced water flow occurs. Failure to follow instructions and operating specifications will void your warranty. Further, the manufacturer assumes no responsibility or liability for damages arising out of misuse of the product. Protect from freezing.

INSTALLATION OVERVIEW

1. Locate the filter housing and open the cartridge cover by pushing in where indicated and the cover will drop down.

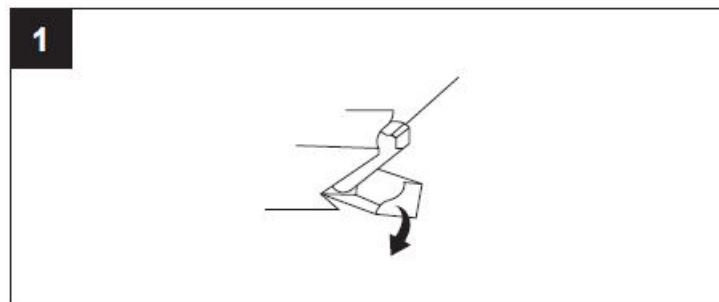

2. Remove the existing water filter by slowly rotating it counterclockwise. A small amount of water may drip from the water filter.

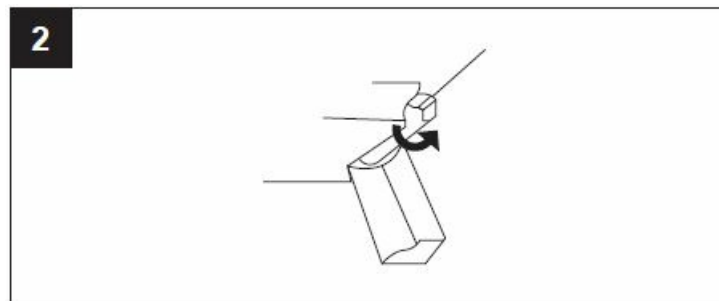

3. Carefully remove the sanitary cap from the top of the new filter.

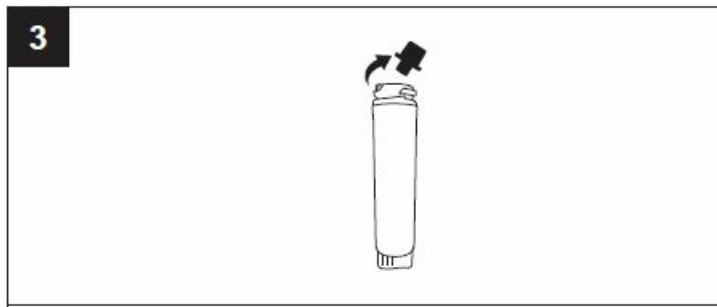

4. Position the filter inside of the filter housing and slowly rotate the filter clockwise until it stops. When the filter is properly installed, you will feel it “click” as it locks into place. The blade on the end of the water filter should be in the vertical position when it is fully installed. Do not over-tighten.

Note: Please ensure the filter is fully installed as it is required to activate the internal water valve. If the filter isn’t properly installed, you may experience a slow flow or a chattering noise. If this occurs, please uninstall and reinstall the filter ensuring the filter is fully installed.

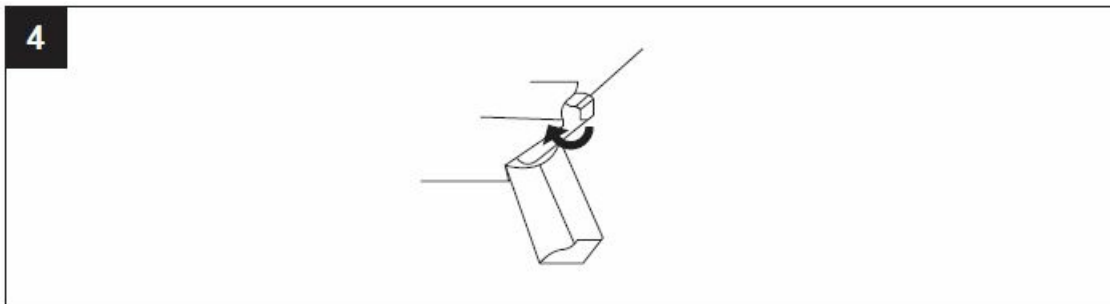

5. Close the cartridge cover.

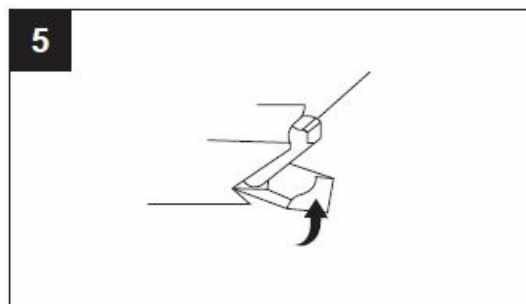

6. Run approximately 2.5 gallons of water from the dispenser periodically to clear the system and to receive a good flow. If the water flow is slower than usual, please repeat Step 4.

Note: Initial flow rate may be slower than expected. Full flow rate should be restored within 24-36 hours.

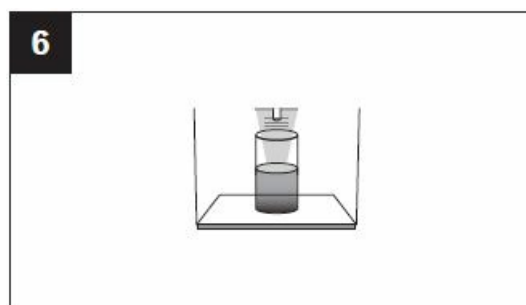

7. Inspect the filter for any noticeable leaks. If leaks are detected, please repeat Step 4.

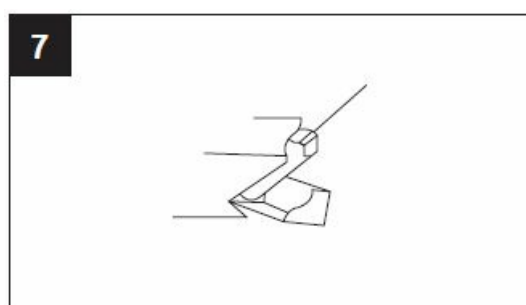

8. To reset the filter monitor light, please refer to your refrigerator owner's manual for specific instructions.

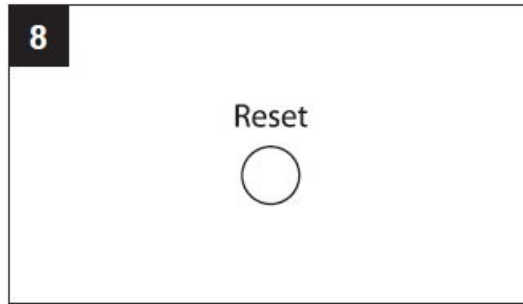

9. Locate the included Water Filter Replacement Calendar and follow the instructions on the label.

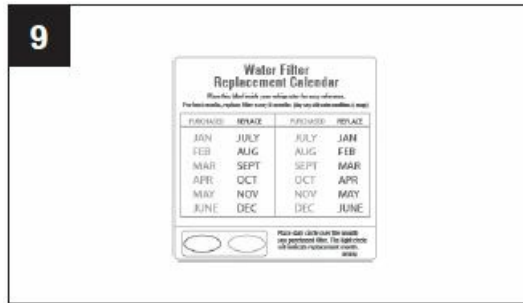

SPECIFICATIONS

- **Flow Rate:** .5 gpm (1.89 lpm)
- **Operating Temperature:** 33°-100°F (0.6°-38°C)
- **Min Operating Pressure:** 30 psi (207 kPa)
- **Max Operating Pressure:** 100 psi (689 kPa)
- **Capacity:** 6 months or 300 gallons (1,136 liters)

This G-3/G-3-2 is Tested and Certified by NSF International against NSF/ANSI Standard 42 and 53 for the reduction of chlorine taste and odor, Tetrachlorethylene, Endrin, Carbon Tetrachloride, Trichlorobenzene, p-Dichlorobenzene. Refer to the performance data sheet for a complete list of claims.

This G-3/G-3-2 is Certified by IAPMO R&T against NSF/ANSI Standard 42, 53, 372, 401, P473, and CSA B483.1 for the reduction of Chlorine taste and odor, Lead, Cyst, VOC, Mercury, Asbestos, Pharmaceuticals (such as Naproxen, Ibuprofen, and Phenytoin), BPA, PFOA/PFOS. Refer to Performance Data Sheet for a complete list of claims.

The compounds under NSF/ANSI 401 have been deemed as 'incidental contaminants / emerging compounds'.

Documents / Resources

	PROJECT SOURCE G-3 Refrigerator Water Filter [pdf] User Manual G-3, G-3-2, G-3 Refrigerator Water Filter, G-3, Refrigerator Water Filter, Water Filter, Filter
---	---

References

- [Lowe's Parts Plus](#)

