

**ProdataKey Red 1 High Security Controller**



# ProdataKey Red 1 High Security Controller User Guide

[Home](#) » [prodatakey](#) » ProdataKey Red 1 High Security Controller User Guide 

## Contents

- 1 ProdataKey Red 1 High-Security Controller
- 2 Product Information
- 3 Product Usage Instructions
- 4 FAQ
- 5 Package Contents
- 6 Mounting Controller
- 7 Reader Connection
- 8 Input A/ DPS Connection
- 9 Locking Relay
- 10 Communication Connections
- 11 Power Connection
- 12 OSDP Reference Guide
- 13 Documents / Resources
  - 13.1 References



**ProdataKey Red 1 High-Security Controller**



## Product Information

### Specifications:

- Brand: ProdataKey, Inc.
- Product Series: RED SERIES HARDWARE
- Model: Red 1 High-Security Controller

## Product Usage Instructions

### Installation:

1. Locate a suitable mounting location for the Red 1 High-Security Controller.
2. Securely mount the controller using appropriate screws and tools.
3. Connect the necessary cables as per the user manual.

### Setup:

1. Power on the Red 1 High-Security Controller.
2. Follow the setup wizard on the connected device to configure the controller.
3. Set up user access levels and permissions as needed.

### Operation:

1. Use the provided credentials or access method to interact with the controller.
2. Monitor access logs and system status regularly for security purposes.
3. Troubleshoot any issues following the troubleshooting guide in the user manual.

## FAQ

- **Q: How do I reset the Red 1 High-Security Controller?**

- A: To reset the controller, locate the reset button on the device and hold it down for 10 seconds until the device restarts.

- **Q: Can I expand the capacity of the Red 1 High-Security Controller?**

- A: Yes, you can expand the capacity by adding compatible expansion modules as per the user manual instructions.

## Quick Start Guide

### Package Contents

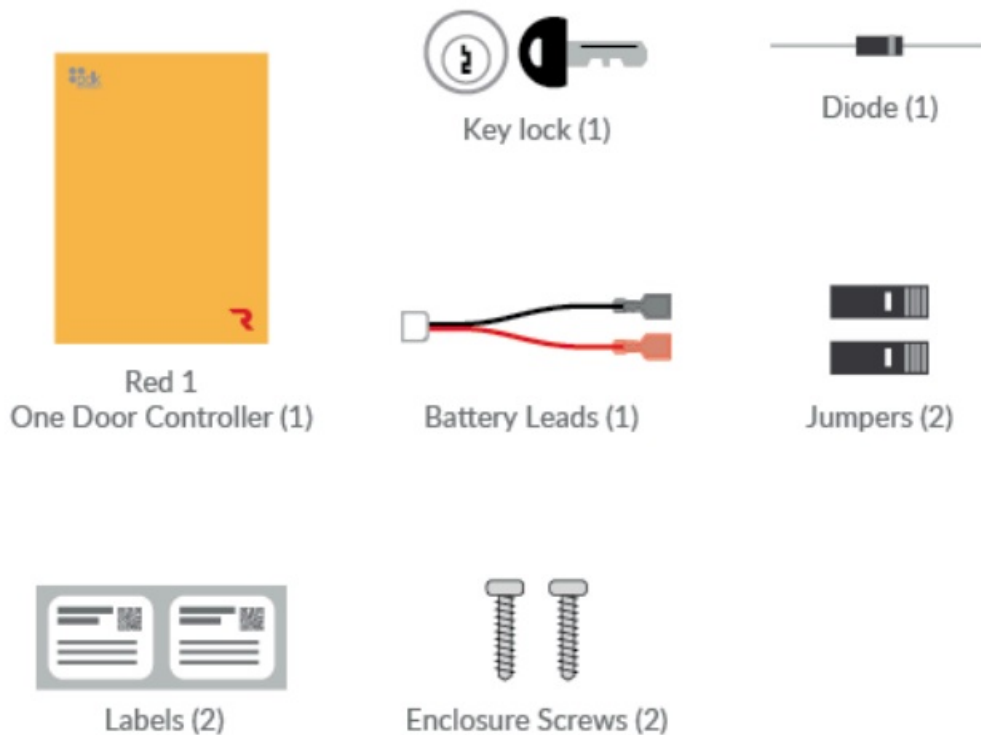

## Mounting Controller

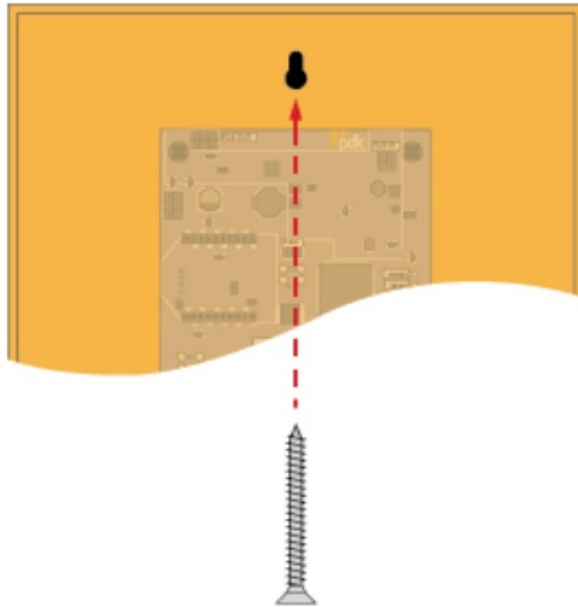

**Mount** - Mount the Red 1 enclosure securely to a wall.

## Reader Connection

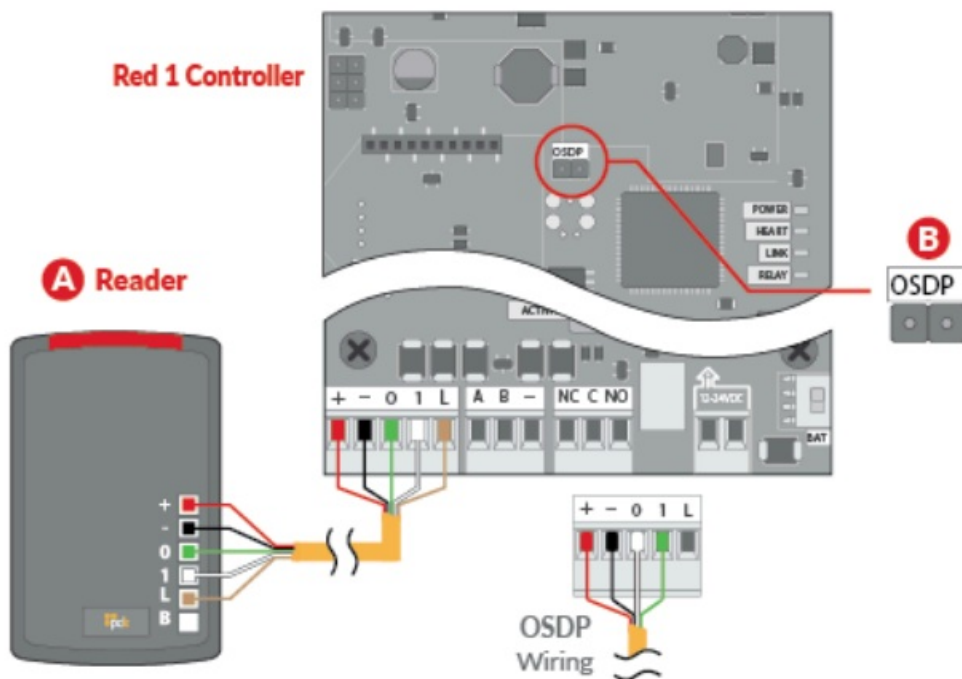

- A Reader · The reader is mounted at the door with a 22/5 or 22/6 wire ran to the door controller. Wire the reader to the controller as shown above. Be sure to check polarity and voltage prior to powering controller.
- B OSDP · Place jumper to enable OSDP (see OSDP reference guide at the end of this guide for more info)

## Input A/ DPS Connection

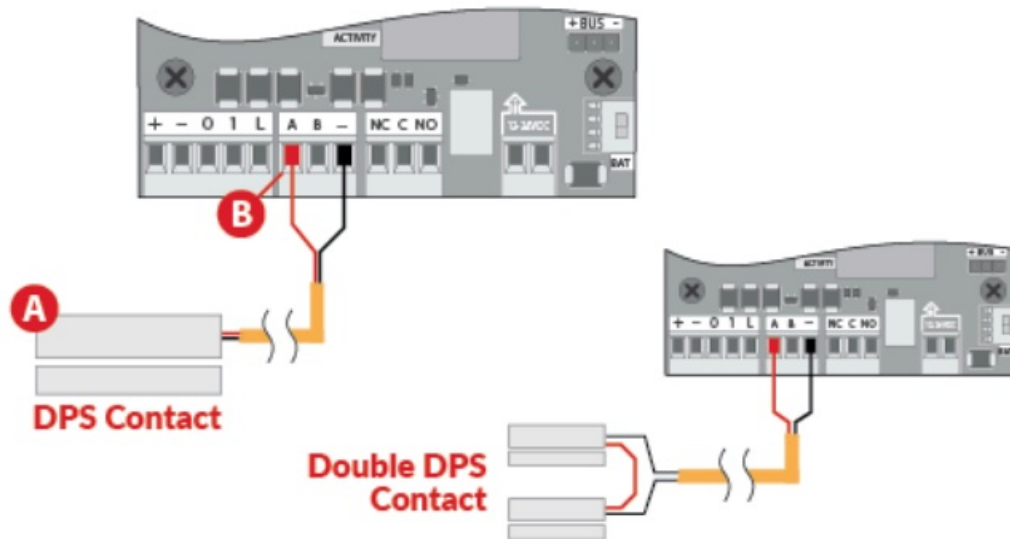

- A DPS (Door Position Switch) – The OPS is mounted on the door frame in the desired location with a 22/2 wire running from the OPS to the controller. Wire the DPS to the controller as shown above. When using two OPS sensors for double doors you will wire them in series with only two conductors running back to the controller for connection.
- B AUX Input -A rule can be setup to trigger events or outputs based on this input trigger.

## Input B / REX Connection

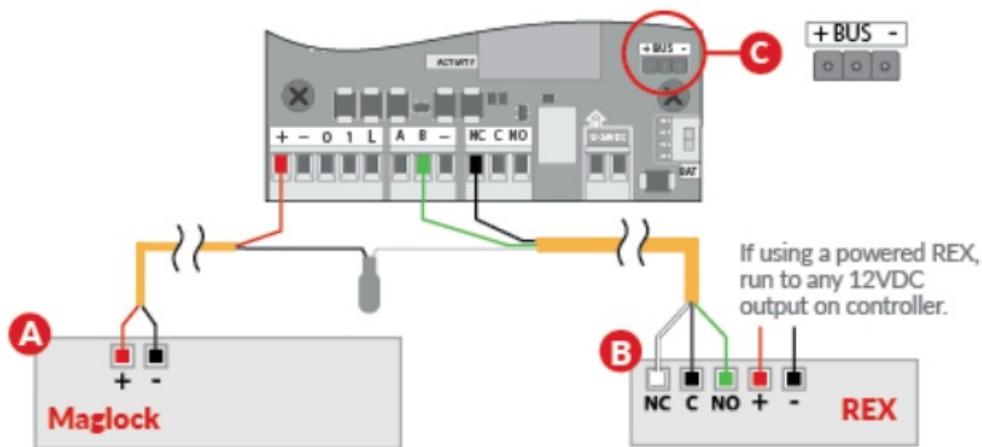

- A Maglock – When installing a Maglock it is typical to install a REX (ReQuest to Exit) at the door for free egress. Run an 18/2 wire from the Maglock to the Door Controller, connecting to the Maglock as shown.
- B REX (Request to Exit) – The REX is mounted in the desired location with an 18/5 wire ran from the REX to the controller. Wire the REX to the controller and maglock as shown above. If reporting is not needed in the system , simply eliminate the green labeled wire.
- C Jumper Block – Use to designate(+) or(-) board voltage out of NO and NC. If jumper is off, the relay is a standard dry contact needing input into
- AUX Input – A rule can be setup to trigger events or outputs based on this input trigger.

## Locking Relay

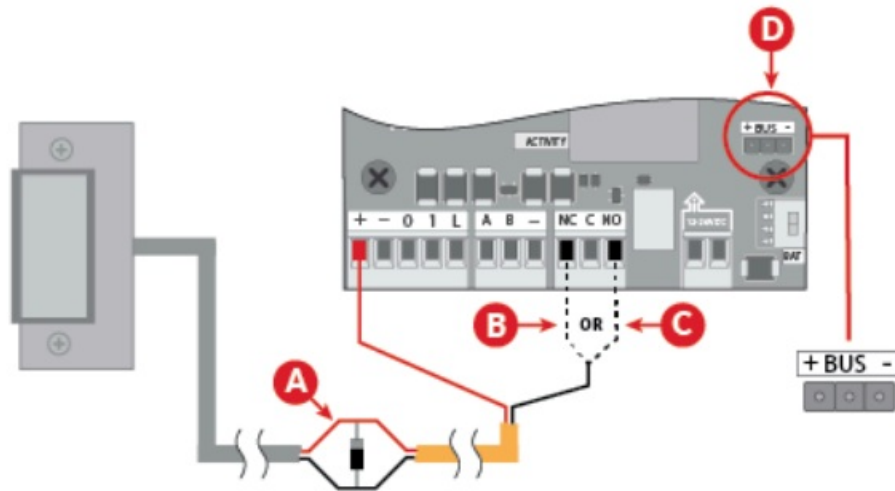

- **A Diode** – The provided diode must be installed when using a strike. Install at the strike with the grey stripe of diode on positive and the black on negative.
- **B NC** – Used for maglocks (or strikes in fail-safe configuration). Connect the negative(-) of the maglock or strike to NC on the door controller.
- **C NO** – Used for strikes in fail-secure configuration. Connect the negative(-) of the strike to NO on the door controller.
- **D Jumper Block** – Use to designate(+) or(-) board voltage out of NO and NC. If jumper is off, the relay is a standard dry contact needing input into

## Communication Connections

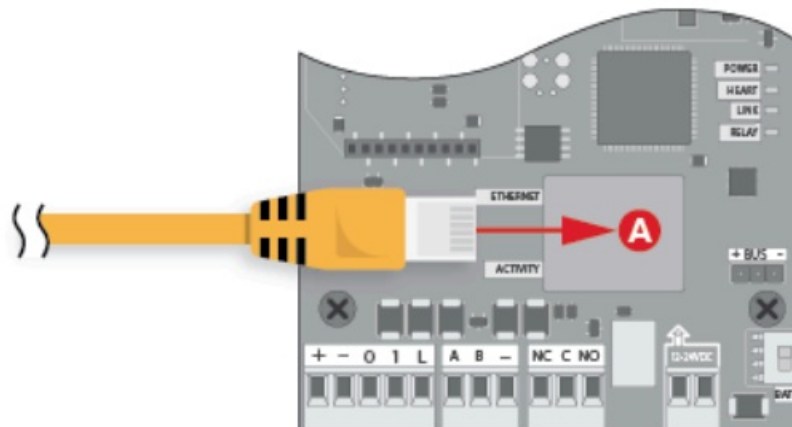

- **A Ethernet** – All Red controllers come with a built in RJ45 connection for network connectivity. Once connected the Red 1 controller is
- Self-Discoverable from pdk.io using IPV6. Alternatively you may use IPV4 or assign a static IP using pdk.io if desired.
- Wireless (PN: RMW) and PoE (PN: RM POE) module kits can be purchased for optional communication add-ons.



## Power Connection

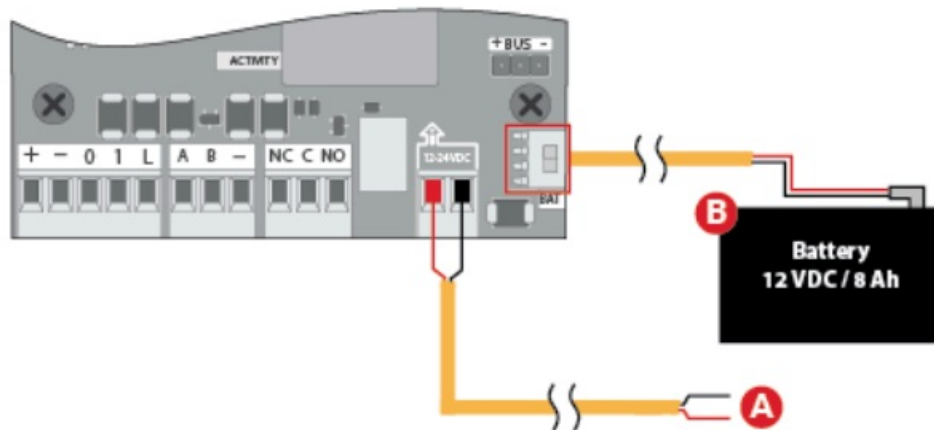

- **A DC INPUT** – Use the included 14VOC, 2 amp transformer for DC power input. It is recommended to use 18/2 wire. For high voltage applications, use the HV converter (PN: HVQ)
- **B BATTERY** -The enclosure will fit most 12 VOC 8 Ah batteries. The battery is connected with supplied leads and is polarity sensitive. Receive up to 8 hrs of battery backup using a strike in fail-secure.

## Reference Guide

- **Fire Input** -To integrate the fire system using a Red 1 door controller, refer to wiring diagrams in the Partner Portal at [www.prodatakey.com/resources](http://www.prodatakey.com/resources)
- **Proi:rammini**: – After the Red 1 door controller has been connected back to the Cloud Node, access the configuration software as instructed in the programming manual. This manual is available for download through the Partner Portal at [www.prodatakey.com/pdkio](http://www.prodatakey.com/pdkio)
- **Reader Compatibility** – ProdataKey does not require proprietary readers. Door controllers accept a wiegand input, including biometric readers and keypads. OSOP readers are supported by using included jumper (see OSOP reference guide). Contact support for details.
- **UL 294 Compliance** – All equipment must meet appropriate UL certifications. For UL listed installations, all cable runs must be less than 30 meters (98.5')
- **Part Number** – RI

## PDK Technical Support

- Phone: 801.317.8802 option #2
- Email: [support@prodatakey.com](mailto:support@prodatakey.com)
- POK Knowledge Base: [prodatakey.zendesk.com](https://prodatakey.zendesk.com)

## OSDP Reference Guide

- What Is OSOP -Open Supervised Device Protocol (OSDP) Is an access control communications standard developed by the Security Industry Association to Improve Interoperability among access control and security products. OSDP brings heightened security and Improved functionality. It Is more secure than Wiegand and supports AES-128 encryption.
  - **OSDP Wire Specification** – Four (4) conductor twisted pair overall shield Is recommended to remain fully TIA-48S compliant at maximum supported baud rates and cable distances.
  - **NOTE** -It's possible to reuse existing Wiegand wiring for OSDP, however, using single stranded cable typical of Wiegand readers generally does not meet the RS485 twisted pair recommendations.
  - **OSDP Multi-Drop** – Multi-drop gives you the capability to accommodate many readers by running one length of 4-conductor cable, eliminating the need to run wire for each wire.
  - **NOTE** -Four (4) Is the maximum number of readers each port can support
  - **NOTE** -Wiegand readers will not work when OSDP Jumpers are Installed
- 

## Documents / Resources

	<p><a href="#">ProdataKey Red 1 High Security Controller</a> [pdf] User Guide Red 1 High Security Controller, Red 1, High Security Controller, Security Controller, Controller</p>
---	--

## References

- [User Manual](#)

### [Manuals+](#). [Privacy Policy](#)

This website is an independent publication and is neither affiliated with nor endorsed by any of the trademark owners. The "Bluetooth®" word mark and logos are registered trademarks owned by Bluetooth SIG, Inc. The "Wi-Fi®" word mark and logos are registered trademarks owned by the Wi-Fi Alliance. Any use of these marks on this website does not imply any affiliation with or endorsement.