



# PROBEAM PB-DS-14-BLK Dynamic Strips LED Turn Signals Instruction Manual

[Home](#) » [PROBEAM](#) » PROBEAM PB-DS-14-BLK Dynamic Strips LED Turn Signals Instruction Manual 

## Contents

- [1 PROBEAM PB-DS-14-BLK Dynamic Strips LED Turn Signals](#)
- [2 Part Numbers](#)
- [3 Package Contents](#)
- [4 ATTENTION](#)
- [5 Installation](#)
- [6 Documents / Resources](#)
- [7 Related Posts](#)



**PROBEAM PB-DS-14-BLK Dynamic Strips LED Turn Signals**



We thank you for purchasing the Custom Dynamics® ProBEAM® Dynamic Strips™ LED Turn Signals! Our LEDs offer maintenance free service and higher visibility. Our ProBEAM® product line utilizes the latest technology and automotive grade components to ensure the highest level of reliable service. Custom Dynamics® offers one of the best warranty programs and customer support in the industry. If you have any questions during the installation of this product please call us at 1(800) 382-1388.

## Part Numbers

- PB-DS-14-BLK (Black)
- PB-DS-14-CRM (Chrome)
- PB-DS-14-CON (Contrast Cut)

## Package Contents

- ProBEAM® Dynamic Strips™ (pair)
- A/W Converter (pair)
- 4" Black Tie Wraps (8)
- 5/16" 18x1 1/4" Button Head Bolt(4)
- Finished Flat Washer (4)

**Fitment:** All 2014 -2022 Street Glide Models (including CVO) and 2014-2022 FLHT Models Without Driving Light Buckets

## ATTENTION

- **Warning:** Disconnect negative battery cable from battery; refer to owner's manual. Failure to do so may result in electrical shock, injury, or fire. Secure negative battery cable away from positive side of battery and all other positive voltage sources on vehicle.
- **Safety First:** Always wear appropriate safety gear including safety glasses when performing any electrical work. It is highly recommended that safety glasses be worn throughout this installation process. Be sure vehicle is on level surface, secure and cool.
- **Cleaning:** Take special care in cleaning the finish. Use only a non-abrasive cleaner and a fine microfiber cloth to remove dirt or debris. Never use abrasive polishes or cleaners as these can scratch the finish.

## Installation

1. Remove the 1/2" nuts that secure the turn signal assembly to the fork shown in Picture 1. Pull assembly away from the fork to re-veal the black wiring connector as shown in Picture 2.
2. Unplug the connector by pushing in on the tab located on the male side of the connection as shown in Picture 3. Push the tab and pull apart both sides at the same time. Remove the turn signal assembly from the bike completely.



3. Remove the mounting studs on the fork with a 9/16" wrench or deep well socket.
4. Repeat steps 1 through 3 on the opposing side turn signal assembly.

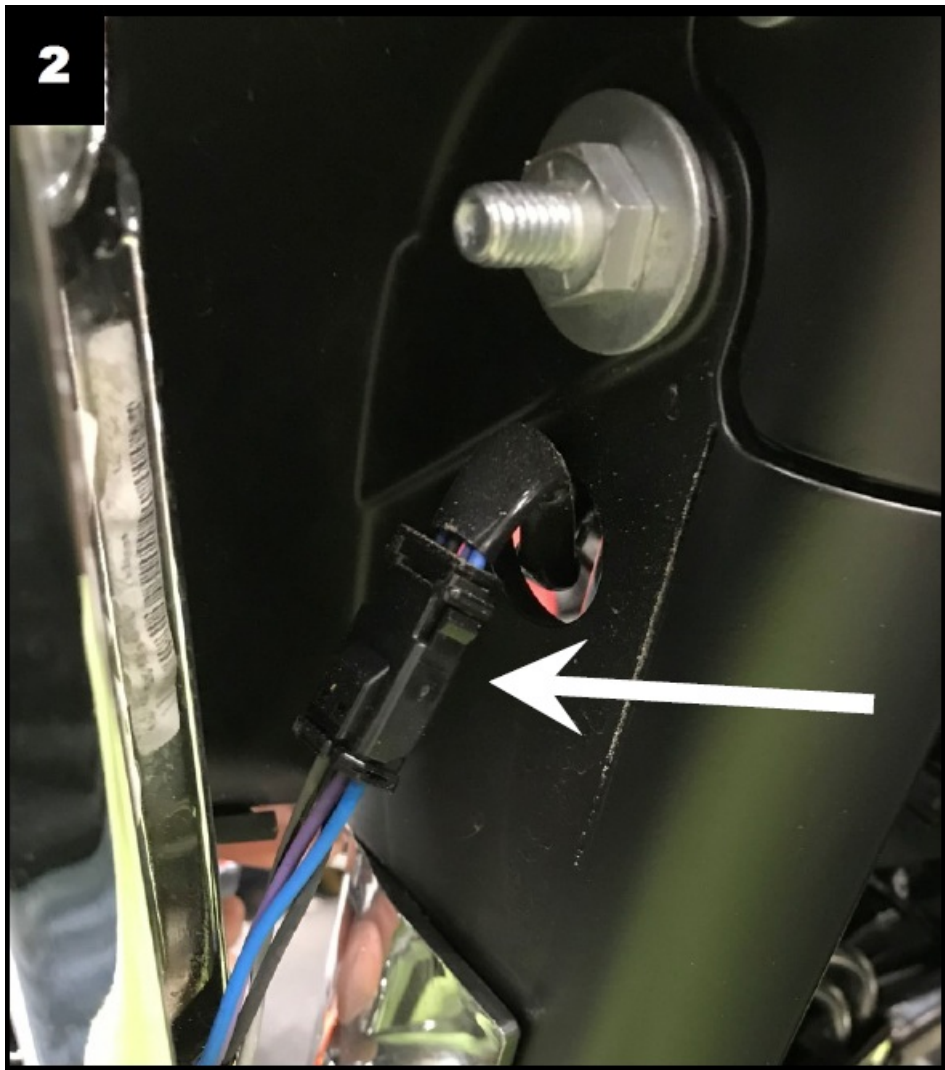

5. Remove the 3 top T27 Torx Bolts from the outer fairing as shown in Picture 4. Remove the windshield and store it in a safe place for reinstallation later.
6. Reinstall the center T27 Torx Bolt only that was removed in Step 4. Lightly tighten the center bolt to secure the fairing while you remove the remaining 4 inner fairing bolts.
7. Remove the 2 T27 Torx bolts from the left and the right side of the inner fairing as shown in Picture 5. Save the bolts for reinstallation.
8. While standing in front of the bike and holding the fairing, remove the center outer fairing T27 Torx bolt and pull the fairing slightly away from the bike.
9. With the fairing slightly pulled away from the bike, disconnect the connector from the headlamp. Lay the fairing on a protected flat surface to prevent damage.
10. With the fairing removed, plug in the male connector of the of the AW Con-verter harness into female connector on the turn signal factory wiring harness. Repeat step for the opposing side.



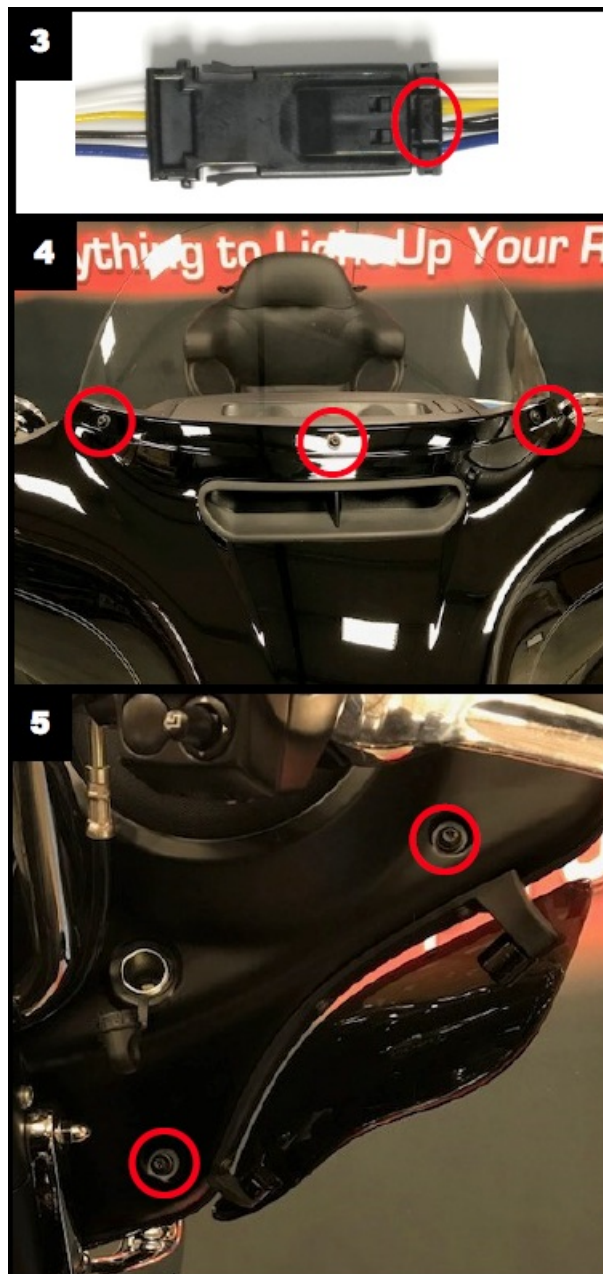

11. Push the male plug on the ProBEAM® Dynamic Strips™ harness into the hole in the fork frame and plug it into the female connector of the A/W Convert-er.
12. Install the ProBEAM® Dynamic Strips™ onto the fork frame and secure with the provided 5/16" button head bolts and washers. The LEDs should be on the bottom of the ProBeam® Dynamic Strips™ when mounted to the fork. Repeat step for the opposing side.
13. Using the provided wire ties, secure the ProBEAM® Dynamic Strips™ wiring harnesses and A/W converters to prevent the wires from being damaged during fairing installation.
14. Reinstall the fairing and windshield in the reverse order that it was removed. NOTE: THE 4 INNER FAIRING BOLTS ARE TWO DIFFERENT LENGTHS! The 2 longer bolts go in the top holes and the 2 shorter bolts go in the bottom holes of the inner fairing.
15. Run the 4 way hazard flashers, with the ignition in the off position, for 3 minutes to sync BCM with the ProBEAM® Dynamic Strips™. After you have sync'd the BCM check for proper operation of all lighting in all modes.

### Questions?

Call us at: 1 (800) 382-1388 M-TH 8:30AM-5:30PM / FR 9:30AM-5:30PM EST

	<p><a href="#">PROBEAM PB-DS-14-BLK Dynamic Strips LED Turn Signals</a> [pdf] Instruction Manual PB-DS-14-BLK, PB-DS-14-CRM, PB-DS-14-CON, PB-DS-14-BLK Dynamic Strips LED Turn Signals, PB-DS-14-BLK, Dynamic Strips LED Turn Signals, Strips LED Turn Signals, LED Turn Signals, Turn Signals, Signals</p>
---	--