



# PROAIM VCTR-LT-HAP Height Adjustable Telescopic Poles Instruction Manual

[Home](#) » [PROAIM](#) » PROAIM VCTR-LT-HAP Height Adjustable Telescopic Poles Instruction Manual 

## Contents

- [1 PROAIM VCTR-LT-HAP Height Adjustable Telescopic Poles](#)
- [2 Height Adjustable Telescopic Poles for Victor Lite Carts \(VCTR-LT-HAP\)](#)
- [3 Specifications](#)
- [4 Product Usage Instructions](#)
- [5 Telescopic Poles Setup](#)
- [6 FAQ](#)
- [7 Documents / Resources](#)
  - [7.1 References](#)



**PROAIM VCTR-LT-HAP Height Adjustable Telescopic Poles**



## Height Adjustable Telescopic Poles for Victor Lite Carts (VCTR-LT-HAP)

### Specifications

- Height Range: 2.46ft / 29.6 to 1.67ft / 20.1
- Material: Aluminum

### What's In The Box

Please inspect the contents of your shipped package to ensure you have received everything that is listed below:

- 4 x Height Adjustable Telescopic Poles



4 x Height Adjustable Telescopic Poles

### Telescopic Poles Setup

NOTE: Two people are required to detach the top shelf from the foldable rods.

## **Product Features**

- The height of the top shelf can be adjusted from 2.46 feet / 29.6 to 1.67 feet / 20.1
- The aluminum poles easily lock into place at the desired height range, ensuring longevity and ease of use.

## **Product Usage Instructions**

### **Step 1: Unboxing**

Inspect the contents of the package to ensure you have received all the height adjustable telescopic poles.

### **Step 2: Setup**

NOTE: Two people are required to detach the top shelf from the foldable rods.

1. Attach the height-adjustable telescopic poles to the designated slots on the Victor Lite Cart.
2. Ensure the poles are securely attached and locked into place.

### **Step 3: Adjusting the Height**

To adjust the height of the top shelf:

1. Locate the locking mechanism on each telescopic pole.
2. Release the locking mechanism by pressing the button or lever.
3. Extend or retract the pole to the desired height range.
4. Release the button or lever to lock the pole into place.
5. Repeat the above steps for each telescopic pole.

## **Telescopic Poles Setup**

- Remove the locking knobs at all corners of the top shelf of the Victor Lite Cart (Not Included) by loosening them.
- Now, remove the top shelf by lifting it upwards.

NOTE: Two people are required to detach the top shelf from the foldable rods.

- After removing the top shelf, loosen and remove the bolts and washers of the rod on the bottom shelf.
- After removing the bolts from the Foldable Rod, loosen the locking knobs from both sides, as shown in the image.
- Now, remove the Foldable Rod from the bottom shelf.
- Similarly, follow the same steps to remove the remaining rods.
- All rods from the Victor Lite Cart (Not Included) have been removed.
- Loosen and remove the bolts of the Adjustable Telescopic Poles.



- Follow the same process to remove bolts from the remaining Adjustable Telescopic Poles.
- Attach the Adjustable Telescopic Pole to the bottom shelf of the Victor Lite cart.
- After attaching it to the Pole, insert the bolt, as shown in the image.
- After inserting the bolt, tighten it using the Allen key and wrench.
- Detach the Locking knobs, as shown in the image.
- Insert the locking knob in the provided hole of the adjustable Pole and insert the second knob from outside, as shown in the image.
- Tighten the knobs to secure the attachment.
- Remove the upper knob fixed in the adjustable pole by loosening it.

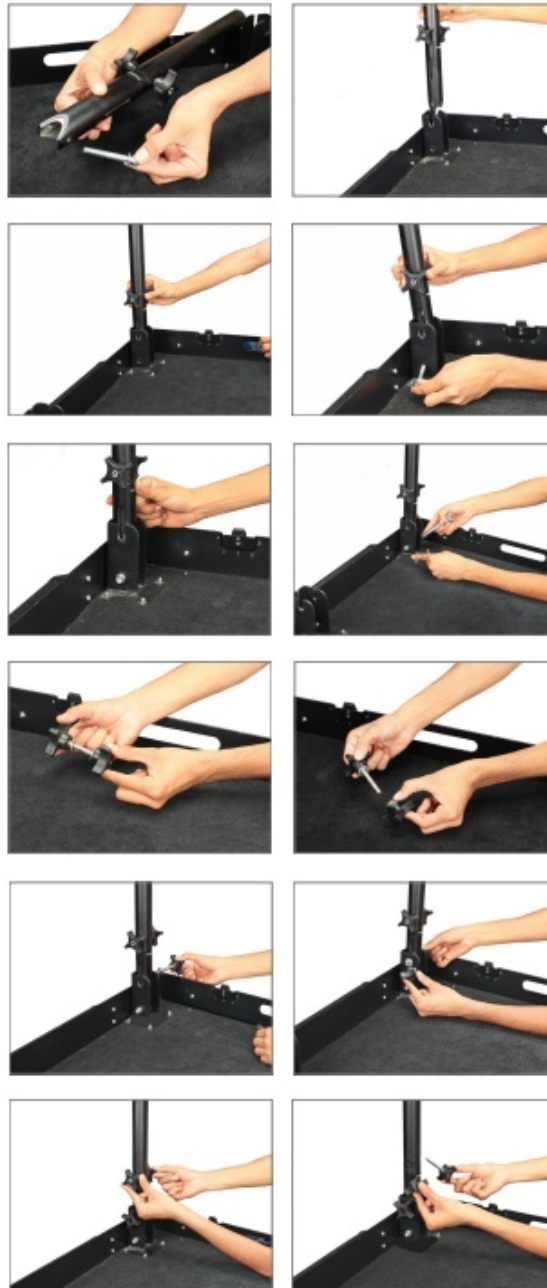

- Adjust the height of the adjustable Pole per your requirement and insert the locking knob in the Pole to fix the Pole.

NOTE: The adjustable poles extend the height and range of operation of the Victor Lite Cart.



### Height Range- 2.46ft / 29.6" To 1.67ft / 20.1"

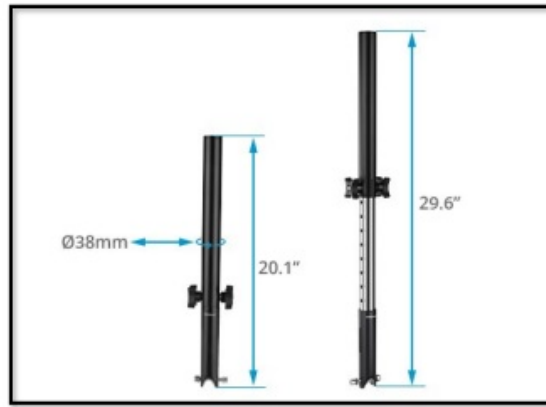

- After inserting the knobs, tighten them to secure the Pole at your desired height.
- Similarly, secure the remaining Poles at the desired height and tighten their knobs, as shown in the image.
- Mount the top shelf of the Victor cart on the rod.
- Insert the Locking knobs on all corners of the top shelf.

Features: The height of the top shelf can be adjusted from 2.46 feet / 29.6" to 1.67 feet / 20.1"

- The locking knobs are properly attached all to four corners of the cart's top shelf.

Feature: The aluminum Poles easily lock into place at the desired height range, ensuring longevity and ease of use.

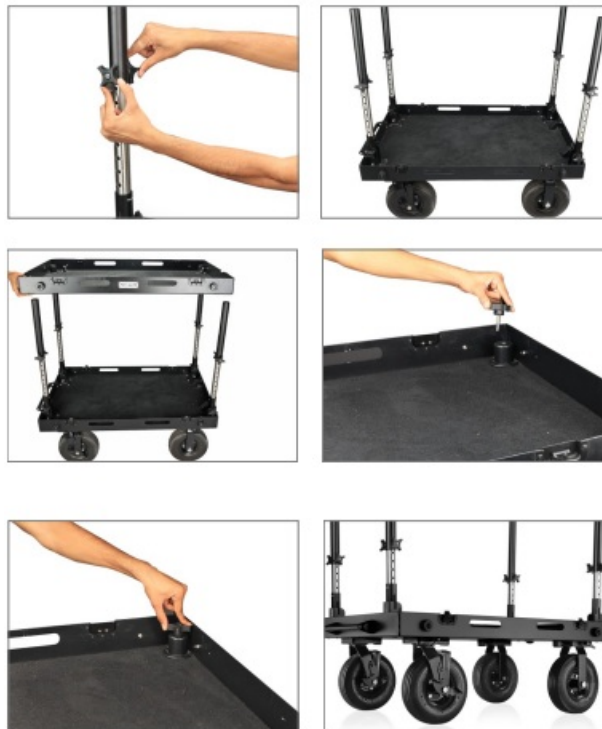

**YOUR PROAIM HEIGHT ADJUSTABLE POLES FOR VICTOR LITE CARTS ARE ALL DRESSED UP AND READY TO GO!**  
**(SHOWN WITH OPTIONAL ACCESSORIES)**



(SHOWN WITH OPTIONAL ACCESSORIES)

- **Warranty:** We offer a year warranty for our products from the date of purchase. Within this period of time, we will repair it without charge for labor or parts. Warranty doesn't cover transportation costs nor does it cover a product subjected to misuse or accidental damage. Warranty repairs are subjected to inspection and evaluation by us.
- **Liability:** We are not liable for damage caused by products that we do not supply or from mishandling in transit, accident, misuse, neglect, or lack of care of the product, or service by anyone other than our company.
- **Contact Us:** In case of any kind of dissatisfaction, please Contact us immediately and we promise our utmost support and care until you use our product.

## FAQ

### Q: What is the height range of the top shelf?

A: The height range of the top shelf is 2.46ft / 29.6 to 1.67ft / 20.1.

### Q: Can I use these poles with other carts?

A: These height-adjustable telescopic poles are specifically designed for use with Victor Lite Carts and may not be compatible with other carts.

### Q: Are the poles made of aluminum?

A: Yes, the poles are made of aluminum, ensuring durability and lightweight.

---

## Documents / Resources

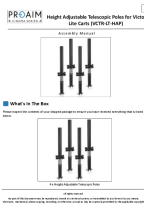
	<p><a href="#">PROAIM VCTR-LT-HAP Height Adjustable Telescopic Poles</a> [pdf] Instruction Manual VCTR-LT-HAP Height Adjustable Telescopic Poles, VCTR-LT-HAP, Height Adjustable Telescopic Poles, Adjustable Telescopic Poles, Telescopic Poles, Poles</p>
---	---

## References

- [User Manual](#)

### Manuals+, Privacy Policy

This website is an independent publication and is neither affiliated with nor endorsed by any of the trademark owners. The "Bluetooth®" word mark and logos are registered trademarks owned by Bluetooth SIG, Inc. The "Wi-Fi®" word mark and logos are registered trademarks owned by the Wi-Fi Alliance. Any use of these marks on this website does not imply any affiliation with or endorsement.