



PROAIM SL-CUR-120-MC Curve-120 Curved Camera Slider Instruction Manual

[Home](#) » [PROAIM](#) » PROAIM SL-CUR-120-MC Curve-120 Curved Camera Slider Instruction Manual 

PROAIM

Curve-120 Curved Camera Slider with Motion
Control System (SL-CUR-120-MC)
Assembly Manual



Contents

- 1 What's In The Box
- 2 Curved Camera slider with End feet Setup
- 3 Proaim Curve-120 curved camera slider with Motion Control System.
- 4 Camera Plate with Motor
- 5 Power the Remote Controller with 2 ways
- 6 Remote Controlled Movement Functions
- 7 Documents / Resources

What's In The Box

Please inspect the contents of your shipped package to ensure you have received everything that is listed below.

Combo-1

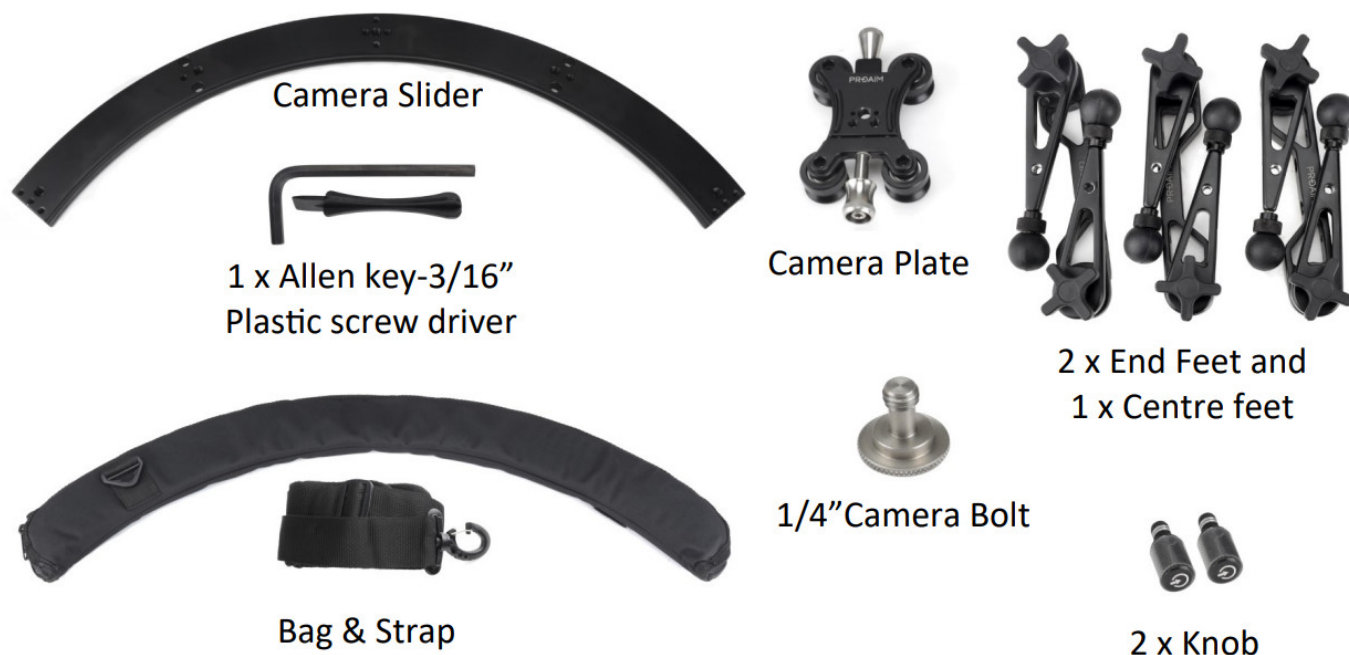

All rights reserved.

No part of this document may be reproduced, stored in a retrieval system, or transmitted by any form or by any means, electronic, mechanical, photo-copying, recording, or otherwise, except as may be expressly permitted by the applicable copyright statutes or in writing by the Publisher.

Combo-2



Curved Camera slider with End feet Setup

- Loosen the knobs of the end feet and open them.



- After opening the feet, secure them by re-tightening with the provided knobs. Follow the same process for all the sets of feet.

NOTE: Attach the center feet to the center part of the slider only.



- Remove the center bolts of the camera slider with the help of an Allen key.



- Remove all the bolts of the Camera Slider from both the sides with the help of an Allen Key, as shown in the image.



- Place the end feet on the slider and then insert bolts, by matching the threads of the slider and the feet. Then

tighten with an Allen key to secure.



- Place the middle feet at the center of the slider and then insert bolts, by matching the threads of the slider and the middle feet. Then tighten with an Allen key to secure.



- Follow the same process to attach the other set of end feet.



- Finally all the feet have been attached to the slider.



- Insert the stopper, by matching the threads of the end feet and tighten properly.



- Follow the same process to insert the other stopper in the 2nd set of end feet .

NOTE: All sets of feet have threads for stoppers except for the center feet. The two end feet stoppers provide support to the camera plate.



- Another additional stopper is included to secure the camera (Not Included) properly.



- Properly insert the camera bolt into the camera plate.



- Loosen the side knobs of the camera plate and attach it on the slider. Then, re-tighten the side knobs.



Proaim Curve-120 curved camera slider with Motion Control System.

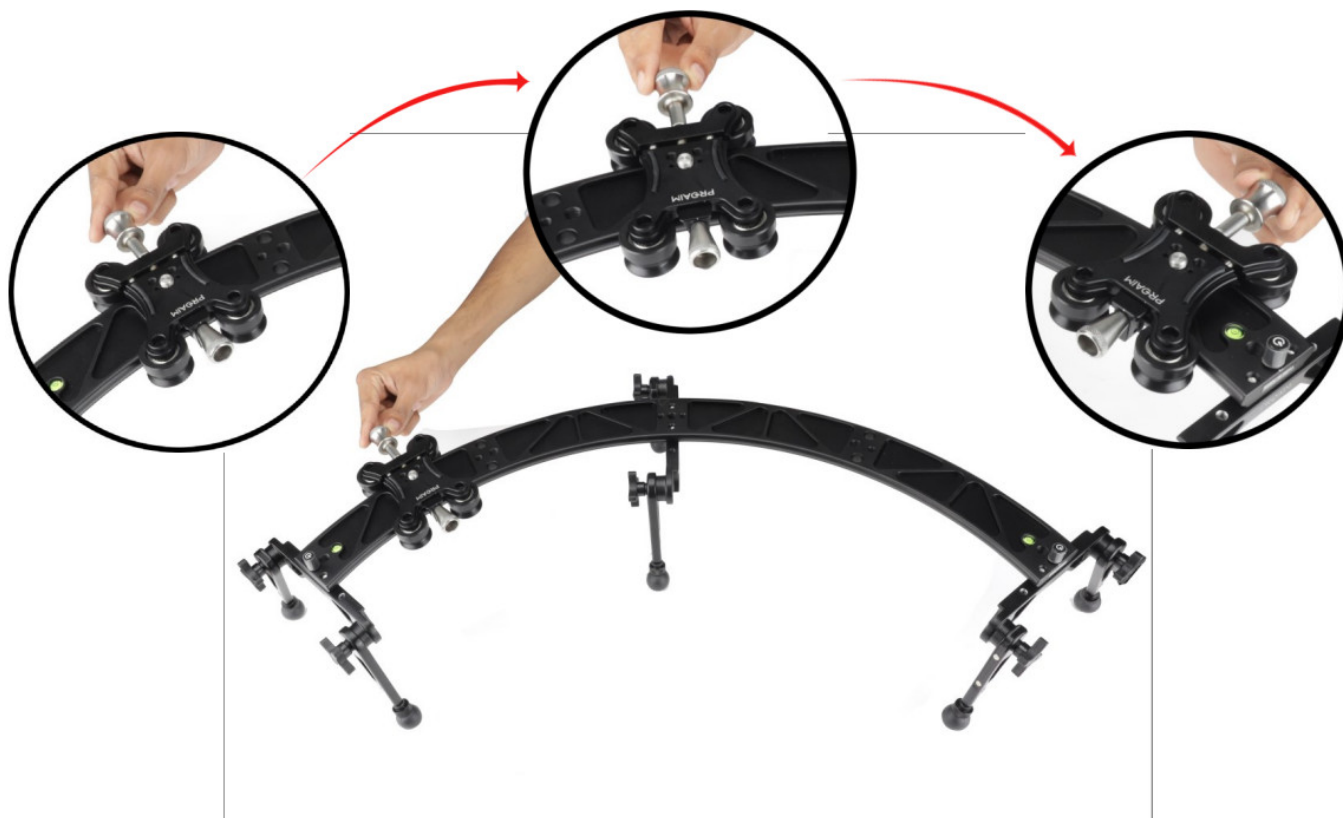

- Attach the camera plate by aligning its threads to the camera and then secure it using the screw driver (Not Included) .



- Then place the camera (Not Included) on the slider & properly tighten the knob of the camera plate.



- The camera (Not Included) is now properly mounted on the slider, as shown in the picture.



Camera Plate with Motor

- Open the motor lever by pulling it, as shown in the image.



- Attach the Camera Plate with Motor to the bottom of the camera (Not Included).



- Then secure it with the help of a screwdriver, as shown in the image.



- Then place the camera (Not Included) on the slider & properly tighten the knob of the camera plate.



- Then attach the motor by connecting it properly to the slider. Thus, powering the slider.

Caution: While performing this step, make sure that your camera plate is mounted onto the slider.



- Attach the Female connector of the motor to one end of the 3 meter wire of DC male connector.



Power the Remote Controller with 2 ways

1. 12v Adapter

- Attach the other end of the 3 meter wire (4 pin hero push pull connector) to the 4 pin male connector on controller.



- Attach one end of the 12v adapter cable to the adapter.



- Then connect the other end of the cable with the battery.



- Connect the electric plug of the 12v adapter wire to the universal adapter for generating the power-supply.



- 12v Adapter: Attach the 12v Adapter with the controller and press the power button.



2. Battery

- Battery: Attach the battery (Not Included) with the controller and press the power button.



Remote Controlled Movement Functions



**YOUR PROAIM CURVE-120 CURVED CAMERA SLIDER WITH MOTION CONTROL SYSTEM
ALL DRESSED UP AND READY TO GO!**



(SHOWN WITH OPTIONAL ACCESSORIES)

Warranty: We offer one year warranty for our products from date of purchase. Within this period of time, we will

repair it without charge for labor or parts. Warranty doesn't cover transportation costs nor does it cover a product subjected to misuse or accidental damage. Warranty repairs are subjected to inspection and evaluation by us.

Liability: We are not liable for damage caused by products that we do not supply or from mishandling in transit, accident, misuse, neglect, lack of care of the product, or service by anyone other than our company.

Contact Us: In case of any kind of dissatisfaction, please Contact us immediately and we promise our utmost support and care until you use our product.



Documents / Resources

	<p>PROAIM SL-CUR-120-MC Curve-120 Curved Camera Slider [pdf] Instruction Manual SL-CUR-120-MC Curve-120 Curved Camera Slider, SL-CUR-120-MC, Curve-120 Curved Camera Slider, Curved Camera Slider, Camera Slider, Slider</p>
---	--