

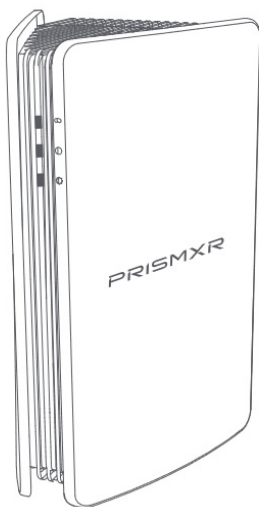

# PRISM XR S1 P1411 Specialized Router User Guide

[Home](#) » [PRISM XR](#) » PRISM XR S1 P1411 Specialized Router User Guide 

## PRISM XR S1 P1411 Specialized Router User Guide



### Quick Start Guide

PrismXR Pupils S1 P1411

## Support

For more information, please visit [www.prismxr.com/pages/support](http://www.prismxr.com/pages/support)

### Contents

- [1 Product Introduction](#)
- [2 LED Indicators and Buttons](#)
- [3 Set Up your Puppis S1](#)
  - [3.1 Connect Puppis S1 and PC](#)
  - [3.2 Get and Download PrismXR App](#)
  - [3.3 Connect to PrismXR App](#)
  - [3.4 Reconnect to PrismXR App](#)
- [4 How to Stream \(PrismPulse Mode\)](#)
  - [4.1 Set Up Internet](#)
  - [4.2 Start Streaming](#)
- [5 Wi-Fi Hotspot Mode](#)
- [6 Wi-Fi Adapter Mode](#)
- [7 Maintenance](#)
  - [7.1 Firmware Update](#)
  - [7.2 Factory Reset](#)
- [8 Safety Instruction](#)
- [9 FCC Statement](#)
- [10 ISED Notice](#)
- [11 ISED RF Exposure Statement](#)
- [12 Documents / Resources](#)
  - [12.1 References](#)

## Product Introduction

The PrismXR Puppis S1 is a specialized router designed for enhanced streaming experience between VR headsets and PCs. It utilizes 802.11AX Wi-Fi technology and a dedicated 5G band to ensure a smooth and stable connection. With the Puppis S1, you can enjoy virtual reality experiences with optimized streaming performance, reduced latency, and improved overall performance. Additionally, it supports both 2.4G Wi-Fi and PC Internet Sharing, providing flexibility in the internet connection. Puppis S1 supports three modes: PrismPulse, Wi-Fi Hotspot, and Wi-Fi Adapter.

- PrismPulse Mode: Establish a high-speed, dedicated connection between your PC and HMD.
- Wi-Fi Hotspot Mode: Function as an access point, establishing a Local Area Network (LAN) for PCs and other wireless devices.
- Wi-Fi Adapter Mode: Function as a client to enable your PC to connect to the Internet.

Download the PrismXR App to enhance your experience, including mode switching, upload or download rate, network monitoring, Wi-Fi settings, device management, firmware updating, and more.

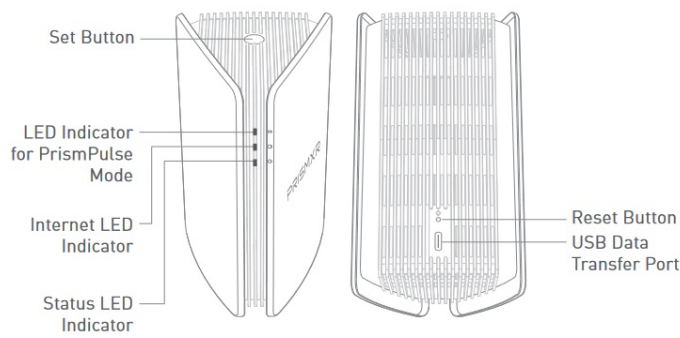

## LED Indicators and Buttons

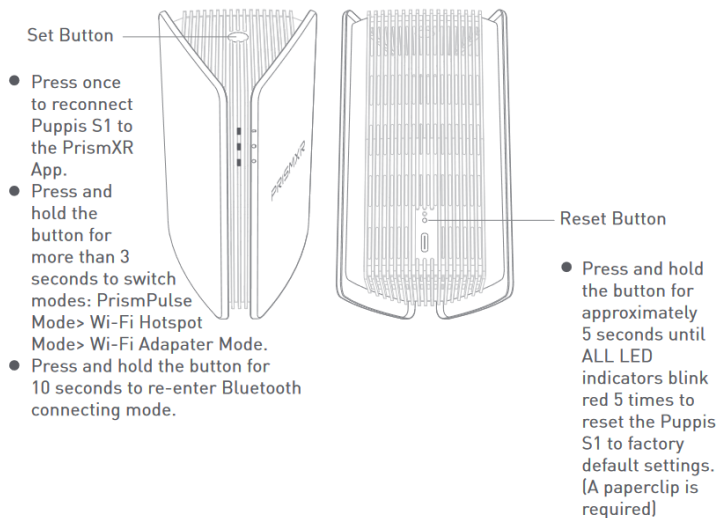

## Set Up your Puppis S1

### Connect Puppis S1 and PC

Note: It will take about 30 seconds for the Puppis S1 to boot up.

#### Requirements

- a** Your PC should have two USB-A 3.0 ports, or one USB-A 3.0 port and one USB-A 2.0 port. Alternatively, you can use a USB 3.0 C-C data transfer cable (not provided).
- b** Please insert the provided USB cable into the corresponding ports on your PC. Inserting the cable in reverse will result in slower data transfer speeds.

1. Insert the blue-marked male USB-A into the USB-A 3.0 port on the PC, and insert the white-marked male USB-A into another USB-A 3.0 or USB-A 2.0 port on the PC.

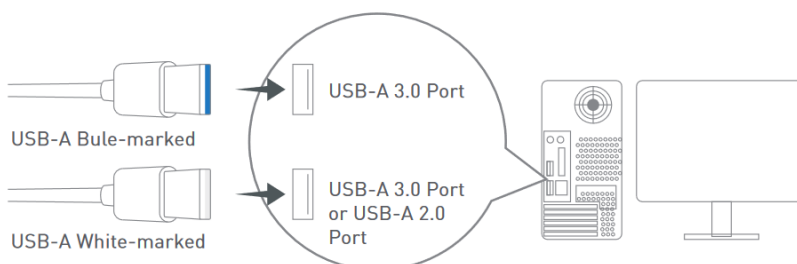

2. Position the side of the USB-C male connector labeled “L” to the left, and the side labeled “R” to the right, then insert it into the Puppis S1.

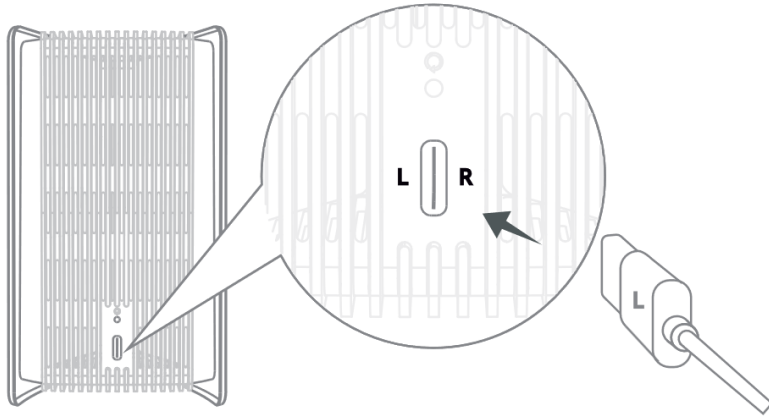

3. The Puppis S1 will perform as follows after it finishes booting up:

- a** Enter pending HMD and Bluetooth connecting mode with LED Indicator for PrismPulse Mode flashes blue and Status LED Indicator flashes white.
- b** The Internet LED Indicator is red due to the device not being connected to the network.

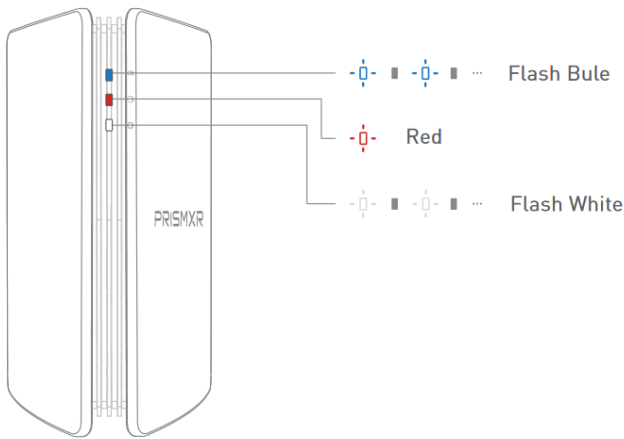

### Get and Download PrismXR App

- Method 1: Scan the QR code.



<https://www.prismxr.com/pages/downloads>

- Method 2: Search for the PrismXR App on the Apple App Store or Google Play Store.



App Store and App Store logo  
are trademarks of Apple Inc.



Google Play and the Google Play logo  
are trademarks of Google LLC.

## Connect to PrismXR App

### Notes:

- PrismPulse mode only supports internet access via 2.4GHz networks or PC Internet sharing.
- If the status LED indicator stops flashing white, press and hold the SET button for 10 seconds to enter Bluetooth connecting mode.

1. Make sure your Puppis S1 is in Bluetooth connecting mode with the Status LED indicator flashes white.

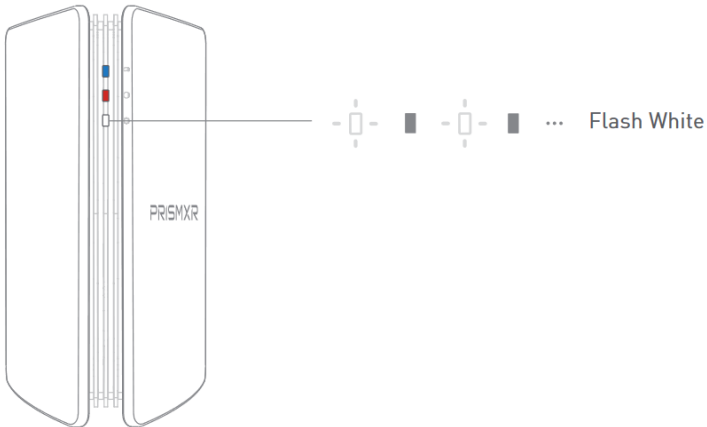

2. Open the PrismXR App, there will be a pop-up notification "Puppis S1 is Found". Select "Add" to add the Puppis S1 to the App.

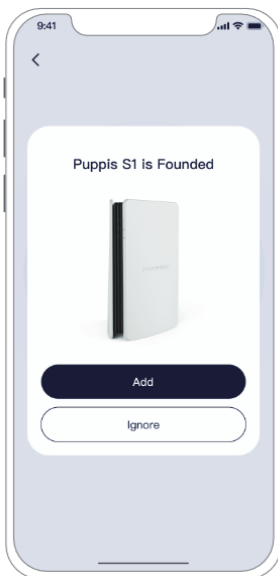

## Reconnect to PrismXR App

To ensure maximum smoothness of PC VR streaming, the Bluetooth connection between the App and the Puppis S1 is not always maintained. Instead, it automatically disconnects after 30 minutes when the App is exited and running in the background. You can follow the steps below to reconnect the Puppis S1 to the App.

1. Open the PrismXR App.
2. Press the SET button on the Puppis S1 once, and the Puppis S1 will enter Bluetooth connecting mode.
3. Your Puppis S1 will automatically reconnect to the PrismXR App.

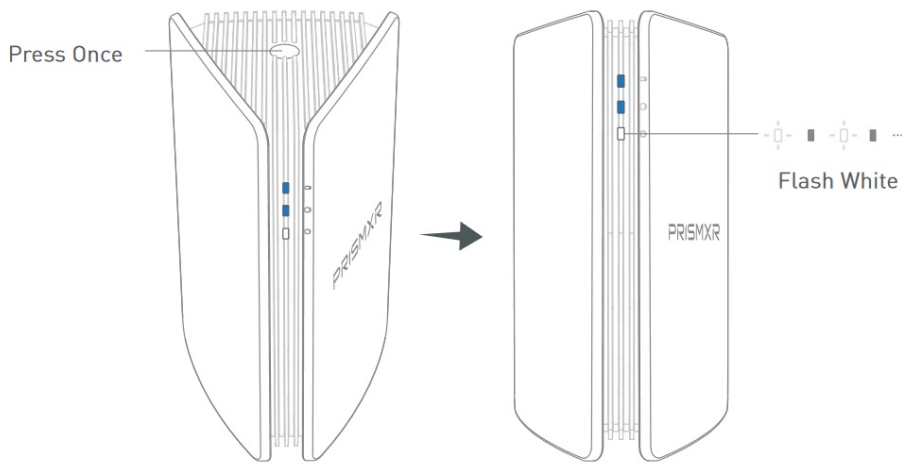

## How to Stream (PrismPulse Mode)

### Set Up Internet

You can choose one of the following two methods to set up the Internet for Puppis S1 before streaming.

- Method 1: Connect Puppis S1 to the Internet via 2.4G Wi-Fi.
- Method 2: Connect Puppis S1 to the Internet via PC Internet Sharing. If your PC's Internet sharing is disabled, you can go to the Puppis S1 in the PrismXR App, click on "Internet", then "PC Internet Sharing Guide" for detailed instructions on PC Internet sharing.

When you switch the network connection mode of your Puppis S1 between PC Internet Sharing and Wi-Fi connection, please note the following:

1. Temporary Network Interruption: Due to Windows-related reasons, there will be a brief 30-second period during which the network of Puppis S1 can not be accessed. This is a normal occurrence during the switching. Windows needs this time to re-detect and establish the new network connection.
2. Puppis S1 Internet LED Indicator: While the network is temporarily unavailable, the Internet LED indicator on Puppis S1 will turn red. Once the network connection is re-established, the LED indicator will return to blue.

### Start Streaming

1. Turn on your PC and VR headset.
2. Select "PrismPulse" in the Wi-Fi settings of your VR headset.
3. Depending on your VR headset, you can choose your preferred streaming method, such as Virtual Desktop(recommended), Quest Link, Pico Streaming Assistant, etc.

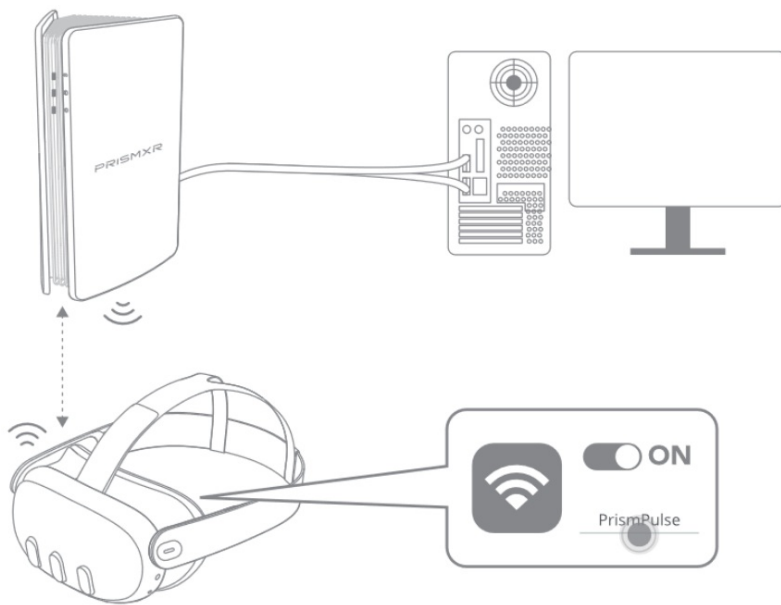

## Wi-Fi Hotspot Mode

Note: If your PC's Internet sharing is disabled, you can go to the Puppis S1 in the PrismXR App, click on "Internet", then "PC Internet Sharing Guide" for detailed instructions on PC Internet sharing.

1. Enable PC Internet sharing.
2. On the Settings page of the PrismXR App or by pressing and holding the SET button on the device for 3 seconds until the status LED indicator turns yellow (by using the SET button, depending on your current mode, you may need to press and hold the button for 3 seconds 1-2 times), which indicates that the Puppis is switched to Wi-Fi Hotspot mode.
3. Select "PrismXR Hotspot" or "PrismXR Hotspot\_5G" in the Wi-Fi settings of your device.

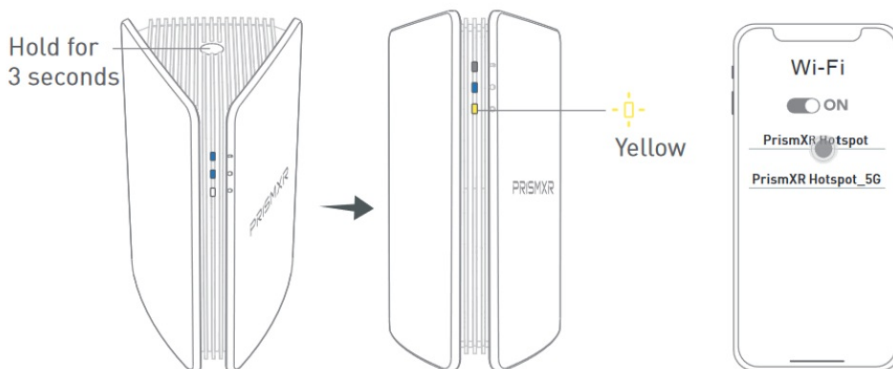

## Wi-Fi Adapter Mode

Note: If your PC's Internet sharing is enabled, you can go to the Puppis S1 in the PrismXR App, click on "Internet", then "PC Internet Sharing Guide" for detailed instructions on PC Internet sharing.

1. Disable PC Internet sharing.
2. On the Settings page of the PrismXR App or by pressing and holding the SET button on the device for 3 seconds until the status LED indicator turns Purple (by using the SET button, depending on your current mode, you may need to press and hold the button for 3 seconds 1-2 times), which indicates that the Puppis is switched to Wi-Fi Adapter mode.

3. Now you can connect your PC to the internet through the Puppis S1.

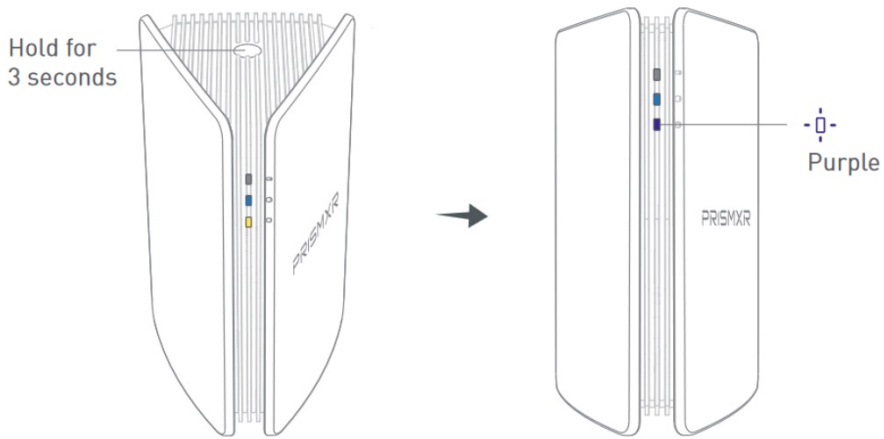

## Maintenance

### Firmware Update

To ensure our customers have the best user experience, we highly recommend you update to the newest version firmware.

Note: Keep the Puppis S1 connected to both the PC and the internet during the update. The Puppis S1 will restart after the update is completed.

- Method 1

- a If a pop-up displays “Update Available” in the App, click “Update Firmware” to view the updated information.
  - b Click “Update” to download and install the new firmware.

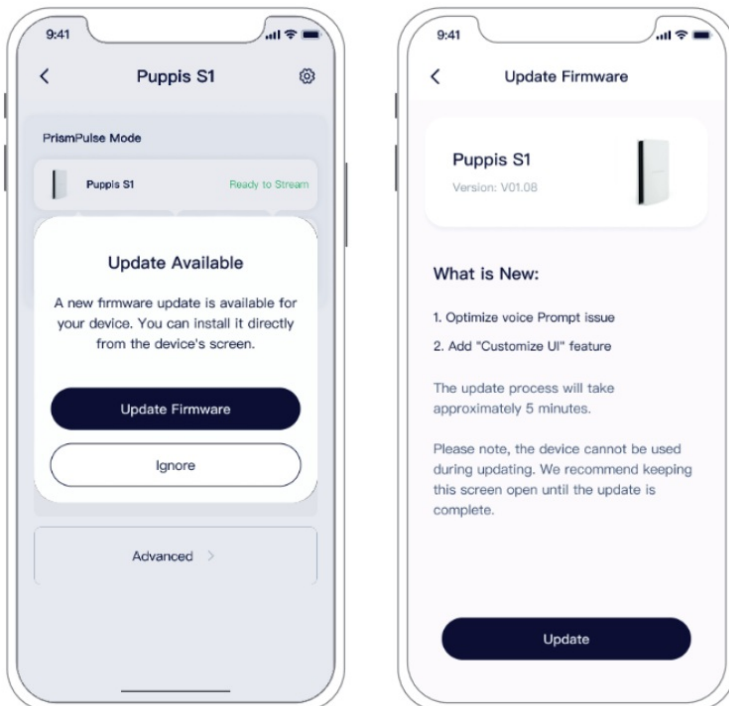

- Method 2

- a Click “Settings” to enter the Settings page.
  - b Click “Firmware Version” to enter the “Update Firmware” page when a red dot is displayed.
  - c Click “Update” to download and install the new firmware.



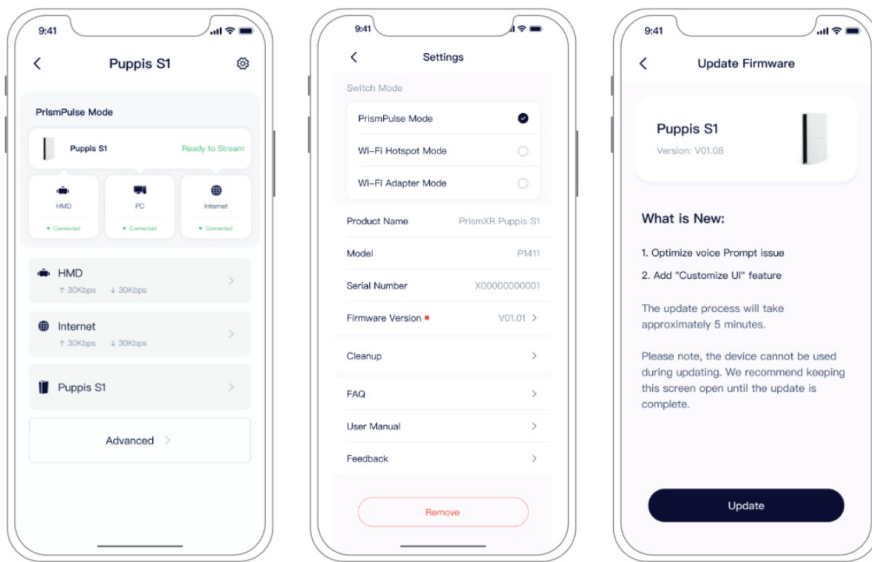

## Factory Reset

Note:

- You might need to reset the Puppis S1 if you experience any connectivity problems or function issues.
- Factory reset will erase all of your settings and restore it to factory defaults. After factory reset, your device will remain in your PrismXR App.

1. Insert a paperclip into the Reset button, press and hold the button for 5 seconds until ALL LED indicators flash red 5 times.
2. Puppis S1 will automatically restart after completing the factory reset.

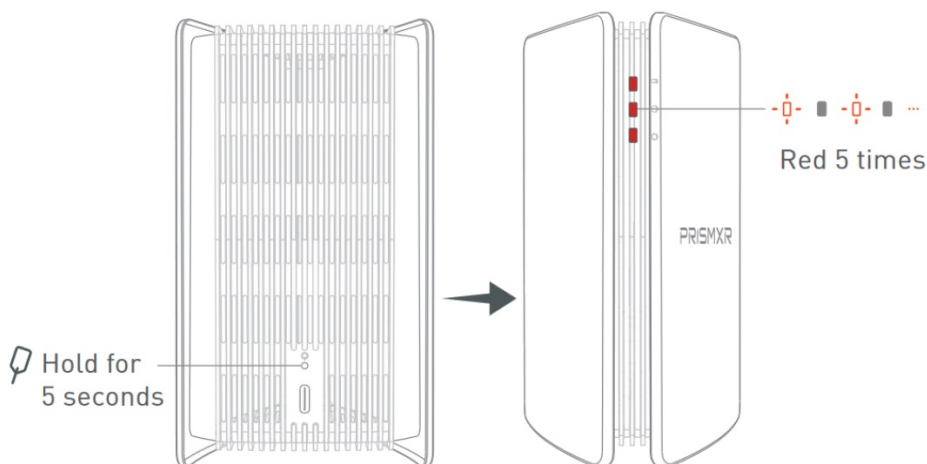

## Safety Instruction

The following basic guidelines are recommended when unpacking, installation, use, and maintenance of your electronic device.

- Avoid dropping.
- Do not disassemble.

- Do not use or install this product near water, to avoid fire or shock hazard. For example, near a bathtub, kitchen sink or laundry tub, or near a swimming pool. Also, do not expose the equipment to RAIN or MOISTURE areas (e.g. a wet basement).
- To safeguard the equipment against overheating, make sure that all openings in the unit that offer exposure to air are not blocked.
- Do not push any objects into the openings of your product. Doing so can cause fire or electric shock by shorting out interior components.
- Keep the product away from radiators and heat sources.
- Do not spill food or liquids on your product components.
- If your product uses a power adapter:
  - a. Make sure the USB adapter must meet the voltage and current marked on the product electrical ratings label.
  - b. Make sure that the ampere rating limit of the USB cable meet be fulfilled for the product.

## FCC Statement

This device complies with Part 15 of the FCC Rules. Operation is subject to the following two conditions: (1) This device may not cause harmful interference, and (2) this device must accept any interference received, including interference that may cause undesired operation.

**Warning:** Changes or modifications not expressly approved by the party responsible for compliance could void the user's authority to operate the equipment.

**Note:** This equipment has been tested and found to comply with the limits for a Class B digital device, pursuant to Part 15 of the FCC Rules. These limits are designed to provide reasonable protection against harmful interference in a residential installation. This equipment generates, uses, and can radiate radio frequency energy and, if not installed and used in accordance with the instructions, may cause harmful interference to radio communications. However, there is no guarantee that interference will not occur in a particular installation. If this equipment does cause harmful interference to radio or television reception, which can be determined by turning the equipment off and on, the user is encouraged to try to correct the interference by one or more of the following measures:

1. Reorient or relocate the receiving antenna.
2. Increase the separation between the equipment and receiver.
3. Connect the equipment into an outlet on a circuit different from that to which the receiver is connected.
4. Consult the dealer or an experienced radio / TV technician for help.

To maintain compliance with FCC's RF exposure guidelines, this equipment should be installed and operated with a minimum distance of 20cm between the radiator and your body.

The following importer is the responsible party.

Company Name: PRISM XR PTE, LTD

Address: 60 PAYA LEBAR ROAD #12-03 PAYA LEBAR SQUARE SINGAPORE, 409051

## ISED Notice

This device complies with Industry Canada license-exempt RSS standard(s). Operation is subject to the following two conditions: (1) this device may not cause interference, and (2) this device must accept any interference, including interference that may cause undesired operation of the device.

CAN ICES-003 (B)/NMB-003(B)

This Class B digital apparatus complies with Canadian ICES-003.

## ISED RF Exposure Statement

This device complies with ISED RSS-102 RF exposure limits set forth for an uncontrolled environment. In order to avoid the possibility of exceeding the IC RSS-102 RF exposure limits, human proximity to the antenna shall not be less than 20 cm during normal operation.



<https://www.prismxr.com/pages/downloads>

Download PrismXR App  
Discover more: [www.prismxr.com](http://www.prismxr.com)

## Documents / Resources



[PRISM XR S1 P1411 Specialized Router](#) [pdf] User Guide  
S1 P1411 Specialized Router, S1 P1411, Specialized Router, Router

## References

- [PrismXR Official Website – PrismXR](#)
- [Support – PrismXR](#)
- [User Manual](#)

[Manuals+](#), [Privacy Policy](#)

This website is an independent publication and is neither affiliated with nor endorsed by any of the trademark owners. The "Bluetooth®" word mark and logos are registered trademarks owned by Bluetooth SIG, Inc. The "Wi-Fi®" word mark and logos are registered trademarks owned by the Wi-Fi Alliance. Any use of these marks on this website does not imply any affiliation with or endorsement.