

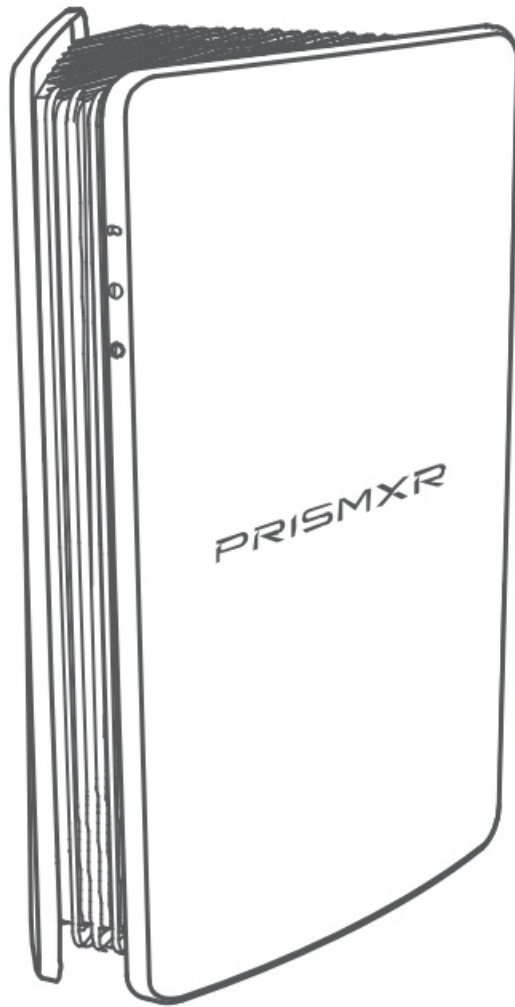

PRISM XR P1411 Streaming Link Air Bridge WiFi6 Router User Guide

[Home](#) » [PRISM XR](#) » PRISM XR P1411 Streaming Link Air Bridge WiFi6 Router User Guide 

PRISM XR P1411 Streaming Link Air Bridge WiFi6 Router



Contents

- [1 Download PrismXR App](#)
- [2 LED Indicator and Port Instruction](#)
- [3 Connect Puppis S1 and PC](#)
- [4 Connect to PrismXR App](#)
- [5 How to Streaming \(Prism Pulse Mode\)](#)
- [6 Safety Instruction](#)
- [7 FCC Statement](#)
- [8 Support](#)
- [9 Documents / Resources](#)
 - [9.1 References](#)
- [10 Related Posts](#)

Download PrismXR App

Download the PrismXR App to enhance your experience (Mode Switching, Upload/Download Rate Checking, Network Topology Checking, Wi-Fi Settings, Device Management, Firmware Updating, and more).



LED Indicator and Port Instruction

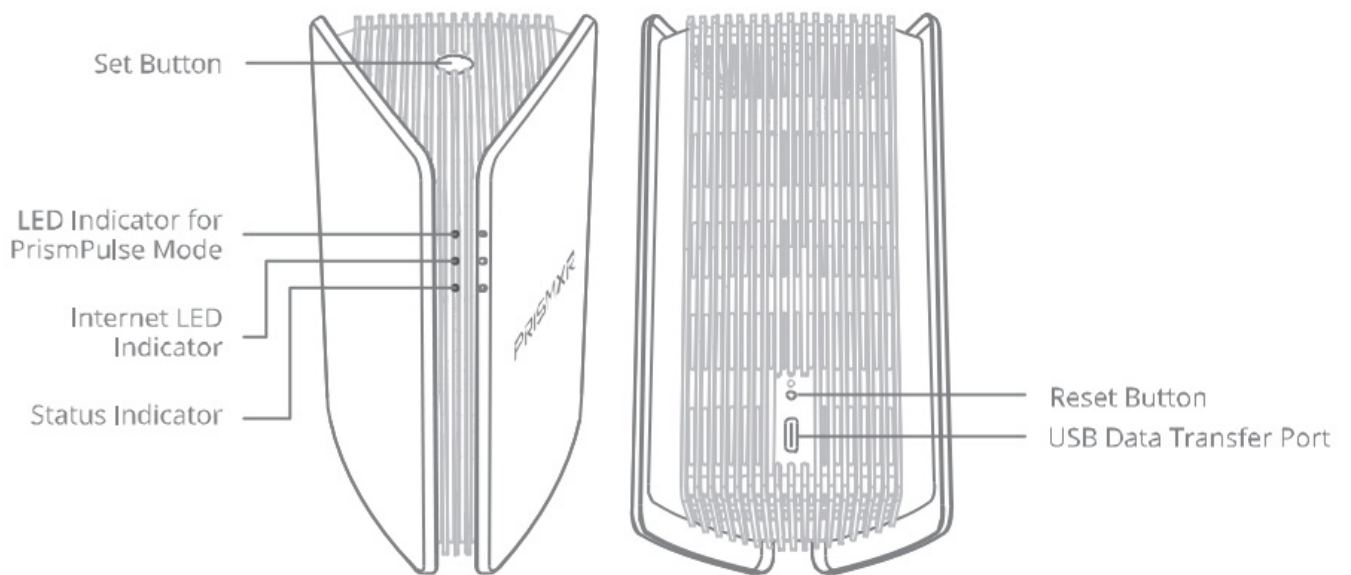

LED Indicator for PrismPulse Mode	Flash Blue	PrismPulse mode is pending connection.
	Blue	HMD is connected.
	Orange	HMD is connected, but PrismPulse mode is abnormal.
	Red	HMD is connected failed.
	Off	Puppis S1 is not powered on or in another mode.
Internet LED Indicator	Blue	The Internet is connected.
	Red	The Internet is disconnected.
	Off	Puppis S1 is not powered on.
Status Indicator	White	Puppis S1 is powered on and operating normally.
	Flash White	Bluetooth connecting mode.
	Yellow	Puppis S1 is in Wi-Fi Hotspot Mode.
	Purple	Puppis S1 is in Wi-Fi Adapter Mode.
	Red	Puppis S1 is powered on but operating abnormally.
	Off	Puppis S1 is not powered on.

Button Explanation

Set Button:

- Press once to reconnect your Puppis S1 to the PrismXR App.
- Press and hold the button for more than 3 seconds to switch modes.
- Press and hold the button for 10 seconds to re-enter pairing mode.

Reset Button:

- Press and hold the button for approximately 5 seconds until the All LED Indicators blink red five times to reset the router to its factory default settings.

Connect Puppis S1 and PC

Requirements:

- Your PC should have two USB-A 3.0 ports, or one USB-A 3.0 port and one USB-A 2.0 port. Alternatively, you can use a USB 3.0 C-C data transfer cable (not provided).

- Please insert the provided USB cable into the corresponding ports on your PC. Plugging in the cable in reverse can result in slower data transfer speeds.

Use Guide:

1. Insert the blue-marked male USB-A into the USB-A 3.0 port on the PC, and insert the white-marked male USB-A into another USB-A 3.0 or USB-A 2.0 port on the PC.

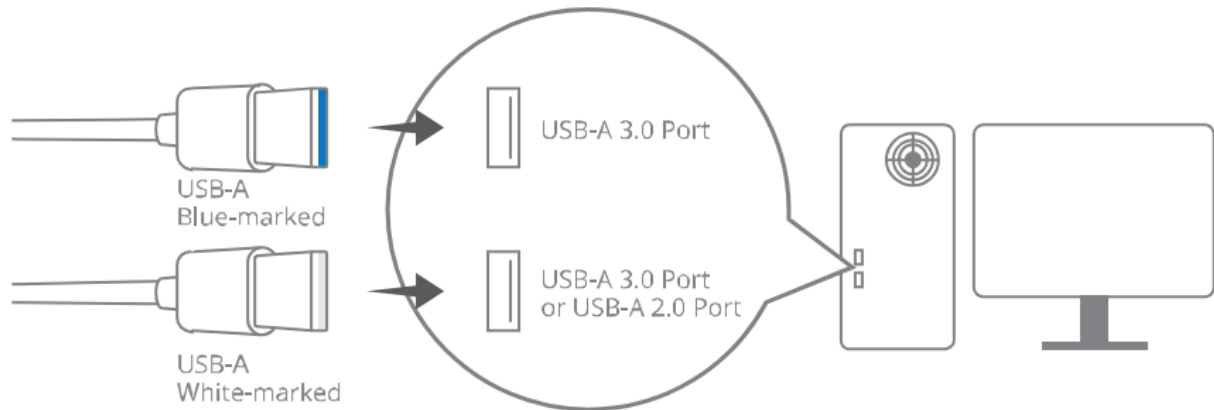

2. Position the side of the male USB-C connector labeled 'L' to the left, and the side labeled 'R' to the right, then insert it into the Puppis S1.

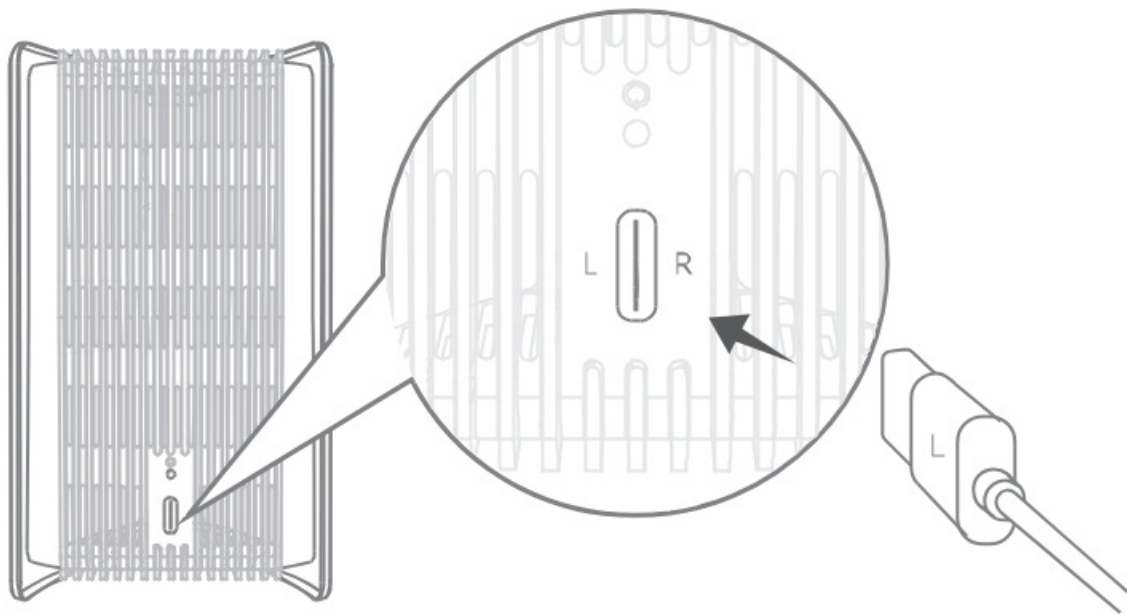

3.
 - a. LED Indicator for PrismPulse Mode: Flash Blue
 - b. Internet LED Indicator: Red
 - c. Status LED Indicator: Flash White

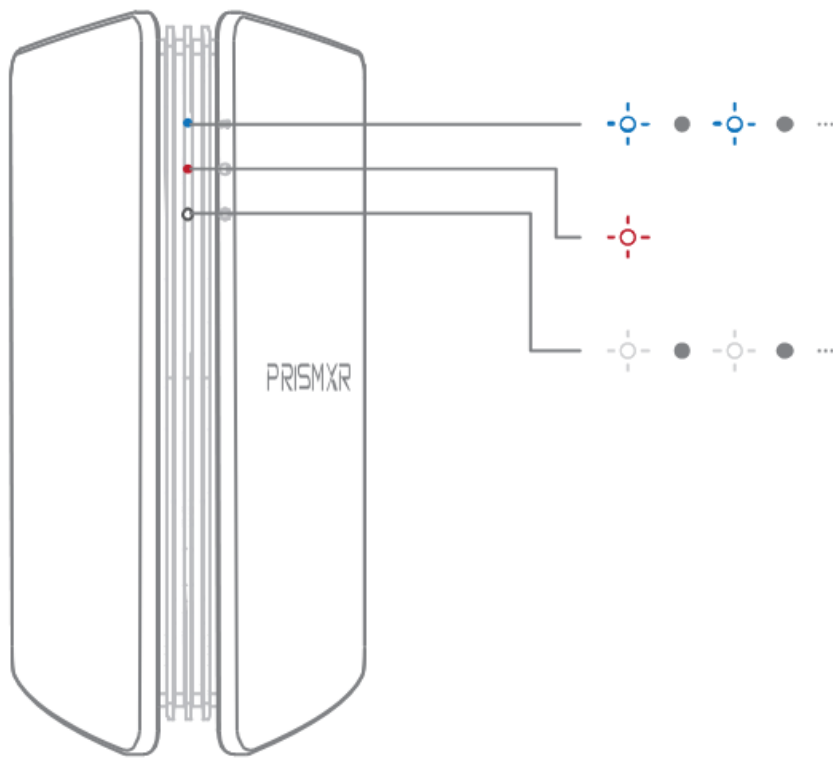

Connect to PrismXR App

Notes:

- To connect your VR to the Internet, you need to configure the network settings in the PrismXR App.
- PrismPulse mode only supports internet access under 2.4GHz networks.
- You will need to press the SET button once to reconnect your Puppis S1 to the PrismXR App if the Puppis S1 becomes disconnected.

Use Guide:

1. After Puppis S1 is connected to a PC without pairing with any bluetooth device, the status LED indicator will flash white. If the status LED indicator stops, press and hold the SET button for 10 seconds to re-enter pairing mode.
2. Open the PrismXR App, there will be a pop-up notification saying "Puppis S1 is Founded".
3. Select 'Add' to add Puppis S1 to the App.
4. Follow the device initialization process to set up Wi-Fi, check for firmware updates, and explore the features of the Puppis S1.

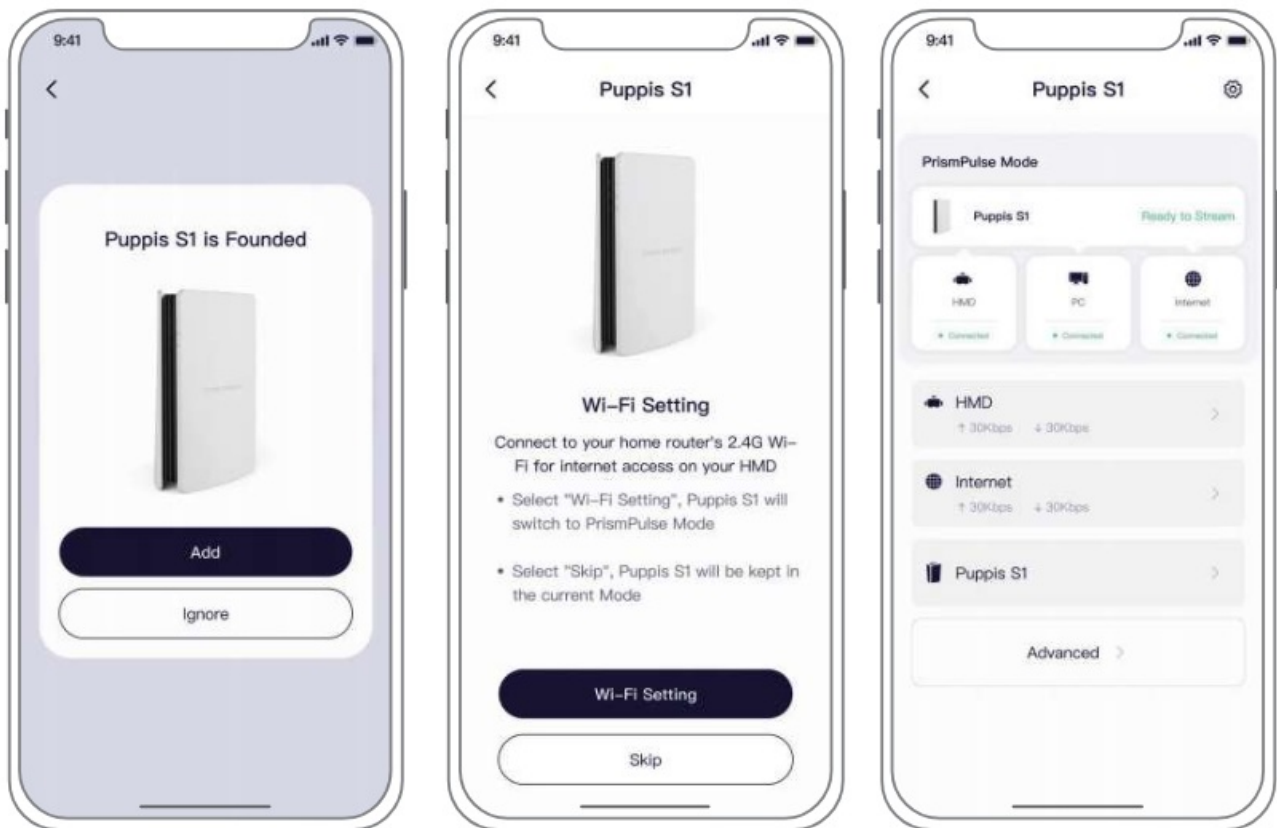

How to Streaming (Prism Pulse Mode)

Set Up Guide:

1. Turn on your PC and VR headset.
2. Select "PrismPulse" in the Wi-Fi settings of your VR headset.
3. Depending on your VR headset, you can choose your preferred streaming method, such as Quest Link, Virtual Desktop, Pico Streaming Assistant, etc.

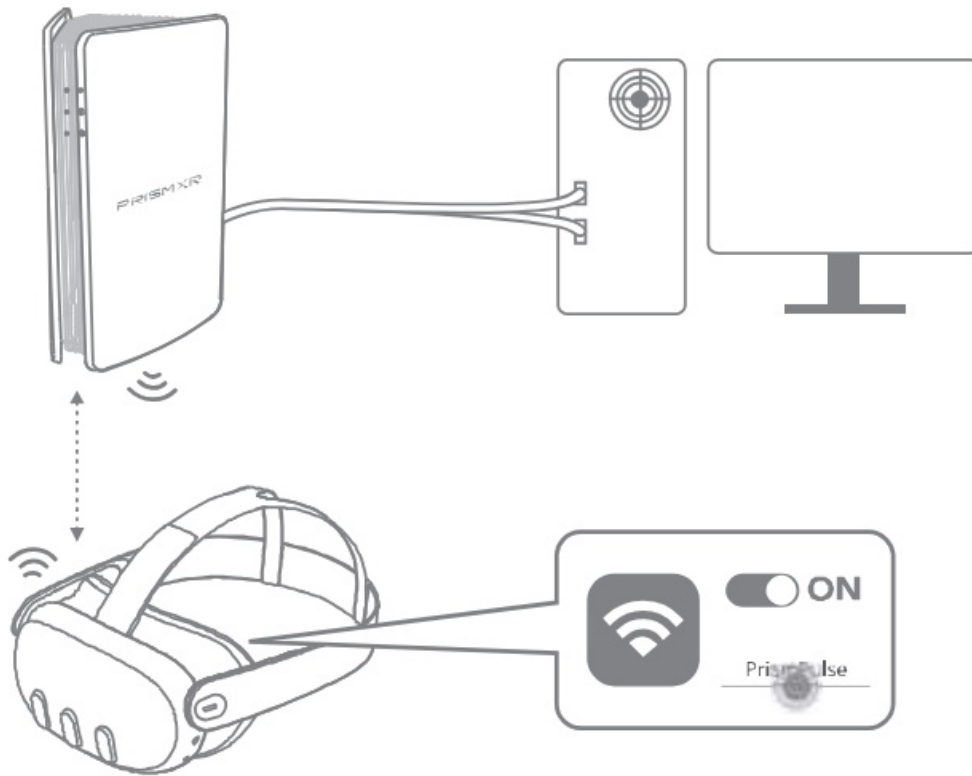

Safety Instruction

- Do not use damaged USB cable to connect to the product.
- Store product in a cool and dry place.
- Do not store the product in a hot or humid environment.
- The operating temperature should be between 0°C to 40°C.
- Do not disassemble the product. Take it to a qualified service person when service or repair is required.
Incorrect reassembly may result in a risk of fire or injury to persons.
- Do not dispose of the product in heat or fire.
- Do not clean the product with harmful chemicals or detergents.
- Misuse, dropping or excessive force may cause product damage.

FCC Statement

This device complies with Part 15 of the FCC Rules. Operation is subject to the following two conditions: (1) This device may not cause harmful interference, and (2) this device must accept any interference received, including interference that may cause undesired operation.

Warning: Changes or modifications not expressly approved by the party responsible for compliance could void the user's authority to operate the equipment.

Note: This equipment has been tested and found to comply with the limits for a Class B digital device, pursuant to Part 15 of the FCC Rules. These limits are designed to provide reasonable protection against harmful interference in a residential installation. This equipment generates, uses, and can radiate radio frequency energy and, if not installed and used in accordance with the instructions, may cause harmful interference to radio communications. However, there is no guarantee that interference will not occur in a particular installation. If this equipment does cause harmful interference to radio or television reception, which can be determined by turning the equipment off and on, the user is encouraged to try to correct the interference by one or more of the following measures:

1. Reorient or relocate the receiving antenna.
2. Increase the separation between the equipment and receiver.
3. Connect the equipment into an outlet on a circuit different from that to which the receiver is connected.
4. Consult the dealer or an experienced radio/ TV technician for help.

To maintain compliance with FCC's RF exposure guidelines, this equipment should be installed and operated with a minimum distance of 20cm between the radiator and your body.

The following importer is the responsible party.

Company Name: PRISM XR PTE, LTD

Address: 60 PAYA LEBAR ROAD #12-03 PAYA LEBAR SQUARE SINGAPORE, 409051

Support

For more information, please visit www.prismxr.com/pages/support

Download PrismXR App
Discover more: www.prismxr.com



Documents / Resources

	<p>PRISM XR P1411 Streaming Link Air Bridge WiFi6 Router [pdf] User Guide P1411, 2BCGS-P1411, 2BCGSP1411, P1411 Streaming Link Air Bridge WiFi6 Router, Streaming Link Air Bridge WiFi6 Router, Link Air Bridge WiFi6 Router, Air Bridge WiFi6 Router, WiFi Router, Router</p>
---	--

References

- [User Manual](#)

[Manuals+](#), [Privacy Policy](#)

This website is an independent publication and is neither affiliated with nor endorsed by any of the trademark owners. The "Bluetooth®" word mark and logos are registered trademarks owned by Bluetooth SIG, Inc. The "Wi-Fi®" word mark and logos are registered trademarks owned by the Wi-Fi Alliance. Any use of these marks on this website does not imply any affiliation with or endorsement.