



PRINCE CASTLE 755-HM10 Multi-Display 10-Channel and 16-Channel Timers User Manual

[Home](#) » [PRINCE CASTLE](#) » PRINCE CASTLE 755-HM10 Multi-Display 10-Channel and 16-Channel Timers User Manual 

Contents

- [1 PRINCE CASTLE 755-HM10 Multi-Display 10-Channel and 16-Channel Timers](#)
- [2 Product Identification](#)
- [3 LIMITED WARRANTY](#)
- [4 Safety Information](#)
- [5 Installation](#)
- [6 Cleaning](#)
- [7 Operation](#)
- [8 Channel Defaults](#)
- [9 Programming](#)
- [10 Exploded View](#)
- [11 Documents / Resources](#)
 - [11.1 References](#)
- [12 Related Posts](#)



PRINCE CASTLE 755-HM10 Multi-Display 10-Channel and 16-Channel Timers



Product Identification

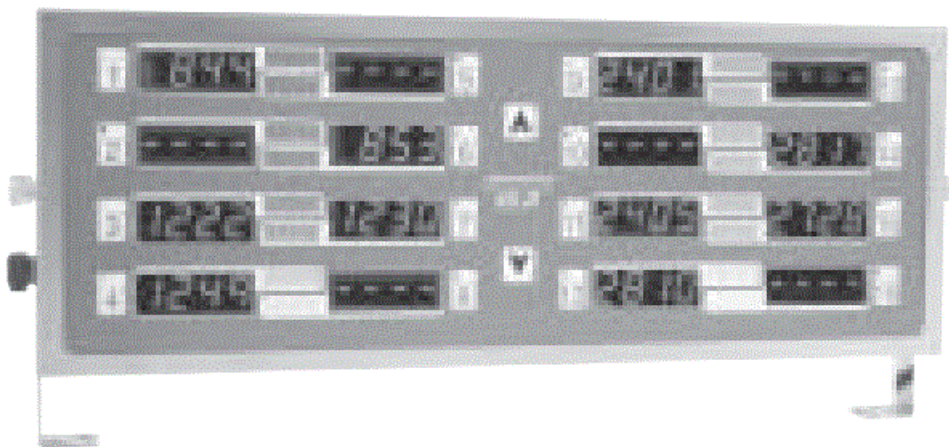

The Prince Castle Model 755 Series Multi-display 10-Channel Timer and 16-Channel Timer are easy-to-use timers that count down in minutes and seconds, or hours and minutes. Each channel has its own display and can be programmed independently. Slide in replaceable menu strips identify the product being timed on each channel, and are replaceable as restaurant menus change. Both auditory and visual signals are used to alert busy staff people when a function is complete.

LIMITED WARRANTY

This product is warranted to be free from defects in material and/or workmanship for a period of 1 year from date of original installation, not to exceed 18 months from the date of manufacture. Any component which proves to be faulty in material and/or workmanship will be replaced or repaired (at the option of Prince Castle, Inc.) without cost to the customer for parts and labor. This equipment is portable; charges for on-location service (e.g., trip charges, mileage) are not included in the provisions of this warranty. This warranty is subject to the following exceptions/conditions:

- Use of any non-genuine Prince Castle parts voids this warranty.
- All labor to be performed during regular work hours. Overtime premium (the incremental amount) will be charged to the customer.
- Damage caused by carelessness, neglect and/or abuse (e.g., dropping, tampering or altering parts, equipment damaged in shipment, by fire, flood or an act of God) is not covered under this warranty.
- All problems due to operation at voltages other than that specified on equipment nameplates are not covered

by this warranty. Conversion to correct voltage is the customer's responsibility.

- This equipment must be serviced by Prince Castle Authorized Service Agency or a Prince Castle Service Technician during the warranty period.

The power cord on this product is rated for a maximum surface temperature of 194 °F (90 °C). If the cord comes into contact with the fryer or thermalized or any other heated surface, it may be damaged and/or cause damage to the product and/or injury to the user. The power cord may also be damaged if placed directly in the path of the high temperature exhaust emitting from the flue of the fryer or thermalized. Damage resulting from any such misuse may result in a voided Warranty at the sole discretion of the manufacturer.

Safety Information

WARNING: Indicates information important to the proper operation of the unit. Failure to observe may result in damage to the equipment and/or severe bodily injury or death.

CAUTION: Indicates information important to the operation of the unit. Failure to observe may result in equipment damage.

Important! Prince Castle reserves the right to change specifications and product design without notice. Such revisions do not entitle the buyer to corresponding changes, improvements, additions or replacements for previously purchased equipment.

Installation

Remove the unit from the carton and inspect for signs of damage. If there is damage to the unit:

- Notify the freight carrier (e.g. UPS) within 24 hours,
- Save carton and packaging materials for inspection purposes,
- Contact your local dealer, or if purchased directly, the Prince Castle Sales Department at 1-800-722-7853 or 630-462-8800 to arrange for a replacement unit.

NOTE: When installing this unit, the ambient temperature at the mounting site should not exceed 100°F (37.8°C).

CAUTION: All electrical connections must be in accordance with local electrical codes and any other applicable codes. Plug the unit into an applicable electrical receptacle.

Cleaning

Use **ONLY** a clean damp cloth, and wipe the face and other surfaces on the Model 755 Series Timer, as necessary. If desired, a mild soap may also be used. **NEVER** use chemicals and/or degreaser of any kind! Long-term use of certain chemicals has a negative effect on the surface of the timer, making it brittle and easily damaged.

Operation

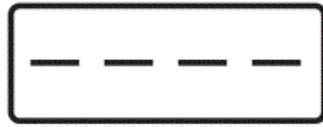

(Menu 1)

or



(Menu 2)

- When a channel's timing cycle has been activated its individual display will show the timing countdown of that channel.
- If the time is in Hours-Minutes (H:M) the colon in the middle of the 4-digits will flash. If the time is in Minutes-Seconds (M:S) the colon in the middle of the 4-digits will be on continuously.
- At the conclusion of a timing cycle, the display flashes "0".
- At the conclusion of a timing cycle, the display will show either "diSc" for discard or "done" for doing. This indication is programmable.

Each of the channels of the 10-Channel or 16-Channel timers operates in an identical manner. Press a channel button to activate a timing cycle (a short beep sound). The timers can be programmed to count up to a selected value or count down to 0:00.

NOTE: To cancel any operation in progress, press the related channel button three times in quick succession (less than three seconds). The channel LED turns off and the LED of the next channel with the lowest countdown remaining will blink. At the conclusion of a timing cycle, the display will show either "diSc" or "donE" depending on how it is programmed. Two different timing cycles can be set up for each channel. These are called "Menu 1" and "Menu 2". To change from one menu to the other, all channels must be idle. Simultaneously press both the UP and DOWN buttons for 6 seconds. The display will change between the single-line display (Menu 1) and the three-line display (Menu 2).

Channel Defaults

HM10

	Menu 1		
	Cycle Time	Alert	Cycle End
	Time	Time	Label
Channel 1	30:00	0:00:00	DISC
Channel 2	30:00	0:00:00	DISC
Channel 3	30:00	0:00:00	DISC
Channel 4	30:00	0:00:00	DISC
Channel 5	30:00	0:00:00	DISC
Channel 6	30:00	0:00:00	DISC
Channel 7	30:00	0:00:00	DISC
Channel 8	30:00	0:00:00	DISC
Channel 9	<i>04:00</i>	0:00:00	DISC
Channel 10	<i>04:00</i>	0:00:00	DISC

Bold italic times are in Hours: Minutes. All other times are in Minutes: Seconds. Alert time = 0 (feature turned off).

HM10

	Menu 2		
	Cycle Time	Alert	Cycle End
	Time	Time	Label
Channel 1	30:00	0:00:00	DISC
Channel 2	30:00	0:00:00	DISC
Channel 3	30:00	0:00:00	DISC
Channel 4	30:00	0:00:00	DISC
Channel 5	30:00	0:00:00	DISC
Channel 6	30:00	0:00:00	DISC
Channel 7	30:00	0:00:00	DISC
Channel 8	30:00	0:00:00	DISC
Channel 9	<i>04:00</i>	0:00:00	DISC
Channel 10	<i>04:00</i>	0:00:00	DISC

Bold italic times are in Hours:Minutes. All other times are in Minutes:Seconds. Alert time = 0 (feature turned off).

HM16

	Menu 1		
	Cycle Time	Alert	Cycle End
	Time	Time	Label
Channel 1	15:00	0:00:00	DISC
Channel 2	15:00	0:00:00	DISC
Channel 3	15:00	0:00:00	DISC
Channel 4	15:00	0:00:00	DISC
Channel 5	15:00	0:00:00	DISC
Channel 6	15:00	0:00:00	DISC
Channel 7	15:00	0:00:00	DISC
Channel 8	15:00	0:00:00	DISC
Channel 9	30:00	0:00:00	DISC
Channel 10	30:00	0:00:00	DISC
Channel 11	30:00	0:00:00	DISC
Channel 12	30:00	0:00:00	DISC
Channel 13	30:00	0:00:00	DISC
Channel 14	30:00	0:00:00	DISC
Channel 15	30:00	0:00:00	DISC
Channel 16	30:00	0:00:00	DISC

Bold italic times are in Hours:Minutes. All other times are in Minutes:Seconds. Alert time = 0 (feature turned off).

HM16

	Menu 2		
	Cycle Time	Alert	Cycle End
	Time	Time	Label
Channel 1	15:00	0:00:00	DISC
Channel 2	15:00	0:00:00	DISC
Channel 3	15:00	0:00:00	DISC
Channel 4	15:00	0:00:00	DISC
Channel 5	15:00	0:00:00	DISC
Channel 6	15:00	0:00:00	DISC
Channel 7	15:00	0:00:00	DISC
Channel 8	15:00	0:00:00	DISC
Channel 9	30:00	0:00:00	DISC
Channel 10	30:00	0:00:00	DISC
Channel 11	30:00	0:00:00	DISC
Channel 12	30:00	0:00:00	DISC
Channel 13	30:00	0:00:00	DISC
Channel 14	30:00	0:00:00	DISC
Channel 15	30:00	0:00:00	DISC
Channel 16	30:00	0:00:00	DISC

Bold italic times are in Hours:Minutes. All other times are in Minutes:Seconds. Alert time = 0 (feature turned off).

Programming

Timer Programming

To program the timer, all 10 or 16 timing channels must be idle with the display showing either one or three sets of four dashes and all LED's turned off. A single set of dashes is shown to program Menu 1 and three sets of dashes are shown to program Menu 2.

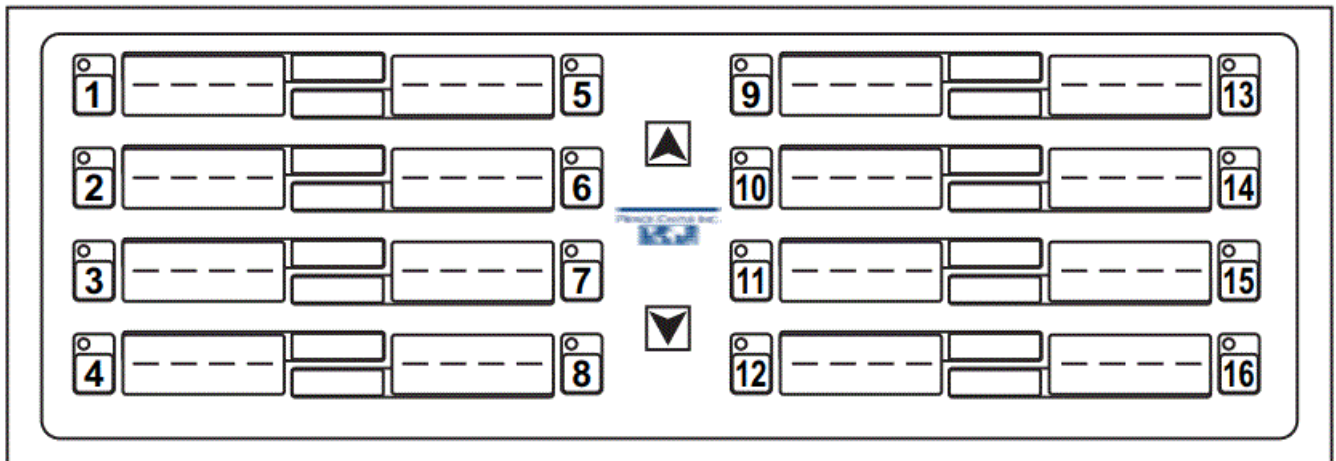

Entering Program Mode

Press and hold the Prince Castle logo button for 6-8 seconds to enter the Programming Mode. The display changes to "Prog" and all channel LED's turn red.

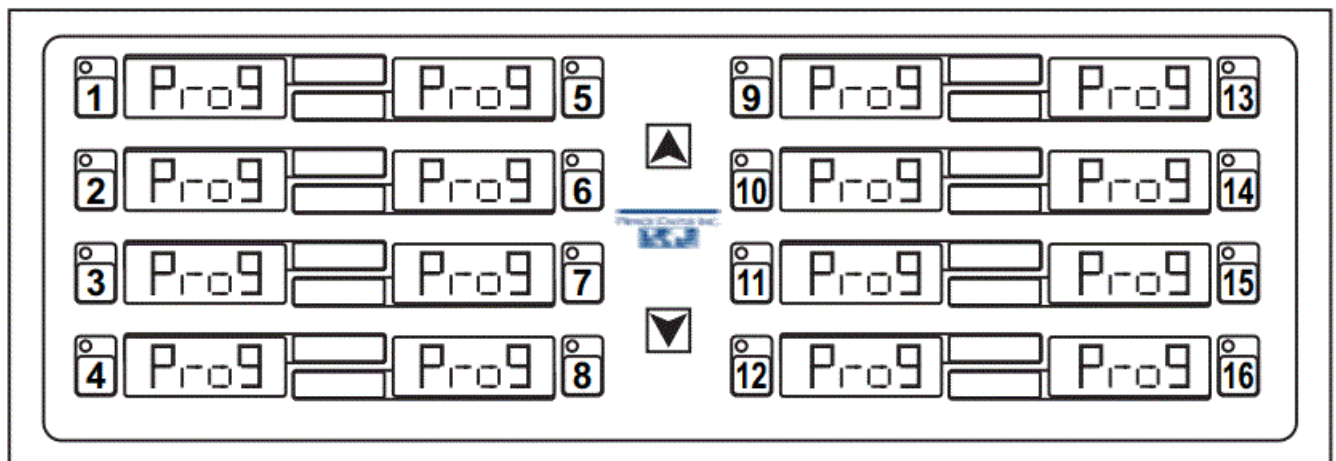

Countdown Mode

NOTE: This mode can only be entered when all channels are idle.

Enter the Countdown Mode by holding the UP button for 6 seconds. This will determine if all the timing cycles count up from 0:00 or count down to 0:00. Use the UP or DOWN buttons to toggle between count up or count down. Display 1 will indicator "C-uP" or "C-dn". When the desired mode is obtained, momentarily press any channel button to save it and return to Timing Mode.

NOTE: To return to Timing Mode without saving, momentarily press the Prince Castle logo button.

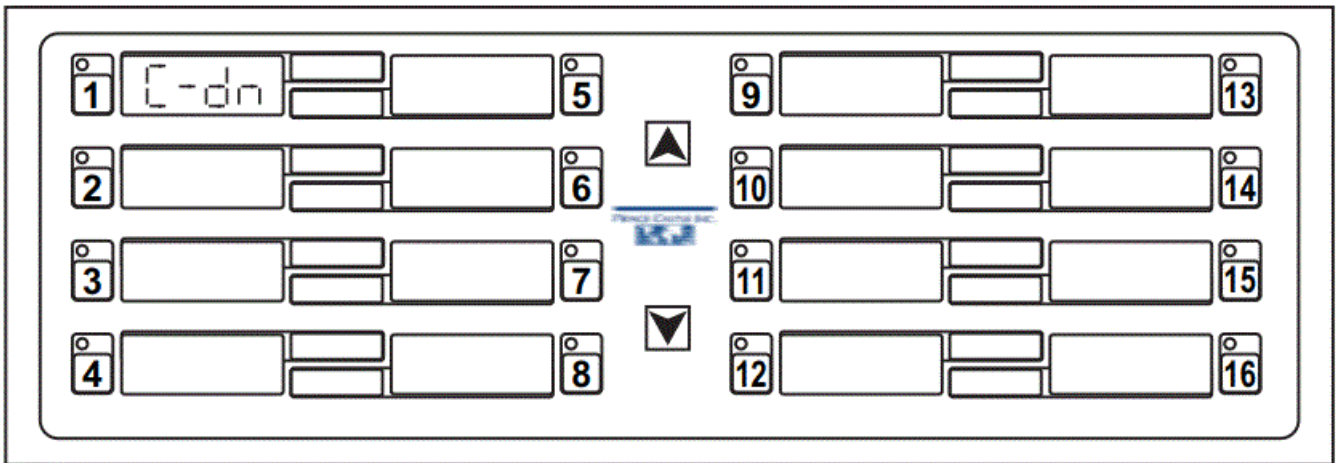
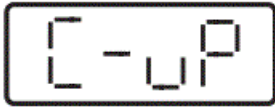

Volume Level Selection

NOTE: This mode can only be entered when all channels are idle.

Press and hold the DOWN button for 6 seconds to initiate the Volume Level Setup Mode. In this mode the timer's audio volume can be set to one of three different levels by using the UP and DOWN buttons. A display will sequence through "SL-1, SL-2, SL-3". When the desired level is obtained, momentarily press any channel button to save the setting and return to the Timing Mode.

NOTE: To return to Timing Mode without saving, momentarily press the Prince Castle logo button.

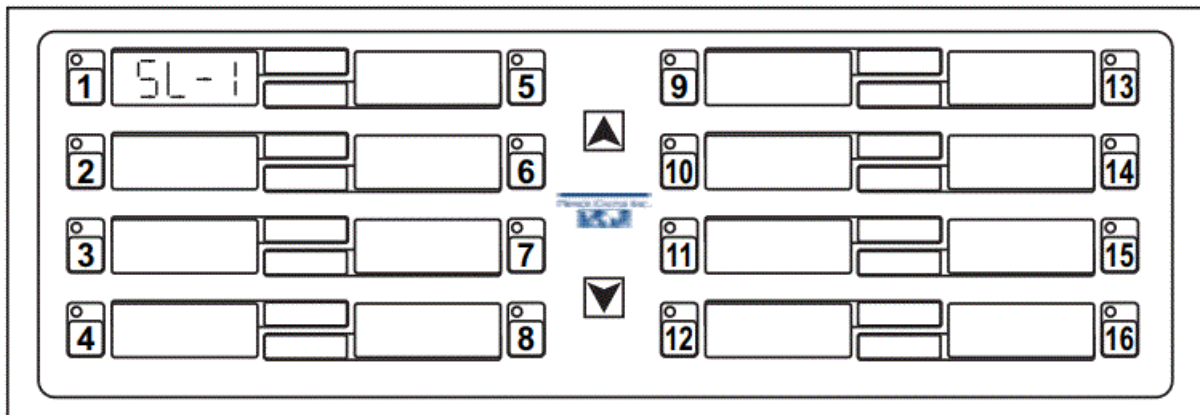

Restoring Factory Presets

Simultaneously pressing both the UP button, DOWN button and the Prince Castle logo button during the first 6 seconds after applying power to the timer will reset all channels back to their factory default settings.

Individual Channel Programming

NOTE: This mode can only be entered when all channels are idle.

Pressing and holding the Prince Castle logo button for 6 seconds will transfer the unit into Channel Parameter Programming Mode. When programming mode is first entered, the displays will show "Prog" until a channel is selected. Momentarily pressing a channel's button enables the parameter-programming mode for that channel. After a channel has been selected, its associated display will show and its timing cycle value, end of cycle label information and action alarm time information will be displayed above or below it.

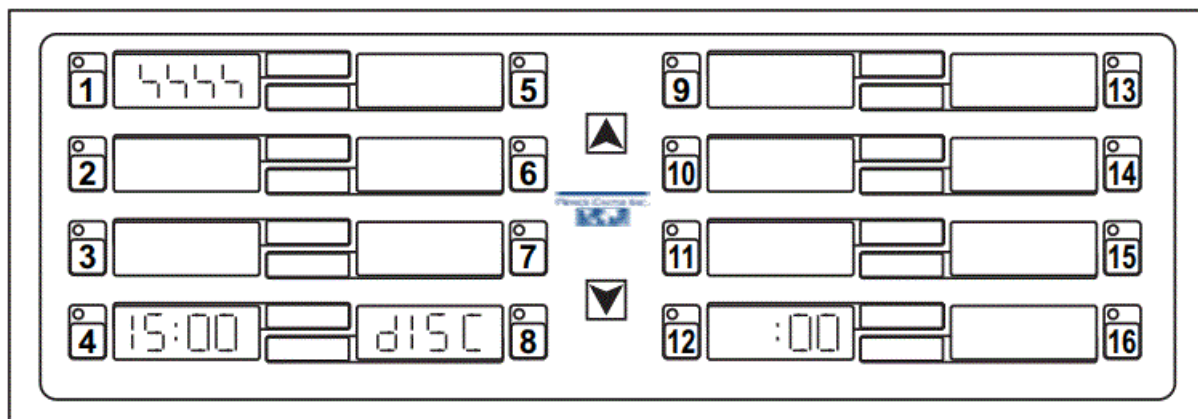

While in Channel Parameter Programming Mode, pressing the channel button next to a parameter (timing value, end-of-cycle label or action alarm time) enables the programming of that parameter for the selected channel. Use the UP and DOWN buttons to modify the value of the enabled parameter. When either the timing cycle value or action alarm time value are programmed, pressing the UP button will increment the value and pressing the DOWN button will decrement the value. Each time the UP or DOWN button is pressed the timing value increments or decrements by one count.

NOTE: If either button is pressed and held, the timing value begins to increment or decrement automatically with the change rate increasing the longer the button is held.

When the parameters for the selected channel are set, pressing the Prince Castle logo button will exit the channel's Parameter Programming Mode and return the unit to a state where another channel can be selected for programming. When parameter changes for all channels have been completed, press the Prince Castle logo button to exit Programming Mode and return the unit to an operationally ready, idle state.

Exploded View

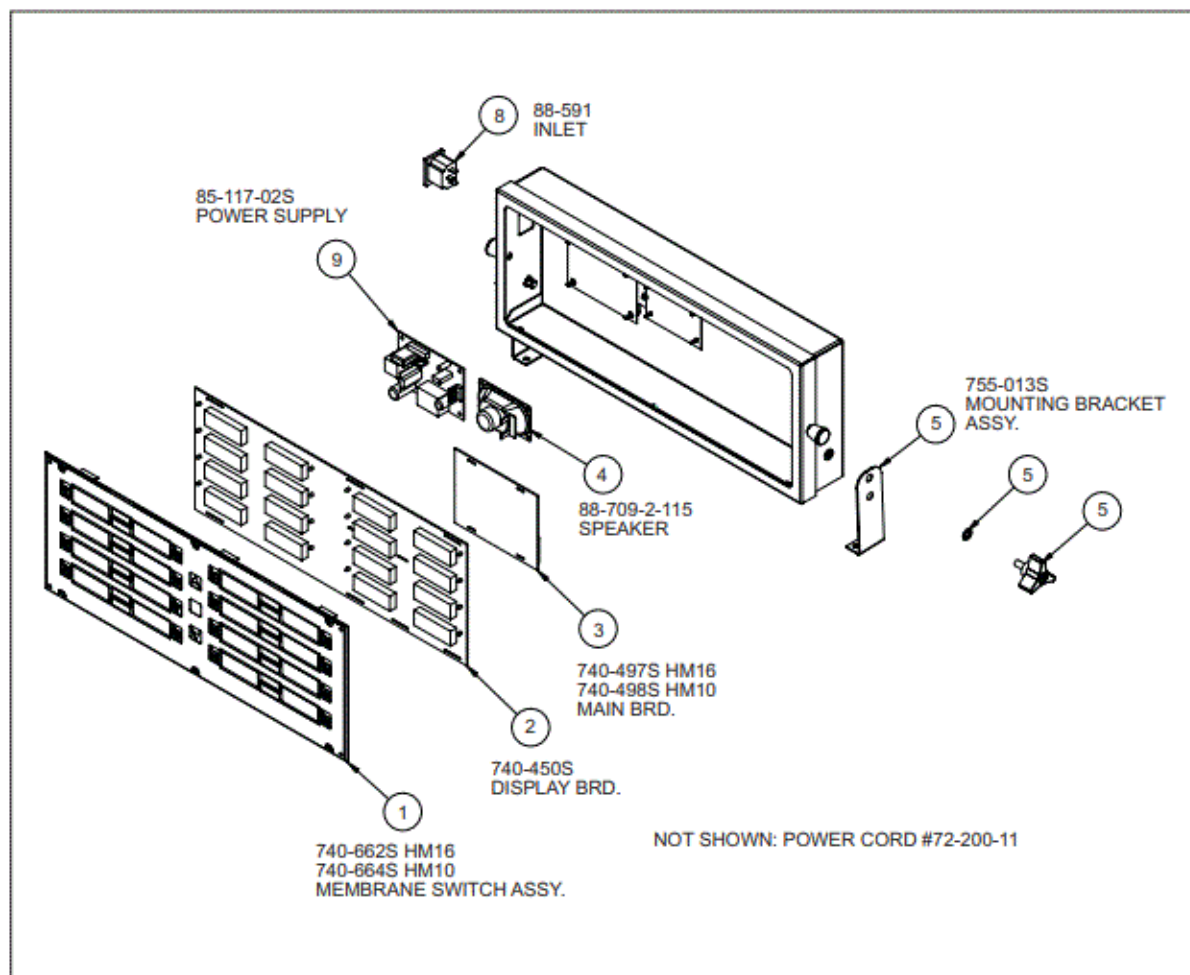

Documents / Resources



[PRINCE CASTLE 755-HM10 Multi-Display 10-Channel and 16-Channel Timers](#) [pdf] User Manual
755-HM10, 755-HM16, Multi-Display 10-Channel and 16-Channel Timers

References

-  [Prince Castle – Prince Castle](#)