



PRIMO Bluetooth control Smart Strip Lighting Led box User Manual

[Home](#) » [PRIMO](#) » PRIMO Bluetooth control Smart Strip Lighting Led box User Manual 



Bluetooth control Smart Strip Lighting Led box
User Manual

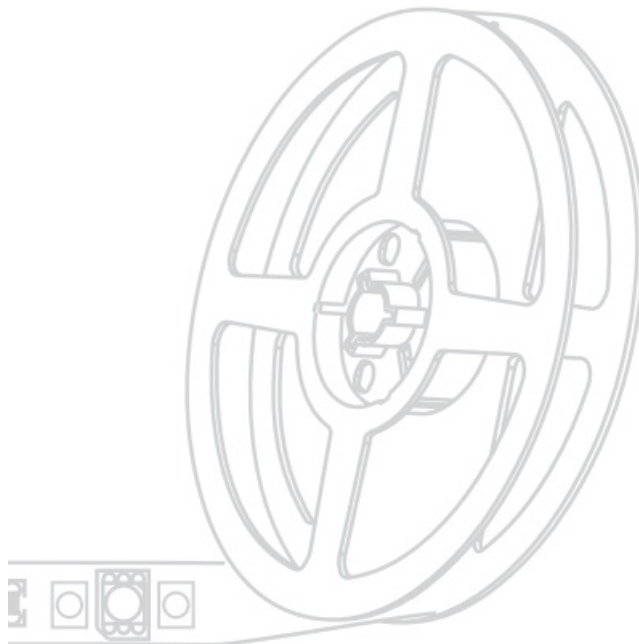

16ft / 4.8m

SMART
STRIP LIGHTING

Contents

- [1 Bluetooth control Smart Strip Lighting Led box](#)
- [2 INSTALLATION](#)
- [3 DOWNLOAD APP](#)
- [4 ADD NEW DEVICE](#)
- [5 DEVICE CONTROL](#)
- [6 WARNINGS & PRECAUTIONS](#)
- [7 Documents / Resources](#)
- [8 Related Posts](#)

Bluetooth control Smart Strip Lighting Led box

NOTES:

PRINT ON MAGAZINE PAPER PRINT GRAYSCALE ONE SIDE ONLY



NOTE: Fold Accordion Style

INSTALLATION

Plug In

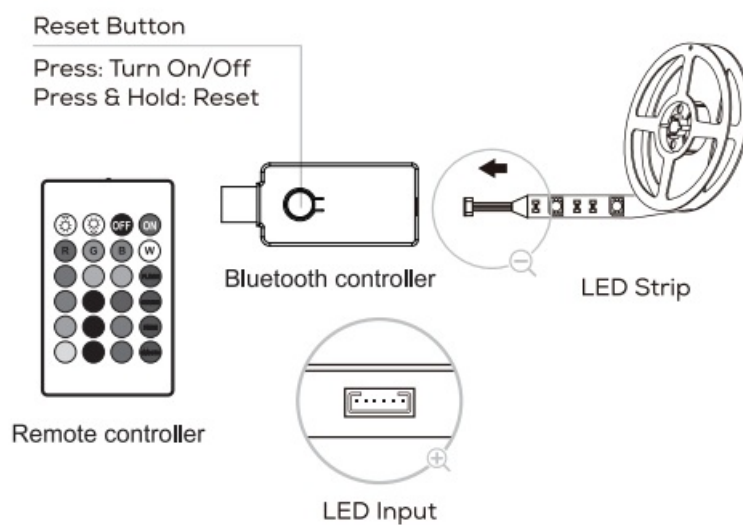

1. Plug the controller into the device with a USB interface Make sure the indicator light on the device is flashing rapidly, indicating the device is ready to connect.
2. Measure the area you wish to attach the LED strip to. Ensure that the ore has a clean, solid surface.

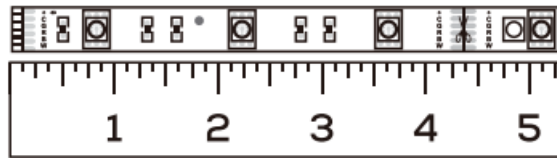

3. Measure the LED strip for the desired length, starting at the end closest to the connector for the Bluetooth Controller.

IMPORTANT: If you measure 8 cut from the opposite end, you will not be able to connect the LED strip to the Bluetooth Controller.

4. Locate the closest cut mark to your desired length. Each strip has cut markings located every 10cm. Take a sharp pair of scissors or blade, and cut along the cut mark.

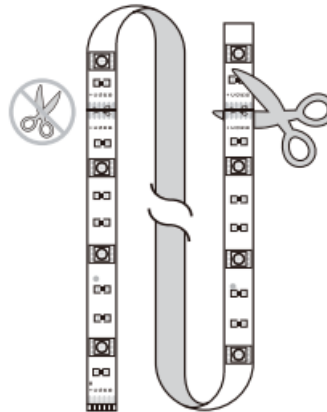

5. LED Strip Adhesive Installation 'Follow Instructions Carefully



Be sure to thoroughly clean surface or wall with any standard rubbing alcohol before applying adhesive and let dry.

Position LED strip upon surface and press every section firmly for at least 30 seconds ensuring a strong hold.

NOTE:

3M adhesive may not adhere well to vinyl surfaces nor to delicate wallpaper.

FCC Warning:

This equipment has been tested and found to comply with the limits for a Class B digital device, pursuant to part 15 of the FCC Rules. These limits are designed to provide reasonable protection against harmful interference in a residential installation. This equipment generates, uses and can radiate radio frequency energy and, if not installed and used in accordance with the instructions, may cause harmful interference to radio communications. However, there is no guarantee that interference will not occur in a particular installation. If this equipment does cause harmful interference to radio or television reception, which can be determined by turning the equipment off and on, the user is encouraged to try to correct the interference by one or more of the following measures:

- Reorient or relocate the receiving antenna.
- Increase the separation between the equipment and receiver.
- Connect the equipment into an outlet on a circuit different from that to which the receiver is connected.
- Consult the dealer or an experienced radio/TV technician for help.

Caution: Any changes or modifications to this device not explicitly approved by manufacturer could void your authority to operate this equipment.

This device complies with part 15 of the FCC Rules. Operation is subject to the following two conditions: (1) This device may not cause harmful interference, and (2) this device must accept any interference received, including

interference that may cause undesired operation.

The device has been evaluated to meet general RF exposure requirement. The device can be used in portable exposure condition without restriction.

DOWNLOAD APP

Download the SmartLife App from App Store or Google Play.



If you would like to enjoy the features of SmartLife as a guest, click on “Try Me”. Otherwise, follow these steps to register:

Register an account on your SmartLife App.

1. Enter your mobile phone number or email address

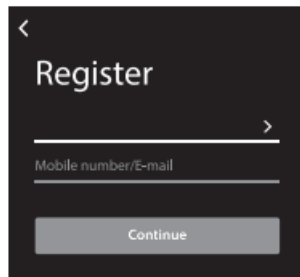

2. Enter the verification code and create a password.

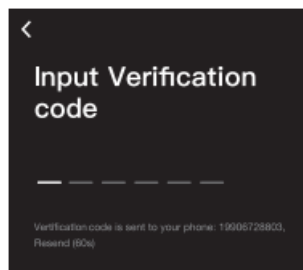

3. Log in to the App.

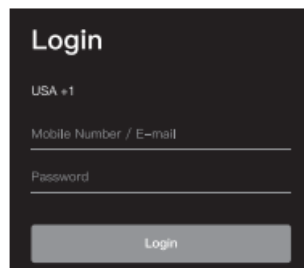

ADD NEW DEVICE

*Make sure your mobile phone Bluetooth is turned on. If the device is flashing, open Smart Life App on <My home> page, press <+> in the upper right corner and then <Lighting Devices>. Then click <Add> to add new devices.

When connecting the device, you can see the connection status as shown in the picture. Once connected, a page will open. Select the room of your home where the device is located and press <Done> to access the control page

of your new device.

Now your new device is ready to be controlled via the App.

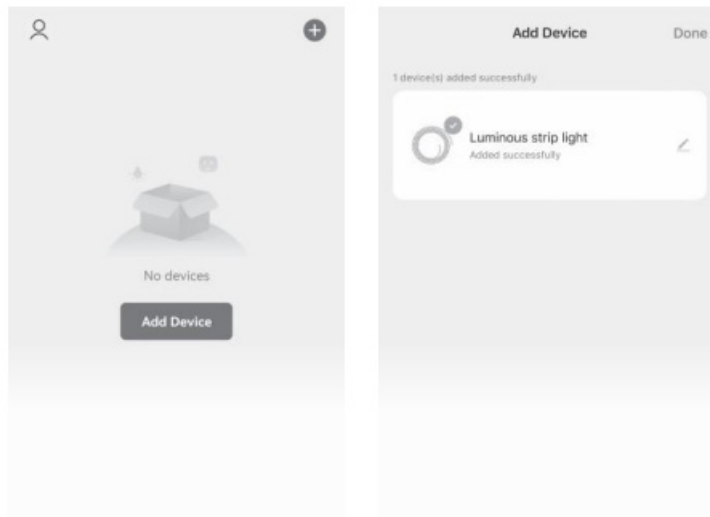

Connection Failed

If the Application shows “Device Adding Timeout”, it means that the device connection has failed. Please check your network and follow the instructions in the notification. Then try to connect it again.

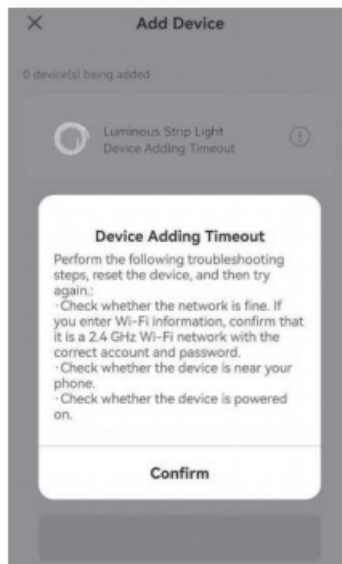

DEVICE CONTROL

After connecting the device, automatically it will open the page to control it by the application. With the keys you find at bottom page, you can:

- Change the color of 16 million color and brightness.
- Dim 1%-100%.
- Select one if the scenarios already created for you.
- Select one of preset music mode already created for you.
- Set more information like schedule. Do Not Disturb. Default Light. Gradient in page <More>.

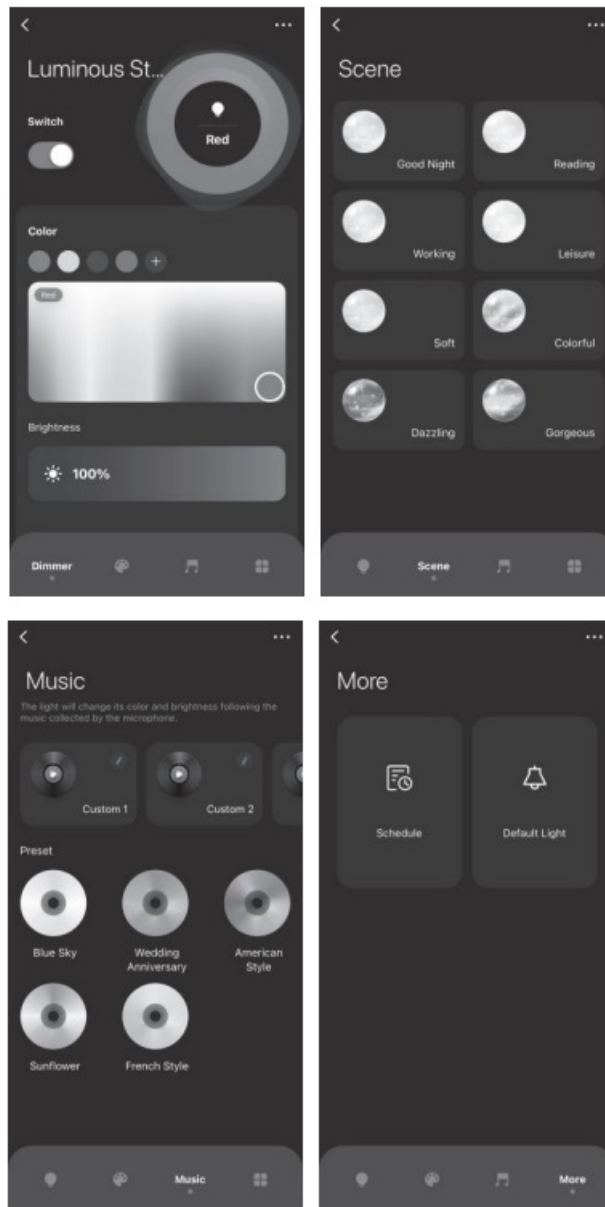

Sharing Devices

You can share your devices with your family and friends who has already downloaded Smart Life App and registered a new account.

The people you shared your devices with will be able to control them, but they will not be able to add new devices to your home or delete shared devices.

Recommended Sharing Method

If the recipient is a household member or other trusted user tap: Me > Home Management > Add Member and add the recipient to your home. Then, devices in the home can be shared with the new user.

WARNINGS & PRECAUTIONS

1. Please do not use or store the equipment in the wet environment such as the bathroom or in a place with dust or dirt. This may damage components and electronic components.
2. Do not place the equipment in an overheated place. High temperature will shorten the service life of electronic equipment and damage the plastic parts of the product.
3. Do not strongly impact or rub the equipment, which may damage its precise structure.
4. Do not use strong chemicals, cleaning products or strong detergent to dean the equipment.
5. Do not use in flammable and explosive environment.
6. If you find abnormal conditions such as odor, heating, discoloration or deformation, please stop using the

equipment and contact us immediately.

7. During operation, if radio frequency interference occurs, the light band may not work.
8. Do not put it in a place where infants can reach. Children should use it under the supervision of their parents.
9. When this product is powered on, please pay attention to power safety.
10. It can only be used indoors.



Documents / Resources

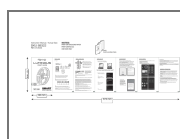

[PRIMO Bluetooth control Smart Strip Lighting Led box](#) [pdf] User Manual
2AKG3-5VDDBXSG, 2AKG35VDDBXSG, 5vddbxsq, Bluetooth control Smart Strip Lighting Led
box, Smart Strip Lighting Led box, Strip Lighting Led box, Lighting Led box, Led box