



Contents [[hide](#)]

- [1 PRETUL DES-25P Gas String Trimmer](#)
- [2 Use and care recommendations](#)
- [3 Technical data](#)
- [4 Fuel specifications](#)
- [5 General motor tools safety warnings](#)
- [6 Parts](#)
- [7 Assembly](#)
- [8 Fuel supply](#)
- [9 Start up](#)
- [10 Operation](#)
- [11 Maintenance](#)
- [12 Available accessories and replacement parts list](#)
- [13 Troubleshooting](#)
- [14 Warranty policy](#)
- [15 FAQ](#)
- [16 Documents / Resources](#)
 - [16.1 References](#)

PRETUL

PRETUL DES-25P Gas String Trimmer



CAUTION

To gain the best performance of the tool, prolong the duty life, make the Warranty valid if necessary, and to avoid hazards of fatal injuries please read and understand this manual before using the tool.

Keep this manual for future references.

The illustrations in this manual are for reference only. They might be different from the real tool.

Use and care recommendations



For better performance and durability, use high-octane gasoline. In Mexico, we recommend using PREMIUM gasoline mixed with 2-STROKE ENGINE OIL.

Using the wrong mixture can cause serious engine damage.

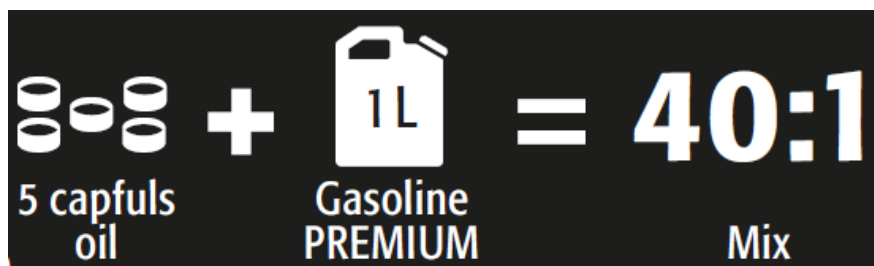

- DO NOT use GASOLINE MIXTURE that has been stored for over 15 days.
- Always USE the SAFETY GUARD and nylon line with a DIAMETER of 0.080" to 0.105"
- ALWAYS run your brush cutter at FULL POWER with the throttle FULLY squeezed.
- Perform periodic MAINTENANCE to your machine (page 10).

Technical data

DES-25P

- Code 22430
- Description Gas string trimmer
- Net weight 11.4 lb (with no fuel)
- Tank capacity 16.9 oz
- Engine cylinder capacity 25 cc
- Engine capacity 1 Hp
- Speed 7500 RPM
- Cutter head Nylon spool
- Cutting diameter 17"
- Trimmer thread diameter 0.080" to 0.105"
- Work cycle 40 minutes rest per each used tank. 5 hours daily

Fuel specifications

For better performance and durability use higher-octane gasoline. In Mexico, we suggest using PREMIUM gasoline.

- The string trimmer has an air-cooled 2-cycle motor using a mix of unleaded gasoline and high quality self-propulsion oil with fuel stabilizer specified for air-cooled two-cycle motors.
- The motor is certified to run with unleaded gasoline for vehicles with 87 or more $([R+M]/2)$ octane level.
- Do not use any type of gasoline premixed with oil bought in service stations such as gasoline for motorcycles.
- Do not use automotive oil or oil for 2-cycle outboard motors oil.
- The mix ratio should be 40 parts gasoline per 1 part oil (40:1 ratio). Prepare the mix in a gasoline-approved container. Always mix thoroughly before pouring in the motor tank.
- CAUTION Do not use fuel mix stored longer than 15 days. Make small amounts of mix.
- WARNIN Never smoke near fuel, the gasoline filling up area or where the oil mix is

being prepared or when operating the tool.

- **WARNING** Any attempt to start the string trimmer with no oil added to the fuel mix will damage to the string trimmer.

Use TRUPER ACES-2, ACES-5 or ACES-20 oil caps** to measure the mix. Mix 5 capfuls oil per each gasoline liter.

A wrong mix may cause the motor to throw a rod causing expensive repairs!



To prolong the useful life of the motor use TRUPER two-cycle synthetic motor oil.

- 1 gallon = 3.78 liter
- Not included

General motor tools safety warnings

WARNING! Read carefully all safety warnings and instructions listed below. Failure to comply with any of these warnings may result in electric shock, fire and / or severe damage. Save all warnings and instructions for future references.

Work area

- Keep your work area clean, and well lit.
- Cluttered and dark areas may cause accidents.
- Never use the tool in explosive atmospheres, such as in the presence of flammable liquids, gases or dust.
- Sparks generated by power tools may ignite the flammable material.
- Keep children and bystanders at a safe distance while operating the tool.
- Distractions may cause losing control.

Electrical Safety

- The tool plug must match the power outlet. Never modify the plug in any way. Do not use any adapter plugs with grounded power tools.
- Modified plugs and different power outlets increase the risk of electric shock.
- Avoid body contact with grounded surfaces, such as pipes, radiators, electric ranges and refrigerators.
- The risk of electric shock increases if your body is grounded.
- Do not expose the tool to rain or wet conditions. Water entering into the tool increases the risk of electric shock.
- Do not force the cord. Never use the cord to carry, lift or unplug the tool. Keep the cord away from heat, oil, sharp edges or moving parts.
- Damaged or entangled cords increase the risk of electric shock.
- When operating a tool outdoors, use an extension cord suitable for outdoor use.
- Using an adequate outdoor extension cord reduces the risk of electric shock.
- If operating the tool in a damp location cannot be avoided, use a ground fault circuit interrupter (GFCI) protected supply. Using a GFCI reduces the risk of electric shock.

Personal safety

- Stay alert, watch what you are doing and use common sense when operating a tool. Do not use a power tool while you are tired or under the influence of drugs, alcohol or medication.
- A moment of distraction while operating the tool may result in personal injury.
- Use personal protective equipment. Always wear eye protection.
- Protective equipment such as safety glasses, anti-dust mask, non-skid shoes, hard hats and hearing protection used in the right conditions significantly reduce personal injury.



- Prevent unintentional starting up. Ensure the switch is in the “OFF” position before

connecting into the power source and / or battery as well as when carrying the tool.

- Transporting power tools with the finger on the switch or connecting power tools with the switch in the “ON” position may cause accidents.
- Remove any wrench or vice before turning the power tool on.
- Wrenches or vices left attached to rotating parts of the tool may result in personal injury.
- Do not overreach. Keep proper footing and balance at all times.
- This enables a better control on the tool during unexpected situations.
- Dress properly. Do not wear loose clothing or jewelry. Keep hair, clothes and gloves away from the moving parts.
- Loose clothes, jewelry or long hair may get caught in moving parts.
- If you have dust extraction and recollection devices connected onto the tool, inspect their connections and use them correctly. Using these devices reduce dust-related risks.

Power Tools Use and Care

- Do not force the tool. Use the adequate tool for your application.
- The correct tool delivers a better and safer job at the rate for which it was designed.
- Do not use the tool if the switch is not working properly.
- Any power tool that cannot be turned ON or OFF is dangerous and should be repaired before operating.
- Disconnect the tool from the power source and / or battery before making any adjustments, changing accessories or storing.
- These measures reduce the risk of accidentally starting the tool.
- Store tools out of the reach of children. Do not allow persons that are not familiar with the tool or its instructions to operate the tool.
- Power tools are dangerous in the hands of untrained users.
- Service the tool. Check the mobile parts are not misaligned or stuck. There should not be broken parts or other conditions that may affect its operation. Repair any damage before using the tool.
- Most accidents are caused due to poor maintenance to the tools.
- Keep the cutting accessories sharp and clean.
- Cutting accessories in good working conditions are less likely to bind and are easier to

control.

- Use the tool, components and accessories in accordance with these instructions and the projected way to use it for the type of tool when in adequate working conditions.
- Using the tool for applications different from those it was designed for, could result in a hazardous situation.

Service

- Repair the tool in a TRUPER Authorized Service Center using only identical spare parts.
- This will ensure that the safety of the power tool is maintained.
- Children or people with reduced physical, sensory or mental capabilities shall not operate the tool, neither inexperienced people or without knowledge in the use of the tool, unless supervised by a person responsible of their safety or if receiving previous instructions about the tool operation.
- Children shall be kept under supervision to double-check they will not play with the tool. Tight supervision shall be used with children or disabled persons to prevent from using or being close to any household tool.

Fuel handling

- Never smoke near fuel or where gasoline is supplied.
- Or where the oil mix is prepared or while operating the string trimmer.
- Handle fuel with care to reduce risk of fire or burns.
- Fuel is very flammable.
- Do not allow gasoline or oil getting contact with your skin.
- Protect your eyes. Avoid spilling oil or gasoline. In the event of accidental contact, wash eyes immediately with clean water. If irritation persists, see a doctor.
- Mix and store fuel in a labeled container.
- **WARNING** Mix fuel outdoors away from flames or sparks.
- Before refueling the string trimmer turn off the motor.
- Set the string trimmer in the ground in a clear surface.
- Wait for the motor to cool down.
- **CAUTION** Clean all the fuel that might have been spilled before operating the string trimmer.

- **CAUTION** Verify there are no leaks. If so, correct them before using the string trimmer to prevent fire or burns.
- Move the string trimmer at least 30 feet away from the fuel filling up site before starting the motor.
- Under no circumstance burn spilled fuel.
- Under no circumstance, use any other type of fuel different from the specified in this Instructions Manual
- Do not use the string trimmer with any guards in place. Or if the guards show any type of damage or they have missing parts.

When operating the string trimmer

- **CAUTION** Keep passersby, children and animals away no less than 50 feet away.
- Verify the cutter head is not making contact with any object before starting the motor.
- Keep both feet firmly set on the ground and both hands holding the string trimmer by the handles. Never operate the string trimmer single-handed.
- Otherwise the operator and any other person present may be injured.
- **WARNING** Keep all your body away from the cutter head when the motor is running.
- Always keep the cutting head pointed downwards, below your waist level. Never raise it above 2.4 feet from the ground.
- Keep all your body parts away from the muffler. Otherwise severe burns can occur.
- Keep the string trimmer away from flammable materials.
- Do not use the string trimmer to cut woody shrubs.
- Be alert to surrounding risks. The string trimmer noise could prevent you from noticing them.
- **DANGER** If making jobs near traffic roads, stop cutting until there are no vehicles in sight. The string trimmer could shoot particles towards the moving vehicles and produce a severe accident

After operating the string trimmer

- **WARNING** Do not try to stop the cutter head rotating movement in any other way than releasing the switch. Wait for the cutter head stop after shutting off the string trimmer. It will take a couple of seconds.

- **CAUTION** Always carry the string trimmer with the motor off and the muffler away from your body. Before putting the string trimmer in a vehicle, drain the fuel tank.
- **WARNING** Turn off the motor before idling the string trimmer. DO NOT leave the motor running unattended. Wait for the string trimmer to cool off before storing.
- **CAUTION** Highly trained personnel string trimmer should only carry out service and repairs.
- **WARNING** Do not try to modify the tool or manufacture accessories that are not recommended. Otherwise there is hazard of severe personal injury and making the warranty void.
- When assembling parts disconnect the spark plug cable from the motor, to prevent an accidental start and cause severe injury.

Parts

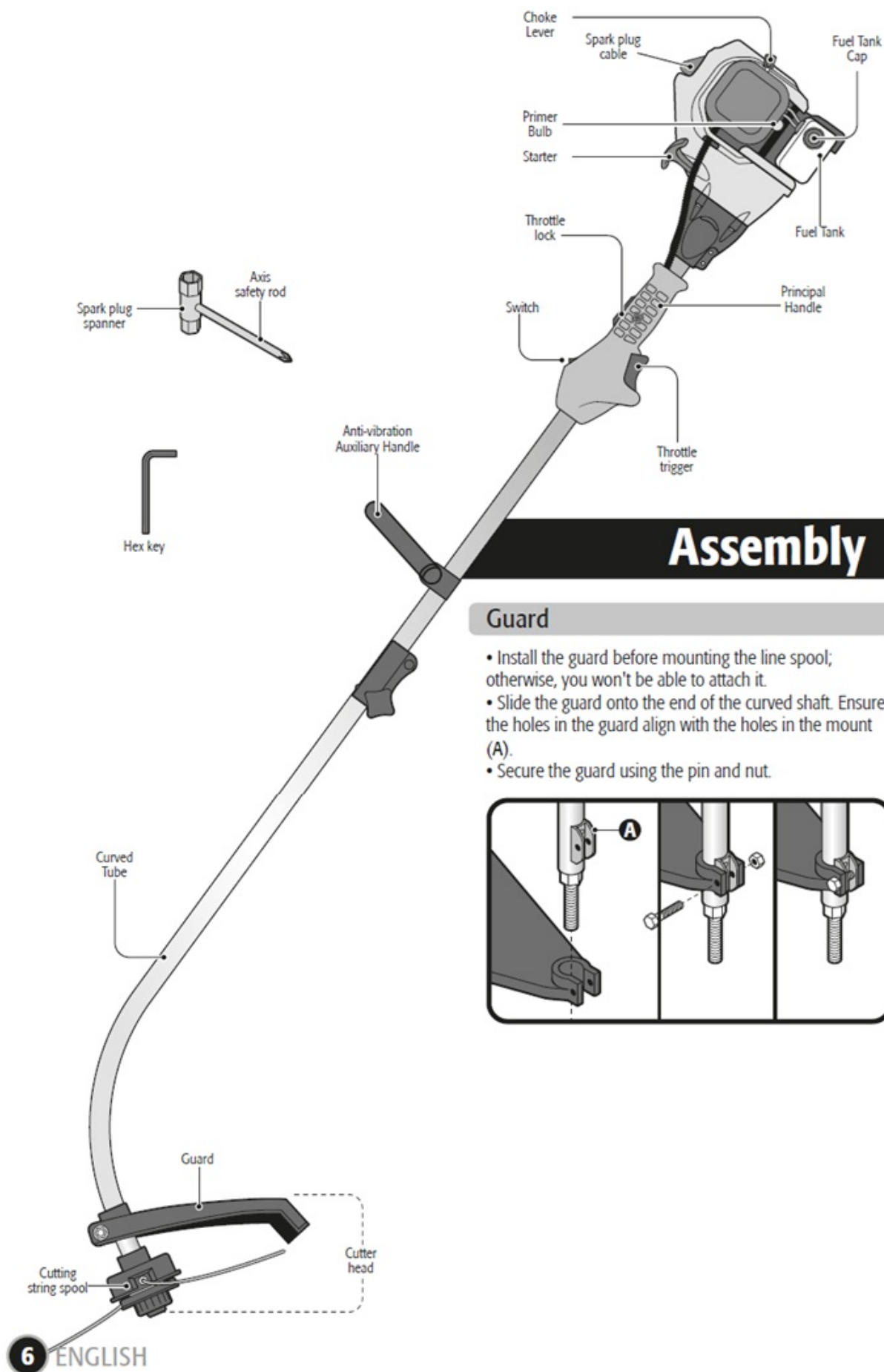

Assembly

Shaft

- Align the safety pin (a) of the lower shaft with the middle hole in the clamp (b).
- Press the safety pin down and insert the lower shaft into the clamp.
- Release the safety pin; ensure that it engages in the hole on the upper shaft .
- Tighten the locking knob clockwise to secure the connection (c).

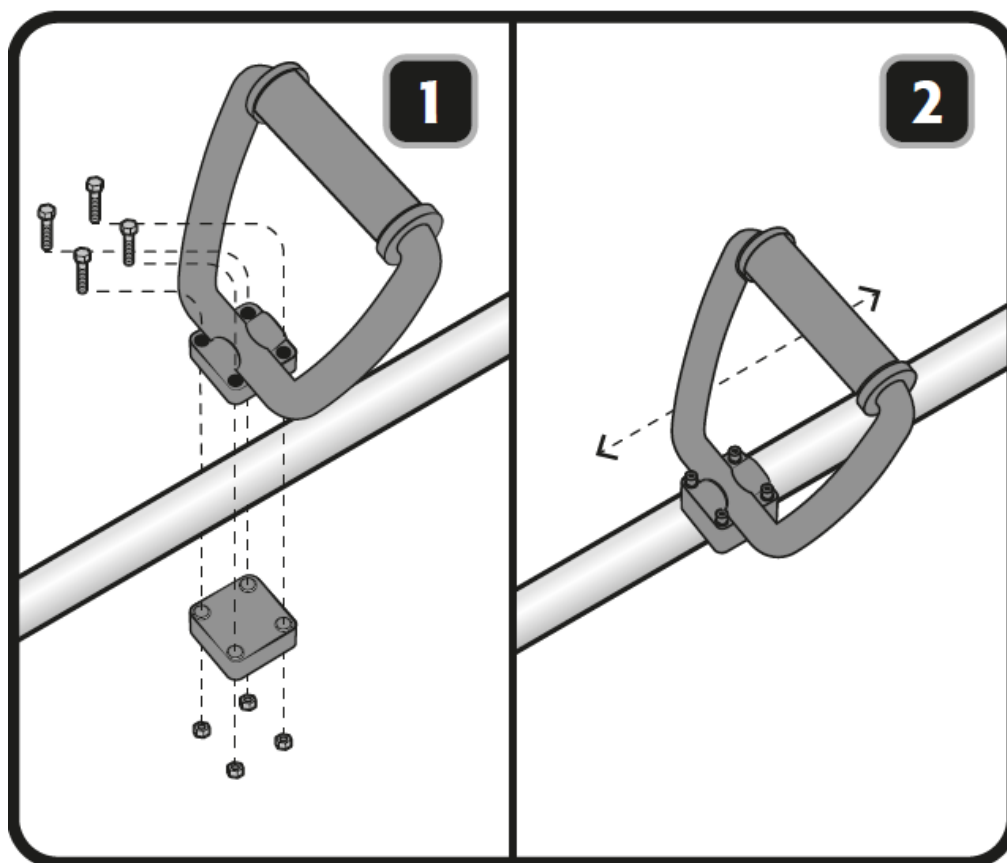
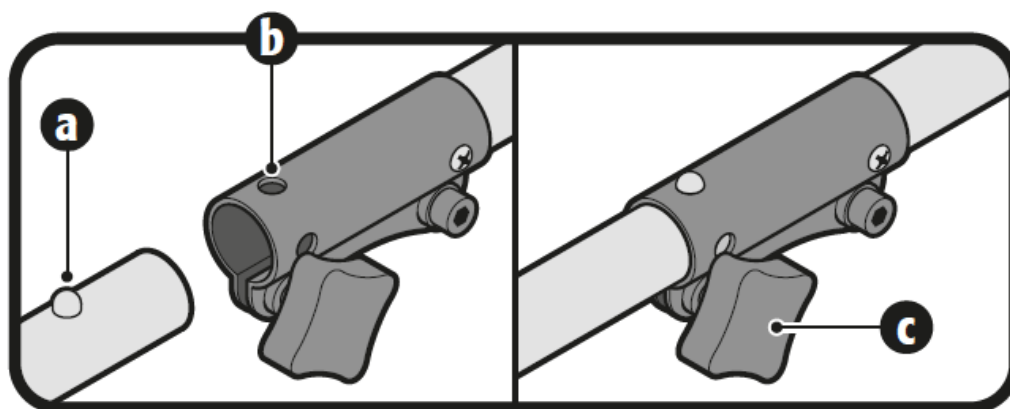

Anti-vibration Auxiliary Handle

- Install the auxiliary handle as shown in the figure (1)
- Move the auxiliary handle through the string trimmer arm to the right height to operate comfortably (2)
- Tighten the screws to fix the auxiliary handle into position.

Cutting string replacement and mounting

- With the string trimmer off, remove the spool-retaining cap (B) turning counter-clockwise.
- Remove the empty spool. Verify is clean and has no damaged or worn parts.
- Cut one 5 m length of cutting string. Make a loop in the middle of the line and insert the loop in the spool inner hook (C). Hold the string and wind it clockwise.
Double-check is en of the string is wound in its respective section (upper and lower).
Do not wind too much string. After wounding there shall remain a 6 mm minimum distance between the spool edge and the wound string.
- Leave approximate 20 cm unwound centimeters on both ends of the string and insert each one of them in the spool notches (D). This is to prevent the string to unwind while installing the spool in the string trimmer. Later on you should release the strings from their notches.
- Set back the spool in its cover passing the ends of each string through the cover orifices (E). If the string is loose or tangled in this step, wind it again in the spool and secure it in its notches.
- Set the spool cover in the axis (F) and secure the spool tightening the retaining cap (B).
- Apply force and pull outwards both ends of the cutting string to release it from the notches in the upper side of the spool (G).

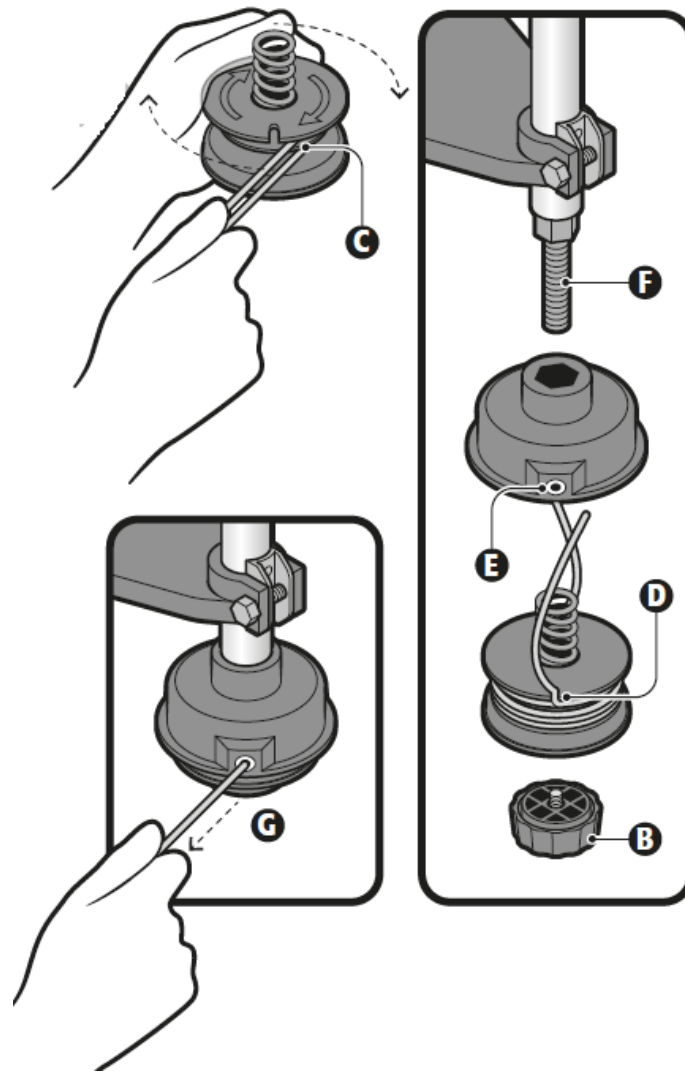

Fuel supply

- Follow the safety standards for handling fuel. (Page 5)
- Let the motor cool down completely before filling up.
- Set the string trimmer onto a flat surface leaning it as shown in the figure.
- Wipe around the fuel tank cap to avoid contamination.
- Slowly loosen the fuel cap.
- Use care to avoid spillage. Pour the fuel mix into the fuel tank. **CAUTION** follow fuel specifications. (Page 3)
- Before setting back the fuel cap check and clean the joints.
- Immediately cover the fuel tank cap and tighten by hand.
- Wipe clean any fuel spill.

CAUTION In a new motor and after using for the first time is a normal that smoke emissions are present.

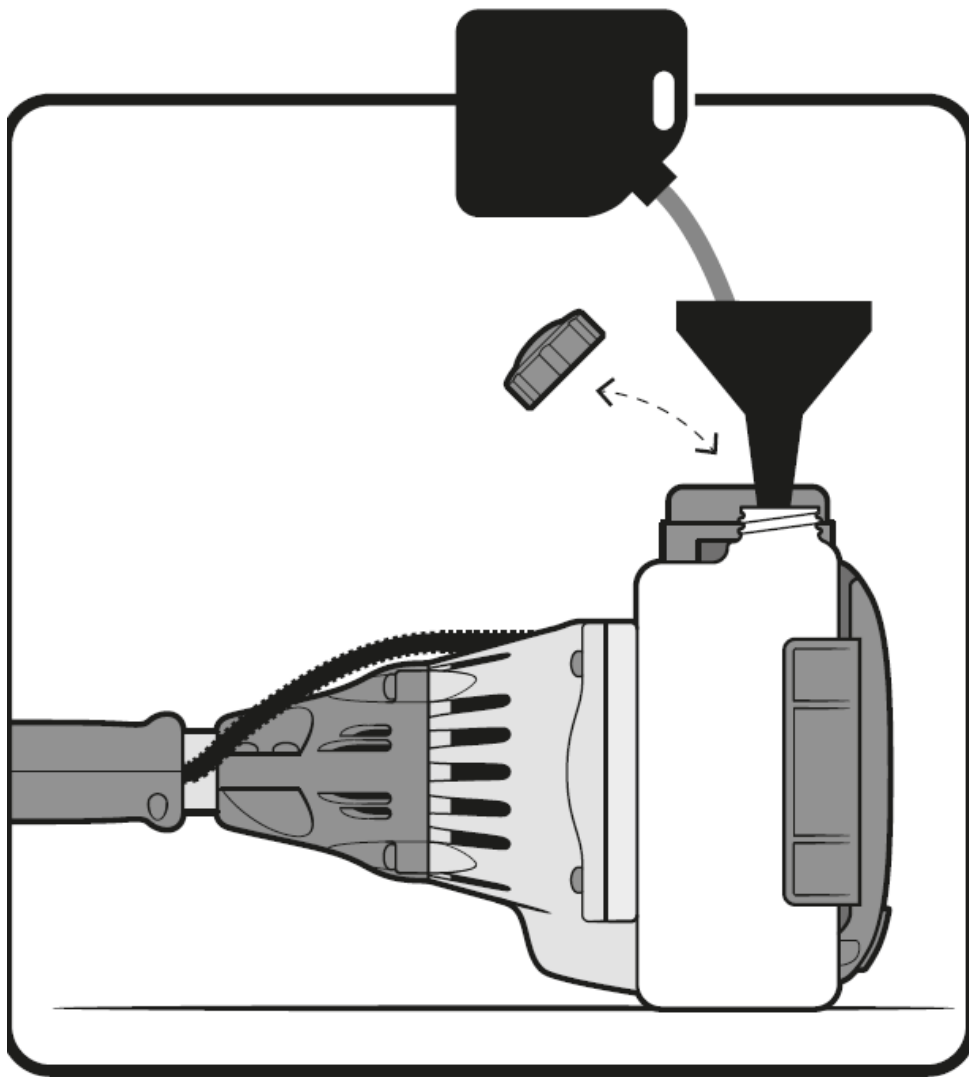

Start up

Starting with a cold motor

- Set the string trimmer in level ground where the cutter head is not making contact with obstacles.
- Set the switch in the ON position (A).
- Press and release 6 times the starter choke (B).
- Move the choke lever into “” position (1).
- Pull the starter 3 to 5 times (C) to let the fuel enter into the motor. Then press the lock and the throttle trigger (D) and pull the starter fast and with force to start the motor. Do not release the starter. Put it back carefully into its initial position to prevent damaging the starter.
- Once the motor starts set the choke lever into the “ ” position (2).
- Release the throttle trigger to make the motor run idle a couple of minutes.
- The string trimmer is ready to be used. Hold it by its two handles using both hands

and lift it to start the job.

- Press the lock and throttle trigger to start the cutting device.

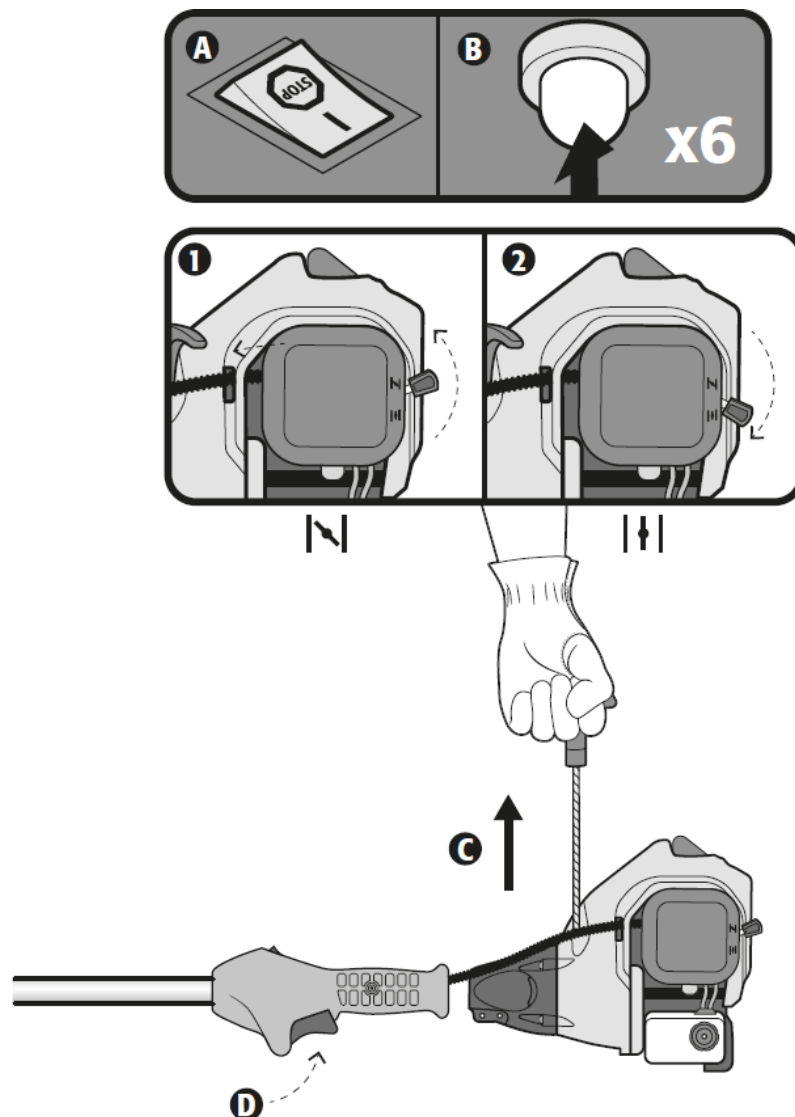

Starting a hot motor

- Set the string trimmer on level ground with the cutting head away from making contact with obstacles.
- Set the switch into the on position (E).
- Set the choke lever into “H” position (F).
- Press the lock and throttle trigger and keep them that pressed.
- Pull the starter (G) until the motor starts.
- Release the lock and throttle trigger to set the motor running idle (H).
- The string trimmer is ready to operate. Hold it by the two handles with both hands and raise it to start the job.
- Press the lock and throttle trigger to start the cutting device.

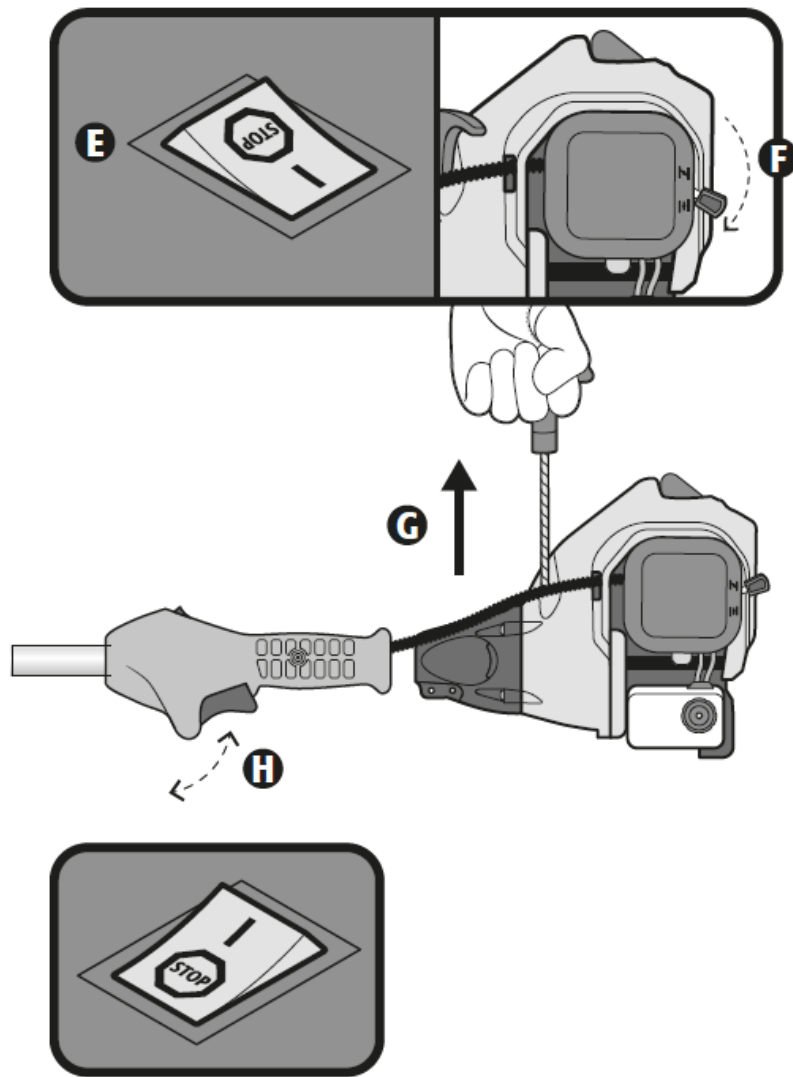

Turning OFF

- Release the lock and the throttle trigger and run it idle for 10 seconds to 15 seconds.
- Set the switch into the off position until the motor stops.

Operation

- **CAUTION** Remember that you, being the string trimmer operator, are responsible of your safety and the safety of those who are near your work area. Follow all security standards (pages 4 and 5) before operating the tool.
- Keep good balance with both feet firmly set on ground.
Hold firmly the string trimmer in front of you. Set one hand in the handle and the other in the auxiliary handle to have the tool aligned to your body and pointing the cutter head 30° downwards, away from your feet.
- **DANGER** Do not turn on or operate the string trimmer in any other position.
- Turn on the string trimmer and make cuts from left to right rotating your waist and

keeping the tool position.

- As you cut grass the cutting thread will wear and will fall. To release more thread from the spool press the string trimmer lightly downwards to have the ground pressing the retention cap against the spool and to release more thread. The guard blade will cut the remaining thread. At this moment stop pushing the string trimmer against the ground to stop spending more thread.
- To cut brush or tall grasses make it gradually. Do not try to cut in one pass from its base because residue could clog the cutting head or make you lose control over the string trimmer.

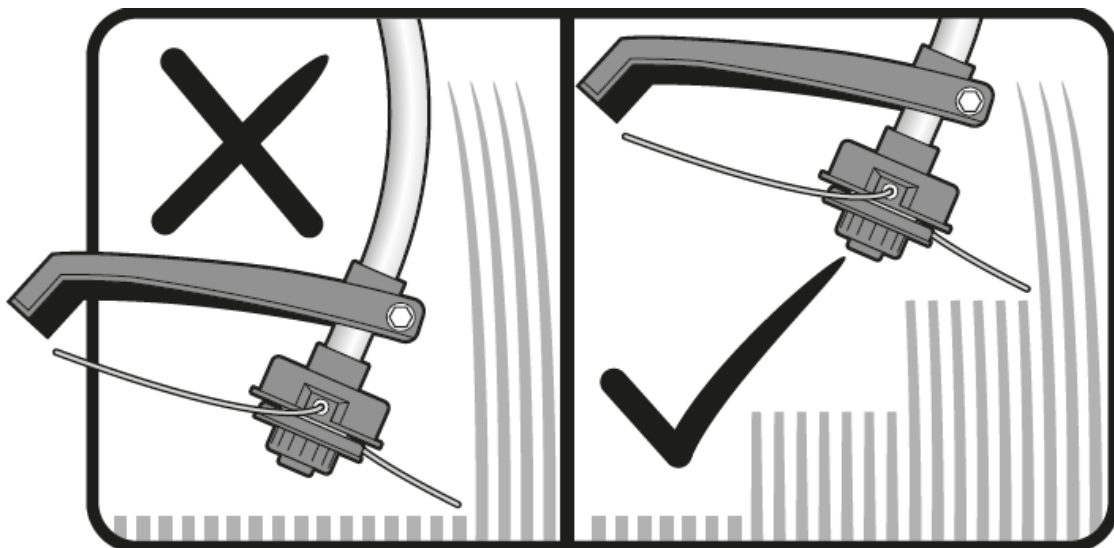
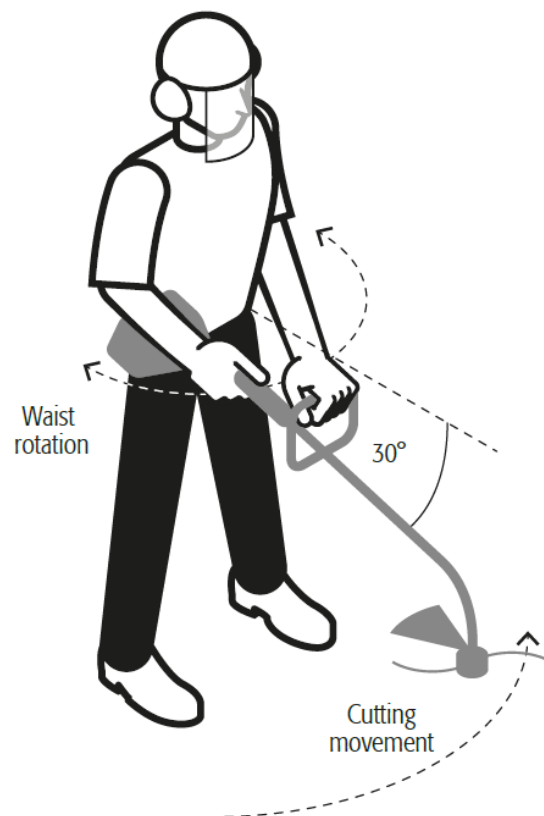

Maintenance

- Before inspecting, cleaning or servicing the string trimmer, turn off the motor. Wait for all the moving parts to stop. Disconnect the spark plug cable and separate it from the spark plug. Otherwise, you could be severely injured and the equipment could get damaged.

General cleaning

- Clean and unblock all the starter unit ventilation slots with a brush when necessary.
- Like ways, periodically clean the motor cylinder wings and the fan wings to remove dirt. Not doing it will cause the motor to overheat and get damaged.

Cleaning the air filter

- Remove the air filter cap pressing the sides and lifting it.
- Remove the air filter.
- Depending of the time it has been used you can give a superficial cleaning to the filter by only tapping it against a flat surface to remove most of the particles.
- You can also blow the filter with compressed air. Do it in both sides.
- For a more complete cleaning wash the filter in lukewarm soapy water. Rinse it and let it dry before installing it back in the tool.
- Install back the air filter verifying it clicks in place.
- Clean the air filter as frequently as necessary to keep it always clean. Otherwise the motor performance will diminish.

Fuel filter

- Check the gasoline filter frequently.
- If the filter is dirty, replace it.
- If the gas tank interior is dirty rinse it with gasoline.

Carburetor adjustment

- We recommend making carburetor adjustments in a TRUPER Authorized Service Center.

- A wrong adjustment can damage the motor and make the warranty void.

Spark plug replacement

- With a totally cold motor, loosen the worn spark plug turning left with the spark plug spanner and remove it.
- Insert the new spark plug and tighten to the right by hand. Then, tighten more using the spanner.
- **CAUTION** Use care not to damage the spark plug thread. Otherwise the motor will be seriously damaged.

Exhaust and muffler cleaning

- The exhaust and muffler can be clogged with carbon deposits, depending on the type of fuel, the amount of oil used and / or the conditions the tool is used. If noticing loss of power you should remove the deposits to restore performance. Go to a TRUPER Authorized Service Center to have this service made.
- The muffler is equipped with an anti-spark screen inside the muffler. After being used long periods of time the screen gets dirty and needs to be replaced.
Go to a TRUPER Authorized Service Center to have it replaced.

CAUTION Check constantly that the muffler has the fasteners secured and that there is no damage or corrosion. If finding leaks, stop the tool and immediately go to a TRUPER Authorized Service Center to have it repaired.

Tool storage





If storing the tool a month or more, be aware of the following:

- Drain all the contents in the fuel tank into an approved gasoline container.
All the remaining fuel should be used again in other equipment with a two-cycle motor with a ratio of 40:1.
- Run the motor until the rest of the fuel is consumed and the motor shuts off by itself.
This way you eliminate the fuel residues and will avoid gum forming and damaging the fuel system.
- Clean thoroughly.

- Store the tool in a ventilated space, away from corrosive agents like garden chemical substances or deicing salts. Also store away from children.
- Comply with all the government rules regarding safety in handling and storing fuel.

| Regular maintenance | Every use | Every 25 h of use | Every 50 h of use | Every 150 h of use | Every 250 h of use |
|--|-----------|-------------------|-------------------|--------------------|--------------------|
| General cleaning | ✓ | | | | |
| Air filter cleaning | | | | | |
| Carburetor cleaning * | | | | | |
| Spark plug inspection and adjustment * | | | | | |
| Fuel tank cleaning ** | | | | | |
| Fuel filter change ** | | | | | |
| Fuel chamber replacement ** | | | | | |
| Combustion chamber cleaning ** | | | | | |

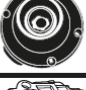
Available accessories and replacement parts list

| Component | Code | Part | Description |
|---|--------|---------------|---|
|  | 16924 | RET-GRUPO-01 | Spool retainer for Truper string trimmer |
|  | 16926 | REP-GRUPO-01 | Bump feed head for Truper string trimmer |
|  | 16925 | TAP-GRUPO-01 | Trimmer spool head replacement for Truper |
|  | 101814 | CB-DES-GRUPO2 | Carburetor for gas string trimmer |
|  | 26131 | KC-DES-25P | Carburetor maintenance kit |

Troubleshooting

| Problem | Cause | Solution |
|---|--|---|
| The motor does not start. | <ul style="list-style-type: none"> • There is no spark. • There is no fuel. • The motor is choked. • The starter jack is pulling with more difficulty than when new. | <ul style="list-style-type: none"> • Check the spark. Remove the motor cover. Remove the spark plug from the cylinder. Connect the spark plug cable and set it on top of the motor cylinder with its metal part touching the cylinder. Pull the starter and watch the spark in the spark plug electrode. If there is no spark, repeat the test with a new spark plug. • Press the starter choke until the fuel is visible in the choke. If no fuel is showing it means that the fuel supply primary system is blocked. Contact an TRUPER Authorized Service Center. If the starter choke fills with fuel, it means the motor is choked. • With the switch off, remove the spark plug. Move the choke lever downwards and pull the starter handle 15 to 20 times to eliminate the fuel excess in the motor. Clean the spark plug and reinstall. Follow the normal starting procedure (consult page 8). If the motor does not start, move the choke lever downwards and repeat the starting procedure. If the motor is still not running, repeat the procedure but this time using a new spark plug. • Take the tool to a TRUPER Authorized Service Center. |
| The motor starts but it is not accelerating. | <ul style="list-style-type: none"> • The motor needs a few minutes to warm up. | <ul style="list-style-type: none"> • Allow the motor to warm up completely. If the motor is not accelerating after three minutes contact your TRUPER Authorized Service Center. |
| The motor starts but it only runs high speed with half choke. | <ul style="list-style-type: none"> • Carburetor needs adjustment. | <ul style="list-style-type: none"> • Take the tool to a TRUPER Authorized Service Center. |
| The motor is not gaining full speed and has too much smoke emissions. | <ul style="list-style-type: none"> • Check the oil / fuel mix. • The air filter is dirty. • The anti spark guard screen is dirty. | <ul style="list-style-type: none"> • Use new fuel and the right oil mix for two-cycle. • Clean the air filter. See page 10. • Take the tool to a TRUPER Authorized Service Center. |

Authorized service centers

In the event of any problem contacting a Truper Authorized Service Center, please see our webpage WWW.TRUPER.COM to get an updated list, or call our toll-free numbers 800 690-6990 or 800 018-7873 to get information about the nearest Service Center.

Warranty policy

- Code 22430
- Model DES-25P
- Brand PRETUL

Warranty. Duration: 1 year. Coverage: parts, components and workmanship against manufacturing or operating defects, except if used under conditions other than normal; when it was not operated in accordance with the instructive; was altered or repaired by

personnel not authorized by TRUPER®. To make the warranty valid, present the product, stamped policy or invoice or receipt or voucher, in the establishment where you bought it or in Corregidora 35, Centro, Cuauhtémoc, CDMX, 06060, where you can also purchase parts, components, consumables and accessories. It includes the costs of transportation of the product that derive from its fulfillment of its service network. .

Phone number 800-018-7873. Made in China. Imported by TRUPER, S.A. de C.V.

Parque Industrial 1, Parque Industrial Jilotepec, Jilotepec, Edo. de Méx. C.P. 54257,

Phone number 761 782 9100.

Stamp of the business. Delivery date:

WWW.TRUPER.COM

FAQ

- **Q: Can I use any type of gasoline for this trimmer?**

A: It is recommended to use high-octane gasoline for better performance. In Mexico, PREMIUM gasoline is suggested.

- **Q: What happens if I use the wrong gasoline-oil mixture ratio?**

A: Using the wrong mixture can cause serious engine damage and may lead to costly repairs.

- **Q: How often should I perform maintenance on the trimmer?**

A: Periodic maintenance should be performed as indicated on page 10 of the manual to keep the trimmer in good working condition.

Documents / Resources

| | |
|---|--|
|  | <p>PRETUL DES-25P Gas String Trimmer [pdf] Instructions</p> <p>DES-25P, 22430, DES-25P Gas String Trimmer, DES-25P, Gas String Trimmer, String Trimmer</p> |
|---|--|

References

- [User Manual](#)

Leave a comment

Your email address will not be published. Required fields are marked *

Comment *

Name

Email

Website

☐ Save my name, email, and website in this browser for the next time I comment.

Post Comment

Search:

e.g. whirlpool wrf535swhz

Search

[Manuals+](#) | [Upload](#) | [Deep Search](#) | [Privacy Policy](#) | [@manuals.plus](#) | [YouTube](#)

This website is an independent publication and is neither affiliated with nor endorsed by any of the trademark owners. The "Bluetooth®" word mark and logos are registered trademarks owned by Bluetooth SIG, Inc. The "Wi-Fi®" word mark and logos are registered trademarks owned by the Wi-Fi Alliance. Any use of these marks on this website does not imply any affiliation with or endorsement.