

**Contents** [ [hide](#) ]

- [1 Prestigio PSMB528K002 Mini Computer](#)
- [2 Product Usage Instructions](#)
- [3 Preparing for Operation](#)
- [4 Technical specifications.](#)
- [5 Troubleshooting](#)
- [6 FAQs](#)
- [7 Documents / Resources](#)
  - [7.1 References](#)
- [8 Related Posts](#)

# Prestigio

## Prestigio PSMB528K002 Mini Computer



## Specifications

- Model: PSMB528K002
- Version: 1.0.1
- Date: 13.06.2024

## Product Information

The Mini Computer PSMB528K002 is designed for working with programs based on the Windows operating system (OS), data creation, and processing. It can be installed into Multiboard interactive panels of compatible series Light, Light+, Prime, or used as a desktop mini computer.

## Product Usage Instructions

### Preparing for Operation

1. Carefully open the box, take out the device and accessories. Remove any packaging materials.
2. Choose the devices to be connected to the mini computer connectors (JAE (80 pin), HDMI OUT, LAN (RJ45), AUX, USB (A), USB (C)).

### Intended Use

- Data exchange with the Multiboard interactive panel
- Video signal output to the monitor
- Data exchange with network devices (router, etc.)
- Audio signal input and/or output from/to headset, acoustic systems, etc.
- Data exchange with peripheral devices (keyboard, mouse, web camera, etc.), devices powering/charging (up to 5.0 V, 0.9 A)
- Data exchange with peripheral devices (keyboard, mouse, web camera, etc.), devices powering/charging (up to 5.0 V, 1.0 A)

### Installation and Operation

The device can be used in two ways:

1. As a mini-computer built into the Multiboard interactive panel:

- Ensure compatibility with Multiboard Light, Light+, and Prime series interactive panels.
- Connect interactive panel's touch screen, remote control, keyboard, and mouse.
- Set up access to the Wi-Fi network.

2. As a desktop mini computer with peripheral devices connected:

- Use a power adapter with the required parameters.
- Connect external data carriers (flash drives), conference call devices (web cameras, speakerphones), and acoustic systems.

## LED Indication

Indicator	Status	Description
On (red)	Device is turned on and operating	
Off	Device is turned off / no power supply	
Flashing green	Internal drive is running, data transfer is in progress, low load	
On (green)	Internal drive is running, data transfer is in progress, high load	
Off	Internal drive not running / no power supply available	

## Preparing for Operation

I

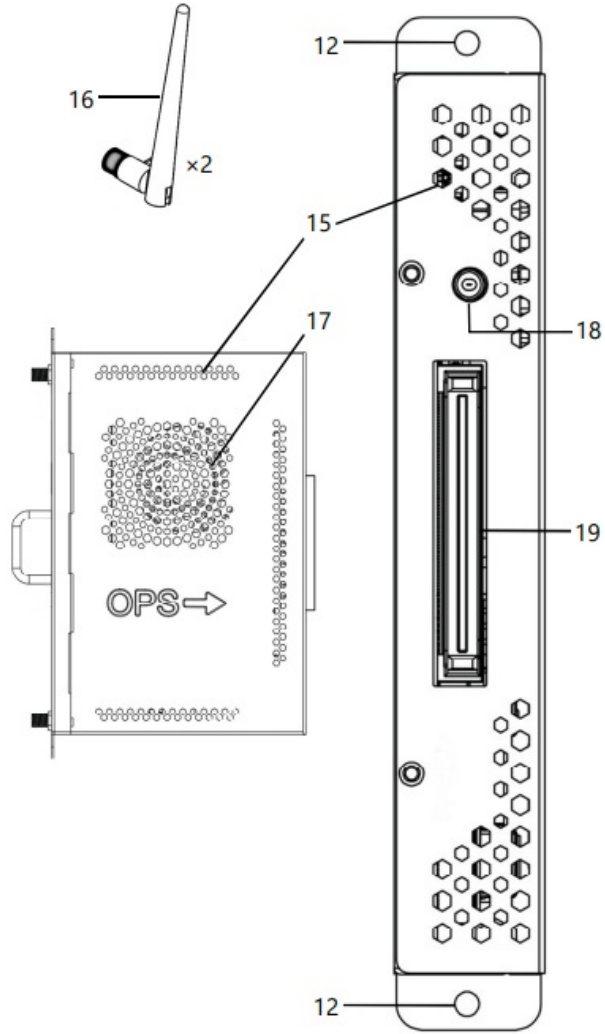
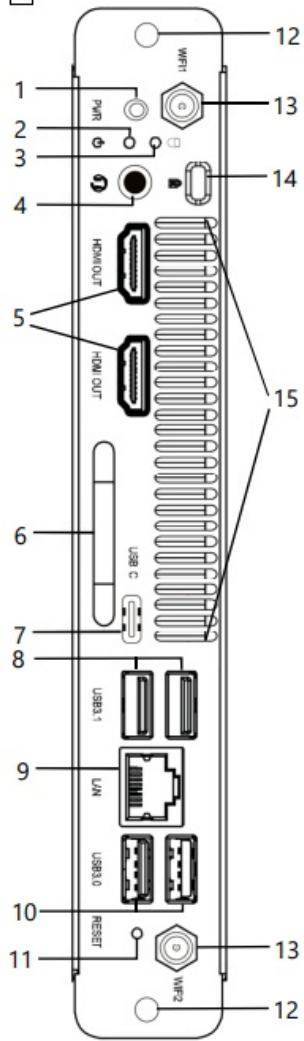

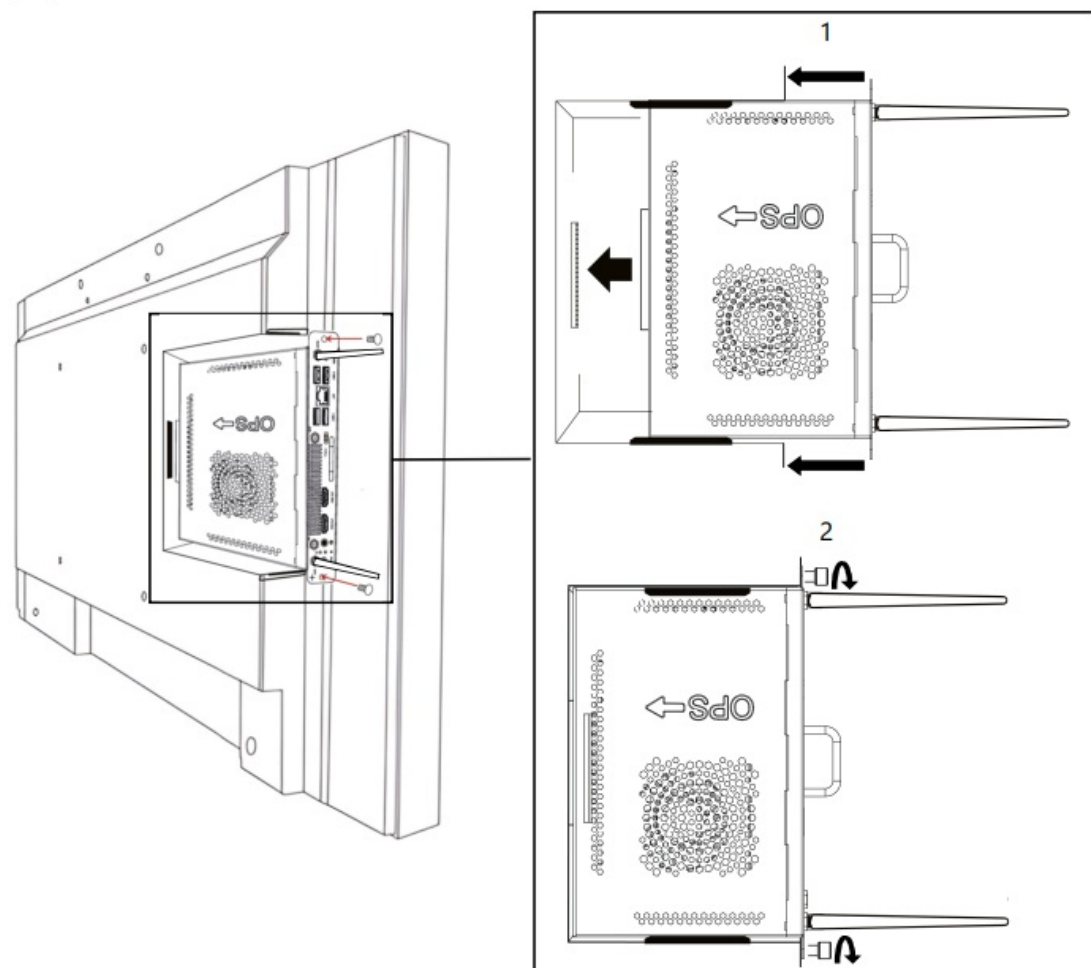

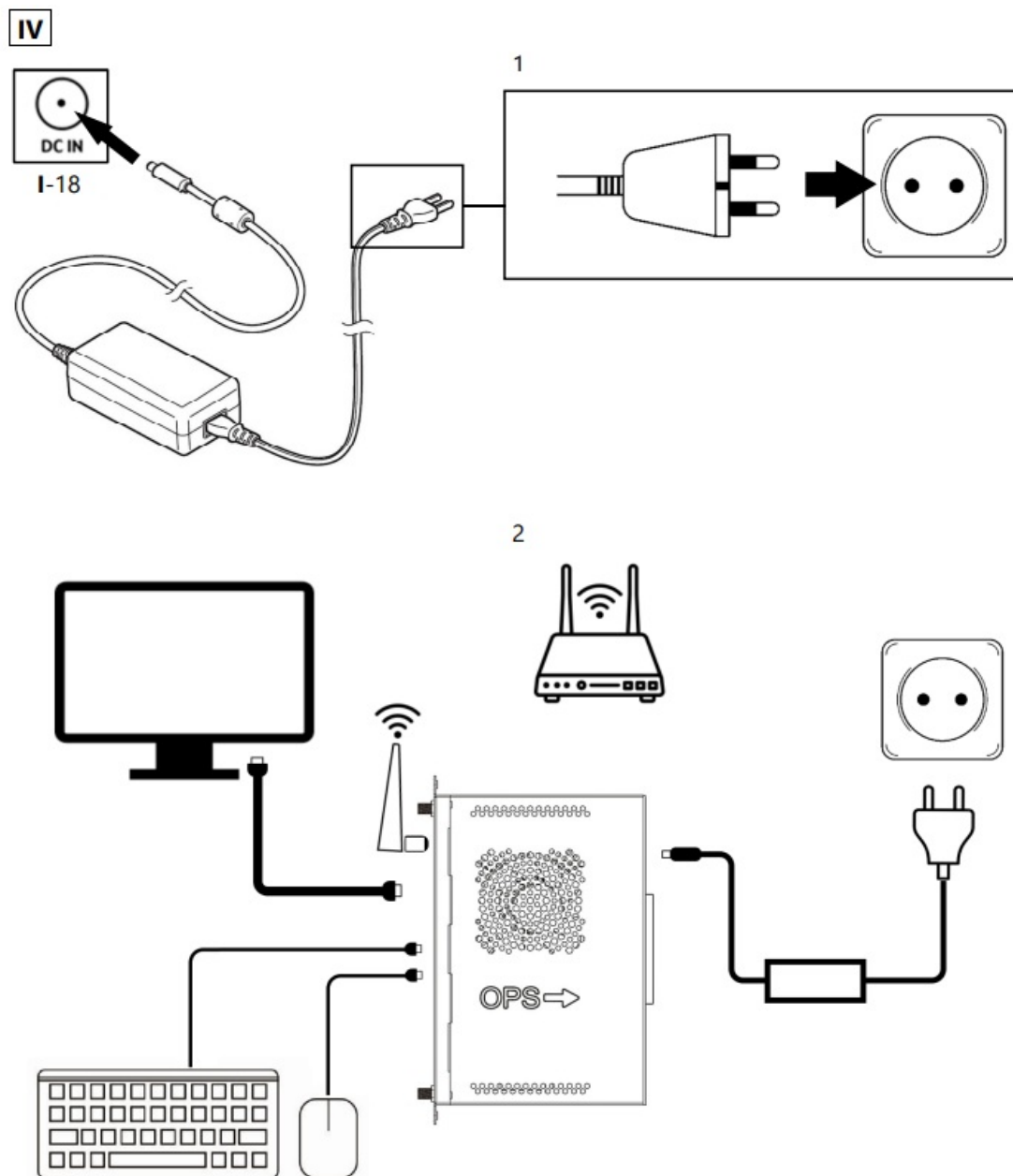

## I – Appearance (see page 4)

1. Power button
2. Power indicator
3. Internal drive status indicator
4. AUX connector
5. HDMI OUT connectors
6. Handle
7. USB (C) 3.1 connector
8. USB (A) 3.1 connector
9. LAN (RJ45) connector
10. USB (A) 3.0 connectors

11. Restart button
12. Mounting holes
13. Connectors for antennas (Wi-Fi network)
14. Kensington lock
15. Ventilation holes
16. Antennas
17. Cooling fan (under the protective grid)
18. Power connector
19. JAE (80 pin) connector

## **II – Example of antenna connection to the connector (see page 5 \*)**

NOTE. 2 identical antennas are included in the package. Wi-Fi network operation depends on antenna connection to the specific connector (I-13).

## **III – Installation into the interactive panel (see page 5 \*)**

1. Insertion into the slot on the back of the interactive panel
2. Fixing with fastening screws

## **IV – Use as a desktop mini computer (see page 6 \*)**

1. Power adapter connection (not included in the package)
2. Example of peripheral devices connection to the mini computer

Mini computer PSMB528K002 is designed for working with programs based on Windows operating system (OS), data creation and processing. It can be installed into Multiboard interactive panel (compatible series Light, Light+, Prime). It can also be used as a desktop mini computer.

## **Technical specifications.**

- Power supply: input 19 V (DC), 4.74 A, 90.0 W max. (standby  $\leq 0.83$  W); USB (A)
- output: 5.0 V (DC), 0.9 A, USB (C) output: 5.0 V (DC), 1.0 A.

## **Power adapter required parameters:**

- input 100–240 V (AC), 50/60 Hz; output 19 V (DC), 4.74 A, 90.0 W.
- Connectors: JAE (80 pin); HDMI OUT (×2); LAN (RJ45);
- AUX; USB (A) 3.0 (×2); USB (A) 3.1 (×2); USB (C) 3.1.
- CPU: Intel Core i5 1235U 4.4 GHz (10 cores).
- GPU: Intel Iris Xe Graphics 1.2 GHz.
- Audio codec: Realtek ALC897.
- RAM: DDR5, 8 GB (64 GB max.).
- ROM: SSD, 256 GB. LAN 10/100/1000 Mbps.
- Wi-Fi 802.11 (2.4/5.0 GHz): ≤ 17 dBm (50.12 mW).
- BT 5.2: ≤ 9.5 dBm (8.91 mW). OS Windows 11 Pro.
- Control: manual (keyboard and mouse, Multiboard touch screen), remote (remote control for Multiboard).
- Material: metal, plastic. Color: black. Size (L×W×H): 180×119×30 mm. Net weight: 1.5 kg.
- Operating conditions: temperature –5...+45 °C; RH 10–95 % (non-condensing).
- Storage conditions: temperature –20...+60 °C; RH 10–95 % (non-condensing).
- Package includes: mini computer PSMB528K002, antennas (2 pcs.), fastening screws (2 pcs.), Quick Start Guide. Warranty: 2 years, unless otherwise specified by local law (see [prestigio-solutions.com/warranty](https://prestigio-solutions.com/warranty)).
- Service life: 2 years.
- If you have any problems or questions while using the device, contact the technical support before returning it to the seller. To do so, fill out the form at the bottom of the home page at [prestigio-solutions.com](https://prestigio-solutions.com).
- The images are for illustrative purposes only.

## Limitations and warnings

**ATTENTION!** The warnings, precautions and instructions contained in this document do not cover all possible dangerous situations. Use common sense when using the device.

1. Use the device indoors only. Do not expose the device to high temperatures (from an electric heater, direct sunlight). Do not allow liquids or dust to get on the device.
2. Do not block the ventilation holes of the device.
3. The device is not intended for use by children under the age of 14 or by persons with

reduced physical, mental or intellectual abilities if they do not have sufficient experience or knowledge of its operation.

4. Do not turn on the power of the mini computer and/or interactive panel before connecting the cables.
5. Use the connectors of the mini computer only for their intended purpose. Do not insert foreign objects into the connectors, do not use force when connecting cables or flash drives to the connectors.
6. Do not crimp or pinch the cables connected to the mini computer. Do not allow them to come into contact with hot surfaces and sharp objects.
7. Turn off the mini computer before turning off the interactive panel. Disconnect the mini computer from the interactive panel only after both devices have been turned off.
8. After turning the device off, wait at least 30 seconds before turning it back on again.
9. Before cleaning, turn off the mini computer, disconnect it from the interactive panel. Use a dry, soft, lint-free cloth for cleaning. Do not use aggressive or abrasive detergents, or metal sponges.
10. Disconnect the device from the power source during lightning storms.
11. Regularly update the installed software and firmware of the device to their latest versions.
12. Before installing the software, make sure that its system requirements match the parameters of the mini computer. If you have any questions concerning the software operation, please contact support of its developer.
13. Do not drop or bump the device.
14. If the device has been transported or stored at low temperatures, leave it at room temperature for 2 hours before use.
15. If you notice smoke, noise or odor from the device, disconnect it immediately from the power source. Contact technical support by filling out the feedback form on the home page of [prestigio-solutions.com](http://prestigio-solutions.com).

## **Preparing for operation**

1. Carefully open the box, take out the device and accessories. Remove any packaging materials.
2. Choose the devices to be connected to the mini computer connectors (I).

Connector	Intended use
JAE (80 pin)	Data exchange with the Multiboard interactive panel
HDMI OUT	Video signal output to the monitor
LAN (RJ45)	Data exchange with network devices (router, etc.)
AUX	Audio signal input and/or output from/to headset, acoustic systems, etc.
USB (A)	Data exchange with peripheral devices (keyboard, mouse, web camera, etc.), devices powering/charging (up to 5.0 V, 0.9 A)
USB (C)	Data exchange with peripheral devices (keyboard, mouse, web camera, etc.), devices powering/charging (up to 5.0 V, 1.0 A)

**NOTE.** The interactive panel, peripheral devices, connection cables are not included in the package. Signal quality and charging speed depend on the cable characteristics, so use original certified cables.

For using Wi-Fi network, screw the antennas to the connectors (I-13) as far as they will go (II). For better connection quality (Wi-Fi), use two antennas instead of one for each network. In this way all 2 antennas can be connected at the same time.

**NOTE.** If the antennas are not connected, network signal input will be weak or may not be available.

## Installation and operation'

## **The device is used in two ways:**

- As a mini computer built into the Multiboard interactive panel;
- As a desktop mini computer with peripheral devices connected.

### **Mini computer built into the Multiboard interactive panel**

**ATTENTION!** The mini computer is only compatible with Multiboard Light, Light+ and Prime series interactive panels. Do not install the mini computer into the interactive panels of other manufacturers and series.

**NOTE.** Please refer to the instructions for the interactive panel to set up the devices correctly. You can download it from [prestigio-solutions.com](http://prestigio-solutions.com) on the panel information page.

1. Make sure the power of the interactive panel is turned off. Insert the mini computer into the interactive panel slot (III-1) and fix it manually with the fastening screws (III-2). Make sure that the screws are tightened securely.
2. Connect the keyboard and mouse to the mini computer USB connectors in case of using them instead of the interactive panel, to control the device.
3. Turn on the interactive panel (see also the instructions for the interactive panel). It is the power source for the mini computer. Wait for the Android OS interface to appear on the interactive panel screen. Turn on the mini computer by pressing the power button (I-1).
4. Select the mini computer as the signal source for the interactive panel. In the interactive panel's menu, select the "Signal source" section, then select the "OPS" option (see also the instructions for the interactive panel). Wait for the Windows OS interface to appear on the interactive panel screen.
5. Control the mini computer with (choice of):
  - Interactive panel's touch screen;
  - Remote control of the interactive panel;
  - Keyboard and mouse.
6. Set up access to the Wi-Fi network. In the lower right corner of the screen, press on the icon . In the list that appears, select the desired network, then press "Connect".

## Desktop mini computer with peripheral devices connected



### ATTENTION!

Power adapter is necessary (see the required parameters above).

1. Place the mini computer on a clean, dry, and stable surface (table, stand, etc.).
2. Connect peripheral devices (monitor, keyboard, mouse, etc.) to the mini computer's connectors.
3. Connect the power adapter to the mini computer (IV-1). Insert the plug into the outlet.
4. Turn on the mini computer by pressing the power button (I-1). Wait for the Windows OS interface to appear on the monitor.
5. Control the mini computer with the keyboard and mouse connected.
6. Set up access to the Wi-Fi network. In the lower right corner of the screen, press on the icon . In the list that appears, select the desired network, then press "Connect".

You can also connect external data carriers (flash drives), conference call devices (web cameras, speakerphones), and acoustic systems to the mini computer.

### LED indication

Indicator	Status	Description
	On (red)	The device is turned on and operating
	Off	Device is turned off / no power supply
	Flashing green	Internal drive is running, data transfer is in progress, low load
	On (green)	Internal drive is running, data transfer is in progress, high load
	Off	Internal drive not running / no power supply available

### Shut down

When you are finished, close all apps. Next, shut down the mini computer in one of the following ways:

- In the “Start” menu, select “Power” → “Shut down”
- Press the power button (I-1) once.

**NOTE.** For detailed information about the mini computer functionality, see the full user manual of the device at: [prestigio-solutions.com](http://prestigio-solutions.com).

## Troubleshooting

1. The LEDs are off, the mini computer does not turn on:
  - The power supply is faulty. Connect the interactive panel or power adapter (depending on the way of using the mini computer) to other outlet. Check that the mains are in good working order;
  - The mini computer is not properly connected to the interactive panel. Make sure that the mini computer is inserted into the slot as far as it will go and that the screws are tightened securely. If necessary, disconnect the mini computer and reinsert it into the slot, tighten the screws.
2. Windows OS is not booting:
  - The SSD drive is faulty. Contact a service center for diagnosis and repair;
  - The OS is damaged or not installed. Install/reinstall the OS or contact a service center for diagnosis and recovery.
3. The interface on the screen “freezes” or does not respond: overload from active processes. Press the restart button (I-11) with a thin object (paper clip, etc.).
4. The Internet signal is weak or missing:
  - There is interference with the network signal (electrical appliances, building structures). Correct the interference or change the mini computer location;
  - The antennas are not screwed to the Wi-Fi connectors as far as they will go. Make sure the antennas are screwed as far as they will go;
  - The network to be connected is unavailable. Check your connection settings, contact your service provider if necessary.
5. The mini computer is making a lot of noise and/or is overheating:
  - The cooling system is contaminated or defective. Contact a service center to diagnose and clean the cooling system.

**ATTENTION!** If none of the suggested solutions solve the problem, contact your supplier or an authorized service center (see [prestigio-solutions.com/warranty](http://prestigio-solutions.com/warranty) for centres' addresses). Do not disassemble the device or attempt to repair it yourself.

## **SIMPLIFIED DECLARATION OF CONFORMITY**

Hereby, ASBISC declares that the device is in compliance with Directive 2014/53/EU. The full text of the EU declaration of conformity is available at the following internet address: [files.prestigio-solutions.com/documents/certificates/multiboards](http://files.prestigio-solutions.com/documents/certificates/multiboards).

## **Recycling information.**



This symbol means that you must follow the Waste Electrical and Electronic Equipment (WEEE) regulations when disposing of the device and its electrical and electronic accessories. According to the rules, this equipment must be disposed of separately at the end of its service life. Do not dispose of the device and its electrical and electronic accessories together with unsorted municipal waste, as this would be harmful to the environment. To dispose of this equipment, it must be returned to the point of sale or turned in to a local recycling facility. You should contact your local household waste disposal service for more information.

- All trademarks and trade names mentioned are the property of their respective owners. The information in this document is subject to change without prior notice to users. Up-to-date information and a detailed description of the device, as well as connection instructions, certificates, information about companies accepting quality claims and warranty, are available in the full user manual at [prestigio-solutions.com](http://prestigio-solutions.com).
- The manufacture date is indicated on the sticker under the serial number. Made in China.
- Information on the operating process

## **WARRANTY CARD**

- **Product:**
- **Serial number:**
- **Purchase date:**
- **Dealer:**

- **Dealer's stamp**
- **Customer's signature**

The complete warranty card is available for downloading at the webpage [prestigio-solutions.com/warranty](http://prestigio-solutions.com/warranty).

[prestigio-solutions.com](http://prestigio-solutions.com)

## FAQS

**Q: Can I install the mini computer into interactive panels of other manufacturers and series?**

A: No, the mini computer is only compatible with Multiboard Light, Light+, and Prime series interactive panels.



**Q: How can I contact technical support?**

A: To contact technical support, fill out the form at the bottom of the home page at [prestigio-solutions.com](http://prestigio-solutions.com).

## Documents / Resources

	<p><a href="#">Prestigio PSMB528K002 Mini Computer [pdf]</a> User Guide</p> <p>PSMB528K002 Mini Computer, PSMB528K002, Mini Computer, Compute r</p>
---	---

## References

-  [ASBIS – IT Distributor](#)
-  [Prestigio Solutions | Hardware & Software solutions for business and education](#)
-  [Prestigio Solutions Service Centers](#)
- [User Manual](#)

## Related Posts

[ZEBRA TN28 Touch Computer User Guide](#)



## ZEBRA TN28 Touch Computer User Guide



### [DJI Mini 2 User Guide](#)

DJI Mini 2 User Guide Steps: Step 1:      DJI Fly APp  
Step 2: ...



### [Honeywell MOBILE COMPUTER User Guide](#)

Honeywell MOBILE COMPUTER User Guide DOCKS  
AND MODULES HOLSTERS AND HANDLES  
BATTERIES CABLES POWER SUPPLIES AND  
ADAPTERS REPLACEMENT...



### [Acrojoy E502 Mini Projector User Guide](#)

Acrojoy E502 Mini Projector User Guide Frequently  
Asked Questions If you have questions or concerns about  
the projector,...

◆ Computer, Mini computer, Prestigio, PSMB528K002, PSMB528K002 Mini

■ Prestigio    Computer

—Previous Post

**[Prestigio PSMB000L Series Multiboard Light User Guide](#)**

Next Post—

**[Prestigio PSMB528K001 Mini Computer User Guide](#)**

Manuals+, Privacy Policy | @manuals.plus | YouTube

This website is an independent publication and is neither affiliated with nor endorsed by any of the trademark owners. The "Bluetooth®" word mark and logos are registered trademarks owned by Bluetooth SIG, Inc. The "Wi-Fi®" word mark and logos are registered trademarks owned by the Wi-Fi Alliance. Any use of these marks on this website does not imply any affiliation with or endorsement.