



Prestel VCS-S1 Hi-Fi Speaker User Manual

[Home](#) » [Prestel](#) » Prestel VCS-S1 Hi-Fi Speaker User Manual 

Contents

- [1 Prestel VCS-S1 Hi-Fi Speaker](#)
- [2 Product Information](#)
- [3 Product Usage Instructions](#)
- [4 Packing List](#)
- [5 Appearance and Interface](#)
- [6 Installation Method](#)
- [7 Product Specifications](#)
- [8 Safety Instructions](#)
- [9 Using Speaker](#)
- [10 Documents / Resources](#)



Prestel VCS-S1 Hi-Fi Speaker



Product Information

- **Product Name:** Prestel VCS-S1 Hi-Fi Speaker
- **Type:** Speaker
- **Power Supply:** DC 18V/2A
- **Peak Power:** Not specified
- **Sound Channel:** Not specified
- **Driver:** Not specified
- **Functional Interface:** RCA Audio Cable, 3.5mm Audio Cable

- **Distortion:** Not specified
- **Product Weight:** Not specified
- **Product Dimension:** Not specified

Product Usage Instructions

Installation Method A: Table Placement

1. Choose a solid surface to place the Hi-Fi speaker on.
2. Ensure the surface is stable and can support the weight of the speaker.
3. Place the Hi-Fi speaker on the selected surface.

Installation Method B: Wall Mount

1. Locate a suitable wall where you want to mount the Hi-Fi speaker.
2. Use the provided Speaker Wall Mount Screws to securely attach the speaker to the wall.

Note: Please refer to the user manual for detailed instructions on wall mounting and safety precautions.

Packing List

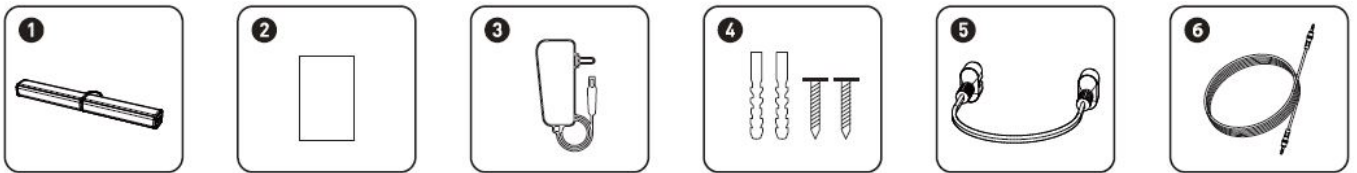

1. Speaker
2. User Manual
3. Power Adapter
4. Wall Mount Screws
5. RCA Audio Cable
6. 3.5mm Audio Cable

Appearance and Interface

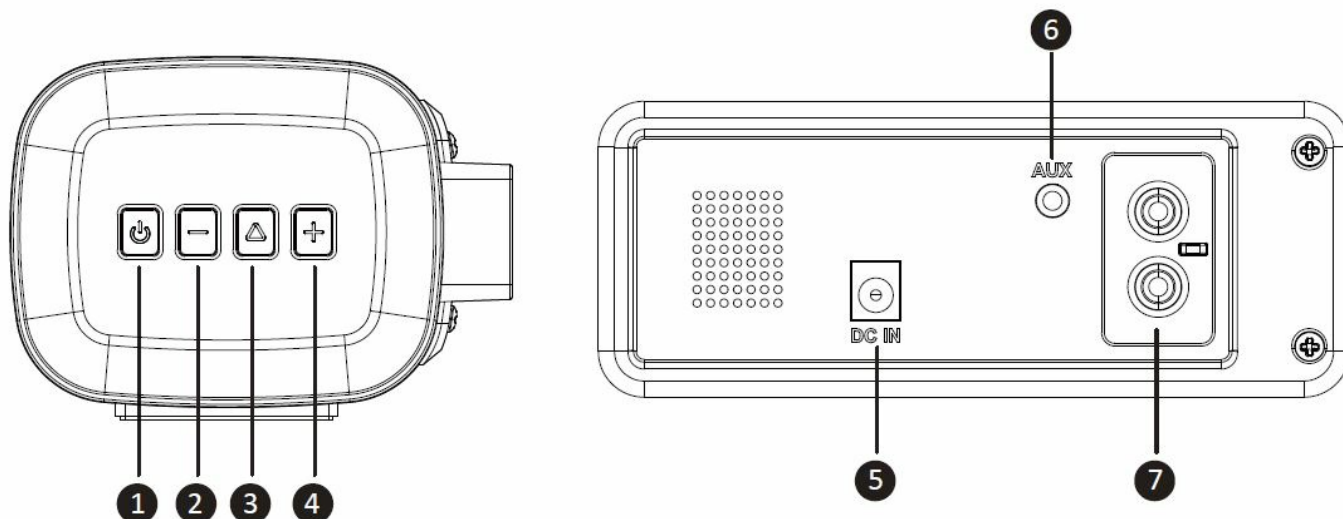

1. **Power Key:** Short press to turn on, long press to turn off.
2. **Volume – Key:** Short press volume -1, long press to decrease quickly.
3. **Play/Pause Key:** Short press to mute the sound.
4. **Volume + Key:** Short press volume +1, long press to increase quickly.
5. **Power Interface:** DC 18V IN.
6. **Audio Interface:** Connect to compatible equipment through 3.5mm RCA audio cable.
7. **RCA Interface:** Main and auxiliary audio connection interface.

Installation Method

A. Table Placement

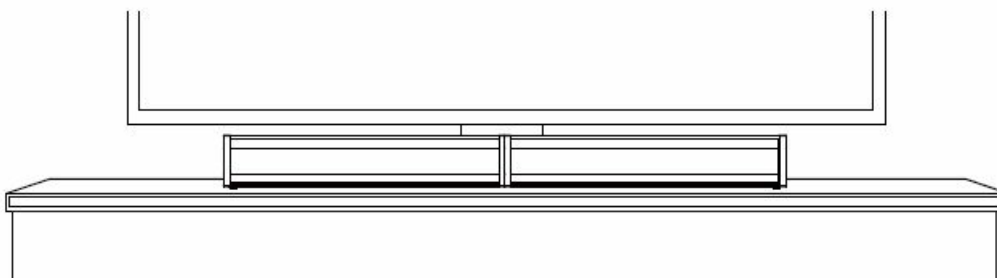

Placement:

Place the Hi-Fi speaker on a solid surface.

B. Wall Mount

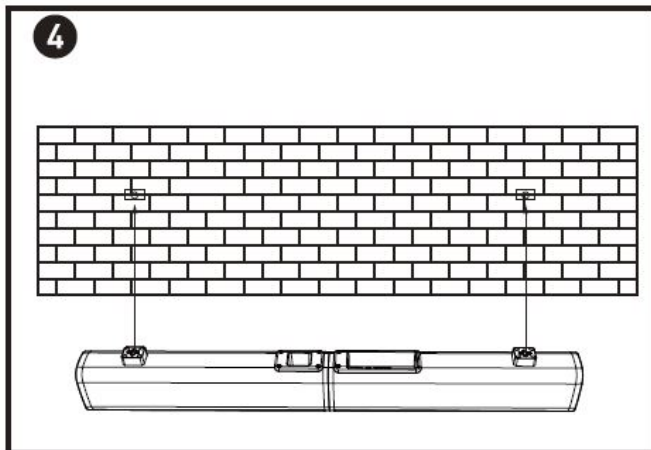
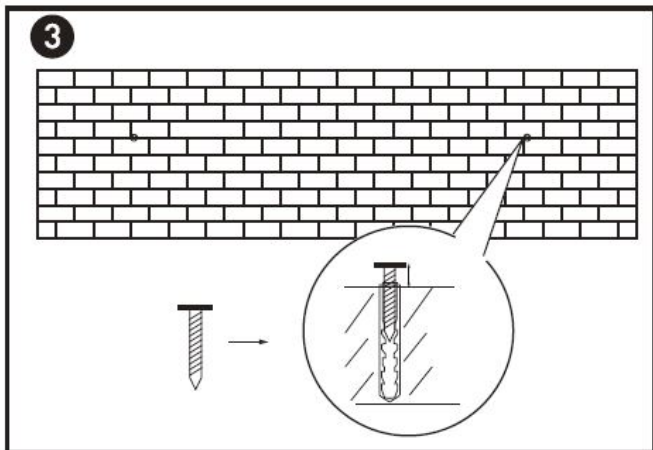
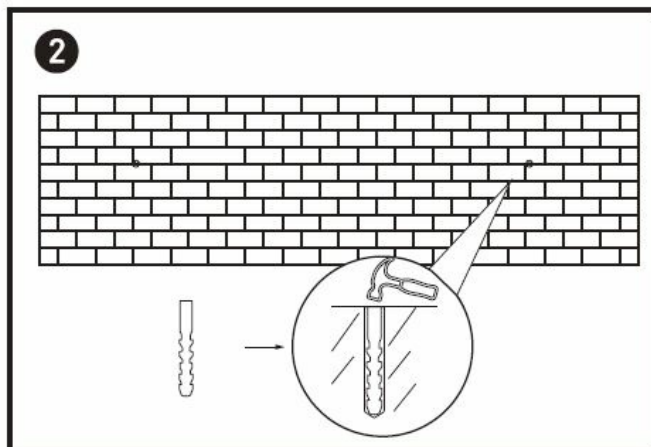
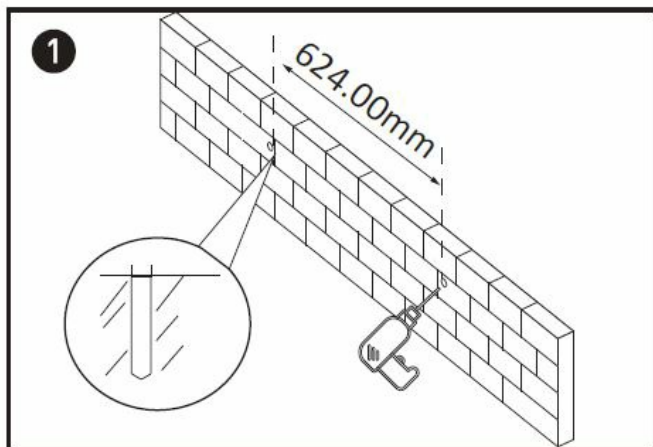

Product Specifications

Type	Speaker
Power Supply	DC 18V/2A
Peak Power	30W
Sound Channel	2.1
Driver	(52×58mm)×2 Driver + Subwoofer 2.25"×2
Functional Interface	AUX×1
Distortion	<1%
Product Weight	2.1kg
Product Dimension	805(L)×90(D)×73(H)mm

Safety Instructions

1. Avoid dropping
2. Do not disassemble
3. Avoid extreme temperatures
4. Don't use the device outdoors during thunderstorms
5. Use original or certified cables

6. Don't use any corrosive cleaner/oil to clean
7. The products should not be exposed to dripping or splashing water

Using Speaker

• A. Power Connection

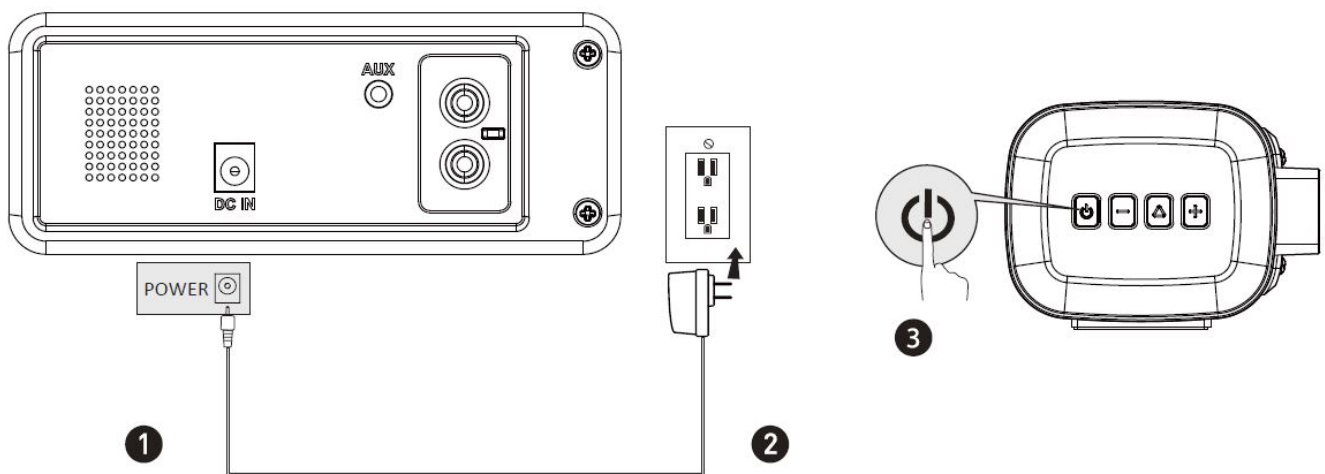

• B. Connect to TV

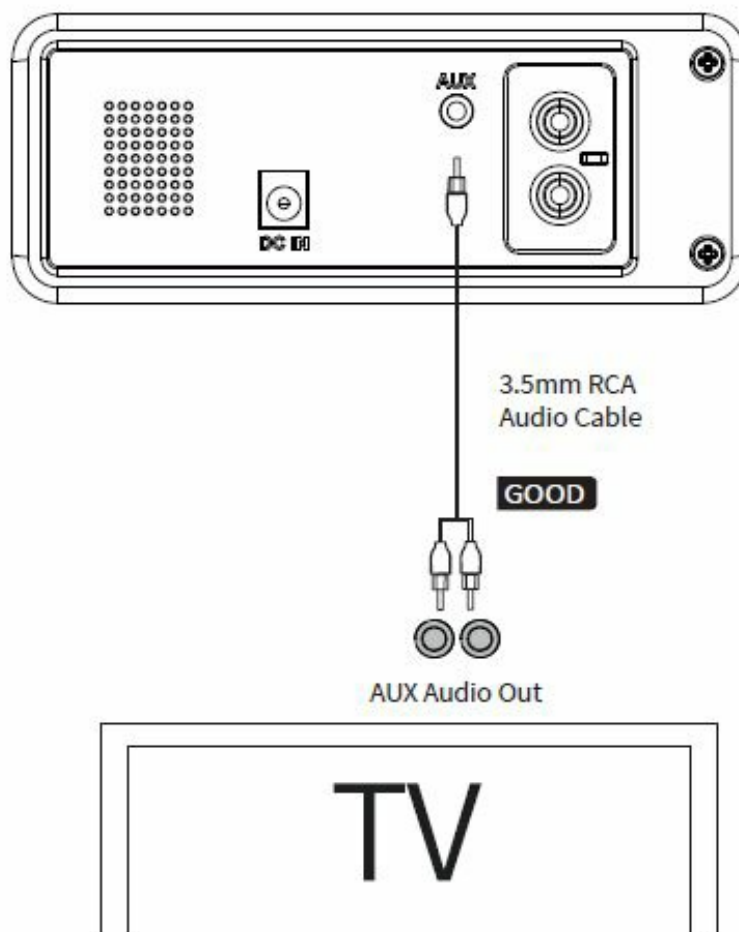

• C. Connect to Other Devices

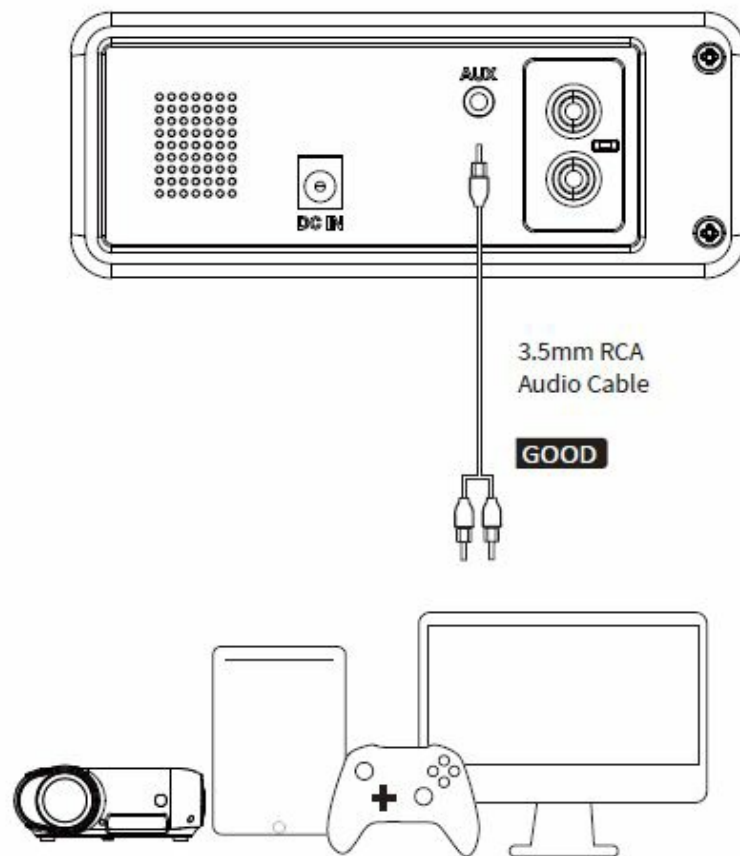



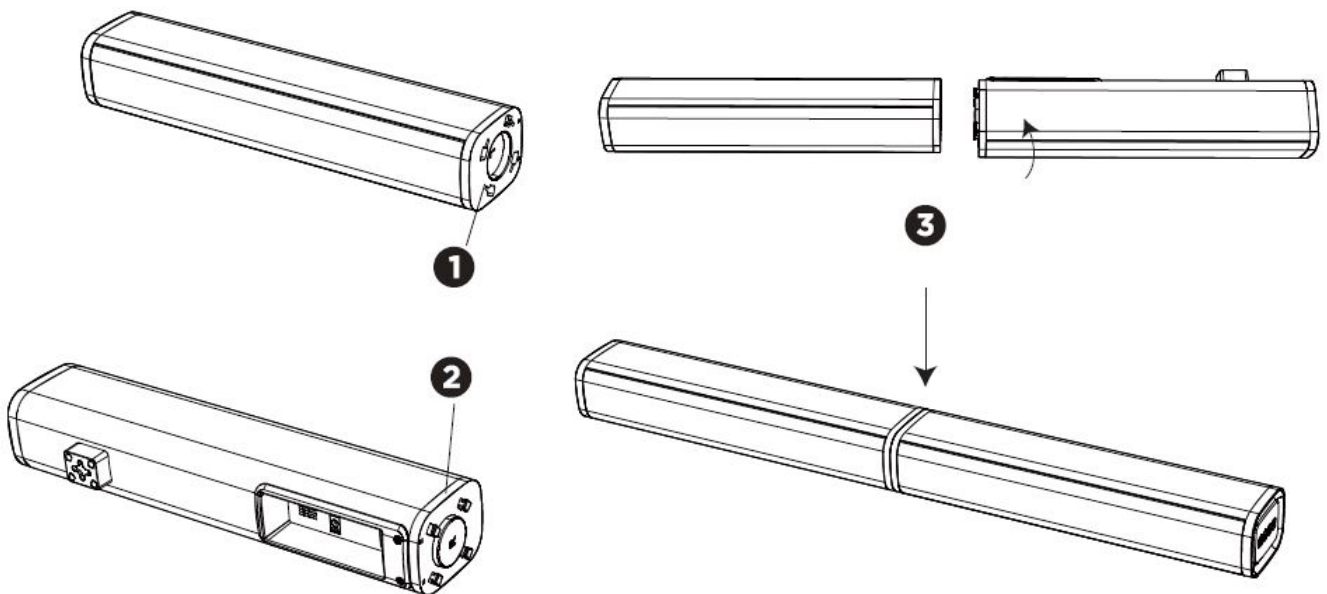

You need to purchase one 3.5mm-3.5mm audio cable if there is only 3.5mm female output on your devices.

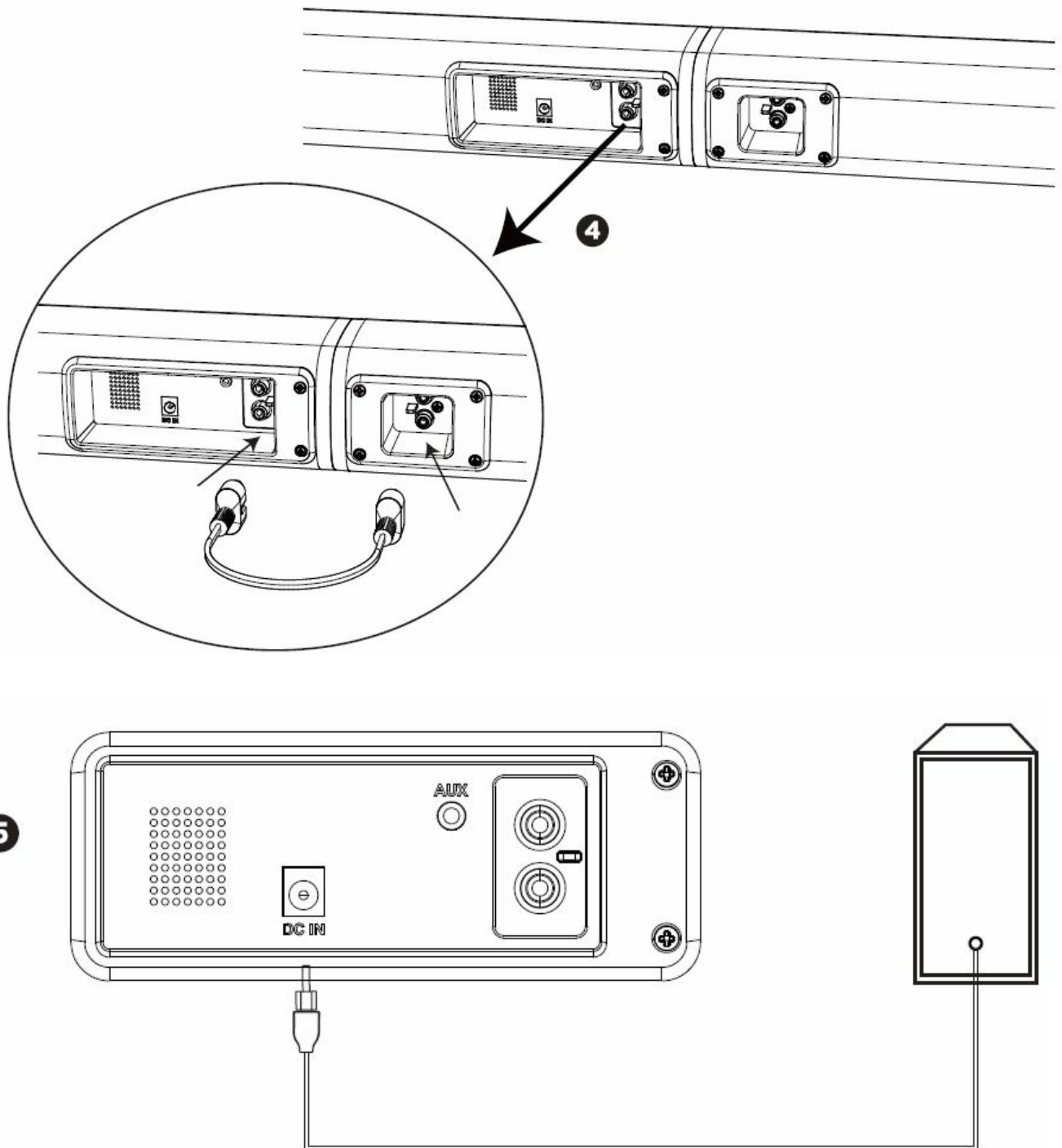
Using Speaker System





Documents / Resources

<p> Prestel</p> <p> Prestel VCS-S1</p> <p> Hi-Fi Speaker</p> <p></p> <p><small>USER MANUAL</small></p>	<p>Prestel VCS-S1 Hi-Fi Speaker [pdf] User Manual</p> <p>VCS-S1, VCS-S1 Hi-Fi Speaker, Hi-Fi Speaker, Speaker</p>
--	---

