



## PreSonus REC0015353-000 MicroStation BT 2.1 Monitor Controller with Bluetooth Connectivity User Guide

[Home](#) » [PreSonus](#) » PreSonus REC0015353-000 MicroStation BT 2.1 Monitor Controller with Bluetooth Connectivity User Guide 

### Contents

- [1 PreSonus REC0015353-000 MicroStation BT 2.1 Monitor Controller with Bluetooth Connectivity](#)
- [2 INSTALLATIONS](#)
- [3 Redfish Couvillion Ingredients:](#)
- [4 Cooking Instructions:](#)
- [5 FEATURES](#)
- [6 FCC Warnings](#)
- [7 Documents / Resources](#)
- [8 Related Posts](#)



**PreSonus REC0015353-000 MicroStation BT 2.1 Monitor Controller with Bluetooth Connectivity**



## INSTALLATIONS

### Hookup

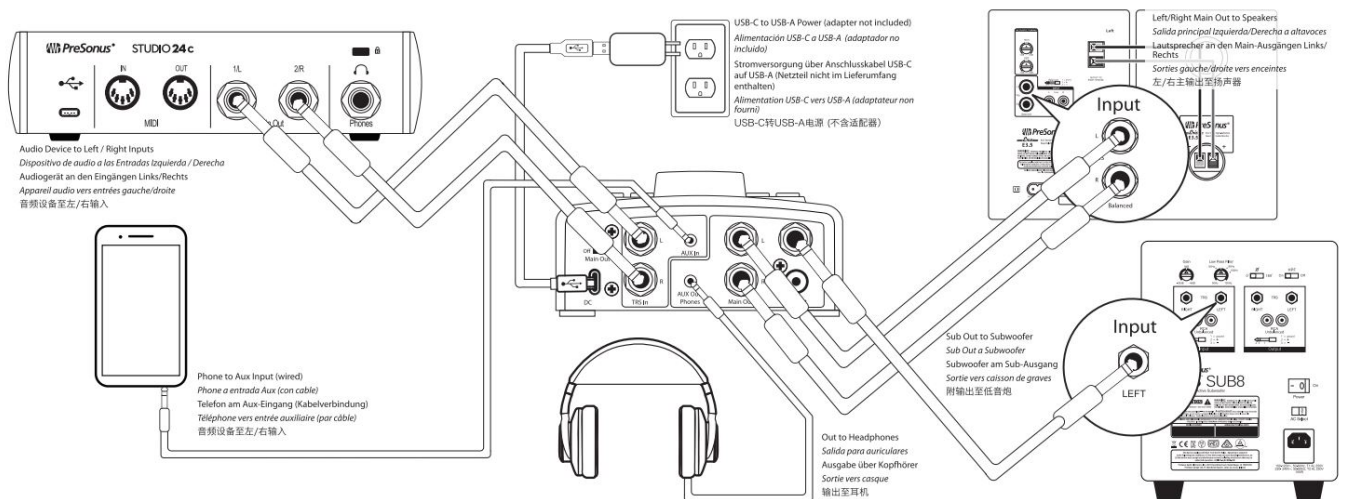

### Pairing Bluetooth Device

- Press and hold Pair until light flashes.

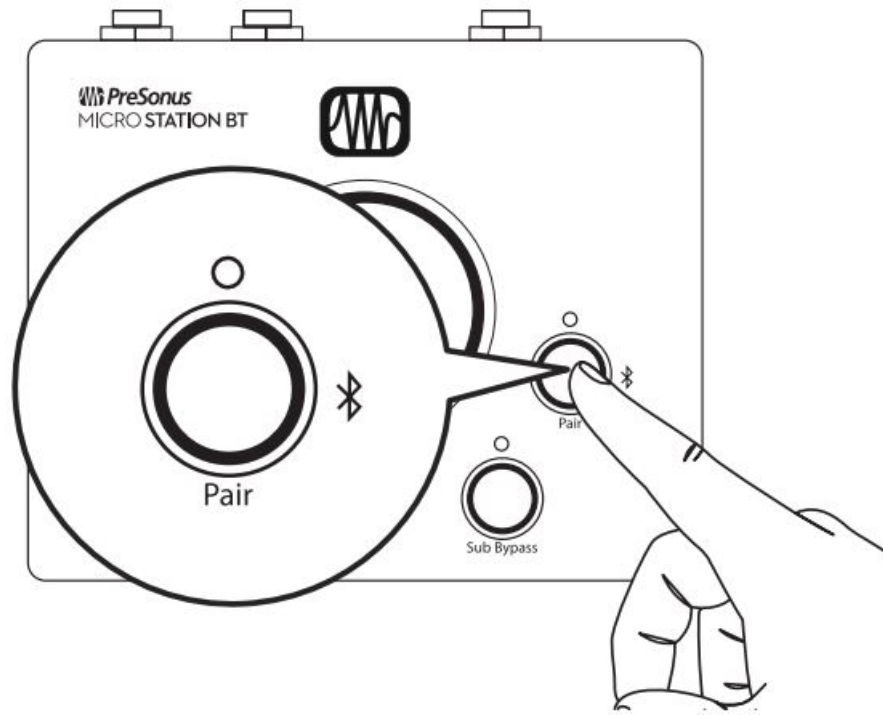

- Select “Micro Station BT” on Bluetooth Device.
- Pair light is solid when ready. Press Bluetooth to listen

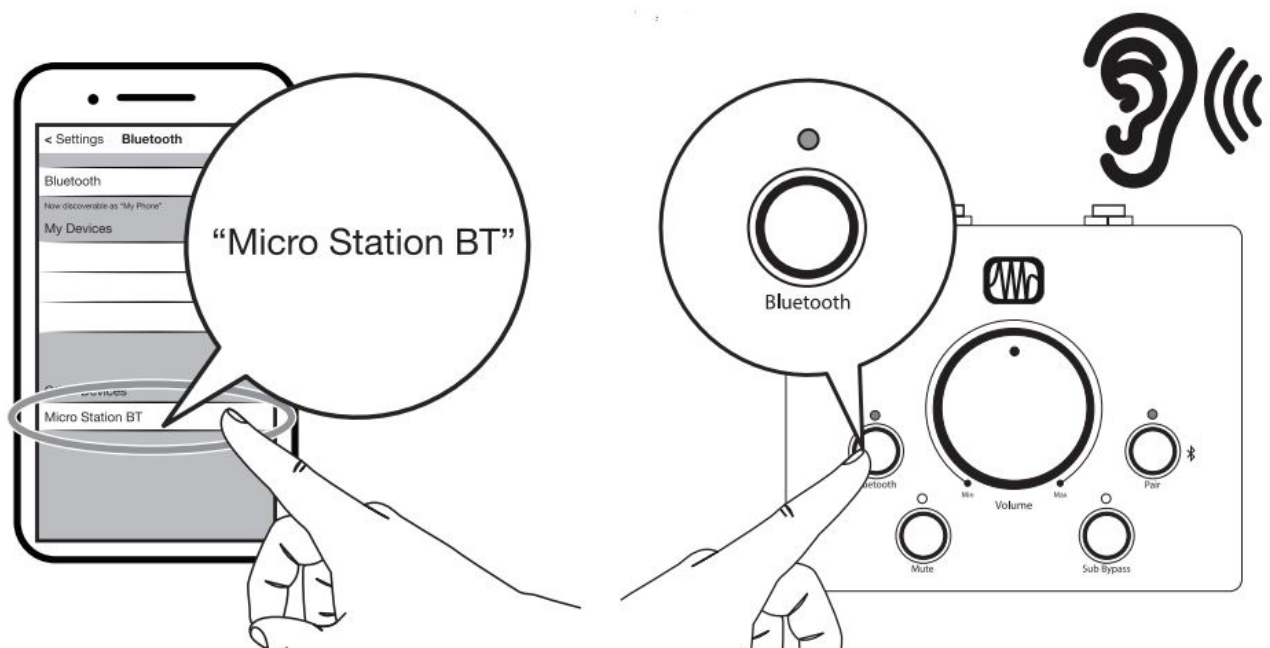

**Added bonus: PreSonus’ previously Top Secret recipe for**

### **Redfish Couvillion Ingredients:**

- ¼CVegetable oil
- ¼(fLOUR
- 1 onion diced
- 1 clove garlic minced
- 1 green pepper diced
- 3 celery stalks diced

- 1 14oz can diced tomatoes
- 1 bottle light beer
- 2 bay leaves
- 1 tsp thyme
- 2 lbs Redfish fillets

## Cooking Instructions:

1. In a heavy saucepan or large skillet, heat oil on medium high and slowly add flour a tablespoon at a time to create a roux. Continue cooking the roux until it begins to brown, creating a dark blond roux.
2. Add garlic, onions, green pepper, and celery to roux.
3. Saute vegetables for 3-5 minutes until they start to soften.
4. Add tomatoes, bay leaves, thyme, and redfish. Cook for several minutes.
5. Slowly add beer and bring to a low boil.
6. Reduce heat and simmer uncovered for 30-45 minutes until redfish and vegetables are completely cooked, stirring occasionally. Break up redfish into bite size chunks and stir in. Add pepper or hot sauce to taste. Do not cover.
7. Serve over rice

## Serves 6-8

While not one of Southeast Louisiana's more famous dishes, Redfish Couvillion is a favorite way to serve our favorite Gulf fish. Also known as Reds or Red Drum, Redfish is not only fun to catch, it's also delicious!

## FEATURES

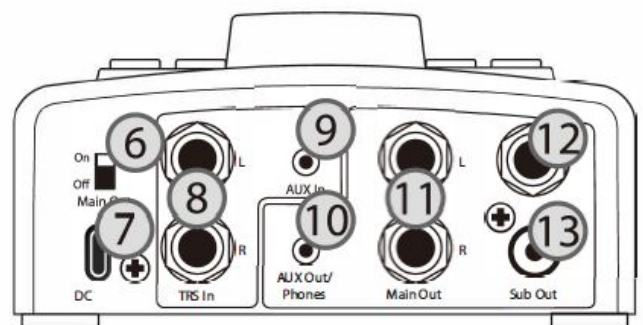
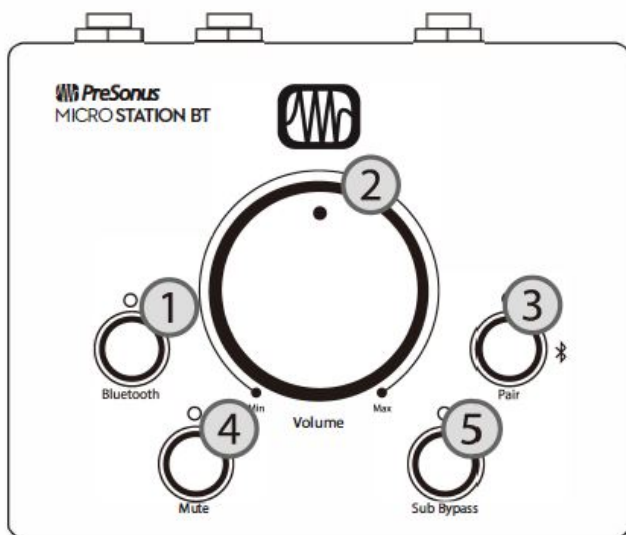

1. Bluetooth On/Off. Enables Bluetooth input.
2. Volume. Controls the overall output volume.
3. Bluetooth Pairing. Press to pair your Bluetooth device.
4. Mute. Mutes all outputs.
5. Sub Bypass. Mutes Sub Outs only.
6. Main Out On/Off. Enables / Disables the Main and Sub Outs. Enable to use Aux Out/Phones exclusively.
7. Power. Connect USB-C to USB-A cable (included) to USB power (adapter not included).
8. TRS In. Balanced stereo 1/4" TRS inputs.

9. Aux-In. Unbalanced stereo 1/8"TRS input.
10. Aux Out / Phones. Unbalanced stereo 1/18"TRS output (line-level or headphones).
11. Main Out. Balanced 1 /4"TRS outputs for speakers or power amp.
12. Sub Out (Balanced). Balanced 1/4"TRS output for the subwoofer.
13. Sub Out (Unbalanced). Unbalanced RCA Output for subwoofer.

**Note:** Use either the Unbalanced or the Balanced Sub Out. Only one is required.

## FCC Warnings

This device complies with part 15 of the FCC Rules. Operation is subject to the following two conditions:

1. This device may not cause harmful interference, and
2. this device must accept any interference received, including interference that may cause undesired operation.

Any Changes or modifications not expressly approved by the party responsible for compliance could void the user's authority to operate the equipment.

**Note:** This equipment has been tested and found to comply with the limits for a Class B digital device, pursuant to part 15 of the FCC Rules. These limits are designed to provide reasonable protection against harmful interference in a residential installation. This equipment generates uses and can radiate radio frequency energy and, if not installed and used in accordance with the instructions, may cause harmful interference to radio communications. However, there is no guarantee that interference will not occur in a particular installation. If this equipment does cause harmful interference to radio or television reception, which can be determined by turning the equipment off and on, the user is encouraged to try to correct the interference by one or more of the following measures:

- Reorient or relocate the receiving antenna.
- Increase the separation between the equipment and receiver.
- Connect the equipment into an outlet on a circuit different from that to which the receiver is connected.
- Consult the dealer or an experienced radio/TV technician for help. This equipment complies with FCC radiation exposure limits set forth for an uncontrolled environment. This equipment should be installed and operated with minimum distance 20cm between the radiator & your body.

## IC WARNING

- This radio transmitter has been approved by Industry Canada.
- This Class B digital apparatus complies with Canadian standard ICES-003. This device complies with Industry Canada License exempt RSS standard(s). Operation is subject to the following two conditions.
- This device may not cause interference and (2) this device must accept any interference, including interference that may cause undesired operation of the device.
- This equipment complies with ISED radiation exposure limits set forth for an uncontrolled environment. This equipment should be installed and operated with minimum distance 20cm between the radiator & your body.

## Documents / Resources

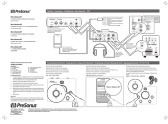

**[PreSonus REC0015353-000 MicroStation BT 2.1 Monitor Controller with Bluetooth Connectivity](#) [pdf] User Guide**

MSBT, 2ACCU-MSBT, 2ACCUMSBT, REC0015353-000 MicroStation BT 2.1 Monitor Controller with Bluetooth Connectivity, MicroStation BT 2.1 Monitor Controller with Bluetooth Connectivity