



# Precision CS Car Smart Ai Box User Manual

[Home](#) » [PRECISION](#) » Precision CS Car Smart Ai Box User Manual 

PRECISION

User Manual

Wireless Carplay

Android Auto Adapter

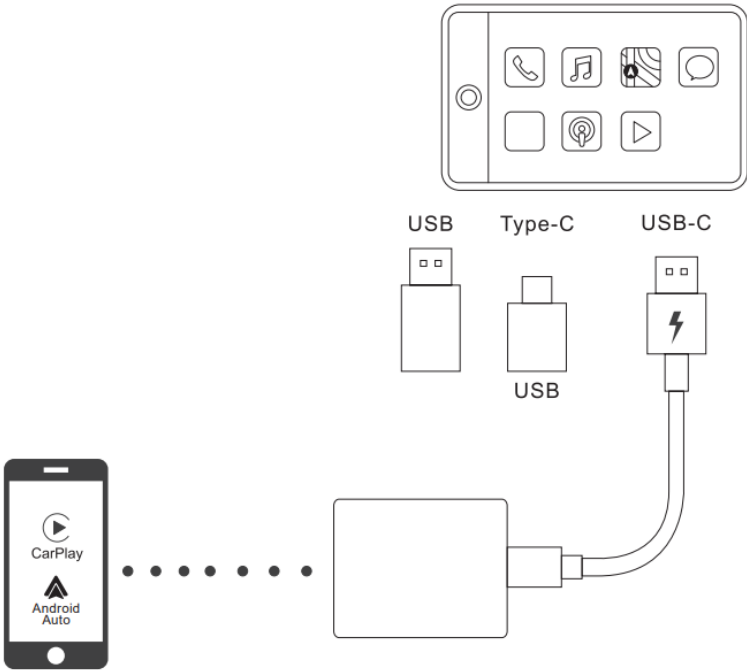

Please read the manual carefully before use  
Recommend keeping this manual for future reference

## Contents

- [1 Compatibility Note](#)
- [2 How to use](#)
- [3 Package list](#)
- [4 FQA](#)
- [5 Online update](#)
- [6 Documents / Resources](#)
  - [6.1 References](#)

## Compatibility Note

- Please make sure your car supports wired carplay/ Android Auto
- Required iPhone 6 or later iPhone models with iOS 10 or above for wireless carplay function
- Required an Android smart phone that support latest Android 'Auto function and with Android 11 or higher of the Android operating system for wireless Android Auto function.

How to confirm If your car has Apple wired CarPlay or Android Auto function

**Method 1:** Connect your iPhone or Android smart phone to your car by USB data cable and see carplay or android auto logo on your car display



**Method 2:** Check the compatible st below or check with your car manufacturer to see if your car has this capability:

Check out the website for supported car models:

|   |   |
|---|---|
|                                    |    |
| <a href="https://www.apple.com/ios/carplay/available-models/">https://www.apple.com/ios/carplay/available-models/</a> | <a href="https://www.android.com/auto/Compatibility#Compatibility-vehicles">https://www.android.com/auto/Compatibility#Compatibility-vehicles</a> |
| <a href="https://www.apple.com/ios/carplay/available-models/">https://www.apple.com/ios/carplay/available-models/</a> | <a href="https://www.android.com/auto/#next-steps">https://www.android.com/auto/#next-steps</a>   |

## How to use

1. Start the car and wait for the car head until system to be loaded
2. Switch the button UP use for wireless carplay and down for wireless Android Auto.
3. Connect the Wireless Carplay Android auto adapter to the USB-A or USB- C port in your car. please be sur plug the adapter into the port that s for wired apple carplay or android auto.

4. Open WIFI and Bluetooth on your iPhone/Android smartphone and find the Bluetooth named 'smart Box -\*\*\*\*'; Click on 'Pair', Click on 'Allow'; Click on 'Use Carplay' or Use Android Auto.

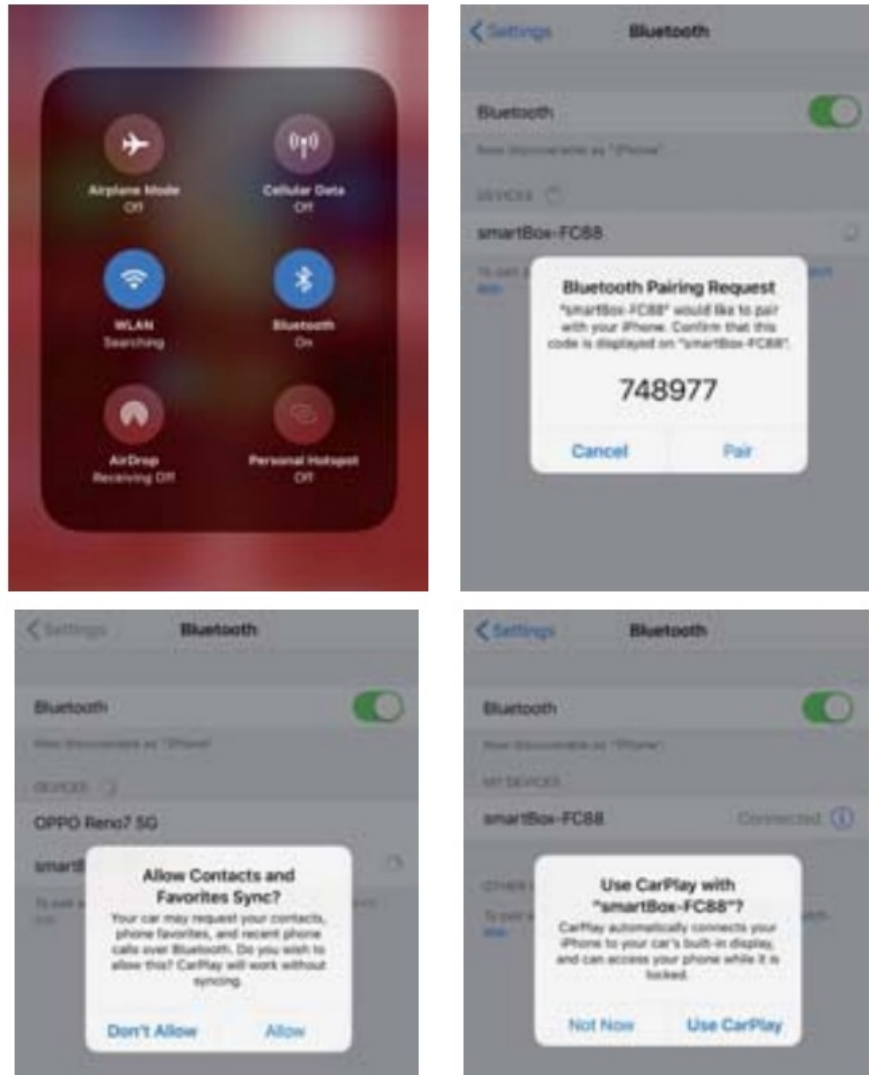

4. You are ready to enjoy wireless carplay or wireless Android Auto.

### Please note

1. The wireless Carplay Android Auto adapter working principle is uses Bluetooth to establish a pairing between the iPhone/ Android smartphone and the vehicle, then switches to using WiFi o maintain the wireless connection.  
After the Bluetooth pairing s successful, the iPhone/Android smartphone WiFi wil automatically connect to the adapter's WiFi, and then disconnect the Adapter Bluetooth connection by default for carplay and automafically Connect 1o your vehicle Bluetooth by default for Android auto.
2. Please ensure wireless Carplay Android auto Adapter power indicates blue lights on.
3. Please ensure that your car models supports wired carplay/ Android auto

### Package list

- 1x Wireless Android Auto Adapter
- 1 USB-A OR USB-C OTG Adapter
- 1x3M Sticker
- 1xUser Manuel

## FQA

### 1.What Is the Wi-Fi password for the wireless Carplay Android Auto Adapter?

we need to connect the bluetooth, not Wi-Fi, After Bluetooth matching is successful, WiFi will automatically connect. So no need Wi-Fi password. Make sure your Wi-Fi is turned on and unoccupied when pairing,

### 2 . After pairing Android Auto adapter, can not start Android Auto function or compatible/ can not recognize the USB....

1)If your car has use the android auto function for the first time, please use your data cable to connect your phone to activate android auto through a wired method 2)Please make sure that android auto on your android phone is the last version. If not, please log in to your google play account to update to the latest version. 3)Please turn off the Bluetooth of your phone and enter the mobile application management to search auto to clear the auto cache. After the cleaning is completed, Restart the adapter and reconnect to Bluetooth.

### 3. Audio input or output issues : calls rejected or forwarded to voicemail / no play sound / microphone not working / music playback interrupted or paused / voice functioning abnormally...

1) Please check if the iphone/Android smartphone's Bluetooth connect to other devices such as Earphone, watch.....If so, Please disconnect other auto-connected Bluetooth devices or turn of the Bluetooth directly for carplay and connect to your vehicle bluetooth for android auto 2)When on a call, check that your "Audio" output option is Carplay/Android Auto

### 4. The indicator light of the adapter is still on after the car is tuned off.

we need to connect the bluetooth, not Wi-Fi. After Bluetooth matching is successful, WiFi will automatically connect. So no need Wi-Fi password. Make sure your Wi-Fi is turned on and unoccupied when pairing.

### 5. When use the wireless carplay Android Auto Adapter whether Mobile Phone can use other internet wifi

When enjoying the wireless android auto adapter function, the phone's WiFi will be occupied by the adapter. So you can not use other internet at the same time. You only can use your phone SIM card internet.

#### 6. Unable to automatically reconnect

1) Please make sure that the Bluetooth and WiFi functions of your mobile phone are turned on and the Bluetooth is not occupied when you get in the car 2) Clear the pairing record, restart the phone and repair the adapter

#### 7. Can the adapter be paired with multiple phones

The adapter can be paired with maximum five phones, but only one device can be connected at a time. If you would like to pair it with a new phone, please cancel the current connection first. Please note, by Bluetooth function default, the adapter's system will only auto-connect back to the last used phone.

#### 8. Can't find the bluetooth and Wi-Fi of the wireless Carplay Android Auto Adapter ?

Please make sure wireless Carplay Android auto adapter power indicates blue light is on and Be sure plug the adapter into the port that is for wired carplay/ Android auto, If convenient, Please test it with another Phone. If only a specific phone cannot find the Bluetooth or Wi-Fi of the adapter, please try to reset the network and bluetooth settings of this Phone and then restart the phone once, if the same problem happens on other Phone, It will be defective, please let us know,

#### 9. Whether Wireless Carplay Android auto Adapter support Youtube Video

—

—

Setting Video link: <https://www.youtube.com/watch?v=m8xHyEI9zxXY>



<https://www.youtube.com/watch?v=m8xHyEI9zXY>

## Online update

- If the adapter works properly, it means the current version is suitable for your car. It is not recommended to update the firmware
- Only try this solution when the problem you cannot solve from the “FQA” list

|   |
|---|
| 1.Power up the adapter  |
| 2.Connect the adapters WiFi. the password is '88888888'   |
| 3.Open web browser and enter “192.168.1101” to enter the setting page and click” Online Update” for Carplay function  |
| 4.For Android auto. Please Click “Switch P2P”Then Click -OK”  |
| 5.Return to WiFi Connect, Find ‘Wi-Fi Description .Then connect the Available devices ( smart Box —) (This step is for reference only for Android phone users. If use iPhone update the firmware, please ignore “Wi-Fi Direct step) |
| 6.Return to the browser’s page, Click ‘Update’ (PS: the signal light of will flash when it reached 70%,and it will return to normal after successful)   |
| 7.On the same page. you could also fill in the car brand. model .years. and more details. Next tap “Submit” to report the issue. Our engineers will record your problem and research possible solutions                             |

☆

192.168.1.101

🔄

System Version

Build Number23090512.2801.1

Date of manufacture2023-08-22

Settings

Restore factory settings>

WiFi AP36>

Audio streaming modeDefault>

Delayed startDefault>

Problem Description

Car MakeE.g. Toyota

Model NameE.g. Camry XLE

YearE.g. 2020

Detailed description of the problem:

Please enter text here

Submit

Online Update

🔄 Checking for updates...

Switch P2P

Copyright©2023 - 2023

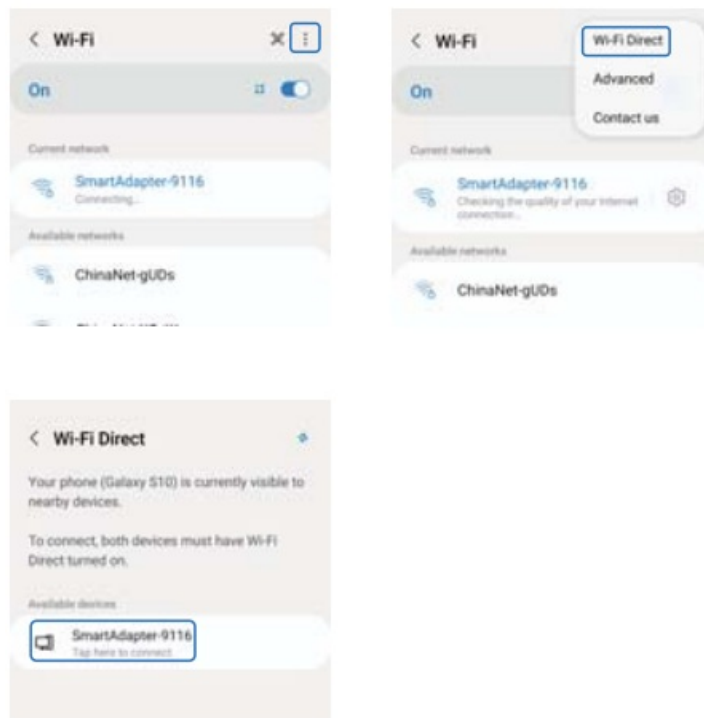

## FCC Statemen

This equipment has been tested and found to comply with the limits for a ClassB digital device, pursuant to part 15 of the FCC rules. These limits are designed to provide reasonable protection against harmful interference in a residential installation. This equipment generates, uses and can radiate radio frequency energy and, if not installed and used in accordance with the instructions, may cause harmful interference to radio communications. However, there is no guarantee that interference will not occur in a particular installation. If this equipment does cause harmful interference to radio or television reception, which can be determined by turning the equipment off and on, the user is encouraged to try to correct the interference by one or more of the following measures: -

Reorient or relocate the receiving antenna. -Increase the separation between the equipment and receiver. - Connect the equipment into an outlet on a circuit different from that to which the receiver is connected. -Consult the dealer or an experienced radio/TV technician for help. To assure continued compliance, any changes or modifications not expressly approved by the party.

Any changes or modifications not expressly approved by the party responsible for compliance could void the user's authority to operate this equipment.

This equipment complies with Part 15 of the FCC Rules. Operation is subject to the following two conditions:

1. This device may not cause harmful interference, and
- (2)This device must accept any interference received, including interference that may cause undesired operation.

**FCC Radiation Exposure Statement:**

The equipment complies with FCC Radiation exposure limits set forth for uncontrolled environment. This equipment should be installed and operated with minimum distance 20cm between the radiator and your body



Made in china

**Documents / Resources**

|   |   |
|---|---|
|  | <p><a href="#">Precision CS Car Smart Ai Box</a> [pdf] User Manual</p> <p>CS Car Smart Ai Box, CS, Car Smart Ai Box, Smart Ai Box, Ai Box</p> |
|---|---|

**References**

- [User Manual](#)

[Manuals+](#), [Privacy Policy](#)

This website is an independent publication and is neither affiliated with nor endorsed by any of the trademark owners. The "Bluetooth®" word mark and logos are registered trademarks owned by Bluetooth SIG, Inc. The "Wi-Fi®" word mark and logos are registered trademarks owned by the Wi-Fi Alliance. Any use of these marks on this website does not imply any affiliation with or endorsement.