



PRECISION PRO NX9 Slope Rangefinder User Manual

[Home](#) » [PRECISION PRO](#) » PRECISION PRO NX9 Slope Rangefinder User Manual 

Contents

- [1 PRECISION PRO NX9 Slope Rangefinder](#)
- [2 Product Overview](#)
- [3 How to use](#)
- [4 FAQs / Troubleshooting](#)
- [5 Slope / non-slope](#)
- [6 Changing the battery](#)
- [7 Best practices](#)
- [8 Industry-Leading Customer Support](#)
- [9 Documents / Resources](#)
 - [9.1 References](#)



PRECISION PRO NX9 Slope Rangefinder



Product Overview

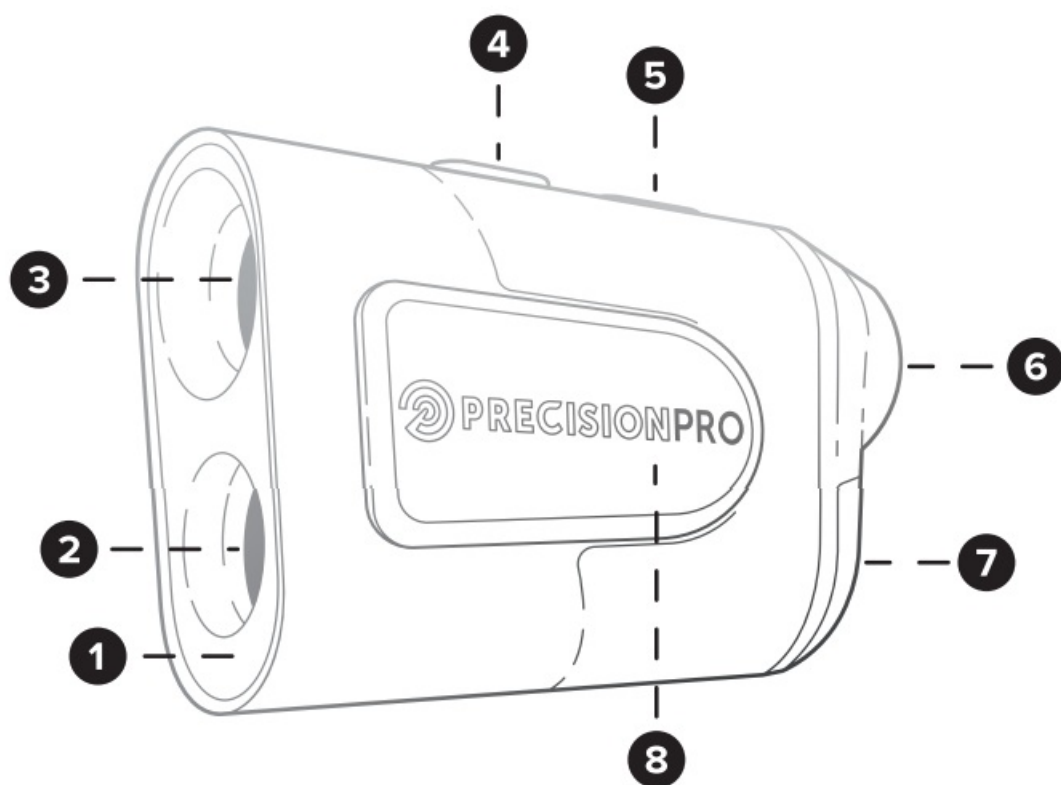

1. Front Plate
2. Laser Lens
3. Optical Lens
4. Slope Switch
5. Power/Laser
6. Adjustable Eyepiece
7. Battery Door
8. Magnetic Grip

laser screen

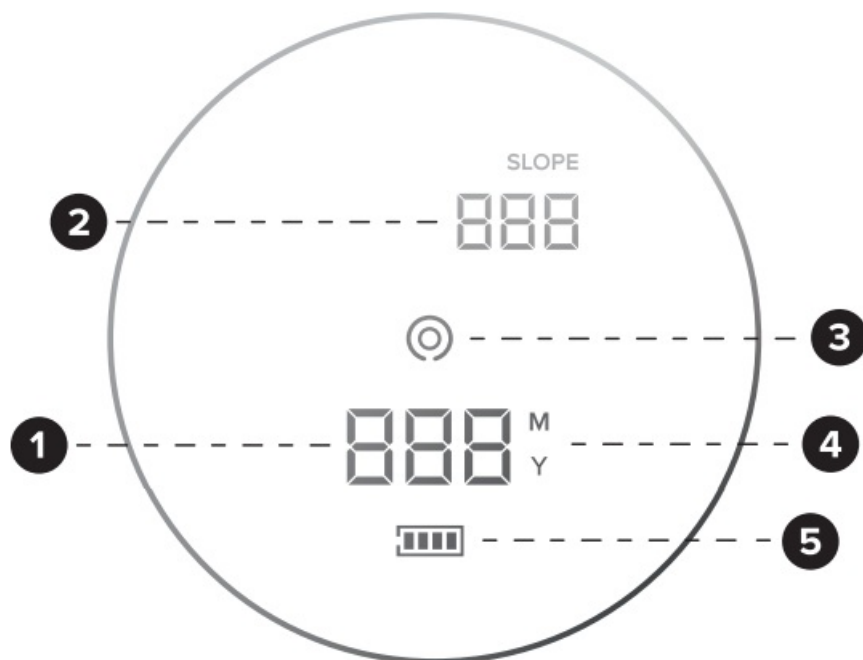

1. Non-Slope Distance
2. Slope-Adjusted Distance
3. Aiming Circle
4. Yards/Meters Indicator
5. Battery Indicator

How to use

1. Look through the eyepiece and press the power button to turn on the rangefinder. The aiming circle will appear in the middle of the screen.

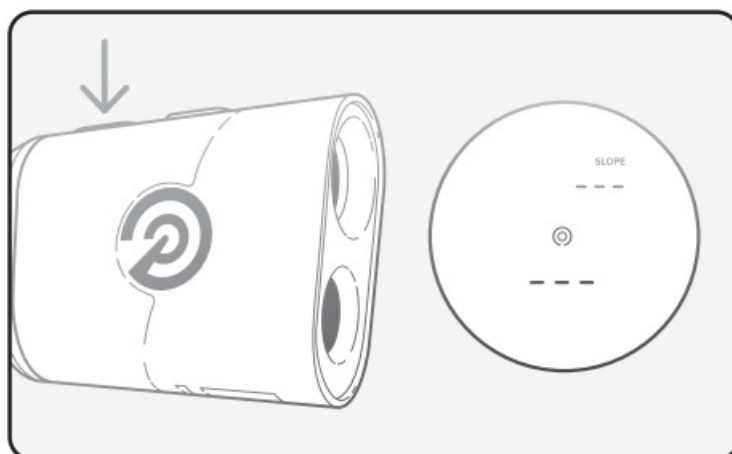

2. Rotate the dial left or right on the adjustable eyepiece until the display appears sharply focused.

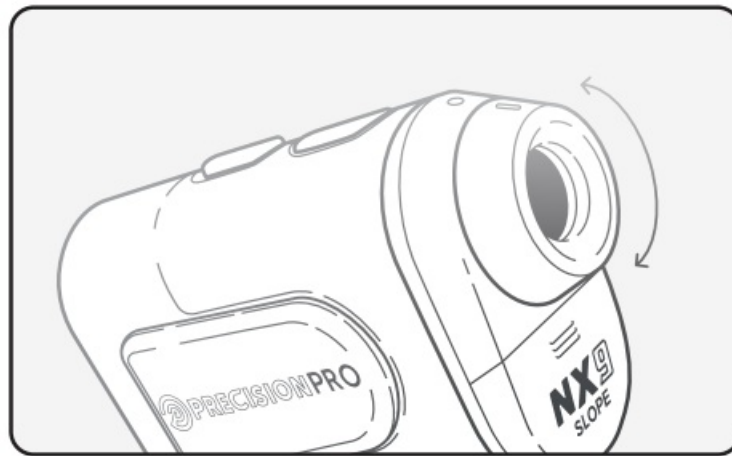

3. Point the aiming circle at the target — flag, tree, bunker, etc. Then press and release the POWER button to “shoot your target.”

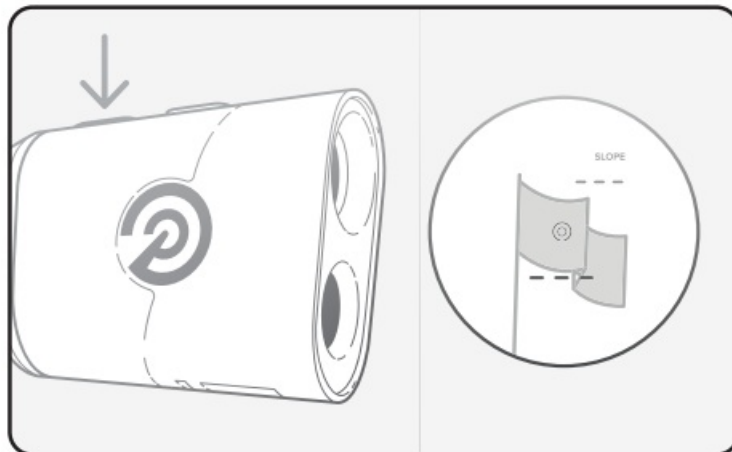

4. If slope is on, the slope-adjusted number will appear above the aiming circle. The non-slope number will appear below the aiming circle.

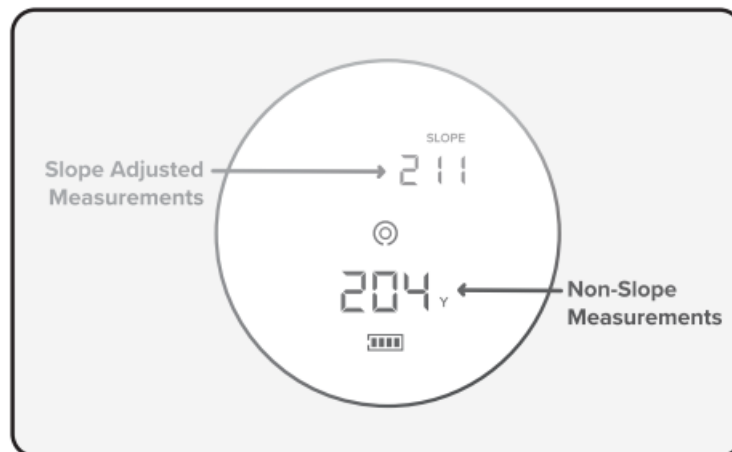

5. The rangefinder will automatically turn off after eight seconds.

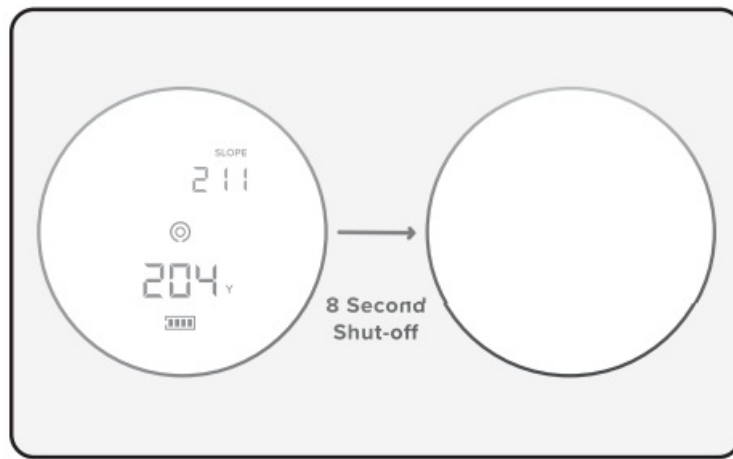

6. Swing with Confidence!



yards/meters

Make sure the screen is off, then press and hold the POWER button for five seconds to change between yards and meters. You will see a Y in the bottom right-hand corner for Yards and an M for Meters.

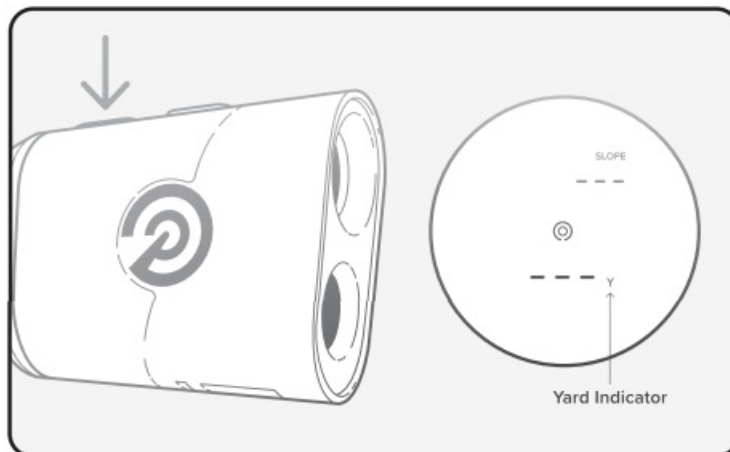

- **Y** – Yards
- **M** – Meters

FAQs / Troubleshooting

- “My Rangefinder always shows a distance shorter/farther than I know the distance to be” – Please ensure the unit is in the correct yards/meters mode. A unit in Meters will display a number about 10% shorter than in Yards.
- “My unit is constantly showing a very short distance” – Please ensure that the front lenses are clean and free of

any debris. Please also check the battery meter. The battery bar icon will slowly empty as the battery loses power.

- “My rangefinder makes everything look smaller, I thought this had magnification?” – It feels a little silly writing this, but we’ve heard this question enough we felt the need to include it. Please ensure you are holding your rangefinder in the correct direction. You should notice the eyepiece is much more comfortable to hold your eye to than the nose of the rangefinder that should be facing your target.
- “Where should I aim my rangefinder?” – We recommend aiming at the flag. The rangefinder is able to pick up the flagstick, but a good tip is “The more surface area you’re aiming at, the easier it is for the rangefinder to pick it up”.

Slope / non-slope

1. Slide the slope indicator switch on the top of the rangefinder. Slope is activated when the green is visible. Slope is turned off when the green is not visible.

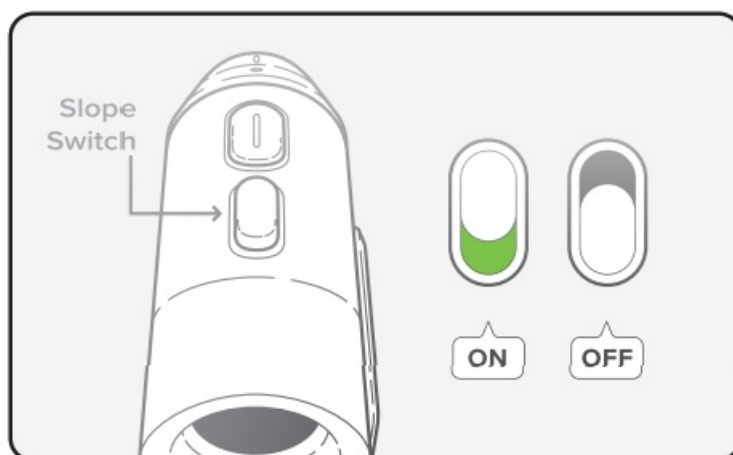

2. When slope is on, the slope-adjusted distance will appear above the aiming circle. When slope is turned off, the second display will not be shown.



MAGNETIC CART MOUNT

1. The built-in magnetic cart mount will adhere to any flat metal surface. Attach the rangefinder so that the logo is facing out and the rangefinder is vertical.

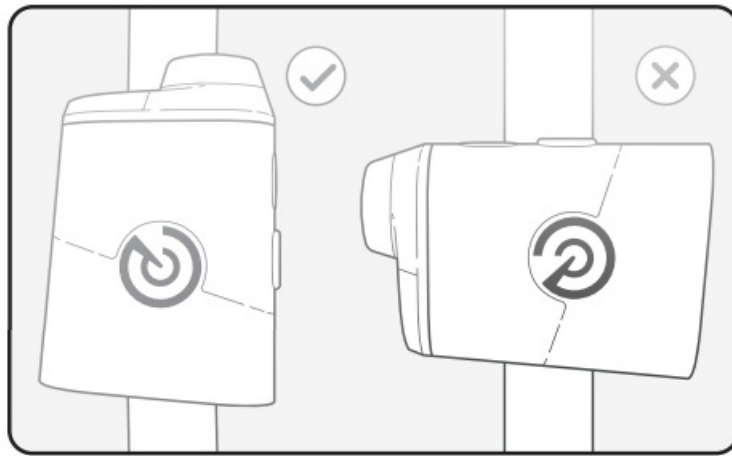

2. When attaching to a frame of a golf cart, make sure that the rangefinder is parallel with the bar. Not perpendicular.

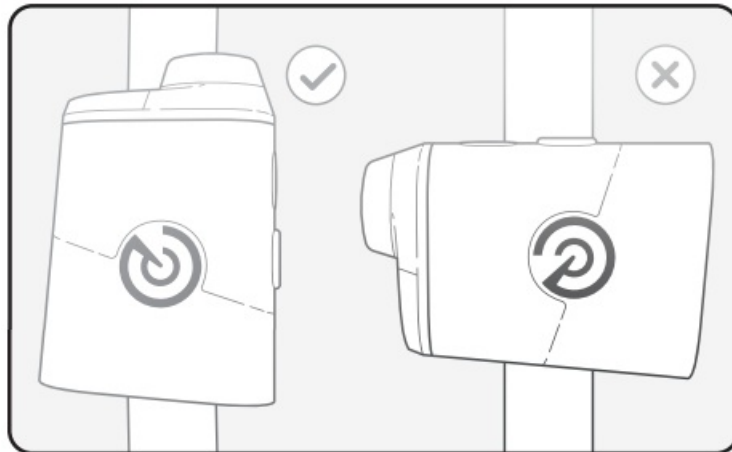

Changing the battery

1. Open the battery door by sliding the panel away from the eye piece.

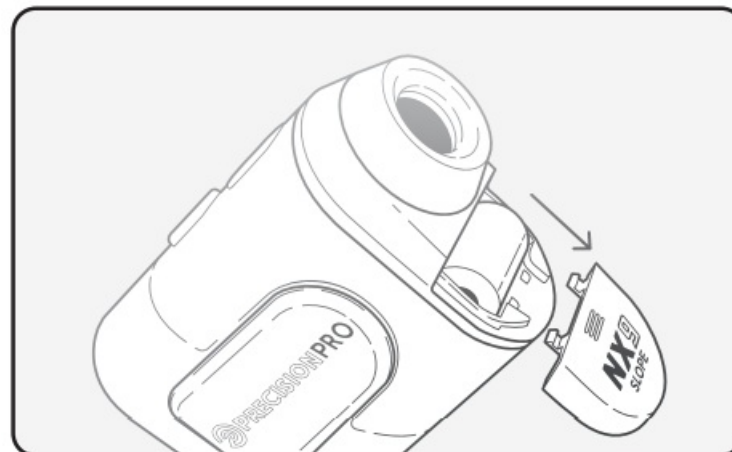

2. Remove the old battery and insert the new battery to match the image shown above. Put the battery door back on and secure tightly.

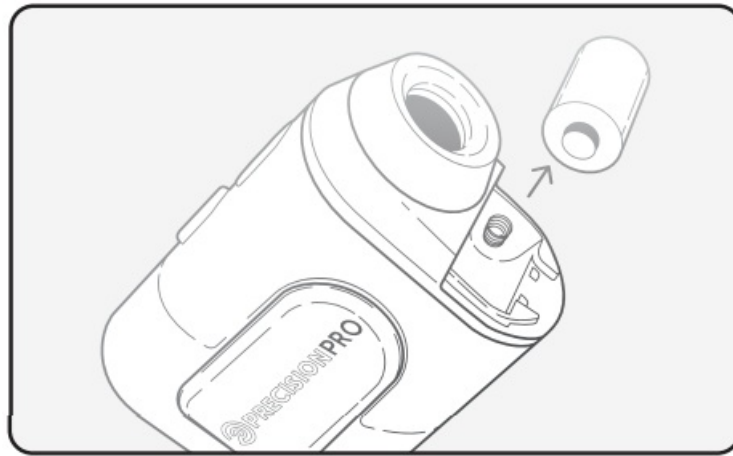

3. Check the viewfinder to make sure the battery is fully charged and operating correctly.

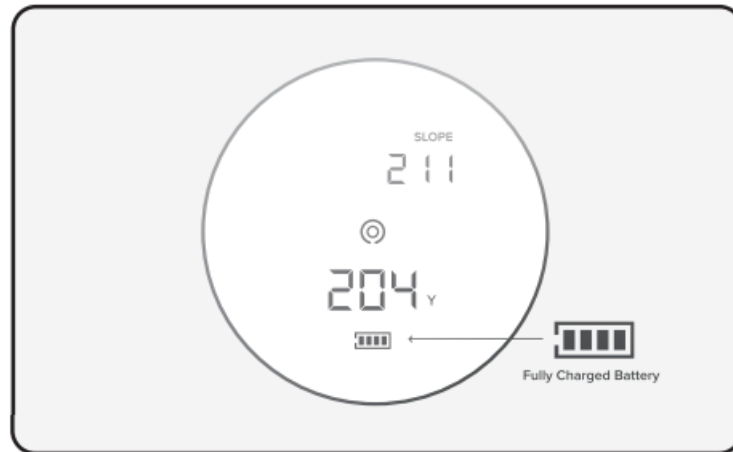

4. Double check that the battery door is on securely.

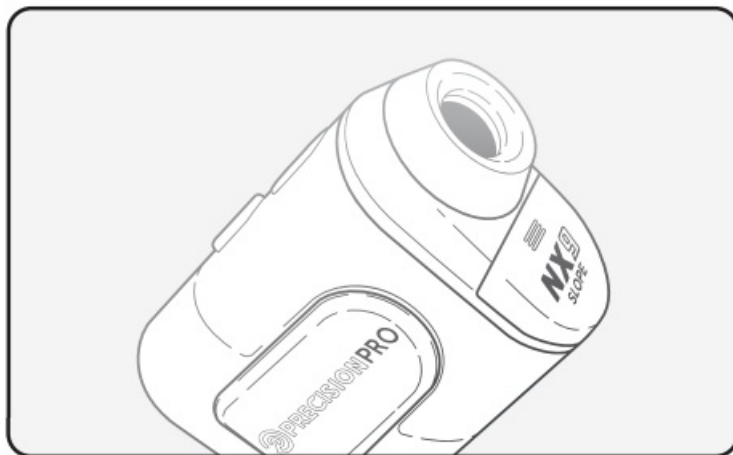

Best practices

- **AIM DIRECTLY AT THE FLAG:** For the best results, hold your rangefinder steady and hold the aiming circle over the flag as your rangefinder measures the distance.

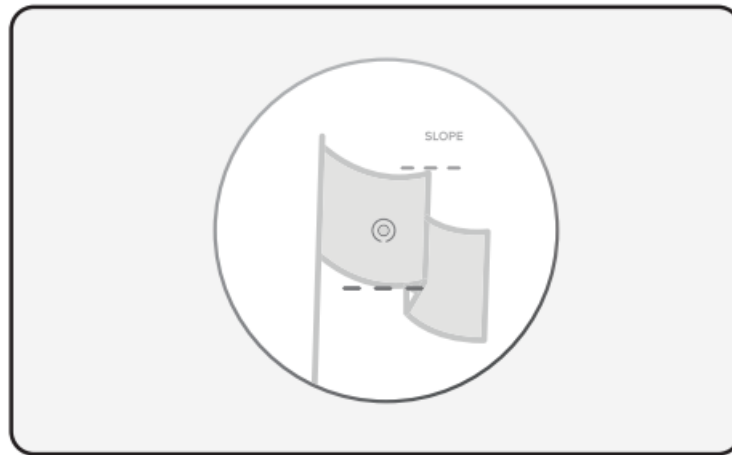

- **PRESS AND RELEASE:** When measuring distances, it's important to press and then release the power button. Holding the button will not work correctly.

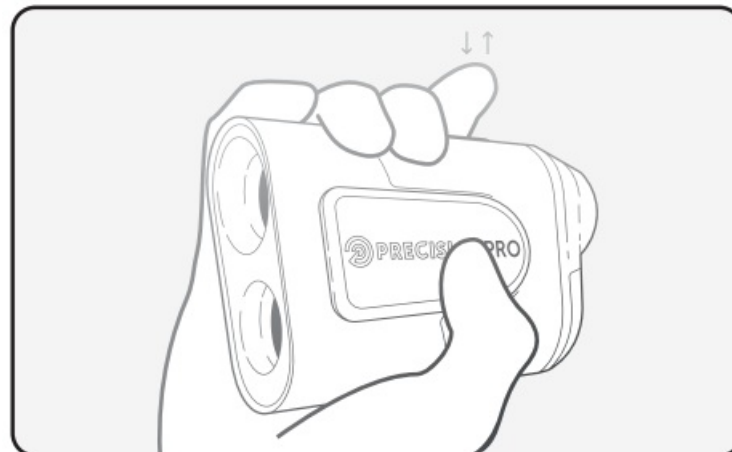

- **DON'T COVER THE LENS:** Make sure the front of the rangefinder is unobstructed. A finger or side of the palm will interfere with the laser and result in incorrect readings or no readings at all.

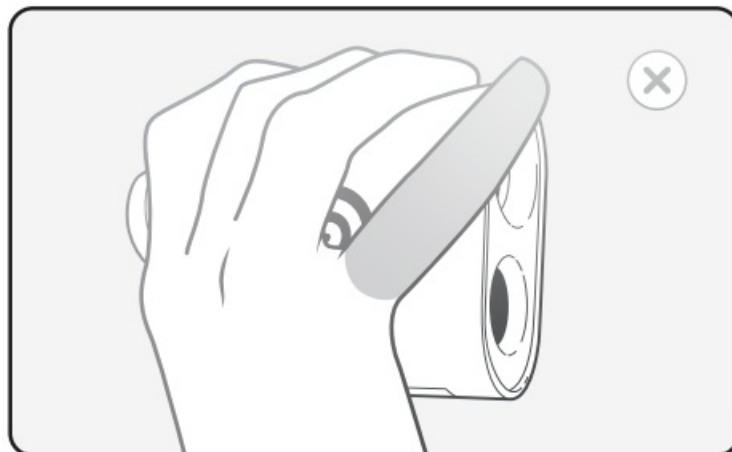

- **USE BOTH HANDS:** Stabilize the rangefinder by using both hands and steady your arms by bracing them against your chest.

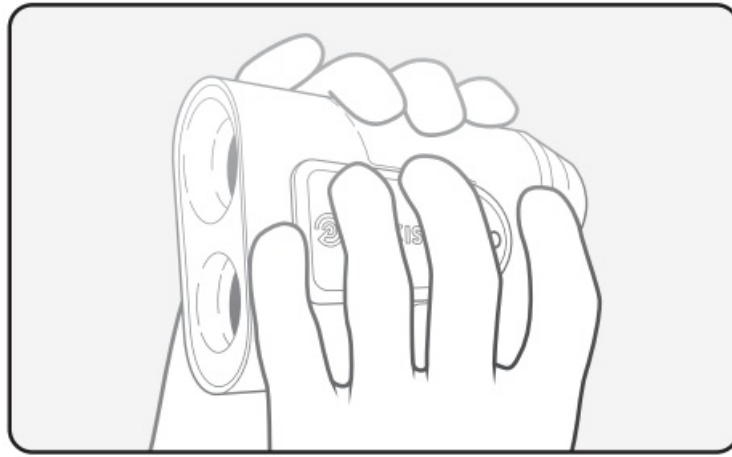

Industry-Leading Customer Support

We believe that golf is enjoyed most when you're confident. And when everything else is made to measure, nothing else compares to Precision Pro.

REGISTER YOUR PRECISION PRO precisionprogolf.com/register

It feels more like joining a club with lifetime benefits and exclusive offers on future products and our partners.



TWO-YEAR WARRANTY

We're confident nothing will go wrong, but we'll make it right if it does. Our two-year manufacturer warranty covers any operational defects – no questions asked.



HONEST PRICING PROMISE

Confidence is a wonderful thing. Doubt is not. You can be confident when purchasing from Precision Pro. We price our products honestly and consistently. No clearance sales, no permanent sales, and no gimmicks.

REGISTER YOUR RANGEFINDER

• EXCLUSIVE OFFERS

We partner with some of the biggest names in golf and share exclusive partner discounts on anything from golf apparel, to equipment, and even lessons.

• HASSLE FREE EXCHANGES

Should anything ever happen to your rangefinder, the exchange process is quick and easy. We go to great lengths to minimize time without a rangefinder by sending you a prepaid shipping label and shipping you a replacement.

• TRADE-UP PROGRAM

Precision Pro has quickly become the most innovative rangefinder company in golf – and we have no plans on stopping. Our team of designers and engineers are working on incredible new products to help golfers play better and have more fun. We offer a 30% discount on new Precision Pro Golf products when you're ready to upgrade.

help@precisionprogolf.com
precisionprogolf.com/help
(888) 568-6770

Documents / Resources

	<p>PRECISION PRO NX9 Slope Rangefinder [pdf] User Manual NX9, NX9 Slope Rangefinder, Slope Rangefinder, NX9 Slope, Rangefinder</p>
---	---

References

- ⓘ [GOLF.com: Golf News, Golf Equipment, Instruction, Courses, Travel](#)
- ⓘ [Product Registration](#)

Manuals+.