

PowerA OPS V3 Overpowered Series PC Pro Wireless Controller



PowerA OPS V3 Overpowered Series PC Pro Wireless Controller User Manual

[Home](#) » [PowerA](#) » PowerA OPS V3 Overpowered Series PC Pro Wireless Controller User Manual 

Contents

- [1 PowerA OPS V3 Overpowered Series PC Pro Wireless Controller](#)
- [2 Product Information](#)
- [3 Product Usage Instructions](#)
- [4 FAQ](#)
- [5 GAMEPAD LAYOUT](#)
- [6 ADVANCED GAMING BUTTON PROGRAMMING](#)
- [7 TURBO SETTINGS](#)
- [8 RGB LED CONTROL](#)
- [9 FCC STATEMENT](#)
- [10 Documents / Resources](#)
 - [10.1 References](#)
- [11 Related Posts](#)

PowerA[™]

PowerA OPS V3 Overpowered Series PC Pro Wireless Controller



Product Information

Specifications

- **Product Name:** Pro Wireless Controller for PC and Cloud Gaming
- **Connectivity:** USB, Bluetooth, RF
- **Charging:** Wireless
- **Turbo Settings:** Yes
- **RGB LED Control:** Yes
- **Analog Stick:** Quick-Twist Adjustable

Product Usage Instructions

The gamepad layout consists of various buttons and triggers:

- **LB:** Left Select Button
- **RB:** Right Select Button
- **ABXY Buttons:** Action buttons
- **RSB:** Right Stick Button
- **AGR-1, AGR-2, AGR-3:** Analog Stick Right
- **AGL-1, AGL-2, AGL-3:** Analog Stick Left
- **Profile Button:** Button for profiles
- **USB/BT/RF Switch:** Connectivity switch
- **Turbo Button:** Turbo mode activation
- **Sync Button:** Synchronization button

Charging

- To charge the controller, use the wireless charging feature provided. Make sure to place it on the charging pad correctly.

Wireless Pairing

- To pair wirelessly with your device, follow the instructions in the user manual. Typically, you would need to activate the pairing mode on the controller and then search for it on your device's Bluetooth settings.

RGB LED Control

- You can control the RGB LED settings of the controller through the provided software or app. Customize the lighting according to your preference.

Turbo Settings

- The controller offers turbo settings for certain buttons. Refer to the manual to set up and customize the turbo functionality to enhance your gaming experience.

Quick-Twist Adjustable Analog Stick

- The analog stick on the controller is adjustable for quick-twist action. This feature allows for better control and precision during gameplay.

FAQ

- What should I do if my controller is not connecting wirelessly?
- If you are facing connectivity issues, try resetting the controller and re-pairing it with your device. Ensure that the controller is charged sufficiently and within range of the device.
- How do I customize the turbo settings on the controller?
- To customize turbo settings, access the controller software on your PC and follow the instructions provided. You can map specific buttons for turbo functionality based on your gaming preferences.
- Can I use this controller with a gaming console?
- The Pro Wireless Controller is designed for PC and cloud gaming. While it may work with certain gaming consoles, full compatibility cannot be guaranteed. It is recommended to check compatibility before use.

GAMEPAD LAYOUT

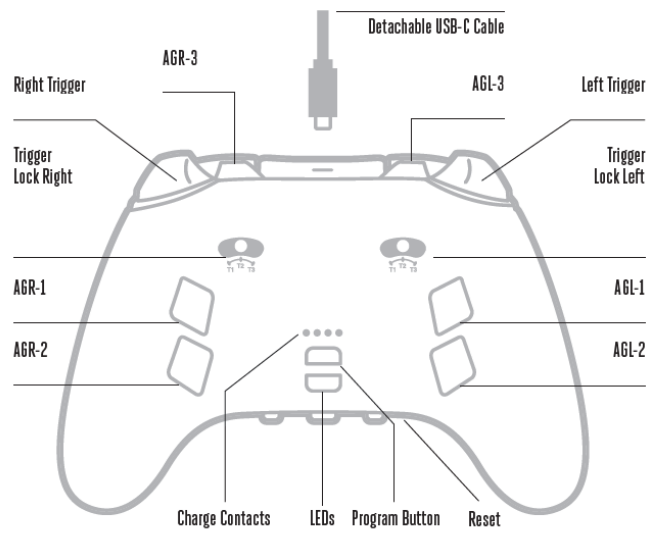
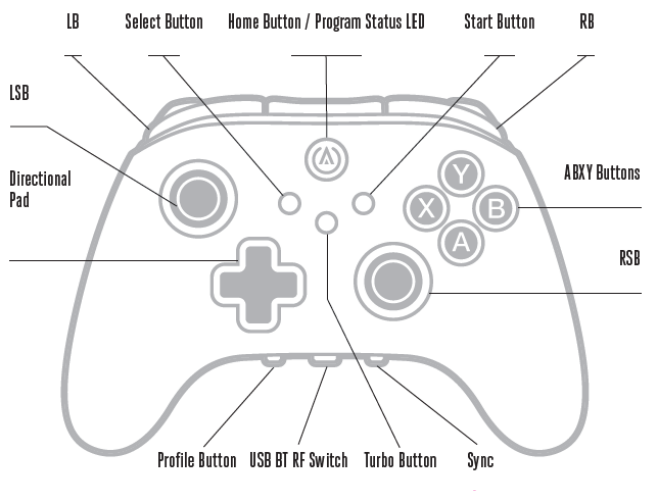

ADVANCED GAMING BUTTON PROGRAMMING

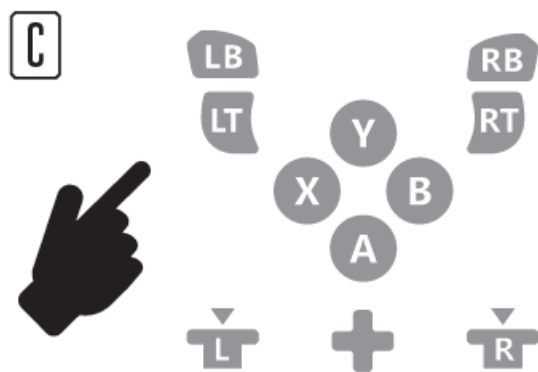

CHARGING

NOTE: Fully charge before initial use.

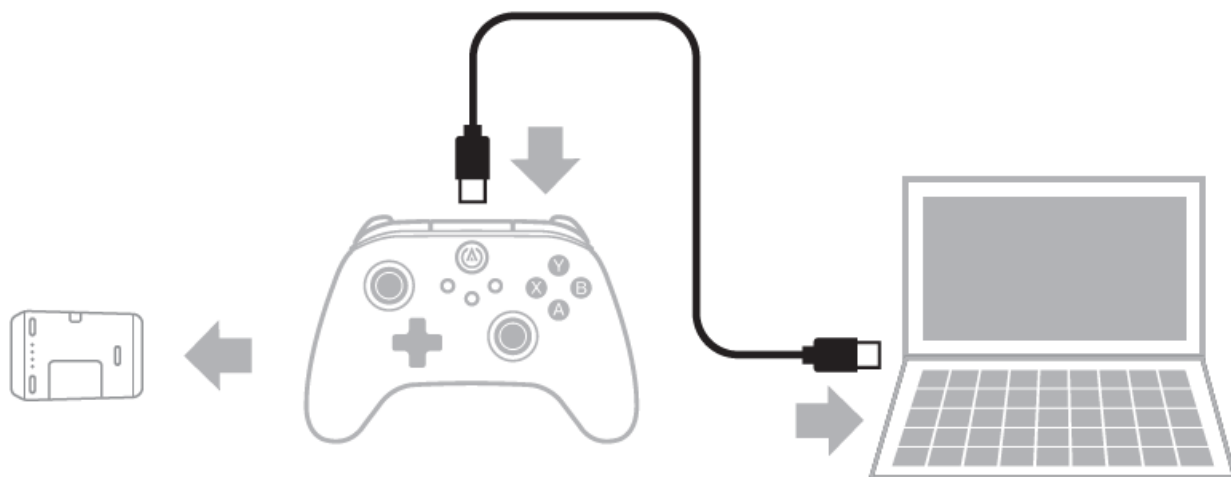

WIRELESS PAIRING

A



B



TRIGGER LOCK ADJUSTMENT

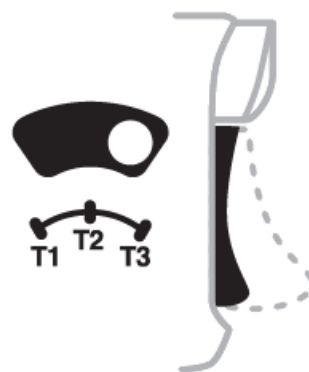
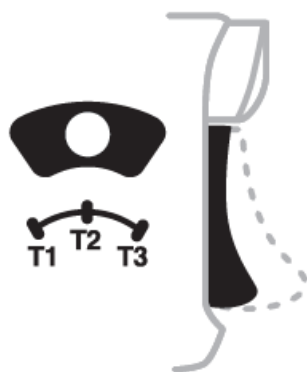

TURBO SETTINGS



B



QUICK-TWIST ADJUSTABLE ANALOG STICK

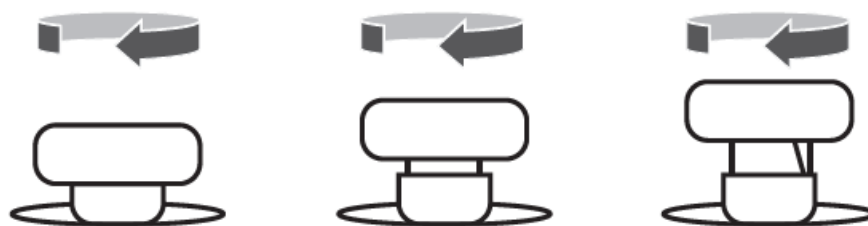

RGB LED CONTROL

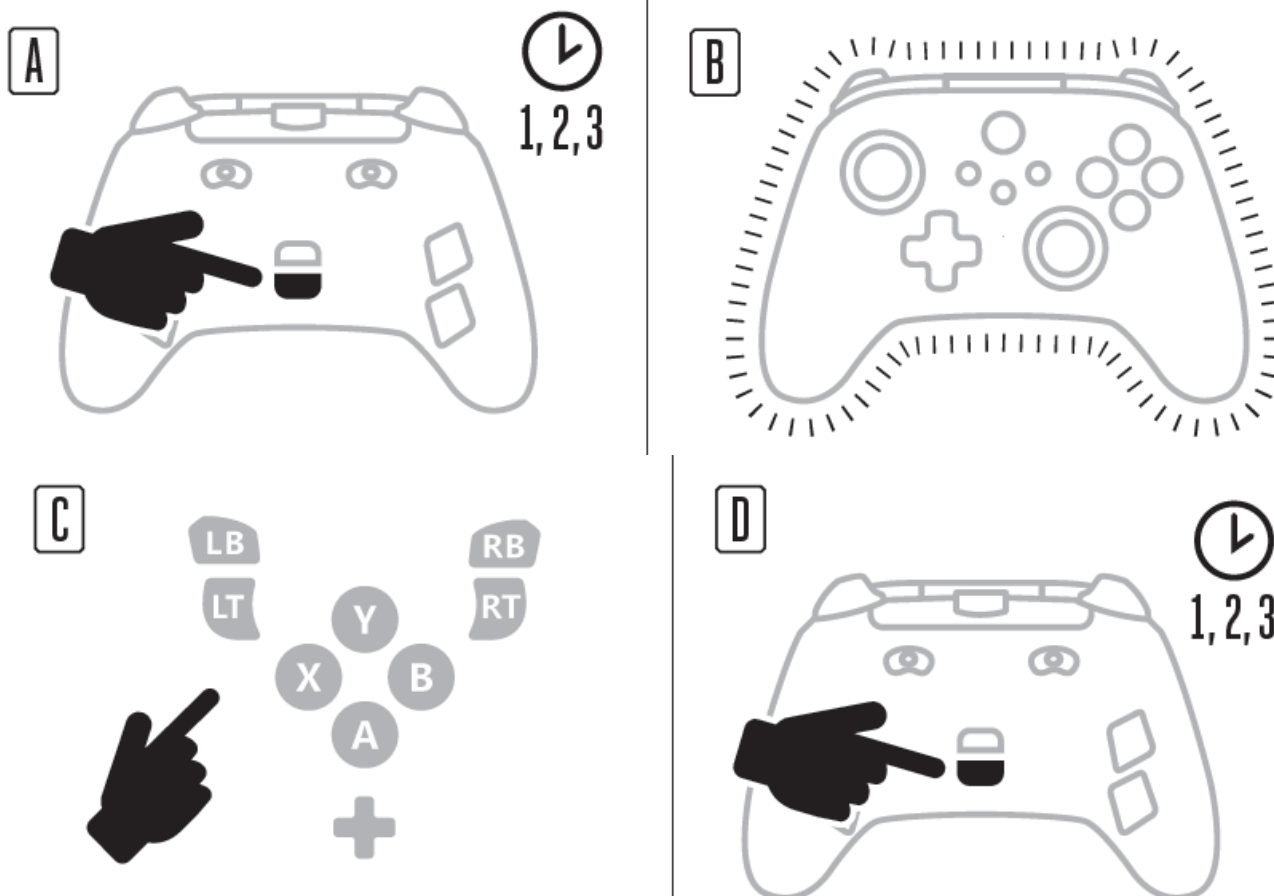

NOTE: Please refer to the digital user manual for detailed directions.

BATTERY WARNING

- Do not attempt to repair the Li-ion battery yourself—you may damage the battery, which could cause overheating, fire, and injury.
- The Li-ion battery in your device should be serviced or recycled by PowerA or an authorized provider and must be recycled or disposed of separately from household waste.
- Dispose of batteries according to your local environmental laws and guidelines.
- Do not use or leave a device containing rechargeable batteries in a high-temperature environment (e.g., in strong direct sunlight or in a vehicle in hot weather). High temperatures may cause batteries to overheat or catch fire, and the battery's performance or longevity may be negatively affected.
- Do not use a device containing rechargeable batteries in an environment with high levels of static electricity.

Excessive static electricity can impair the batteries' internal safety measures, increasing the risk of overheating or fire.

- If liquid leaking from a battery pack comes into contact with your eyes, DO NOT RUB EYES! Immediately flush your eyes thoroughly with clean running water and seek medical attention to prevent injury to the eyes.
- If the battery gives off an odor, generates heat, or in any way appears abnormal during use, recharging, or storage, immediately remove it from any charging device and place it in a sealed fireproof container such as a metal box, or in a safe location away from people and flammable items.
- Discarded batteries may cause a fire. Do not heat the controller or battery, or place it either in or near the fire.

FCC STATEMENT

This device complies with Part 15 of the FCC Rules. Operation is subject to the following two conditions:

1. this device may not cause harmful interference, and
2. this device must accept any interference received, including interference that may cause undesired operation.

WARNING: Changes or modifications to this unit not expressly approved by the party responsible for compliance could void the user's authority to operate the equipment.

NOTE: This equipment has been tested and found to comply with the limits for Class B digital devices, according to Part 15 of the FCC Rules.

These limits are designed to provide reasonable protection against harmful interference in a residential installation. This equipment generates, uses, and can radiate radio frequency energy and, if not installed and used under the instructions, may cause harmful interference to radio communications. However, there is no guarantee that interference will not occur in a particular installation. If this equipment does cause harmful interference to radio or television reception, which can be determined by turning the equipment off and on, the user is encouraged to try to correct the interference by one or more of the following measures:

- Reorient or relocate the receiving antenna.
- Increase the separation between the equipment and the receiver.
- Connect the equipment to an outlet on a circuit different from that to which the receiver is connected.
- Consult the dealer or an experienced radio/TV technician for help.

CAN ICES-003(B)/NMB-003(B)

This device contains license-exempt transmitter(s)/receiver(s) that comply with Innovation, Science, and Economic Development Canada's license-exempt RSS(s). Operation is subject to the following two conditions:

1. This device may not cause interference.
2. This device must accept any interference, including interference that may cause undesired operation of the device.

EU/UK DECLARATION OF CONFORMITY

Hereby, ACCO Brands USA LLC declares the wireless controller complies with Directive 2014/53/EU and UK Radio Equipment Regulation 2017, as well as other essential requirements and relevant provisions of EU directives and UK legislation. The full text of the declaration of conformity is available at the following internet address: PowerA.com/compliance.

WIRELESS SPECIFICATIONS

- **Frequency Range:** 2.4 – 2.4835GHz
- **Max E.I.R.P.:** < 10dBm. For EU & UK only.

ADDITIONAL LEGAL

© 2024 ACCO Brands. All Rights Reserved. PowerA and PowerA Logo are trademarks of ACCO Brands. The Bluetooth® word mark and logos are registered trademarks owned by Bluetooth SIG, Inc. and any use of such marks by ACCO Brands Corporation is under license. All other trademarks are the property of their respective owners.

CONTACT/SUPPORT





- For support with your authentic PowerA accessories, please visit PowerA.com/support.



Documents / Resources

	<p>PowerA OPS V3 Overpowered Series PC Pro Wireless Controller [pdf] User Manual YFK-PCGPPRWLDA, YFKPCGPPRWLDA, pcgpprwlda, OPS V3 Overpowered Series PC Pro Wireless Controller, OPS V3 PC Pro Wireless Controller, Overpowered Series PC Pro Wireless Controller, OPS V3, PC Pro Wireless Controller, Wireless Controller, Controller, PC Wireless Controller, Pro Wireless Controller</p>
--	--

References

-  [ACCO Brands](#)
-  [PowerA | PowerA](#)
-  [Declaration of Conformity | PowerA](#)
-  [Support | PowerA](#)
-  [Anlage 1 ElektroG - Einzelnorm](#)
- [User Manual](#)

[Manuals+](#), [Privacy Policy](#)

This website is an independent publication and is neither affiliated with nor endorsed by any of the trademark owners. The "Bluetooth®" word mark and logos are registered trademarks owned by Bluetooth SIG, Inc. The "Wi-Fi®" word mark and logos are registered trademarks owned by the Wi-Fi Alliance. Any use of these marks on this website does not imply any affiliation with or endorsement.