

 **PowerA™**
NSGPWLLGDA
Enhanced
Wireless
Controller with
Lumectra



PowerA NSGPWLLGDA Enhanced Wireless Controller with Lumectra User Manual

[Home](#) » [PowerA](#) » PowerA NSGPWLLGDA Enhanced Wireless Controller with Lumectra User Manual 

Contents

- [1 PowerA NSGPWLLGDA Enhanced Wireless Controller with Lumectra](#)
- [2 Product Specifications](#)
- [3 Product Usage Instructions](#)
- [4 CONTENTS](#)
- [5 PAIRING](#)
- [6 CHARGING](#)
- [7 ADVANCED GAMING BUTTON PROGRAMMING](#)
- [8 LUMECTRA LED CONTROLS](#)
- [9 BATTERY WARNING](#)
- [10 FCC STATEMENT](#)
- [11 WIRELESS SPECIFICATIONS](#)
- [12 2-YEAR LIMITED WARRANTY](#)
- [13 ABOUT COMPANY](#)
- [14 FAQ](#)
- [15 Documents / Resources](#)
 - [15.1 References](#)
- [16 Related Posts](#)



PowerA NSGPWLLGDA Enhanced Wireless Controller with Lumectra



Product Specifications

- **Model:** PowerA Enhanced Wireless Controller with Lumectra
- **Compliance:** CAN ICES-003(B)/NMB-003(B), IMDA Standards
- **Wireless Technology:** Licence-exempt transmitter(s)/receiver(s)
- **Regulatory Compliance:** Directive 2014/53/EU, UK Radio Equipment Regulation 2017

Product Usage Instructions

Pairing/Synchronization:

When pairing your controller, follow these steps:

1. Do not touch the left stick or right stick during pairing.

Charging:

To charge your controller:

1. Connect the charging cable to the controller and a power source.
2. Ensure the Lumectra LED controls indicate the charging status.

Lumectra LED Controls:

The Lumectra mode allows for individual zone controls:

- **Enter/Exit Lumectra mode:** Press specified buttons to enter or exit Lumectra mode.
- **Undo edits in Lumectra mode:** Use designated controls to cancel edits made in Lumectra mode.

CONTENTS

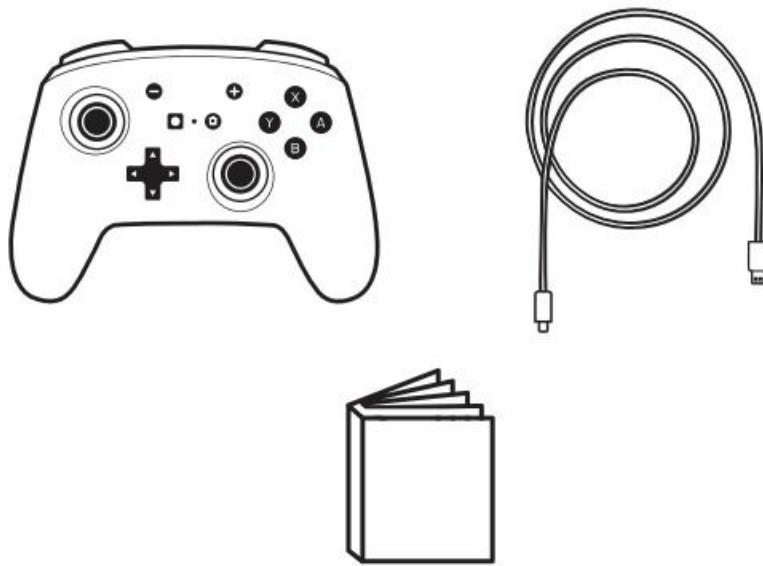

PAIRING

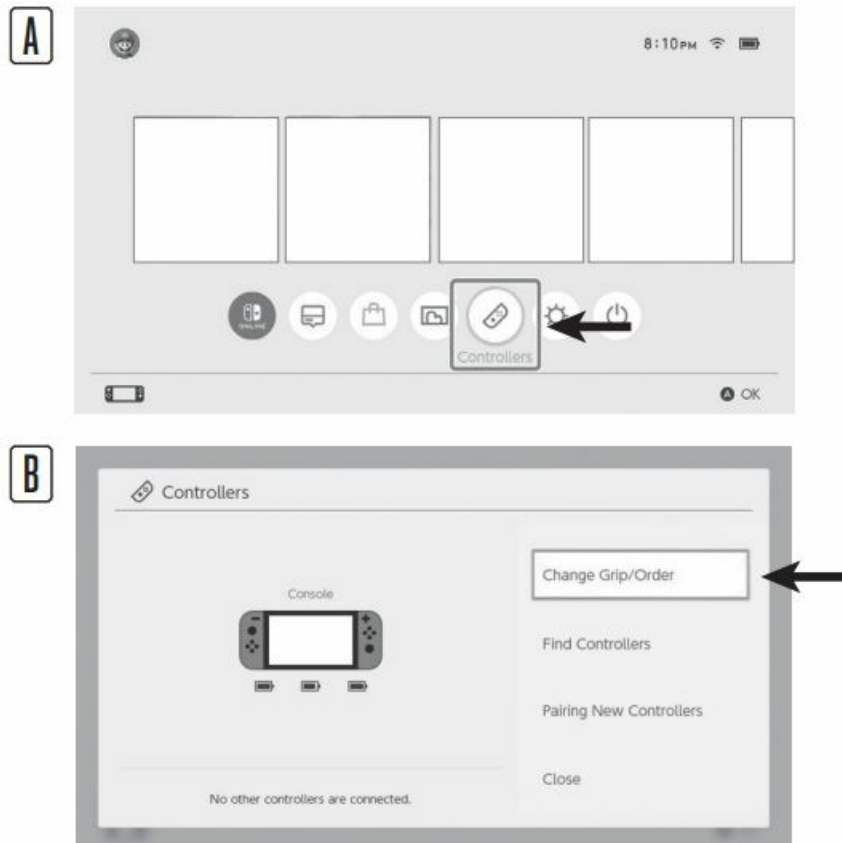

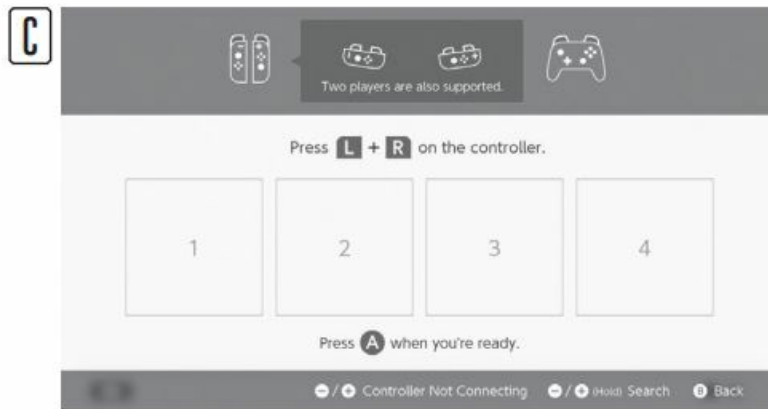

NOTE: DO NOT TOUCH THE LEFT STICK OR RIGHT STICK WHEN PAIRING YOUR CONTROLLER.
NE TOUCHEZ NI LE STICK GAUCHE NI LE STICK DROIT LORS DE LA SYNCHRONISATION DE VOTRE MANETTE.

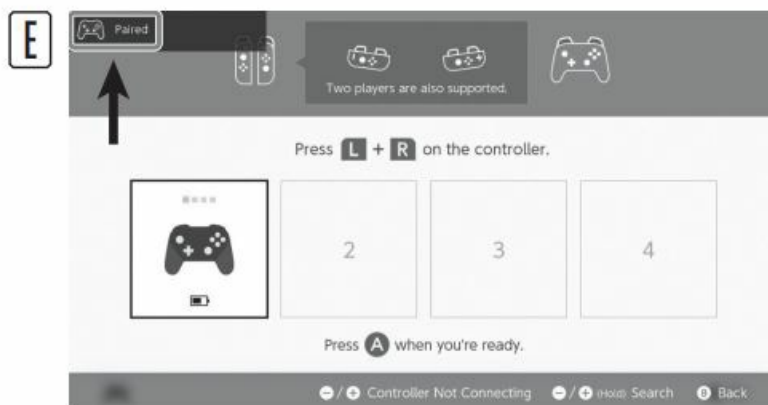

CHARGING

NOTE

- Charge your controller at least once every 45-60 days (regardless of use) so that the battery retains its ability to charge.
- When the battery is near depletion, the recharge LED will blink red and the Lumectra lighting will dim.

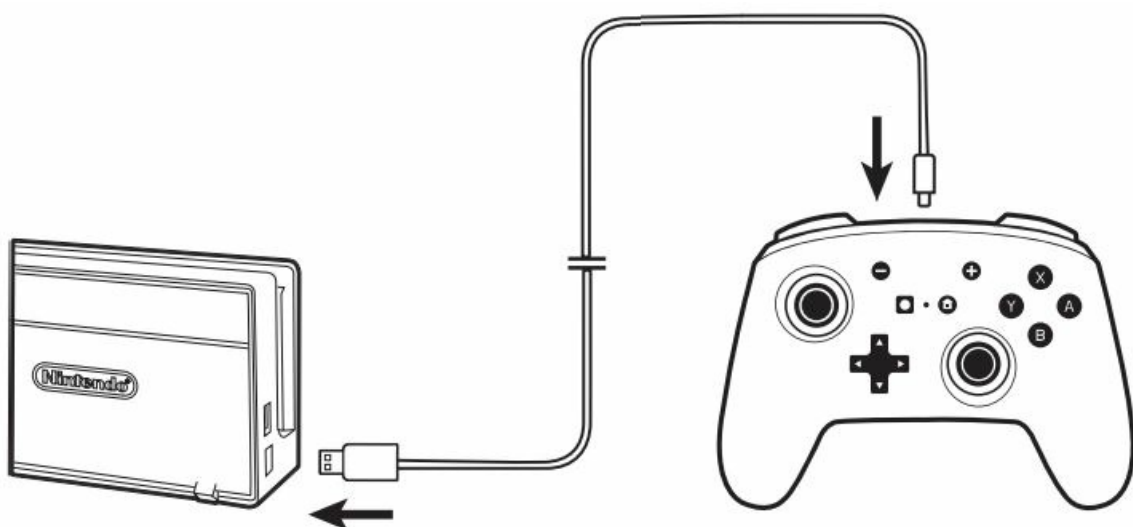

ADVANCED GAMING BUTTON PROGRAMMING

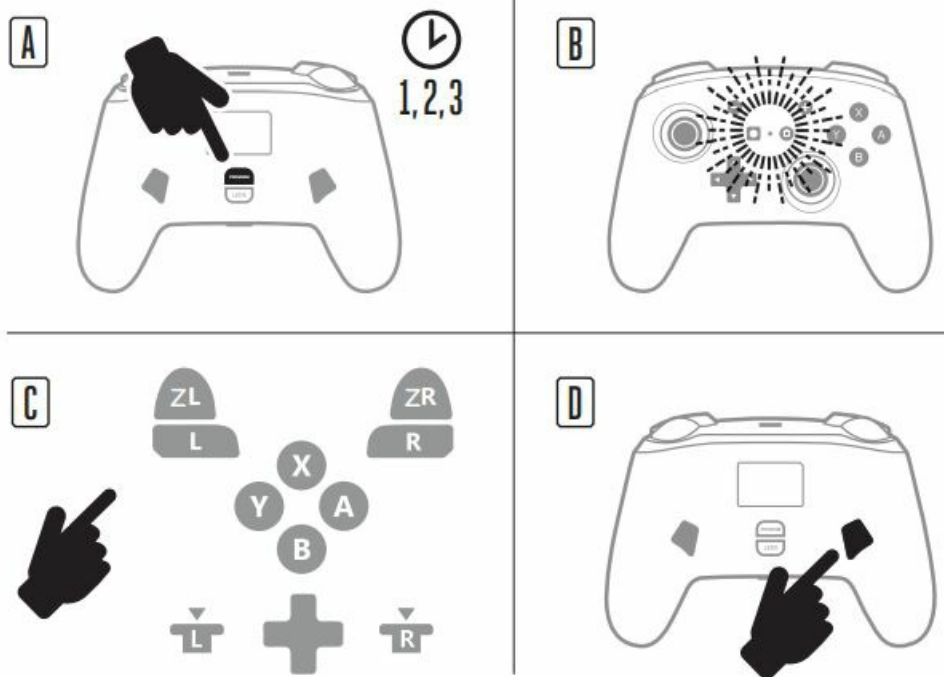

LUMECTRA LED CONTROLS

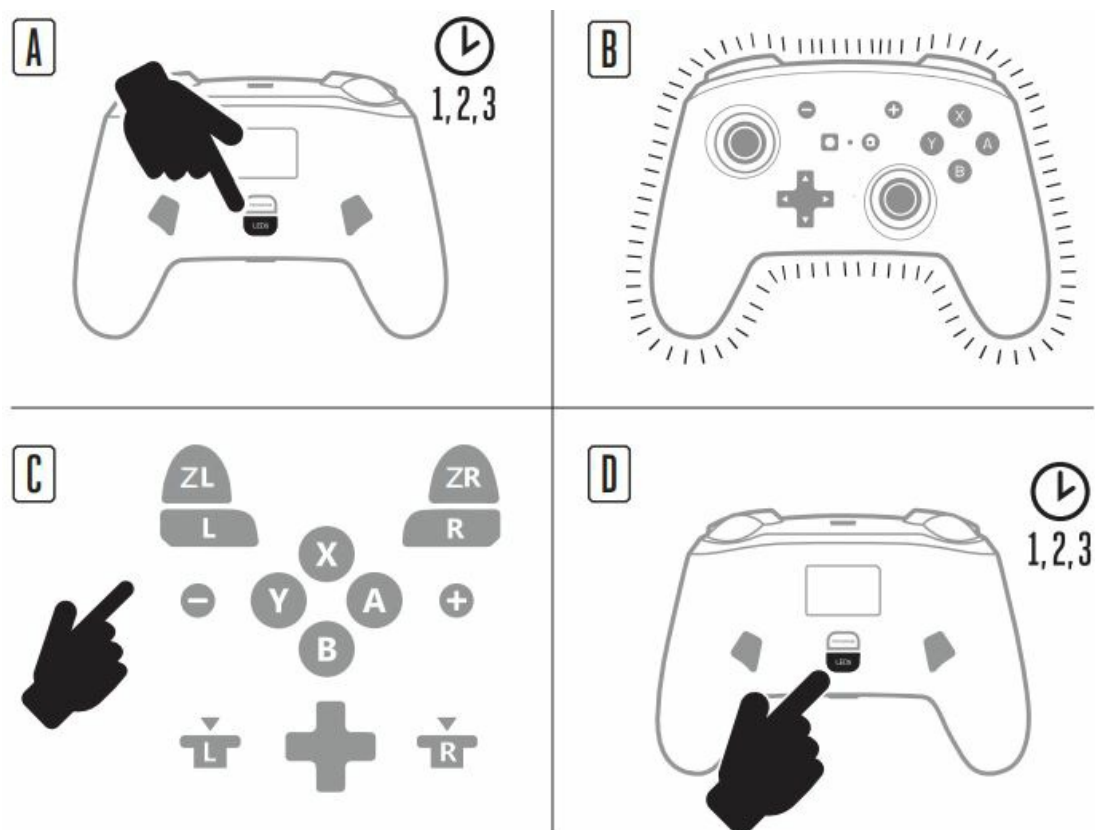

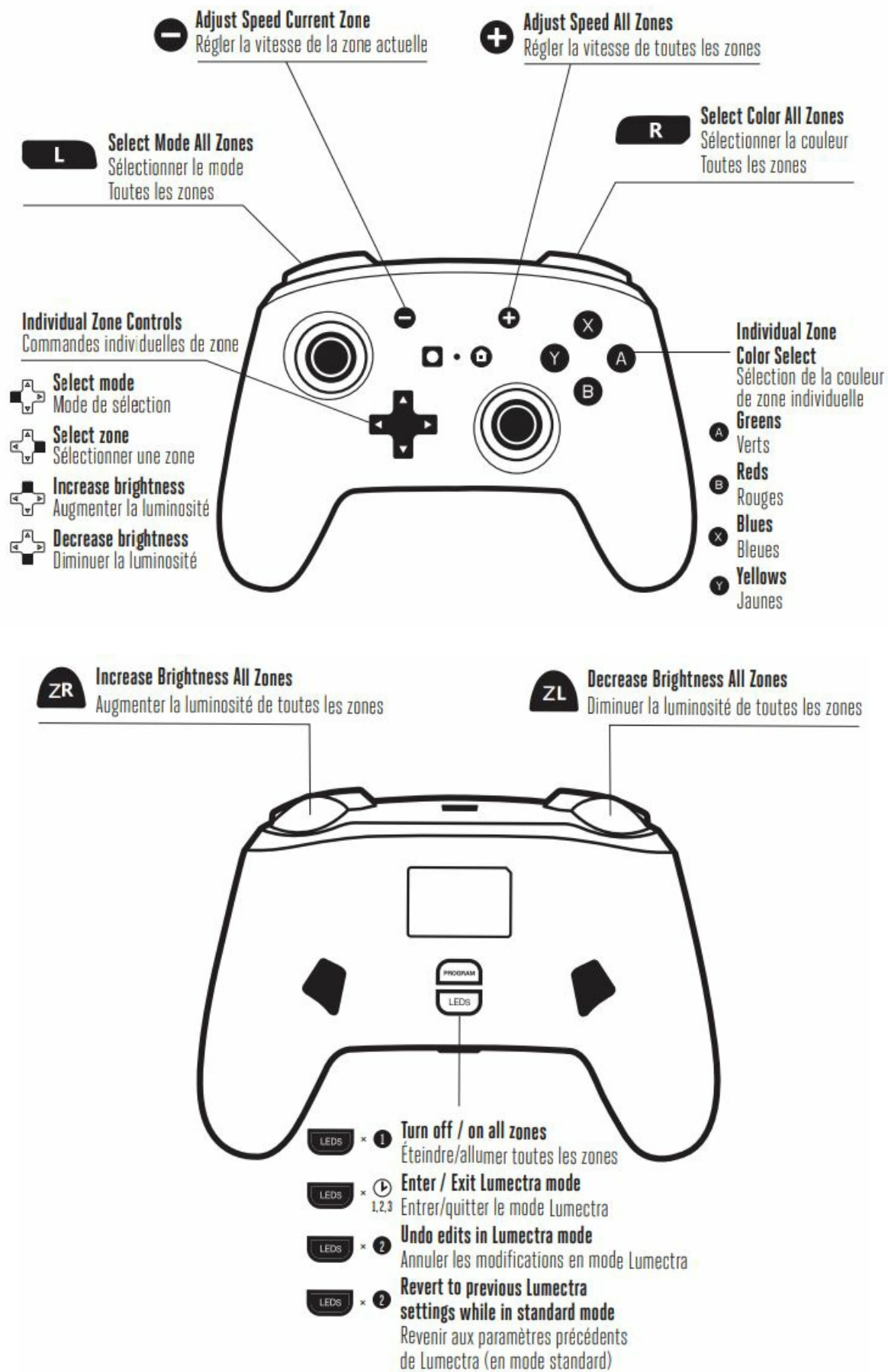

BATTERY WARNING

- Do not attempt to repair the Li-ion battery yourself—you may damage the battery, which could cause overheating, fire, and injury.

- The Li-ion battery in your device should be serviced or recycled by PowerA or an authorized provider and must be recycled or disposed of separately from household waste.
- Dispose of batteries according to your local environmental laws and guidelines.
- Do not use or leave the product containing rechargeable batteries exposed to very high or very low temperature (e.g. at strong direct sunlight or in a vehicle in extremely hot or extremely cold weather), or in an environment with extremely low air pressure can result in an explosion, fire, or the leakage of flammable liquid or gas.
- Do not use a device containing rechargeable batteries in an environment with high levels of static electricity. Excessive static electricity can impair the batteries' internal safety measures, increasing the risk of overheating or fire.
- If liquid leaking from a battery pack comes into contact with your eyes, DO NOT RUB EYES! Immediately flush eyes thoroughly with clean running water and seek medical attention to prevent injury to eyes.
- If the battery gives off an odor, generates heat, or in any way appears abnormal during use, recharging or storage, immediately remove it from any charging device and place it in a sealed fireproof container such as a metal box, or a safe location away from people and flammable items.
- Discarded batteries may cause fire. Do not heat the controller or battery, or place either in or near fire.

FCC STATEMENT

This device complies with Part 15 of the FCC Rules. Operation is subject to the following two conditions:

1. this device may not cause harmful interference, and
2. this device must accept any interference received, including interference that may cause undesired operation.

WARNING: Changes or modifications to this unit not expressly approved by the party responsible for compliance could void the user's authority to operate the equipment.

NOTE: This equipment has been tested and found to comply with the limits for Class B digital device, under Part 15 of the FCC Rules. These limits are designed to provide reasonable protection against harmful interference in a residential installation. This equipment generates, use,s and can radiate radio frequency ener,gy and, if not installed and used by the instructions, may cause harmful interference to radio communications. However, there is no guarantee that interference will not occur in a particular installation. If this equipment does cause harmful interference to radio or television reception, which can be determined by turning the equipment off and on, the user is encouraged to try to correct the interference by one or more of the following measures:

- Reorient or relocate the receiving antenna.
- Increase the separation between the equipment and receiver.
- Connect the equipment into an outlet on a circuit different from that to which the receiver is connected.
- Consult the dealer or an experienced radio/TV technician for help.

CAN ICES-003(B)/NMB-003(B)

This device contains licence-exempt transmitter(s)/receiver(s) that comply with Innovation, Science and Economic Development Canada's licence-exempt RSS(s). Operation is subject to the following two conditions:

1. This device may not cause interference.
2. This device must accept any interference, including interference that may cause undesired operation of the device.

EU/UK DECLARATION OF CONFORMITY

Hereby, ACCO Brands USA LLC declares the wireless controller complies with Directive 2014/53/EU and UK Radio Equipment Regulation 2017, as well as other essential requirements and relevant provisions of EU directives and UK legislation. The full text of the declaration of conformity is available at the following internet address: PowerA.com/Compliance.

WIRELESS SPECIFICATIONS

- **Frequency Range:** 2.4 – 2.4835 GHz
- **Max E.I.R.P.:** < 10 dBm. For EU & UK only.

ADDITIONAL LEGAL

© 2024 ACCO Brands. All Rights Reserved. PowerA, PowerA Logo, and Lumectra are trademarks of ACCO Brands. The Bluetooth® word mark and logos are registered trademarks owned by Bluetooth SIG, Inc. and any use of such marks by ACCO Brands is under license. Other trademarks and trade names are those of their respective owners. © Nintendo. Nintendo Switch is a trademark of Nintendo.

For more details and different languages of the User Guide, please scan the QR code to read before playing.



2-YEAR LIMITED WARRANTY

For warranty details or support with your authentic PowerA accessories, please visit PowerA.com/Support.

ABOUT COMPANY

- **MANUFACTURED FOR**
ACCO Brands USA LLC, 4 Corporate Drive, Lake Zurich, IL 60047
- ACCOBRANDS.COM
- POWERA.COM

FAQ





- **How do I reset the controller?**
To reset the controller, press the reset button located on the back of the controller using a small pin or paperclip.
- **Can the controller be used with multiple devices?**
Yes, the controller can be paired with multiple devices, but only one active connection is supported at a time.

Documents / Resources



[PowerA NSGPWLLGDA Enhanced Wireless Controller with Lumectra](#) [pdf] User Manual
NSGPWLLGDA, YFK-NSGPWLLGDA, YFKNSGPWLLGDA, NSGPWLLGDA Enhanced Wireless Controller with Lumectra, NSGPWLLGDA, Enhanced Wireless Controller with Lumectra, Wireless Controller with Lumectra, Controller with Lumectra, Lumectra, Controller

References

-  [ACCO Brands](#)
-  [PowerA | PowerA](#)
-  [Declaration of Conformity | PowerA](#)
-  [Support | PowerA](#)
-  [Anlage 1 ElektroG - Einzelnorm](#)
- [User Manual](#)

[Manuals+](#), [Privacy Policy](#)

This website is an independent publication and is neither affiliated with nor endorsed by any of the trademark owners. The "Bluetooth®" word mark and logos are registered trademarks owned by Bluetooth SIG, Inc. The "Wi-Fi®" word mark and logos are registered trademarks owned by the Wi-Fi Alliance. Any use of these marks on this website does not imply any affiliation with or endorsement.