

POSTURITE
Penguin 3-in-1
Ambidextrous
Vertical
Mouse



posturite Penguin 3-in-1 Ambidextrous Vertical Mouse User Guide

[Home](#) » [POSTURITE](#) » posturite Penguin 3-in-1 Ambidextrous Vertical Mouse User Guide 

Contents

- [1 posturite Penguin 3-in-1 Ambidextrous Vertical Mouse](#)
- [2 Product Usage Instructions](#)
- [3 FAQs](#)
- [4 PARTS LIST](#)
- [5 HOW TO USE](#)
- [6 Charging light sequence](#)
- [7 TROUBLESHOOTING GUIDE](#)
- [8 IMPORTANT INFORMATION](#)
- [9 FCC CONFORMITY](#)
- [10 SPECIFICATIONS](#)
- [11 Documents / Resources](#)
 - [11.1 References](#)
- [12 Related Posts](#)



posturite Penguin 3-in-1 Ambidextrous Vertical Mouse



Product Usage Instructions

Wired Operation:

Plug the USB cable into any spare USB port on your computer.

Wireless Operation:

1. Locate the 2.4 GHz USB micro receiver inside the housing under the Penguin.
2. Insert the micro receiver into a spare USB port on your computer.
3. Switch the base switch (F) to the GREEN position for wireless operation.
4. To use Bluetooth, switch the base switch (F) to the Bluetooth position and follow the pairing steps.

Auto Power Save:

The Penguin enters power save mode after 20 seconds of inactivity. It enters deep sleep mode after 30 minutes of inactivity. Click any button to reawaken.

Rechargeable Battery:

To charge the battery, insert the USB end of the cable (G) into your computer and the USB-C end into the mouse (I).

Battery Charging Light Sequence:

- Orange light + flashing Ice Blue light: Battery charging (below 20% charge)
- Orange light + constant Ice Blue light: Battery charging (above 20% charge)
- Ice Blue light only: Battery fully charged

Right & Left-Handed Use:

To switch to left-handed use, depress the raised section of the rocker switch – ‘Bow Tie’ (D) at the front of the Penguin.

Adjusting DPI:

To change the DPI setting, press and release the DPI button (E) on the base of the Penguin. The illuminated logo will indicate the DPI level.

FAQs

Q: How do I know if my Penguin is connected via Bluetooth?

A: The 'P' logo will flash BLUE briefly when connected via Bluetooth.

Q: What should I do if my battery is low?

A: When the Ice Blue light is flashing, it indicates low battery (approximately 20% charge remaining). Recharge the battery.

PARTS LIST

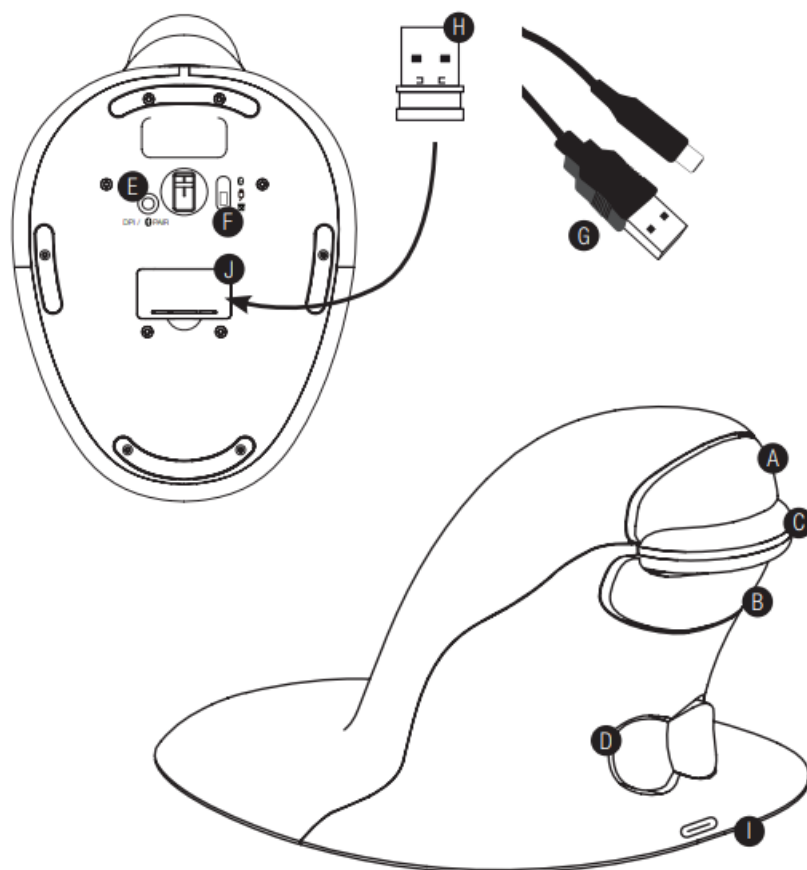

- **A.** Left Click
- **B.** Right Click
- **C.** Scroll Wheel
- **D.** Rocker Switch – 'Bow Tie'
(L/R Hand Switch)
- **E.** DPI and Bluetooth syncing button
- **F.** Bluetooth/wired/wireless switch
- **G.** USB – USB-C Recharging Cable
(Bluetooth/wireless only)
- **H.** 1 x USB Micro Receiver
(wireless only)
- **I.** Recharging USB-C Port
(Bluetooth/wireless only)
- **J.** Micro Receiver Dongle Housing (Bluetooth/wireless only)

HOW TO USE



For wired operation

Plug the USB cable into any spare USB port.

For wireless operation

The 2.4 GHz USB micro receiver is located inside the housing on the underneath of the Penguin (J).



1. Remove the micro receiver and insert into a spare USB port of your computer or laptop. Wait for a short time for your PC to recognise the Penguin.

2. Move switch (F) on the base from  downwards to the  position. The 'P' logo will flash GREEN briefly.

For Bluetooth® operation

Make sure that your PC is Bluetooth compatible.

To choose Bluetooth operation.

1. Move switch (F) on the base from  upwards to Bluetooth. 
The 'P' logo will flash BLUE briefly.
2. On your computer turn on 'Search for Bluetooth'.
3. Press the DPI/ Bluetooth  pair button for 5-10 seconds.
4. On your PC search for "Penguin 3.0 or 5.0 Mouse".
5. Click on "Penguin 3.0 or 5.0 Mouse" and connect.
6. Your Penguin should now be connected via Bluetooth. If not, press 'remove 'Penguin 3.0 or 5.0 Mouse' and repeat same procedure to sync to Bluetooth.

Auto power save

- After approximately 20 seconds inactive – Penguin enters power save mode
- After approximately 30 minutes – Penguin enters deep sleep mode
- Inactive – click any button to reawaken

 **Note:** It is advised to switch to the  position if the Penguin is to be transported as this will conserve power.

Rechargeable battery

The Penguin has an internal rechargeable battery. There may be a certain amount of charge already in the battery. To fully charge the battery, insert the USB end of the cable (G) into a spare USB port of your computer and the USB-C end of the cable into the front of your mouse (I) see diagram. Refer to the Charging Light Sequence section to indicate the battery level.

Rechargeable battery low power level indicator

Ice Blue light flashing	Low battery (approximately 20% charge remaining)
-------------------------	--

Charging light sequence

When the charging cable is connected, a series of coloured lights in the illuminated 'P' logo will indicate different battery levels.

Penguin in ACTIVE mode:

Orange light + flashing Ice Blue light	Battery charging (below 20% charge)
Orange light + constant Ice Blue light	Battery charging (above a 20% charge)
Ice Blue light only	Battery fully charged

Penguin in INACTIVE mode:

Orange 'P' light	Battery charging
------------------	------------------

Orange 'P' light turns off once fully charged.

Plug & play

The Penguin uses Plug & Play technology. No additional software is required.

Right & left-handed use

The Penguin is set as a right-handed mouse by default. To use with your left hand, simply depress the raised section of the rocker switch – 'Bow Tie' (D) at the front of the Penguin. This will adjust the direction of the scroll wheel.

Variable DPI [800-1200-1600-2400] – Pointer Speed

The default setting is 800 DPI. To adjust, press and release the DPI button (E) on the base of the Penguin. The illuminated 'P' logo will flash to indicate the DPI has been changed.

DPI (pointer speed)	Number of Flashes	Speed
800 DPI	1 'P' Flash	Slow
1200 DPI	2 'PP' Flash	Medium
1600 DPI	3 'PPP' Flash	Fast
2400 DPI	4 'PPPP' Flash	Fastest

Precision scroll wheel with auto scroll

As well as a soft touch and feel Precision Scroll Wheel (C), The Penguin has an Auto Scroll feature. To activate this, click the Scroll Wheel inwards or downwards and the auto scroll is activated. Move the Penguin forwards or backwards to start auto scrolling at the desired speed. Click the scroll wheel again and the Auto Scroll is stopped.

TROUBLESHOOTING GUIDE

- Make sure that The Penguin is charged via the USB-C charging cable.
- Make sure the switch on the underside of the base is in 'ON' position (rechargeable models only) – either 'UP'

(BLUE) for Bluetooth or 'DOWN' (GREEN) for wireless operation.

- If using wired, make sure your Penguin is firmly plugged into your computer's USB port
- If using wired, try using a different USB port. If possible plug it directly into the computer i.e. not through any monitors/keyboards/hubs etc.
- If using wireless, make sure your Penguin's dongle (micro receiver) is firmly plugged in to your computer's USB port.
- If using wireless, try unplugging the Penguin dongle (micro receiver), then plugging it back in again.
- If using Bluetooth, on your PC, remove Bluetooth item (Penguin Mouse) and re-add Bluetooth device again.
- If using wireless, try holding the Penguin close to the sensor for 30 seconds whilst intermittently clicking the top button – it sometimes takes this to get the dongle to recognise the hardware.
- If using wireless, try using a different USB port to connect your Penguin.
If possible plug it directly into the computer, i.e. not through any monitors/keyboards/hubs etc.
- If using wireless, remove the USB Dongle and turn 'OFF' the Penguin switch. Reboot your computer. Now re-insert USB dongle, wait 10/15 seconds and turn Penguin switch back 'ON' – in 'DOWN' (GREEN) position.
- Although your Penguin is plug & play, make sure your computer is up to date with the latest drivers/operating software for pointing devices.
- Check that the sensor on the underside of the Penguin isn't covered and has a clear line of sight to the surface below. Also check that your Penguin has not been dropped which could dislodge the laser.
- Try using the Penguin on a mouse mat / unreflective surface.
- Make sure the charging cable is firmly attached into the USB port of your computer and the USB-C end is firmly pushed into the front of the Penguin. The 'P' Logo should light an orange colour. Recharge directly via a USB port on your computer NOT via a multi-USB hub.
- Try your Penguin on a different PC/laptop to check if the issue is still present.
- Close your computer down and reboot.

If you attempt all of the above suggestions and there still appears to be a problem, please contact your supplier.

IMPORTANT INFORMATION

Health

Long periods of time at your workstation without regular breaks may cause discomfort. Should discomfort persist, see a qualified health professional.

User advice/Maintenance

Try to avoid contact with strong medicated hand creams/sanitiser whilst using the Penguin. Regularly remove dust and dirt build-up from the underneath of your Penguin to ensure a smooth glide movement.

Disclaimer

We make every effort to ensure that the information and procedure in this guide is accurate and complete, no liability can be accepted for any errors or omissions and we reserve the right to make any changes without further notice herein.

Guarantee

The Penguin is guaranteed for a period of 24 months from the date of the purchase. This guarantee does not apply to misuse or normal wear and tear.

ANTIMICROBIAL PROTECTION

- BioCote® – the antimicrobial brand you can trust.
- Based on silver ions BioCote® is proven to offer antimicrobial protection for the expected lifetime of the product. BioCote® keeps your Penguin fresher and cleaner for longer, protecting against odour causing and staining microbes, such as bacteria and mould.
- BioCote® has been proven to reduce bacteria/microbes on products by up to 99.5% in two hours OR 99.99% in 24hrs.
- BioCote® tested in a laboratory, proven in real life, antimicrobial quality guaranteed.
- BioCote® protected products are quality control checked to the appropriate test standard.

Please Note

BioCote® technology does not protect users or others against disease-causing bacteria, germs, viruses or other harmful organisms. This technology is not a substitute for good hygiene and/or cleaning practises.

FCC CONFORMITY

This device complies with Part 15 of the FCC Rules. Operation is subject to the following two conditions: (1) This device may not cause harmful interference, and (2) This device must accept any interference received, including interference that may cause undesired operation.

Warning: Changes or modifications to this unit not expressly approved by the party responsible for compliance could void the user's authority to operate the equipment.

NOTE: This equipment has been tested and found to comply with the limits for a Class B digital device, pursuant to Part 15 of the FCC Rules. These limits are designed to provide reasonable protection against harmful interference in a residential installation. This equipment generates, uses and can radiate radio frequency energy and, if not installed and used in accordance with the instructions, may cause harmful interference to radio communications.

However, there is no guarantee that interference will not occur in a particular installation. If this equipment does cause harmful interference to radio or television reception, which can be determined by turning the equipment off and on, the user is encouraged to try to correct the interference by one or more of the following measures:

- Reorient or relocate the receiving antenna.
- Increase the separation between the equipment and receiver.
- Connect the equipment into an outlet on a circuit different from that to which the receiver is connected.

The device has been evaluated to meet general RF exposure requirement. The device can be used in portable exposure condition without restriction.

IC STATEMENT

This device contains licence-exempt transmitter(s)/receiver(s) that comply with Innovation, Science and Economic Development Canada's licence-exempt RSS(s). Operation is subject to the following two conditions:

1. This device may not cause interference.
2. This device must accept any interference, including interference that may cause undesired operation of the device

UKCA

Manufacturer: Posturite Ltd

Address: The Mill, Berwick, East Sussex, BN26 6SZ, United Kingdom

USB cable:

- Accessory Manufacturer: ShenZhen Zhongtai Electricity Co., Ltd
- Address of Manufacturer: 3rd Floor, Building NO.15, Xitian No.3 Industrial Zone, Gongming street, Guangming district, Shenzhen, Guangdong, China
- Operating temperature: 0° to 45°

Satisfies all the technical regulations applicable to the product within the scope of UK Radio Equipment Regulations (SI 2017/1206); UK Electrical Equipment (Safety) Regulations (SI 2016/1101); and UK Electromagnetic Compatibility Regulations (SI 2016/1091).

CAUTION:

RISK OF EXPLOSION IF BATTERY IS REPLACED BY AN INCORRECT TYPE. DISPOSE OF USED BATTERIES ACCORDING TO THE INSTRUCTIONS.

- **Operation Frequency:** 2402MHz~2480MHz
- **Maximum Power:** 4.76dBm (EIRP)

© 2024 Posturite Ltd. All Rights Reserved. Posturite, the logo design, Penguin, the logo design are registered trademarks of Posturite Ltd. Posturite Ltd, The Mill, Berwick, East Sussex BN26 6SZ, UK.
+44 (0) 345 345 0010 | www.posturite.co.uk

Patents Pending, UK Application
No.0915129 and Worldwide.
Design Registration Number: EC 001211536.



PRODUCT NAME

The Penguin – Small (Code: 100106076) The Penguin – Medium (Code: 100106080) The Penguin – Large (Code: 100106086)

MODEL

Bluetooth/Wireless/Wired

SPECIFICATIONS

Bluetooth® Li-ion rechargeable battery.

- **Bluetooth® version:** 3.0 & 5.0
- **System Model:** GFSK 2.4G&BT
- **Working Voltage:** 3.7V
- **Working current:** 5mA
- **Battery:** 3.7V 500MA
- **Charging voltage:** 5V

- **Charging current:** 200mA
- **Charging time:** Approx. 3 hours

RESPONSIBLE PARTY

Penguin Mouse

- FCC ID: Y35-100106080A
- IC: 10227A-100106080A

Dongle:

- FCC ID: Y35-10608DX
- IC: 10227A-10608DX

Documents / Resources

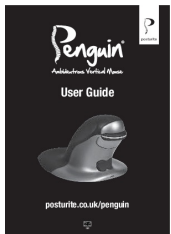

[posturite Penguin 3-in-1 Ambidextrous Vertical Mouse](#) [pdf] User Guide
Penguin 3-in-1 Ambidextrous Vertical Mouse, Penguin, 3-in-1 Ambidextrous Vertical Mouse, Am
bidextrous Vertical Mouse, Vertical Mouse, Mouse

References

- [User Manual](#)

[Manuals+](#), [Privacy Policy](#)

This website is an independent publication and is neither affiliated with nor endorsed by any of the trademark owners. The "Bluetooth®" word mark and logos are registered trademarks owned by Bluetooth SIG, Inc. The "Wi-Fi®" word mark and logos are registered trademarks owned by the Wi-Fi Alliance. Any use of these marks on this website does not imply any affiliation with or endorsement.