



postium PRM-207Q LCD Rack Monitor User Manual

[Home](#) » [postium](#) » postium PRM-207Q LCD Rack Monitor User Manual 

Postium®
LCD Rack Monitor



PRM-207Q LCD Rack Monitor User Manual

Contents

- [1 Warning](#)
- [2 Features](#)
- [3 Feature Name & Functions](#)
- [4 OSD Menu Organization & Adjustment](#)
- [5 Other Functions](#)
- [6 System Default Value](#)
- [7 Product Specification](#)
- [8 Documents / Resources](#)
 - [8.1 References](#)
- [9 Related Posts](#)

Warning

- Always use set voltage.

– DC 12V

- If liquid is spilled on or impacts this product, please disconnect the product immediately and contact for professional help before continuing use.
- Keep unit disconnected during extended periods of disuse.
- Keep unit in a well-ventilated place to prevent overheating.
- Do not install the product near any heat-generating equipment.
- Keep the product out of direct sunlight or dusty areas.
- Only clean the product with a noncommercial, mild, and neutral detergent.
- When transporting the product, make use of its original packaging for safer transport.

FCC (Federal Communications Commission)

This equipment has been tested and found to comply with the limits for class A digital device, pursuant to part 15 of the FCC Rules. These limits are designed to provide reasonable protection against harmful interference when the equipment is operated in a commercial environment. This equipment generates, uses, and can radiate radio frequency energy, and if not installed and used in accordance with the instruction manual, may cause harmful interference to radio communications. Operation of this equipment in a residential to correct the interference at his own expense Change or modifications not expressly approved by the manufacturer responsible for compliance void the user's authority to operate the equipment.

Warning!! :

Disposal of Old Electrical & Electronic Equipment

(Applicable in the European Union and other European countries with separate collection systems)



This symbol on the product or on its packing indicates that this product shall not be treated as household waste. Instead it shall be handed over to the applicable collection point for the recycling of electrical and electronic equipment. By ensuring this product is disposed of correctly, you will help prevent potential negative consequence for the environment and human health, which could otherwise be caused by inappropriate waste handling of this product. The recycling of materials will help to conserve natural resources.

Features

Multi-Format PRM-207Q Rack Monitor Contains the following features :

- **Compatible with various SDI Signals**
The product is compatible with varied SDI Signals
-480i,576i,720p,1035i,1080i,1080p,1080psf, 2K
- **Wide Varieties of Markers & Safety Areas**
Center Marker, Safety Area Marker, Aspect Marker, Display Size(Scan)
- **High Resolution(960X540)/LED Backlight**
- **24Bit RGB CMOS Interface Panel**
- **Tilt of LCD Module: $\pm 15^\circ$**
- **Dynamic UMD(Under Monitor Display)**
Small, medium, and large size display.
Possible to control monitor to the maximum value of 100 by Set ID Menu.
- **BLUE ONLY/MONO**
- **H/V Delay**
- **Pixel To Pixel**
Provides both full screen and unscaled native image.
- **DC Compatible**

The product is powered by a normal 12V source.

- **Additional Features**

Active loop-thru/SDI, 200:1 Contrast Ratio, 250 cd/m² Brightness, OSD user interface, Rack Mountable, Cooling Fan

Feature Name & Functions

<FRONT>

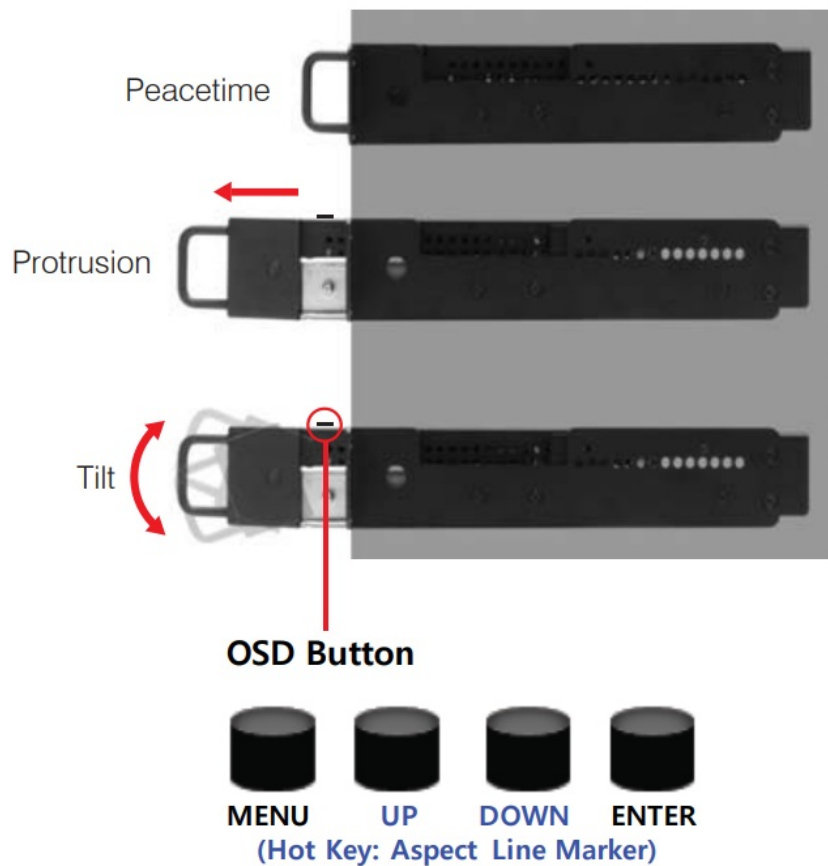

- [MENU] button
Used to activate the OSD Menu.
- [UP] button
Used to navigate menu during OSD Menu activation.
It may also be used to select Aspect Marker during OSD Menu non-activation.
- [DOWN] button
Used to navigate menu during OSD Menu activation.
It may also be used to select Aspect Marker during OSD Menu non-activation
- [ENTER] button
Used to confirm a chosen value (or mode) within the OSD Menu.

<REAR>

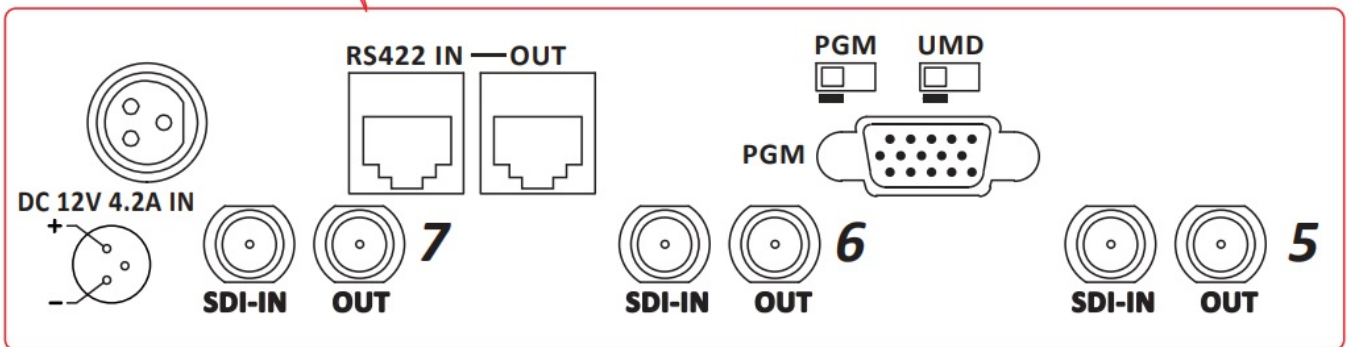

- SDI A-IN (BNC)

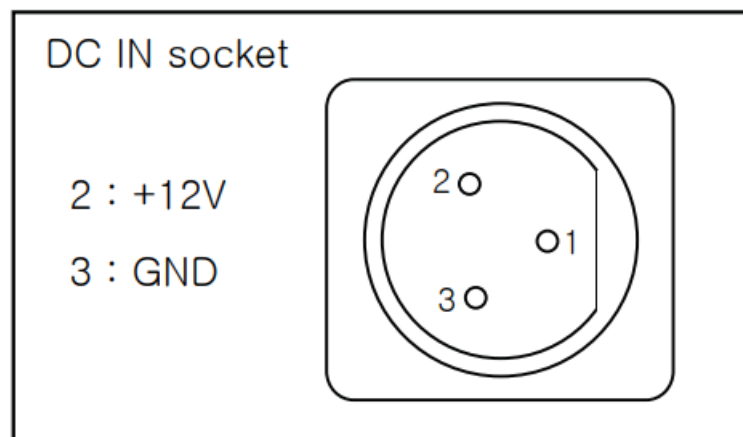

SDI A signal input terminal

- SDI-OUT (BNC)

SDI signal output terminal

- DC IN (3 pins)

Used to supply DC power; 12V

- RS422 IN/OUT (RJ45)

Pin 1	TX-
Pin 2	TX+
Pin 3	RX-
Pin 6	RX+
Pin 7, 8	Ground
Pin 4, 5	N.O

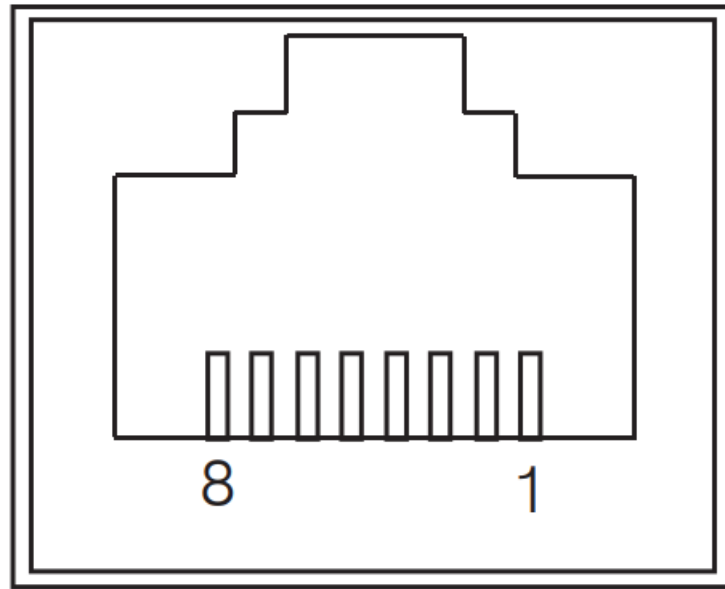

Used to display a dynamic UMD

- PGM SW(mini slide switch)
Used to download a program.
- UMD SW(mini slide switch)
Used to active a dynamic UMD

PGM SW

· F/W Download



· Control Set



UMD SW

· Dynamic UMD Off
& F/W Download



· Dynamic UMD On



OSD Menu Organization & Adjustment

[1] MAIN – Color

[1] MAIN - Color



- Color Temp (Default Setting – 6500K)
This item controls Color Temperature with presets of 3200K, 5600K, 6500K, 9300K, and User1, User2, and User3 mode.
- User
On User Mode, the user may select and control R, G, & B GAIN, or BIAS values by using the [UP]/[DOWN]/[ENTER] buttons.
- Color Copy (Default Setting – 6500K)
In User mode, user can copy the presets of 3200K, 5600K, 6500K, or 9300K to make the custom adjustment by using the [UP]/[DOWN]/[ENTER] buttons.

[2] MAIN – Marker

[2] MAIN - Marker



- Marker (Default Setting – On)

Used to show MARKER on the screen. The type of marker at work may be selected on the other menu.

-This function is not available in Pixel to Pixel and HV Delay modes.

- Line Marker (Default Setting – Off)

MODE	MARKER CLASS
HD / SD 16:9	16:9, 4:3, 4:3 ON AIR, 15:9, 14:9, 13:9, 1.85:1, 2.35:1, 1.85:1 & 4:3
SD 4:3	16:9

This selects the marker type when the MARKER is displayed on the screen. Compatible MARKER types are as follows:

- Center Marker (Default Setting – Off)

This item displays the CENTER MARKER on the screen.

- Safety Area (Default Setting – Off)

This item controls the size of the SAFETY AREA between 80%, 85%, 88%, 90%, 93%, and 100%.

-Line Marker, Center Marker, and Safety Area functions operate only after activating the MARKER function to the 'On' position in the Marker Menu.

[3] MAIN - System [page1]

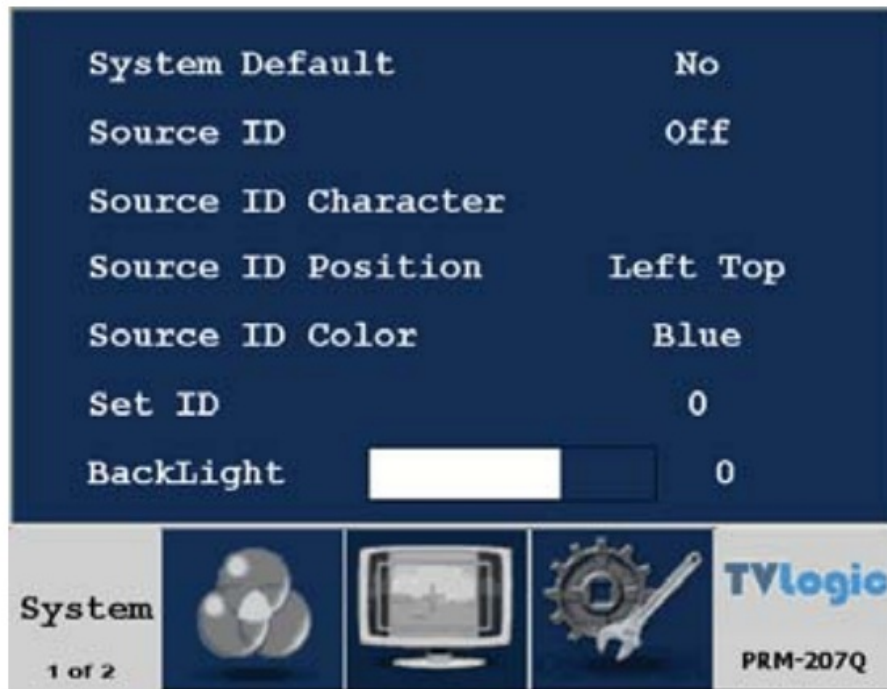

- **System Default (Default Setting – No)**
User can use the System Default Menu to initialize the values of the monitor.
- **Source ID (To make active, off the Marker function)**
This item is used to activate the Source ID display by selecting Manual(BG), Manual(Char), UMD(Small), UMD(Medium), or UMD(Large).
-This function is only available in same Set ID with UMD controller's.
- **Source ID Character**
This item is used to customize the Source ID display. (A~Z, a~z, 0~9, and special characters).
-This function is only available if the Source ID is selected on Manual.
- **Source ID Position (Default Setting – Left Top)**
This item controls the position of the Source ID display. (Top-Left, Top-Center, Top-Right, Bottom-Right, Bottom-Center, Bottom-Left)
-This function is only available if the Source ID is selected on Manual.
- **Source ID Color (Default Setting – Blue)** This item is used to change the color of Source ID display by selecting blue, white, red, green, black, or yellow.
- **Set ID (Default Setting – 0)** This item controls the Set ID settings for Dynamic UMD. The value should be within range between 0 and 126.
- **Back Light** This item controls the LED backlight setting. The value should be within ranges between MIN(0) and MAX(50).

[4] MAIN - System [page2]



- Blue & Mono
You may remove R(red) and G(green) from the input signal and show the image only with a B(blue) signal.
Menu may be set to 'Mono' to change the screen to MONO mode.
(This mode uses only the Luminance value)
- Scan
This item controls the transition from OVER SCAN mode to ZERO SCAN mode.
Mode changes in the order of Zero Scan -> Over Scan -> Pixel To Pixel -> Zero Scan.
-In Pixel To Pixel mode, the Marker Feature and Menu are disabled automatically.
-In Pixel To Pixel mode, pressing the Enter button rotates the position of display.
- Aspect Ratio
This item toggles aspect ratio in SD from standard to anamorphic.
-SD Signal only (Disables automatically in any other signal including No signal)
- HV Delay
This item activates the HV Delay mode.
-In HV Delay mode, Marker Feature and Menu are disabled automatically.
- Firmware Version
This item is the firmware version of the system.
- License
Licensed by Postium Korea.

Other Functions

[1] Line Marker

- A line marker which is enabled by default, displays aspect lines with the input signal.
- To display the [Line Marker] mode, use the [UP]/[DOWN] buttons to select aspect lines as below.

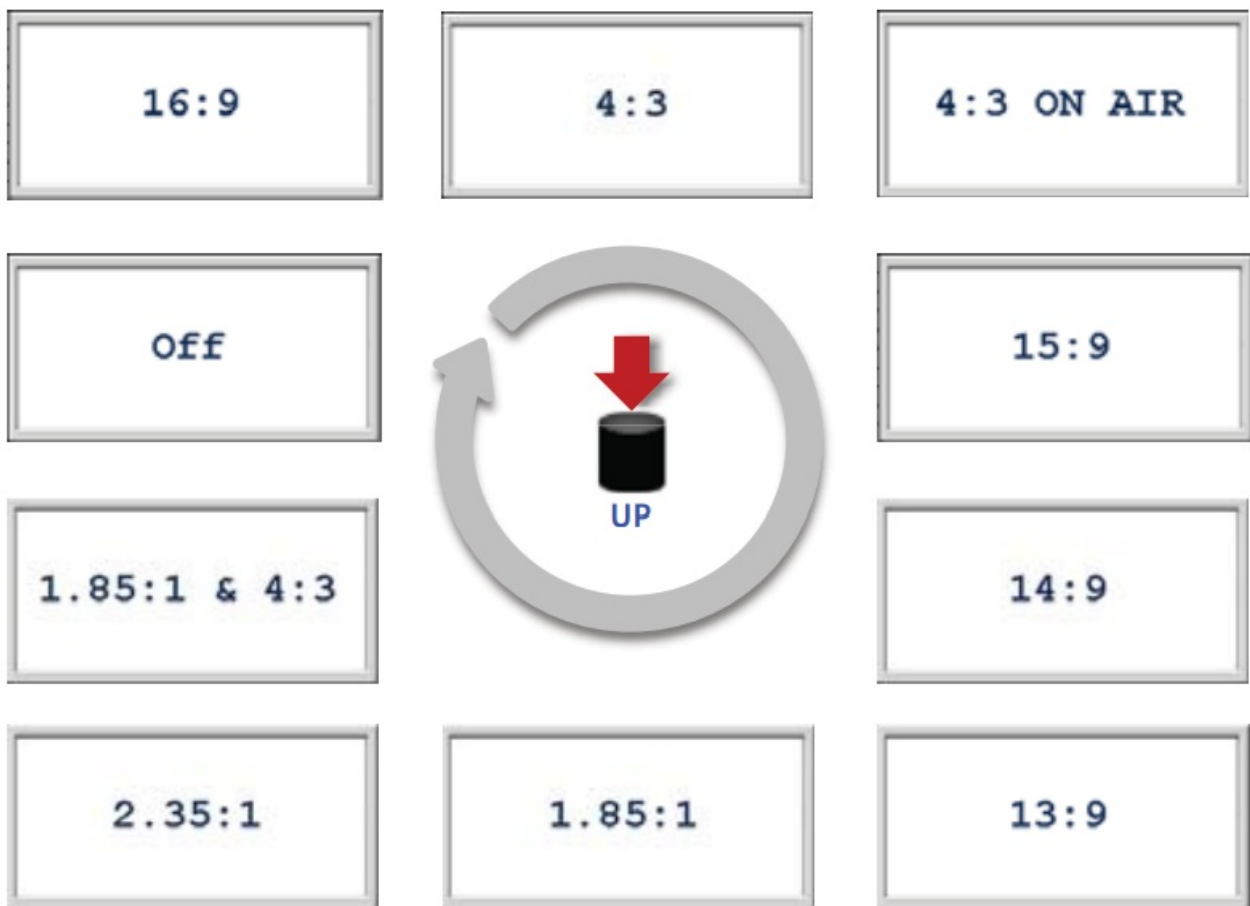

[2] PIXEL TO PIXEL

- Pixel to Pixel mode in PRM-207Q monitor displays the input signal without scaling the image
- To activate the [Pixel to Pixel] mode, access the Scan Menu in System Menu and select [Pixel to Pixel].
- In the [Pixel To Pixel] mode, use the [UP]/[DOWN] buttons to toggle between 1:1 scan sections.

Input	Action Button	Available Modes
HD 1080i / 1080p	[UP] (Clockwise)	Center -> Left-Top -> Mid-Top -> Right-Top -> Right-Mid -> Right- Bottom -> Mid-Bottom -> Left-Bottom -> Left-Mid -> Center -> ...
	[DOWN] (Opposite)	Center -> Left-Mid -> Left-Bottom -> Mid-Bottom -> Right-Bottom -> Right-Mid -> Right-Top -> Mid-Top -> Left-Top -> Center -> ...

- OSD change

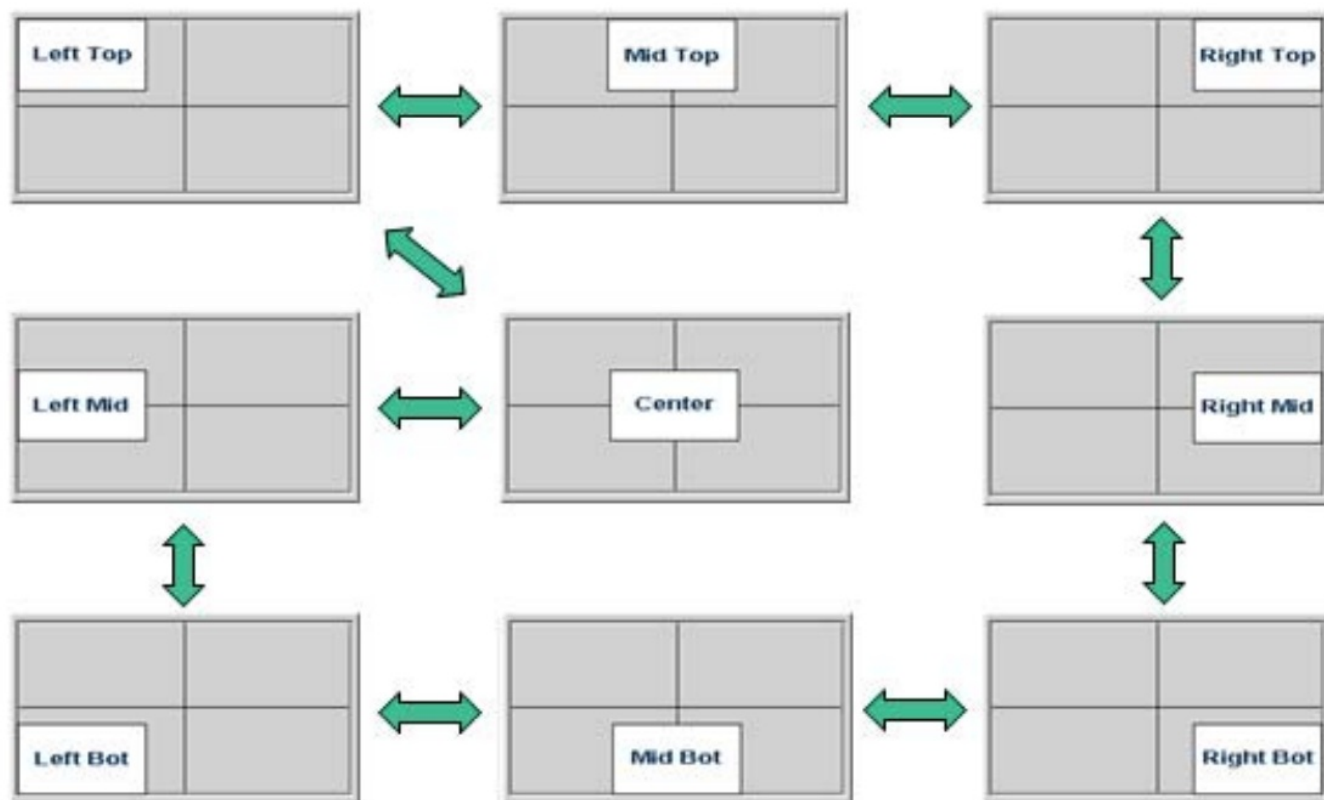

Input	Action Button	Available Modes
HD 720p	[UP] (Clockwise)	Center -> Left-Top -> Right-Top -> Right-Bottom -> Left-Bottom -> Center -> ...
	[DOWN] (Opposite)	Center -> Left-Bottom -> Right-Bottom -> Right-Top -> Left-Top -> Center -> ...

- OSD change

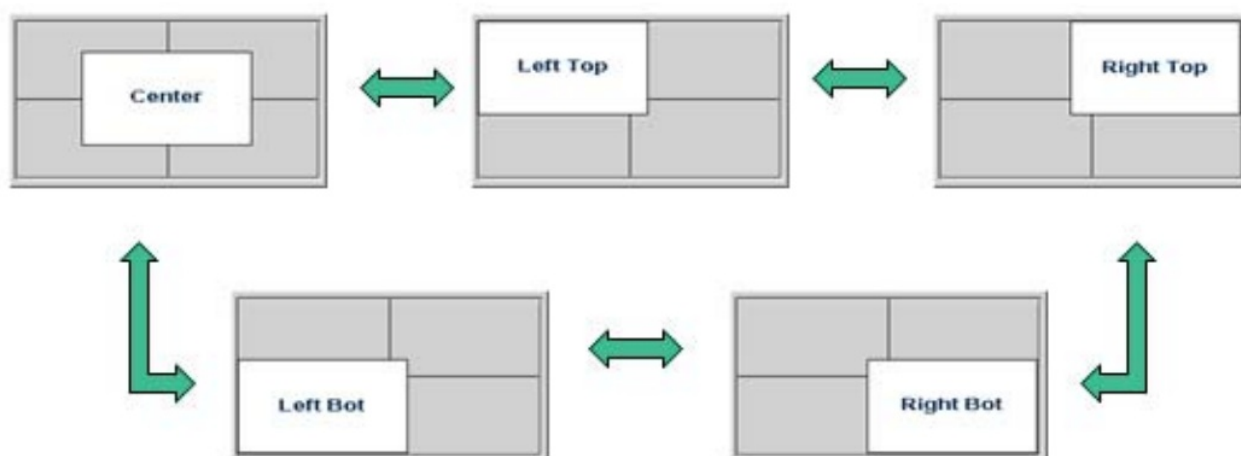



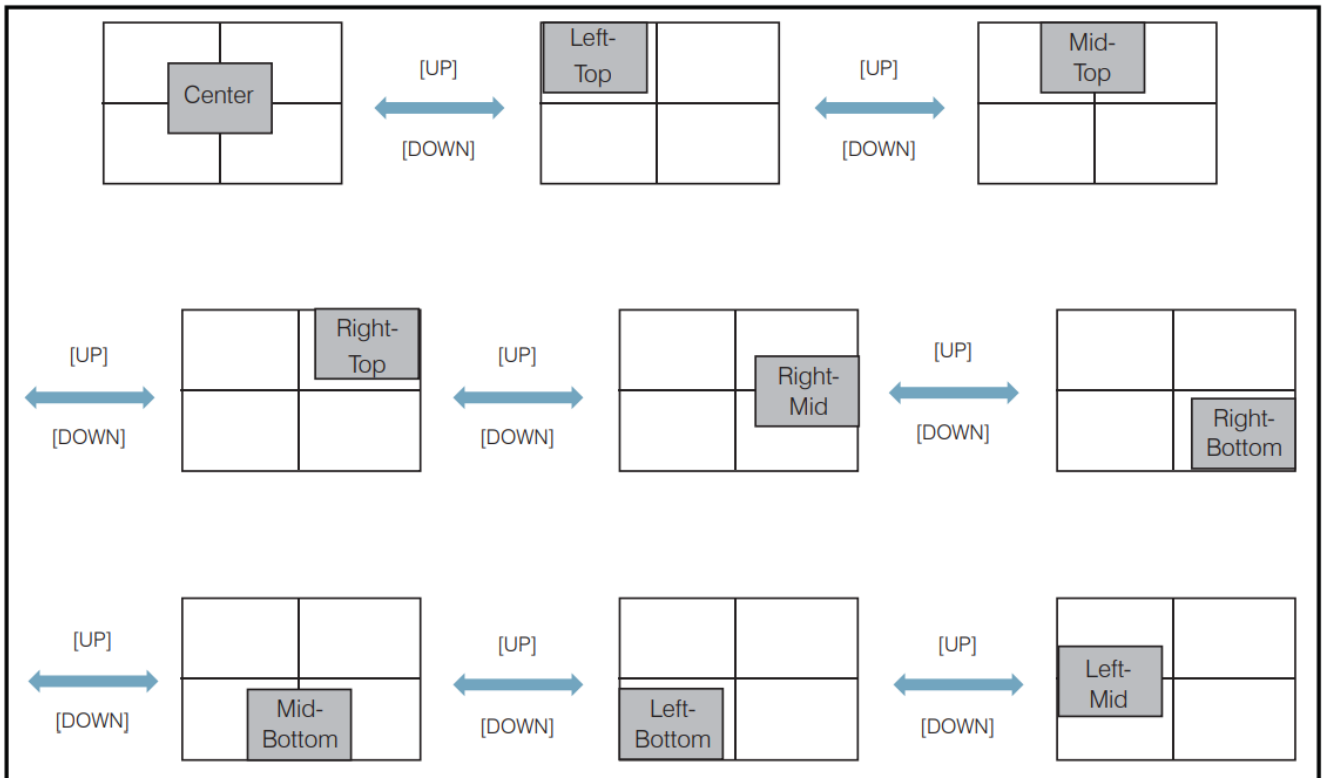

- Pixel To Pixel mode is not available in Graphic mode.
- Pixel To Pixel mode is available in SD mode, but 1:1 sections cannot be rotated through as with HD sources.
- Positions in HD Signal 1080i/1080p mode

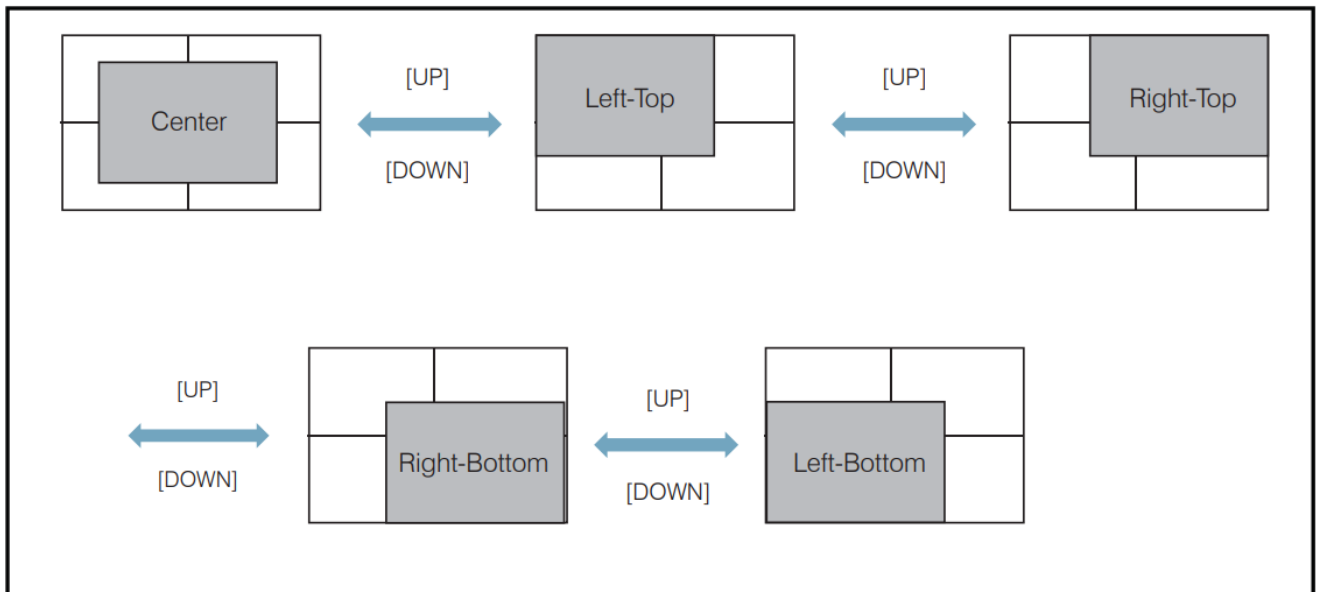

- Position in HD Signal 720p mode

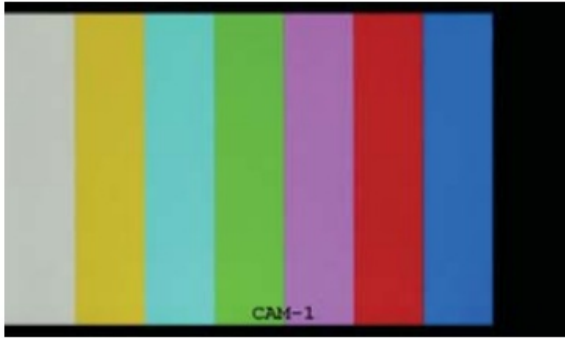

[3] Source ID

Manual (BG)	Manual (Char)
	
UMD (Small)	UMD (Medium)
	
UMD (Large)	UMD Usage Example
	

- Source ID Position (Manual Only)

· Source ID Position (Manual Only)

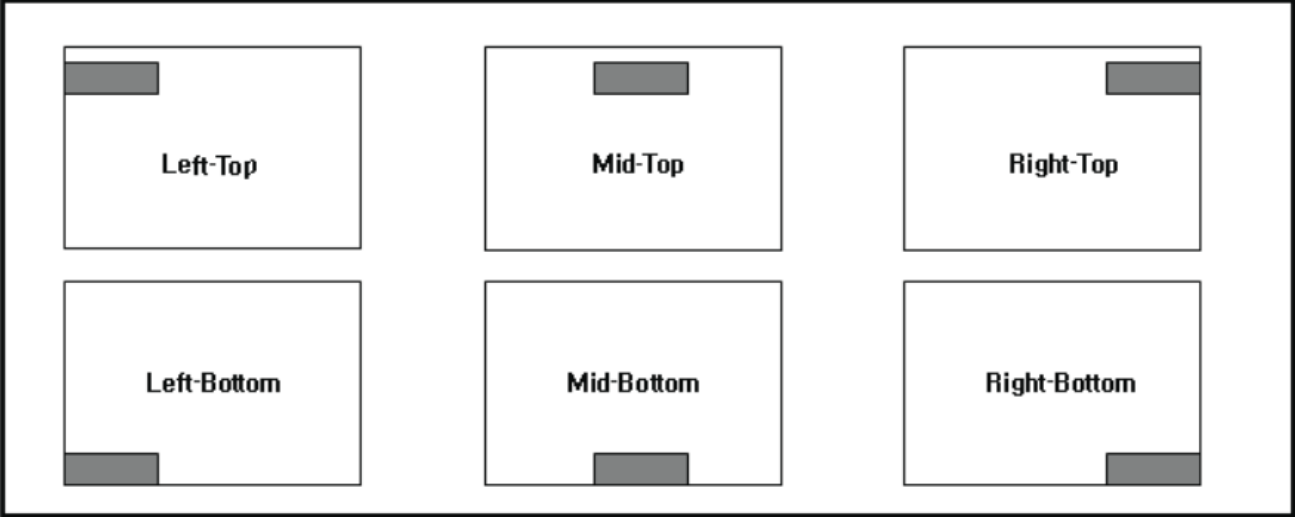

· Source ID Color

Blue	White	Red	Green	Black	Yellow
CAM-1	CAM-1	CAM-1	CAM-1	CAM-1	CAM-1

System Default Value

MENU		VALUE
Color	Color Temp	6500K
	Gain RED (1/2/3)	0
	Gain GREEN (1/2/3)	0
	Gain BLUE (1/2/3)	0
	Bias RED (1/2/3)	0
	Bias GREEN (1/2/3)	0
	Bias BLUE (1/2/3)	0
	Color Copy	6500K
Marker	Marker	On
	Line Marker	Off
	Center Marker	Off
	Safety Area	Off
System [Page1]	System Default	No
	Source ID	Off
	Source ID Character	C A M – 1
	Source ID Position	Left Top
	Source ID Color	Blue
	Set ID	0
	Back Light	different for each set
System [Page2]	Blue & Mono	Off
	Scan	Zero Scan
	Aspect Ratio	16:9
	HV Delay	Off

Product Specification

Input (1 Screen)*	1 x BNC	SDI 2 Channel Input
Output (1 Screen)*	1 x BNC	SDI Output (Active Through Out)
Input Signal*	HD-SDI	1.458Gbps
	SD-SDI	270Mbps
SDI Input Signal Formats*	SMPTE-274M	1080i (60/59.94/50)
		1080p (30/29.97/25/24/24sF/23.98/23.98sF)
	SMPTE-296M	720p (23.98/24/25/29.97/30/50/59.94/60)
	SMPTE-260M	1035i (60/59.94)
	SMPTE-125M	480i (59.94)
	ITU-R BT.656	576i (50)
	2K Format	2048 x 1080 (23.98psf/24psf/23.98psf/24p)
LCD*	Size	2 Inch
	Resolution	960 x 540 (16:9)
	Pixel Pitch	0.0465(H) x 0.0465(V)mm
	Color	16.7M(true), 24bit
	Viewing Angle	H : 100 degrees
		V : 100 degrees
	Luminance of White	250 cd/m ² (Center)
	Contrast	200:1
	Display Area	44.64 (H) x 25.11 (V)mm
Power		12V DC/Max4.2A
Power Consumption (Approx.)		50.4 Watts(DC)
Operating Temperature		-5°C to 40°C (32°F to 104°F)
Storage Temperature		-30°C to 50°C (-22°F to 122°F)
Main Body Dimensions (mm/inch)		445(W) x 225(L) x 44.8(H) mm
Weight		4kg, 8.8083 lb (net without AC/DC Adaptor)
Accssory		DC Power Adapter
Option		19" Rack Mountable Kit (1U)

· All specifications are subject to change without notice.

* Specification is for (1) screen out of 7 display screens.

Postium Korea
Postium Bldg. 2F, 433-34 Kalhyun-Dong,
Eunpyoung-Gu, Seoul, 122-811, Korea
Tel : +82-2-354-6055

Documents / Resources

 A black LCD rack monitor with a silver bezel and a red Postium logo at the bottom.	<p>postium PRM-207Q LCD Rack Monitor [pdf] User Manual PRM-207Q, PRM-207Q LCD Rack Monitor, LCD Rack Monitor, Rack Monitor, Monitor</p>
--	---

References

- [postium | Broadcast Monitors](#)
- [User Manual](#)