

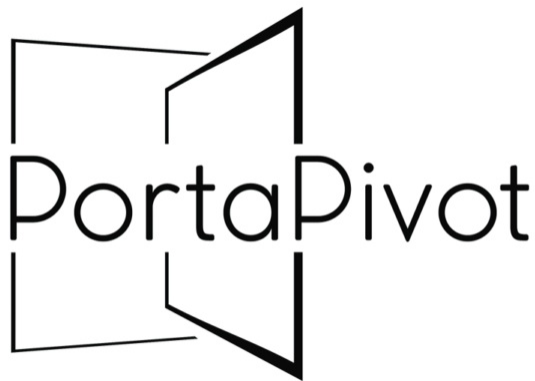

## PortaPivot V2-NL Self-Closing Pivot Hinge Systems Installation Guide

[Home](#) » [PortaPivot](#) » PortaPivot V2-NL Self-Closing Pivot Hinge Systems Installation Guide 



STEALTH PIVOT NL – QUICKSTART GUIDE

## Contents

- 1 STEALTH PIVOT NL SET
- 2 OPTIONAL STEALTHPIVOT NL ACCESSORY SET
- 3 OPTIONAL STEALTHPIVOT INSTALLATION TOOL
- 4 STEALTHPIVOT NL CAVITY DIMENSIONS (mm)
- 5 STEALTHPIVOT NL DIMENSIONS (mm)
- 6 XIS POSITIONS (X)
- 7 ADVISED JOINT DIMENSIONS
- 8 INTEGRATION OPTIONS
- 9 S90 – 90° STOP ACCESSORY
- 10 DRILL PIVOT MOUNT HOLES
- 11 SYNCHRONIZE PIVOT AXIS HEIGHT IN DOORWAY
- 12 HINGE HEIGHT ADJUSTMENT OPTIONS
- 13 INSTALL ASSEMBLED DOOR
- 14 ADJUST PIVOT AXIS POSITION
- 15 0° POSITIONING ADJUSTMENTS
- 16 MINIMIZE VISIBLE COMPONENTS
- 17 INTERCHANGEABLE GAS DAMPERS
- 18 OPTIONAL 0° POSITIONING ACCESSORIES
- 19 Documents / Resources
  - 19.1 References
- 20 Related Posts

## STEALTH PIVOT NL SET

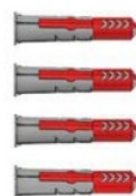
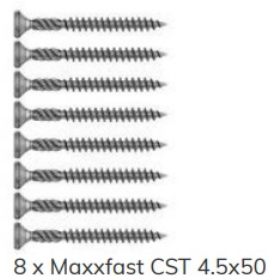
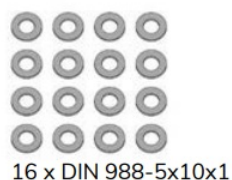

**OPTIONAL STEALTHPIVOT NL ACCESSORY SET**

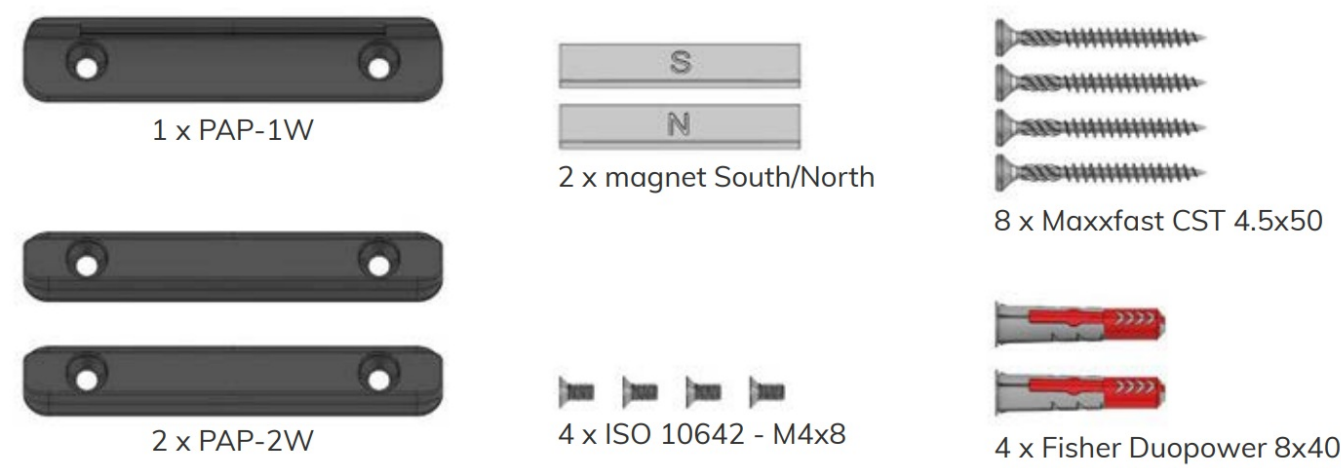

**OPTIONAL STEALTHPIVOT INSTALLATION TOOL**

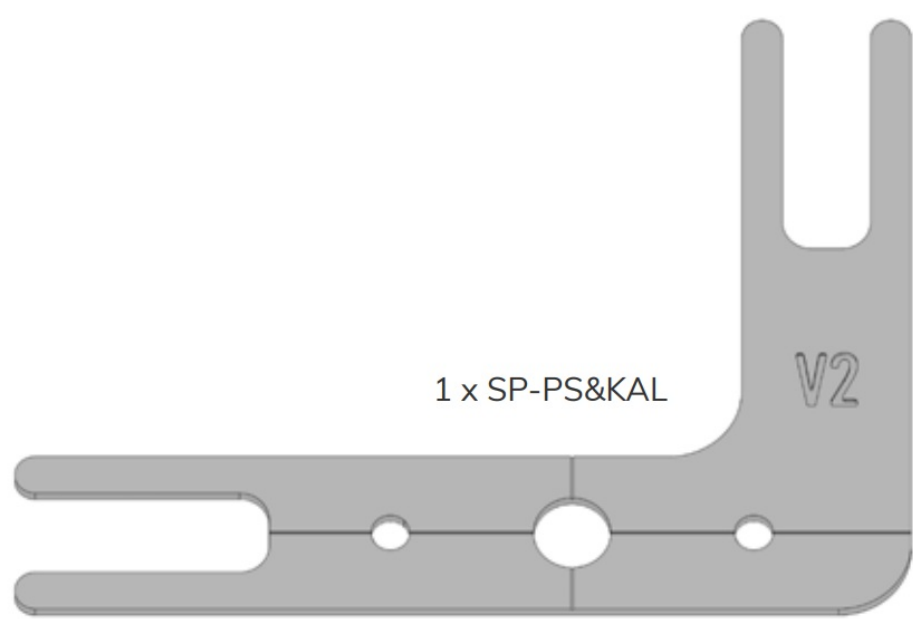

**STEALTHPIVOT NL CAVITY DIMENSIONS (mm)**

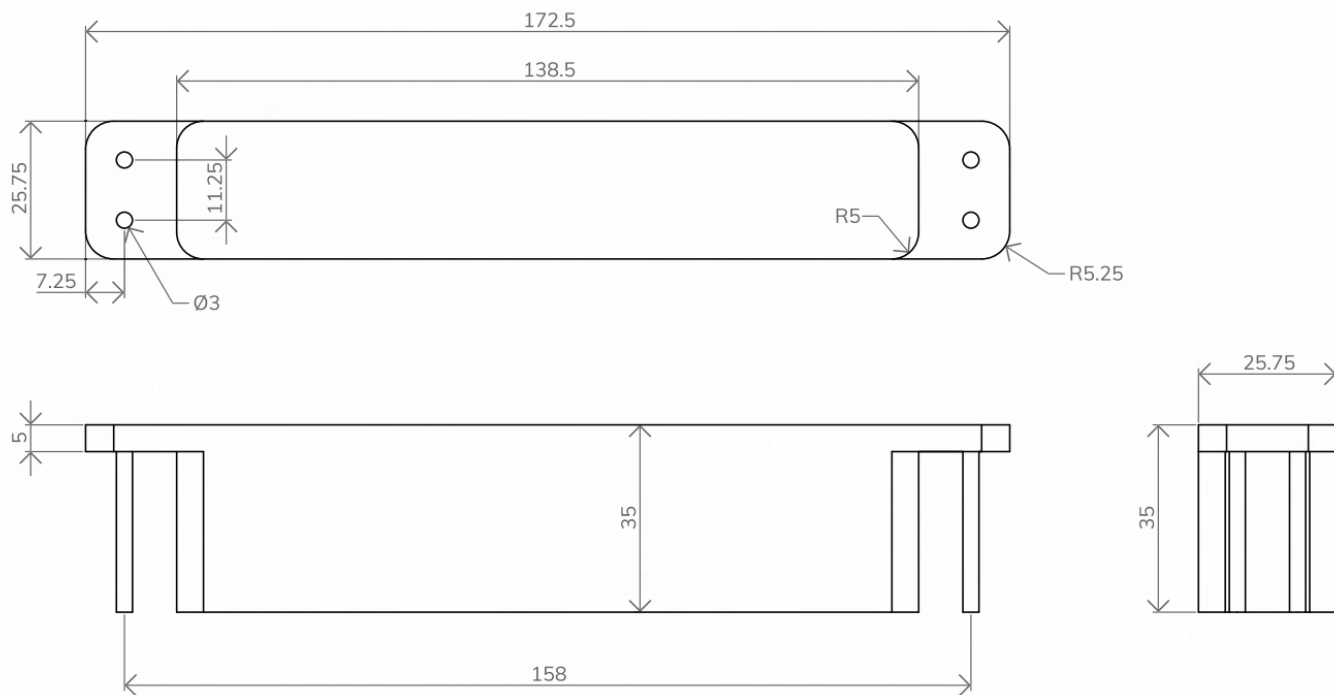

STEALTHPIVOT NL DIMENSIONS (mm)

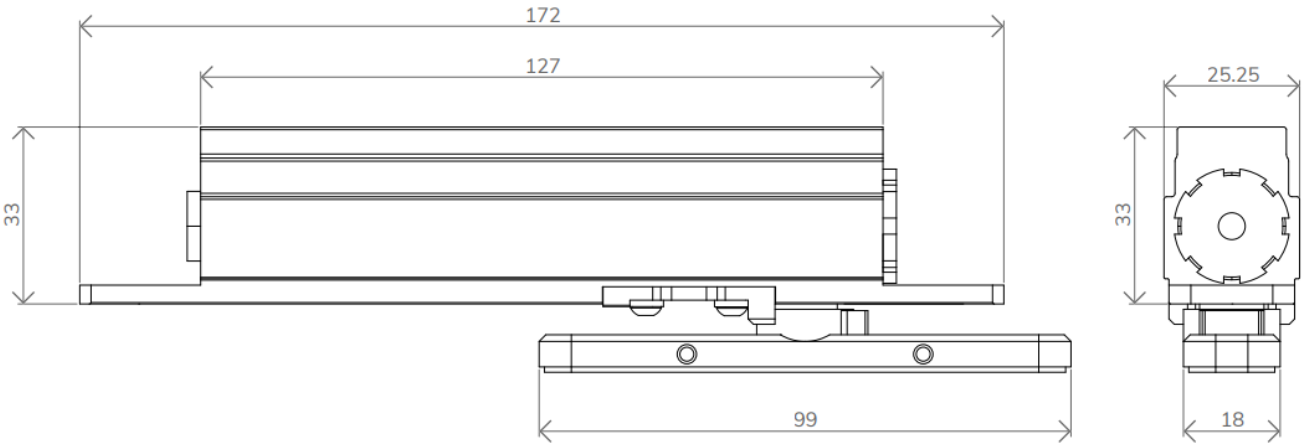
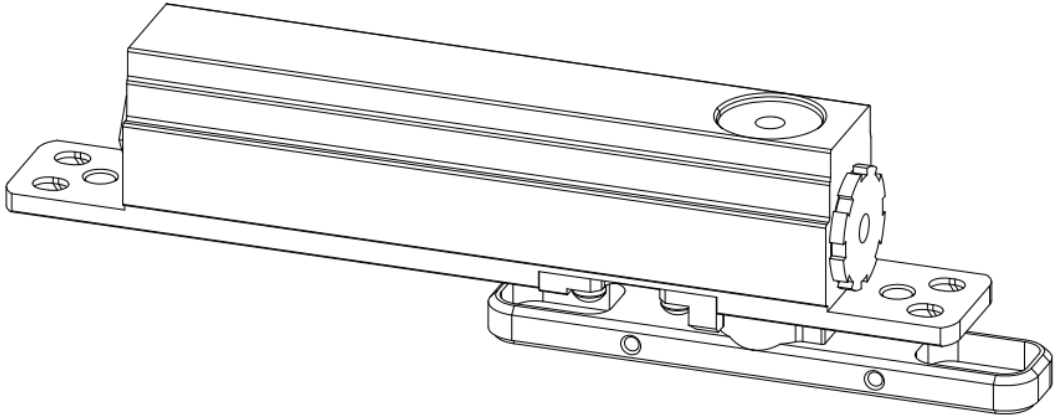

## XIS POSITIONS (X)

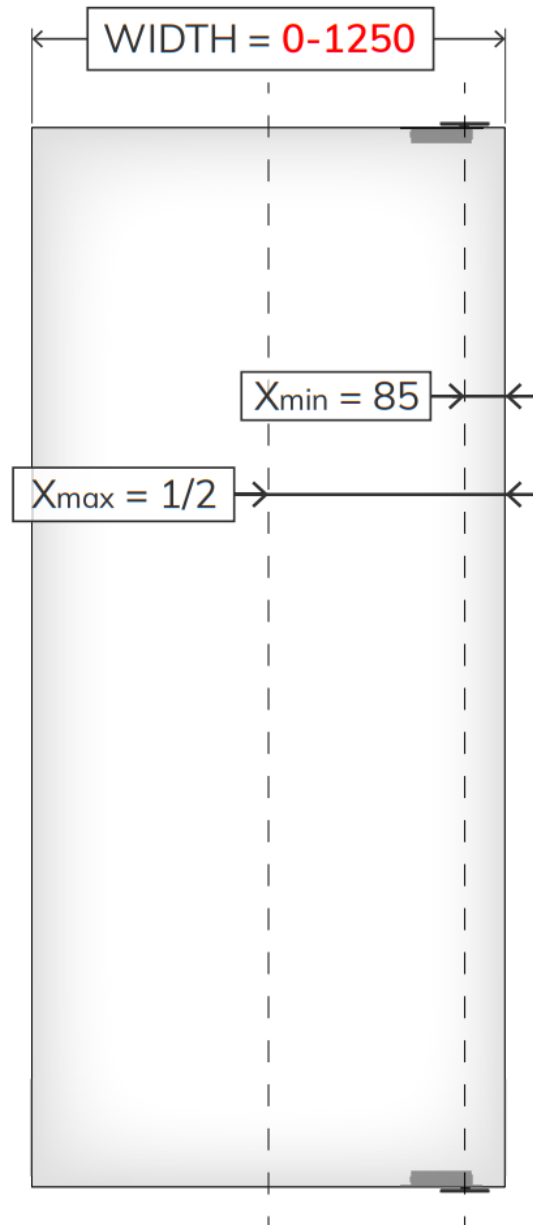

Max. width = 1250 mm

Max. weight = 75 kg (165 lbs)

Axis position (X) = 85 mm up to 1/2

## ADVISED JOINT DIMENSIONS

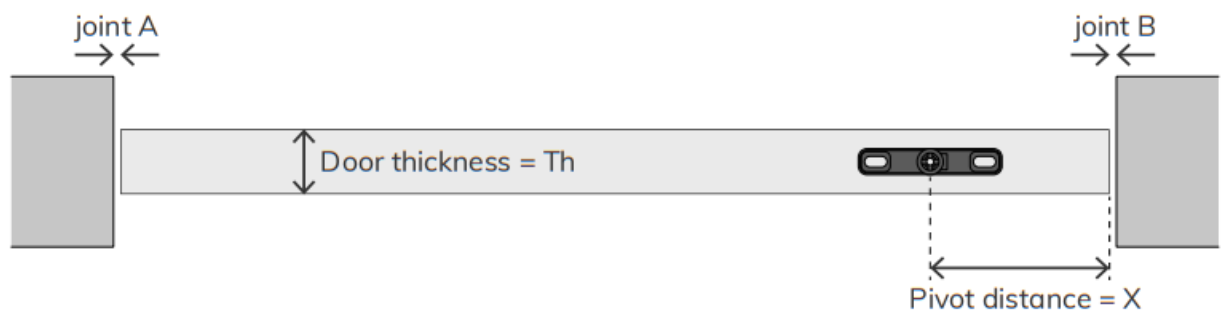
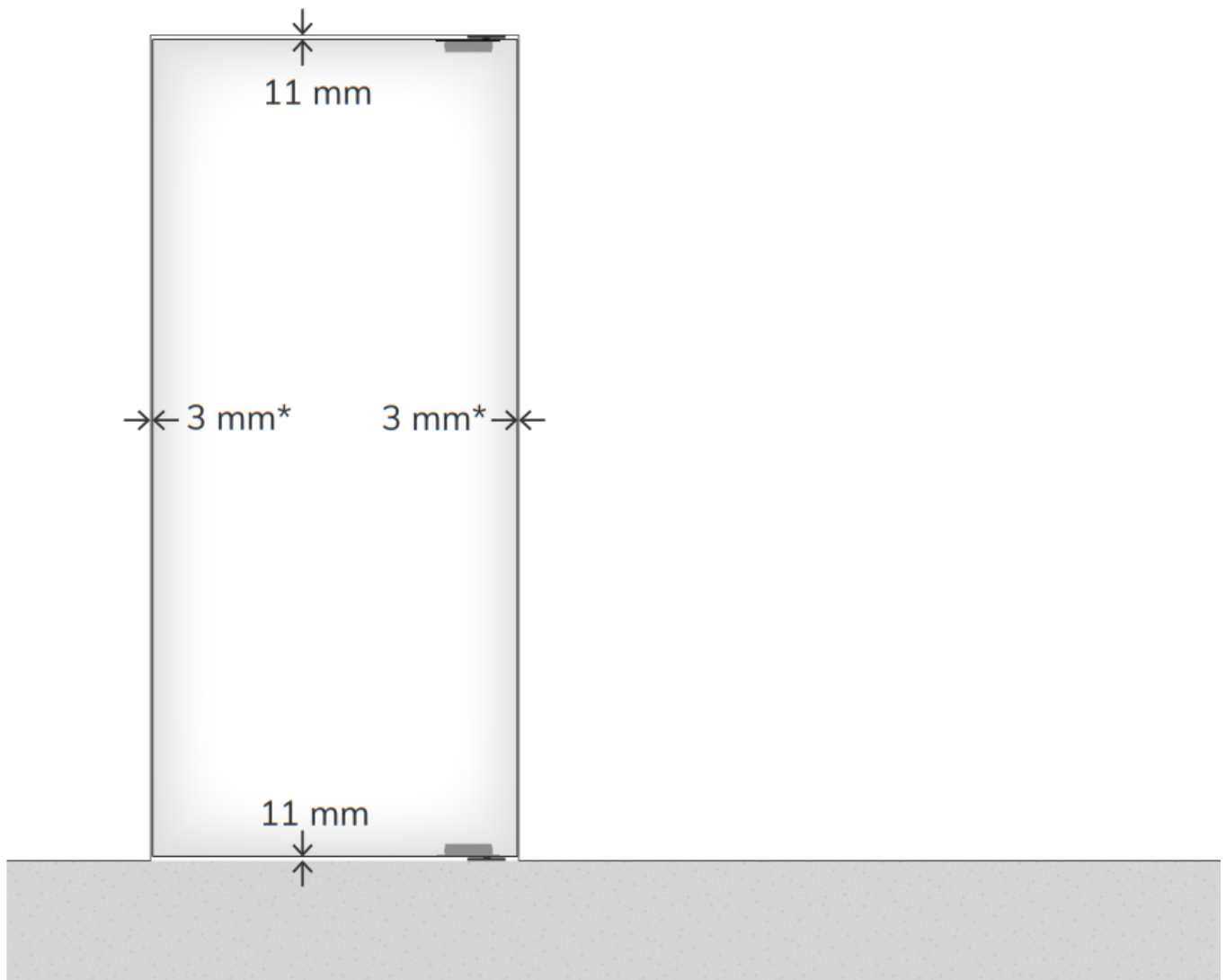

**Top & bottom joints: min. 11 mm**

**\*Left & right joints:**

The minimum joint depends on the door thickness and pivot distance.

For visual coherence, we advise using equal joints left and right. See the visual and table below for advised left and right joint dimensions.

X		joint A & B		
1000	2	2	2	3
500	2	2	3	3
250	3	3	3	4
85	3	4	5	7
Th	30	40	50	60

INTEGRATION OPTIONS

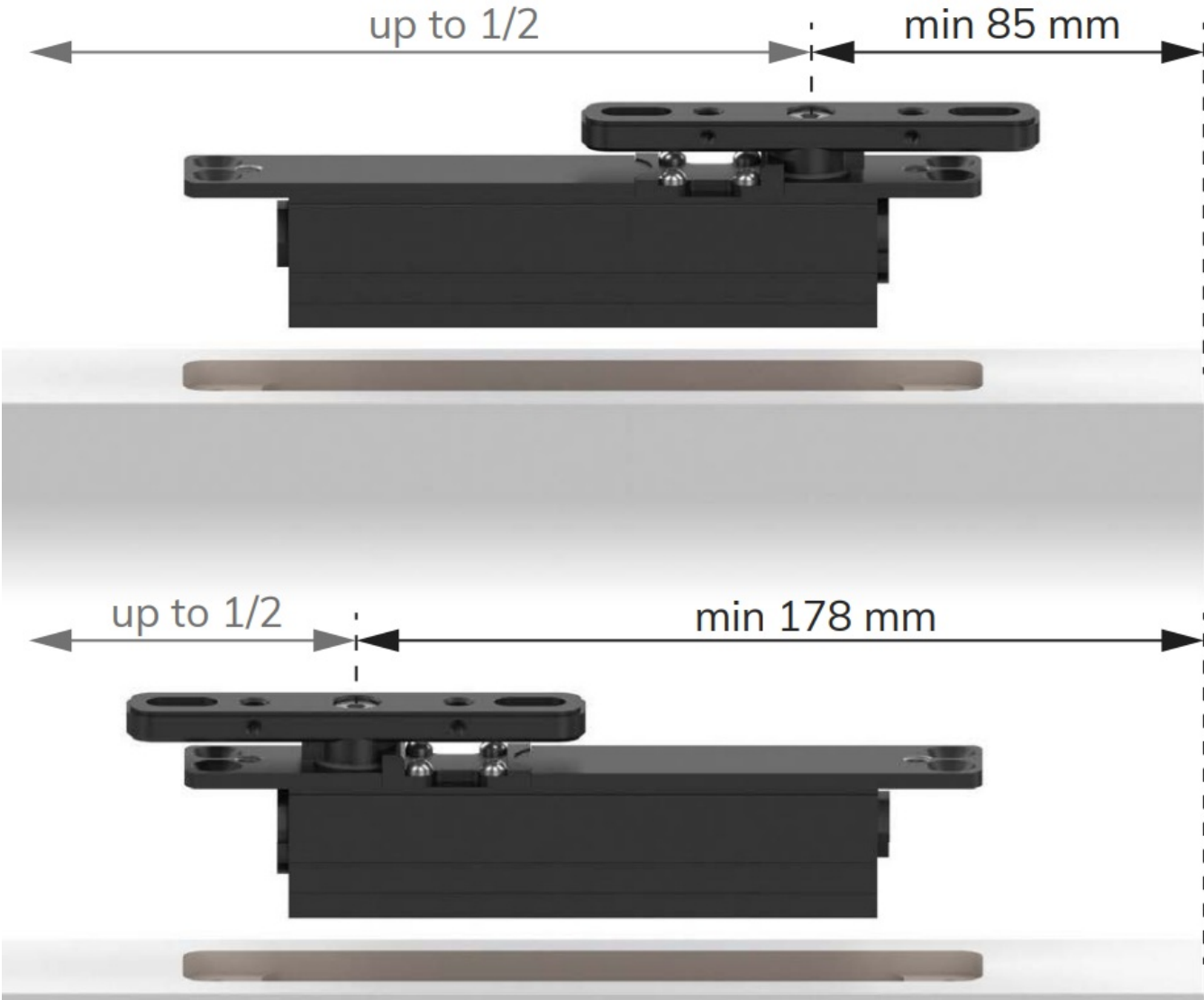



S90 – 90° STOP ACCESSORY

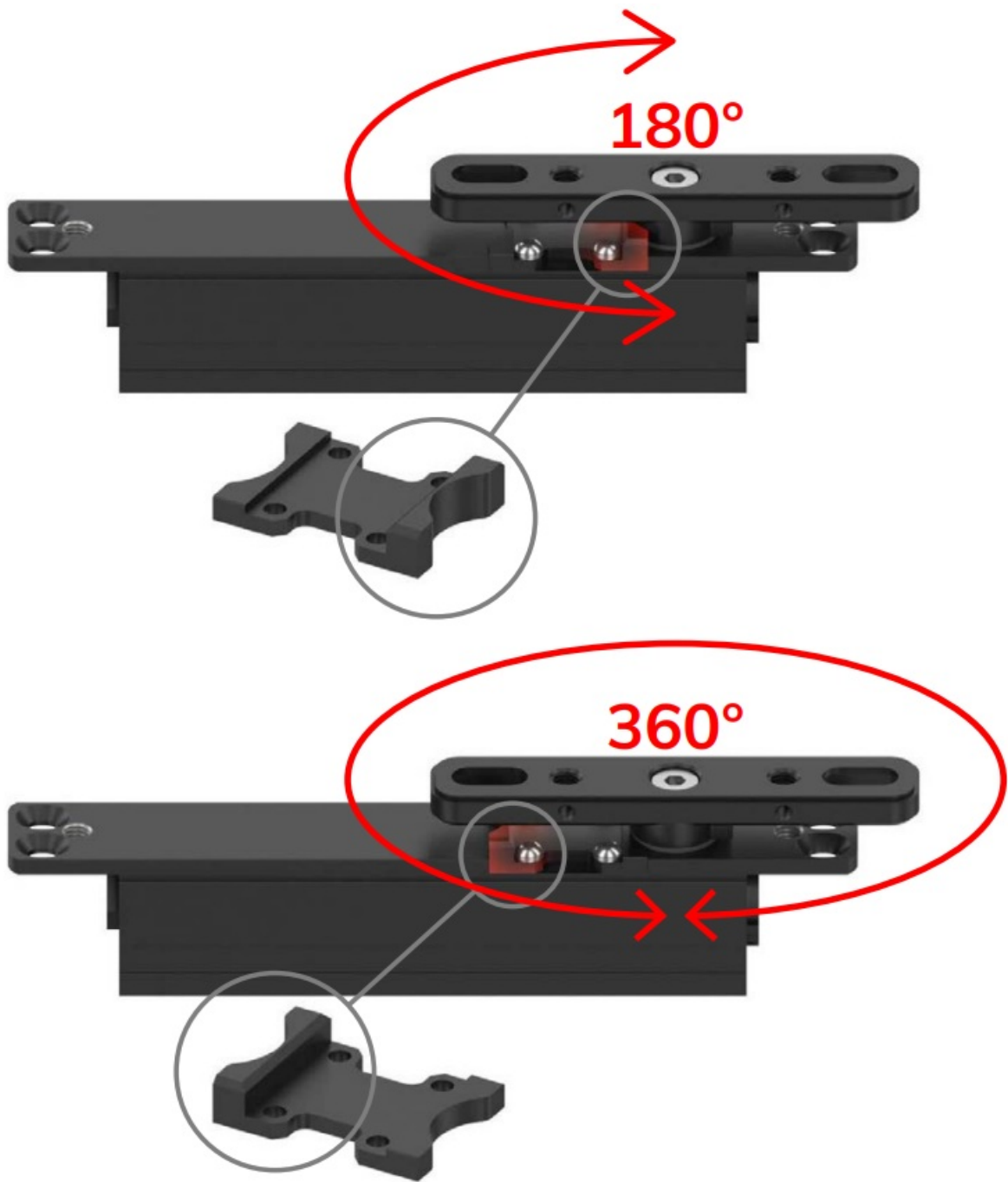

## DRILL PIVOT MOUNT HOLES

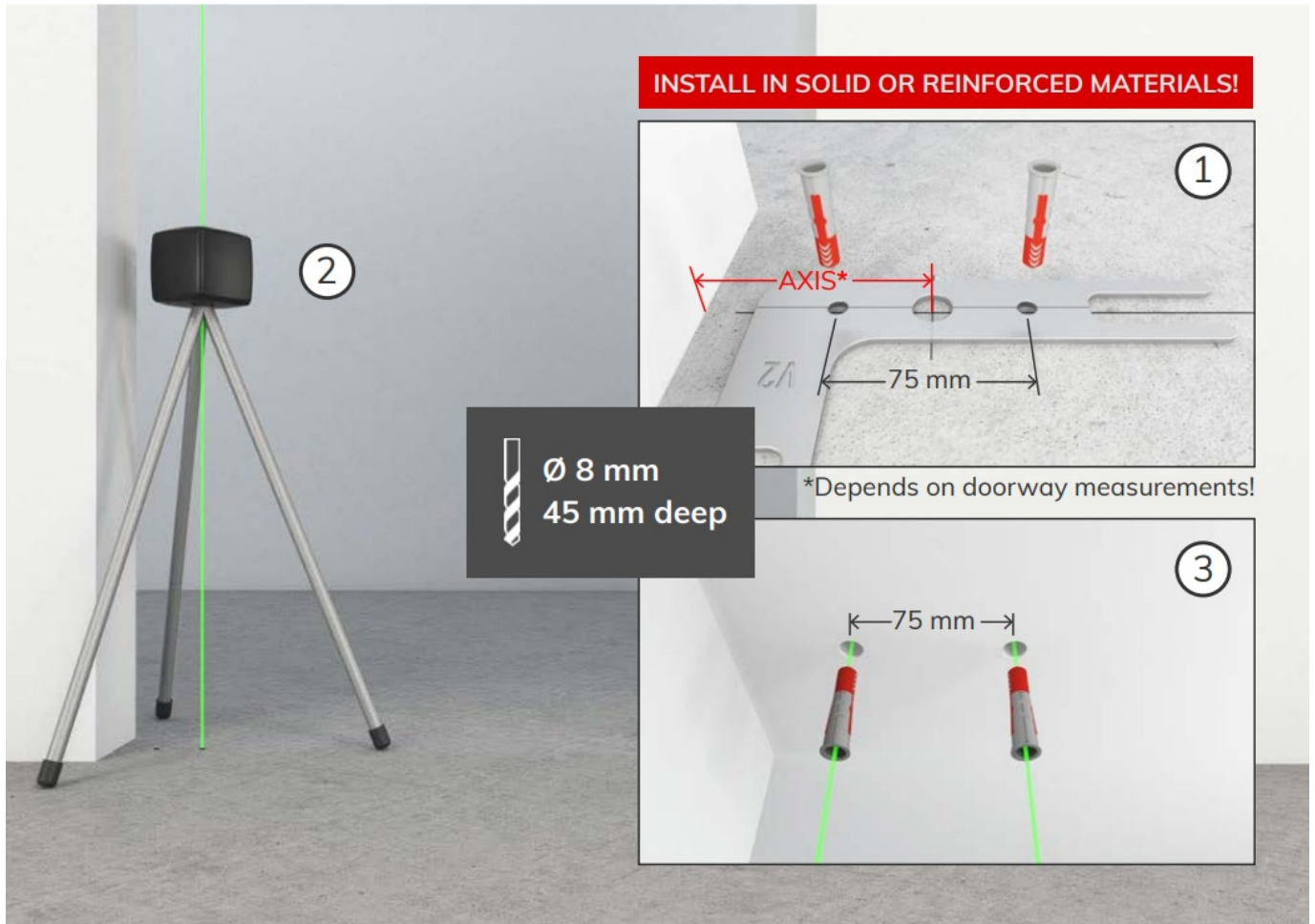

## SYNCHRONIZE PIVOT AXIS HEIGHT IN DOORWAY

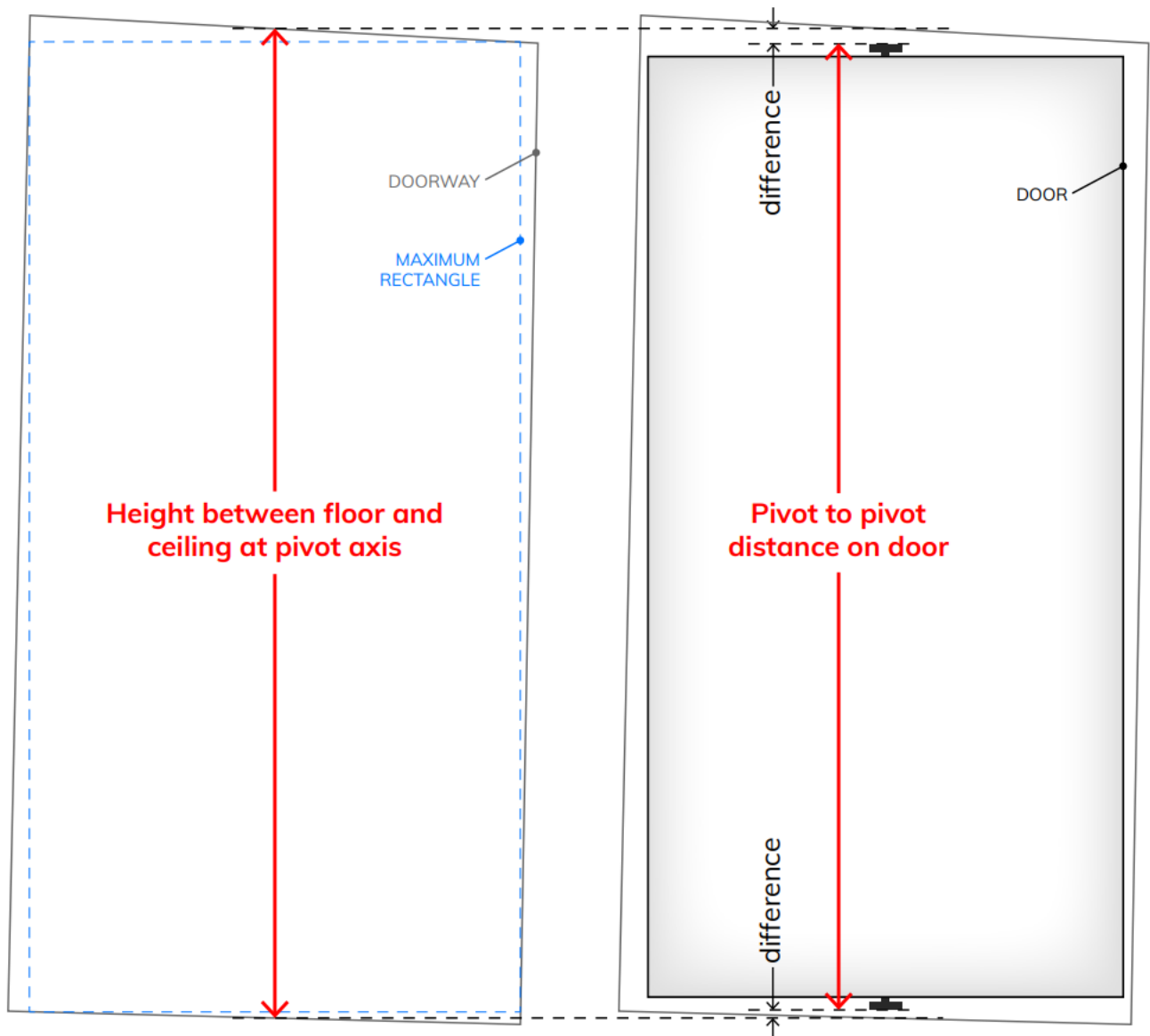

Compare the measured doorway height at the pivot axis with the pivot to pivot distance of the door. Synchronize them if necessary by using one of the hinge height adjustment options on the next page.

## HINGE HEIGHT ADJUSTMENT OPTIONS



1. Shims between hinge and door For TOP or BOTTOM joint adjustment = preferred method for the bottom hinge



2. Shims between the hinge and floor/ceiling For TOP or BOTTOM joint adjustment = faster but less stable method



3. Indus screws Only for TOP joint adjustment and noncompressible door structures!

## INSTALL ASSEMBLED DOOR



1. Put both pivots in their 'closed' position.

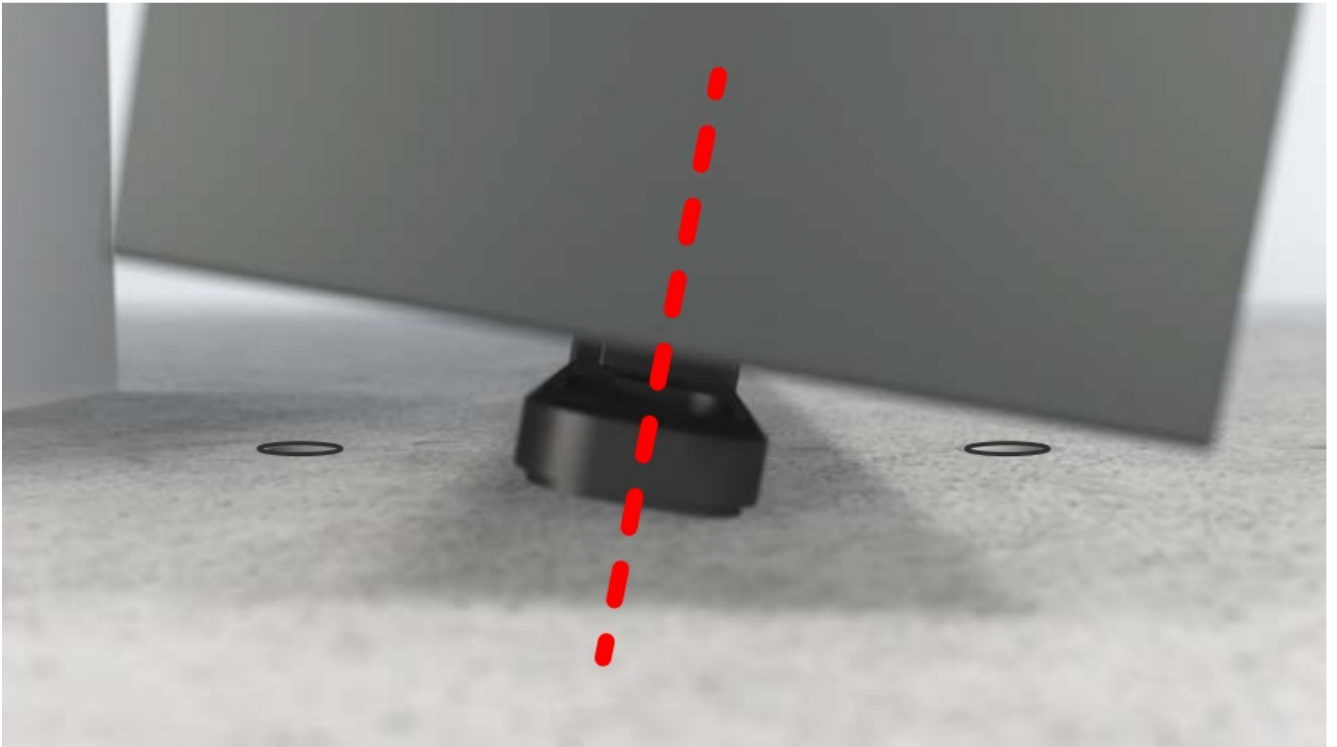

2. Place the assembled door in the doorway, with the pivot axis in between the 2 pivot mounting holes.



3. Tilt the door upright and keep it in place.

Always rotate the pivot mount in the closing direction of the door! If not, the door will be blocked in its opened position.



4. Use the drill tool to rotate the pivot mount in place. Repeat for the bottom pivot mount.



5. Install the octagonal inserts at 'position 1' in the top mount, then insert screws but do not fully tighten yet. Repeat for the bottom mount.

### ADJUST PIVOT AXIS POSITION

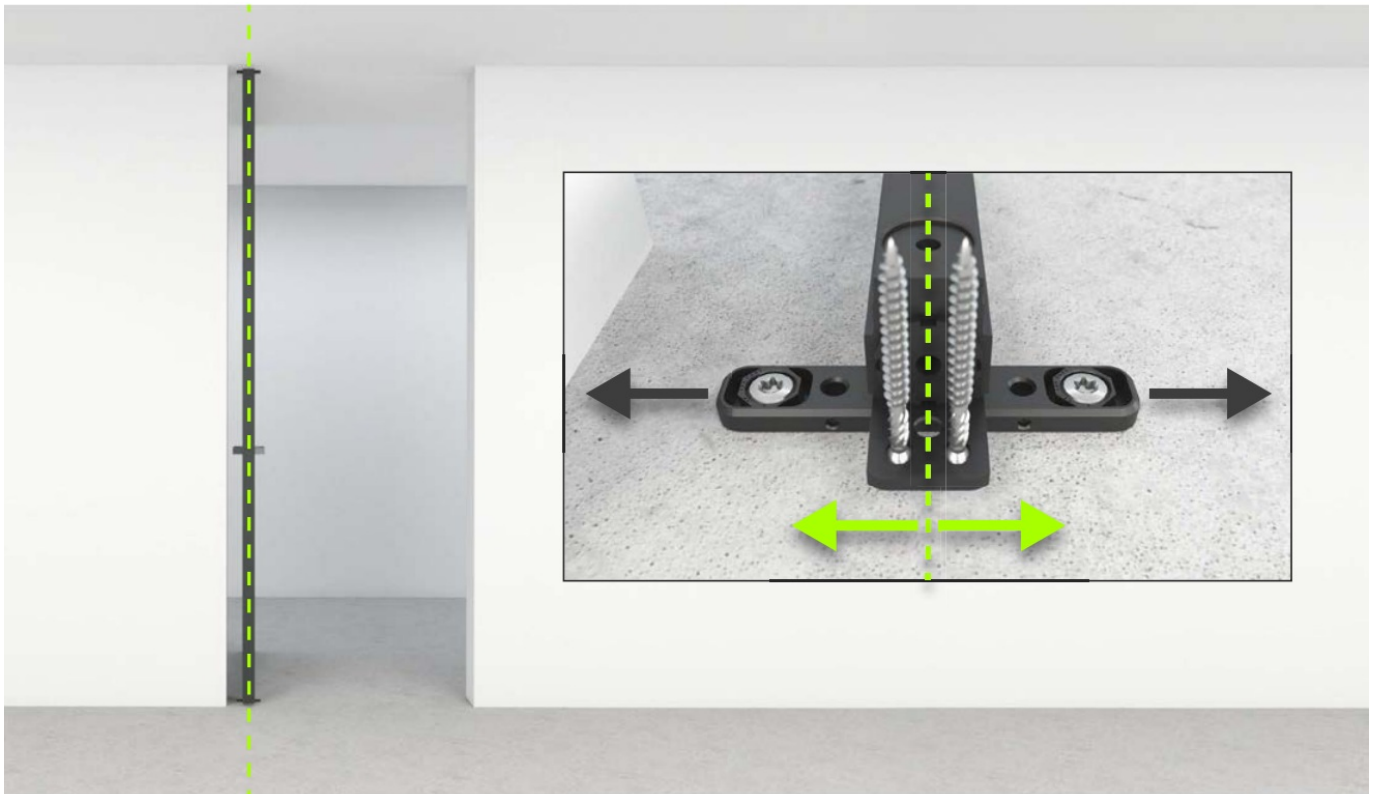



## 0° POSITIONING ADJUSTMENTS

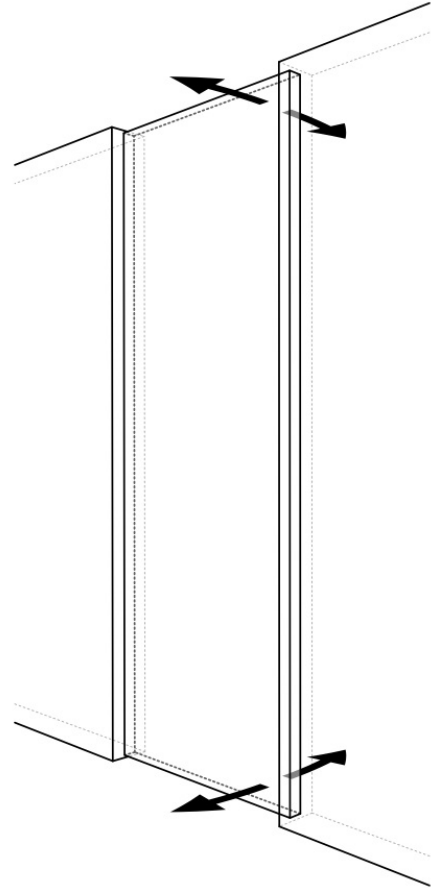

The inserts are excentric, so each position will affect the centerline angle of the door leaf.  
The view below shows the effect on the centerline angle when rotating the inserts to different positions.

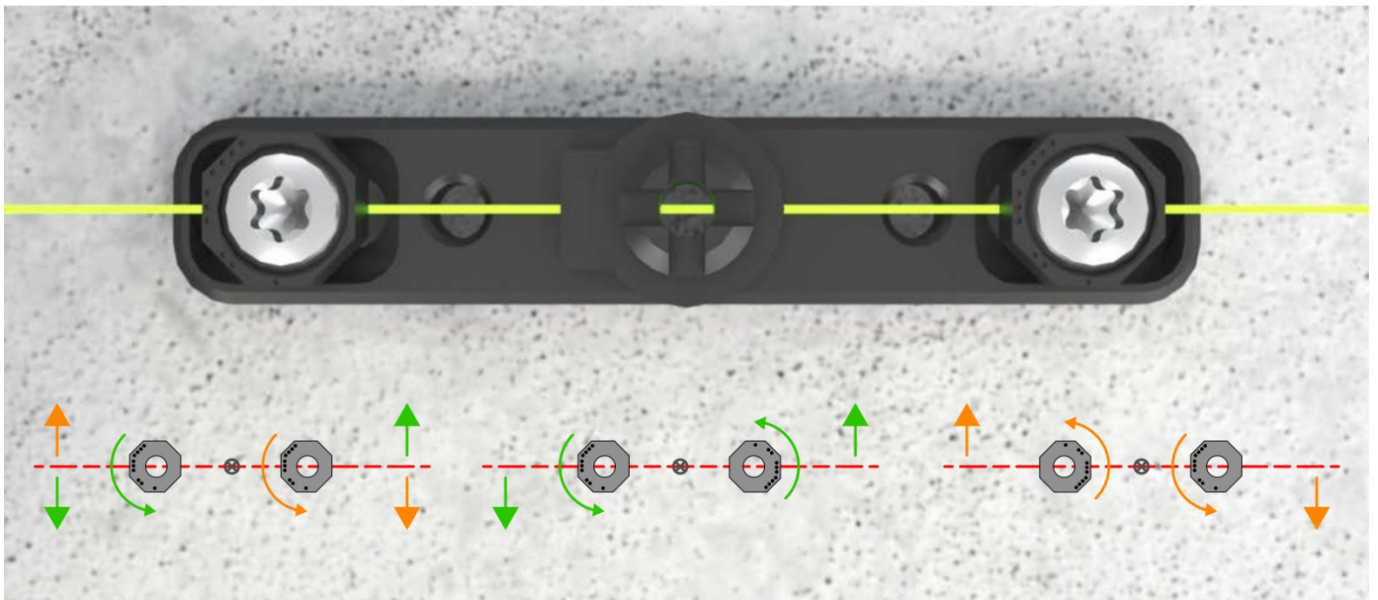



## MINIMIZE VISIBLE COMPONENTS



Slide the 3D printed covers over the base of the hinge to cover up the screws and hexagonal inserts.

## INTERCHANGEABLE GAS DAMPERS



Stealth pivot NL and XL are equipped with 480N gas dampers which can easily be replaced. Optional 750N dampers are also available.

## OPTIONAL 0° POSITIONING ACCESSORIES

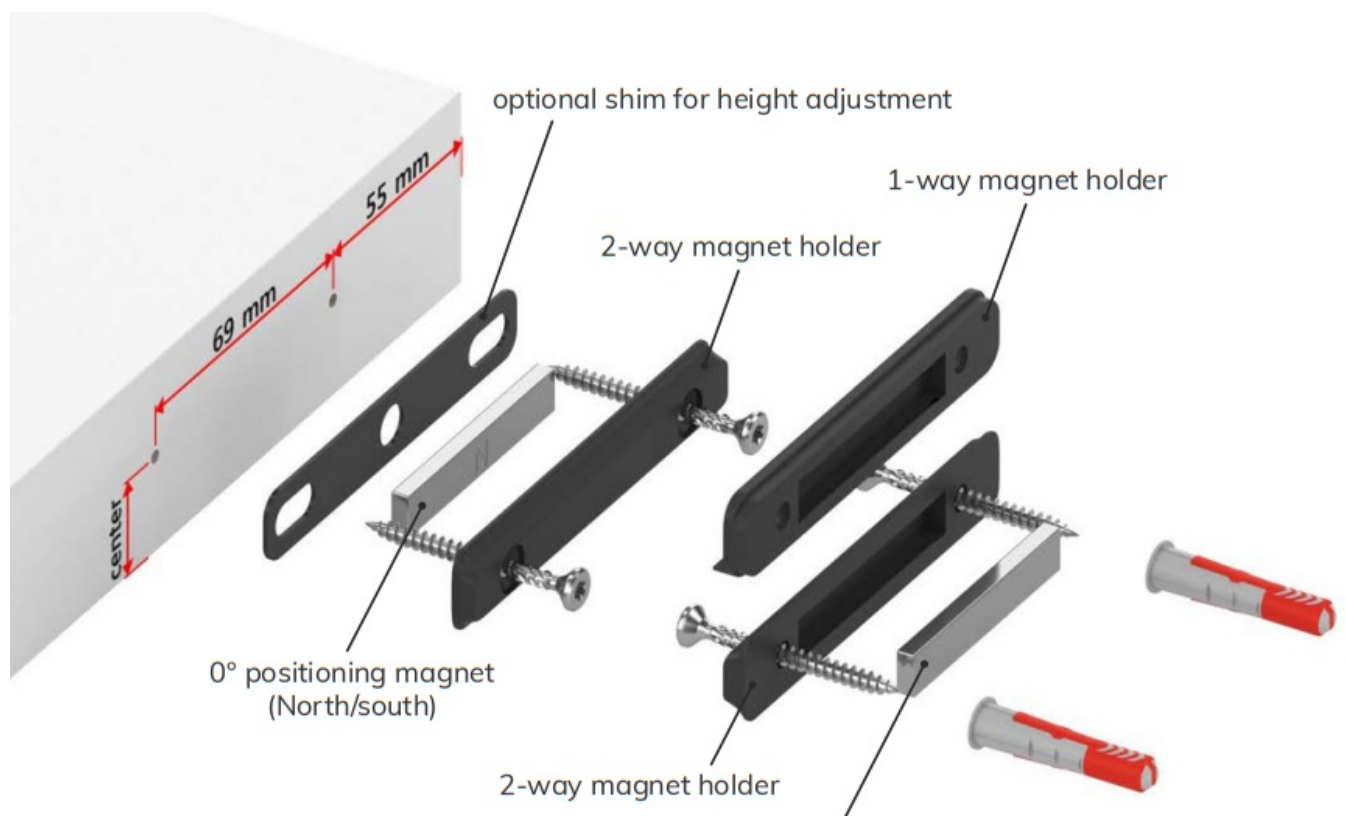

0° positioning magnet  
(North/south)

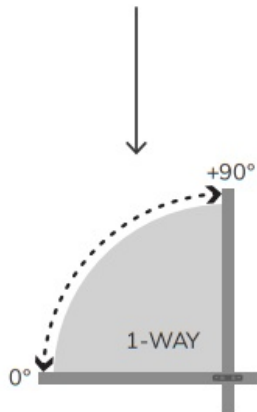
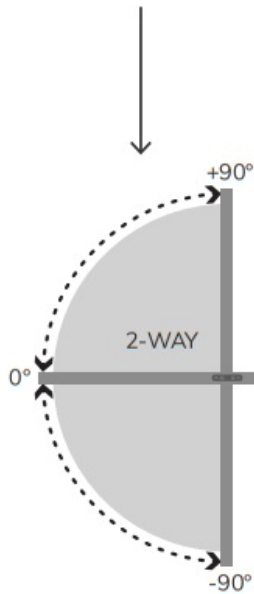
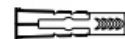
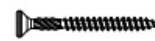
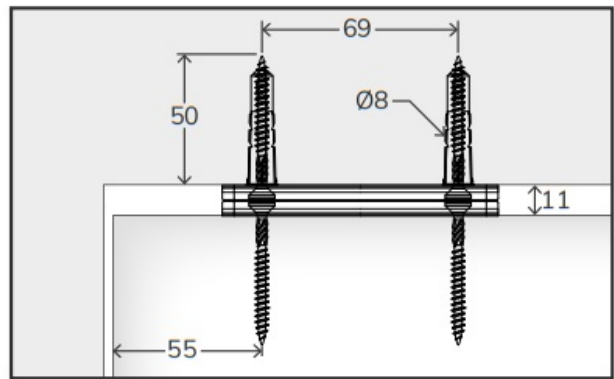
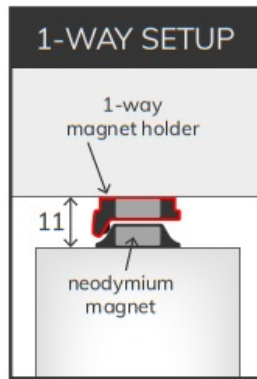
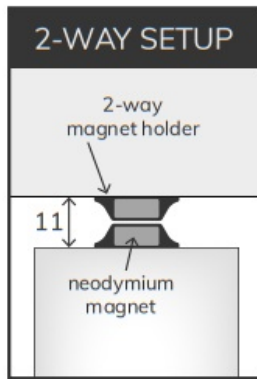





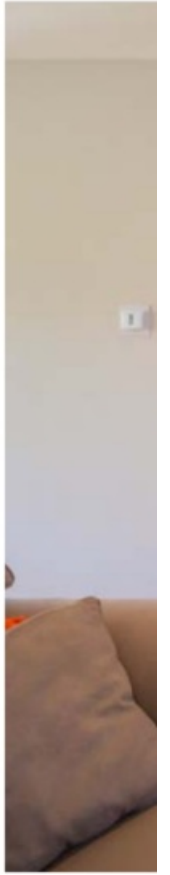

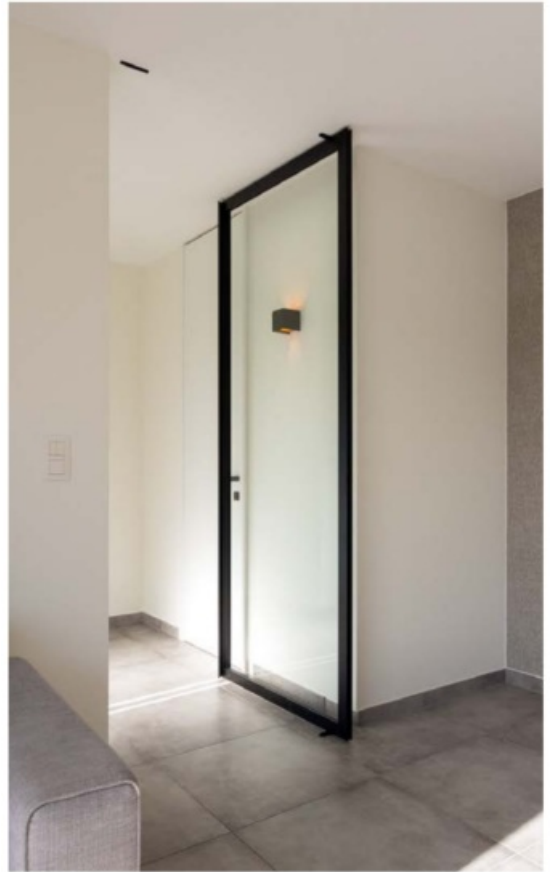

Find more pictures, information, and in-depth manuals

@

[WWW.PORTAPIVOT.COM](http://WWW.PORTAPIVOT.COM)

# STEALTHPIVOT

By PortaPivot

## Documents / Resources

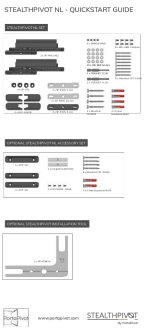
	<p><a href="#">PortaPivot V2-NL Self-Closing Pivot Hinge Systems</a> [pdf] Installation Guide V2-NL Self-Closing Pivot Hinge Systems, V2-NL, Self-Closing Pivot Hinge Systems</p>
---	---

## References

-  [Architectural hardware for pivot, glass and sliding doors – PortaPivot](#)