

Porseme QMJS30 280ml Aroma Diffuser User Guide

[Home](#) » [Porseme](#) » Porseme QMJS30 280ml Aroma Diffuser User Guide 

Porseme®

280ml Aroma Diffuser

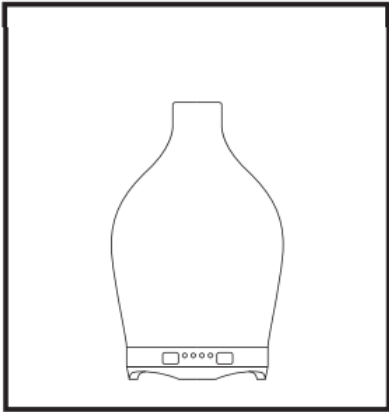
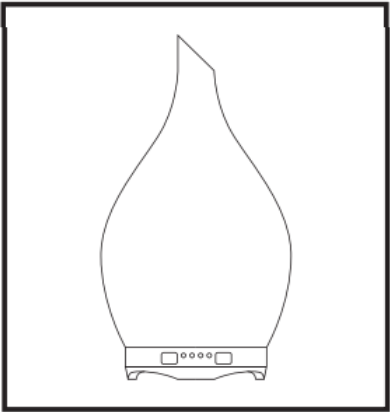
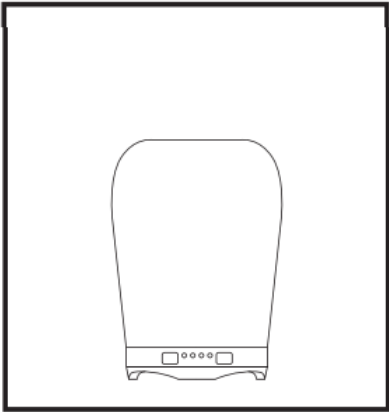

Product image

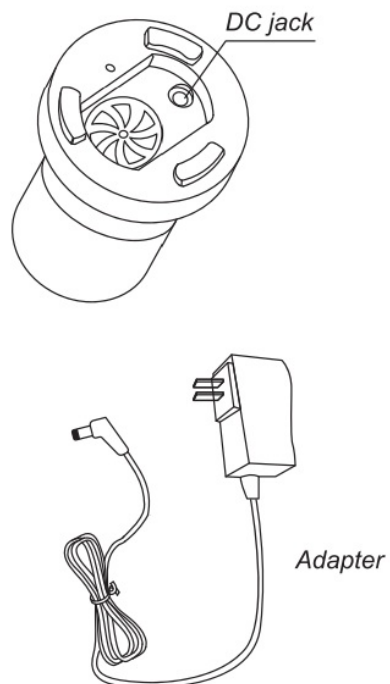
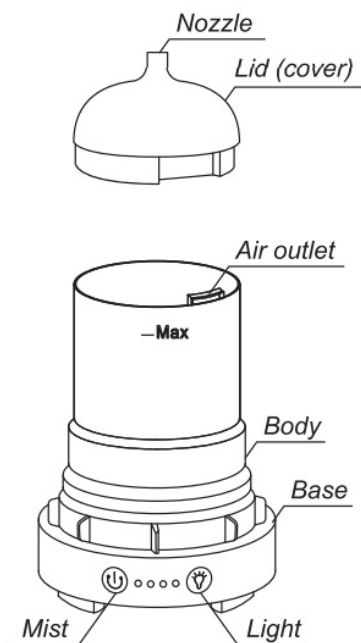

Contents

- 1 SPECIFICATIONS
- 2 PACKAGE INCLUDED
- 3 TROUBLESHOOTING
- 4 HOW TO USE
- 5 HOW TO CLEAN
- 6 MODEL SETTING
- 7 PRODUCT MAINTENANCE
- 8 Documents / Resources
- 9 Related Posts

SPECIFICATIONS

Model	QMJS30	Run time	up to 7 hours
Capacity	280m1	Coverage	up to 250 square feet
Adaptor Power		100-240V,24V 0.5A	

PACKAGE INCLUDED

- 1 X Aroma Diffuser
- 1 X Adaptor
- 1 X Manual

TROUBLESHOOTING

SYMPTOM	CAUSE	SOLUTION
No mist or little mist	Using distilled or purified water.	Use tap water(without filter)
	Water is exceeding the max fill line.	Clean the unit and add water 1/2 way to fill line and additional water after getting mist.
	The sensor/disc(inside the bottom of the water tank) needs to be cleaned.	Clean as advised with clean water.Dry with cloth or brush or swab.
	Tap water is too cold.	Empty tank and refill with lukewarm tap water.
Leaking	Overfilled with water.	Clean the unit and add water 1/2 way to fill line and additional water after getting mist.
	The lid(cover) is not fully covered on the water tank.	Make sure the lid(cover) is properly in place.
Blinking lights	The water level indicator is dirty.	Carefully clean the sensor/disc inside the bottom of the unit.
None of the examples		Get in touch with us and we will be happy to help.

CAUTION: FOR INDOOR USE ONLY

Our Porseme diffuser comes with a 12-month manufacturer warranty. Please kindly contact us before you return it to the retailer. Please contact customer service:

porseme-service@Photmail.com Our Facebook is PORSEME US.

HOW TO USE

3D glass globe

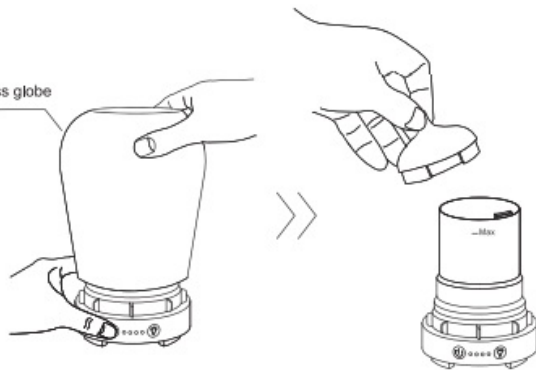

Lift the 3D glass globe and the cap.

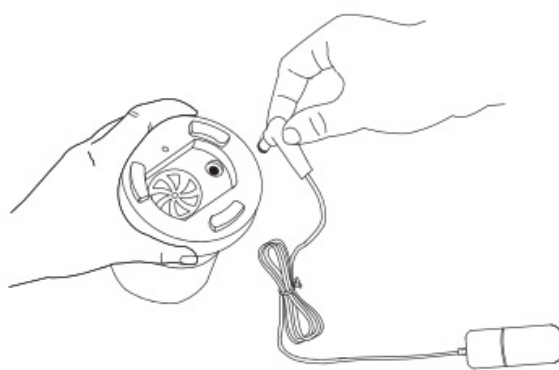

Connect the power cord to the base.

1

2

3

4



Add water and several drops of essential oils.

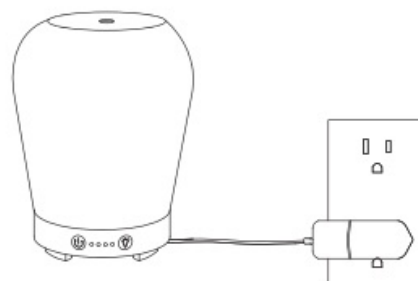

Replace the cap and the glass globe, then plug in.

CAUTION:

1. Do not exceed the "MAX" line when adding water.
2. Better use a container to add water in case water splashing into the motor.

HOW TO CLEAN



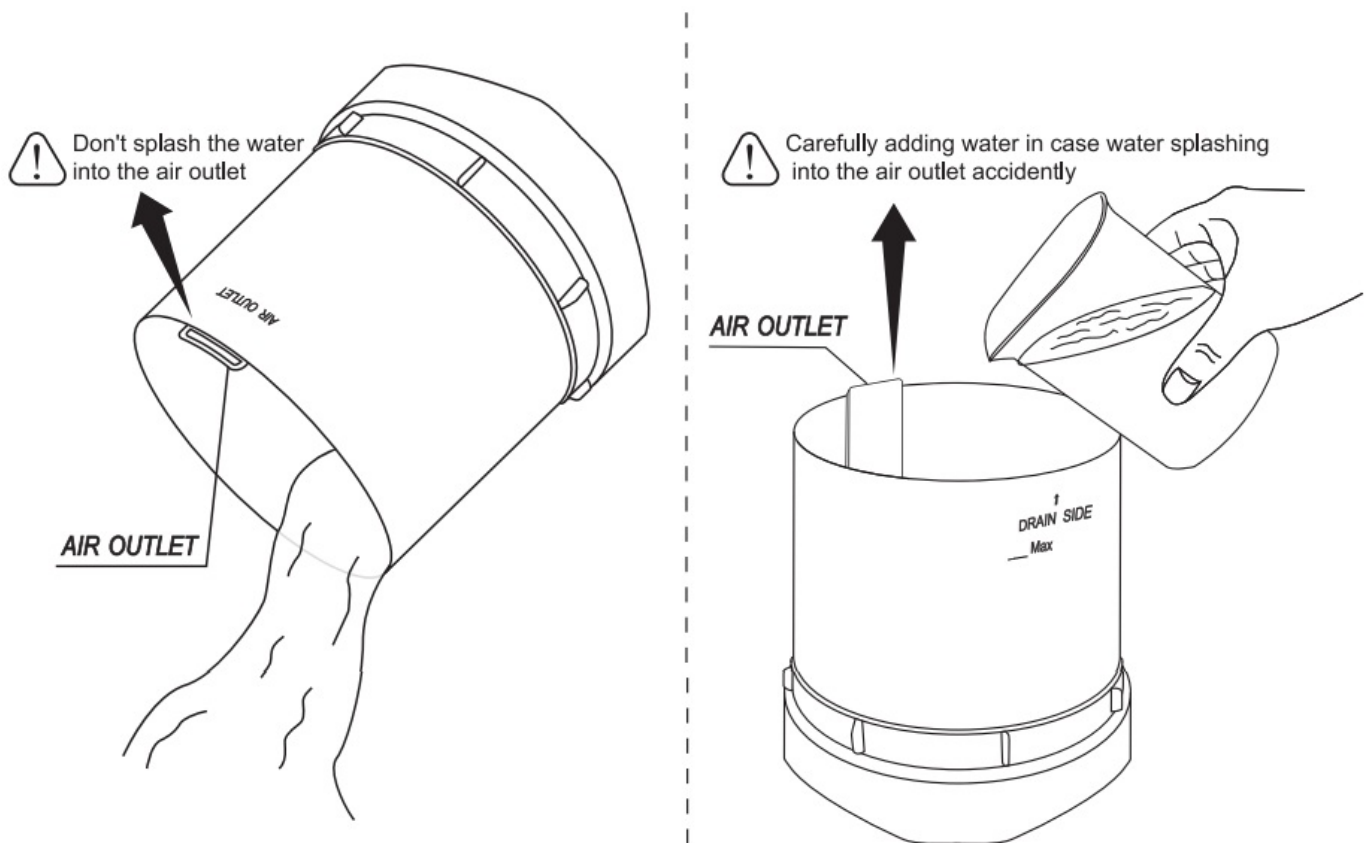

1. Rinse the water tank with clean water and wipe dry with a clean cloth. Please make sure there is no any water splashing into the air outlet.
2. Clean the sensor/disc with a cotton swab.

CAUTION:





MODEL SETTING

LIGHT MODE:

1. The 1st time press the  to turn on the LED light, the color will change automatically.
2. The 2nd time presses the  to fix the color.
3. The 3rd to 9th time press the  to change the color, our essential oil diffuser has 7 changing colors.
4. The 10th time or long-press the  for 3 seconds to turn off the light.

MIST AND TIME MODE:

1. The 1st time press the  to turn on the spray. The initial configuration is AUTO.
2. The 2nd to 4th time press the  to change the timer to 1H/3H/5F1.
3. The 5th time press the  to turn off the spray.

PRODUCT MAINTENANCE

- Do not use with a wet hand

- Do not use detergents, solvents, or abrasive agents to clean the diffuser unit.
- Do not block the mist output or it will damage the product. * Do not remove the cover or add water/oils when in use.
- Please use on a flat surface.
- Please clean the diffuser regularly, recommend once a week.
- Please follow the advised cleaning instructions.
- Please keep away from children and pets
- Please contact us if you found any problems, we will be happy to help



Porseme US



www.amazon.com/porseme



www.porseme.store



porseme-service@hotmail.com

Documents / Resources

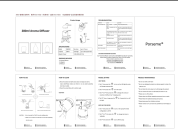

[Porseme QMJS30 280ml Aroma Diffuser](#) [pdf] User Guide
QMJS30, 280ml Aroma Diffuser, B07MN9XP95