



POP SONIC V40022 Noise Sound Machine User Guide

[Home](#) » [POP SONIC](#) » POP SONIC V40022 Noise Sound Machine User Guide 

POP SONIC V40022 Noise Sound Machine

User Guide



WHITE NOISE MACHINE

For a deeper sleep

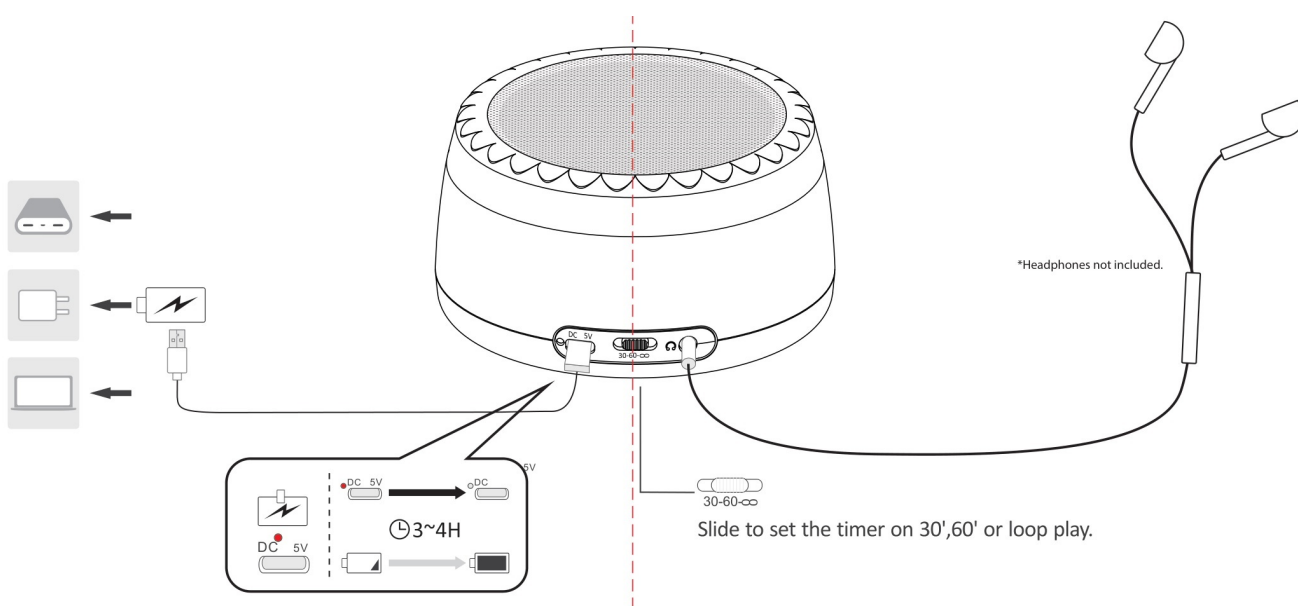
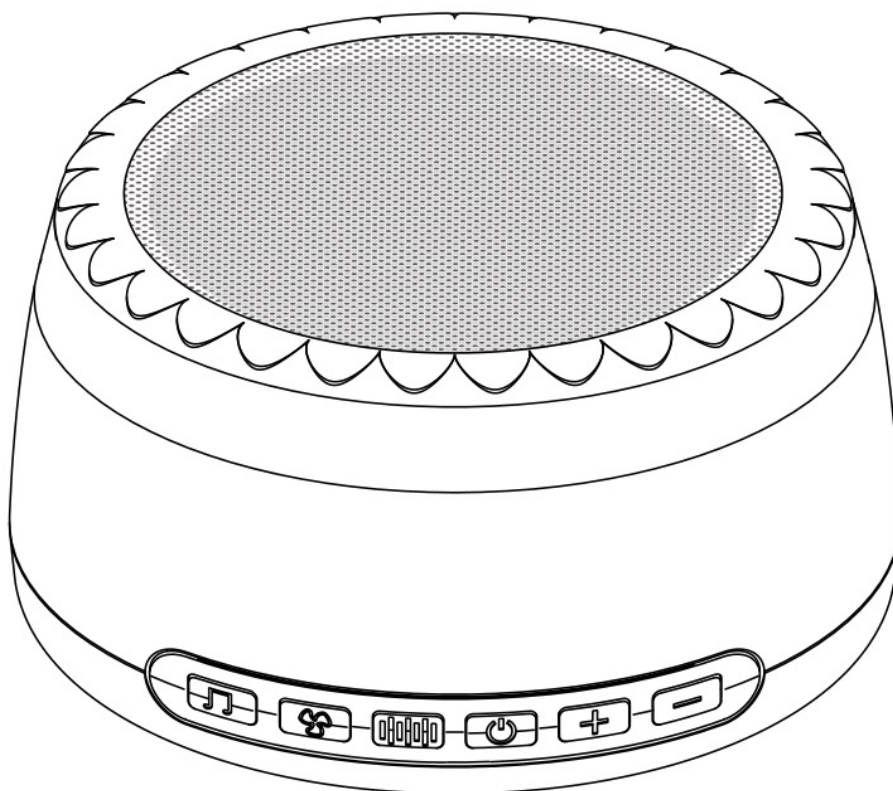

Contents

- 1 INCLUDES
- 2 HOW TO USE
- 3 GETTING STARTED
- 4 USING YOUR MACHINE
- 5 USING THE NIGHT LIGHT
- 6 TIMER SWITCH
- 7 MAINTENANCE
- 8 SOUNDS
- 9 WARRANTY
- 10 DISPOSAL
- 11 SPECIFICATIONS
- 12 SUPPORT
- 13 Documents / Resources
 - 13.1 References
- 14 Related Posts

INCLUDES

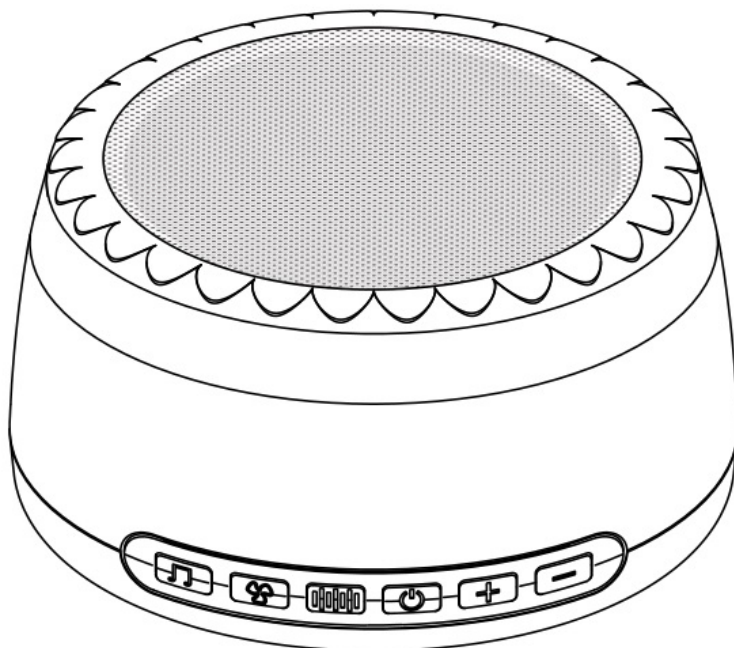

·1 xSound Machine



·1 x USB Charging Cable

HOW TO USE



Press to Change one of the 20 tunes under each sounds.



Press to play fan tone.



Press to play white noise.

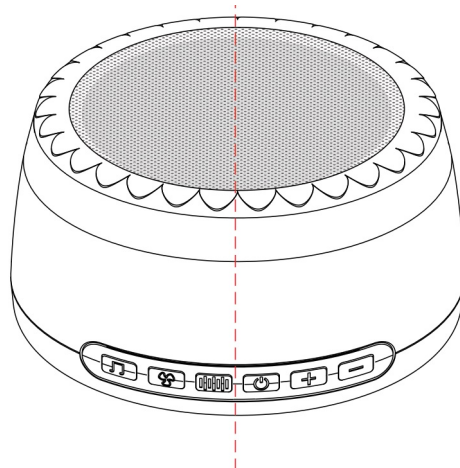

Press to Power on/Power off



Press to increase the volume.





Press to decrease the volume.

GETTING STARTED

1. Machine can be used with or without charging cord.
2. If using the included charging cord, make sure to plug the USB side into a UL certified charging base (see illustration), then insert the C-type opposite end of the cord into the charging port on the machine.
3. If using without cord, make sure to charge the machine for at least 3-4 hours before using to insure longest battery life.

USING YOUR MACHINE

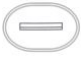
1. To turn on, press the power button 
2. Adjust the volume with the  or  buttons to the right of the power button.
3. Select the sound by pressing one of the 3 buttons to the right of the power button (see illustration for sound types for each button).
4. To turn on light, tap the top mesh part (see illustration and instructions on next page).

USING THE NIGHT LIGHT

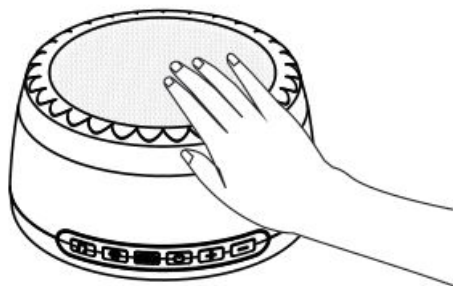

1. Tap once to turn on light
2. Tap again to start cycling thru colors
3. Tap and hold to adjust brightness
4. To turn off light, tap until light turns off

TIMER SWITCH

On the back of the machine, near the power port, there is a switch with 3 settings that functions as a timer. Set to 30 and the machine will automatically turn off after 30 minutes. Set to 60 and the machine will automatically turn off after 60 minutes. Set to loop (far right setting) and the machine will stay on until it is manually turned off or runs out of battery.

MAINTENANCE

To Store

You may leave the unit on display. It can be stored in it's original box or a cool and dry place.

To Clean

Wipe off dust with a damp cloth. NEVER use liquids or abrasive cleaner to clean the white noise machine.

Modifications not authorized by the manufacturer may void users authority to operate this device.

SOUNDS

Cycle thru the 20 natural sounds by pressing the  button.

- Set 1 – forest, running water, songbirds
- Set 2 – running water, songbirds
- Set 3 – campfire
- Set 4 – creek water
- Set 5 – cricket calls in the summer night
- Set 6 – soothing wavelets
- Set 7 – distant waves
- Set 8 – waves (from near to far)
- Set 9 – seagull croak
- Set 10 – waves (from far to near, accompanied by bird calls)
- Set 11 – soothing rain sound
- Set 12 – the sound of rain in the forest
- Set 13 – the sound of heavy rain
- Set 14 – thundershower
- Set 15 – thunderstorm
- Set 16 – life force
- Set 17 – piano sounds
- Set 18 – natural melody
- Set 19 – train
- Set 20 – clock

Cycle thru the 5 fan sounds by pressing the  button.

- Set 1 – large fan
- Set 2 – industrial fan
- Set 3 – mellow fan-lo
- Set 4 – mellow fan-hi
- Set 5 – exhaust fan

Cycle thru the 5 noise sleep aids by pressing the  button.

Set 1 – brown white noise
Set 2 – chestnut white noise
Set 3 – cinnamon white noise
Set 4 – tan white noise
Set 5 – amber white noise

WARRANTY

POP SONIC warrants the white noise machine for a period of 1 year after the original date of purchase, against defects due to faulty workmanship or materials. For warranty claims, you must register your device and log in to your account at www.shoppopsonic.com, then select the option to make a warranty claim. Our customer service department will then contact you to initiate the warranty procedure.

This warranty covers working parts. It does not cover damage due to normal usage or accidents such as dropping the device.

Other exclusions include misuse or neglect to the device. This warranty is void if any other charging cables besides the one included is used with your device.

For any warranty claims, proof of purchase must be provided. For this reason, please keep your receipt for the duration of the warranty period. Shipping costs are non-refundable.

DISPOSAL

Do not dispose of this machine in your normal garbage because it has a built-in battery. Bring to the proper collection point for recycling of electronic equipment.

SPECIFICATIONS

Product Name: White Noise Machine
Model #: 23305
Components: ABS plastic and metal
Battery Type: Lithium Ion
Capacity: 3.7V 1200 mAh
Rated Energy: 4.44 Wh
Charging Time: About 2-3 hours

SUPPORT

For questions about your product please call Pop Sonic customer services at (800) 772-9147 or email help@shoppopsonic.com

Made By Pop Sonic, LLC
Minneapolis, MN 55344 , USA
MADE IN CHINA

Documents / Resources

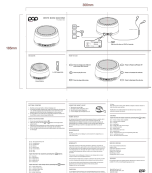
 A thumbnail image of the user guide for the POP SONIC V40022 Noise Sound Machine. It shows a diagram of the device and some text.	<p>POP SONIC V40022 Noise Sound Machine [pdf] User Guide V40022 Noise Sound Machine, V40022, Noise Sound Machine</p>
---	--

References

-  [Popsonic](#)