



POOLEX Opti Side Pool Filter User Manual

July 20,
2025

POOLEX

Contents [[hide](#)]

1 OPTI SIDE

1.1 Installation and user manual

1.1.1 WARNINGS

1.1.2 1. SECURITY

1.1.3 2. DESCRIPTION

1.1.3.1 2.1 List of accessories

1.1.3.2 2.2 Operating principle

1.1.3.3 2.3 Exploded view

1.1.3.4 2.5 Water chemical parameters

1.1.3.5 2.4 Features and dimensions

1.1.4 3. INSTALLATION

1.1.4.1 3.1 Location

1.1.4.2 3.2 Assembly

1.1.5 4. USE

1.1.5.1 4.1 Commissioning: washing the filter

1.1.5.2 4.2 The 7 functions of the 6-way valve

1.1.6 5. MAINTENANCE

1.1.6.1 5.1 General

1.1.6.2 5.2 Most frequent faults

1.1.6.3 5.3 Dismantling the valve

1.1.6.4 5.4 Valve assembly

1.1.7 6. WARRANTY

1.1.7.1 6.1 General warranty conditions

2 Documents / Resources

2.1 References

OPTI SIDE



Installation and user manual

WARNINGS

**These instructions are an integral part of the product.
They must be given to the installer and kept by the user.
If you lose the manual, please refer to the website :**

www.poolex.fr

The instructions and warnings contained in this manual must be read carefully and understood, as they provide important information on the safe handling and operation of the filter.

Keep this manual in an accessible place for future reference.

Installation must be carried out by a qualified professional in accordance with current regulations and the manufacturer's instructions. Incorrect installation may result in physical injury to people or animals, as well as mechanical damage for which the manufacturer cannot be held responsible under any circumstances.

After unpacking the filter, please check the contents for any damage.

Before connecting the filter, make sure that the data given in this manual is compatible with the actual installation conditions and does not exceed the maximum authorised

limits for the product in question.

In the event of a fault and/or malfunction, the power supply to your technical room must be cut off and no attempt must be made to repair faults on the tank. Repair work must only be carried out by an authorised technical assistance service using original spare parts.

Failure to comply with the above may adversely affect the safe operation of the filter. To guarantee the efficiency and correct operation of the filter, it is important to ensure that it is regularly maintained in accordance with the instructions provided.

If the filter is sold or transferred, always ensure that all the technical documentation is passed on with the equipment to the new owner.

This filter is designed exclusively to treat swimming pools. All other uses must be considered inappropriate, incorrect or even dangerous.

Any contractual or extra-contractual liability of the manufacturer/distributor shall be considered null and void for damage caused by installation or operating errors, or by failure to comply with the instructions provided in this manual or with the installation standards in force for the equipment which is the subject of this document.

1. SECURITY

The installation and maintenance of the upstream electrical parts must be carried out by a professional electrician. Otherwise there is a risk of electrocution, serious injury, material damage and even life-threatening consequences.

Before any maintenance or operation, make sure that all machinery, especially the circulation pump, is de-energised so that the filter is no longer under pressure:

 **Never operate the 6-way valve while the pump is running.**

 **Never unscrew the cover ring when the pump is running.**

Clean the pump pre-filter regularly to ensure that the water circulates properly and without excess pressure.

In low-temperature conditions, particularly when active wintering is no longer possible

(ask your dealer for advice), we strongly recommend that you set the 6-way valve to WINTER position and drain the water from the filter using the drain screw at the bottom of the tank.

Do not operate without water and do not connect the filter directly to the water supply network, as the pressure of some distribution networks may be higher than the maximum working pressure of the filter.

Check that your equipment is suitable for the volume of water to be treated, in particular the flow rates and working pressures.

To ensure the transparency and integrity of the plastics, do not clean the filter with products that degrade plastics (detergents, solvents, etc.).

Take care not to break the various plastic parts; it is not necessary to overtighten the screws/nuts. Do not use PTFE or Teflon tape on the manometer threads.

Always maintain the correct level of disinfectant and a pH of around 7.2.

The person responsible for the installation must read this manual carefully. If any incorrect or erroneous operation occurs, please contact your nearest authorised dealer or the technical support service.

In the event of a damaged part, please give priority to the purchase of a replacement part from the manufacturer or an authorised dealer.

 FAILURE TO OBSERVE THESE WARNINGS MAY RESULT IN PROPERTY DAMAGE, ELECTRIC SHOCK, COMPLICATIONS, OTHER SERIOUS INJURY OR DEATH.

CAUTION – To avoid any risk of injury, do not allow children to use this appliance.

WARNING – Intensive use of the pool and high temperatures may require long filtration times (even 24 hours a day) in order to maintain a satisfactory level of cleanliness and water quality.

2. DESCRIPTION

2.1 List of accessories

Your OPTI SIDE filter comes in 2 boxes, 1 for the tank and its accessories and 1 for the valve and its accessories. Check the following parts list to make sure all the accessories are present:

In the tank box	In the cardboard box
<ul style="list-style-type: none"> • 1 tank • 1 filter cover • 1 strainer • 1 bag containing : <ul style="list-style-type: none"> – the cover O-ring – the drain plug – multilingual manual 	<ul style="list-style-type: none"> • 1 multiway valve body • 2 O-rings • 2 threaded union connections (1.5"/50mm) for gluing • 1 threaded union (1.5"/50mm) for gluing, "drain" outlet with transparent tube • 1 elbow tube • 1 threaded valve connection • 1 multi-way valve position label • 1 multilingual manual

2.2 Operating principle

Your swimming pool filter is the main component of your technical room, ensuring that your water is clean and clear, followed by the chemical treatment components.

To do this, the filter must contain a filtering charge, which may be sand or glass. This filtering charge mechanically eliminates all waste, larger than the filtration fineness of the media used, suspended in the water and introduced by nature or by swimmers.

When the 6-way valve is in the FILTRATION position, the pool water is sucked through the pipe system and drawn to the top of the filter by the 6-way valve. The water passes through the filter, and suspended impurities are mechanically blocked by the filter media. The filtered water then leaves the lower part of the filter via the strainers and the 6-way valve, and is returned to the pool via the pipe system.

The accumulation of waste retained in the filter alters the flow rate and increases the pressure.

The filter then needs to be cleaned.

Wash the filter at least once a week or when the pressure has increased by 30% compared with the initial pressure when the filter is clean, i.e. generally when the pressure gauge indicates a pressure of over 1.3 bars.

To do this, switch off the circulation pump, set the 6-way valve to the WASH position and restart the pump. The flow of water is then reversed in the filter so that it circulates

through the filter medium from the lower part of the filter to the upper part, in order to loosen the build-up of waste from the filter medium and discharge it via the 6-way valve into the drain pipe (note: if present, the valve on the drain pipe must be open).

Check the cleanliness of the water through the transparent tube located on the 6-way valve, in the direction of the drain.

When it becomes transparent again, the impurities have been removed from the filter.

Switch the pump off again, then move the 6-way valve to the RINSE position, then restart the pump for 30s to 60s.

Then switch the pump off again, move the 6-way valve back to the FILTRATION position and restart the pump one last time to resume normal filtration.

To ensure optimum water quality, it is important that the filtration time is long enough, a good estimate is :

$$\text{Filtration time} = T^{\circ} \text{ water} / 2$$

But if the water temperature is above 26°C, additional filtration time may be required, until continuous filtration (24 hours a day) is achieved above 30°C.

! Always switch off the pump before working on the 6-way valve. To avoid damaging the seal on the multi-way valve, always press down on the handle before turning it and always turn it clockwise.

2.3 Exploded view

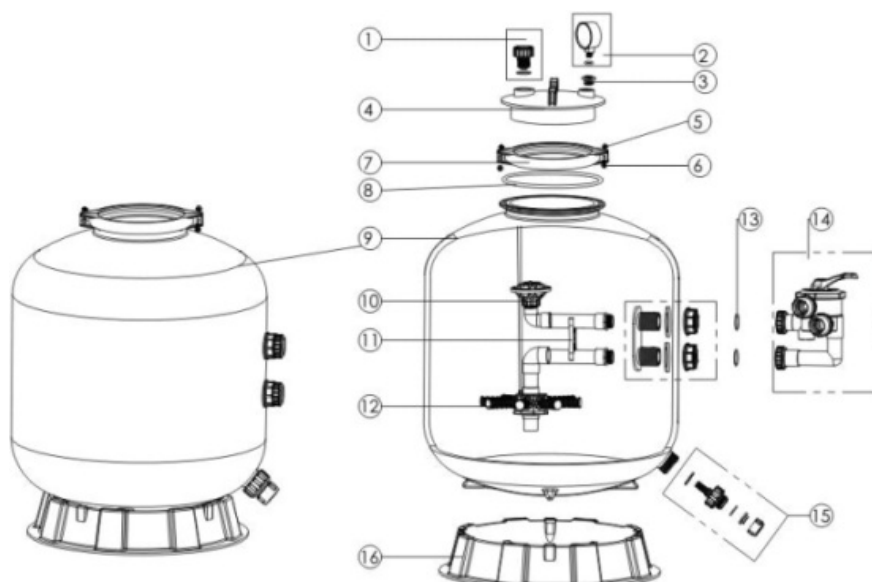

1. Drain plug with O-ring
2. Pressure gauge with seal
3. Connector for manometer/plug
4. Cover (transparent)
5. Nut M6
6. Screw
7. Filter collar
8. Cover O-ring
9. Filter bowl
10. Internal diffuser
11. 1"1/2 internal tube spacer
12. Strainers (115mm or 126mm)
13. O-ring valve/filter 1"1/2 (d53x3)
14. 6-way valve 1"1/2 SIDE (Black)
15. Drain plug kit
16. Filter base

Note: The size of parts 9, 10, 12 and 16 varies according to the model chosen.

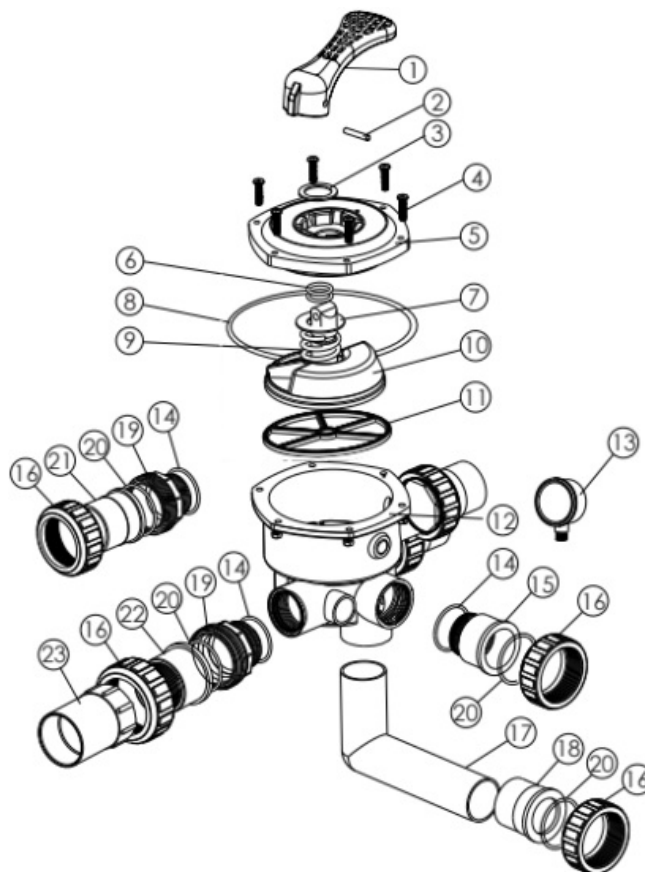

1. Valve handle
2. Handle insert
3. Handle washer
4. Screw and nut M6x30
5. 6-way 1"1/2 valve cover (Black)
6. Valve ball seal
7. Ball washer
8. Cover O-ring
9. Spring
10. Valve ball 1"1/2
11. Star gasket
12. Lower valve body (Black)
13. Pressure gauge with seal
14. O-ring seal
15. Threaded union for 1"1/2 valve (Black)
16. Union nut 1"1/2 (Black)
17. Black elbow tube 1"1/2
18. Union adaptor 1"1/2
19. Union fitting 1"1/2 (Black)
20. Union joint 1"1/5
21. 1"1/2" union glue fitting
22. Union 1"1/2 with sight glass (short)
23. Union 1"1/2 with sight glass support

2.5 Water chemical parameters

We suggest the following chemical levels for your pool:

- pH level: 6.8 to 7.6
- Total alkalinity: 80 to 120 ppm
- Calcium hardness: 200 to 400 ppm
- Combined chlorine: 0.2 ppm maximum
- Chlorine (stabilised): 1.0 to 3.0 ppm
- Chlorine stabiliser (cyanuric acid): 30 to 80 ppm

2.4 Features and dimensions

Before starting installation, check that your equipment is suitable for each other (flow rates and working pressure) and that the dimensions specified for the volume of water to be treated are respected.

These filters are designed for use up to 2.8 bar.

The filter media (sand or glass) is not supplied. Ask your dealer for advice. Use sand or glass dedicated to swimming pool filtration. We recommend using a filter media 1/3 with a particle size of approximately 2mm to 4mm and 2/3 with a particle size of approximately 0.5mm to 0.7mm.

This should preferably be renewed every 5 years.

Model	PF-OPT450S	PF-OPT500S	PF-OPT650S	PF-OPT700S
Height A (mm)	730	770	850	960
Diameter B (mm)	449	527	627	703
Sand required (kg)	45	85	145	210
Glass required (kg)	35	70	115	170
Max flow rate (m ³ /h)	7.80	10.80	15.30	19.20
Pool volume (m ³)	45	60	90	110

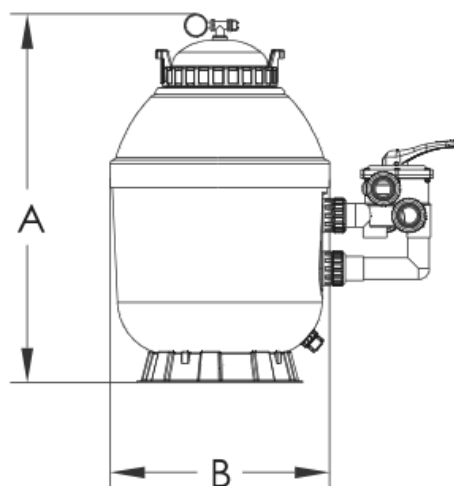

3. INSTALLATION

3.1 Location

This product should only be installed and maintained by a qualified swimming pool professional.

1. Only simple tools (screwdrivers and spanners) and PVC pipe adhesive are needed to install and maintain the filter.
2. The filtration system should be installed on a flat concrete slab or other rigid base. Choose a well-drained, ventilated area that won't flood in the event of rain.
3. Position the filter so that the connections, multiway valve and drain are accessible for use and maintenance.
4. Position the filter body so that all the operating and safety labels are visible.
5. Ideally, the filter should be installed as close as possible to the pool in the equipment room, preferably 50cm below the water level.
6. Provide a waste water drain pipe of the same dimensions as the other pipes used in the equipment room.
7. Always use PVC pool pipes with the correct diameter.
8. Check that the water draining from the drain plug is directed away from electrical appliances.



3.2 Assembly

Step 1 : Use PVC fitting adhesive to glue the union to the end of the lower elbow tube of the 6-way valve.

Step 2 : Place the union nut on the elbow tube before gluing.

Step 3 : Place and grease the O-ring on the bottom wall feedthrough of the filter and fit the elbow tube. Tighten the union nut by hand.

Step 4 : Place the unions on the inlet, outlet and drain ports of the multiway valve.



⚠ O-rings are used for sealing. Do not use PTFE tape.

Step 5 : Place the O-ring on the top wall feedthrough of the filter. Stick the elbow tube into the lower hole of the 6-way valve, positioning it on the filter. Hand-tighten the union nut on the top wall bushing.

Step 6 : Glue the inlet, outlet and drain pipes to the union fittings on the 6-way valve.

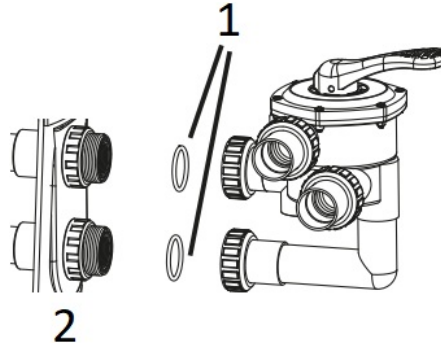

1. Joints

2. Curve filter

Reminder: Filter media (sand or glass) is not supplied. Ask your dealer for advice. Use sand or glass dedicated to swimming pool filtration. We recommend using a filter media 1/3 with a particle size of approximately 2mm to 4mm and 2/3 with a particle size of approximately 0.5mm to 0.7mm. This should preferably be renewed every 5 years.

Step 7 : The filter media is loaded through the top opening of the filter.

- Loosen the collar on the cover and remove it.
- Check the integrity, positioning and tightness of the strainers at the bottom of the filter.
- Cover the diffuser.
- Fill the filter tank with a third of the water required to protect the collector and strainers during filling.
- Carefully pour in the correct quantity and quality of filter media. The surface of the media should be level and approximately in the middle of the filter tank.
- Remove the diffuser protection.



Step 8 : Check that there is no media residue on the cover. Place the O-ring on the cover and then position the cover on the filter. Tighten the flange on the cover. Screw the purge tee onto the cover and the pressure gauge onto the purge tee.

⚠ The bleed tee and pressure gauge are fitted with O-rings. Do not use PTFE

(TEFLON) tape.

Step 9 : Before commissioning, check that all screw connections are tight.

4. USE

4.1 Commissioning: washing the filter

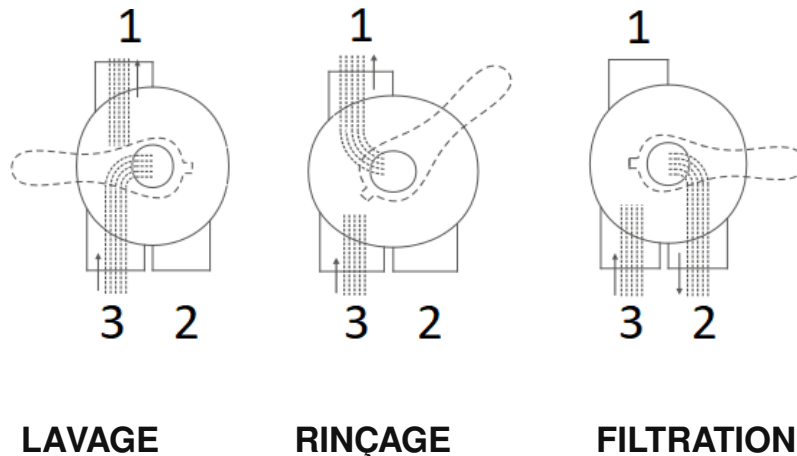

1. SEWER
2. WATER OUTLET
3. WATER INLET

Step 1 : Check that the filtration pump is not supplied with electricity. If necessary, switch it off at the control panel.

Step 2 : Press the handle on the 6-way valve and turn it to the WASH position. If necessary, check that the valve installed on the drain pipe is in the open position; if necessary, open it.

! To avoid damaging the seal on the multi-way valve, always press down on the handle before turning it and always turn it clockwise.

Step 3 : Prime and start the pump according to the manufacturer's instructions.

Step 4 : Allow the filter tank to fill with water. Leave the air bleed screw partially open. When water flows through the air vent, close it again. When the water flows through the drain, leave the pump running for at least 60 seconds. This initial wash is recommended to remove any impurities or fine particles from the filter media. Check the cleanliness of the water through the transparent tube in the drain.

Step 5 : Switch off the pump and turn the valve to the RINSE position.

Step 6 : Start the pump again and run it for 30s to 60s or until all impurities have been removed.

Check that the water in the transparent tube is clean.

Step 7 : Switch off the pump and turn the valve to the FILTRATION position.

Step 8 : Start the pump. The filter is now operating in normal filtration mode, filtering the pool water.

Step 9 : Adjust the pool suction and discharge valves to obtain the desired flow. Check the installation for leaks. Correct if necessary.

Step 10 : Note the initial value displayed on the pressure gauge when the filter is clean (it varies from one pool to another depending on the pump and hydraulic circuit).

 **The accumulation of waste in the filter leads to an increase in pressure and reduces the flow of water. When the pressure gauge indicates a 30% increase in the initial pressure, wash the filter. To do this, follow the steps above in their entirety.**

4.2 The 7 functions of the 6-way valve

 **To avoid damaging the seal on the multi-way valve, always press down on the handle before turning it.**

 **Always turn the handle clockwise.**

FILTRATION	WASHING	RINSE	SEWER
-------------------	----------------	--------------	--------------

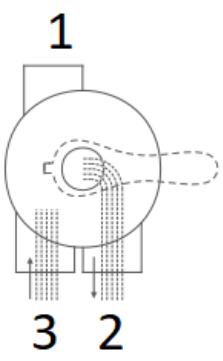
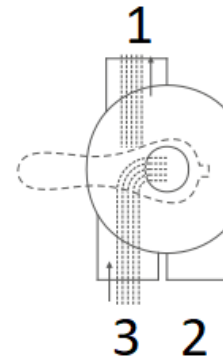
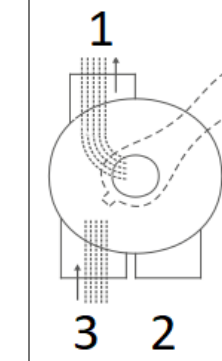
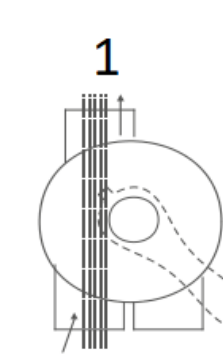
 <p>1. SEWER 2. WATER OUTLET 3. WATER INLET</p>	 <p>1. SEWER 2. WATER OUTLET 3. WATER INLET</p>	 <p>1. SEWER 2. WATER OUTLET 3. WATER INLET</p>	 <p>1. SEWER 2. WATER OUTLET 3. WATER INLET</p>
<p>The main position of the filter, where the water is filtered.</p>	<p>This position triggers backwashing of the filter: the flow is reversed.</p>	<p>This position removes the last impurities after washing.</p>	<p>This position diverts the flow of water to the drain without passing it through the filter, allowing the water to be discharged directly.</p>

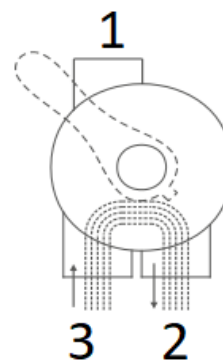
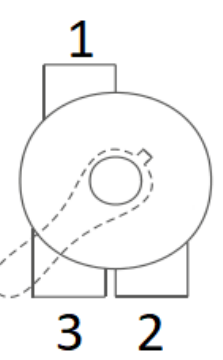
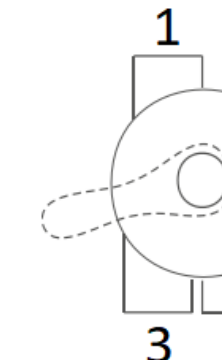
CIRCULATION	CLOSED	WINTERING
 <p>1. SEWER 2. WATER OUTLET 3. WATER INLET</p>	 <p>1. SEWER 2. WATER OUTLET 3. WATER INLET</p>	 <p>1. SEWER 2. WATER OUTLET 3. WATER INLET</p>

This position allows water to pass through without filtering it.	This position closes all water flows to and from the pool.	Raising the valve between the WA SH and CLOSE positions allows air to enter the filter.
--	--	---

5. MAINTENANCE

⚠ Before carrying out any work, to avoid any accidents, it is essential to de-energise the circulation pump and reduce the pressure in the filter using the air bleed screw.

⚠ To avoid damaging the seal on the multiway valve, always press down on the handle before turning it and always turn it clockwise.

5.1 General

- Remember to wash your filter media regularly (see section on commissioning).
- Remember to maintain your pH at around 7.2.
- Remember to disinfect your pool correctly.

If any of these parameters – filtration time (too short), chemical treatment and/or pH – are not controlled, the quality of your bathing water will deteriorate.

The outer casing of the filter should be regularly cleaned of any dust that may have settled on it, particularly the transparent cover that allows you to see that it is working properly. Do not use solvents or detergents that could damage the appearance of the plastics (shine, opacity, etc.).

⚠ Check and clean the inside and grease the star seal of the 6-way valve at least once a year before each new season.

5.2 Most frequent faults

Problem	Solution
The filter has a low flow rate.	– Check that the pump pre-filter basket and skimmers are not blocked.

There is a lack of suction.	<p>– Check that the pipes are not blocked and clean them.</p> <p>– In the case of a three-phase pump, check that the pump does not turn the wrong way round and, if necessary, change the direction.</p>
The pressure on the gauge is high.	
The pressure gauge is oscillating violently.	<p>– Check that there are no air intakes at the pump and, if necessary, remove them.</p> <p>– Check that the suction valves (skimmers and bottom drain) are sufficiently open, open them.</p>
There is sand in the pool.	<p>– Check the condition of the strainers.</p>

During these operations, you may need to check and clean the inside and grease the star seal of the 6-way valve. To do this, you need to dismantle, clean and then reassemble the valve.

5.3 Dismantling the valve

1. Switch off the circulation pump.
2. Close the suction and discharge valves.
3. Turn the valve to the FILTRATION position
4. Remove the screws
5. Lift the cover and remove the handle.

5.4 Valve assembly

1. Position the handle in the FILTRATION position
2. Align the cover with the valve body
3. Fit and grease the gasket
4. Re-tighten the cover screws in a staggered pattern. Do not overtighten.

6. WARRANTY

6.1 General warranty conditions

Poolstar guarantees the original owner against material and manufacturing defects in the

Poolex OPTI SIDE filter for a period of **five (5) years** for the tank and **two (2) years** for the other parts **excluding wear parts (seals and strainers)**.

The guarantee comes into effect on the date of first invoicing and on presentation of the purchase invoice.

The warranty does not apply in the following cases:

- Malfunction or damage resulting from installation, use or repair that does not comply with the safety instructions.
- Malfunction or damage caused by an unsuitable chemical environment in the pool.
- Malfunction or damage caused by conditions unsuitable for the intended use of the appliance.
- Damage caused by negligence, accident or force majeure.
- Malfunction or damage caused by the use of unauthorised accessories.

Repairs carried out during the warranty period must be approved before they are carried out and entrusted to an authorised technician. The warranty will lapse if the appliance is repaired by anyone not authorised by Poolstar.

Warranty parts will be replaced or repaired at Poolstar's discretion. Defective parts must be returned to our workshops within the warranty period to be covered. The warranty does not cover unauthorised labour or replacement costs. The return of the defective part is not covered by the warranty.

Dear customer,

**A question? A problem? Or simply register your
warranty, find us on our website:**

<https://assistance.poolstar.fr/>

Thank you for your trust and support. Happy bathing!

Your personal information is processed in accordance with the French Data Protection Act of 06 January 1978 and will not be shared with 3rd parties.



Technical support

www.assistance.poolstar.fr

contact@poolstar.fr

Poolex is a brand of the group :



04-2025

WWW.POOLEX.FR

Documents / Resources

 <p>POOLEX OPTI SIDE</p> <p>■ Manuel d'installation et d'utilisation ■ Installation und Lern-manual ■ Manual de montage y instalación ■ Manuale d'installazione e uso ■ Installations- und Gebrauchsanleitung ■ Installatie en gebruiksaanwijzing</p>	<p>POOLEX Opti Side Pool Filter [pdf] User Manual</p> <p>Opti Side Pool Filter, Side Pool Filter, Pool Filter</p>
--	---

References

- [User Manual](#)

Leave a comment

Your email address will not be published. Required fields are marked *

Comment *

Name

Email

Website

☐ Save my name, email, and website in this browser for the next time I comment.

Post Comment

Search:

Search

[Manuals+](#) | [Upload](#) | [Deep Search](#) | [Privacy Policy](#) | [@manuals.plus](#) | [YouTube](#)

This website is an independent publication and is neither affiliated with nor endorsed by any of the trademark owners. The "Bluetooth®" word mark and logos are registered trademarks owned by Bluetooth SIG, Inc. The "Wi-Fi®" word mark and logos are registered trademarks owned by the Wi-Fi Alliance. Any use of these marks on this website does not imply any affiliation with or endorsement.