

pontec PondoClear Island 3000 Unique Floating Pond Filter Instruction Manual

[Home](#) » [pontec](#) » **pontec PondoClear Island 3000 Unique Floating Pond Filter Instruction Manual** 

Contents

- [1 pontec PondoClear Island 3000 Unique Floating Pond Filter](#)
- [2 WARNING](#)
- [3 Safety information Correct electrical installation](#)
- [4 Safe operation](#)
- [5 Information about these operating instructions](#)
- [6 Warnings used in these instructions](#)
- [7 Cross-references used in these instructions](#)
- [8 Intended use](#)
- [9 Installation and connection How to proceed](#)
- [10 Remedy of faults](#)
- [11 Maintenance and cleaning](#)
- [12 Cleaning the device](#)
- [13 Wear parts](#)
- [14 Storage/Over-wintering](#)
- [15 Correct Disposal of this product](#)
- [16 Guarantee conditions](#)
- [17 Documents / Resources](#)
- [18 Related Posts](#)



pontec PondoClear Island 3000 Unique Floating Pond Filter

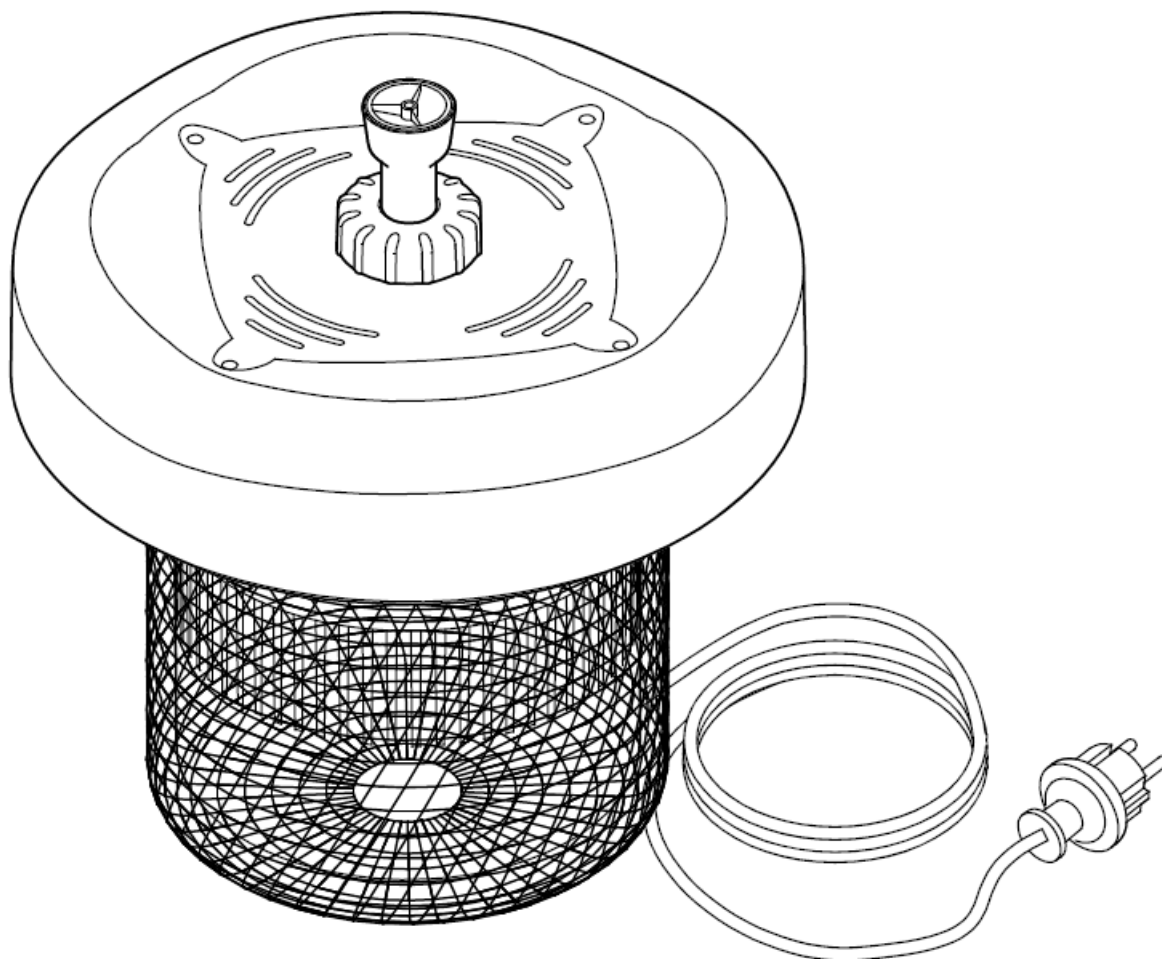

WARNING

- This unit can be used by children aged 8 and above and by persons with reduced physical, sensory or mental capabilities or lack of experience and knowledge if they are supervised or have been instructed on how to use the unit in a safe way and they understand the hazards involved.
- Do not allow children to play with the unit.
- Only allow children to carry out cleaning and user maintenance under supervision.
- This appliance contains a UV-C emitter.
- Household and outdoor use only.
- Children should be supervised to ensure that they do not play with the appliance.
- Ensure that the unit is fused for a rated fault current of max. 30 mA by means of a fault current protection device.
- Only connect the unit if the electrical data of the unit and the power supply correspond. The unit data is to be found on the unit type plate, on the packaging or in this manual.
- Only operate the unit if no persons are in the water.
- Possible death or severe injury from electrocution! Before reaching into the water, disconnect all electrical units in the water from the mains.
- Do not use the unit if electrical cables or housings are damaged.
- A damaged connection cable cannot be replaced. Dispose of the unit.

Safety information Correct electrical installation

- Electrical installations must meet the national regulations and may only be carried out by a qualified electrician.
- A person is regarded as a qualified electrician if, due to his/her vocational education, knowledge and experience, he or she is capable of and authorised to judge and carry out the work commissioned to him/her. This also includes the recognition of possible hazards and the adherence to the pertinent regional and national standards, rules and regulations.
- Switch off all units in the aquarium or disconnect the power plugs of all units before reaching into the water.
- For your own safety, please consult a qualified electrician.
- Extension cables and power distributors (e.g. outlet strips) must be suitable for outdoor use (splash-proof).
- Protect the plug connection from moisture.
- Only connect the unit to a correctly fitted socket.

Safe operation

The appliance is only intended for the purpose described in user manual. Do not use appliance or any part of the appliance out of the intended use to avoid risk.

The use of attachments which are not recommended or sold by the appliance manufacturer may cause a risk of injury to persons.

WARNING: Unplug all appliances in the aquarium or pond before carrying out maintenance.

WARNING: Disconnect the appliance from the supply before carrying out maintenance and cleaning.

WARNING: UV radiation is dangerous for the eyes and skin. Do not operate the UV-C emitter outside the appliance. **WARNING:** Do not operate the UV-C emitter when it is removed from the appliance enclosure. Unintended use of the appliance or damage to the housing may result in the escape of dangerous UV-C radiation. UV-C radiation may, even in little doses, cause harm to the eyes and skin.

- Never carry or pull the unit by the electrical cable.
- Route cables such that they are protected from damage and do not present a tripping hazard.
- Only open the unit housing or its attendant components if this is explicitly specified in the operating instructions.
- Only carry out work on the unit that is described in this manual. If problems cannot be overcome, please contact an authorised customer service point or, if in doubt, the manufacturer.
- Only use original spare parts and accessories for the unit.
- Never carry out technical changes to the unit.
- The supply cord cannot be replaced. If the cord is damaged the appliance should be scrapped.

Information about these operating instructions

You made a good choice with the purchase of this product PondoClear Island 3000. Prior to commissioning the unit, please read the instructions of use carefully and fully familiarise yourself with the unit. Ensure that all work on and with this unit is only carried out in accordance with these instructions.

Adhere to the safety information for the correct and safe use of the unit. Keep these instructions in a safe place! Please also hand over the instructions when passing the unit on to a new owner.

Warnings used in these instructions

The warning information is categorised by signal words, which indicate the extent of the hazard.

WARNING

- Indicates a possibly hazardous situation.
- Non-observance may lead to death or serious injuries.

CAUTION

- Indicates a possibly hazardous situation.
- Non-observance may lead to slight or minor injuries.

NOTE

Information for the purpose of clarification or for preventing possible damage to assets or to the environment.

Cross-references used in these instructions

A reference to a figure, e.g. figure A.

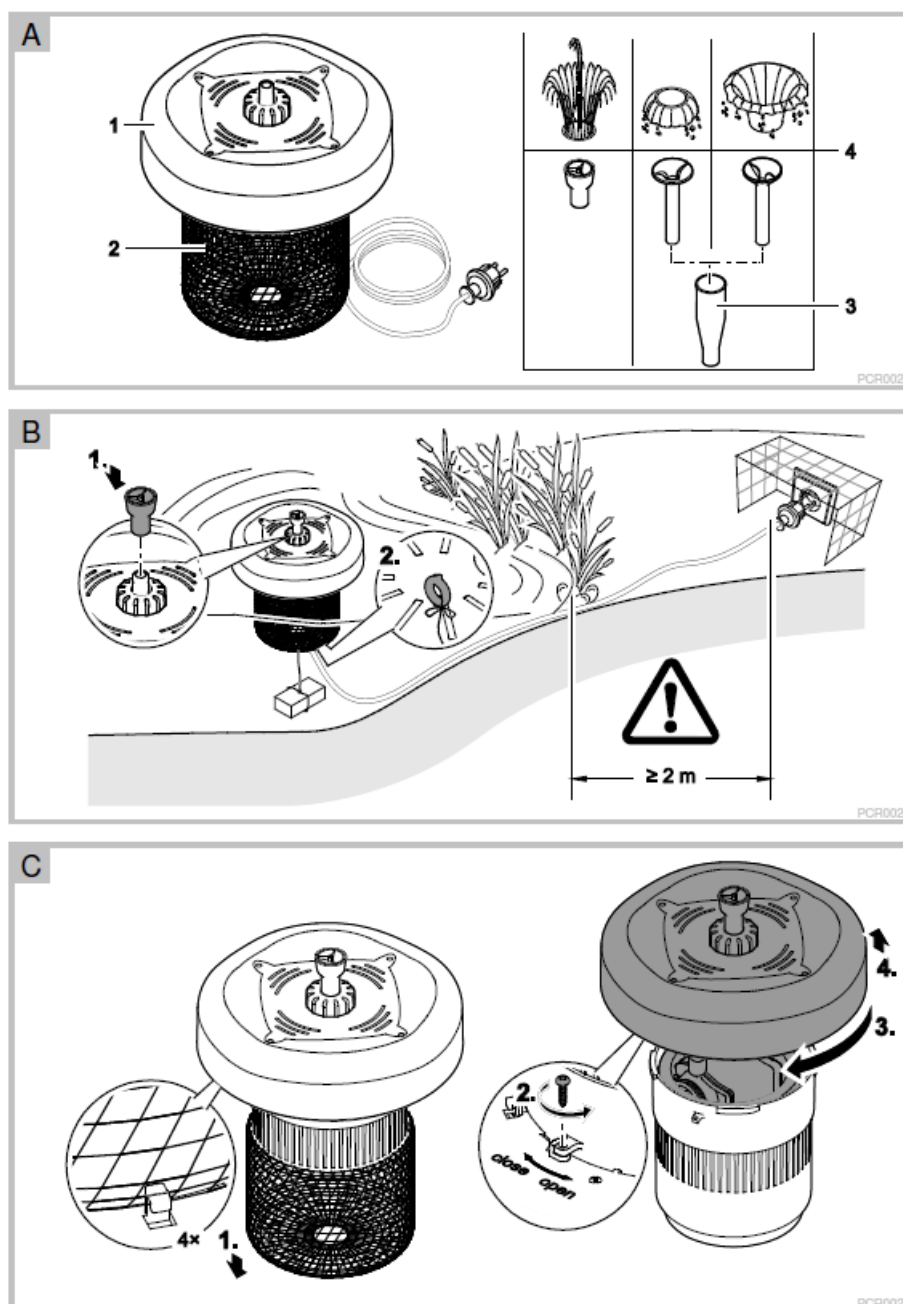

Scope of delivery

5 A	Quantity	Description
1	1	Float unit with outlet and LED lighting
2	1	Filter for removing coarse dirt particles
3	1	Nozzle holder
4	3	Nozzle attachment

Intended use

The product includes: A water pump (submersible pump), UV-C emitter with electronic ballast circuit, LEDs for decorative purposes. This unit is only intended for cleaning the water of garden ponds and for creating a fountain in a pond (not suitable for swimming pools or similar). Only suitable for operation in clean water. This unit is intended for use in garden ponds only. For household, outdoor use only. This unit can be used by children from the age of 8 and by persons with physical, sensory or mental impairments or lack of experience and knowledge, as long as they are supervised or instructed on how to use the unit safely and are able to understand the potential hazards. Do not allow children to play with the unit. Do not allow children to clean or maintain the unit without close supervision. The units can be used by persons with reduced physical, sensory or mental capabilities or lack of experience and knowledge if they are supervised or have been instructed on how to use the unit in a safe way and understand the hazards involved. The unit is only intended for the purpose described in the user manual. In order to prevent hazards, never use the unit or any part of the unit for any use other than that intended. The use of attachments that are not recommended or sold by the unit manufacturer may cause risk of injury to persons. The power cable cannot be replaced. If the power cable is damaged, dispose of the unit. The maximum operating depth for the unit is 1 m. If the operating depth of the unit is greater than 1 m, this will not affect the performance of the unit but the water spray will be reduced or not visible. Always disconnect the power plug before carrying out cleaning or maintenance work.

WARNING: Always disconnect all units in the pond from the power supply or switch them off before carrying out any maintenance work/reaching into the pond. A residual current device (RCD) with a rated residual operating current not exceeding 30 mA must be integrated in the power supply circuit of the unit. Only operate the unit in water with a water temperature of +4°C to max. +35°C.

WARNING: Never operate the UV-C emitter when it is removed from the unit housing.

- For cleaning garden ponds.
- For creating a water fountain in a pond.
- For operation with clean water.
- Only operate with water at a water temperature of +4 °C to +35 °C.
- Operate in accordance with instructions.

The following restrictions apply to the unit:

- Do not use in swimming ponds.
- Never run the unit without water.
- Never use the unit with fluids other than water.
- Do not use in conjunction with chemicals, foodstuff, easily flammable or explosive substances.
- Do not use for commercial or industrial purposes.
- **Concerning:**
 - precautions to be taken when replacing UV-C emitters.
 - This appliance contains a UV-C emitter.
 - Unintended use of the appliance or damage to the housing may result in the escape of dangerous UV-C radiation. UV-C radiation may, even in little doses, cause harm to the eyes and skin.

- Appliances that are obviously damaged must not be operated.
- The replacement of the UV-C emitter is allowed by qualified electrician, and it is better be replaced by qualified electrician of the manufacture. And the type of UV-C emitter must only be provided by the manufacture only. Only use UV-C lamps the designation and rating of which match the information on the type plate.
- Read the maintenance instructions before opening the appliance.
- The appliance must be disconnected from the supply before replacing the UV-C emitter.
- **WARNING:** Disconnect the appliance from the supply before carrying out maintenance.
- Operation under observance of the technical data.

The following restrictions apply to the appliance:

- Do not use in swimming ponds.
- Never use the appliance to convey fluids other than water.
- Never run the appliance without water.
- Hazards encountered by the combination of water and electricity
- The combination of water and electricity can lead to death or severe injury from electrocution, if the appliance is incorrectly connected or misused.
- Do not use in conjunction with chemicals, foodstuff, easily flammable or explosive substances.
- Do not use for commercial or industrial purposes.

Installation and connection How to proceed

1. Assemble the nozzle unit if necessary, and fit it onto the outlet.
 - The spray pattern can be changed by the use of different nozzles as shown in Fig. A.
2. As an option: A cord can be attached to the retaining ring on the underside of the unit to anchor the unit to the ground. It can be attached to a stone with a suitable weight such that the unit floats in the water with only the nozzle attachment above the water. The stone is intended to prevent the unit from being blown about on the water by the wind (see Fig. B). The unit can be used without attaching it to a stone. This will not affect its performance. If the unit is not securely fastened to the stone or if no stone is used, the unit may be blown about in the water by the wind, which can lead to the unit being disconnected from the electrical socket, leading to the risk of leakage current.
3. Place the unit upright into the water so that it can float.
4. Route the connection cable to the socket.
 - The unit can be connected to a fixed indoor or outdoor socket. The socket used may be fixed in a wall or in the ground. If an outdoor socket is used, ensure that it has a moisture protection rating of at least IPX4. The fixed socket must be installed with an enclosure as shown in Fig. B in order to comply with protection rating IPX4.
 - Do not use portable sockets for the unit power supply. Otherwise there is a risk of electric shock if the portable socket falls into the water.
 - Ensure that the socket is installed at least 2 m from the edge of the pond. Socket installations must comply with the national regulations and may only be carried out by a qualified electrician.
 - Switching on: Connect the connection cable to the mains. The LEDs will light up, the pump and UVC will immediately start operating.

- Switching off: Disconnect the connection cable from the mains.

Remedy of faults

Malfunction	Cause	Remedy
LEDs are not lit	No mains connection	Connect the connection cable to the mains.
	Connection defective	Check the electrical connection.
No water flowing out of the nozzle unit, or insufficient or no pump delivery.	The nozzle unit is clogged.	Remove and clean the nozzle unit.
	The coarse dirt filter is clogged.	Clean the coarse dirt filter.
	The pump filter housing is soiled.	Clean the pump filter housing.
	The impeller unit is blocked.	Clean the pump.
	The impeller unit is worn.	Replace the impeller unit.
	Foam filter clogged	Clean or replace the foam filter.
The filtering performance of the unit is not satisfactory.	The unit has only been in operation for a short time.	The full biological cleaning effect is only achieved after several weeks.
	The water is extremely soiled.	Remove algae and leaves from the pond, change the water
	The quartz glass is soiled.	Remove the UVC and clean the quartz glass.
	The UVC lamp is defective or its capacity is exhausted.	Replace the UVC lamp.

Maintenance and cleaning

Unplug and disconnect from the power supply before maintenance and cleaning. The unit has to be taken out of the water for cleaning or maintenance.

WARNING: Unplug or switch off all appliances in the pond before carrying out maintenance.

WARNING

Possible death or severe injury from hazardous electrical voltage!

Cleaning the device

Recommendation regarding cleaning:

- Clean the unit as required but at least twice a year.
- When cleaning the pump, pay particular attention to the cleaning of the impeller unit and pump housing.
- Do not use aggressive cleaning agents or chemical solutions as they could attack the housing or impair the function of the unit.
- Recommended cleaning agent for removing stubborn limescale deposits:
 - Vinegar- and chlorine-free household cleaning agent.

- Clean the outside of the pump.
 - Use a soft brush as an aid.
- After cleaning, thoroughly rinse all parts in clean water.

How to proceed

1. Clean the float unit.
2. Dismantle and clean the nozzle unit.
3. Disassemble the unit. (→ Clean the coarse dirt filter)
4. Clean the filter housing of the pump and impeller unit. (→ Replacing the impeller unit)
5. Clean the UVC water housing and quartz glass. (→ Cleaning the UVC water housing and quartz glass)
6. Reassemble the unit in the reverse order.

Clean the coarse dirt filter How to proceed:

1. Release the net from the coarse dirt filter and remove.
 - The net is attached to the filter with hooks at 4 points.
2. Undo the screw and remove.
3. Turn the coarse dirt filter in the direction OPEN as shown by the arrow.
4. Lift the float unit from the coarse dirt filter and clean the inside and outside of the filter.

Replacing the impeller unit How to proceed

1. Pull the pump (covered by the foam filter) from the pipe bend and then take it out of the foam filter. E
2. Pull the filter housing from the pump (bayonet closure).
3. Pull out the impeller unit and clean or replace.
4. Reassemble the unit in the reverse order.

Cleaning the UVC water housing and quartz glass How to proceed

1. Remove the pump from the pipe bend. (For replacing the pump it must be replaced and provided by the manufacturer, its service agent or similarly qualified persons in order to avoid a hazard.)
2. Undo and remove the union nut from the UVC water housing by turning it counterclockwise.
3. Pull out the UVC unit.
4. Clean the UVC water housing on the inside and outside.
5. Check the quartz glass for damage and wipe it on the outside with a damp cloth.
6. Reassemble the unit in the reverse order.

Exchange the UVC lamp

The UV-C emitter may only be replaced by a qualified electrician, preferably by a qualified electrician from the manufacturer's company. The UV-C emitter type may only be provided by the manufacturer of the original unit. Only use UV-C lamps, the designation and capacity data of which correspond to the information on the unit type plate. The unit must always be disconnected from the power supply before the UV-C emitter is replaced.

CAUTION

Quartz glass and UVC lamp can break and cause cut injuries.

The UV-C lamp has to be replaced after approx. 8000 operating hours. Only use UV-C lamps the designation and rating of which match the information on the type plate. To replace the UVC lamp open the UVC water housing. (→ Cleaning the UVC water housing and quartz glass)

How to proceed

1. Remove the quartz glass by carefully turning and pulling it off the UVC lamp.
2. Pull the UVC lamp out of the lamp socket and replace it with a new one.
3. Observe the following: The anti UV silica gel must be inserted into the quartz glass first. Never remove the silica gel. If there is no silica gel inside the quartz glass, the UV rays may cause damage, see Fig. F.
4. Reassemble the unit in the reverse order.
5. The LED lamps are only for decoration. For replacing the LED lamp it must be replaced and provided by the manufacturer, its service agent or similarly qualified persons in order to avoid a hazard.

Wear parts

- Foam filter
- Impeller unit
- UVC lamp, quartz glass and O ring for quartz glass

Storage/Over-wintering

Remove the unit at temperatures below zero degrees centigrade. Thoroughly clean the unit, check for damage and store immersed in water in a frost-free environment. Do not immerse the plug!

Correct Disposal of this product



NOTE

This marking indicates that this product should not be disposed with other household wastes throughout the EU. To prevent possible harm to the environment or human health from uncontrolled waste disposal, recycle it responsibly to promote the sustainable reuse of material resources. To return your used device, please use the return and collection systems or contact the retailer where the product was purchased. They can take this product for environmental safe recycling.

Guarantee conditions

PfG grants a 2 year guarantee from the date of sale on proven material and manufacturing faults. Wear parts such as bulbs etc. are exempted from the guarantee. Prerequisite for our guarantee is the presentation of the purchase receipt. Our guarantee will become null and void if the unit is misused, electrically or mechanically damaged by inappropriate use and improper repair by non-authorized workshops. Repairs are reserved for workshops authorized by PfG or by PfG itself. In the case of warranty claims, please return the defective unit or part freight paid to PfG together with a description of the fault and the purchase receipt. PfG reserves the right to invoice repair costs. PfG is not liable for transport damage. Any damage must be claimed against the carrier. Further claims of whatever type, especially consequential damage, are excluded. This guarantee does not affect the final customer's claims against the dealer.

Documents / Resources

<div data-bbox="140 98 172 120"></div> <div data-bbox="140 120 193 197"><p>1. Produktbeschreibung 2. Technische Daten 3. Montageanleitung 4. Wartung 5. Sicherheitshinweise 6. Garantie 7. Kontakt 8. Sonstiges</p></div> <div data-bbox="165 224 268 235"><p>PondoClear Island 3000</p></div> <div data-bbox="181 255 248 309"></div>	<p>pontec PondoClear Island 3000 Unique Floating Pond Filter [pdf] Instruction Manual PondoClear Island 3000 Unique Floating Pond Filter, PondoClear Island 3000, Unique Floating Pond Filter, Floating Pond Filter, Pond Filter, Filter</p>
---	--