



---

# Polyvance 6074 Nitro Fuser Accessory Shelf Installation Guide

July 3,  
2025

## Contents [ [hide](#) ]

### [1 Accessory Shelf 6074](#)

#### [1.1 Product Information and Installation Instructions](#)

##### [1.1.1 Benefits:](#)

##### [1.1.2 Features:](#)

##### [1.1.3 Installation Instructions:](#)

### [2 Documents / Resources](#)

#### [2.1 References](#)

## Accessory Shelf 6074

### Product Information and Installation Instructions

Tools not included.



Polyvance's 6074 Accessory Shelf can be attached to any flat-topped Polyvance nitroden welder to provide convenient storage of tools and accessories during plastic repair. The shelf easily folds out of the way when not in use to save shop space.

**Benefits:**

- Safely holds tools like grinders, cutters, and sanders.
- Installs easily.
- Increases the utility of the welding cart set-up
- Folds out of the way when not in use.

**Features:**

- Powder-coated, 16 gauge steel for durability.
- Bolted design for strength and simplicity.
- Slotted edge design to hold extra air tools.
- 10 lb weight limit
- Open dimensions: 16.8 in x 9.4 in x .75 in 42.7 cm x 23.9 cm x 1.9 cm
- Closed dimensions: 10.5" x 9.4" x .81" 26.7 cm x 23.9 cm x 1.9 cm

**Installation Instructions:**

**1:** Align the sides of the drilled stationary shelf with the edges of the welder and mark the hole locations onto the welder top.

**2:** Lightly centerpunch the (4) hole locations onto the top.

**3:** Remove the (8) screws that secure the top to the welder.

**4:** Mark the top yellow wire with tape to identify it later and unplug the (3) wires going to the trigger switch.

**5:** With the lid removed, drill (4) 1/4" holes where marked. **DO NOT DRILL WITH THE LID ON THE WELDER!**

**6:** Deburr the holes.

**7:** Securely fasten the shelf to the lid with (4) 1/4" bolts and locknuts. Tighten firmly.

**8:** Install the hinged part of the shelf with the remaining 2 bolts and locknuts. Do not fully tighten or you will not be able to fold the shelf.

**9:** Reconnect the wires in the same order as removed .

**10:** Reinstall the lid, taking care not to overtighten the screws.

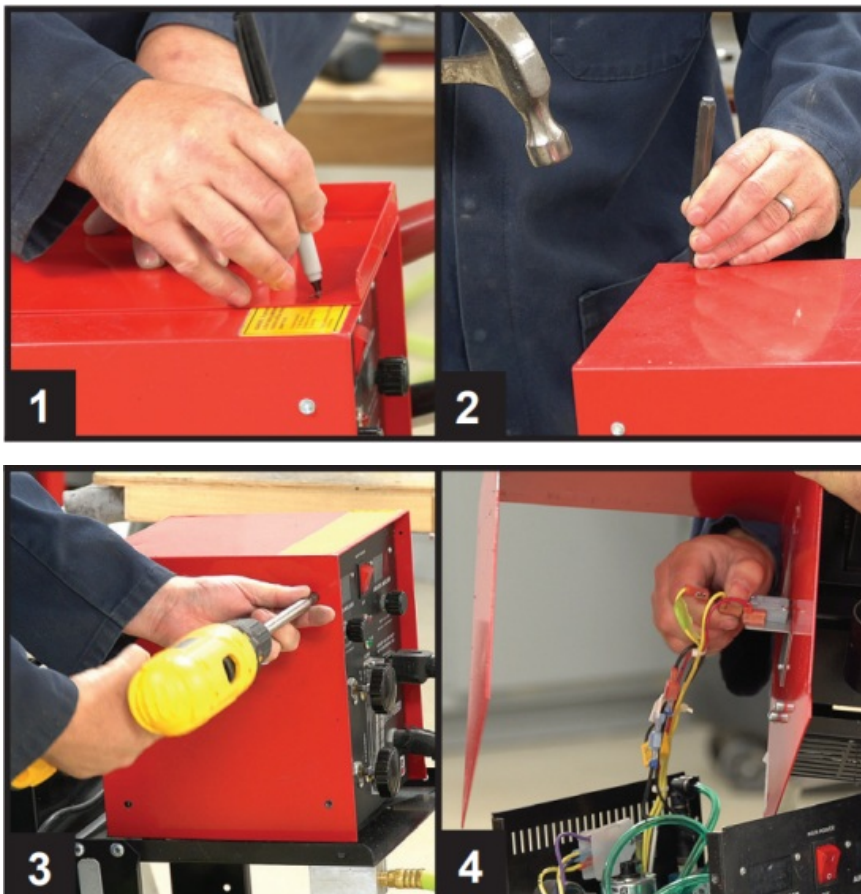

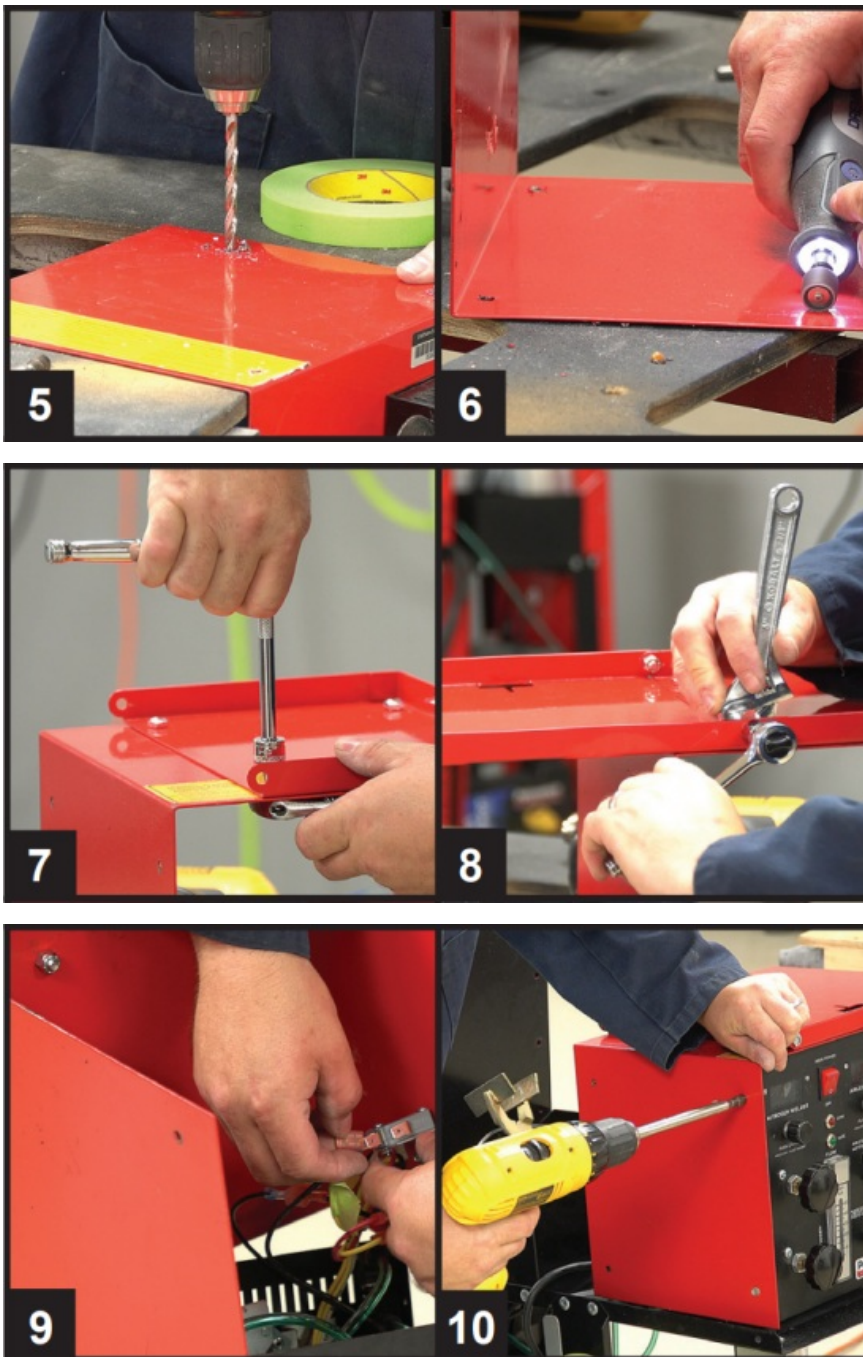

**Customer Support:**

**Toll Free: [800-633-3047](tel:800-633-3047)**

**Phone: [256-638-4103](tel:256-638-4103)**

**[www.polyvance.com](http://www.polyvance.com)**

1128 Kirk Rd. Rainsville, AL 35986-6028 USA

6074 installationsheet.indd 09/16

# Documents / Resources



[Polyvance 6074 Nitro Fuser Accessory Shelf \[pdf\]](#) Installation Guide  
6074, 6074 Nitro Fuser Accessory Shelf, 6074, Nitro Fuser Accessory Shelf, Fuser Accessory Shelf, Accessory Shelf

## References

- [User Manual](#)

📁 Polyvance  
🔍 6074, 6074 Nitro Fuser Accessory Shelf, Accessory Shelf, Fuser Accessory Shelf, Nitro Fuser Accessory Shelf, Polyvance

---

## Leave a comment

Your email address will not be published. Required fields are marked \*

Comment \*

Name

Email

Website

☐ Save my name, email, and website in this browser for the next time I comment.

**Post Comment**

## Search:

e.g. whirlpool wrf535swhz

**Search**

[Manuals+](#) | [Upload](#) | [Deep Search](#) | [Privacy Policy](#) | [@manuals.plus](#) | [YouTube](#)

This website is an independent publication and is neither affiliated with nor endorsed by any of the trademark owners. The "Bluetooth®" word mark and logos are registered trademarks owned by Bluetooth SIG, Inc. The "Wi-Fi®" word mark and logos are registered trademarks owned by the Wi-Fi Alliance. Any use of these marks on this website does not imply any affiliation with or endorsement.