

**poly Voyager 5200 UC Bluetooth Headset System**



# poly Voyager 5200 UC Bluetooth Headset System Instruction Manual

[Home](#) » [Poly](#) » poly Voyager 5200 UC Bluetooth Headset System Instruction Manual 

## Contents

- 1 poly Voyager 5200 UC Bluetooth Headset System
- 2 Specifications
- 3 Product Usage Instructions
- 4 CHARGING
- 5 OVERVIEW
- 6 POWER
- 7 CONNECTION
- 8 LOCK/UNLOCK
- 9 MORE INFORMATION
- 10 Frequently Asked Questions
- 11 Documents / Resources
  - 11.1 References
- 12 Related Posts



**poly Voyager 5200 UC Bluetooth Headset System**



## Specifications

- **Product Name:** Poly Voyager 5200
- **Mobile App:** Poly Lens Mobile App
- **Desktop App:** Poly Lens Desktop App
- **Compatibility:** Siri/Google Assistant
- **V5200 Series Version:** 04

## Product Usage Instructions

### Setting Up the Poly Voyager 5200

To begin using your Poly Voyager 5200, follow these steps:

1. Charge the device fully using the provided charger.
2. Power on the device by pressing and holding the power button until you see the indicator light.
3. Pair the headset with your smartphone or computer via Bluetooth.

## Using the Poly Lens Mobile App

The Poly Lens Mobile App enhances the functionality of your Voyager 5200. Follow these steps to utilize the app:

1. Download and install the Poly Lens Mobile App from your device's app store.
2. Open the app and follow the on-screen instructions to connect it to your Voyager 5200 headset.
3. Explore the various features offered by the app, such as customizing settings and updating firmware.

## Using the Poly Lens Desktop App

The Poly Lens Desktop App provides additional configuration options for your Voyager 5200. Here's how to make the most of it:

1. Download and install the Poly Lens Desktop App from the official website.
2. Launch the app on your computer and connect your Voyager 5200 headset to it.
3. Access advanced settings, manage multiple devices, and optimize your headset's performance through the desktop app.

## CHARGING

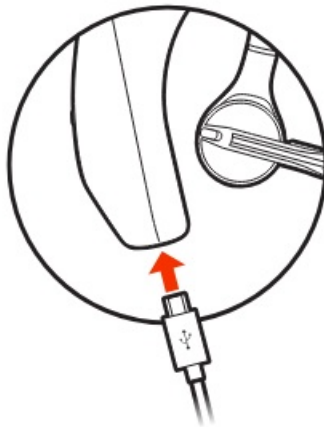

## OVERVIEW

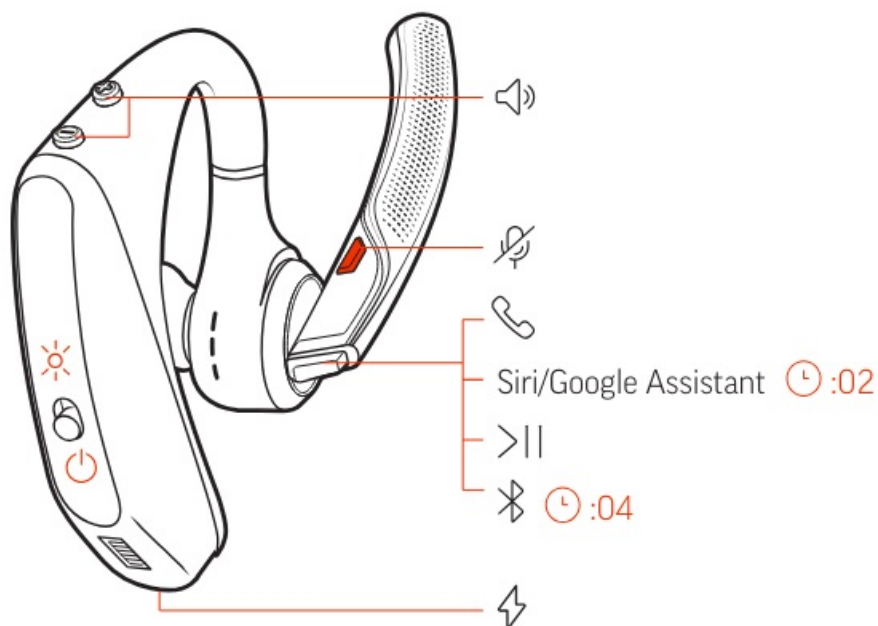

## POWER

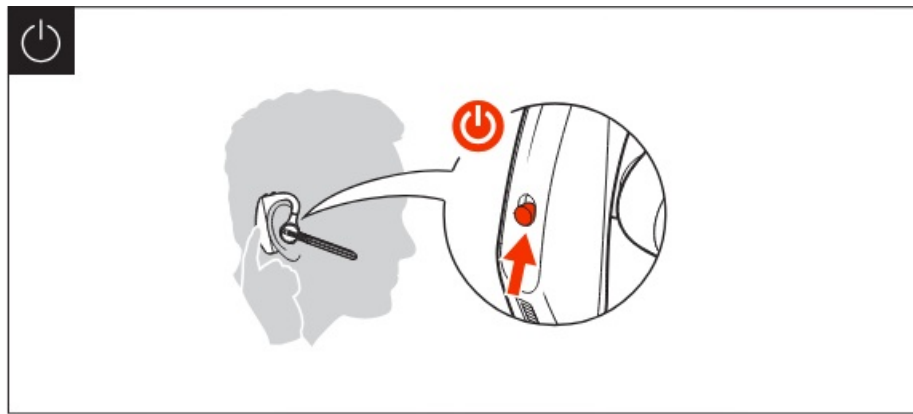

## CONNECTION

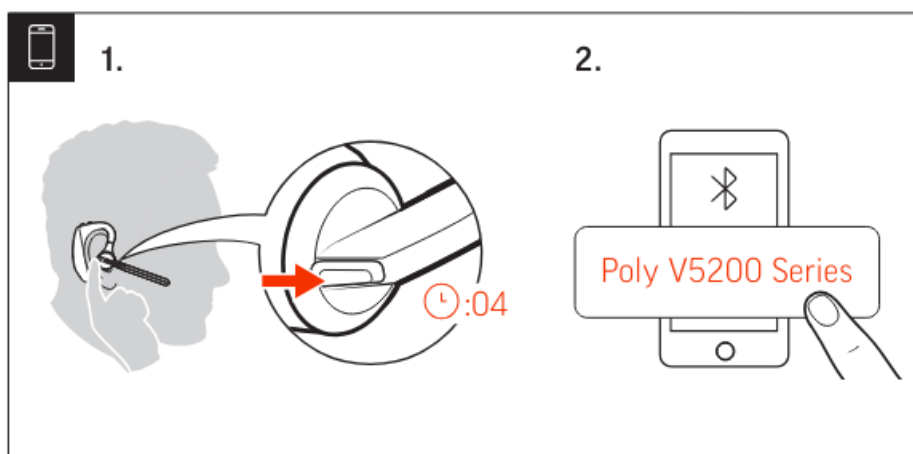

## LOCK/UNLOCK

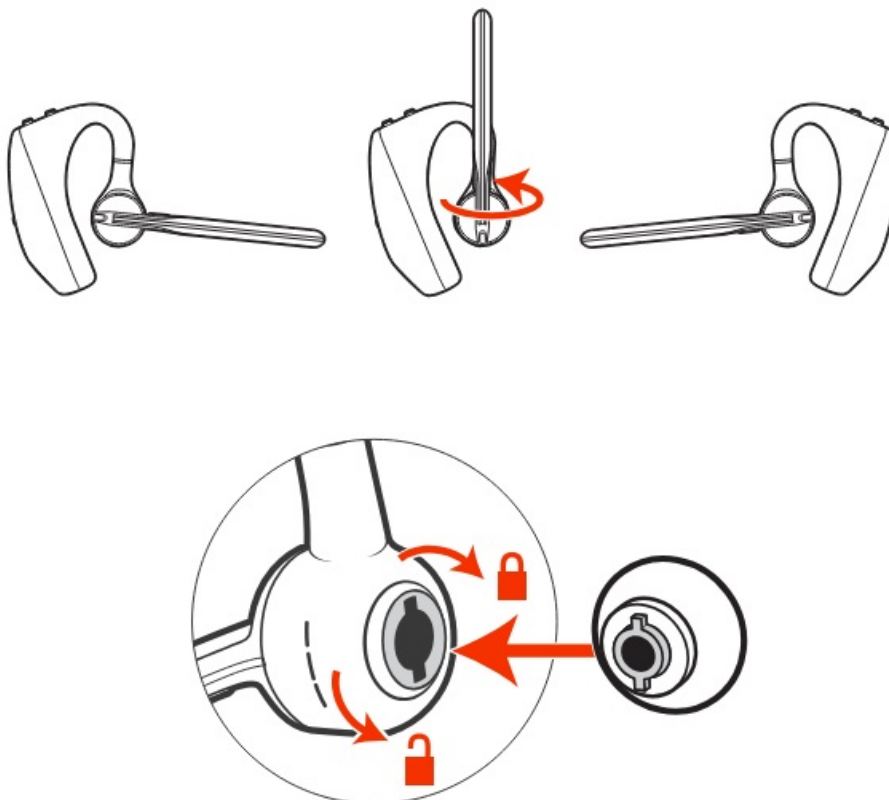

## MORE INFORMATION

Poly Voyager 5200



[hp.support.com/poly](https://hp.support.com/poly)



[poly.com/lens](https://poly.com/lens)

- Poly Lens Mobile App
- Poly Lens Desktop App

© 2023 Poly. Bluetooth is a registered trademark of Bluetooth SIG, Inc. All trademarks are the property of their respective owners.

## Frequently Asked Questions

- **Q: How do I activate Siri or Google Assistant with my Voyager 5200?**
  - A: To activate Siri or Google Assistant, simply press the designated voice command button on your Voyager 5200 for 2 seconds (Siri) or 4 seconds (Google Assistant).
- **Q: How can I update the V5200 Series to version 04?**
  - A: To update your V5200 Series headset to version 04, visit [hp.support.com/poly](https://hp.support.com/poly) and follow the provided instructions for firmware updates.

---

## Documents / Resources



[poly Voyager 5200 UC Bluetooth Headset System](#) [pdf] Instruction Manual  
Voyager 5200 UC Bluetooth Headset System, Voyager 5200, UC Bluetooth Headset System, Bluetooth Headset System, Headset System, System

References

- [User Manual](#)

Manuals+. [Privacy Policy](#)

This website is an independent publication and is neither affiliated with nor endorsed by any of the trademark owners. The "Bluetooth®" word mark and logos are registered trademarks owned by Bluetooth SIG, Inc. The "Wi-Fi®" word mark and logos are registered trademarks owned by the Wi-Fi Alliance. Any use of these marks on this website does not imply any affiliation with or endorsement.