



polk Signa S2D Sound Bar with Wireless Subwoofer User Guide

[Home](#) » [polk](#) » polk Signa S2D Sound Bar with Wireless Subwoofer User Guide 

Contents

- [1 Polk Signa S2D Sound Bar with Wireless Subwoofer](#)
- [2 Product Information](#)
- [3 What's in the Box](#)
- [4 What's in the Box](#)
- [5 Remote Control](#)
- [6 Sound Bar Top Panel](#)
- [7 Sound Bar Back Panel](#)
- [8 Sound Bar Bottom Panel](#)
- [9 Optimizing Your Listening Experience](#)
- [10 Music Listening](#)
- [11 Specifications](#)
- [12 Documents / Resources](#)
 - [12.1 References](#)



Polk Signa S2D Sound Bar with Wireless Subwoofer



Product Information

Signa S2DTM Sound Bar

The Signa S2DTM is a sound bar system that includes a sound bar and a wireless subwoofer. It supports HDMI (ARC) and optical connections for Dolby 5.1 decoding. The sound bar has a remote control and top panel controls for power, Bluetooth, volume, bass control, and dialogue volume levels. It also has movie and music modes and a night effect mode for low-volume listening.

What's in the Box

- Soundbar
- Wireless subwoofer
- Soundbar power cord
- Subwoofer power cord
- Remote control (with AAA batteries)
- Spacers
- HDMI cable
- Quick start guide and safety instructions

Connecting Your Signa S2D to Your TV

1. Check if your TV has an HDMI port labeled ARC. If yes, follow step 2. If no, follow step 4.
2. Connect the included HDMI cable to the HDMI ports labeled with ARC on both the TV and the sound bar.
Connect the sound bar power cord and position the subwoofer. For best performance, place it on the same wall as the TV.
3. If you prefer an optical connection, connect an optical cable (sold separately) between the TV and the sound bar. Then, connect the included HDMI cable to any available HDMI port on the TV and to the TV (HDMI ARC) port on the sound bar.
4. If your TV does not have ARC or optical ports, connect the sound bar to your TV using an analog AUX cable (not included).

Re-establishing Wireless Subwoofer Connection

If your wireless subwoofer stops receiving an audio signal, follow these instructions to re-establish the connection:

1. Turn on your sound bar.
2. Press and hold the BAR SYNC button on the back of the subwoofer for 3 seconds.
3. Simultaneously press and hold Bluetooth and VOL + buttons on the sound bar for 5 seconds.
4. The sound bar will search for a connection while the first and second LEDs on the sound bar flash intermittently. The lights will stop flashing when the sound bar and subwoofer connect. If the sound bar and subwoofer fail to connect, the first and second LEDs will flash together 5 times. Repeat the steps above to establish a connection.

Optimizing Your Listening Experience

You can easily adjust bass volume for more or less impact using the bass control. The movie mode enhances audio reproduction in TV and movies, while the music mode enhances audio whenever you're listening to music or watching TV or movies that have music playing in them. The night effect mode reduces bass and volume dynamics while improving voice intelligibility for low-volume listening. You can also isolate and adjust the voice channel level to reproduce clear, crisp dialogue.

Setting Up Bluetooth

1. To enable Bluetooth, press the Bluetooth button on the sound bar or remote control. A blue LED will pulse on the sound bar.
2. Go to the Bluetooth devices section on your phone, tablet, or computer and select Polk Signa S2. The LED is solid blue when Bluetooth is connected.
3. To take control when another device is connected, press the Bluetooth button.

Thank you for your Polk purchase. If you have a question or comment, please feel free to call or email us. Visit support.polkaudio.com to obtain contact information for your region.

What's in the Box

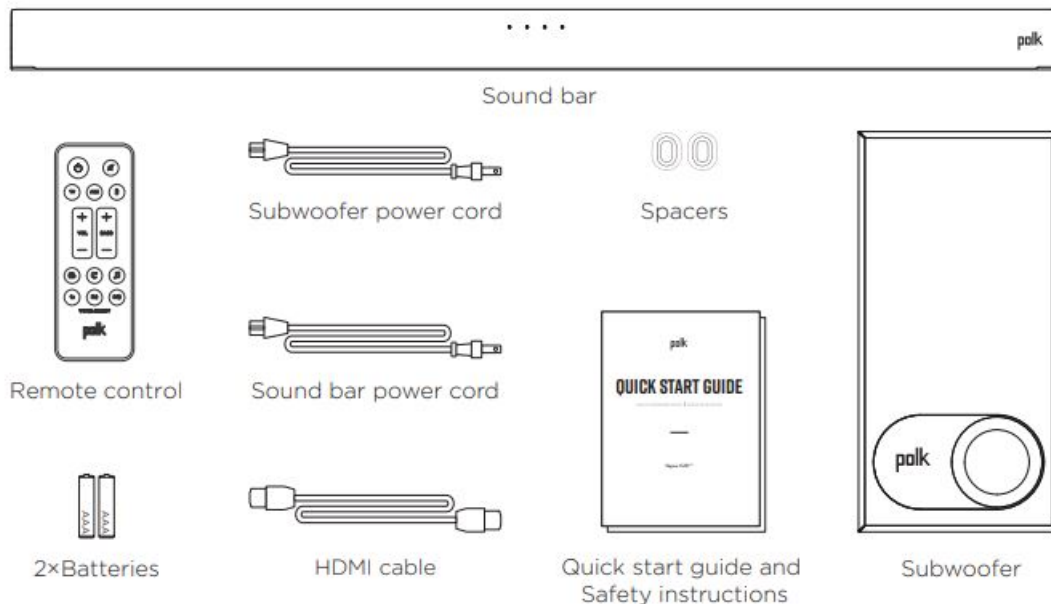

Connecting Your Signa S2D to Your TV

1. Is an HDMI port on your TV labeled “ARC”?

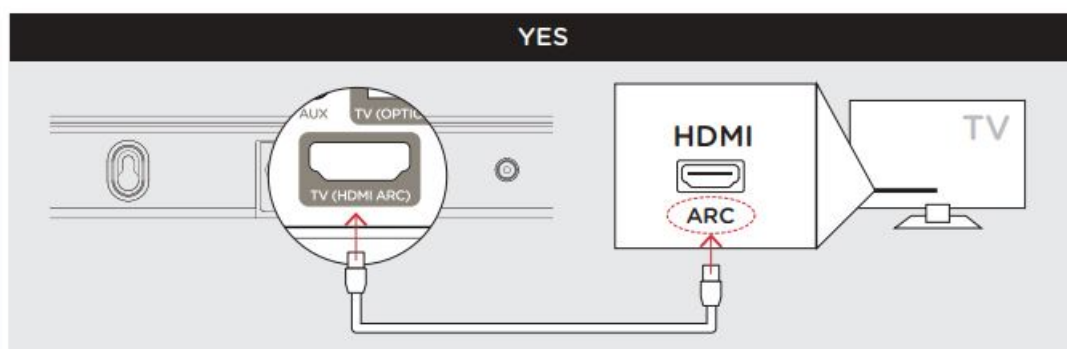

- Connect the included HDMI cable to the HDMI ports labeled with “ARC” on both the TV and the sound bar
- Connect an Optical cable (sold separately) between the TV and the sound bar.

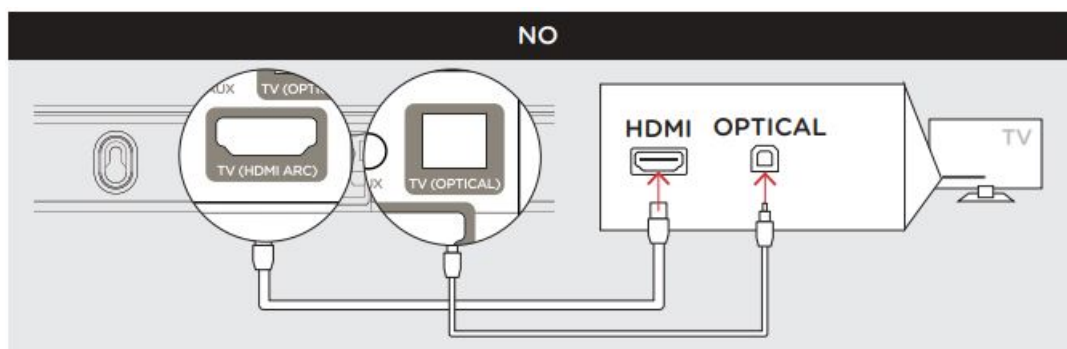

- Then, connect the included HDMI cable to any available HDMI port on the TV and to the “TV (HDMI ARC)” port on the sound bar
- **NOTE:** HDMI (ARC) and optical connections support Dolby 5.1 decoding

Install the remote batteries

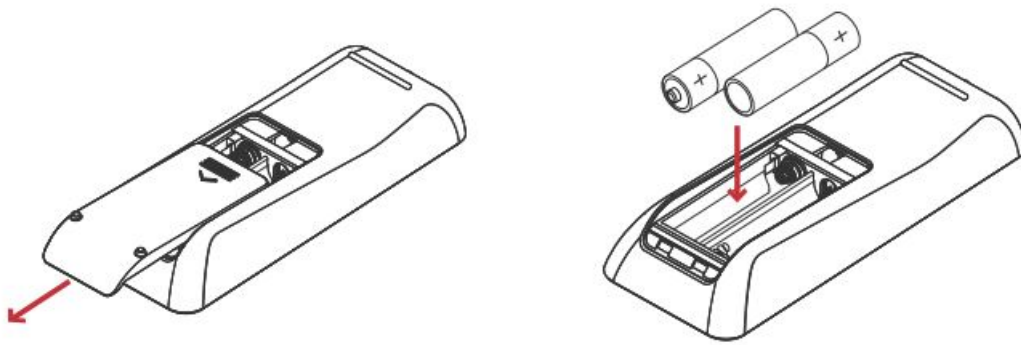

- Connect the sound bar power cord



- Position the subwoofer and connect it to an AC outlet. For best performance, place it on the same wall as the TV.

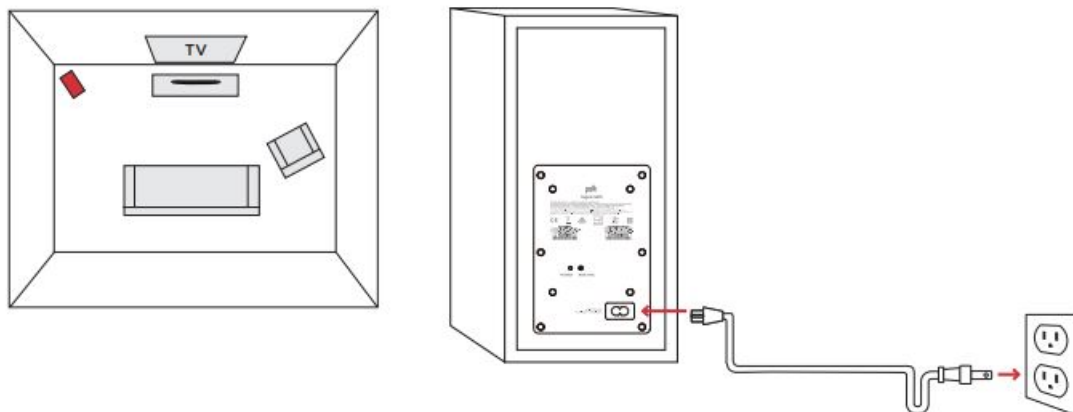

- **NOTE:** The Signa S2D sound bar and wireless subwoofer are preset at the factory to work together. Should your wireless subwoofer stop receiving an audio signal, follow these instructions to re-establish the connection:

1. Turn on your sound bar.
2. Press and hold the BAR SYNC button on the back of the subwoofer for 3 seconds.
3. Simultaneously press and hold Bluetooth and VOL + buttons on the sound bar for 5 seconds.

- The sound bar will search for a connection while the first and second LEDs on the sound bar flash intermittently. The lights will stop flashing when the sound bar and subwoofer connect.
- If the sound bar and subwoofer fail to connect, the first and second LEDs will flash together 5 times. Repeat the steps above to establish a connection.
- Turn on your sound bar.
- Press the Power button on the sound bar or remote.
- **NOTE:** Make sure TV internal speakers are off.

Remote Control

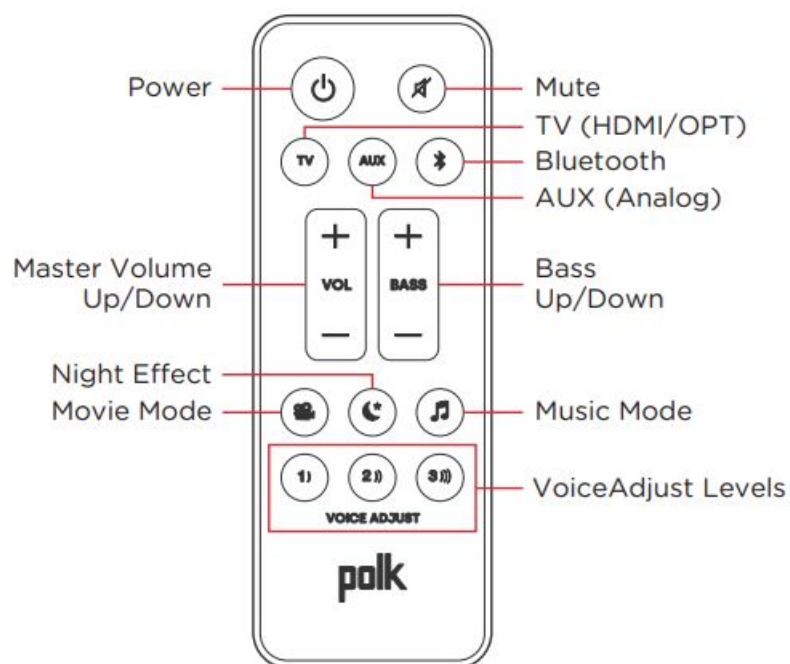

Sound Bar Top Panel

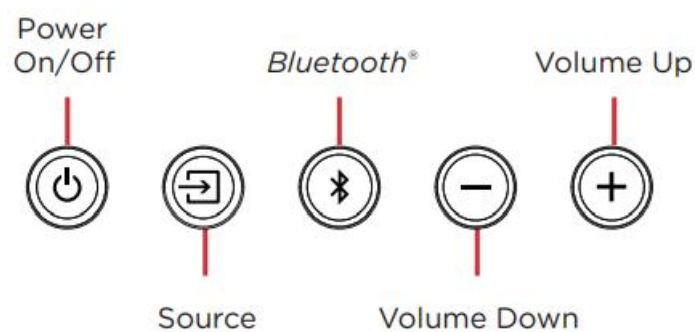

Sound Bar Back Panel

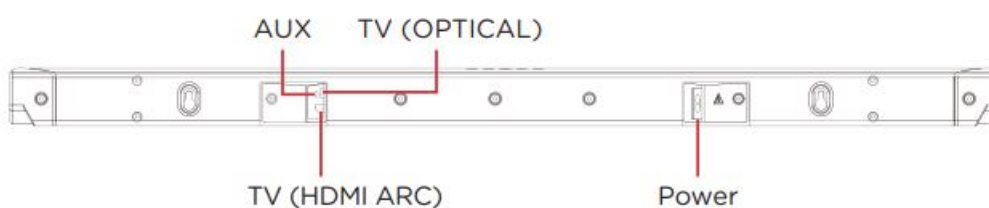

Sound Bar Bottom Panel

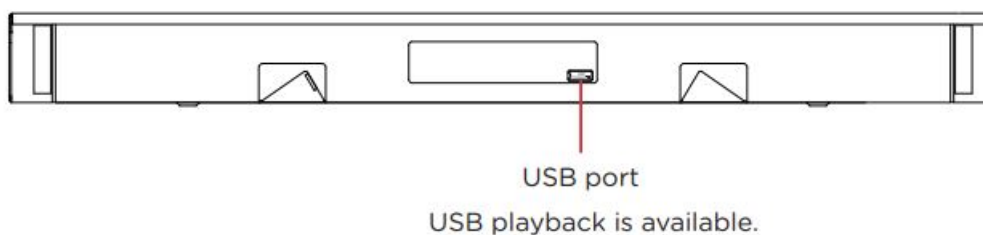

Sound Bar Lights

The Signa S2D has a row of lights that provide status indications, like source, volume and listening modes.

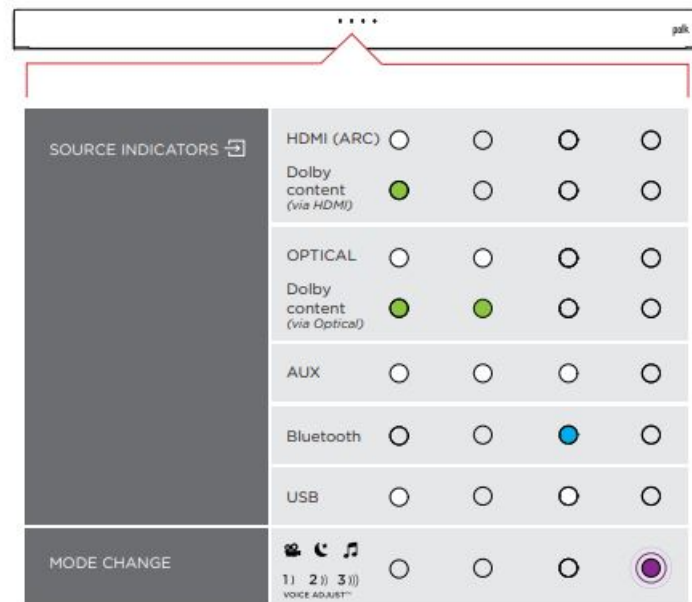

Optimizing Your Listening Experience

Bass Control
Control Bass Volume Levels

Easily adjust bass volume for more or less impact.

Movie Mode
Enhances audio reproduction in TV and movies.

Music Mode
Enhances audio whenever you're listening to music, or watching TV or movies that have music playing in them.

Night Effect
Reduces bass and volume dynamics while improving voice intelligibility for low-volume listening.

1) 2) 3))
VOICE ADJUST™
Control Dialogue Volume Levels
Isolate and adjust the voice channel level to reproduce clear, crisp dialogue.

Music Listening

How to Set Up Bluetooth

1. To enable Bluetooth, press the Bluetooth button on the sound bar or remote control. A blue LED will pulse on the soundbar



2. Go to the Bluetooth devices section on your phone, tablet or computer and select "Polk Signa S2". The LED is solid blue when Bluetooth is connected.

- **NOTE:** To take control when another device is connected, press the Bluetooth button.
- How to hear your TV again: When you are finished using
- Bluetooth, press the source button on the sound bar or remote (TV, AUX).

Bluetooth standby

- When a Bluetooth connection is made from a registered
- Bluetooth device, this unit turns on automatically.
- Press and hold the [TV] button for approximately 5 seconds.
- Bluetooth connection status lights
- **NOTE:** The default setting is “Off”

ON				
OFF				

Auto Standby

- When there is no input signal and operation for 15 minutes, this unit automatically enters Standby mode. The default setting is “OFF”. Press and hold the Night Mode (* button for approximately 5 seconds to set the Auto standby function to on off. The LEDs blink three times in the colors in the following table

ON				
OFF (Default)				

Specifications

Power supply:

- Operating temperature:
- **Power consumption:**
- Power consumption in standby mode:
- Power consumption in Bluetooth standby: 1.6 W Soundbar
- AC 100 – 240 V, 50/60Hz 5°C – 35°C 40 W 03 W
- Subwoofer AC 100 – 240 V, 50/60Hz 5°C – 35°C 40 W 0.26 W 1 W
- For more information, visit polkaudio.com/signas2d
- Dolby, Dolby Audio, and the double-D symbol are trademarks of Dolby Laboratories Licensing Corporation. Manufactured under license from
- Dolby Laboratories. Confidential unpublished works. Copyright [1992–2019] Dolby Laboratories.
- All rights reserved.
- The terms HDMI, HDMI High-Definition Multimedia
- Interface and the HDMI Logo are trademarks or registered trademarks of HDMI Licensing
- Administrator, Inc.
- The Bluetooth® word mark and logos are registered trademarks owned by the Bluetooth SIG, Inc. and any use of such marks by Polk Audio is under license. Other trademarks and trade names are those of their respective owners.



- 5541 Fermi Court Carlsbad, CA 92008, USA www.polkaudio.com
- Printed in China 5411 12026 00AK © 2022 Sound United. All Rights Reserved.
- For more information, visit polkaudio.com/signas2d

Documents / Resources

	polk Signa S2D Sound Bar with Wireless Subwoofer [pdf] User Guide Signa S2D Sound Bar with Wireless Subwoofer, Signa S2D, Sound Bar with Wireless Subwoofer, Signa S2D Sound Bar, Sound Bar
--	--

References

- P [Support Home Page](#)
- P [Polk Audio® | Great Sound for All](#)