

PHILIPS 9290040729 Outdoor Low Voltage Dusk Dawn Sensor



POLARIS XP1000 Radio And Intercom Bracket Installation Guide

[Home](#) » [Polaris](#) » POLARIS XP1000 Radio And Intercom Bracket Installation Guide 

Contents

- [1 POLARIS XP1000 Radio And Intercom Bracket](#)
- [2 HARDWARE AND TOOLS NEEDED](#)
- [3 INSTALLATION INSTRUCTIONS](#)
- [4 Contact](#)
- [5 Documents / Resources](#)
 - [5.1 References](#)
- [6 Related Posts](#)



POLARIS XP1000 Radio And Intercom Bracket



HARDWARE AND TOOLS NEEDED

PROVIDED HARDWARE

- (4) M4 x12 screws
- (4) M5 x12 screws
- (4) M5 washers
- (4) M5 Nylock nut

TOOLS NEEDED

- Oscillating tool or Dremel with cutoff wheel
- 1/4 drill bit
- 10mm socket
- Screwdriver
- Silver Sharpie
- Drill
- 8mm open ended wrench or socket tool
- 2.5mm Allen tool
- 3mm Allen tool

INSTALLATION INSTRUCTIONS

1. Remove glove box door from dash by firmly pulling door away and unsnapping from hinge.
2. Cut away the remaining hinge assembly from the bottom of the storage box so there are no protrusions.

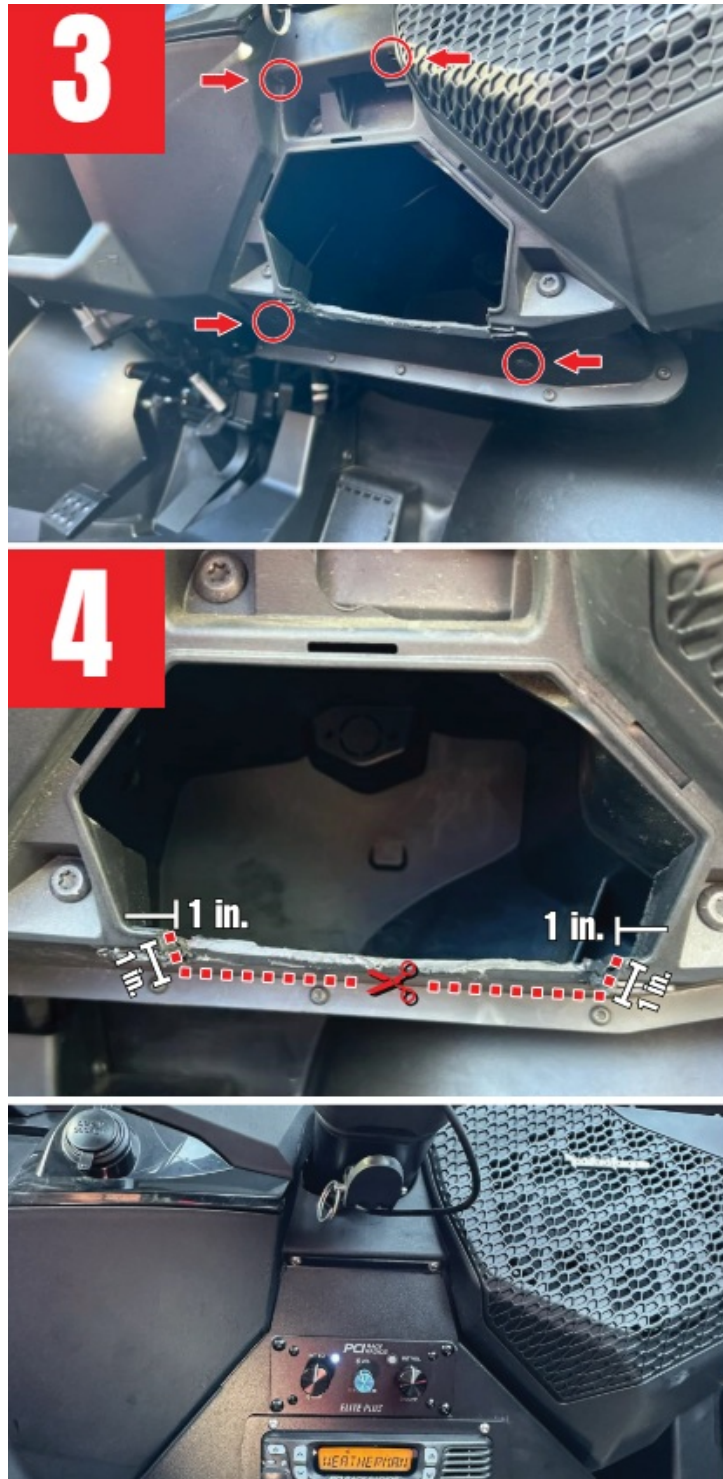

3. Hold up the bracket to the dash and use the bracket as a template to mark the four mounting screw locations with a silver Sharpie. Drill four holes using a 1/4" bit.
4. If you hold the bracket to the dash, you will see where the hinge needs to be cut to clear the radio and mount the bracket flush. Use the bracket as a template or measure and mark with a Sharpie, 1 inch inward from edges of hinge (towards center of hinge) and 1 inch back (towards front of car). Mark your cutout and then use an oscillating tool to remove this marked section.
5. Attach the bracket with the (4) sets of provided M5 hardware. All the drilled locations are accessible to reach behind it and attach the washer and Nylock nut. Use a 8mm open ended wrench or socket tool to securely tighten the hardware.

6. Route power, intercom cables, PTT's and coax. See intercom instructions for guidelines on cable routing.
7. Connect wiring to intercom and bolt into upper slot on bracket using black M4 hardware provided with intercom.
8. Attach radio to the beauty ring, connect coax and power and then attach the beauty ring to the bracket using provided M4 stainless screws.

Contact

- [562-427-8177](tel:562-427-8177)
- www.pciraceradios.com
- 6185 Phyllis Drive, Cypress, CA 90630



Documents / Resources

	<p>POLARIS XP1000 Radio And Intercom Bracket [pdf] Installation Guide XP1000 Radio And Intercom Bracket, XP1000, Radio And Intercom Bracket, Intercom Bracket, Bracket</p>
---	--

References

- [User Manual](#)

[Manuals±](#), [Privacy Policy](#)

This website is an independent publication and is neither affiliated with nor endorsed by any of the trademark owners. The "Bluetooth®" word mark and logos are registered trademarks owned by Bluetooth SIG, Inc. The "Wi-Fi®" word mark and logos are registered trademarks owned by the Wi-Fi Alliance. Any use of these marks on this website does not imply any affiliation with or endorsement.