

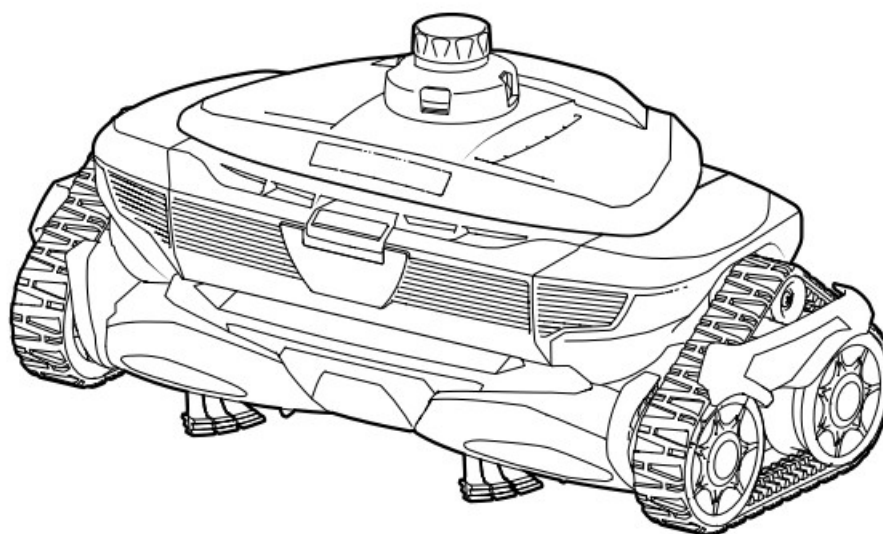

Polaris R0997900 Suction Cleaner Factory Tune Up Kit Instruction Manual

[Home](#) » [Polaris](#) » Polaris R0997900 Suction Cleaner Factory Tune Up Kit Instruction Manual 

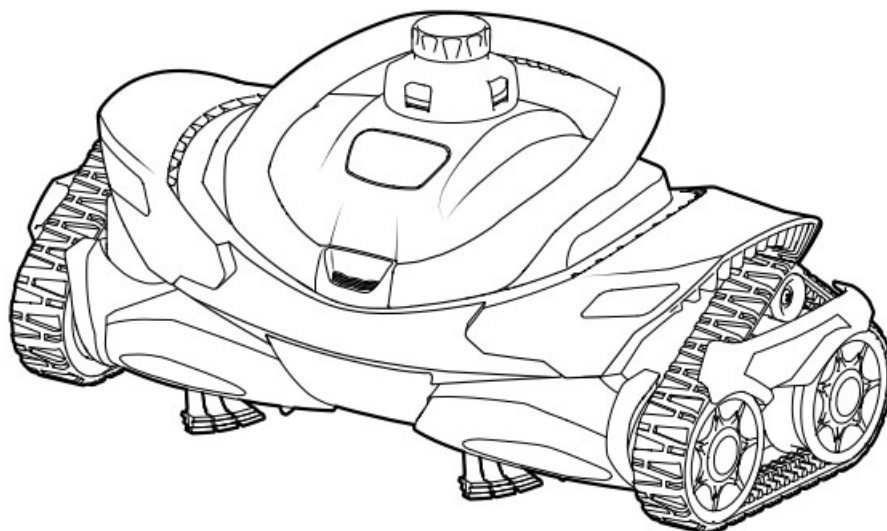



Installation Manual

Contents

1 Polaris Suction Cleaner Tune-Up Kit

2 Disassembly

3 Reassembly

4 Documents / Resources

4.1 References

Polaris Suction Cleaner Tune-Up Kit

These instructions are to be used with the following Polaris Tune-up Kit: R0997900



WARNING

WARNING – This product must be serviced by a qualified professional with sufficient experience in pool equipment installation and maintenance so that all of the instructions in the product's complete installation and operations manual can be followed exactly. All safety instructions in the complete manual must be followed explicitly in order to prevent injury hazards. Improper installation and/or operation may void the warranty.

Tool Required



Disassembly

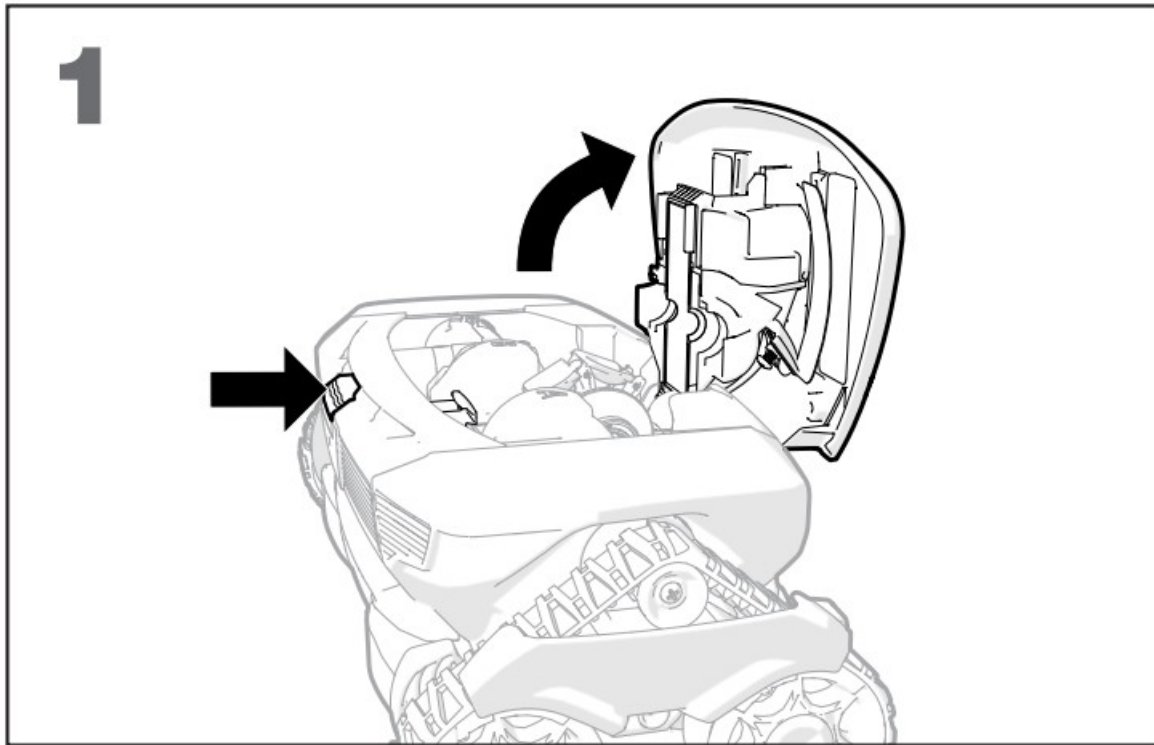

1. Press the release and open the lid.

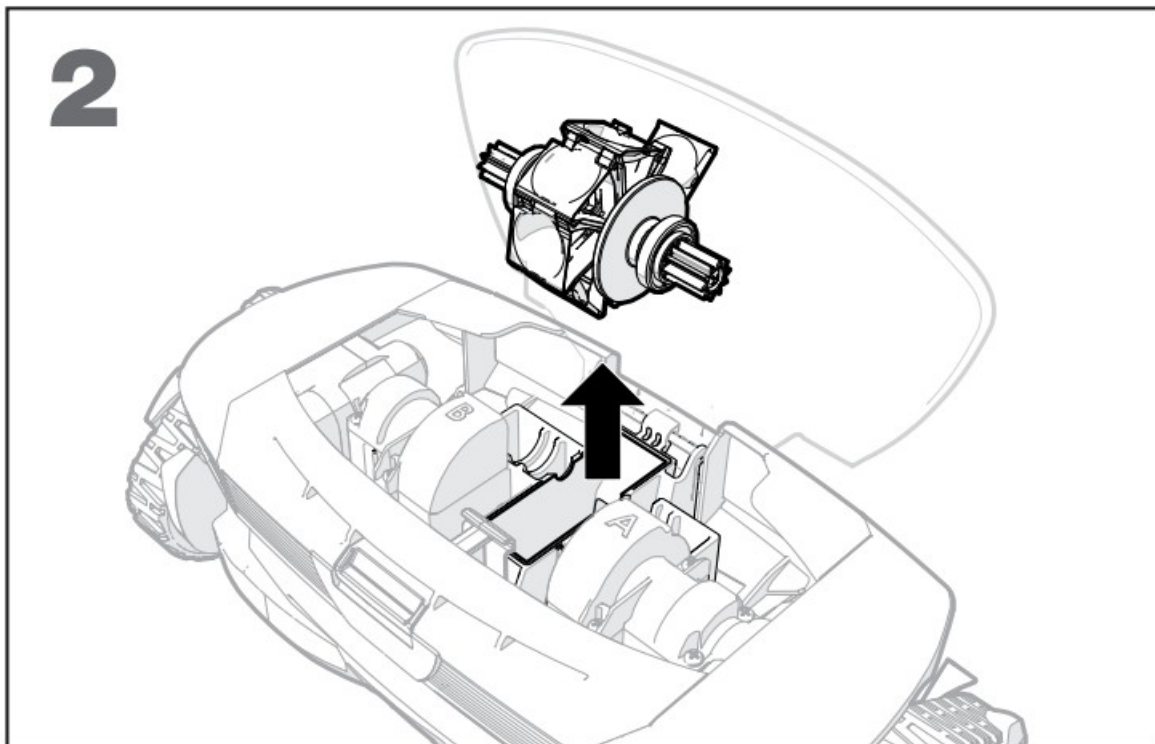

2. Pull the engine straight up to remove.

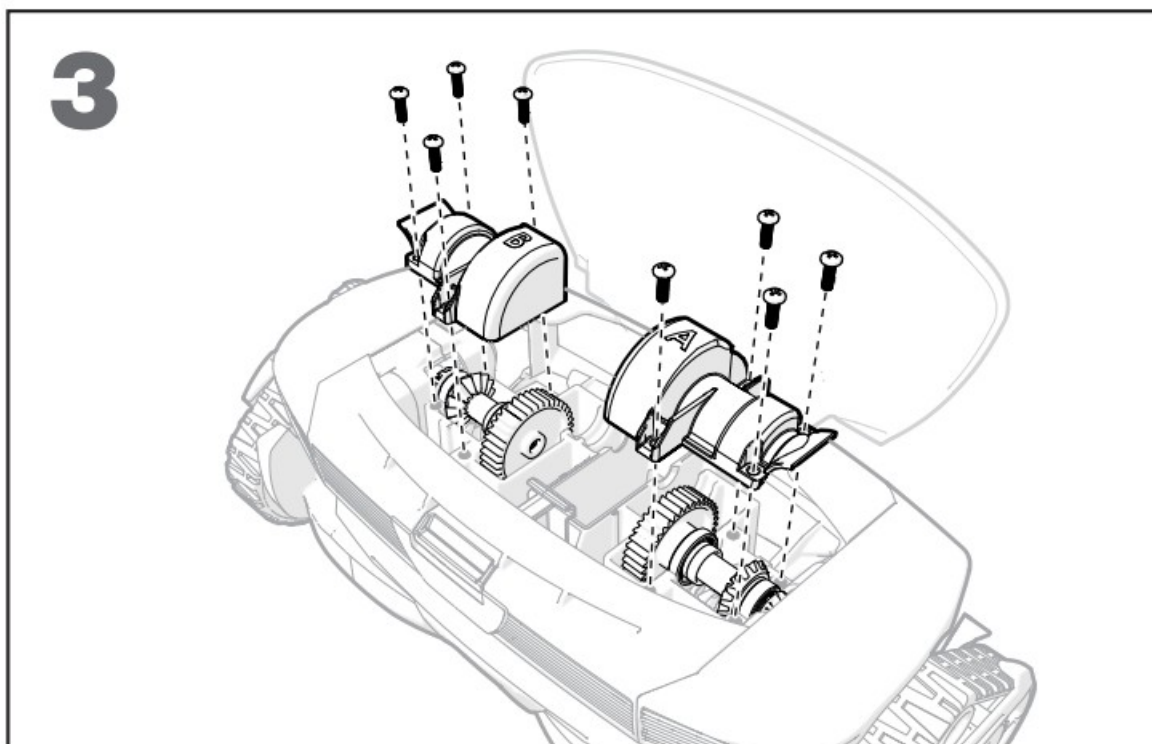

3. Remove 8 screws and the gear covers.

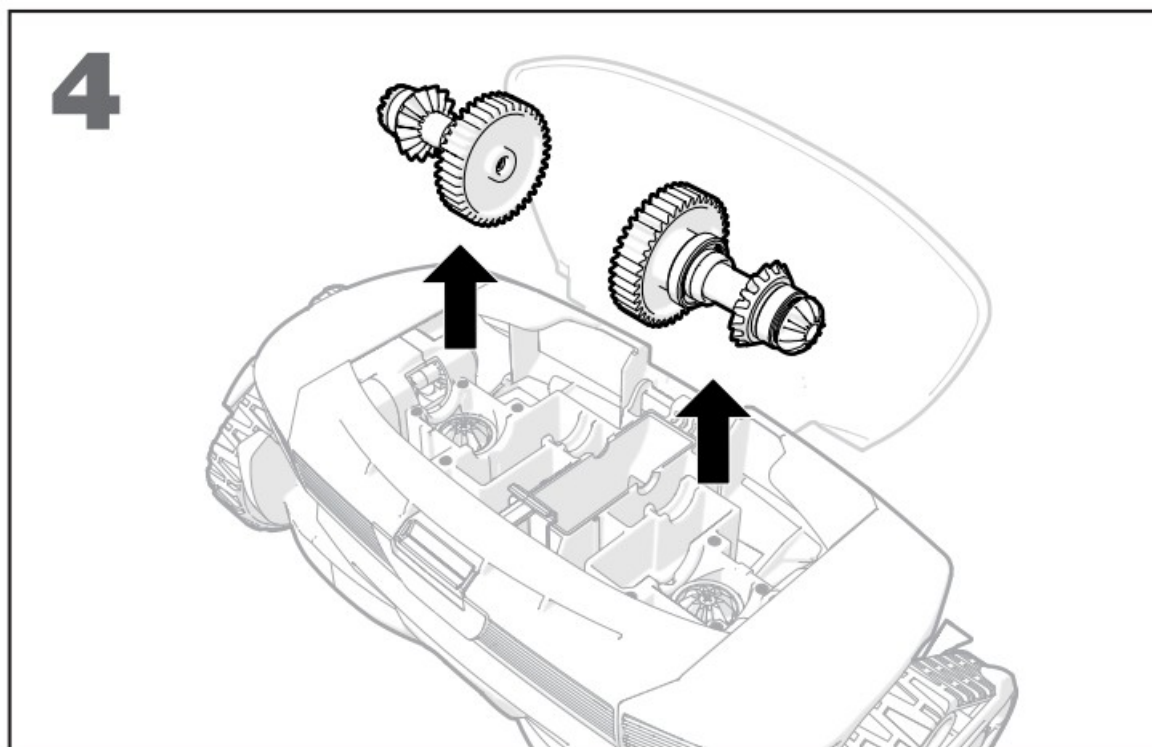

4. Lift drive shafts straight up to remove.

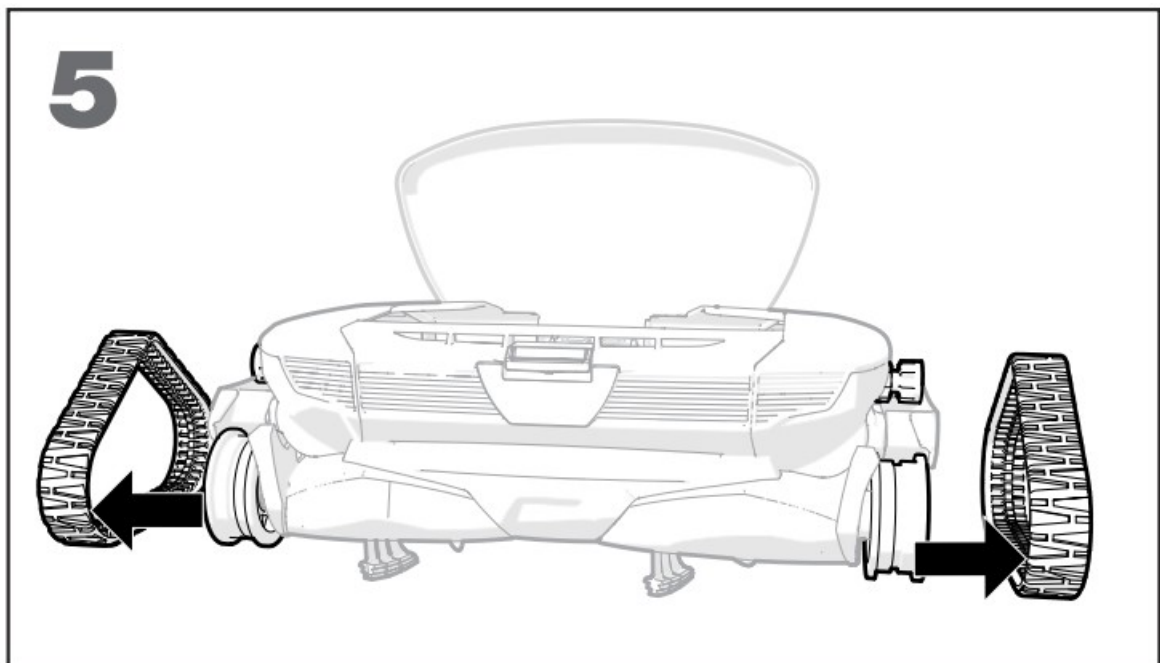

5. Stretch tracks over the wheels to remove.

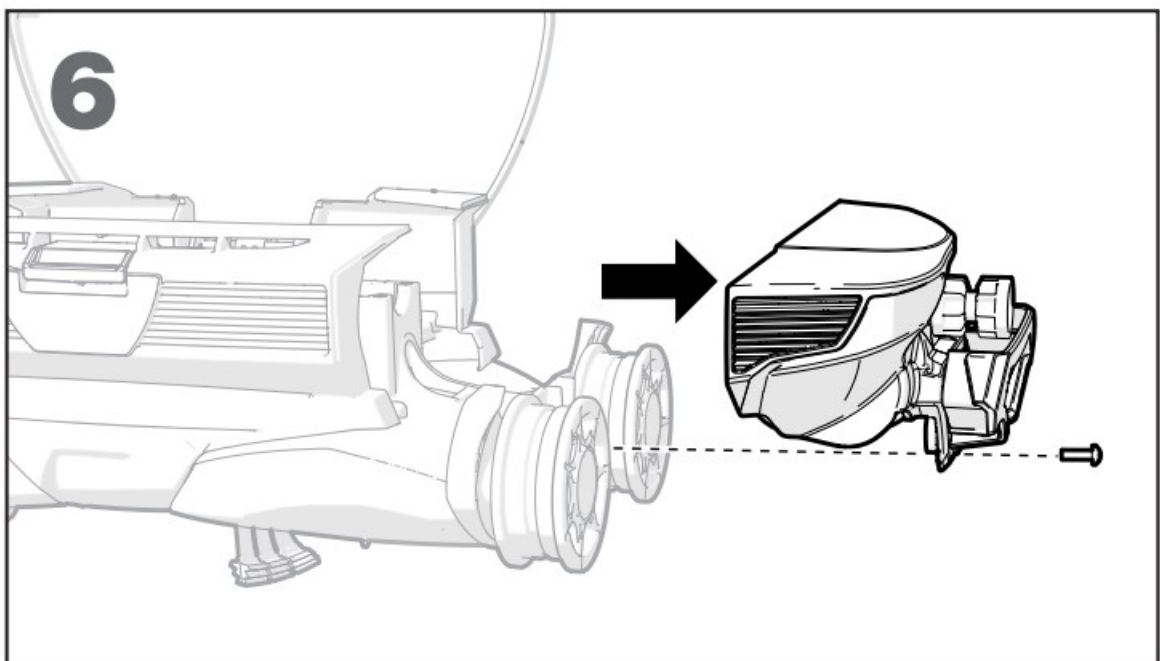

6. Remove the screw between the wheels to remove the panel on each side.

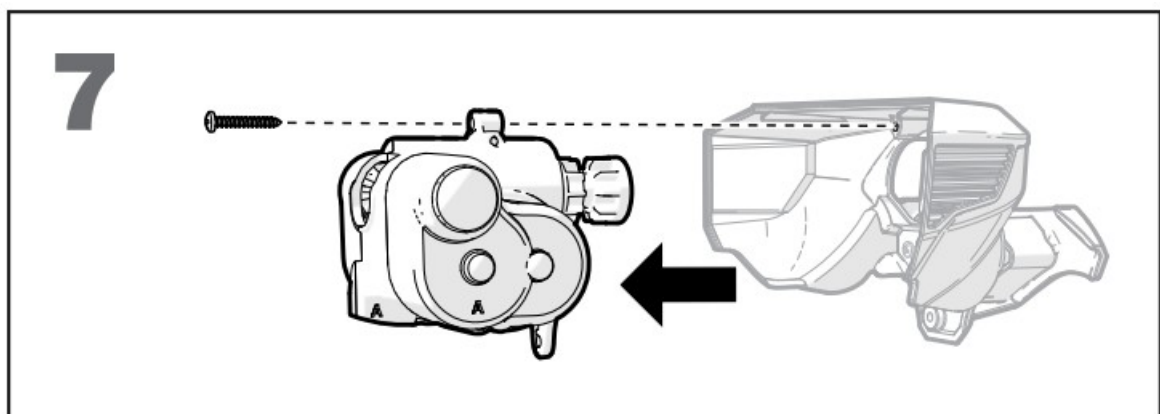

7. Remove the screw from the directional controller to remove it from the panel on each side.

Reassembly

1.

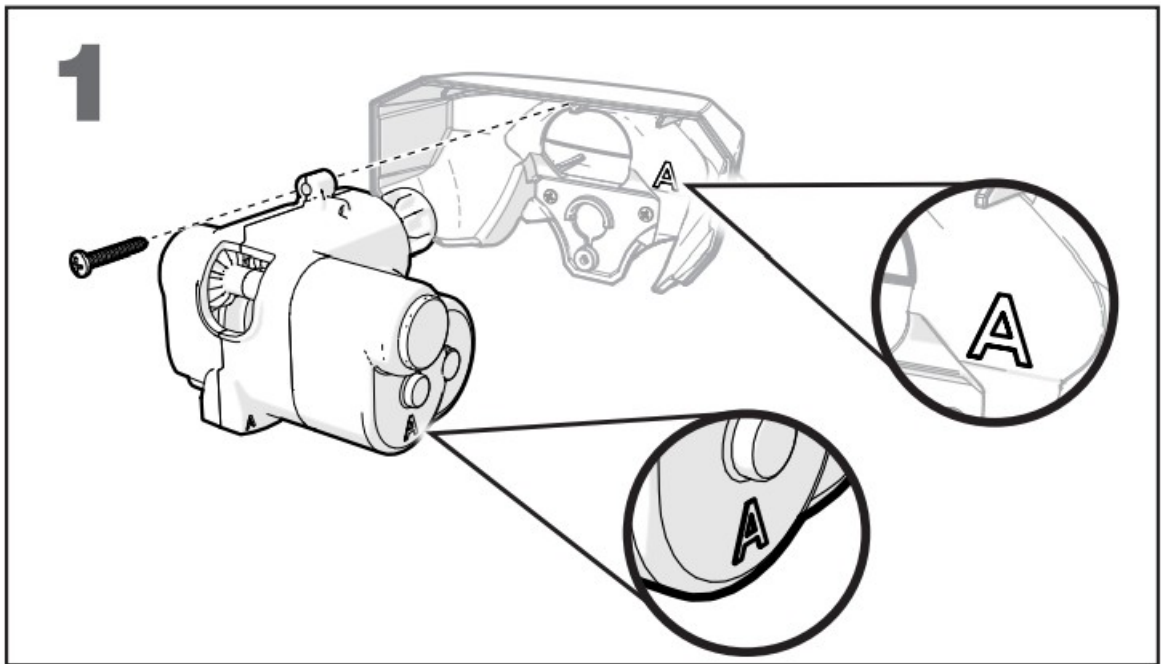

Attach directional controller "A" to side panel "A" and controller "B" to side panel "B" with 1 screw each.

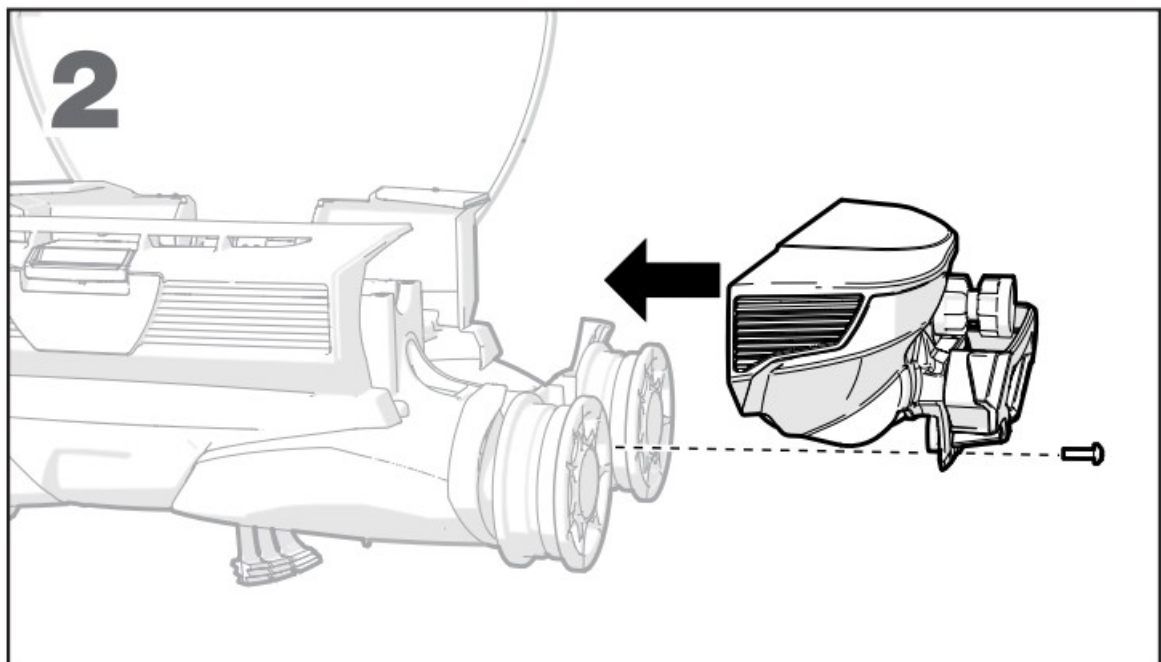

2. Attach the panel on each side with 1 screw between the wheels.

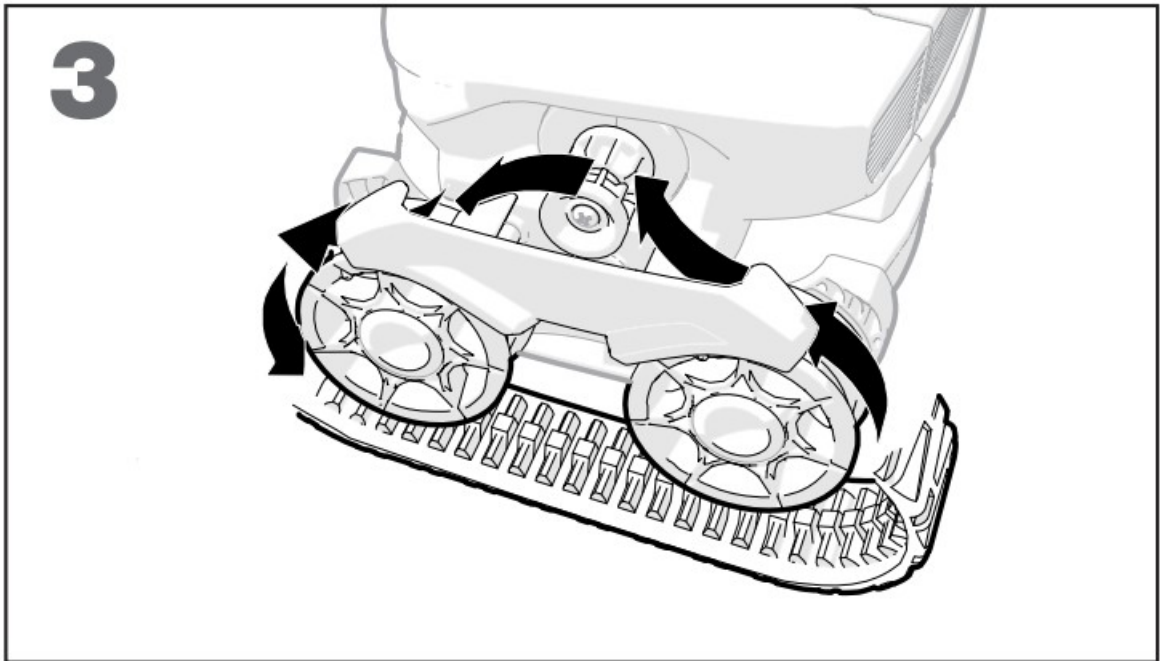

3. Guide the track on to the pulley, stretching it over the wheels and under the track guard, on each side.

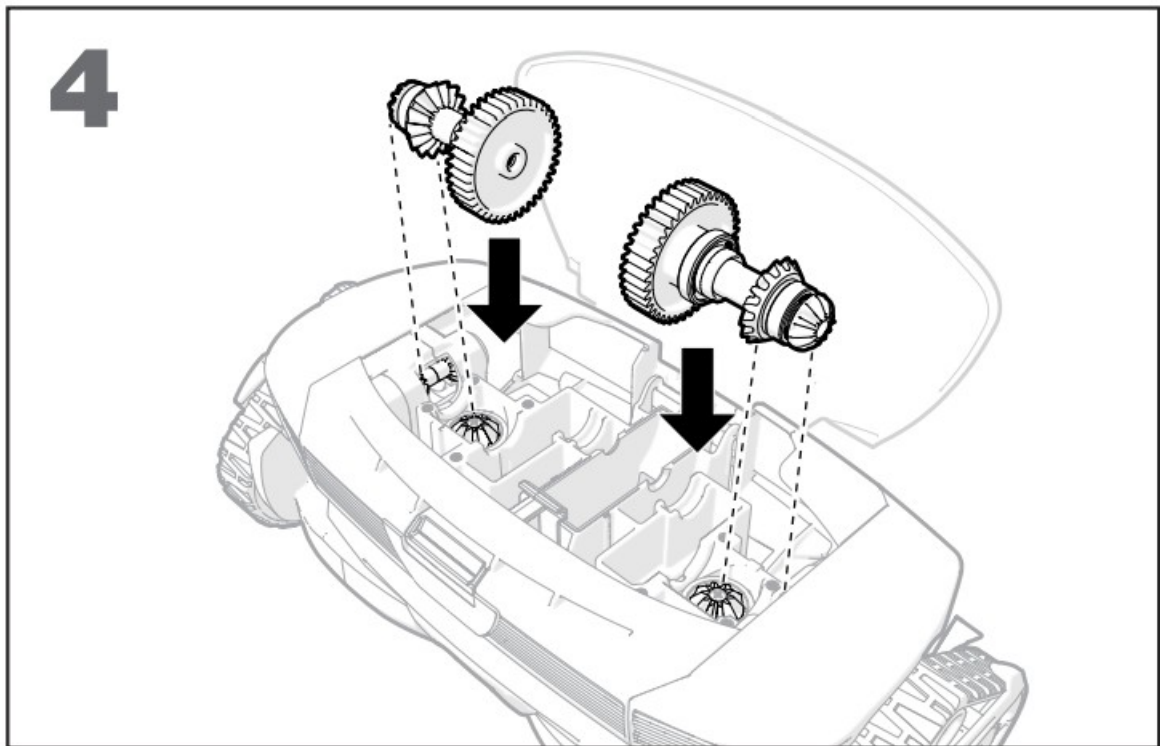

4. Replace drive shafts by aligning with turbine and direction controller gears.

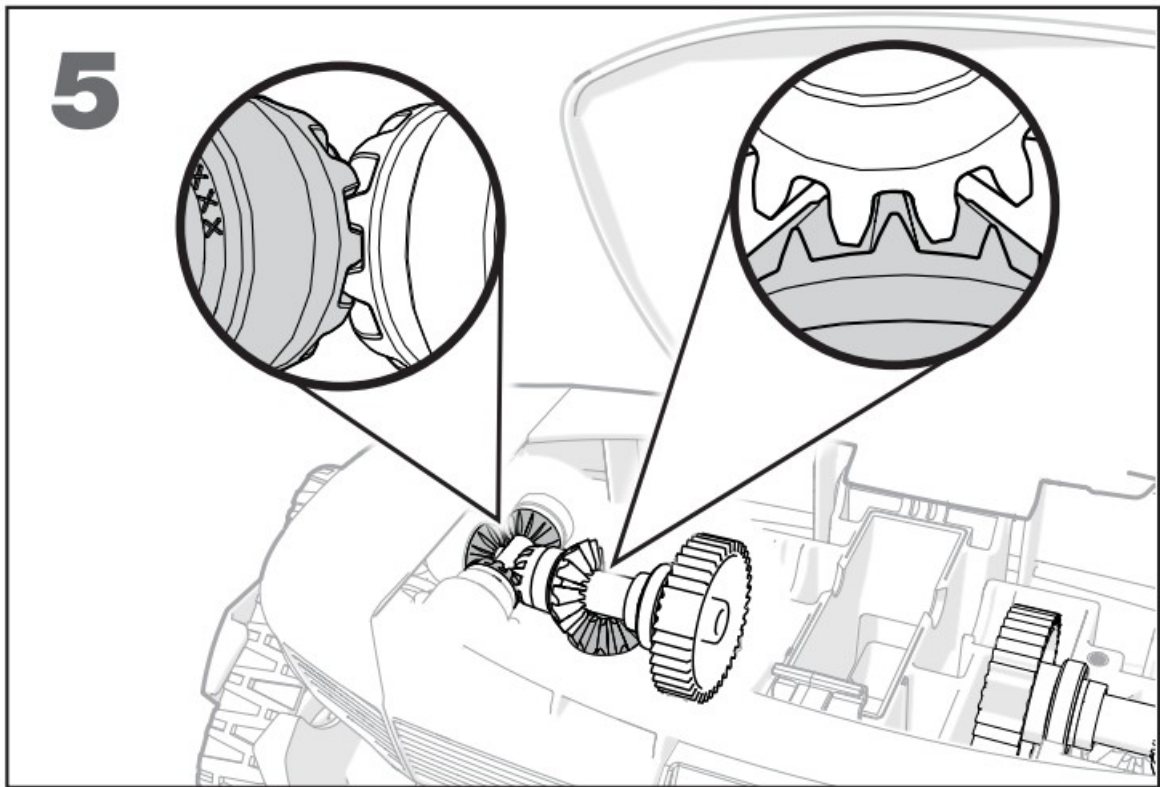

5. Ensure drive shaft gear teeth mesh with turbine and direction controller gears.

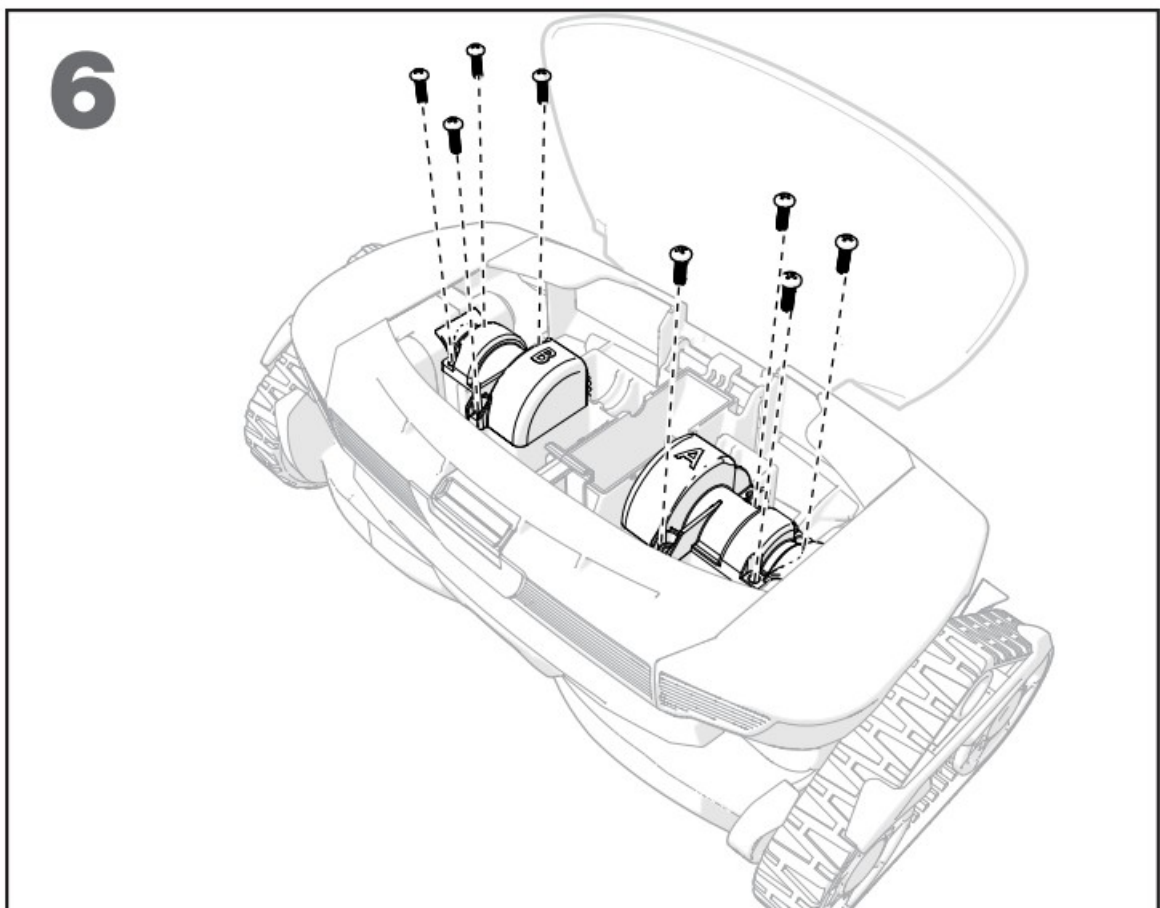

6. Attach gear cover "A" to side "A" and cover "B" to s"B." Replace 8 screws.

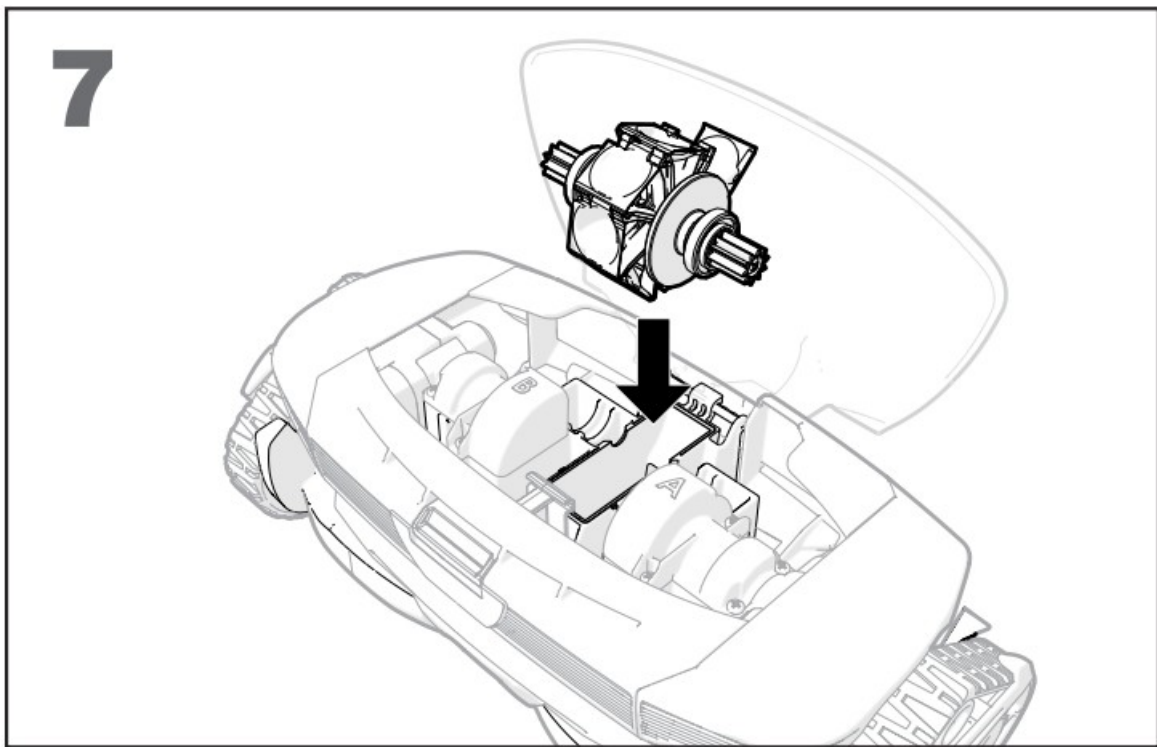

7. Replace the engine. Lower straight down.

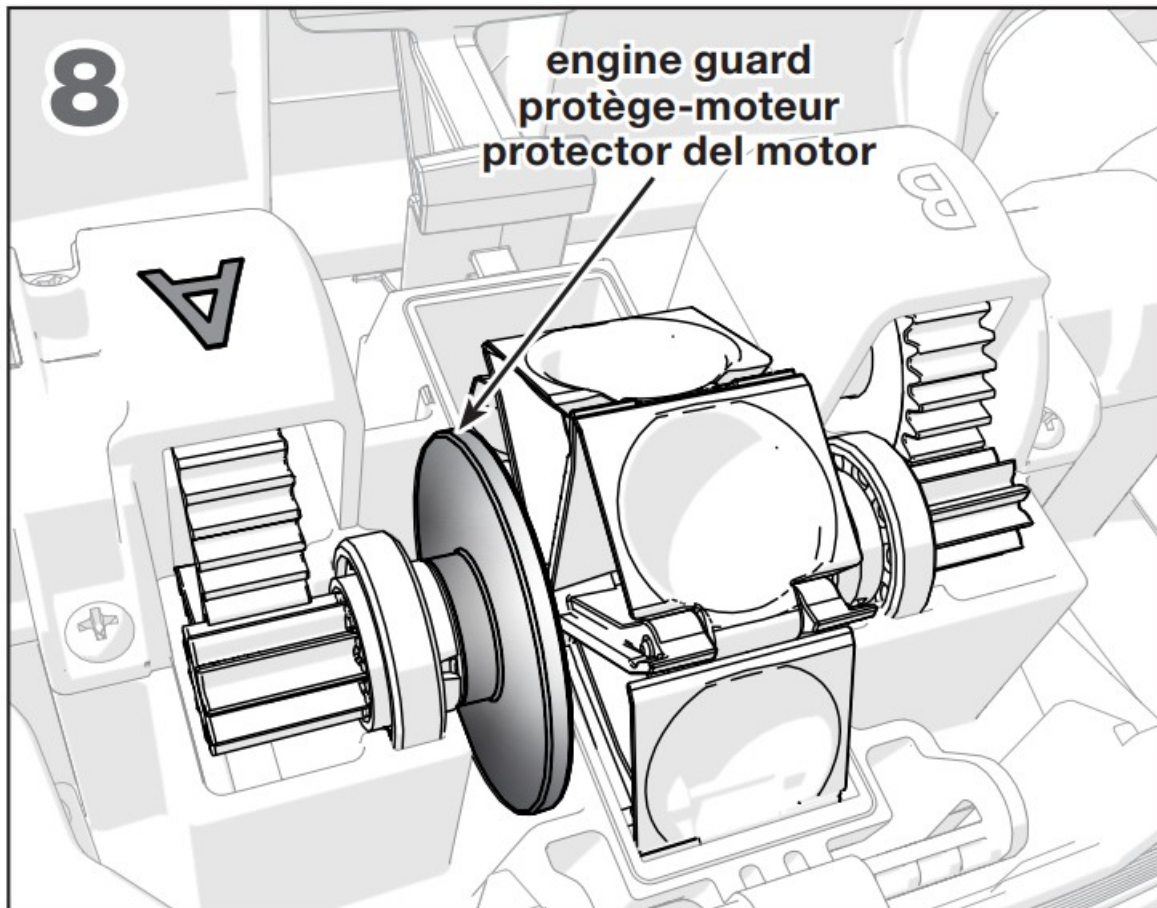

8. Align engine guard with gear cover "A." Ensure bearings are fully seated and the gear teeth mesh.

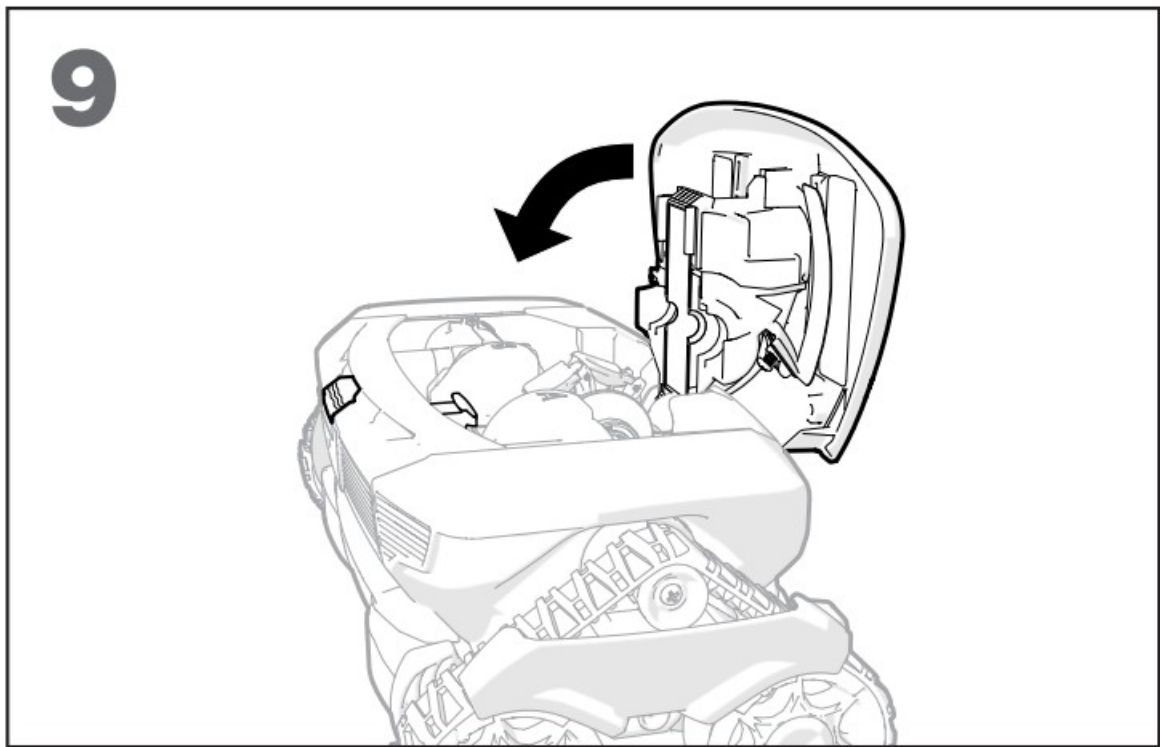

9. Close the lid.



Zodiac Pool Systems LLC

2882 Whiptail Loop # 100, Carlsbad, CA 92010

PolarisPool.com

Zodiac Pool Systems Canada, Inc.

2-3365 Mainway, Burlington, ON L7M 1A6

PolarisPool.ca

Zodiac Pool Care Europe

ZA de la Balme – BP 42, 31450 Belberaud, France

PolarisPool.eu

Fluidra Group Australia Pty Ltd

1 Herbert Place, Smithfield NSW 2164

PO Box 7238 Wetherill Park NSW 1851, Australia

PolarisPool.com.au

A Fluidra Brand

©2023 Zodiac Pool Systems LLC. All rights reserved. ZODIAC®
is a registered trademark of Zodiac International, S.A.S.U., used under license.

All other trademarks are the property of their respective owners.

H0814000_REVB

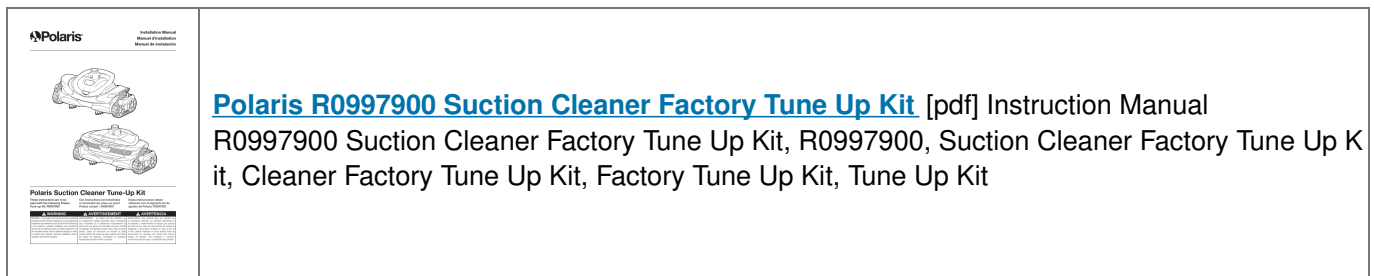

References

- [!\[\]\(746d018fdf6ab02bf5fb7681133e8b29_img.jpg\) Home | Polaris Pool](#)
- [!\[\]\(5daa6eee1904cb6b9d765700250de764_img.jpg\) Home | Polaris Pool](#)
- [!\[\]\(d72e437c7cc5947bc0b147aba6602563_img.jpg\) Under construction - Awesome site in the making!](#)
- [!\[\]\(0d2a89e6d0cbcd8e0459b972b9332401_img.jpg\) English](#)

Manuals+,