

N-PBB610003 EOD 2020 Plus Polaris RZR Pro R Buggy



Polaris N-PBB610003 EOD 2020 Plus Polaris RZR Pro R Buggy Installation Guide

[Home](#) » [Polaris](#) » Polaris N-PBB610003 EOD 2020 Plus Polaris RZR Pro R Buggy Installation Guide 

Contents

- [1 Polaris N-PBB610003 EOD 2020 Plus Polaris RZR Pro R Buggy](#)
- [2 Product Usage Instructions](#)
- [3 Hardware/mounting brackets](#)
- [4 FAQ](#)
- [5 Documents / Resources](#)
 - [5.1 References](#)
- [6 Related Posts](#)



Polaris N-PBB610003 EOD 2020 Plus Polaris RZR Pro R Buggy



Product Specifications:

- **Product Name:** EOD 2020+ Polaris RZR Pro R/ Turbo R/ Pro xp Volt Baja Box
- **Part Number (P/N):** PBB610003

Product Usage Instructions

Installation:

1. Locate a suitable mounting location on your Polaris RZR Pro R, Turbo R, or Pro xp.
2. Securely attach the Volt Baja Box using the provided mounting hardware.
3. Connect the necessary cables following the included wiring diagram.

Operation:

1. Ensure all connections are secure before powering on your vehicle.
2. Turn on the power switch of the Volt Baja Box.
3. Adjust settings as needed using the control panel.

Maintenance:

Regularly inspect the Volt Baja Box for any signs of damage or wear. Clean the exterior with a damp cloth and avoid using harsh chemicals.

Hardware/mounting brackets

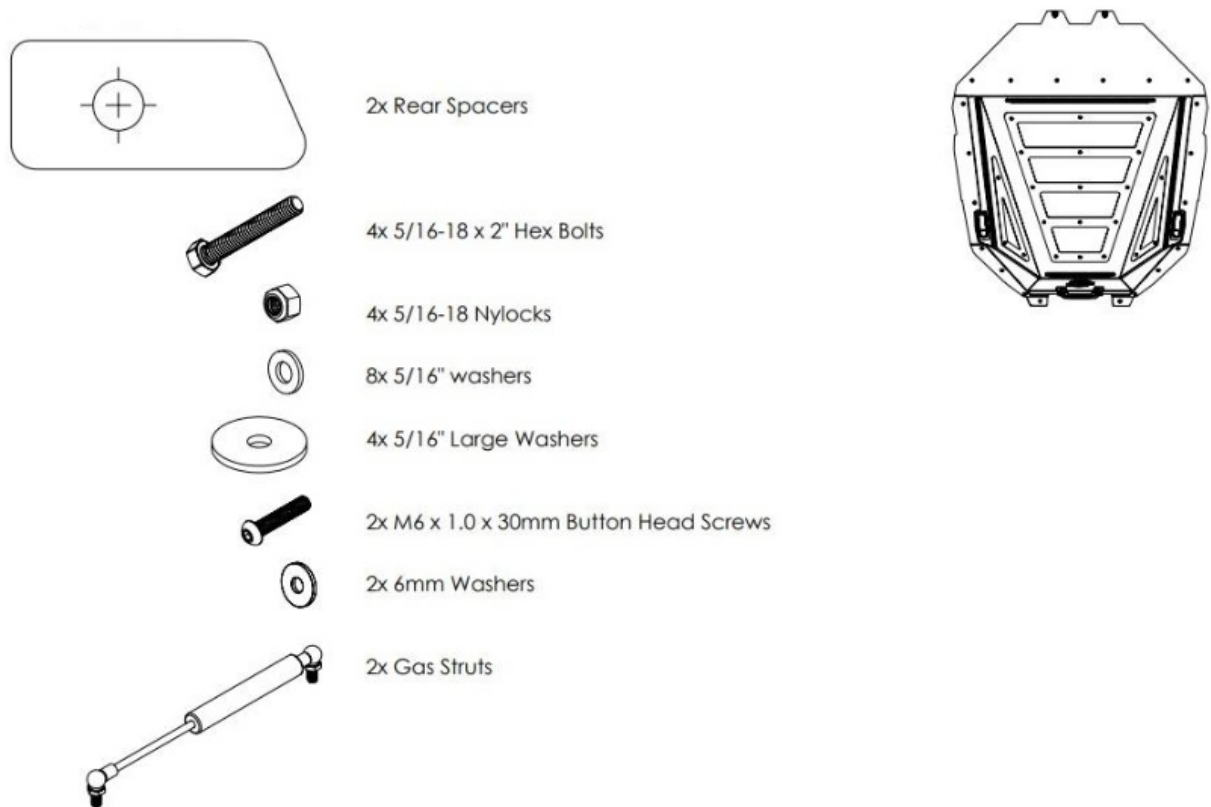

- Remove the factory 4 torx bolts from the vehicles cargo area as shown in the picture above, two of these bolts will be used later on during reassembly. Next, set the baja box carefully down into the rear cargo area and line up the front and rear holes that the factory hardware came out of with the corresponding holes on the box. Due to vehicle variances, if the rear mounting holes on the box do not sit on the plastic the supplied rear\ spacers may need to be installed in between the box and the vehicle.

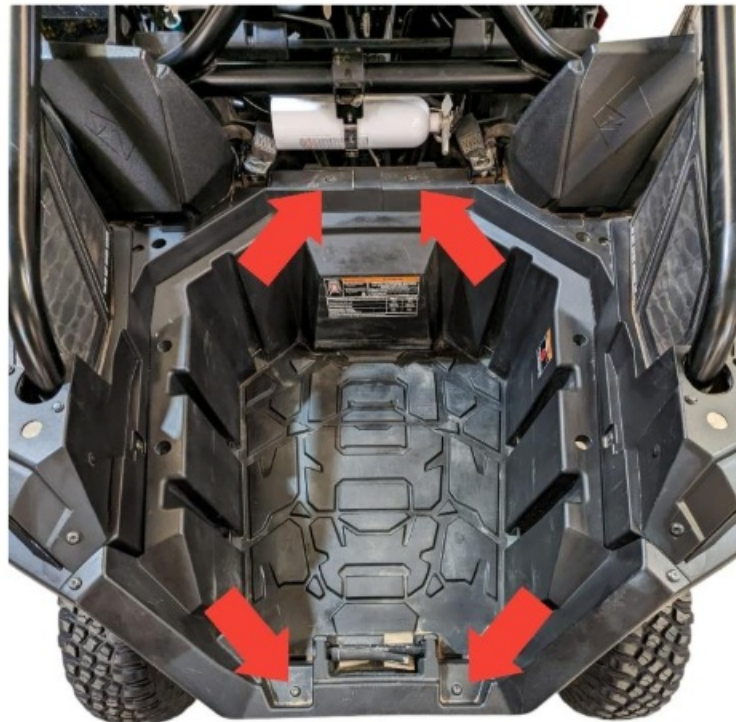

- Install two of the factory torx bolts loosely into the holes nearest to the seats and then install the 6mm bolts and washers into the two mounting holes towards the rear of the vehicle. Do not tighten down any of the hardware at this point.

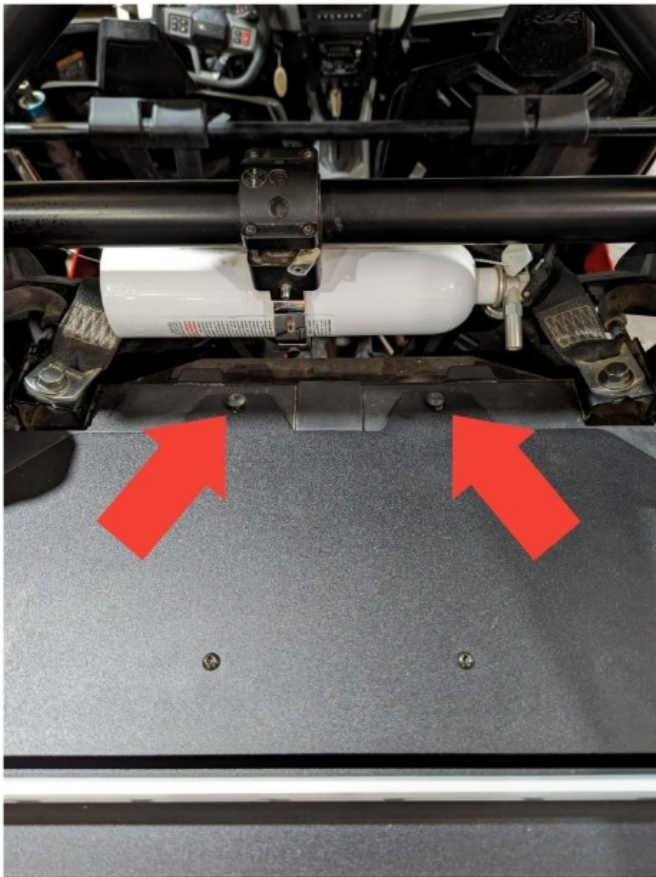

- While supporting the lid of the box open, attach the ball ends for the struts onto the box lid and inside bracket as shown with the upper balls facing outward and the lower ones facing inward and tighten down. Install the gas struts to the ball ends making sure the body of the shock is mounted to the top mounting ball and the shaft end is mounting to the lower ball. Using the supplied 5/16" hardware, install the 4 bolts as shown in the pictures making sure the larger washers go on the bottom side of with the lock nut. Once all the hardware is installed tighten down everything from the center out, perform a final checkover of all the work completed and enjoy another great product from Elektric Offroad Designs!



FAQ

Q: Can the Volt Baja Box be used in extreme weather conditions?

A: The Volt Baja Box is designed to withstand rugged conditions and is suitable for use in various weather environments. However, it is recommended to protect it from direct exposure to heavy rain or extreme heat.

Q: What is the input voltage range supported by the Volt Baja Box?

A: The Volt Baja Box supports an input voltage range of 12V-24V, making it compatible with most vehicle electrical systems.

Q: Is the Volt Baja Box compatible with other Polaris RZR models?

A: The Volt Baja Box is specifically designed for use with EOD 2020+ Polaris RZR Pro R, Turbo R, and Pro xp models. Compatibility with other models may vary.

Documents / Resources

 <p>EOD 2020+ Polaris RZR Pro R/Turbo R/Pro xp Volt Baja Box P/N: P-BB610003</p>	<p>Polaris N-PBB610003 EOD 2020 Plus Polaris RZR Pro R Buggy [pdf] Installation Guide 2022, 2020, N-PBB610003 EOD 2020 Plus Polaris RZR Pro R Buggy, N-PBB610003, EOD 2020 Plus Polaris RZR Pro R Buggy, Polaris RZR Pro R Buggy, Pro R Buggy, Buggy</p>
---	--

References

- [User Manual](#)

Manuals+. Privacy Policy

This website is an independent publication and is neither affiliated with nor endorsed by any of the trademark owners. The "Bluetooth®" word mark and logos are registered trademarks owned by Bluetooth SIG, Inc. The "Wi-Fi®" word mark and logos are registered trademarks owned by the Wi-Fi Alliance. Any use of these marks on this website does not imply any affiliation with or endorsement.