

Polaris FREEDOM Cordless Robotic Cleaner User Guide

[Home](#) » [Polaris](#) » Polaris FREEDOM Cordless Robotic Cleaner User Guide

Contents [[hide](#)]

- [1 FREEDOM Cordless Robotic Cleaner](#)
- [2 Product Information](#)
- [3 Battery Status](#)
- [4 Wi-Fi Connection Status](#)
- [5 Cleaning Mode](#)
- [6 Operating Status](#)
- [7 Charging Station Status](#)
- [8 Charging the Cleaner](#)
- [9 Controlling the Cleaner with the App](#)
- [10 Before You Start](#)
- [11 IN THE BOX](#)
- [12 Information/Status LEDs](#)
- [13 Wi-Fi Connection Status](#)
- [14 Setup and Charging](#)
- [15 Start Cleaning](#)
- [16 Remove from Pool](#)
- [17 Install the App and Add your Cleaner](#)
- [18 Documents / Resources](#)
 - [18.1 References](#)
- [19 Related Posts](#)



FREEDOM Cordless Robotic Cleaner

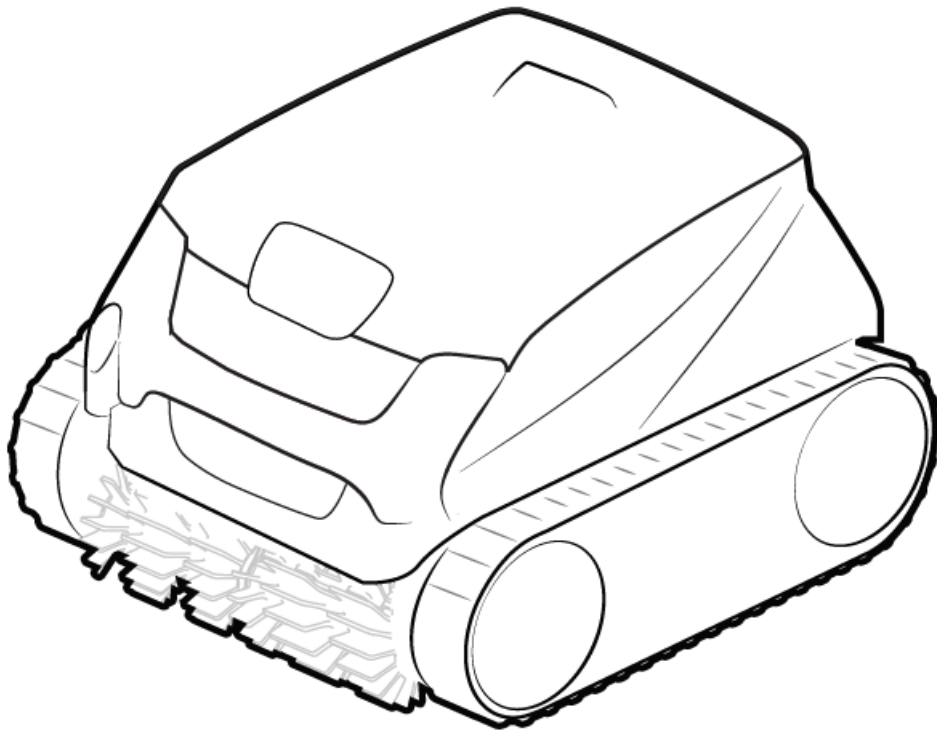

Product Information

The product is a pool cleaner with a battery-powered motor that can clean both floors and walls of a pool. The cleaner has a Wi-Fi connection that allows it to be controlled through a mobile app. The cleaner comes with a charging station that is used to charge the battery. The charging station has two LED indicators, one green and one red. The cleaner also has LED indicators that show the battery status, Wi-Fi connection status, cleaning mode, and operating status.

Battery Status

- Solid Green: Fully charged. Ready to run a full cycle (2h 30).
- Solid Orange: Not fully charged. May not run a complete cycle.
- Blinking Orange: Very low battery level. Charge needed. Cannot run cleaner.
- Blinking Red: Charging error. Cleaner is too hot.

Wi-Fi Connection Status

- Blinking Blue: Pairing
- Solid Blue: Connected to WiFi

Cleaning Mode

- Floor and walls (2h 30)
- Floor only (1h 30)

Operating Status

- Blinking Blue: Out of Water: Ready to submerge, start cleaning.
In Water: End of Cycle. Waiting for removal from pool.
- Blinking Red: Error

Charging Station Status

- Solid Green: Base receiving power
- Solid Red: Charging in progress

Charging the Cleaner

1. Select a charging location (GFCI outlet) at least 11.5 ft (3.5 m) away from the pool, out of direct sunlight and with adequate WiFi strength. Align the cleaner and charging station with the wall for easier access to the controls and handle. DO NOT use an extension cord.
2. Plug the charging station into GFCI and seat the cleaner on the charging contacts. The cleaner will beep and begin charging.
3. Check the current charge level in the App whenever the cleaner is on the charging station. Fully charge the cleaner before the first cleaning.

Starting the Cleaner

1. Start the cleaner using the slider or the App.
2. Submerge the cleaner in the pool.
 - Blinking Blue = Ready to Clean. The cleaner does not begin moving until it senses water. If water is not detected after 15 seconds, slide and release the slider and press Start again.

Removing the Cleaner from the Pool

1. Remove from Pool – Waterline Waiting:
 - Bring the cleaner to the waterline and wait for it to stop moving.
2. Remove from Pool – Using the Hook:
 - Attach the hook (stored on the charging base) to a standard pool cleaning pole (not included).
 - Secure the hook on the cleaner handle. Bring the cleaner to the waterline.

Controlling the Cleaner with the App

1. Install the iAquaLink app from the App Store or Google Play.
2. Open the iAquaLink app and sign up or log in.
3. Add your cleaner to the app by following the on-screen instructions.

Before You Start

This Quick Start Guide contains essential installation and startup instructions. Read the complete manual and all safety warnings before commencing installation.

IN THE BOX

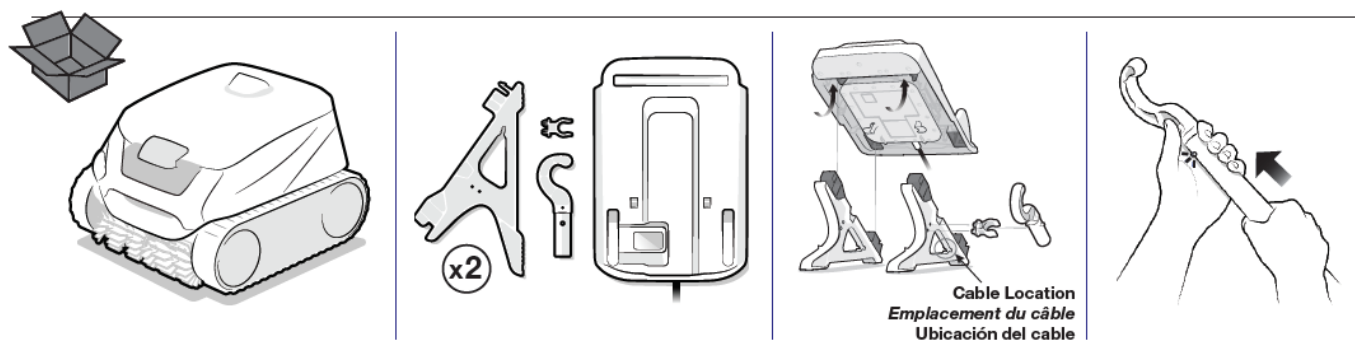

Information/Status LEDs

Battery Status

- **Solid Green:** Fully charged. Ready to run a full cycle (2h 30).
- **Solid Orange:** Not fully charged. May not run a complete cycle.
- **Blinking Orange:** Very low battery level. Charge needed. Cannot run cleaner.
- **Blinking Red:** Charging error. Cleaner is too hot.

Wi-Fi Connection Status

- **Blinking Blue:** Pairing
- **Solid Blue:** Connected to Wi-Fi

Cleaning Mode

- Floor and walls (2h 30)
- Floor only (1h 30)

Operating Status

- **Blinking Blue Out of Water:** Ready to submerge, start cleaning.
- **In Water:** End of Cycle. Waiting for removal from pool.
- **Blinking Red:** Error

Setup and Charging

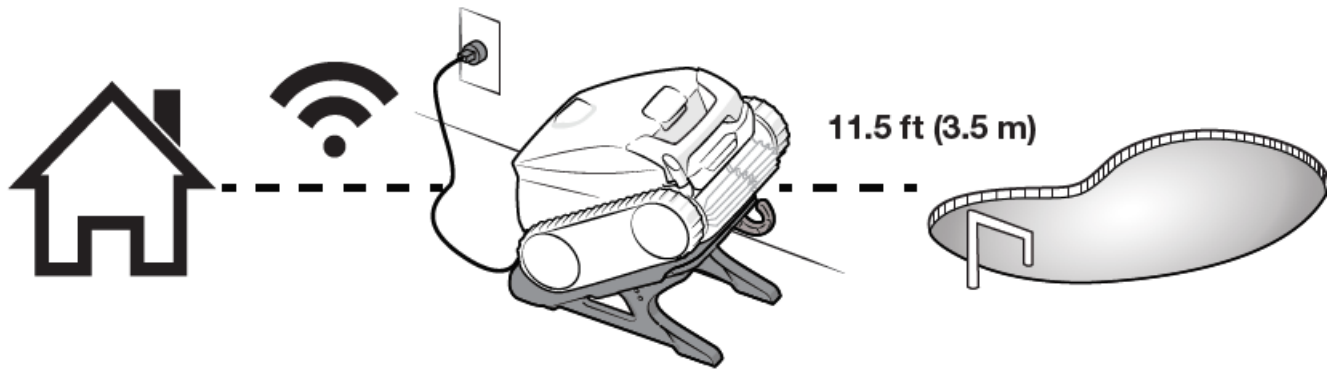

Select a charging location (GFCI outlet) at least 11.5 ft (3.5 m) away from the pool, out of direct sunlight and with adequate Wi-Fi strength. Align the cleaner and charging station with the wall for easier access to the controls and handle. DO NOT use extension cord.

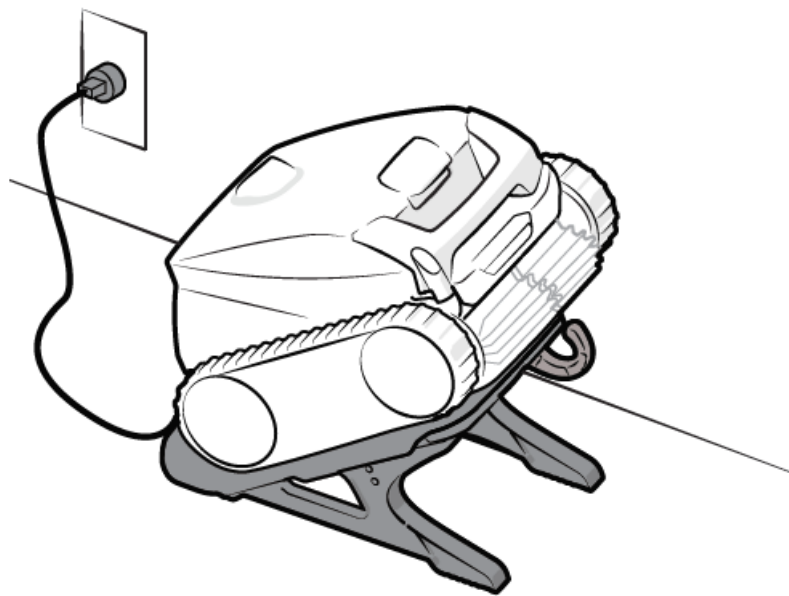

Plug charging station into GFCI and seat cleaner on the charging contacts. Cleaner “beeps” and begins charging.

Start Cleaning

- Fully charge the cleaner before the first cleaning.



- Select Cleaning Mode using the slider or the App.

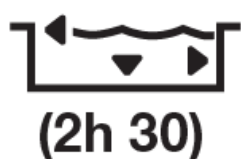
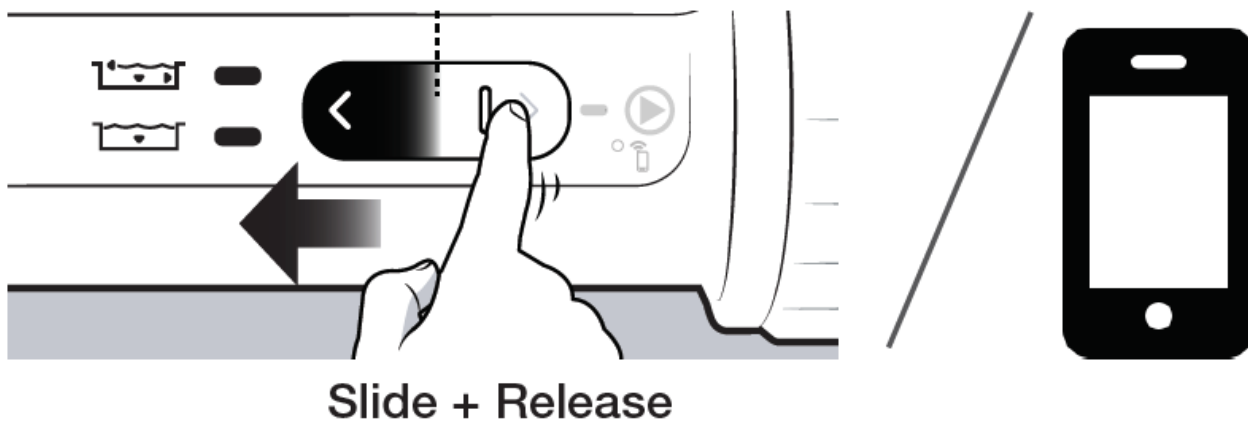

Floor and walls

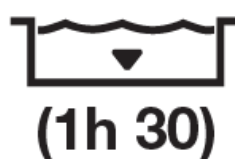

Floor Only

- Choose Floor Only mode to clean with Pool Cover on.
- Additional cleaning modes may be available in the App.
- Start the cleaner. Use the slider or the App.

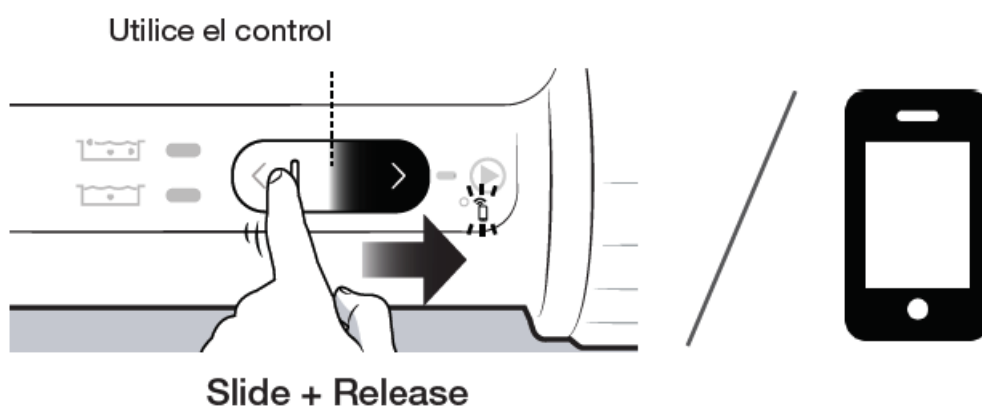

- Blinking Blue = Ready to Clean. Cleaner does not begin moving until it senses water. If water is not detected after 15 seconds, slide and release the slider and press Start again.
- Submerge the Cleaner. Submerge the Cleaner.

Submerge the Cleaner.

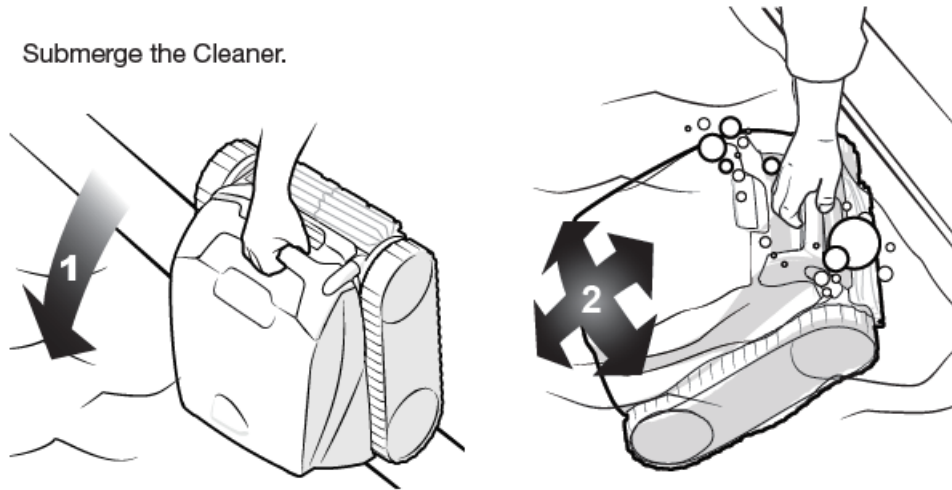

- Wait for bubbles to stop completely, then let the cleaner sink to the bottom of the pool
- Cleaning cycle will start as soon as the cleaner detects the pool floor.

Remove from Pool

Waterline Waiting

- Cleaner waits at the waterline.
- Cleaner waits at the bottom (retrieve with hook and pole).
- For all cleaning cycles (other than Floor Only), the cleaner climbs and waits at the waterline.
- If the cleaner is not retrieved after 30 seconds, it moves to a different wall. If not retrieved after 10 minutes, the cleaner returns to the pool floor for retrieval with the hook and pole.

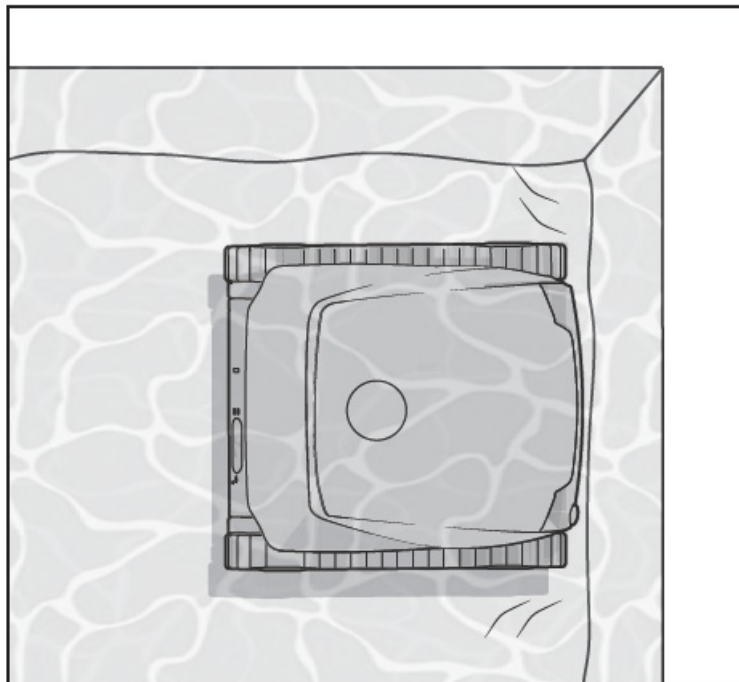

Remove from Pool

Using the Hook

- Attach the hook (stored on the charging base) to a standard pool cleaning pole (not included).

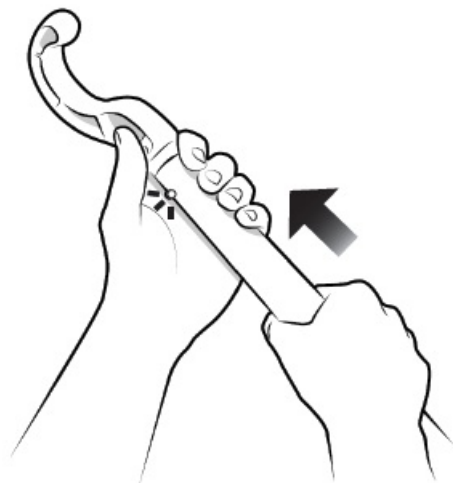

- Secure the hook on the cleaner handle. Bring the cleaner to the waterline.

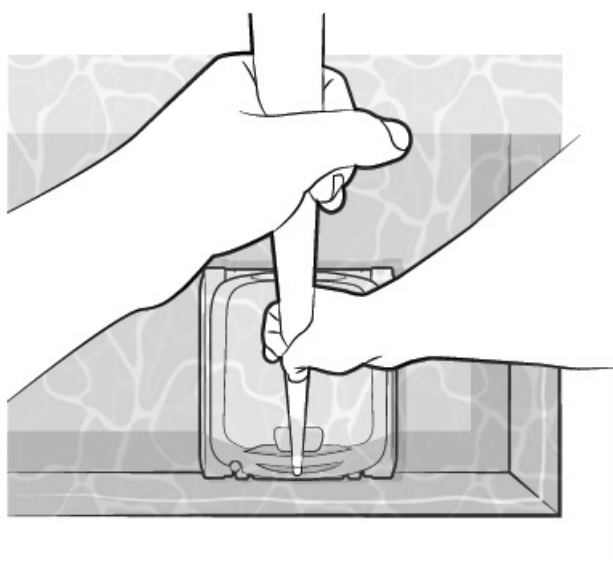

- Hold the cleaner by the handle. Let the water drain.



- Remove the filter canister and rinse.

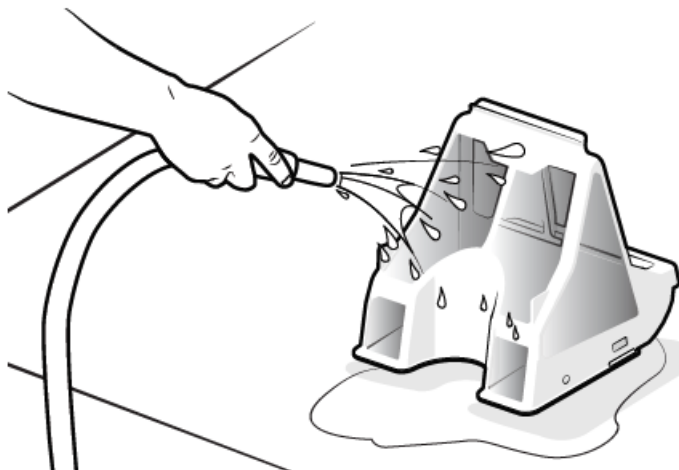
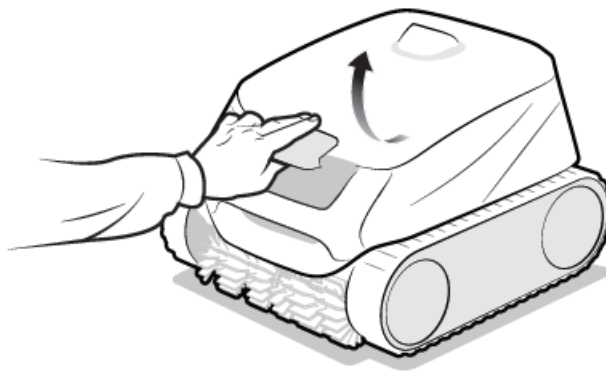

- Store the cleaner on the charging station out of direct sunlight.

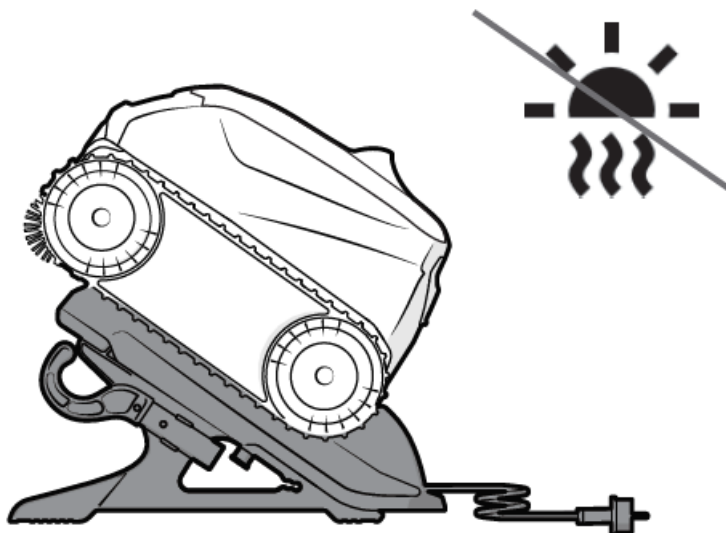

- For best results, dry the cleaner and station charging contact before charging. Periodically clean the charging contact using a cloth or scouring pad.

Install the App and Add your Cleaner

Before you begin installing iAquaLink®, make sure you have the following:

- Charging station connected and plugged into a GFCI outlet.
- Robotic Cleaner on Charging station.
- Wi-Fi and Bluetooth enabled smart device (phone or tablet).

- Wi-Fi router with sufficient signal strength at the Charging station.
- **IMPORTANT:** Have your Wi-Fi network password available.

1. Download iAquaLink app from the App Store or Google Play.
2. Open the iAquaLink app, then Sign Up or Log In.
3. Follow the on-screen prompts to add your cleaner.
4. Slide the slider right and HOLD for ten seconds to put the cleaner in Pairing Mode. Wi-Fi LED indicates connection status.

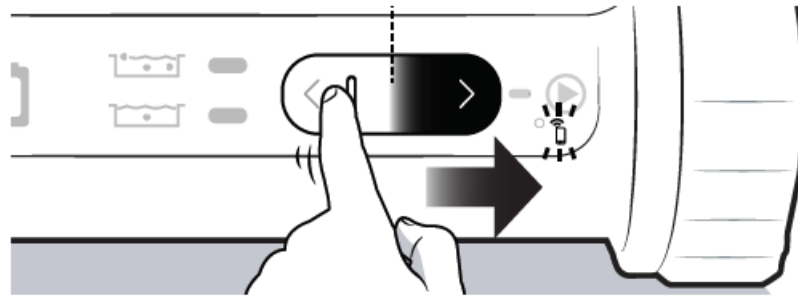

Slide and HOLD 10 seconds

- Blinking Blue – Pairing
- Solid Blue – Connected to Wi-Fi

If you have problems connecting, the Wi-Fi signal may not be strong enough next to the pool. Try placing the charging station cleaner in another location closer to your home router.

Zodiac Pool Systems LLC

2882 Whiptail Loop # 100 Carlsbad, CA 92010, USA [PolarisPool.com](https://www.polarispool.com) | 1.800.822.7933

Zodiac Pool Systems Canada, Inc.

2-3365 Mainway Burlington, ON L7M 1A6, Canada [PolarisPool.ca](https://www.polarispool.ca) | 1.800.822.7933

A Fluidra Brand

©2022 Zodiac Pool Systems LLC. All rights reserved. ZODIAC® is a registered trademark of Zodiac International, S.A.S.U., used under license. All other trademarks are the property of their respective owners.

Documents / Resources



[Polaris FREEDOM Cordless Robotic Cleaner](#) [pdf] User Guide
63426, FREEDOM Cordless Robotic Cleaner, FREEDOM, Cordless Robotic Cleaner, Robotic Cleaner

References

-  [Home](#) | [Polaris Pool](#)
-  [Home](#) | [Polaris Pool](#)

[Manuals+](#), [home](#) [privacy](#)