



PoKeMoNO Go-Tcha Ranger LED Touch Screen G User Guide

[Home](#) » [PoKeMoN GO](#) » PoKeMoNO Go-Tcha Ranger LED Touch Screen G User Guide 

Contents

- [1 PoKeMoNO Go-Tcha Ranger LED Touch Screen G](#)
- [2 OVERVIEW](#)
- [3 Go-tcha Ranger is fully rechargeable](#)
- [4 Connecting Your Go-tcha Ranger](#)
- [5 Go-tcha Screens – Catching/Caught Pokémon](#)
- [6 Go-tcha Screens – Pokéstops](#)
- [7 Go-tcha Screens – Other alerts](#)
- [8 Documents / Resources](#)
 - [8.1 References](#)
- [9 Related Posts](#)



PoKeMoNO Go-Tcha Ranger LED Touch Screen G



Thank you for purchasing the Go-tcha Ranger for Pokémon GO! Enjoy Pokémon GO on the move without looking at your smartphone

OVERVIEW

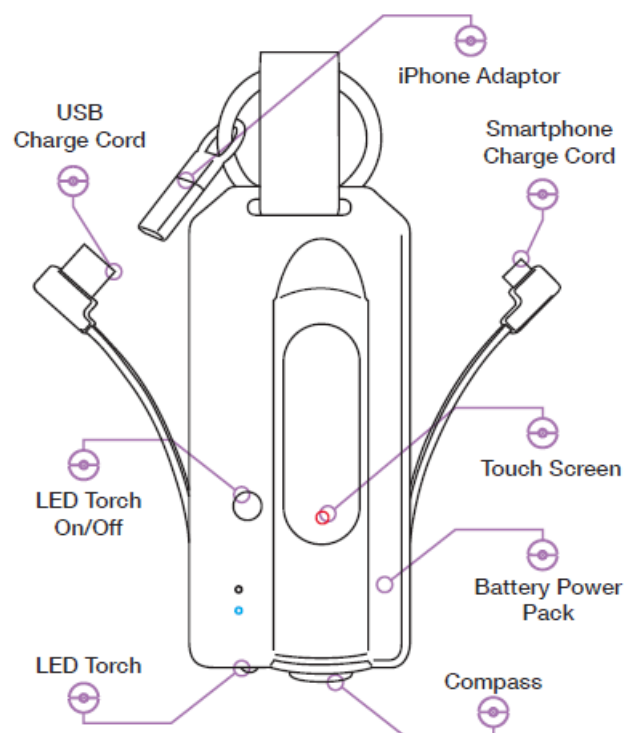

Go-tcha Ranger is fully rechargeable

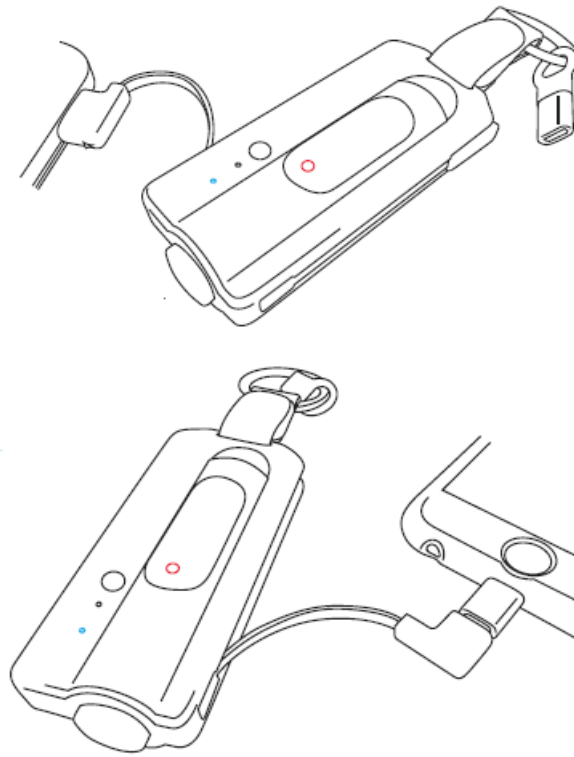

- Ease out the integral charger cable and connect to a suitable USB port.
- The Blue charge LED will flash to indicate that Go-tcha Ranger is charging.
- The Blue LED will become static once the unit is fully charged

Go-tcha Ranger can also be used to give your smartphone a boost of extra power if required. Ease out the phone charger cable and connect to your smartphone, using the iPhone adapter if required. The phone charge LED will indicate that your smartphone is connected. Go-tcha Ranger also features a handy compass and LED torch. Press and hold the Torch button for 3 seconds to turn on – simply double click the button to turn the torch off.

Connecting Your Go-tcha Ranger

To connect your Go-tcha Ranger to the Pokémon App:

- Open the Pokémon GO App
- Touch the Main Menu
- Touch Settings
- Touch 'Pokémon GO Plus'
- Press the button on the Go-tcha to make it discoverable to the Pokémon Go App
- Touch your 'Pokémon GO Plus' under Available Devices list to connect.

Using Your Go-tcha Ranger- Manual Catch

To connect your Go-tcha Ranger to the Pokémon App:

- Go-tcha will vibrate and animate the screen to show a new/duplicate Pokémon is near
- Press the Go-tcha button/screen to catch the Pokémon
- Go-tcha will vibrate and animate the screen to show a successful/unsuccessful catch
- Go-tcha will vibrate and animate the screen to show when a Pokéstop is in range

- Press the Go-tcha button to retrieve items from a Pokéstop
- Go-tcha will vibrate and animate the screen to show it has successfully/unsuccessfully collected the items and how many items it has collected.

See 'Go-tcha Ranger Screens' below for a complete guide to the screen animation alerts.

Using Your Go-tcha Ranger – Auto Catch

To turn the 'Auto-catch' function on, press the Go-tcha button until 'Auto-catch ON' is selected. If you have Auto Catch on:

- Go-tcha will vibrate and animate the screen to show a successful/unsuccessful catch.
- Go-tcha will vibrate and animate the screen to show it has successfully/unsuccessfully collected the items and how many items it has collected at a Pokéstop.

To turn 'Auto-catch' off, press and hold the Go-tcha button until 'Auto-catch OFF' is selected.

Go-tcha Screens – Catching/Caught Pokémon

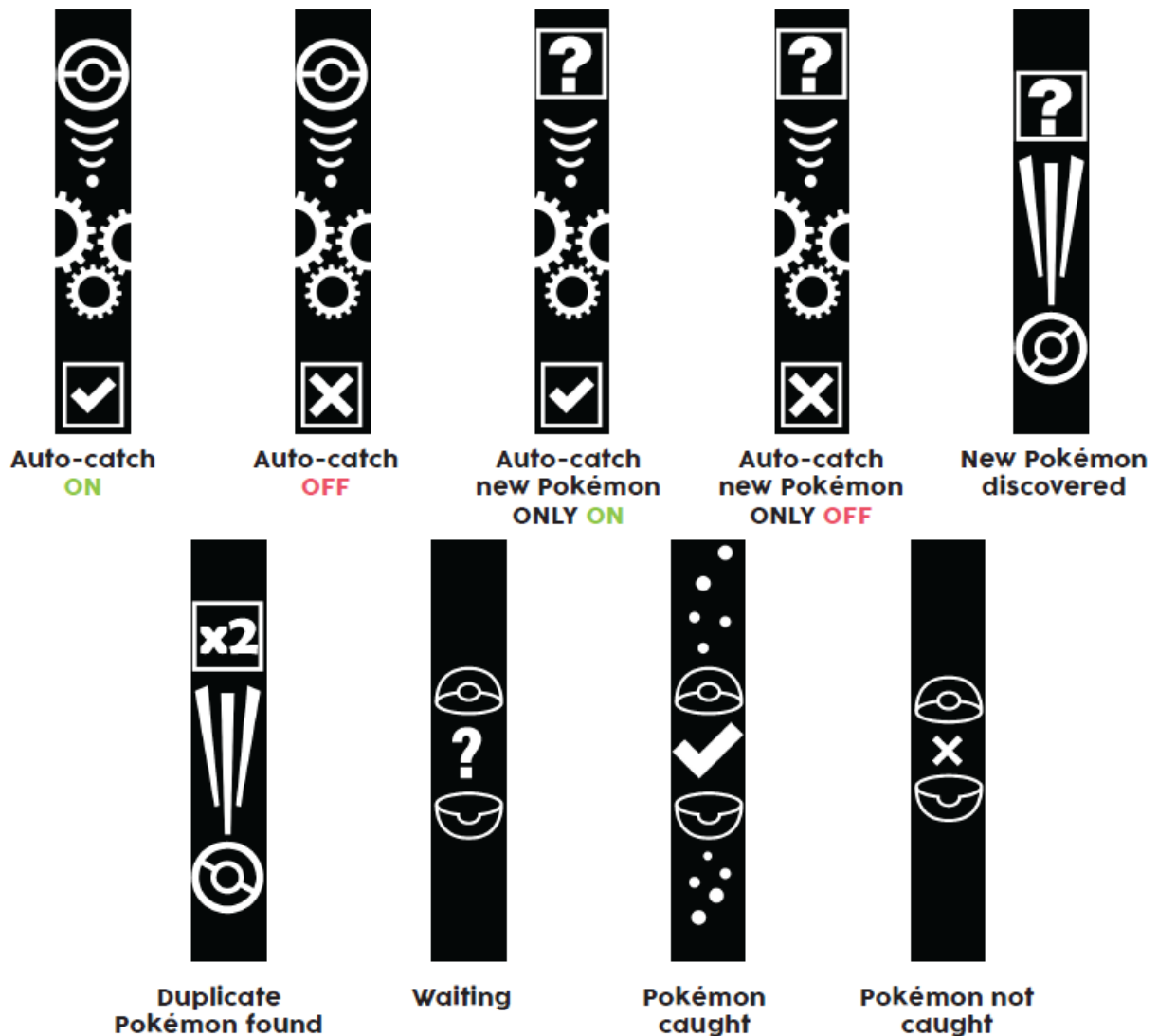

Go-tcha Screens – Pokéstops



Auto-collect
Pokéstop **ON**



Auto-collect
Pokéstop **OFF**



Pokéstop
in range



Pokéstop not
in range



Pokéstop items
collected



Pokéstop items
not collected



x2 Pokéstop
items collected



x3 Pokéstop
items collected



x4 Pokéstop
items collected



5+ Pokéstop
items collected

Go-tcha Screens – Other alerts



Go-tcha intro screen



Out of Pokéballs



Open journal to see escaped Pokémon



Device is paired



Device not paired



Vibration alerts **ON**



Vibration alerts **OFF**

Before You Start – Ensure that your Go-tcha Ranger has the latest firmware

Software Update Go-tcha updates are now available in the Apple App Store and Google Play Store. This resolves the issues with Auto Catch features on iOS devices



Go-tcha Ranger uses the Go-tcha Update App. Simply scan the QR code to take you to Go-tcha Update App on the Apple or Android App Store. To connect your Go-tcha Ranger to the Go-tcha Update App, you must close the Pokémon Go App. Press the button on the Go-tcha Ranger to wake the screen and it will connect automatically to the open Go-tcha Update App. Updates will download automatically.

Note: The Go-tcha Ranger cannot connect to more than one App at a time so the Pokémon Go App cannot be

running in the background. If you tried to connect with the Pokémon Go App running, close both Apps and then open the Go-tcha Update App again. THIS PRODUCT IS NOT SPONSORED, ENDORSED, OR APPROVED BY THE POKÉMON COMPANY OR NIANTIC. Device requires Bluetooth low-energy compatible smartphone with Pokémon GO app installed. Compatible with iPhone® 5 / 5c / 5s / SE / 6 / 6s / 6 Plus / 6s Plus / 7 / 7 Plus devices with iOS Ver. 8–10 installed. Compatible with Android devices with 2 GB RAM or more, Bluetooth Smart (Bluetooth Ver. 4.0 or higher) capability, and Android Ver. 4.4–6.0 installed

Technical Support

Before contacting Datel's customer service department, please ensure that you have read through and understood the information in this manual/guide.

If you contact support, please ensure that you have information on when and where you purchased this product to hand.

Datel Customer Services Europe

Customers Services, Datel Ltd, Stafford Road, Stone, Staffordshire, ST15 0DG. UNITED KINGDOM

- Email: customer.service@codejunkies.com
- Web: <http://support.codejunkies.com/>

© 2018 Datel Ltd. PowerSaves is a trademark of Datel Ltd. Pokémon is a trademark or registered Trademark of the POKÉMON COMPANY. All other trademarks are the property of their respective owners. Go-tcha for Pokémon Go is a 100% unofficial product and is NOT sponsored, endorsed or approved by NINTENDO, nor any games developer or publisher.

Documents / Resources

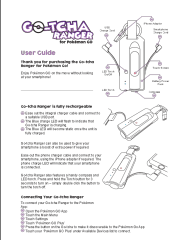
	<p>PoKeMoN GO Go-Tcha Ranger LED Touch Screen [pdf] User Guide</p> <p>Go-Tcha, Ranger LED Touch Screen, Go-Tcha Ranger LED Touch Screen, LED Touch Screen, Touch Screen</p>
-------------------------------------------------------------------------------------	---------------------------------------------------------------------------------------------------------------------------------------------------------------------------------------------

References

-  [Codejunkies Support - support.codejunkies.com](http://support.codejunkies.com)