



PNI WP800 SmartHome Wifi Programmable Smart Plug User Manual

[Home](#) » [PNI](#) » PNI WP800 SmartHome Wifi Programmable Smart Plug User Manual 



PNI SmartHome WP800
Smart socket
User manual



Contents

1 Technical specifications

2 Documents / Resources

Technical specifications

- Supply voltage: 100-240V AC (50/60Hz)
- Maximum power: 3680 W
- Maximum current: 16 A
- Wireless Frequency: 2.4GHz WIFI
- Transmission power: 100mW
- Wireless Standard: IEEE802.11 b/g/n
- Connector type: 2-pin Schuko
- Operating temperature: -26°C ~ +80°C

Manual command of the smart socket

1. Insert the WP800 smart socket into a standard 230VAC socket.
2. To manually turn the socket on or off, press the button  on the side of it.

Reset the socket

1. Hold down for about 5 seconds the button  on the side of the smart socket.
2. The indicator LED will flash quickly.

Tuya Smart app

1. Install the Tuya Smart application on your mobile phone through Google Play or the App Store or by scanning the next QR code.
2. Open the application and log in.



<http://smart.tuya.com/download>

Add the smart socket in Tuya Smart application

1. Connect your phone to the wireless network.
2. In the Tuya Smart application, click on the “+” button in the upper right corner or on the Add device button.
3. On the smart socket, hold down the button for about 5 seconds. The LED will flash quickly, to confirm that the socket is in pairing mode.
4. In the application, select the Electrical option from the list of devices on the left, afterward select the option Socket (WiFi) from the list of options on the right side of the screen.
5. Click on the Next button in the application, then check the Confirm the indicator is blinking rapidly option. Click on Next.
6. In the next interface, select the WiFi network you have connected the phone to and enter its password.
7. The application will start scanning nearby devices.

After identifying your socket, click the Done button to complete the procedure for adding the socket to the application.

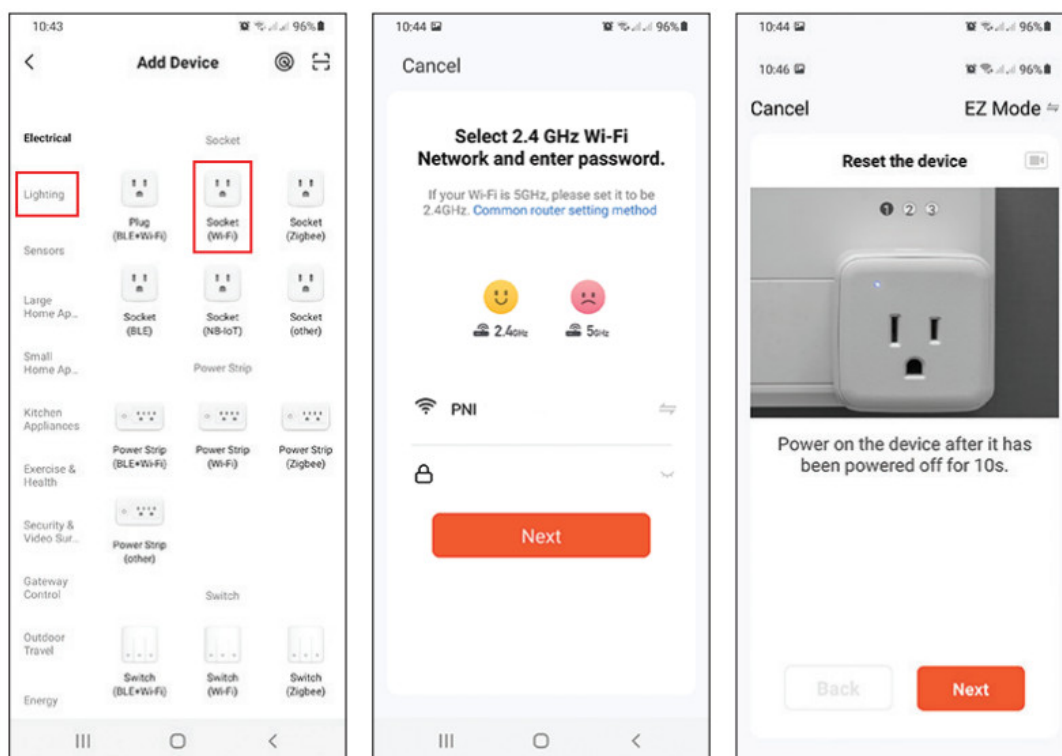

Note: Due to the numerous updates of the Tuya Smart application, it is possible that the images and information described in this manual are different from the version you have installed.

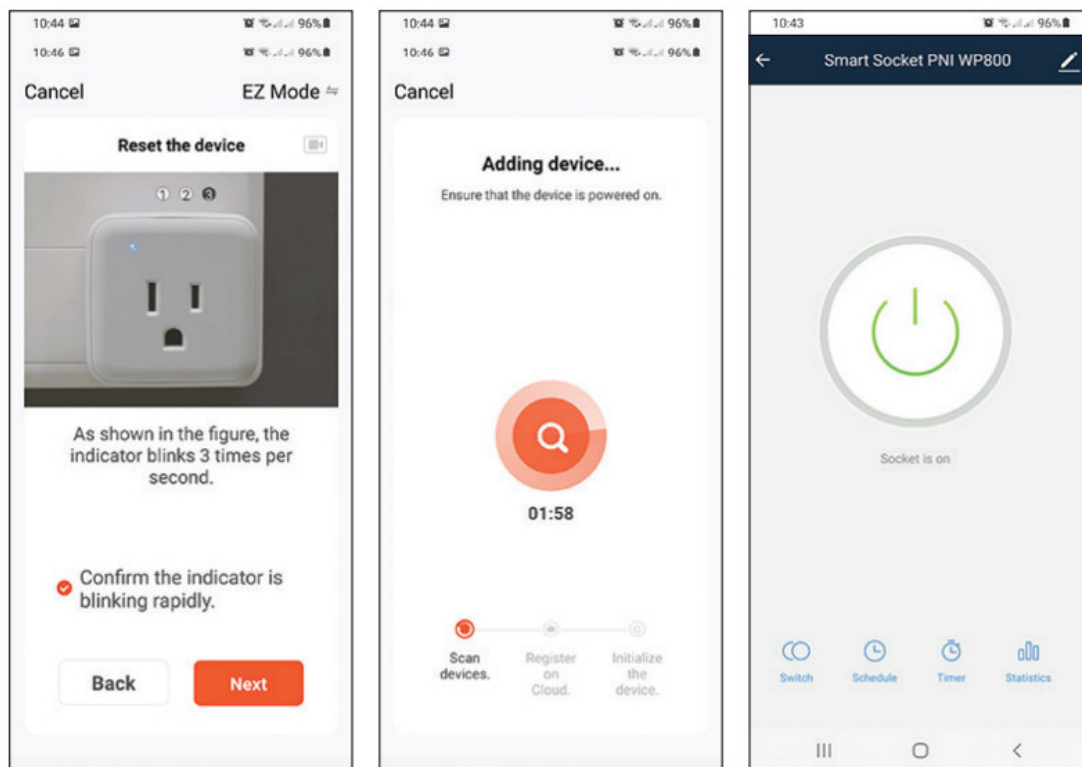

Socket control through the Tuya Smart app

From the Tuya Smart application, from wherever you are, provided you have an internet connection, you can control your smart socket.

Functions:

- Switch On/Off.
- Set operating schedule (Schedule). Schedule certain hours for the socket to turn on or off.
- Timer. Schedule the time after which the socket will turn off.
- Sharing. Share the socket with other family members.

The PNI WP800 smart socket can also be controlled by voice commands via Amazon Alexa or Google Home.

Simplified EU declaration of conformity

SC ONLINESHOP SRL declares that the PNI SmartHome WP800 smart socket is in accordance with the RED Directive 2014/53/EU. The full text of the EU Declaration of Conformity is available at the following internet address: <https://www.mypni.eu/products/6947/download/certifications>

Documents / Resources

	<p>PNI WP800 SmartHome Wifi Programmable Smart Plug [pdf] User Manual WP800 SmartHome Wifi Programmable Smart Plug, WP800, SmartHome Wifi Programmable Smart Plug, Programmable Smart Plug, Smart Plug, Plug</p>
---	--