



PNI CT28WIFI Gateway Hub User Guide

[Home](#) » [PNI](#) » PNI CT28WIFI Gateway Hub User Guide 

PNI CT28WIFI Gateway Hub User Guide



Contents

- [1 Technical specifications](#)
- [2 Usage instructions](#)
- [3 Connecting the hub to the WiFi network and adding it to the Tuya Smart application](#)
- [4 Pairing with PNI CT28 PRO control unit](#)
- [5 Simplified EU declaration of conformity](#)
- [6 Certificate of quality and commercial warranty](#)
- [7 Documents / Resources](#)
 - [7.1 References](#)
- [8 Related Posts](#)

Technical specifications

Supply voltage: 5V

Operating current: 1A
Connector: USB-C
RF frequency: 868MHz / <25mW
WiFi frequency: 2.4 GHz / 100 mW
Dimensions: Ø 65 x 15mm
Operating temperature: -26 ~ +80°C
Protection grade: IP30

Usage instructions

Insert the included power cable into the USB-C port on the hub. Connect the other end of the cable to the 230V – 5V adapter. Plug the adapter into an outlet.

Connecting the hub to the WiFi network and adding it to the Tuya Smart application

Note: Due to the numerous updates to the Tuya Smart application, the images and information described in this manual may be different from the version you installed.

Make sure you have your mobile phone connected to the WiFi 2.4GHz network, the Bluetooth function and the location activated.

Download the Tuya Smart application.



Android



iOS



Open the application, create an account and log in.

Power the hub to a 230V power source. The green LED blinks infrequently.

Add the hub to the application by pressing the + icon in the upper right corner of the screen or by pressing the “Add device” button.

Select the “Others” option from the left side of the screen.

From the list of devices displayed on the right side of the screen, select “Connector (Wi-Fi)”.

Select the WiFi network you want to connect to and add the network password. Click “Next”.

Long press the button on the hub. The green and red LEDs blink frequently.

Then press “Confirm the indicator is blinking”.

The application will start scanning nearby devices.

After the hub has been identified, you will receive the “Added Successfully” confirmation

To finish, click on the “Done” button.

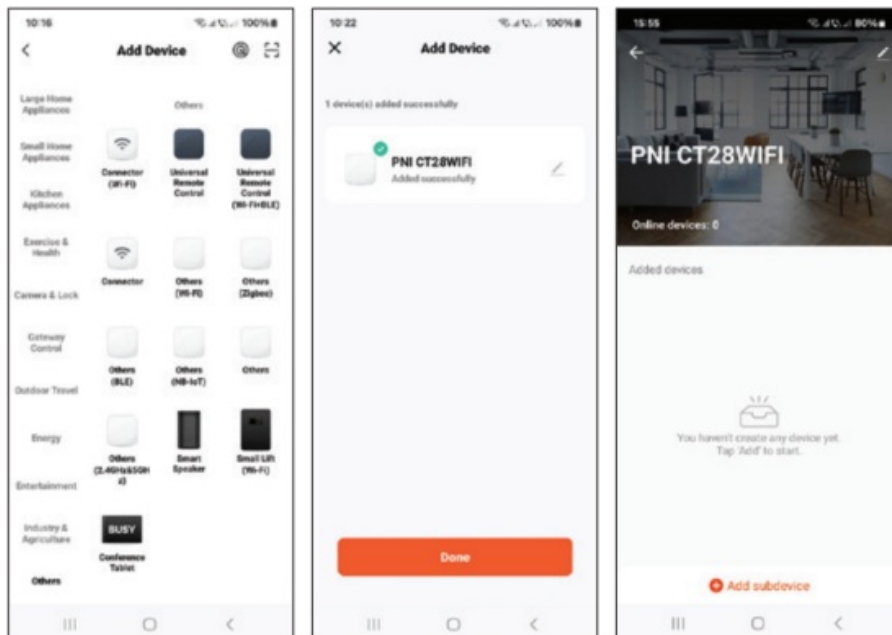

Pairing with PNI CT28 PRO control unit

Note: The PNI CT28 PRO unit must be purchased separately.

After adding the hub to the application, press “Add subdevice”.

In the interface that appears, click on “More device reset methods”.

From the list of devices, select “Heater”.

Turn off the thermostat from the on/off button.

Press and hold the M key until a four-character code appears on the screen.

Press the + or – key. The code and the signal indicator start blinking.

In the application, press “Confirm the indicator is blinking rapidly”.

After your device has been found, press “Done”.

Rename the device if you want, then press “Done” to complete the pairing procedure. The signal indicator remains lit in the right corner of the screen.

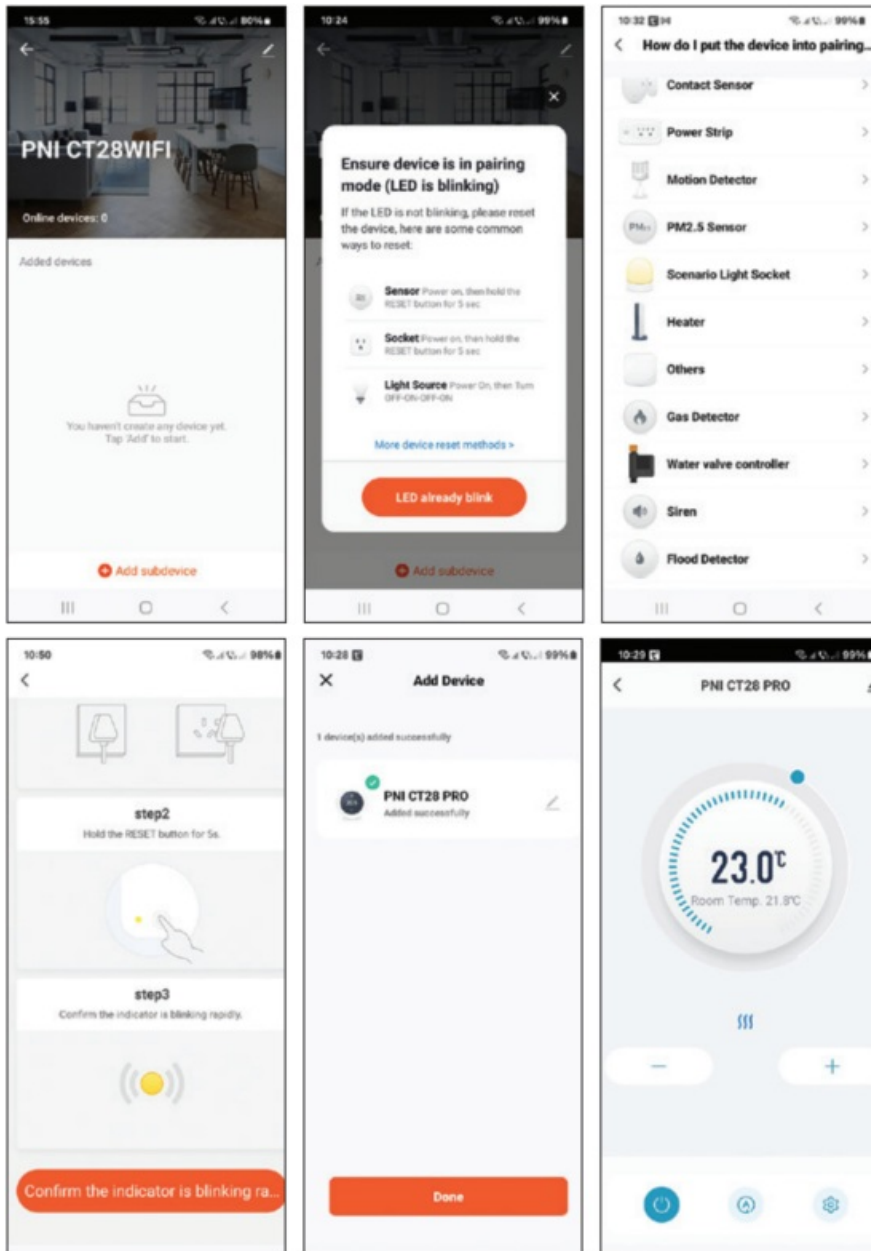

Simplified EU declaration of conformity

ONLINE SHOP SRL declares that the PNI CT28WIFI Internet Hub is in compliance with the RED Directive 2014/53/EU. The full text of the EU declaration of conformity is available at the following internet address: <https://www.mypni.eu/products/10520/download/certifications>.

Certificate of quality and commercial warranty

The warranty period for natural persons is 24 months as of the delivery date for the manufacturing and material

defects.

The warranty period for legal entities is 12 months as of the delivery date for the manufacturing and material defects.

The commercial warranty shall not impair the consumer rights provided by the applicable legislation in force, namely Emergency Government Ordinance 140/28.12.2021 on certain issues related to contracts for the sale of goods, the Government Ordinance 21/1992 on the consumer protection as subsequently amended and supplemented by Law 296/2004 on the consumption code as subsequently amended and supplemented.



Please download the full version of the warranty certificate:



Please download the full version of the user manual:



Documents / Resources

<p>PNI CT28WIFI</p> <p>Gateway Hub</p>  	<p>PNI CT28WIFI Gateway Hub [pdf] User Guide CT28WIFI, CT28WIFI Gateway Hub, Gateway Hub, Hub</p>
--	---

References

- [User Manual](#)

[Manuals+](#), [Privacy Policy](#)

This website is an independent publication and is neither affiliated with nor endorsed by any of the trademark owners. The "Bluetooth®" word mark and logos are registered trademarks owned by Bluetooth SIG, Inc. The "Wi-Fi®" word mark and logos are registered trademarks owned by the Wi-Fi Alliance. Any use of these marks on this website does not imply any affiliation with or endorsement.