



PLT Solutions PLT-90476 6 Selectable LED Downlight with Nightlight Instruction Manual

[Home](#) » [PLT SOLUTIONS](#) » PLT Solutions PLT-90476 6 Selectable LED Downlight with Nightlight Instruction Manual 



Instruction Manual

Contents

- [1 PLT-90476 6 Selectable LED Downlight with Nightlight](#)
- [2 Installation Instructions](#)
- [3 Surface Mount](#)
- [4 Documents / Resources](#)
 - [4.1 References](#)

PLT-90476 6 Selectable LED Downlight with Nightlight

WARNING

- Installation, service, and maintenance of luminaries should be performed by a qualified licensed electrician.

CAUTION

- Do not make or alter any holes in the wiring enclosure or electrical components during installation.
- This device is not intended for use with emergency exits.
- Minimum 90°C supply conductors.

Installation Instructions

Recessed Mount to Existing Housing

Step 1. Open the package and take out the following accessories:



Step 2. Take out the disk light and install the multifunctional bracket on the back of the light.

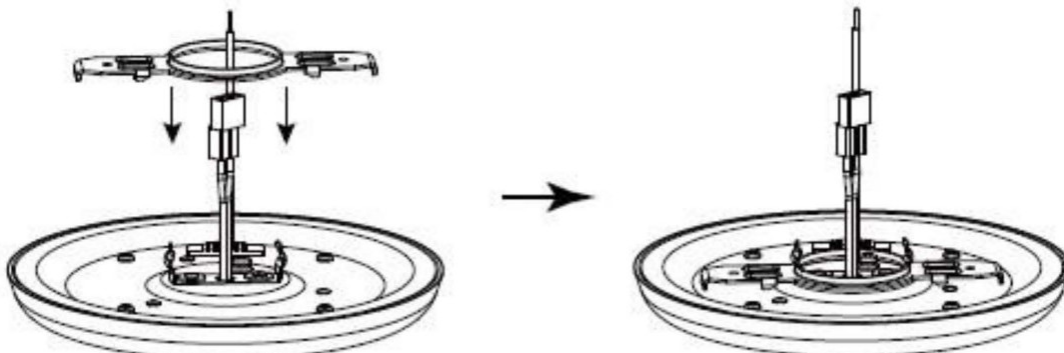

Step 3. Take out the spring tabs and screws and install them on the disk light.

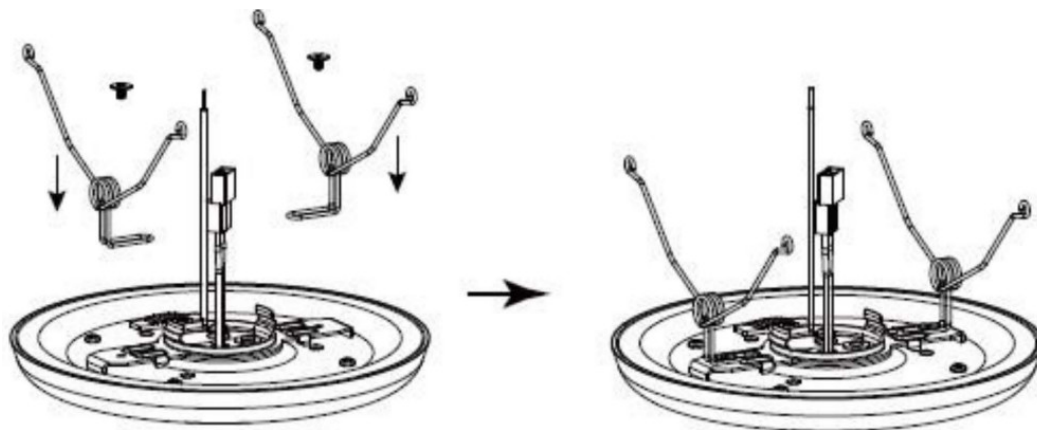

Step 4. Loosen the screws on the bracket to adjust the spring tabs so they can fit 5 or 6-inch cans. If the can is 4-inches, the spring tabs need to be rotated 180°. Once the spring tabs are in the right position, tighten the screws on the bracket.

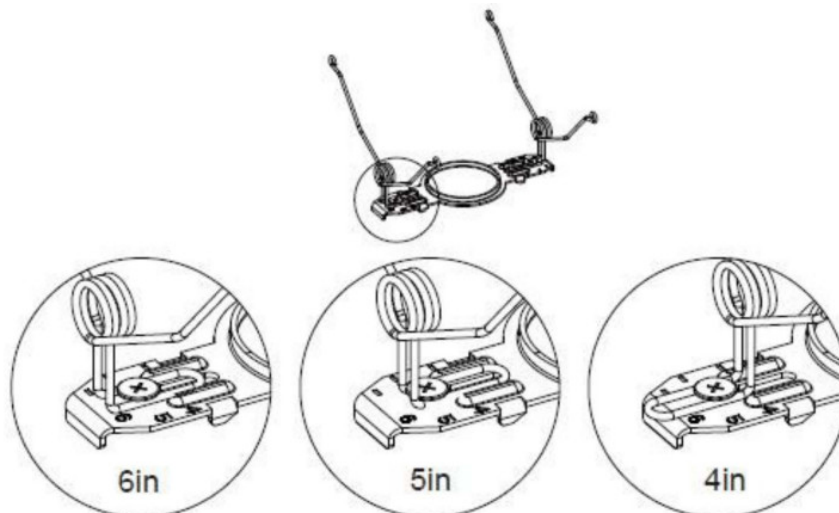

Step 5. Take out the E26 adapter and screw it into the socket of the recessed housing (not provided).

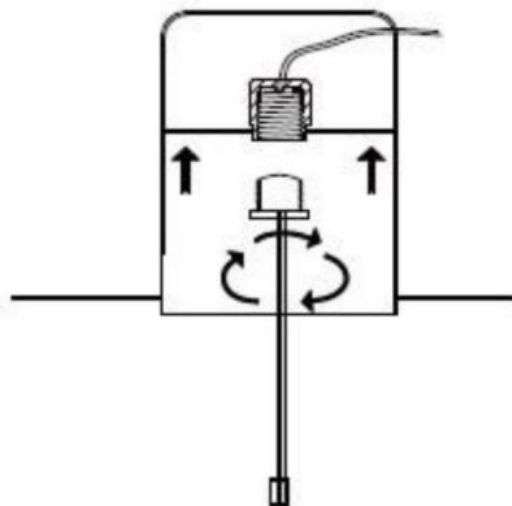

Step 6. Select your desired CCT by sliding the switch on the top of the disk light to the desired setting. Then connect the fast connector between the recessed housing and the disk light.

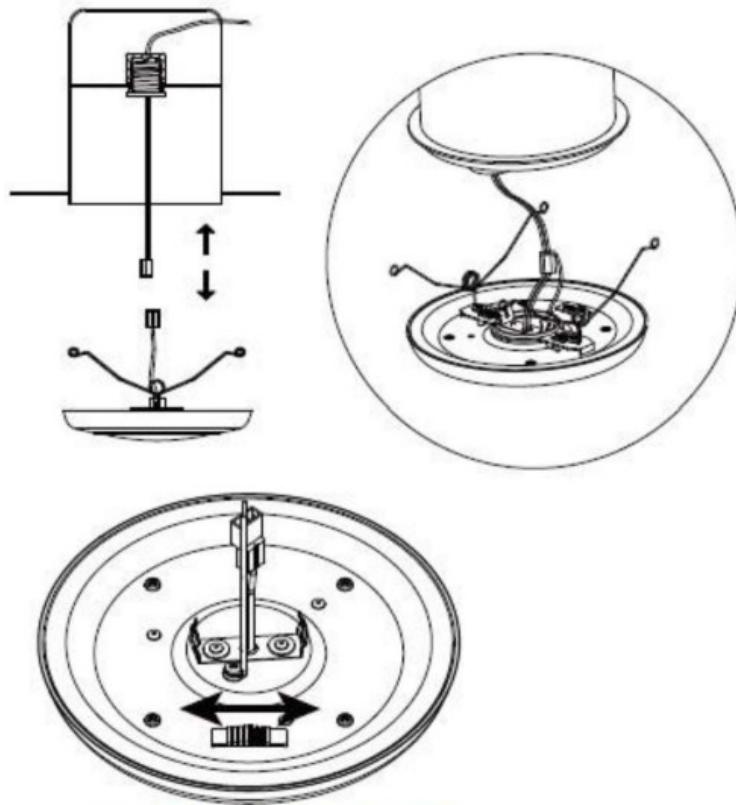

Selectable CCT Switch

Step 7. Press the spring tabs of the disk light in and slide them into the can so they to the attach to the brackets on the housing.

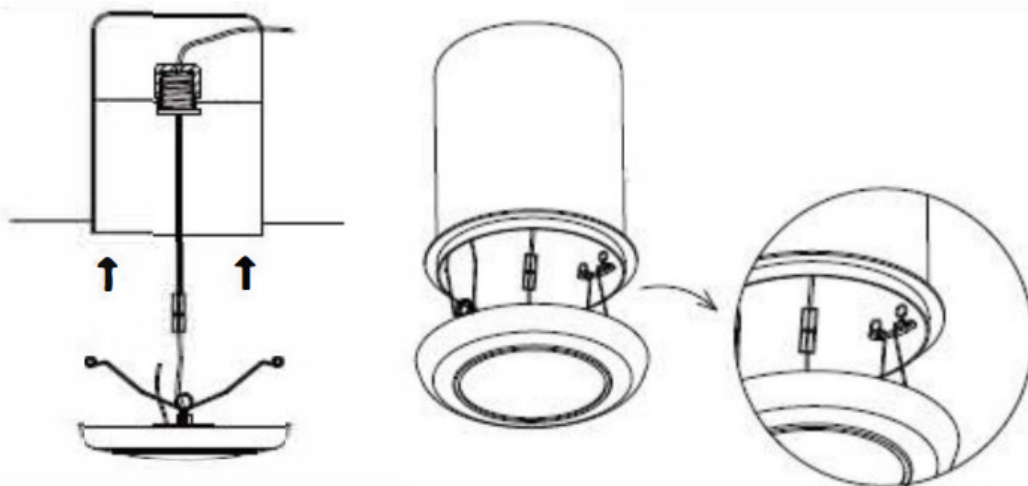

Step 8. Push the disk light into the recessed housing, making sure it's firmly attached. Then turn on the power to verify your successful installation.

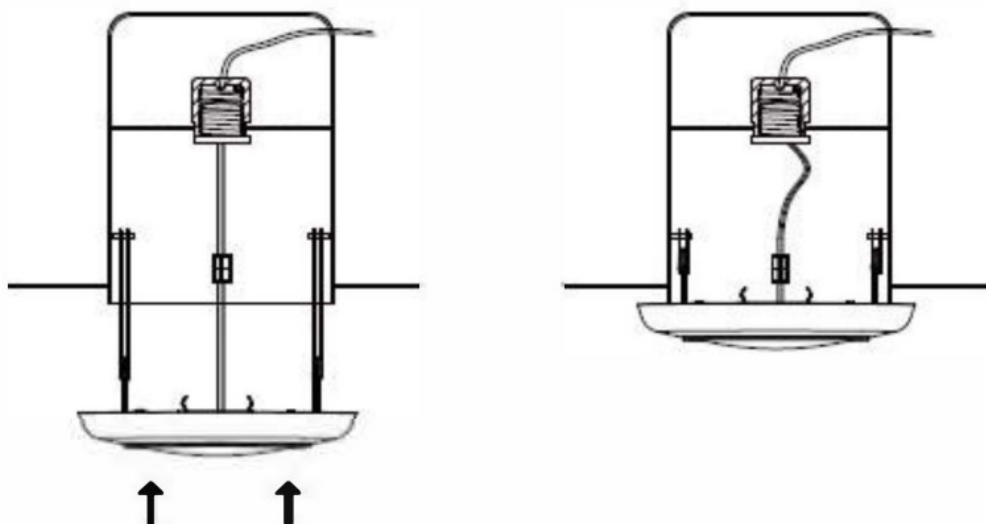

For DOWNLIGHT ON only:

Flip the light switch ON.

For Night Light ON only:

Turn ON the downlight. Flip the light switch OFF, then back ON again.

Reset to Downlight ON from Night Light:

Flip the light switch OFF and hold for 5 seconds to reset to Downlight ON.

Surface Mount

Step 1. Open the package and take out the following accessories:



Step 2. Attach the multifunction bracket to the junction box (not provided) with two M4x6 screws.

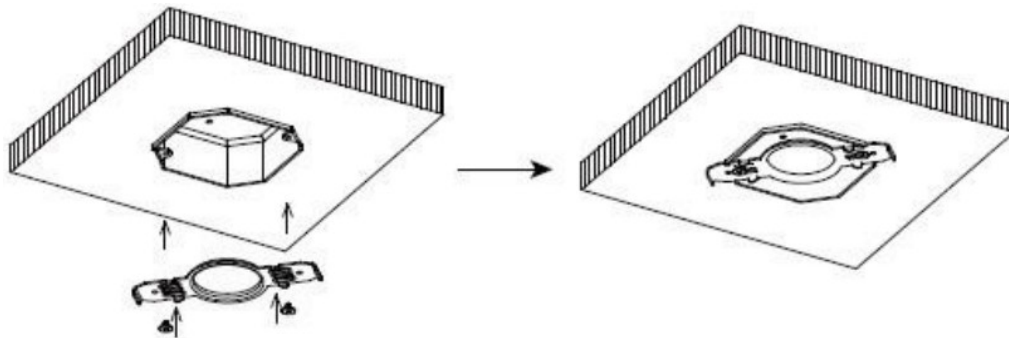

Step 3. Use scissors to cut off the E26 adapter and strip the wires to expose 10mm of the copper core.

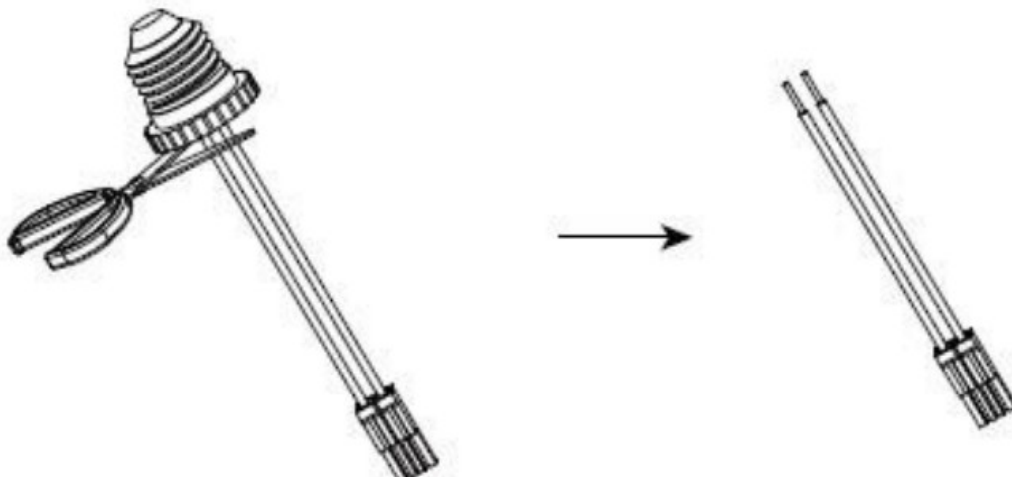

Step 4. Take out the AC wires from the junction box and connect them to the terminal connectors using wire nuts:

Black wire (L) to black wire (L)

White wire (N) to white wire (N)

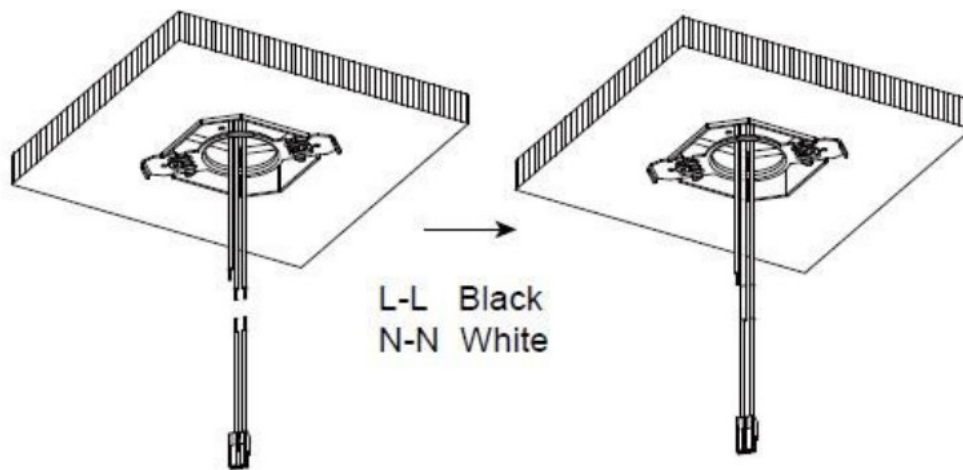

Step 5. Select the desired CCT by sliding the switch on the top of the disk light to your desired setting, then connect the male and female fast connector between the disk light and junction box. Use a wire nut to connect the ground wires.

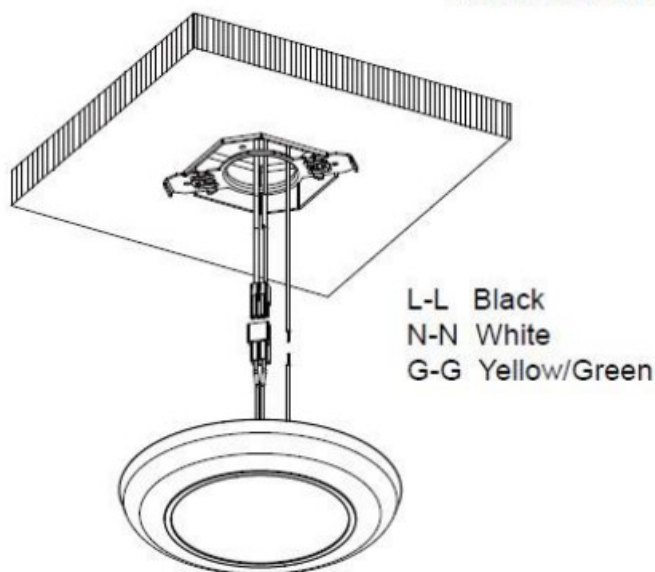
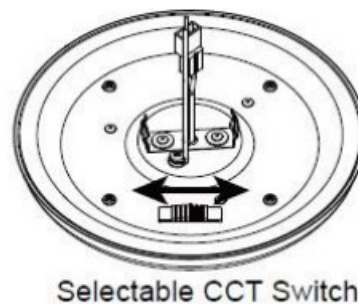

Step 6. Check if the wires are well connected and put them inside of the junction box, then attach the disk light to the multi-functional bracket.

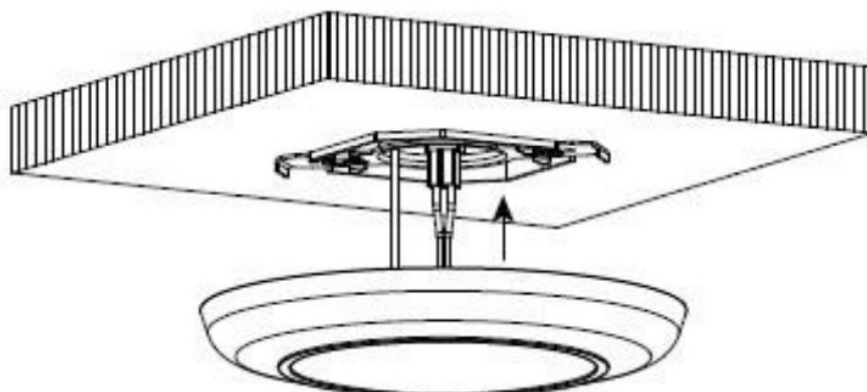

Step 7. Turn on the power to verify your successful installation.

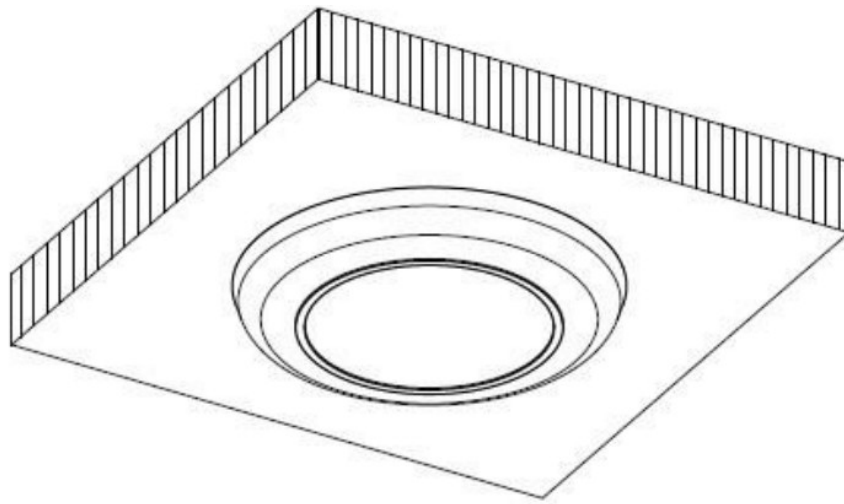

For DOWNLIGHT ON only:

Flip the light switch ON.

For Night Light ON only:

Turn ON the downlight. Flip the light switch OFF, then back ON again.

Reset to Downlight ON from Night Light:

Flip the light switch OFF and hold for 5 seconds to reset to Downlight ON.



WARNING

- Before installing, servicing, or performing routine maintenance upon this equipment, follow these general precautions.
- To reduce the risk of death, personal injury, or property damage from fire, electric shock, falling parts, cuts/abrasions, and other hazards, read all warnings and instructions included with and on the fixture box and all fixture labels.
- Proper grounding is required to ensure safety.
- Power must be turned off at the breaker before installation or maintenance.
- This product must be installed in accordance with the applicable installation code by a person familiar with the construction and operation of the product and the hazards involved.
- Wear gloves and eye protection at all times while installing, servicing, or performing maintenance on the luminaire, and avoid direct eye exposure to the light source while it is on.
- To prevent wiring damage or abrasion, do not expose wiring to edges of sheet metal or other sharp objects.
- Do not install damaged product. Inspect luminaire for damage that may have occurred during transit. If damaged, contact the manufacturer immediately.
- These instructions do not purport to cover all details or variations in equipment nor to provide every possible contingency to meet in connection with installation, operation, or maintenance. Should further information be desired or should particular problems arise which are not covered sufficiently for the purchaser's or owner's purposes, contact the manufacturer.



[972-535-0926](tel:972-535-0926)
pltsolutions.com
ver 082124

Documents / Resources

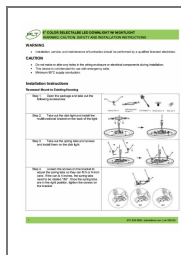

[PLT Solutions PLT-90476 6 Selectable LED Downlight with Nightlight](#) [pdf] Instruction Manual
PLT-90476, PLT-90476 6 Selectable LED Downlight with Nightlight, PLT-90476, 6 Selectable LED Downlight with Nightlight, LED Downlight with Nightlight, Downlight with Nightlight, with Nightlight, Nightlight

References

- [PLT](#)
- [User Manual](#)

Manuals+, Privacy Policy

This website is an independent publication and is neither affiliated with nor endorsed by any of the trademark owners. The "Bluetooth®" word mark and logos are registered trademarks owned by Bluetooth SIG, Inc. The "Wi-Fi®" word mark and logos are registered trademarks owned by the Wi-Fi Alliance. Any use of these marks on this website does not imply any affiliation with or endorsement.